



MoDOT FACT SHEET

I-270 Bridge Renovation at New Florissant Road (Route N)

What is the problem?

The I-270 bridge over New Florissant Road in north St. Louis County is more than 50 years old. It is classified as structurally deficient and this summer we have a project to replace the driving surface with a new structural overlay. This project is a practical solution to extend the usable life of the bridge until funding becomes available for a full replacement.

What will this mean?

In summer 2015, MoDOT has scheduled a project to renovate the driving surface on the bridge over New Florissant Road. To do this safely and quickly, MoDOT has determined that the department will need to close New Florissant Road under I-270 for one month to remove the driving surface of the bridge and replace it. New Florissant Road will be closed from Dunn Road to Jean Drive and there will be no access to or from eastbound I-270. Substantial traffic delays are expected.

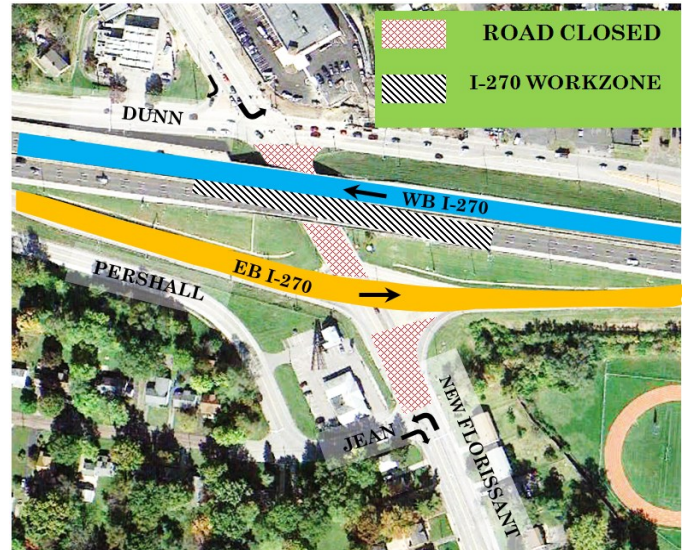

When will construction begin?

Major construction on I-270 over New Florissant Road will begin the week of July 6. Residents should expect noise at all hours of the day for the duration of the project.

Why does New Florissant Road have to be closed?

New Florissant Road must be closed in order to maintain traffic flow on I-270. Eastbound I-270 traffic will be routed down and back up the interchange ramp without stopping. There will be no access to or from eastbound I-270 at this location.

Are there other options besides closing the road?

MoDOT evaluated several options before determining closing New Florissant Road was the safest and fastest way to do the work. Other options for completing the bridge took longer, had longer anticipated backups and more confusing work zones to drive through.