

USER PRICE LIST

Scorpion Truck Mounted Attenuator

Upgrade Options, Parts & Accessories

Upgrade Options			
<u>Stock No</u>	<u>Shipping Weight #</u>	<u>Description</u>	<u>Suggested User Price</u>
10929	28	*Quick Release Kit - (4) T-Pins, (4) Safety Snaps , Heavy Duty Swivel Jacks & 20' Battery Cables with Quick Disconnect	\$895.00
* P6 (add to end of TMA part number)	300	*Fast-Trak SwiftConnect - 6" Fast-Trak System w 5/8" steel truck side backing plate, HD swivel jacks, 20' quick disconnect bat. cable & ind. Connector **For additional lengths and options, see pages 4 & 5	2,230.00
10558-TMA	na	*LED Tail Light Upgrade Kit for TMA - Contains 4 Red LED Tail Light Assemblies	389.00
*G (add to end of TMA part number)	na	*Galvanized Upgrade Option - Replaces all painted steel parts on TMA with Galvanized finish	985.00
10000-TL2-UP-FB	1231	TL-2 to TL-3 Upgrade Kit - Complete - For Flat Bed Trucks	11,550.00
10000-TL2-UP-DT	1241	TL-2 to TL-3 Upgrade Kit - Complete - For Dump Trucks	11,925.00
11027-INSTALL	6	*In Cab Controller - 2 Button Controller with 30' Cable, Socket & Motor Connector - Factory Installed	213.60
Parts			
10001	775	Replacement TL-3 Rear Cartridge - Includes energy absorbing boxes A, B & C, diaphragms, cartridge tube assemblies, lights, wire harnesses, reflective sheeting and hardware	\$9,995.50
10002-R	1470	Replacement TL-3 Strut - Includes energy absorbing box D, diaphragm, strut tube assemblies, lights, wire harnesses, reflective sheeting and hardware. (Does not include: rear backup, mounting hardware, hydraulic cylinders, hose assembly, motor & pump)	11,585.00
10400A	74	Module A Energy Absorbing Back Box	1,613.60
11010	75	12 Volt Motor Assembly Service Replacement w/ORB & NPT Fittings	993.10
10928	15	20' Battery Cables with Quick Disconnect	235.00
11026	6	Cab Controller (Extra) with 30' Cable & Male Plug Connector	175.50
11048	6	In-Cab Controller - 2 Button Controller with 30' Cable with Socket & Motor Connector - For Field Installation	181.50
Accessories			
10390	621	Hydraulic Vertical Lift - Raises arrow board or message board. (arrow board, message board not included)	\$4,680.00
11108	78	Dump Truck Quick Hitch Bracket Kit - Includes (2)Tube Weldments,(2) Splice Plates & Hardware	495.00
11040A	707	Cone Cage with Mounting Hardware	3,110.50
10350	155	Standard Frame Mount- Flat Bed Truck Complete Assembly; Includes (2) Steel Angles, (1) Bottom Angle, (1) Backing Plate and Mounting Hardware	765.00
11088	300	12" Extender Frame - Complete Assembly; Includes 12" Extension Frame, (2) Splice Plates, (2) Vertical Mounting Tubes and Mounting Hardware	1,910.00
11087	685	24" Extender Frame - Complete Assembly; Includes 24" Extension Frame, (1) Mounting Plate, (2) Vertical Mounting Angles, (1) Left & (1) Right Mounting Angles, (2) Pintle Eye Support Tubes (2) Heavy Duty Jacks and Mounting Hardware	3,685.00

* Price is for upgrade option on new units only

For Other Options and Parts - Please Refer To Our Parts Price List

USER PRICE LIST
Scorpion 10,000 TMA Parts List - Major Components

Item #	Part #	Item Description	Quantity Needed/ TMA	Suggested User Price/Ea
1	10100L	Cartridge Tube Assembly Left	1	\$1,528.20
2	10100R	Cartridge Tube Assembly Right	1	1,528.20
3	10100D	Cartridge Diaphragm, Rear	1	661.20
4	10100E	Cartridge Diaphragm, Front of Rear	1	1,018.80
5	10200TR	Strut Tube Frame Right	1	1,447.80
6	10200TL	Strut Tube Frame Left	1	1,447.80
7	10118	Strap Assy (Left & Right)	1	249.90
8	10200E	Strut Diaphragm Assembly, Rear	1	871.80
86	10127	Rear Bottom Angle, Cartridge	1	104.80
9	10465	Rear Top Angle, Cartridge	1	90.30
10	10300	Back-Up, Painted	1	1,899.70
11	10351	Bracket Hydraulic Right	2	73.60
12	10352	Bracket Hydraulic Left	2	73.60
13	10353	Backing Plate	1	146.30
14	10354	4" x 9" Angle Right	1	308.40
15	10355	4" x 9" Angle Left	1	308.40
16	10356	4" x 4" Bottom Angle	1	110.00
17	10400A	Module A Energy Absorber w/4" Yellow Sheeting	1	1,613.60
18	10400B	Module B Energy Absorber	1	1,138.00
19	10400C	Module C Energy Absorber	1	1,672.60
20	10400D	Module D Energy Absorber	1	3,537.70
21	10508	Left Turn Light -12V	2	94.90
21	10504	Left Turn Light -24V	2	120.60
22	10516	Right Turn Light -12V	2	94.90
22	10505	Right Turn Light -24V	2	120.60
23	10500B	ICC Bar Light Assembly - 12V	1	177.40
24	10502	Side Marking Light - 12V	4	12.00
24	10530	Side Marking Light - 24V	4	9.70
24	10520	Side Marker Light Bracket White, Plastic	4	6.60
24	10524	Side Light, Bracket Aluminum Angle	4	12.90
25	10601A	Hydraulic Cylinder 2-1/2" Dia x 8" Stroke Cylinder Assembly - Field Replacement w/ORB & NPT Fittings used Between Strut & Cartridge	2	170.50
26	10701	Standard Swivel Jack (see pg. 7 for drawing)	2	76.20
26	10701NJ	Heavy Duty Swivel Jack (see pg. 7 for drawing)	2	246.90
26	10701MNJ	HD Swivel Jack-Modified (see pg 7 for drawing)	2	286.10
27A	10725	Drop Jack w/ Caster	2	110.20
27B	10750	Drop Jack Mounting Bracket - Universal	2	108.30
29	10800	Lock Out Arm Mechanism Assy	1	621.90
30	10357	Flat Bed Center Supp Assy	1	697.90
40	10550L	Left Tail Light Cover Assy (12 & 24V)	1	72.50
41	10550R	Right Tail Light Cover Assy (12 & 24V)	1	72.50
42	10532A-L	Left Strut Light Bracket	1	20.60
43	10532A-R	Right Strut Light Bracket	1	20.60
50	11001A	Hydraulic Cylinder, 3" Dia x 8" Stroke Cylinder Assembly - Field Replacement w/ORB & NPT Fittings Used On Backup To TMA	2	194.70
50B	11066B	Hydraulic Cylinder, 3"Dia x 8"(Mod 4")Stroke Cylinder Asy-Field Replacement w/ORB & NPT Fittings Used On Backup To Model B TMA	2	238.60
51	10802A	Hydraulic Cylinder, 2" Dia x 4" Stroke Cylinder Assembly - Field Replacement w/ORB & NPT Fittings Used For Lockout Arm	1	158.10
149	11010	12 Volt Motor Assembly Service Replacement w/ORB & NPT Fittings	1	993.10
151	11021-12	Valve w 12V Coil, controls "up"	1	271.60
150	11020-12	Valve w 12V Coil, controls "down"	1	351.70
152	11024	12 Volt Solenoid	1	82.70
149	11011	24 Volt Motor Assembly Service Replacement w/ORB & NPT Fittings	1	1,043.70
151	11021-24	Valve w 24V Coil, controls "up"	1	275.00
150	11020-24	Valve w 24V Coil, controls "down"	1	355.10
152	11025	24 Volt Solenoid	1	86.00
77	10518	Junction Box	2	28.40

160 Ave. La Pata, San Clemente, CA 92673 (949) 361-5663 Fax (949) 361-9205

USER PRICE LIST
Scorpion 10,000 TMA - Major Components Parts Drawing

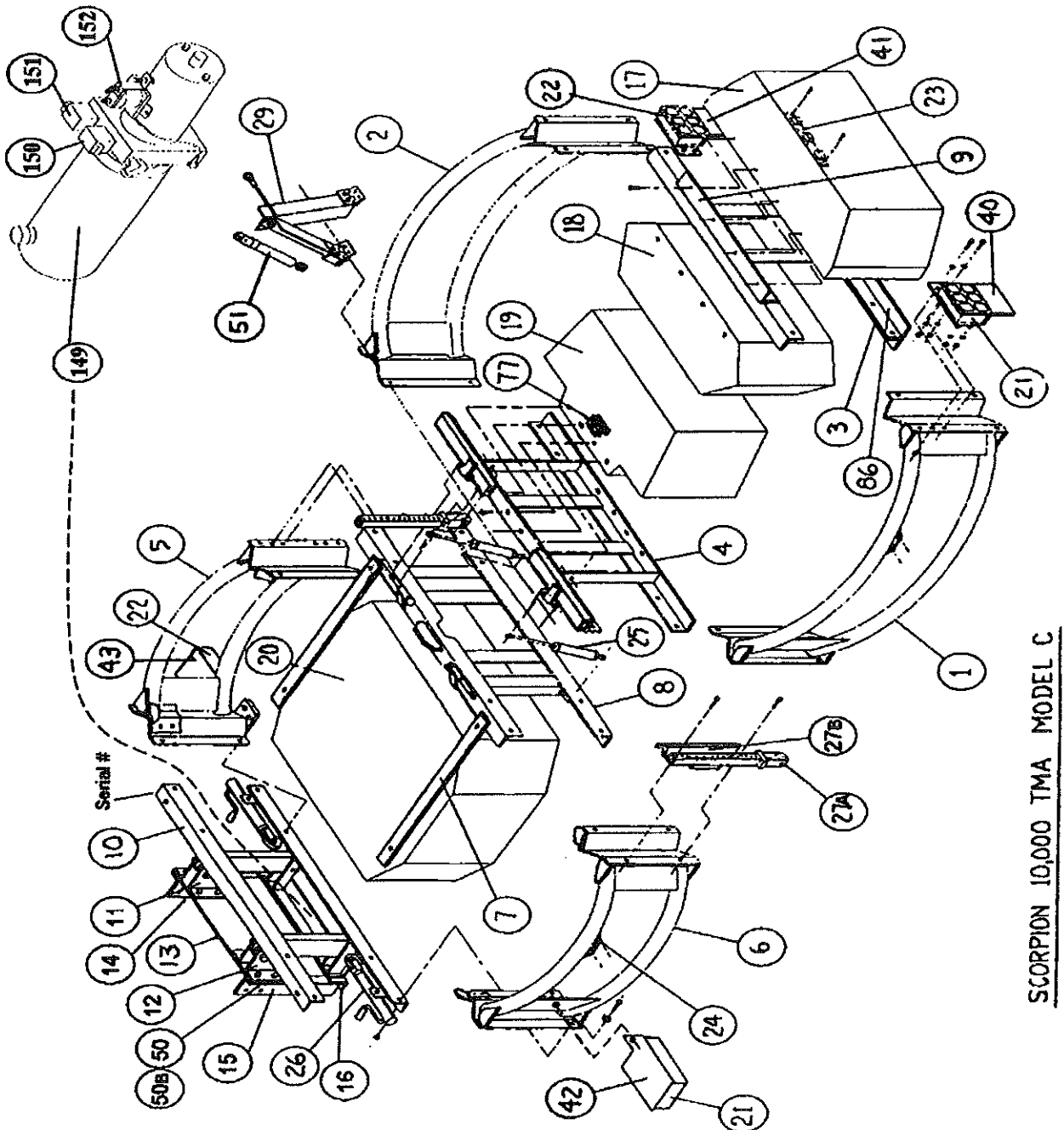

SCORPION 10,000 TMA MODEL C

- d. The MHTC's right to reject any unacceptable equipment, supplies, and/or services shall not exclude any other legal, equitable or contractual remedies the MHTC may have.

2.9.5 Insurance Requirements:

- a. The Bidder is directed to the "Standard Bid Provisions, General Terms and Conditions and Special Terms and Conditions" attached to the bid documents, regarding the amount and types of insurance certificates required to be submitted by the Bidder in accordance with Pricing Pages Options B-D, regarding On-Site Installation, for each item.

3. BID SUBMISSION

3.1 Bid Submission Information:

- 3.1.1 All bids must be received in a sealed envelope/package clearly marked RFB 3-140422BR,TMA and TrMA Bid".
- 3.1.2 All bids must be received at the office of the Buyer as outlined in Section 1. "INTRODUCTION AND GENERAL INFORMATION".
- 3.1.3 The Bidder may withdraw, modify or correct his/her bid after it has been deposited with MoDOT provided such request is submitted in writing and received at the location designated for the bid opening prior to the date and time specified for opening bids. Such a request received as specified will be attached to the bid and the bid will be considered to have been modified accordingly. No bid may be modified after the date and time specified for the opening of bids.
- 3.1.4 Bids must be completed on the forms provided herein, properly signed and with all items filled out. Do not change the wording of the bid forms and do not add words to the bid forms. Unauthorized conditions, limitations or provisions attached to the bid will be cause for rejection of the bid.
- 3.1.5 Submit only the original signed copy of the bid, along with the original signed copy of any and all addenda.
- 3.1.6 The Bidder shall submit the following with the bid:
 - a. A complete list or catalog describing all available training materials related to the items being proposed.
 - b. A complete options list and/or catalog describing parts with detailed pricing information for each make/model of TMA and/or TrMA being proposed.
 - c. Warranty information.
 - d. Descriptive literature and specifications showing the exact equipment being proposed.
 - e. An electronic source for this information should be provided as well. (i.e. Internet site, jump drive, CD, etc.)
www.trafficdevices.com
- 3.1.7 Open Competition / Request For Bid Document:
 - a. It shall be the Bidder's responsibility to ask questions, request changes or clarification, or otherwise advise MoDOT if any language, specifications or requirements of an RFB appear to be ambiguous, contradictory, and/or arbitrary, or appear to inadvertently restrict or limit the requirements stated in the RFB to a single source. Any and all communication from Bidders regarding specifications, requirements, competitive bid process, etc., must be directed to the buyer from MoDOT, unless the RFB specifically refers the Bidder to another contact. Such communication should be received at least five (5) working days prior to the official bid opening date.



Product Warranty

TraFFix Devices, Inc. warrants the design, material and workmanship of our products for a period of twelve months (12), to be free of any manufacturer's defects.

Exemptions from this general warranty include but are not limited to: "wear items," deterioration or fatigue from ordinary wear and tear, impacts and other abuse occurring within the warranty period.

TraFFix Devices, Inc.
160 Avenida La Pata
San Clemente, CA 92673