

PROJECT LIMITS
I-64 SLIDE REPAIRS
APPROX. 0.6 MILES

DISCLAIMER
THE PROFESSIONAL WHOSE SIGNATURE AND PERSONAL SEAL APPEAR HEREON ASSUMES RESPONSIBILITY ONLY FOR WHAT APPEARS ON THIS PAGE, AND DISCLAIMS (PURSUANT TO SECTION 327.411 RSMO) SPECIFICATION, ESTIMATES, REPORTS, OR OTHER DOCUMENTS OR INSTRUMENTS NOT SEALED BY THE UNDERSIGNED PROFESSIONAL RELATING TO OR INTENDED TO BE USED FOR ANY PART OR PARTS OF THE PROJECT TO WHICH THIS PAGE REFERS.

THE EXISTENCE AND APPROXIMATE LOCATION OF UTILITY FACILITIES KNOWN TO EXIST, AS SHOWN ON THE PLANS, ARE BASED ON THE BEST INFORMATION AVAILABLE TO THE COMMISSION AT THIS TIME. THIS INFORMATION IS PROVIDED BY THE COMMISSION "AS-IS" AND THE COMMISSION EXPRESSLY DISCLAIMS ANY REPRESENTATION OR WARRANTY AS TO THE COMPLETENESS, ACCURACY, OR SUITABILITY OF THE INFORMATION FOR ANY USE. RELIANCE UPON THIS INFORMATION IS DONE AT THE RISK AND PERIL OF THE USER, AND THE COMMISSION SHALL NOT BE LIABLE FOR ANY DAMAGES THAT MAY ARISE FROM ANY ERROR IN THE INFORMATION.

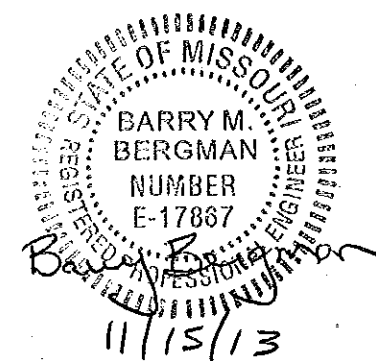
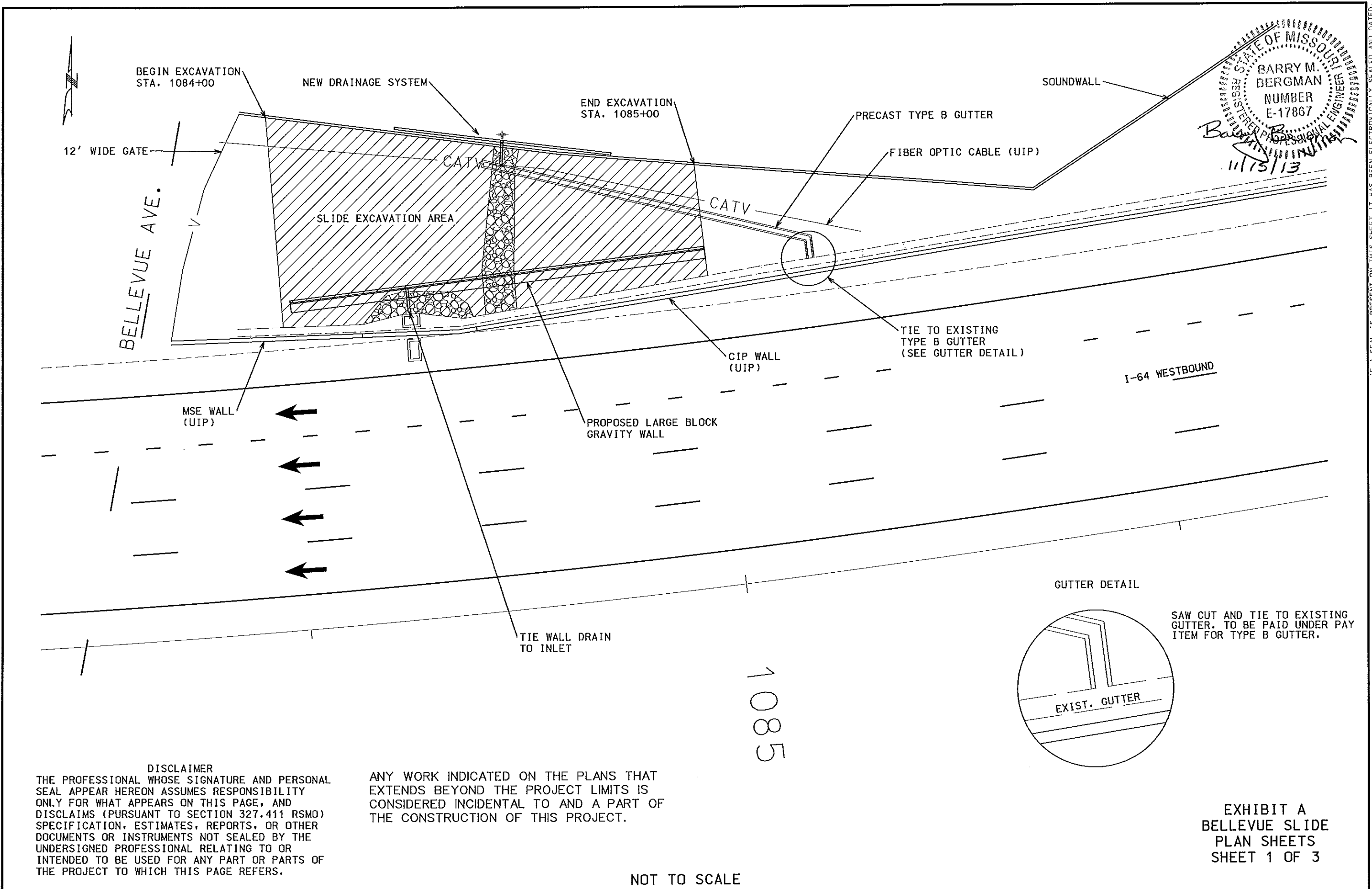

EXHIBIT A
ST. LOUIS CITY / COUNTY
TITLE SHEET

NOT TO SCALE



STATE OF MISSOURI
BARRY M. BERGMAN
REGISTERED PROFESSIONAL ENGINEER
NUMBER E-17867
11/15/13

DISCLAIMER
THE PROFESSIONAL WHOSE SIGNATURE AND PERSONAL SEAL APPEAR HEREON ASSUMES RESPONSIBILITY ONLY FOR WHAT APPEARS ON THIS PAGE, AND DISCLAIMS (PURSUANT TO SECTION 327.411 RSMO) SPECIFICATION, ESTIMATES, REPORTS, OR OTHER DOCUMENTS OR INSTRUMENTS NOT SEALED BY THE UNDERSIGNED PROFESSIONAL RELATING TO OR INTENDED TO BE USED FOR ANY PART OR PARTS OF THE PROJECT TO WHICH THIS PAGE REFERS.

ANY WORK INDICATED ON THE PLANS THAT EXTENDS BEYOND THE PROJECT LIMITS IS CONSIDERED INCIDENTAL TO AND A PART OF THE CONSTRUCTION OF THIS PROJECT.

NOT TO SCALE

EXHIBIT A
BELLEVUE SLIDE
PLAN SHEETS
SHEET 1 OF 3

IF A SEAL IS PRESENT ON THIS SHEET IT HAS BEEN ELECTRONICALLY SEALED AND DATED.

STATE OF MISSOURI
 BARRY M. BERGMAN
 REGISTERED PROFESSIONAL ENGINEER
 NUMBER E-17867
 11/18/13

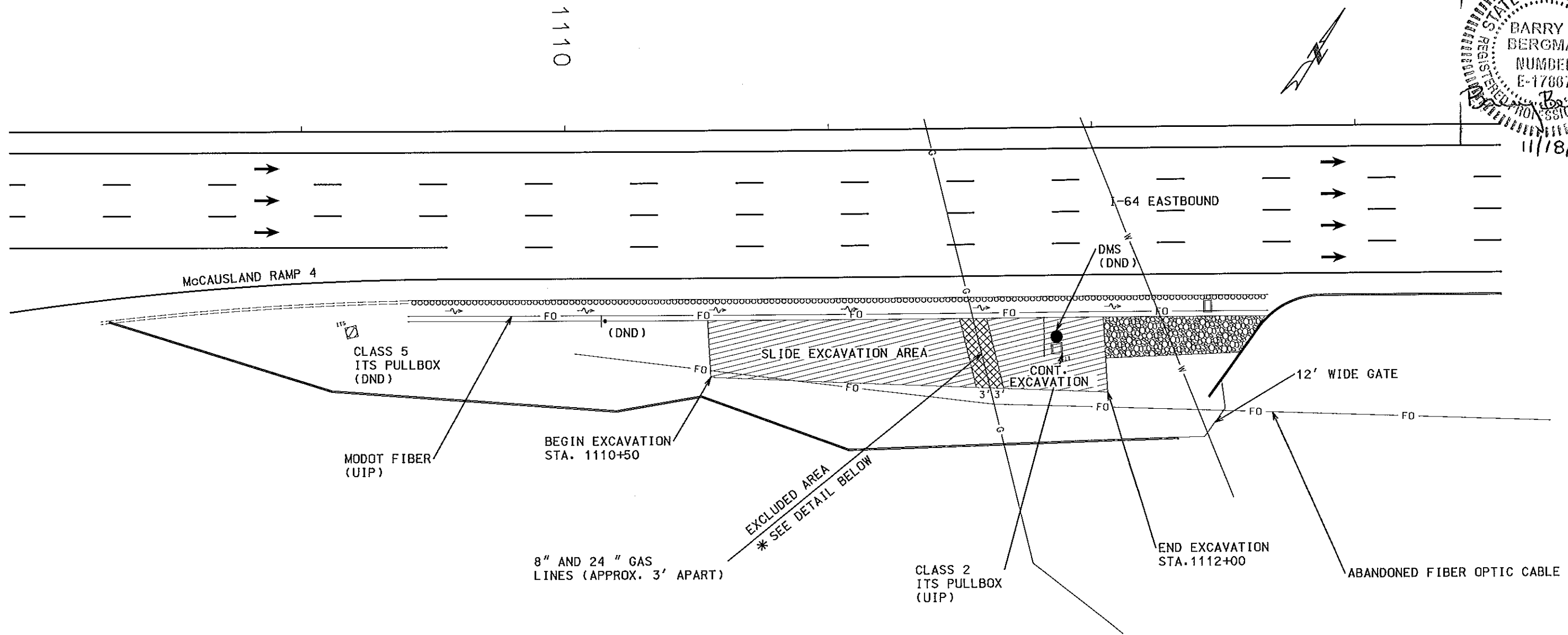

NOTE:
 BOTH 8" AND 24" GAS LINES HAVE BEEN POTHOLED IN THE FIELD BY LACLEDE GAS COMPANY. NO EXCAVATION SHALL TAKE PLACE WITHIN 36" OF EITHER LINE AND ABOVE THE GAS MAINS.

DISCLAIMER
 THE PROFESSIONAL WHOSE SIGNATURE AND PERSONAL SEAL APPEAR HEREON ASSUMES RESPONSIBILITY ONLY FOR WHAT APPEARS ON THIS PAGE, AND DISCLAIMS (PURSUANT TO SECTION 327.411 RSMO) SPECIFICATION, ESTIMATES, REPORTS, OR OTHER DOCUMENTS OR INSTRUMENTS NOT SEALED BY THE UNDERSIGNED PROFESSIONAL RELATING TO OR INTENDED TO BE USED FOR ANY PART OR PARTS OF THE PROJECT TO WHICH THIS PAGE REFERS.

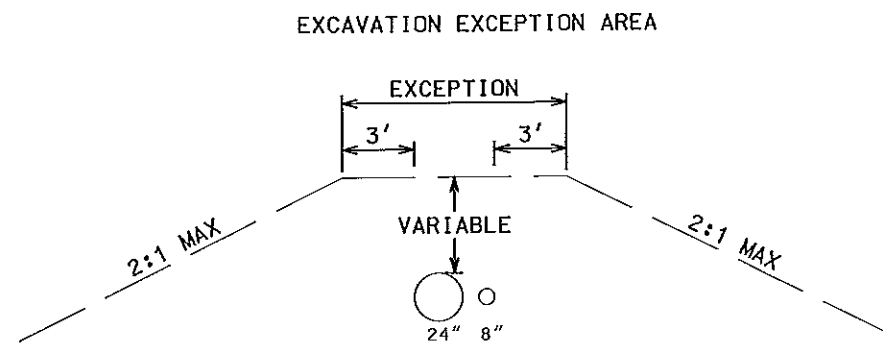

NOT TO SCALE

EXHIBIT A
 CLAYTON SLIDE
 PLAN SHEETS
 SHEET 2 OF 3

IF A SEAL IS PRESENT ON THIS SHEET IT HAS BEEN ELECTRONICALLY SEALED AND DATED.

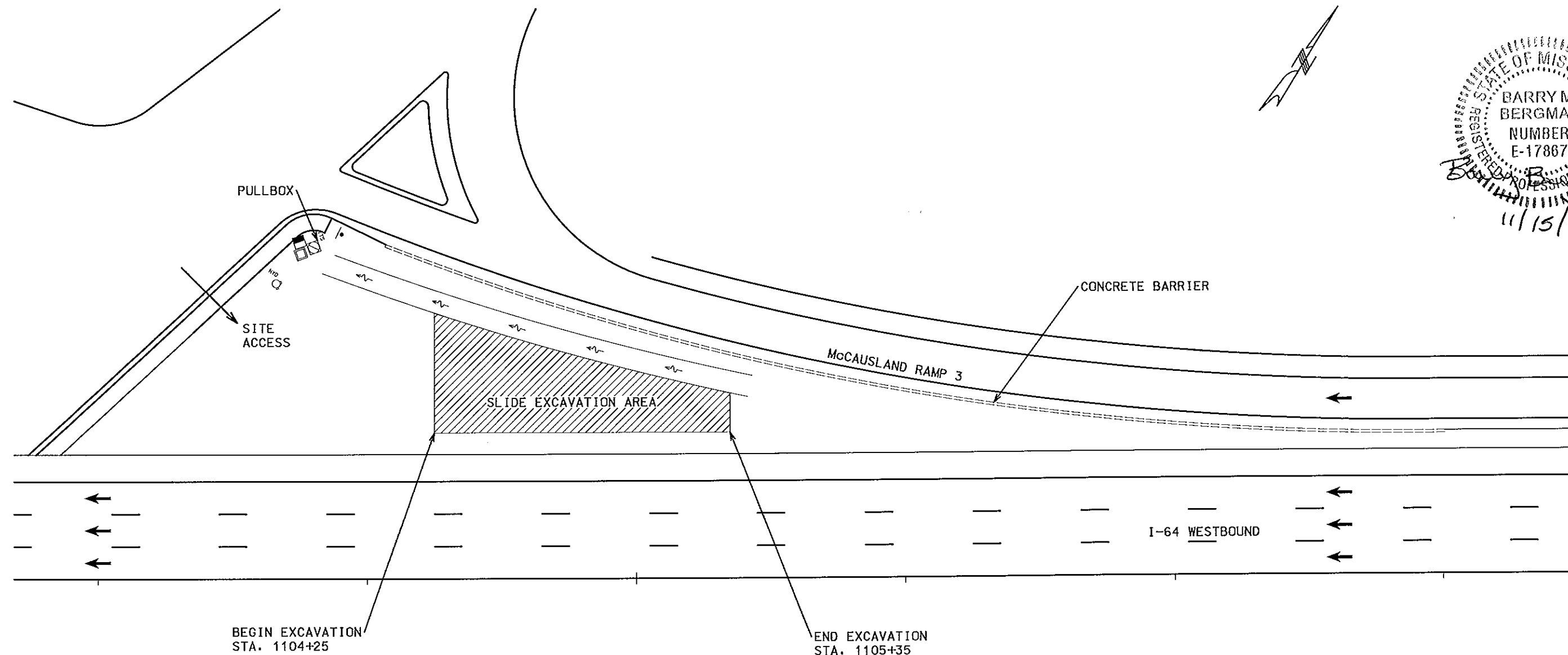

STATE OF MISSOURI
 BARRY M. BERGMAN
 REGISTERED PROFESSIONAL ENGINEER
 NUMBER E-17887
 11/15/13

DISCLAIMER
 THE PROFESSIONAL WHOSE SIGNATURE AND PERSONAL SEAL APPEAR HEREON ASSUMES RESPONSIBILITY ONLY FOR WHAT APPEARS ON THIS PAGE, AND DISCLAIMS (PURSUANT TO SECTION 327.411 RSMO) SPECIFICATION, ESTIMATES, REPORTS, OR OTHER DOCUMENTS OR INSTRUMENTS NOT SEALED BY THE UNDERSIGNED PROFESSIONAL RELATING TO OR INTENDED TO BE USED FOR ANY PART OR PARTS OF THE PROJECT TO WHICH THIS PAGE REFERS.

NOTE:
 REMOVE TREES WITHIN EXCAVATION AREA.
 NO DIRECT PAYMENT.

EXHIBIT A
McCAUSLAND SLIDE
PLAN SHEETS
SHEET 3 OF 3

NOT TO SCALE

IF A SEAL IS PRESENT ON THIS SHEET IT HAS BEEN ELECTRONICALLY SEALED AND DATED.

IF A SEAL IS PRESENT ON THIS SHEET IT HAS BEEN ELECTRONICALLY SEALED AND DATED.

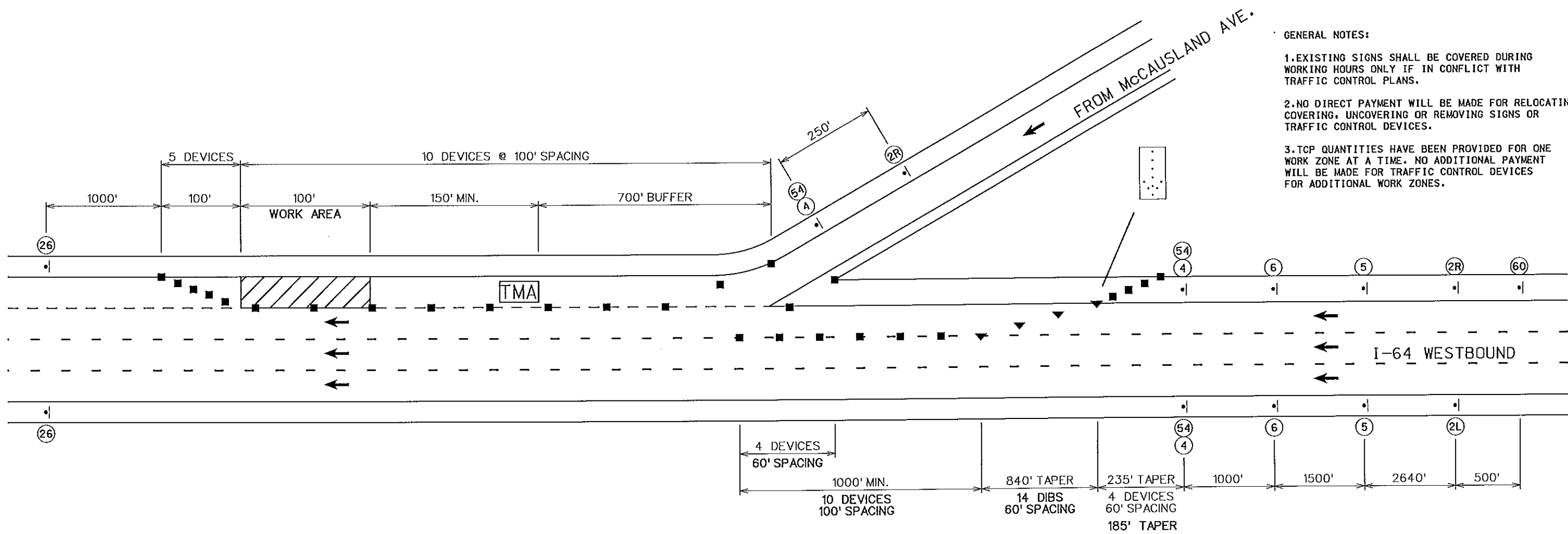

- GENERAL NOTES:**
1. EXISTING SIGNS SHALL BE COVERED DURING WORKING HOURS ONLY IF IN CONFLICT WITH TRAFFIC CONTROL PLANS.
 2. NO DIRECT PAYMENT WILL BE MADE FOR RELOCATING, COVERING, UNCOVERING OR REMOVING SIGNS OR TRAFFIC CONTROL DEVICES.
 3. TCP QUANTITIES HAVE BEEN PROVIDED FOR ONE WORK ZONE AT A TIME. NO ADDITIONAL PAYMENT WILL BE MADE FOR TRAFFIC CONTROL DEVICES FOR ADDITIONAL WORK ZONES.

TRAFFIC CONTROL LEGEND

- WORK ZONE
- TRIMLINE CHANNELIZER
- DIRECTIONAL INDICATOR BARRICADE
- SIGN
- FLASHING ARROW PANEL
- TRUCK OR TRAILER MOUNTED ATTENUATOR

DISCLAIMER
THE PROFESSIONAL WHOSE SIGNATURE AND PERSONAL SEAL APPEAR HEREON ASSUMES RESPONSIBILITY ONLY FOR WHAT APPEARS ON THIS PAGE, AND DISCLAIMS (PURSUANT TO SECTION 327.411 RSMO) SPECIFICATION, ESTIMATES, REPORTS, OR OTHER DOCUMENTS OR INSTRUMENTS NOT SEALED BY THE UNDERSIGNED PROFESSIONAL RELATING TO OR INTENDED TO BE USED FOR ANY PART OR PARTS OF THE PROJECT TO WHICH THIS PAGE REFERS.

CONST-7-72
(60)

W020-1
(2R)

W020-1
(2L)

W020-5
(5)

W020-6a
(6)

R2-1
(54)
(4)

R2-1
(26)

EXHIBIT A
BELLEVUE SLIDE
TRAFFIC CONTROL PLAN
SHEET 1 OF 3

NOT TO SCALE

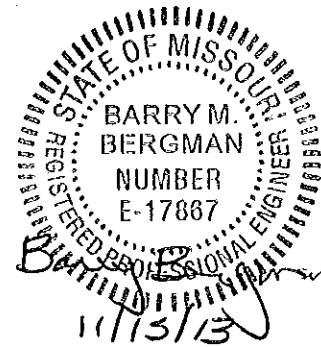

GENERAL NOTES:

1. EXISTING SIGNS SHALL BE COVERED DURING WORKING HOURS ONLY IF IN CONFLICT WITH TRAFFIC CONTROL PLANS.
2. NO DIRECT PAYMENT WILL BE MADE FOR RELOCATING, COVERING, UNCOVERING OR REMOVING SIGNS OR TRAFFIC CONTROL DEVICES.
3. TCP QUANTITIES HAVE BEEN PROVIDED FOR ONE WORK ZONE AT A TIME. NO ADDITIONAL PAYMENT WILL BE MADE FOR TRAFFIC CONTROL DEVICES FOR ADDITIONAL WORK ZONES.

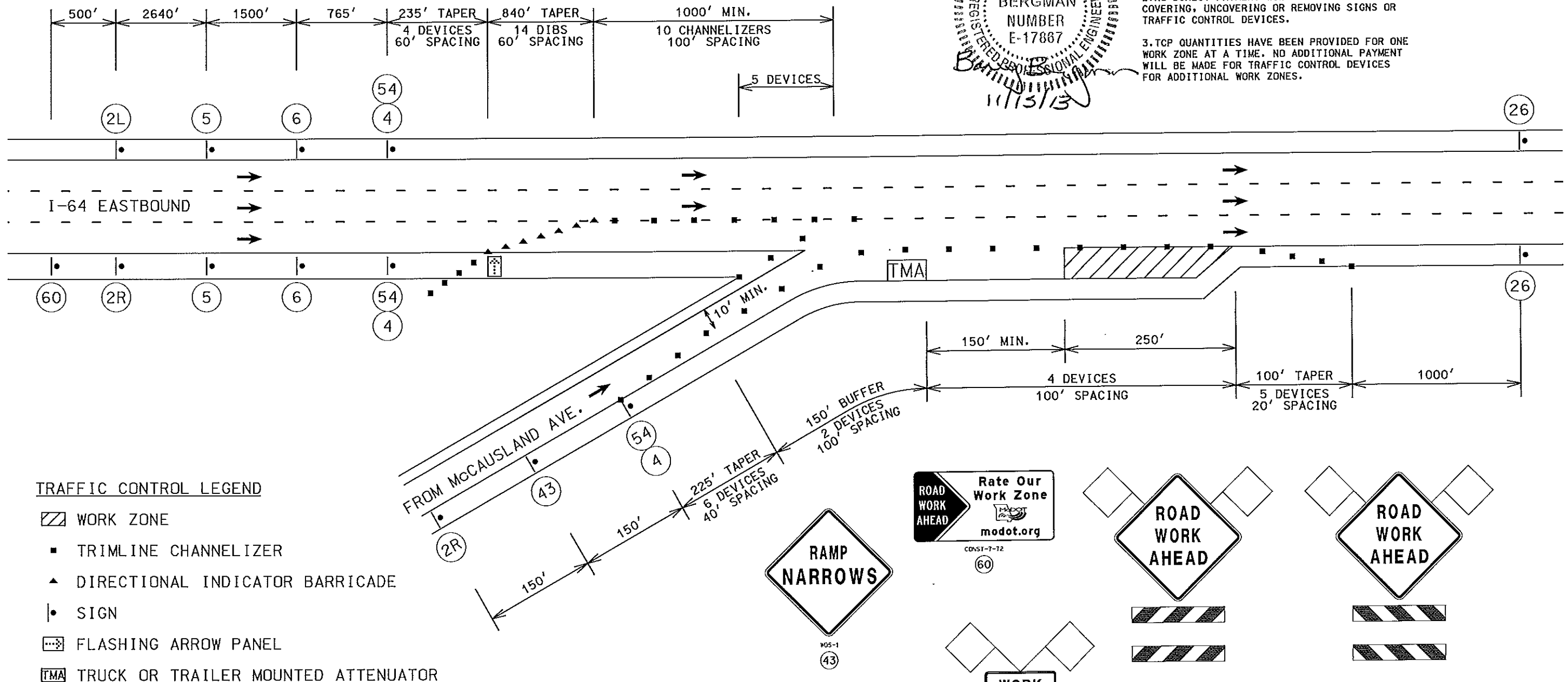

NOT TO SCALE

EXHIBIT A
CLAYTON SLIDE
TRAFFIC CONTROL PLAN
SHEET 2 OF 3

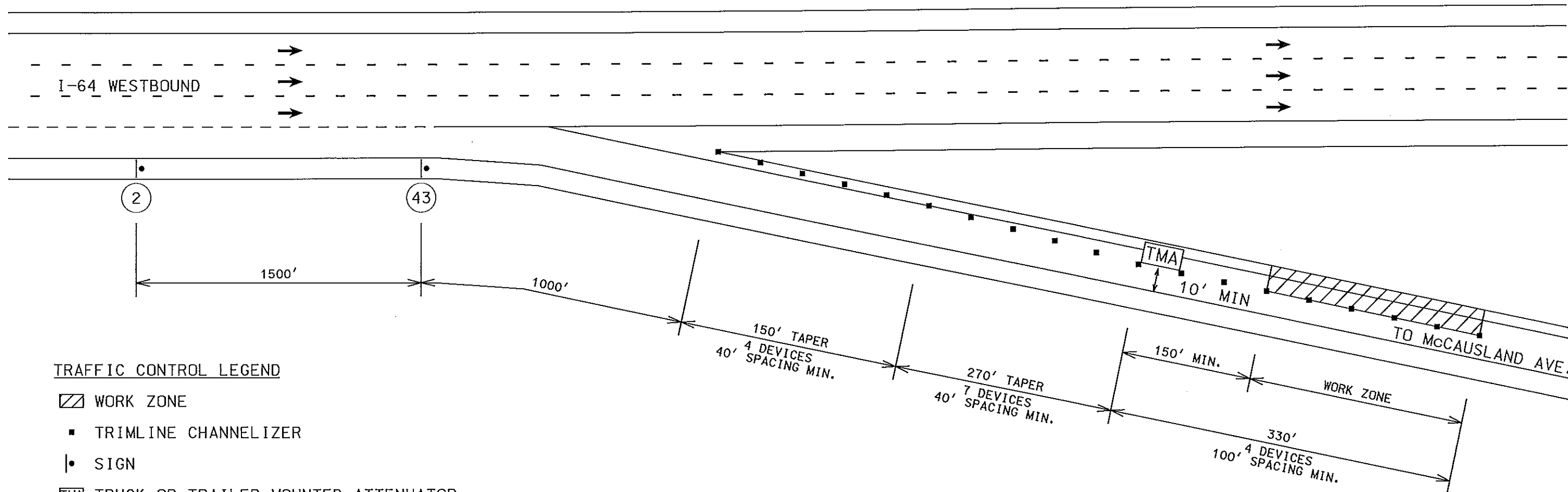

TRAFFIC CONTROL LEGEND

▨ WORK ZONE

▪ TRIMLINE CHANNELIZER

• SIGN

TMA TRUCK OR TRAILER MOUNTED ATTENUATOR

GENERAL NOTES

1. EXISTING SIGNS SHALL BE COVERED DURING WORKING HOURS ONLY IF IN CONFLICT WITH TRAFFIC CONTROL PLANS.
2. NO DIRECT PAYMENT WILL BE MADE FOR RELOCATING, COVERING, UNCOVERING OR REMOVING SIGNS OR TRAFFIC CONTROL DEVICES.
3. TCP QUANTITIES HAVE BEEN PROVIDED FOR ONE WORK ZONE AT A TIME. NO ADDITIONAL PAYMENT WILL BE MADE FOR TRAFFIC CONTROL DEVICES FOR ADDITIONAL WORK ZONES.

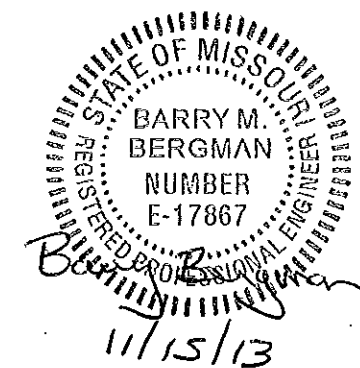
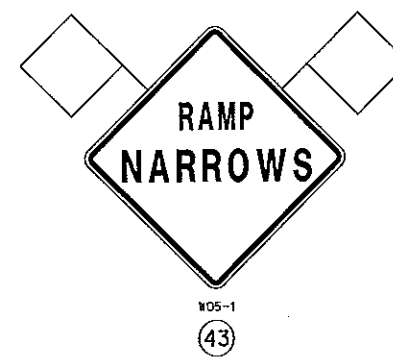
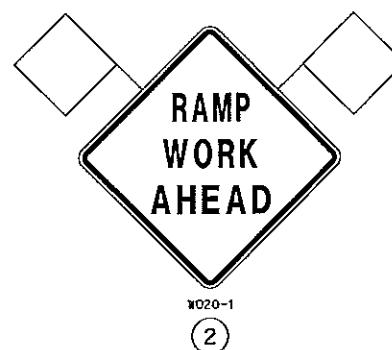

DISCLAIMER
THE PROFESSIONAL WHOSE SIGNATURE AND PERSONAL SEAL APPEAR HEREON ASSUMES RESPONSIBILITY ONLY FOR WHAT APPEARS ON THIS PAGE, AND DISCLAIMS (PURSUANT TO SECTION 327.411 RSMO) SPECIFICATION, ESTIMATES, REPORTS, OR OTHER DOCUMENTS OR INSTRUMENTS NOT SEALED BY THE UNDERSIGNED PROFESSIONAL RELATING TO OR INTENDED TO BE USED FOR ANY PART OR PARTS OF THE PROJECT TO WHICH THIS PAGE REFERS.

EXHIBIT A
McCAUSLAND SLIDE
TRAFFIC CONTROL PLAN
SHEET 3 OF 3

NOT TO SCALE

BELLEVUE AVE.

SLIDE EXCAVATION AREA

PLACE SILT FENCE AFTER
INSTALLATION OF TYPE B
GUTTER



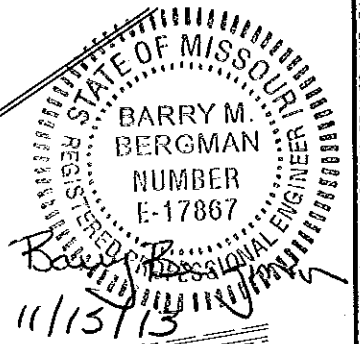

SUBSTITUTE INLET CHECKS
FOR TYPE II DITCH CHECKS

I-64 WESTBOUND

1085

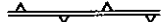

TEMPORARY EROSION CONTROL LEGEND

-  TYPE I DITCH CHECK
-  TYPE II DITCH CHECK
-  TEMPORARY BERM
-  SILT FENCE

DISCLAIMER
THE PROFESSIONAL WHOSE SIGNATURE AND PERSONAL
SEAL APPEAR HEREON ASSUMES RESPONSIBILITY
ONLY FOR WHAT APPEARS ON THIS PAGE, AND
DISCLAIMS (PURSUANT TO SECTION 327.411 RSMO)
SPECIFICATION, ESTIMATES, REPORTS, OR OTHER
DOCUMENTS OR INSTRUMENTS NOT SEALED BY THE
UNDERSIGNED PROFESSIONAL RELATING TO OR
INTENDED TO BE USED FOR ANY PART OR PARTS OF
THE PROJECT TO WHICH THIS PAGE REFERS.

NOT TO SCALE

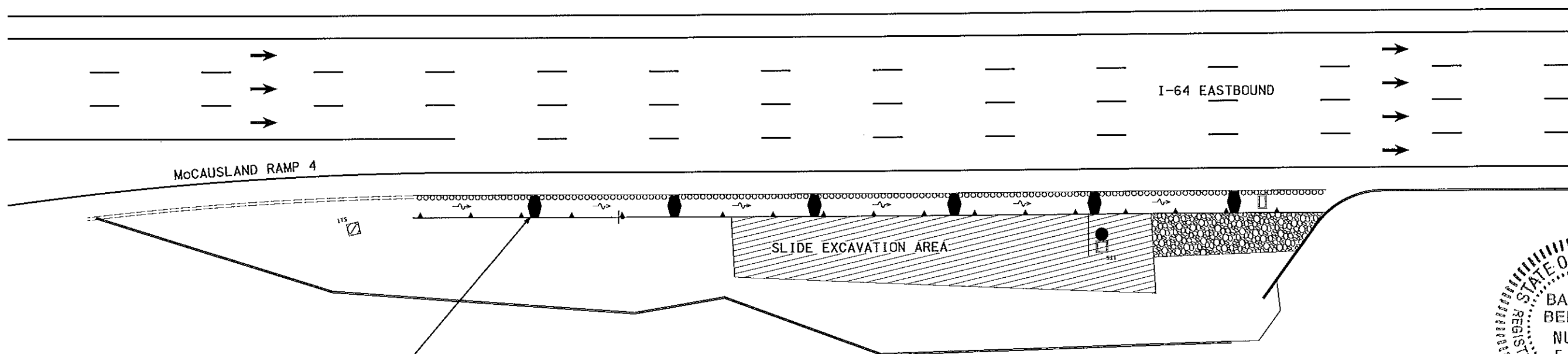

EXHIBIT A
BELLEVUE SLIDE
EROSION CONTROL PLAN
SHEET 1 OF 3

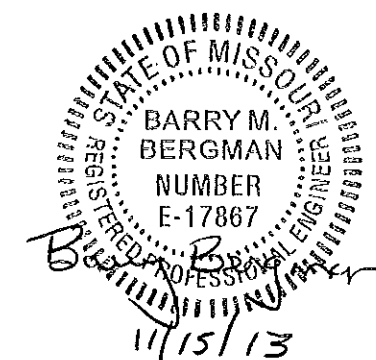

NOTE:
TYPE II DITCH CHECKS ARE AT
50' SPACING

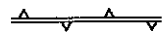
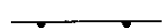

TEMPORARY EROSION CONTROL LEGEND

-  TYPE I DITCH CHECK
-  TYPE II DITCH CHECK
-  TEMPORARY BERM
-  SILT FENCE



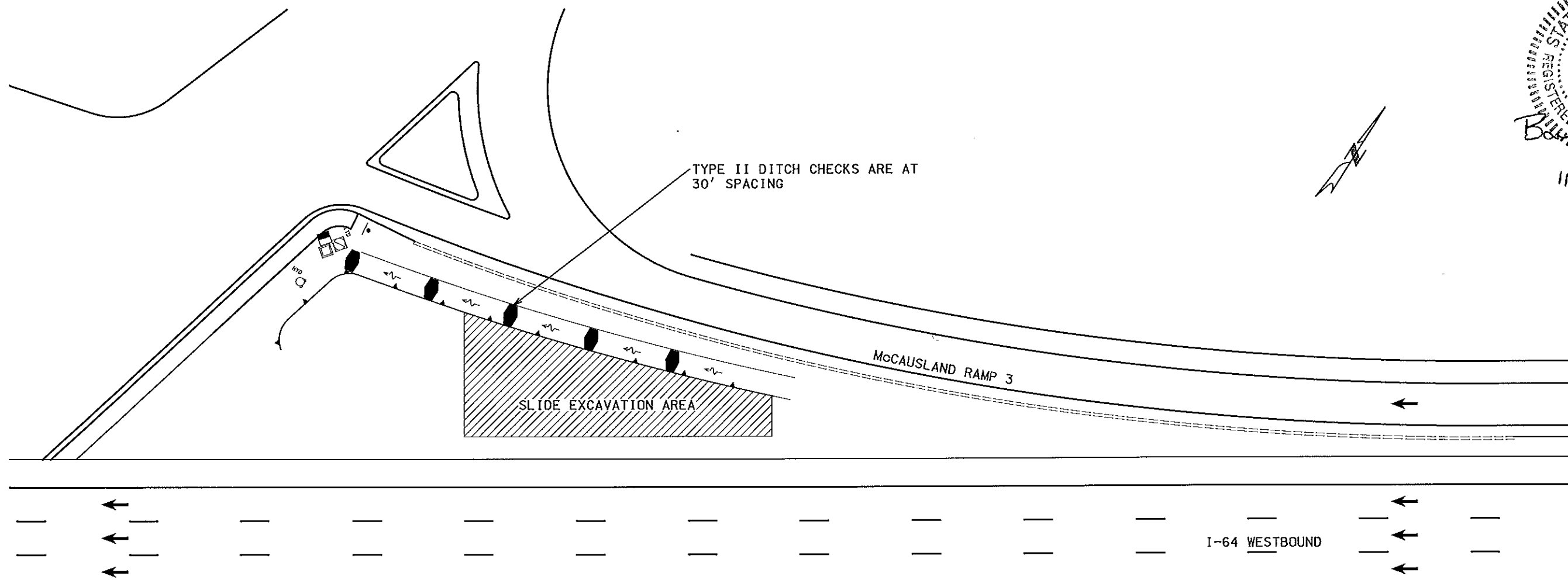
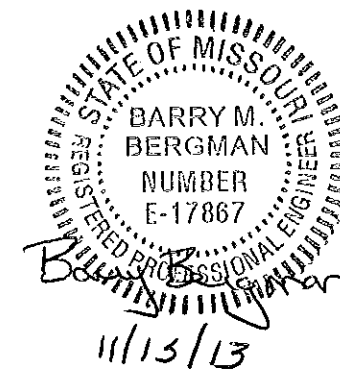

DISCLAIMER
THE PROFESSIONAL WHOSE SIGNATURE AND PERSONAL
SEAL APPEAR HEREON ASSUMES RESPONSIBILITY
ONLY FOR WHAT APPEARS ON THIS PAGE, AND
DISCLAIMS (PURSUANT TO SECTION 327.411 RSMO)
SPECIFICATION, ESTIMATES, REPORTS, OR OTHER
DOCUMENTS OR INSTRUMENTS NOT SEALED BY THE
UNDERSIGNED PROFESSIONAL RELATING TO OR
INTENDED TO BE USED FOR ANY PART OR PARTS OF
THE PROJECT TO WHICH THIS PAGE REFERS.

EXHIBIT A
CLAYTON SLIDE
EROSION CONTROL PLAN
SHEET 2 OF 3

NOT TO SCALE



TEMPORARY EROSION CONTROL LEGEND

-  TYPE I DITCH CHECK
-  TYPE II DITCH CHECK
-  TEMPORARY BERM
-  SILT FENCE

DISCLAIMER
THE PROFESSIONAL WHOSE SIGNATURE AND PERSONAL SEAL APPEAR HEREON ASSUMES RESPONSIBILITY ONLY FOR WHAT APPEARS ON THIS PAGE, AND DISCLAIMS (PURSUANT TO SECTION 327.411 RSMO) SPECIFICATION, ESTIMATES, REPORTS, OR OTHER DOCUMENTS OR INSTRUMENTS NOT SEALED BY THE UNDERSIGNED PROFESSIONAL RELATING TO OR INTENDED TO BE USED FOR ANY PART OR PARTS OF THE PROJECT TO WHICH THIS PAGE REFERS.

NOT TO SCALE

EXHIBIT A
McCAUSLAND SLIDE
EROSION CONTROL PLAN
SHEET 3 OF 3

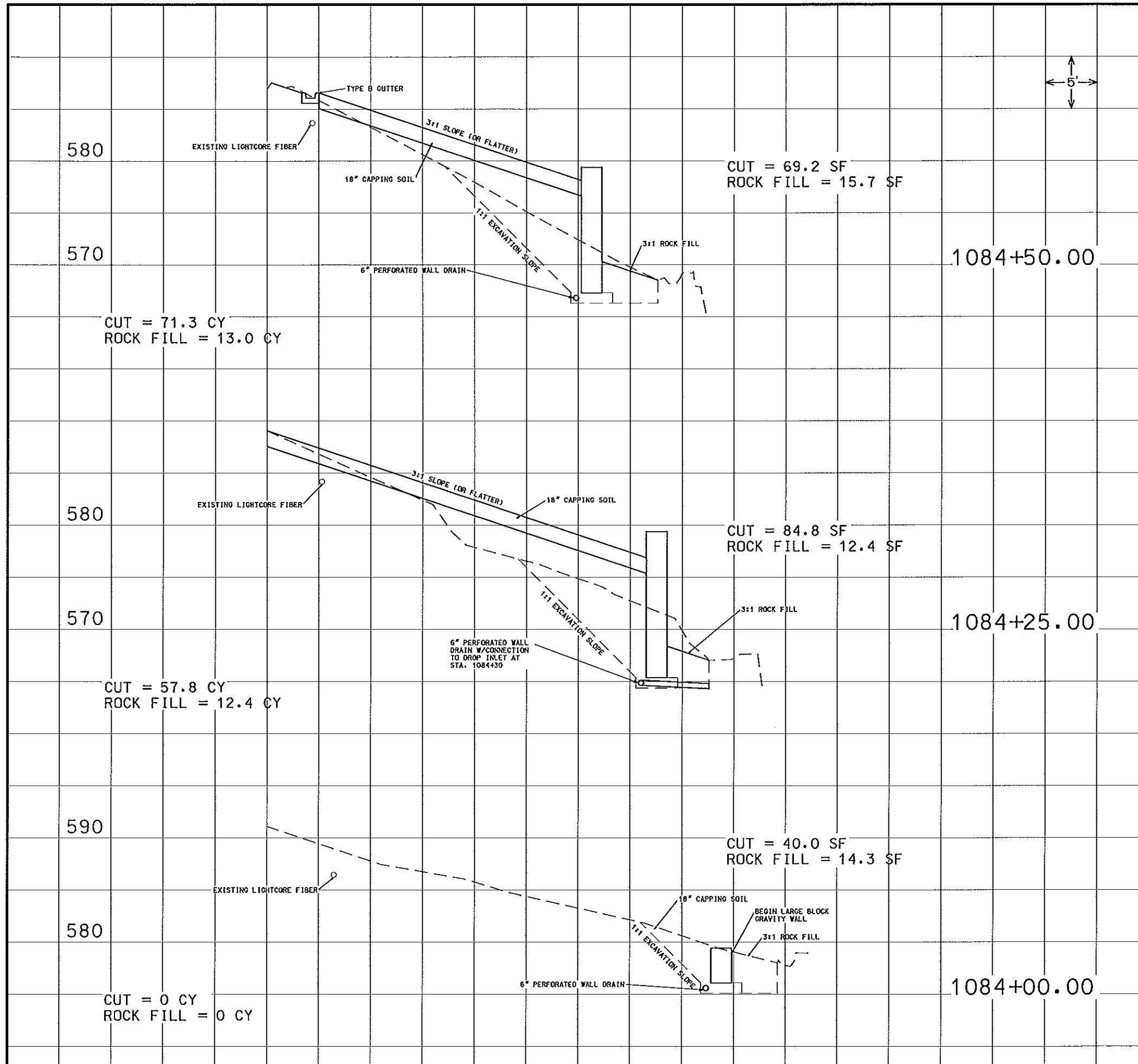

DISCLAIMER
THE PROFESSIONAL WHOSE SIGNATURE AND PERSONAL SEAL APPEAR HEREON ASSUMES RESPONSIBILITY ONLY FOR WHAT APPEARS ON THIS PAGE, AND DISCLAIMS (PURSUANT TO SECTION 327.411 RSMO) SPECIFICATION, ESTIMATES, REPORTS, OR OTHER DOCUMENTS OR INSTRUMENTS NOT SEALED BY THE UNDERSIGNED PROFESSIONAL RELATING TO OR INTENDED TO BE USED FOR ANY PART OR PARTS OF THE PROJECT TO WHICH THIS PAGE REFERS.

NOTE:
EXCESS EXCAVATION MATERIAL SHALL BECOME THE PROPERTY OF THE CONTRACTOR AND REMOVED FROM MODOT RIGHT OF WAY.

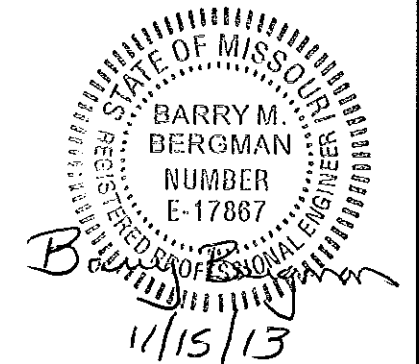

EXHIBIT A
BELLEVUE SLIDE
CROSS SECTION PLAN
SHEET 1 OF 6

NOT TO SCALE

DISCLAIMER
THE PROFESSIONAL WHOSE SIGNATURE AND PERSONAL
SEAL APPEAR HEREON ASSUMES RESPONSIBILITY
ONLY FOR WHAT APPEARS ON THIS PAGE, AND
DISCLAIMS (PURSUANT TO SECTION 327.411 RSMO)
SPECIFICATION, ESTIMATES, REPORTS, OR OTHER
DOCUMENTS OR INSTRUMENTS NOT SEALED BY THE
UNDERSIGNED PROFESSIONAL RELATING TO OR
INTENDED TO BE USED FOR ANY PART OR PARTS OF
THE PROJECT TO WHICH THIS PAGE REFERS.

NOTE:

EXCESS EXCAVATION MATERIAL SHALL
BECOME THE PROPERTY OF THE CONTRACTOR
AND REMOVED FROM MODOT RIGHT OF WAY.

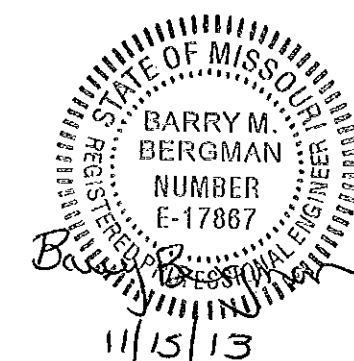

IF A SEAL IS PRESENT ON THIS SHEET IT HAS BEEN ELECTRONICALLY SEALED AND DATED.

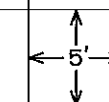

580

570

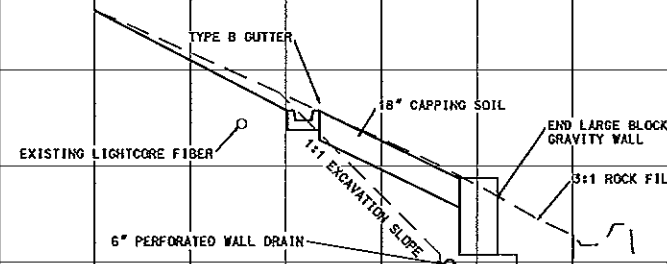

CUT = 50.9 SF
ROCK FILL = 10.8 SF

1085+00.00

CUT = 53.4 CY
ROCK FILL = 12.7 CY

580

570

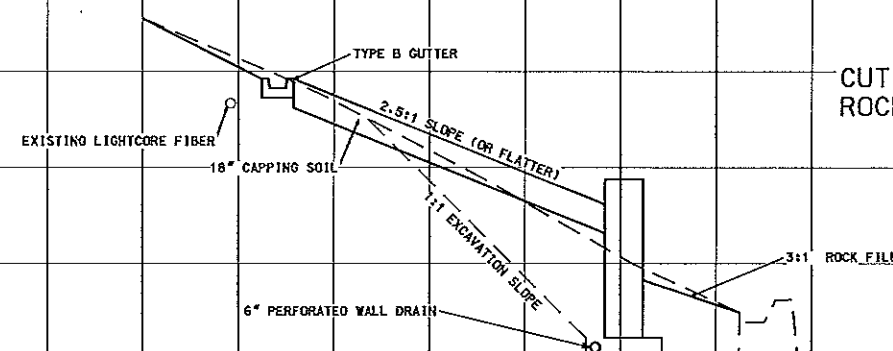

CUT = 64.5 SF
ROCK FILL = 16.6 SF

1084+75.00

CUT = 61.9 CY
ROCK FILL = 15.0 CY

EXHIBIT A
BELLEVUE SLIDE
CROSS SECTIONS
SHEET 2 OF 6

NOT TO SCALE

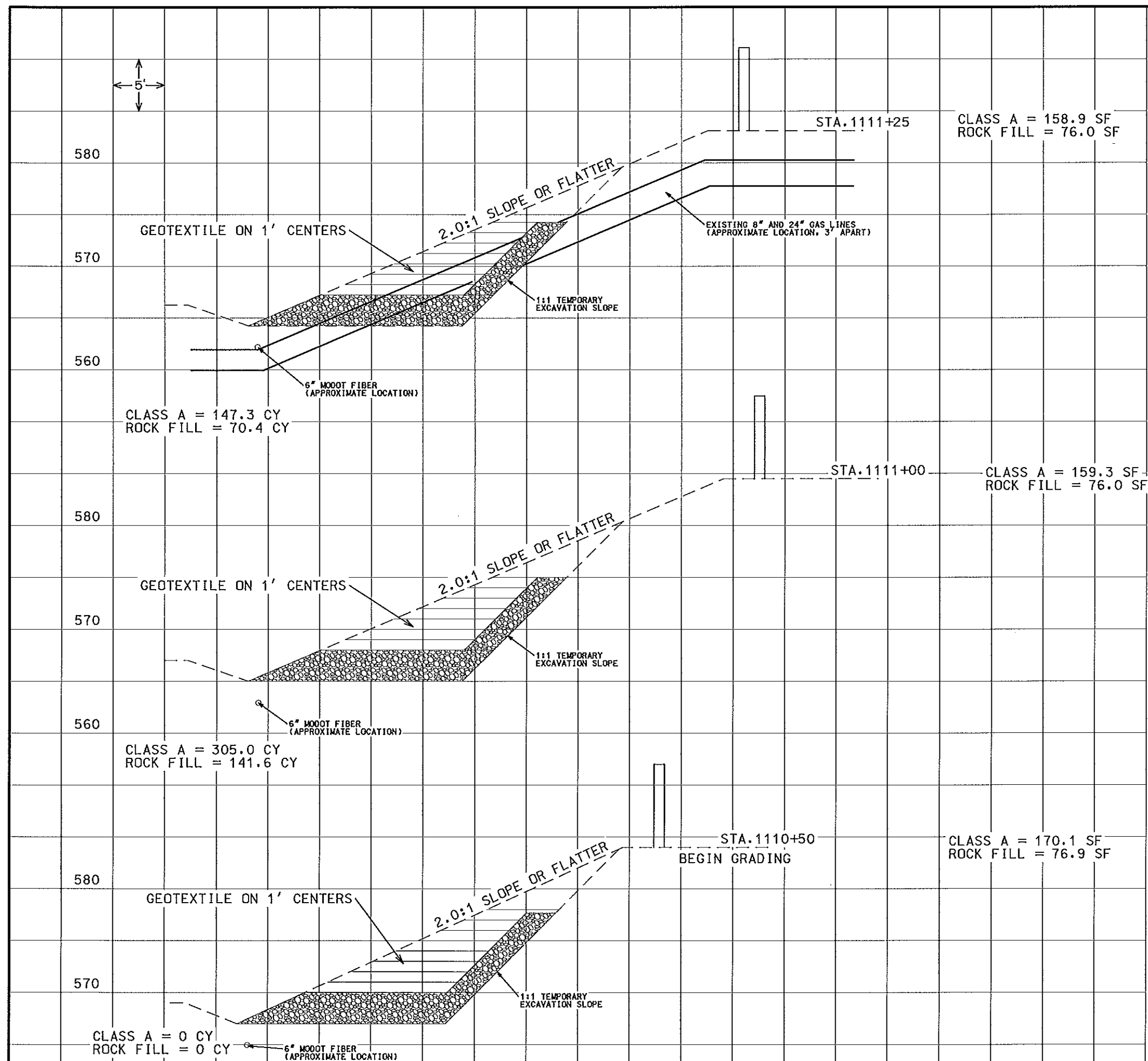

DISCLAIMER
THE PROFESSIONAL WHOSE SIGNATURE AND PERSONAL SEAL APPEAR HEREON ASSUMES RESPONSIBILITY ONLY FOR WHAT APPEARS ON THIS PAGE, AND DISCLAIMS (PURSUANT TO SECTION 327.411 RSMO) SPECIFICATION, ESTIMATES, REPORTS, OR OTHER DOCUMENTS OR INSTRUMENTS NOT SEALED BY THE UNDERSIGNED PROFESSIONAL RELATING TO OR INTENDED TO BE USED FOR ANY PART OR PARTS OF THE PROJECT TO WHICH THIS PAGE REFERS.

NOTE:

1. EXCESS EXCAVATION MATERIAL SHALL BECOME THE PROPERTY OF THE CONTRACTOR AND REMOVED FROM MODOT RIGHT OF WAY.
2. CONTRACTOR SHALL REESTABLISH GRADE LINE OF DITCH AFTER EXCAVATION.
3. BOTH 8" AND 24" GAS LINES HAVE BEEN POTHOLED IN THE FIELD BY LACLEDE GAS COMPANY. NO EXCAVATION SHALL TAKE PLACE WITHIN 36" OF EITHER LINE AND ABOVE THE GAS MAINS.

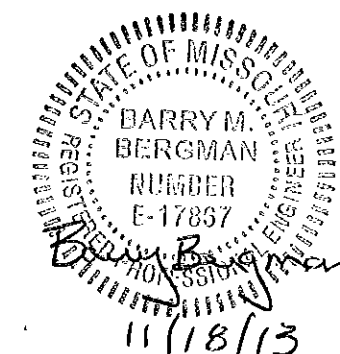

EXHIBIT A
CLAYTON SLIDE
CROSS SECTIONS
SHEET 3 OF 6

NOT TO SCALE

DISCLAIMER
THE PROFESSIONAL WHOSE SIGNATURE AND PERSONAL SEAL APPEAR HEREON ASSUMES RESPONSIBILITY ONLY FOR WHAT APPEARS ON THIS PAGE, AND DISCLAIMS (PURSUANT TO SECTION 327.411 RSMO) SPECIFICATION, ESTIMATES, REPORTS, OR OTHER DOCUMENTS OR INSTRUMENTS NOT SEALED BY THE UNDERSIGNED PROFESSIONAL RELATING TO OR INTENDED TO BE USED FOR ANY PART OR PARTS OF THE PROJECT TO WHICH THIS PAGE REFERS.

NOTE:

1. EXCESS EXCAVATION MATERIAL SHALL BECOME THE PROPERTY OF THE CONTRACTOR AND REMOVED FROM MODOT RIGHT OF WAY.
2. CONTRACTOR SHALL REESTABLISH GRADE LINE OF DITCH AFTER EXCAVATION.

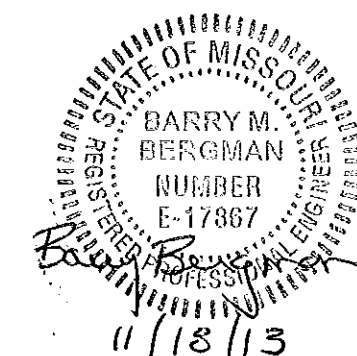
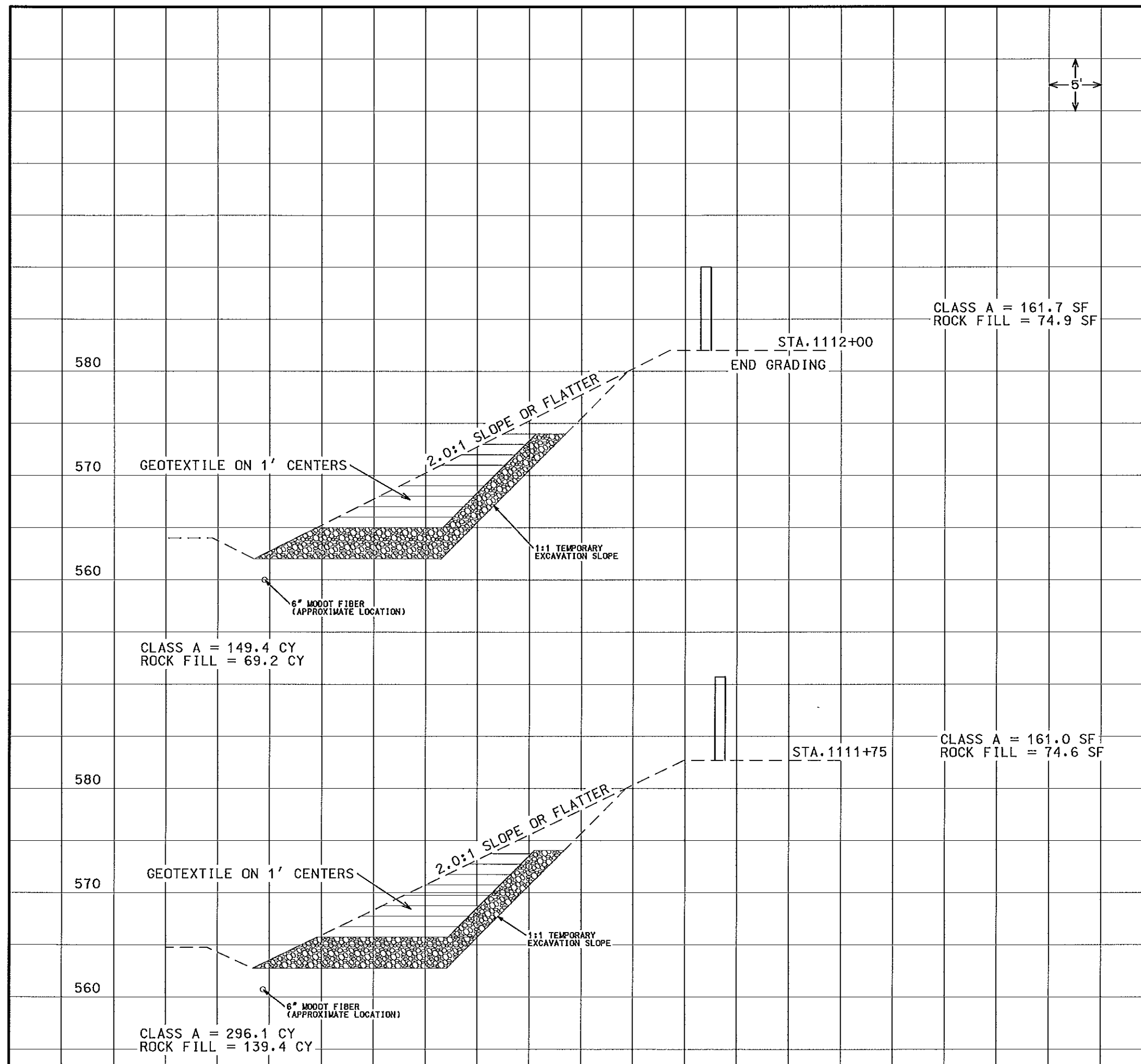
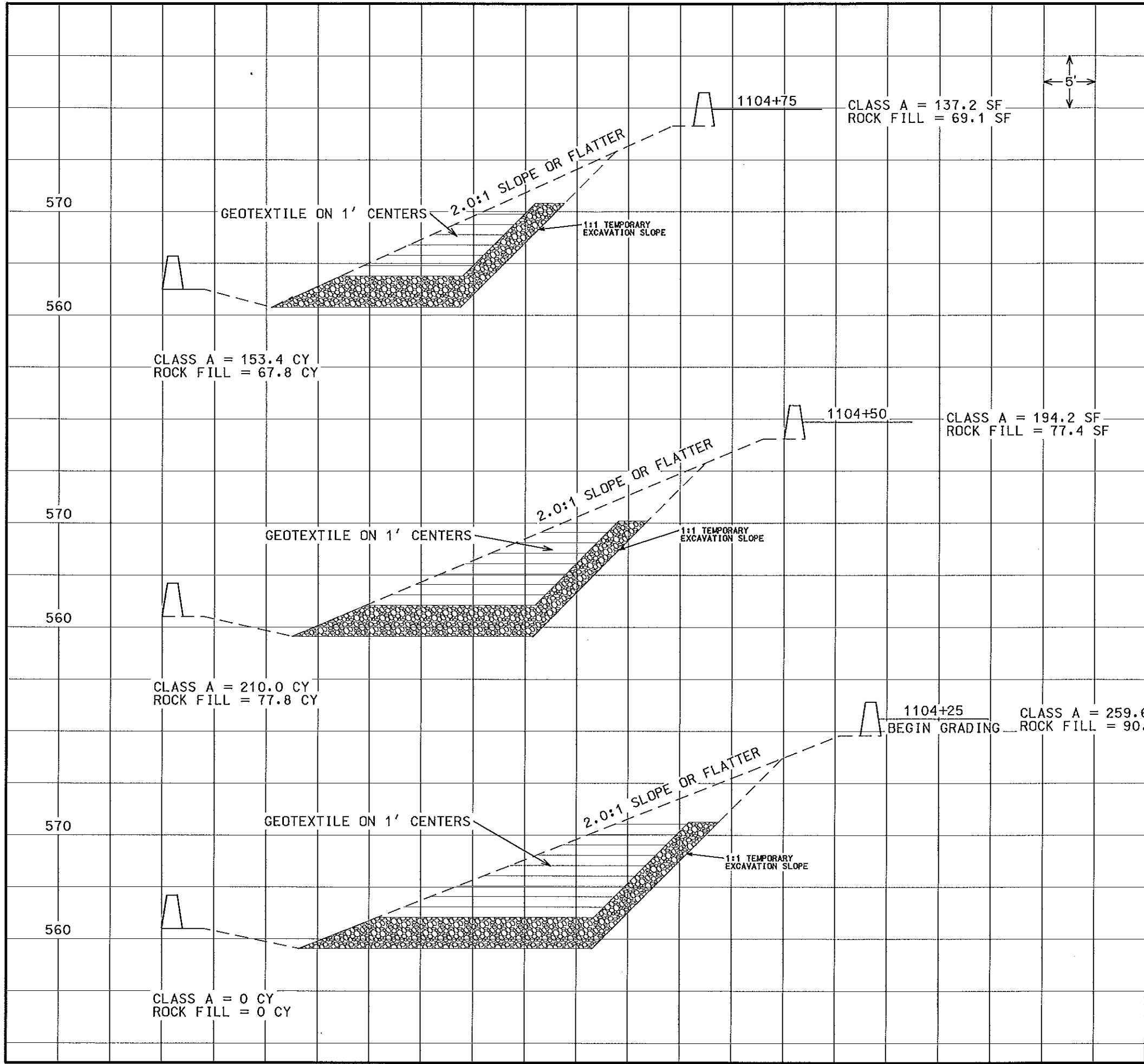

EXHIBIT A
CLAYTON SLIDE
CROSS SECTIONS
SHEET 4 OF 6

NOT TO SCALE





DISCLAIMER
THE PROFESSIONAL WHOSE SIGNATURE AND PERSONAL SEAL APPEAR HEREON ASSUMES RESPONSIBILITY ONLY FOR WHAT APPEARS ON THIS PAGE, AND DISCLAIMS (PURSUANT TO SECTION 327.411 RSMO) SPECIFICATION, ESTIMATES, REPORTS, OR OTHER DOCUMENTS OR INSTRUMENTS NOT SEALED BY THE UNDERSIGNED PROFESSIONAL RELATING TO OR INTENDED TO BE USED FOR ANY PART OR PARTS OF THE PROJECT TO WHICH THIS PAGE REFERS.

- NOTE:
1. EXCESS EXCAVATION MATERIAL SHALL BECOME THE PROPERTY OF THE CONTRACTOR AND REMOVED FROM MODOT RIGHT OF WAY.
 2. CONTRACTOR SHALL REESTABLISH GRADE LINE OF DITCH AFTER EXCAVATION.

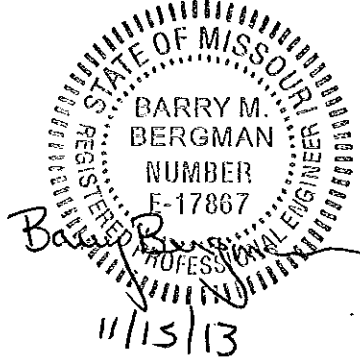

EXHIBIT A
McCAUSLAND SLIDE
CROSS SECTIONS
SHEET 5 OF 6

NOT TO SCALE

IF A SEAL IS PRESENT ON THIS SHEET IT HAS BEEN ELECTRONICALLY SEALED AND DATED.

DISCLAIMER
THE PROFESSIONAL WHOSE SIGNATURE AND PERSONAL SEAL APPEAR HEREON ASSUMES RESPONSIBILITY ONLY FOR WHAT APPEARS ON THIS PAGE, AND DISCLAIMS (PURSUANT TO SECTION 327.411 RSMO) SPECIFICATION, ESTIMATES, REPORTS, OR OTHER DOCUMENTS OR INSTRUMENTS NOT SEALED BY THE UNDERSIGNED PROFESSIONAL RELATING TO OR INTENDED TO BE USED FOR ANY PART OR PARTS OF THE PROJECT TO WHICH THIS PAGE REFERS.

- NOTE:
- 1. EXCESS EXCAVATION MATERIAL SHALL BECOME THE PROPERTY OF THE CONTRACTOR AND REMOVED FROM MODOT RIGHT OF WAY.
 - 2. CONTRACTOR SHALL REESTABLISH GRADE LINE OF DITCH AFTER EXCAVATION.

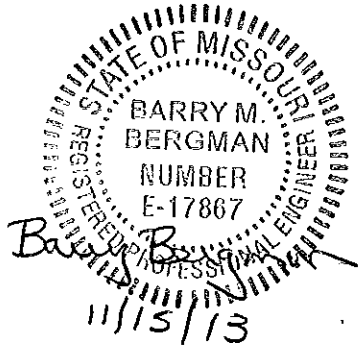
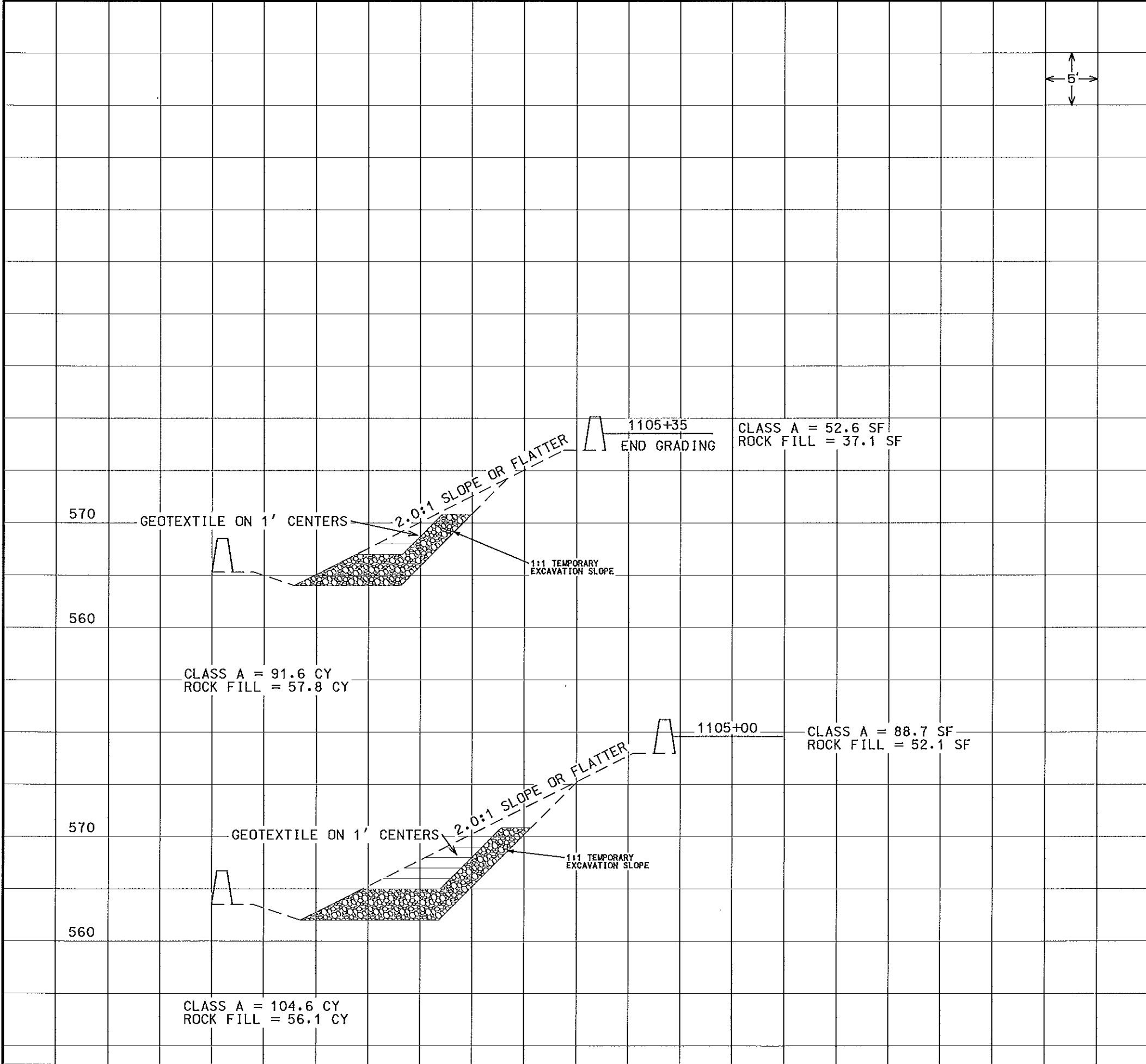

EXHIBIT A
McCAUSLAND SLIDE
CROSS SECTIONS
SHEET 6 OF 6

NOT TO SCALE



IF A SEAL IS PRESENT ON THIS SHEET IT HAS BEEN ELECTRONICALLY SEALED AND DATED.

PROFILE VIEW OF PROPOSED BELLEVUE GRAVITY WALL

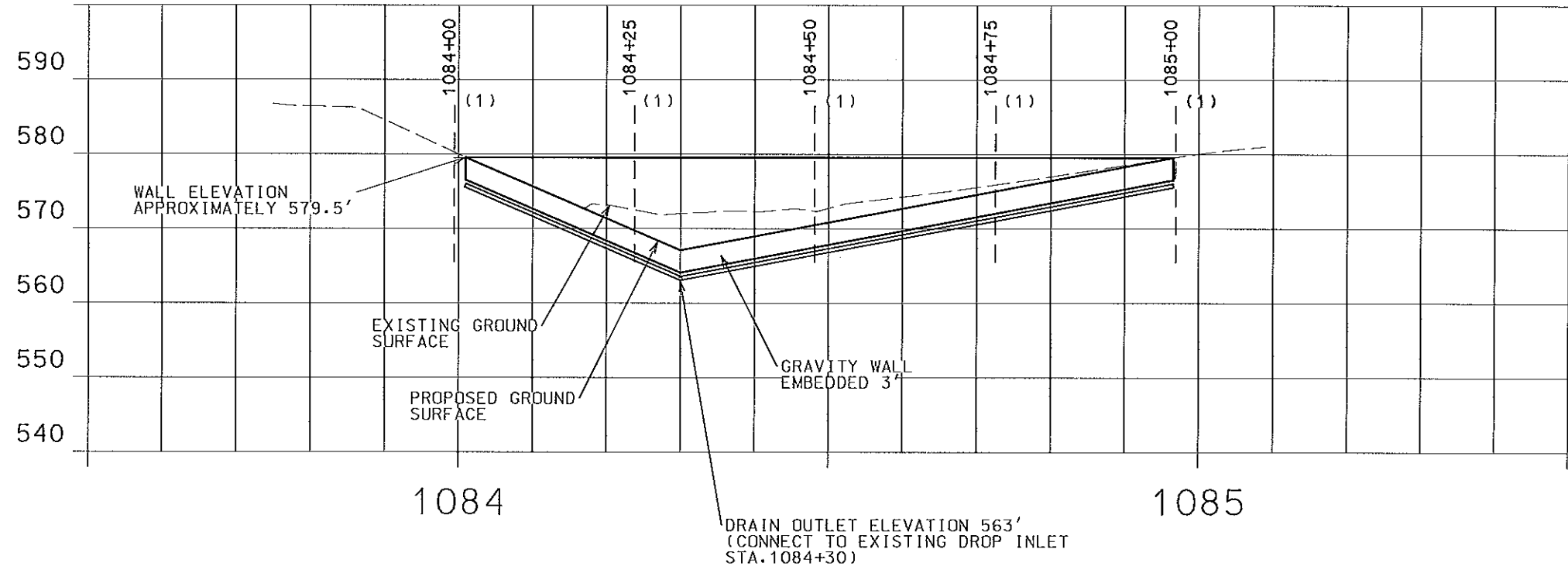
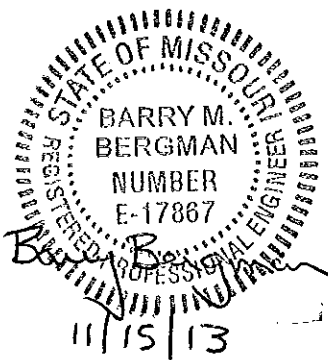
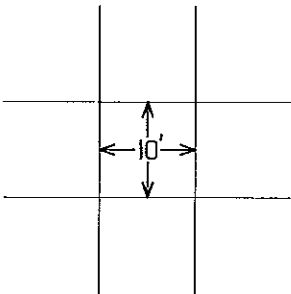

* NOTE
(1) THE CROSS-SECTIONS SHOWN ON THE PROFILE ARE STATIONED WITH RESPECT TO THE WALL, NOT THE CENTERLINE OF I-64.

DISCLAIMER
THE PROFESSIONAL WHOSE SIGNATURE AND PERSONAL SEAL APPEAR HEREON ASSUMES RESPONSIBILITY ONLY FOR WHAT APPEARS ON THIS PAGE, AND DISCLAIMS (PURSUANT TO SECTION 327.411 RSMO) SPECIFICATION, ESTIMATES, REPORTS, OR OTHER DOCUMENTS OR INSTRUMENTS NOT SEALED BY THE UNDERSIGNED PROFESSIONAL RELATING TO OR INTENDED TO BE USED FOR ANY PART OR PARTS OF THE PROJECT TO WHICH THIS PAGE REFERS.

EXHIBIT A
BELLEVUE WALL
SPECIAL SHEETS
SHEET 1 OF 2

NOT TO SCALE

IF A SEAL IS PRESENT ON THIS SHEET IT HAS BEEN ELECTRONICALLY SEALED AND DATED.

IF A SEAL IS PRESENT ON THIS SHEET IT HAS BEEN ELECTRONICALLY SEALED AND DATED.

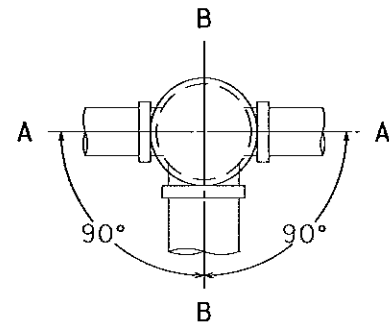
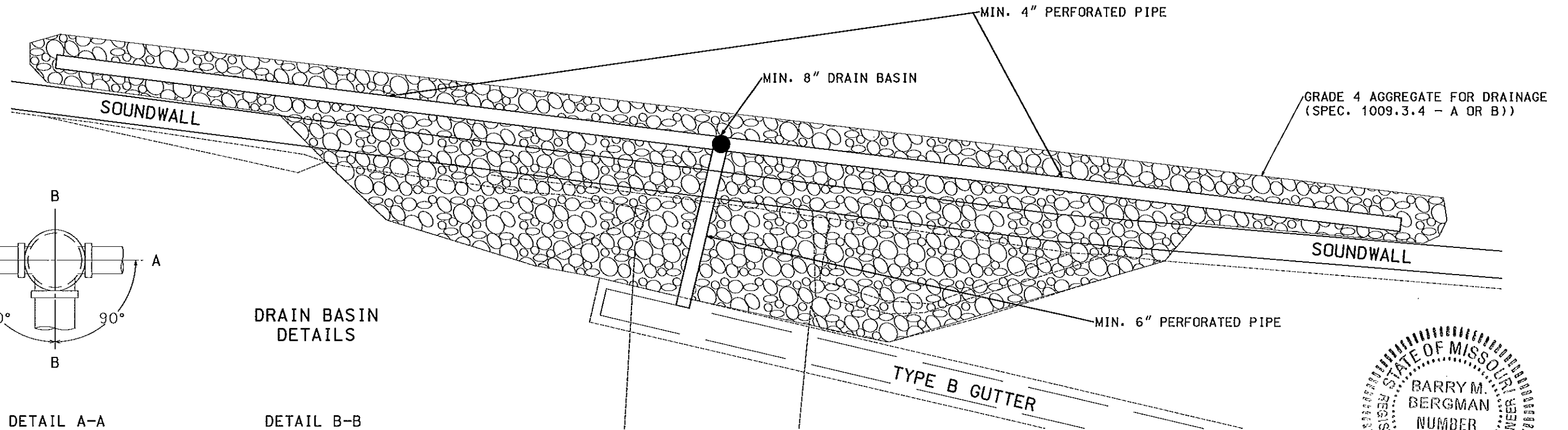

DETAIL A-A

DRAIN BASIN DETAILS

DETAIL B-B

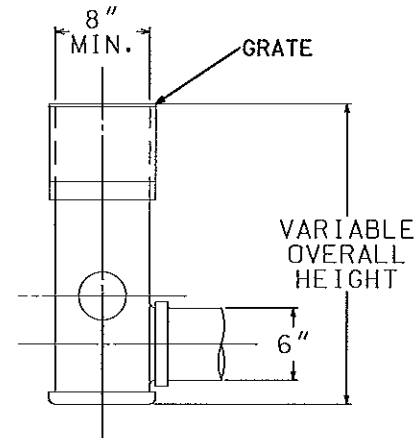
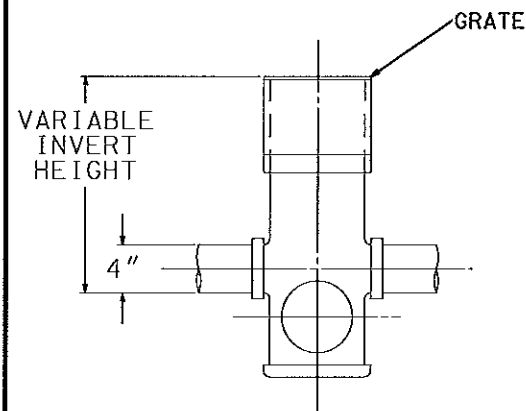

NOTE:

DRAIN BASIN DETAILS ARE SHOWN FOR INFORMATION ONLY. ANY STYLE OF DRAIN BASIN MAY BE USED PROVIDED THE MINIMUM DIMENSIONS ARE MET.

DISCLAIMER

THE PROFESSIONAL WHOSE SIGNATURE AND PERSONAL SEAL APPEAR HEREON ASSUMES RESPONSIBILITY ONLY FOR WHAT APPEARS ON THIS PAGE, AND DISCLAIMS (PURSUANT TO SECTION 327.411 RSMO) SPECIFICATION, ESTIMATES, REPORTS, OR OTHER DOCUMENTS OR INSTRUMENTS NOT SEALED BY THE UNDERSIGNED PROFESSIONAL RELATING TO OR INTENDED TO BE USED FOR ANY PART OR PARTS OF THE PROJECT TO WHICH THIS PAGE REFERS.

PERFORATED PIPE DETAILS

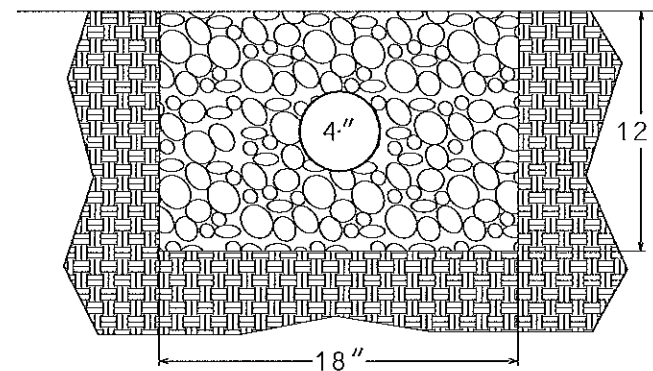

NOT TO SCALE

GUTTER CONNECTION

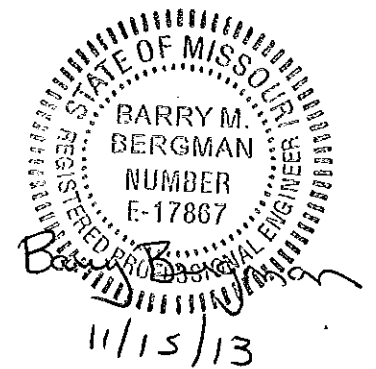
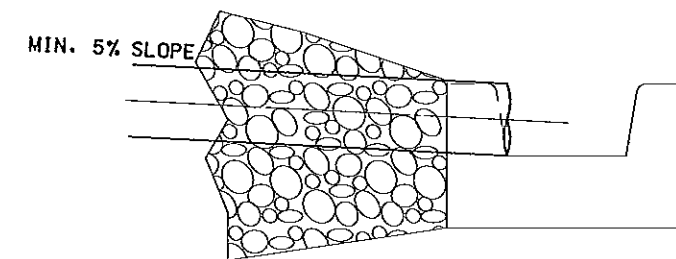
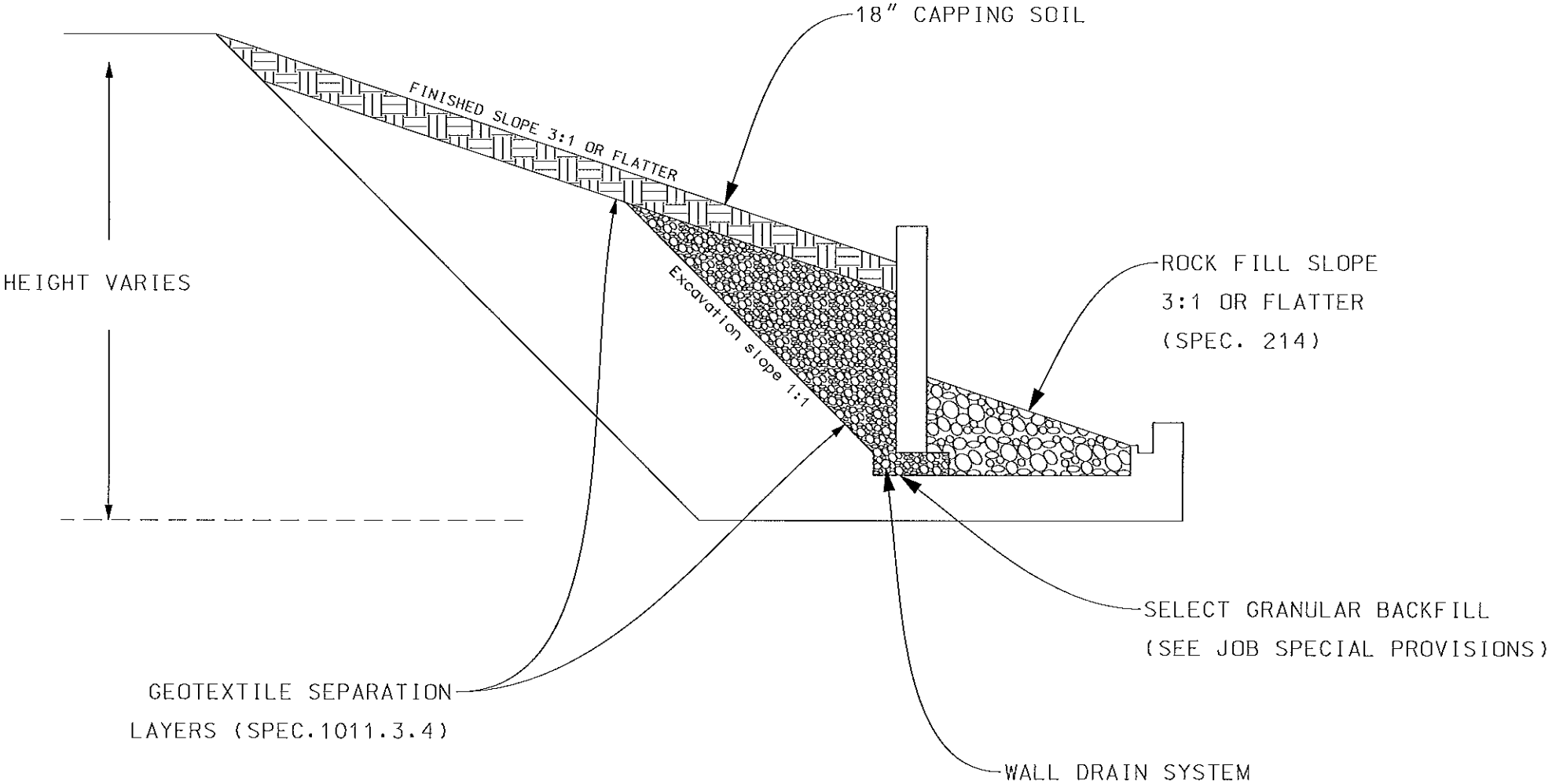
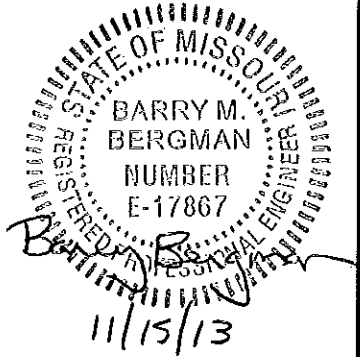

EXHIBIT A
BELLEVUE DRAINAGE
SPECIAL SHEETS
SHEET 2 OF 2

MODULAR LARGE BLOCK GRAVITY WALL REPAIR



NOT TO SCALE

EXHIBIT A
BELLEVUE SLIDE
EXAMPLE CROSS-SECTION

GEOTEXTILE REINFORCED SOIL SLOPE REPAIR

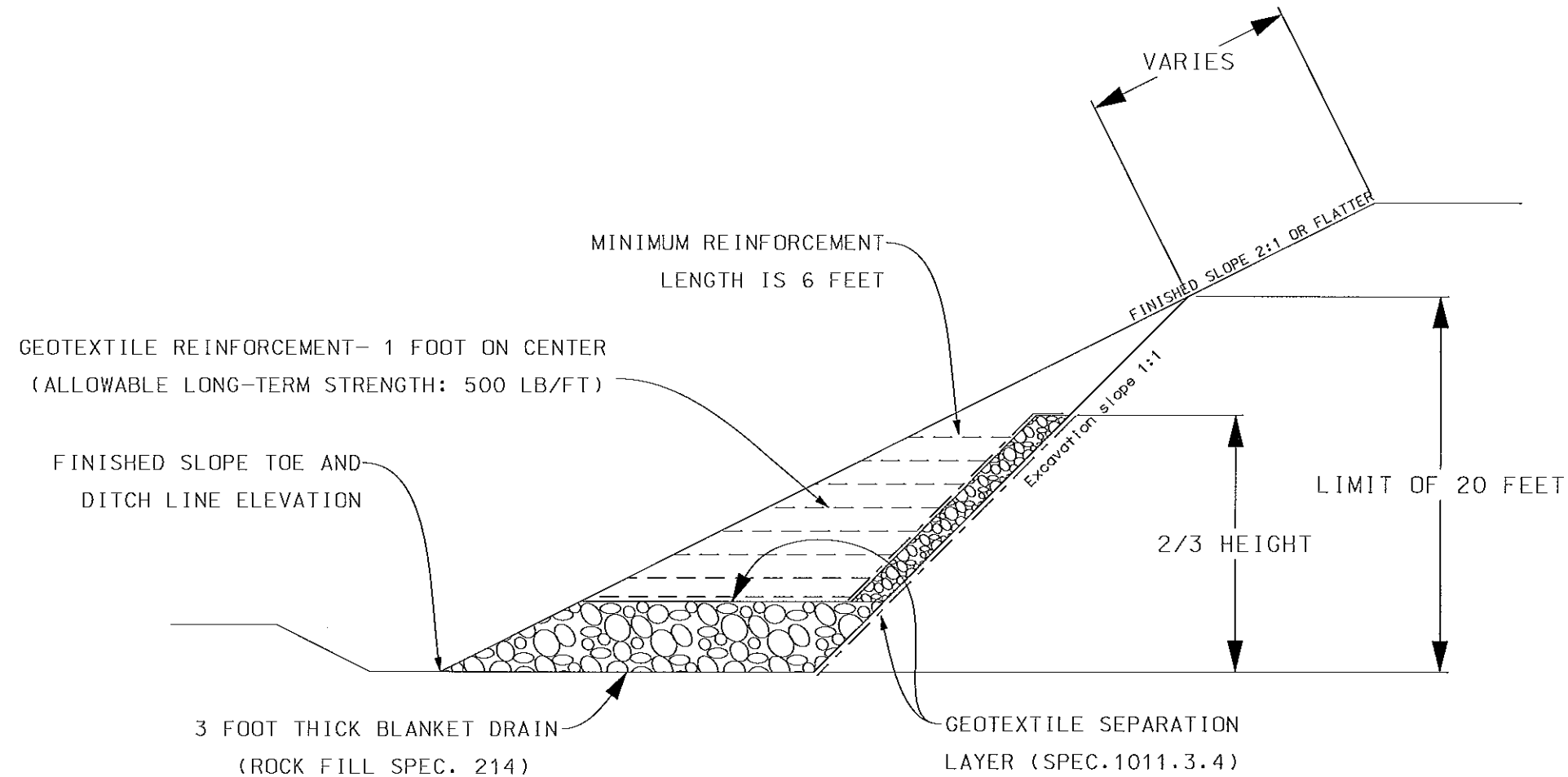
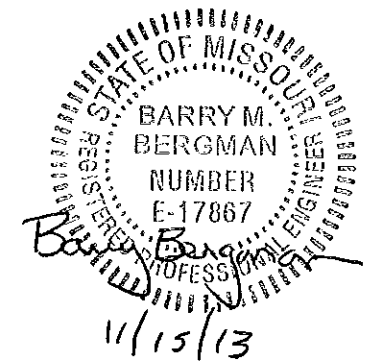

STATION 1110±50 TO 1112±00
WEST ALONG I-64 EBL (0.1 MILE WEST OF CLAYTON OVERPASS)

NOT TO SCALE

EXHIBIT A
CLAYTON SLIDE
EXAMPLE CROSS-SECTION

GEOTEXTILE REINFORCED SOIL SLOPE REPAIR

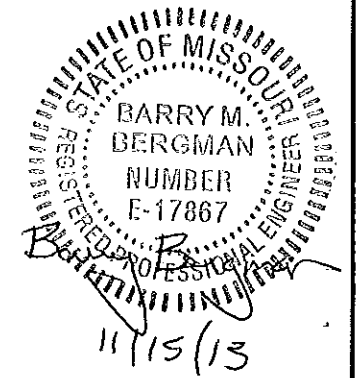

GRSS WITH BLANKET AND CHIMNEY DRAINS, FS=1.45

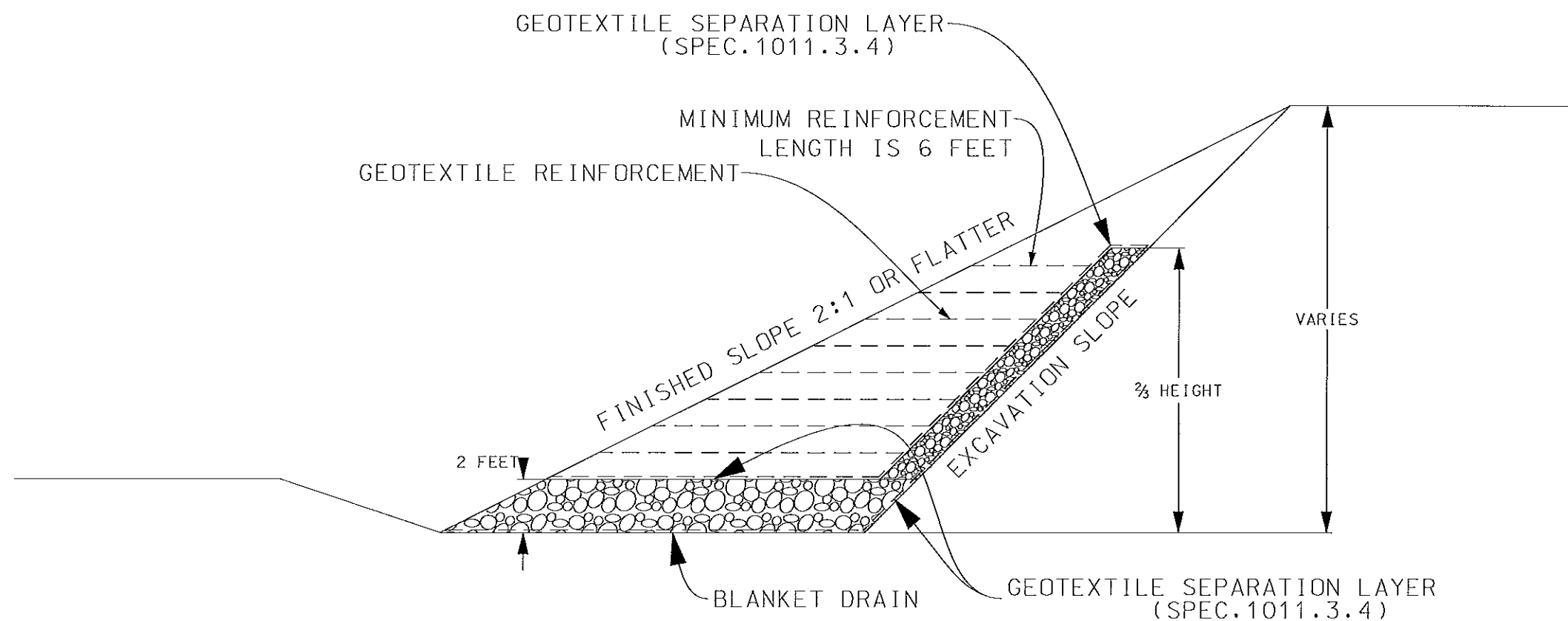

STATION 1104±25 TO 1105±35 LEFT OF I-64
ALONG RAMP 3 OF MCCAUSLAND INTERSECTION

EXHIBIT A
McCAUSLAND SLIDE
EXAMPLE CROSS-SECTION

NOT TO SCALE