

STATE OF MISSOURI
 BARRY M. BERGMAN
 REGISTERED PROFESSIONAL ENGINEER
 NUMBER E-17867
 10/8/13

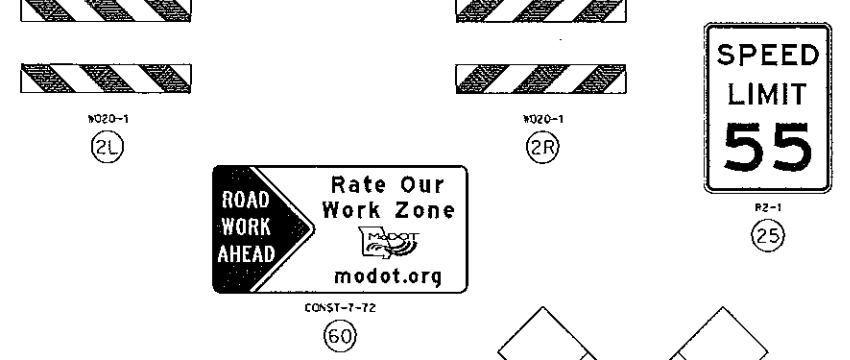

- TRAFFIC CONTROL LEGEND**
- ▲ SIGN (SINGLE SIDED)
 - TRIMLINE CHANNELIZER
 - ▲ DIRECTIONAL INDICATOR BARRICADE
 - ⬜ FLASHING ARROW PANEL
 - ▨ WORK AREA
 - TMA TRUCK OR TRAILER MOUNTED ATTENUATOR

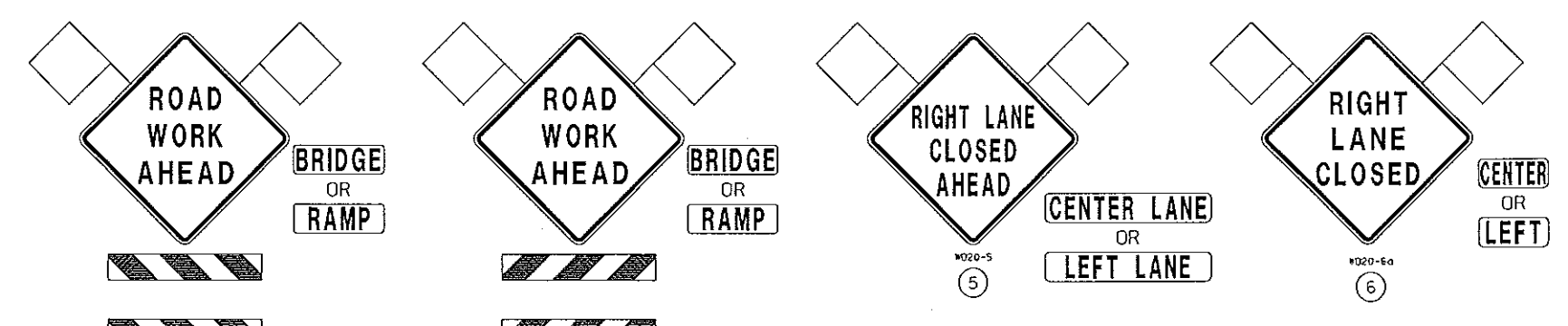
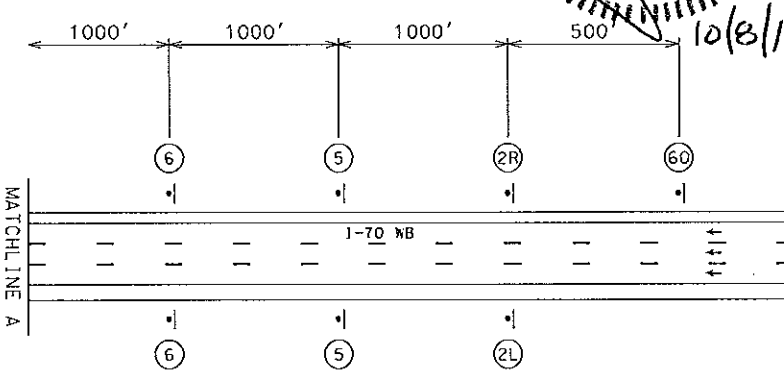

- GENERAL NOTES:**
1. EXISTING SIGNS SHALL BE COVERED DURING WORKING HOURS ONLY IF IN CONFLICT WITH TRAFFIC CONTROL PLANS.
 2. NO DIRECT PAYMENT WILL BE MADE FOR RELOCATING, REMOVING, COVERING, OR UNCOVERING ANY SIGNS OR TRAFFIC CONTROL DEVICES.
 3. TCP QUANTITIES HAVE BEEN PROVIDED FOR ONE WORK ZONE AT A TIME. NO PAYMENT WILL BE MADE FOR ADDITIONAL TRAFFIC CONTROL SIGNS OR DEVICES IN OTHER WORK ZONES.

DISCLAIMER
 THE PROFESSIONAL WHOSE SIGNATURE AND PERSONAL SEAL APPEAR HEREON ASSUMES RESPONSIBILITY ONLY FOR WHAT APPEARS ON THIS PAGE, AND DISCLAIMS (PURSUANT TO SECTION 327.411 RSMO) SPECIFICATION, ESTIMATES, REPORTS, OR OTHER DOCUMENTS OR INSTRUMENTS NOT SEALED BY THE UNDERSIGNED PROFESSIONAL RELATING TO OR INTENDED TO BE USED FOR ANY PART OR PARTS OF THE PROJECT TO WHICH THIS PAGE REFERS.

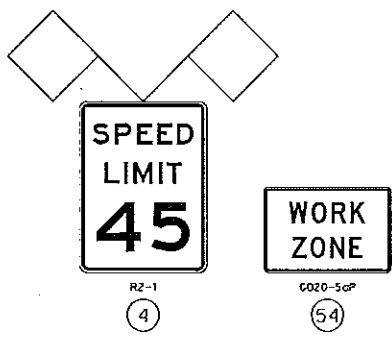
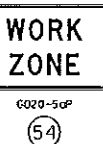
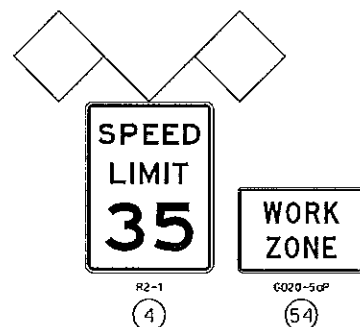
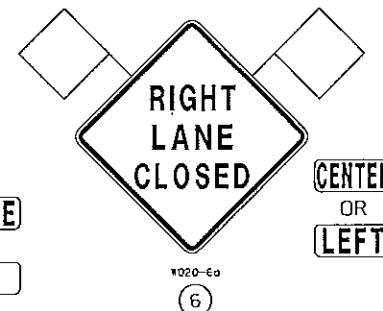
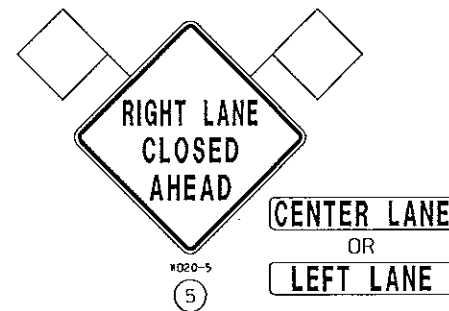
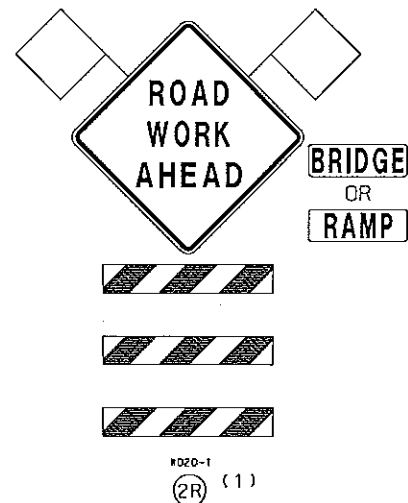
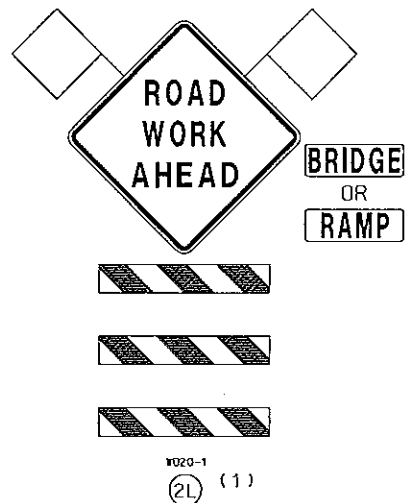
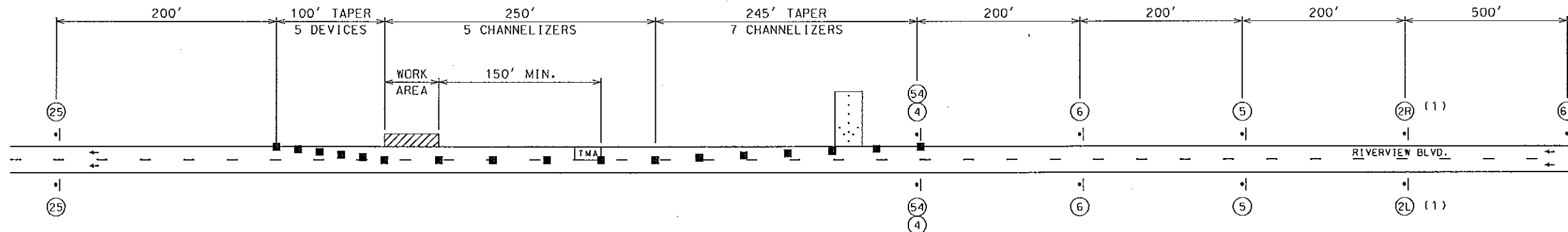

EXHIBIT A
 I-70 UNDER SALISBURY
 TRAFFIC CONTROL
 SHEET 1 OF 3

NOT TO SCALE

IF A SEAL IS PRESENT ON THIS SHEET IT HAS BEEN ELECTRONICALLY SEALED AND DATED.



TRAFFIC CONTROL LEGEND

- ▲ SIGN (SINGLE SIDED)
- TRIMLINE CHANNELIZER
- ▲ DIRECTIONAL INDICATOR BARRICADE
- ⬢ FLASHING ARROW PANEL
- ▨ WORK AREA
- TMA TRUCK OR TRAILER MOUNTED ATTENUATOR

DISCLAIMER
 THE PROFESSIONAL WHOSE SIGNATURE AND PERSONAL SEAL APPEAR HEREON ASSUMES RESPONSIBILITY ONLY FOR WHAT APPEARS ON THIS PAGE, AND DISCLAIMS (PURSUANT TO SECTION 327.411 RSMO) SPECIFICATION, ESTIMATES, REPORTS, OR OTHER DOCUMENTS OR INSTRUMENTS NOT SEALED BY THE UNDERSIGNED PROFESSIONAL RELATING TO OR INTENDED TO BE USED FOR ANY PART OR PARTS OF THE PROJECT TO WHICH THIS PAGE REFERS.

NOTES:

- (1) THIS SIGN SHALL BE PLACED ON ANY ADJACENT ROADWAY LOCATED WITHIN THE ADVANCE WARNING AREA OF THE TRAFFIC CONTROL WORK ZONE.

GENERAL NOTES:

1. EXISTING SIGNS SHALL BE COVERED DURING WORKING HOURS ONLY IF IN CONFLICT WITH TRAFFIC CONTROL PLANS.
2. NO DIRECT PAYMENT WILL BE MADE FOR RELOCATING, REMOVING, COVERING, OR UNCOVERING ANY SIGNS OR TRAFFIC CONTROL DEVICES.
3. TCP QUANTITIES HAVE BEEN PROVIDED FOR ONE WORK ZONE AT A TIME. NO PAYMENT WILL BE MADE FOR ADDITIONAL TRAFFIC CONTROL SIGNS OR DEVICES IN OTHER WORK ZONES.

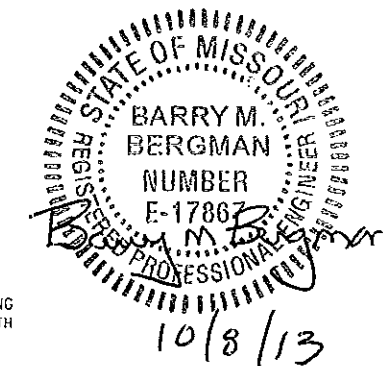
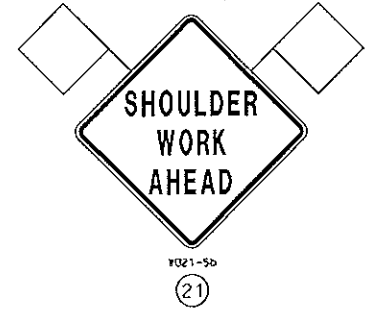
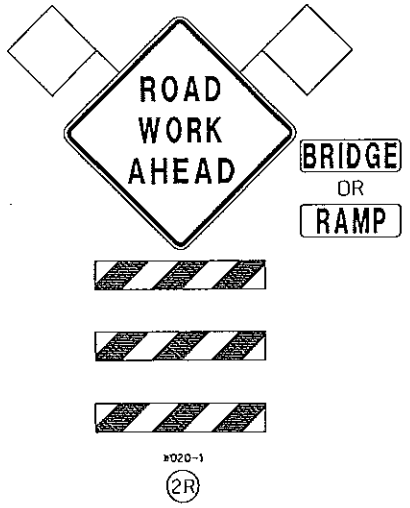
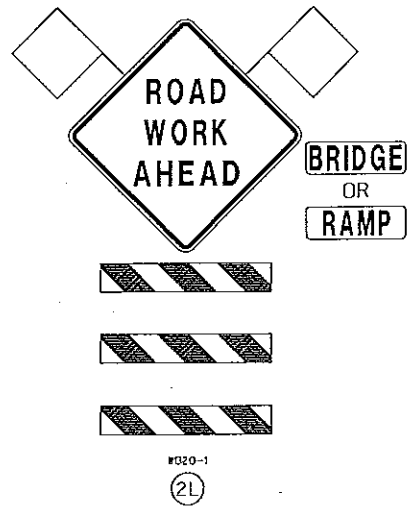
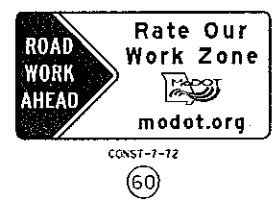
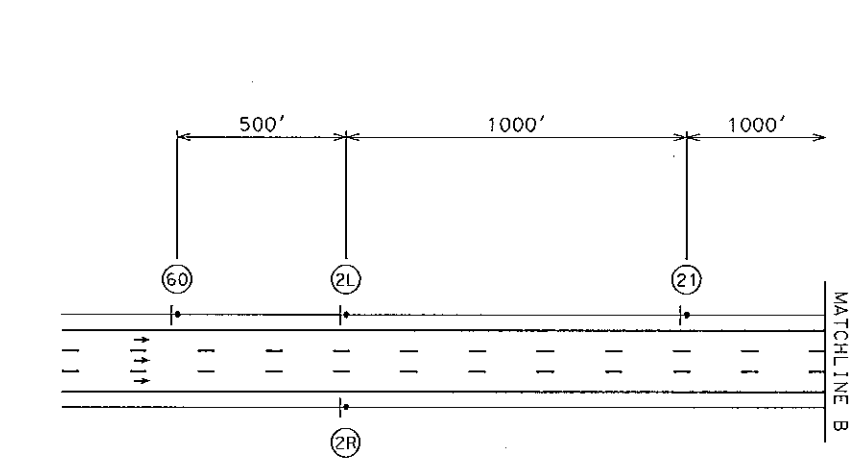
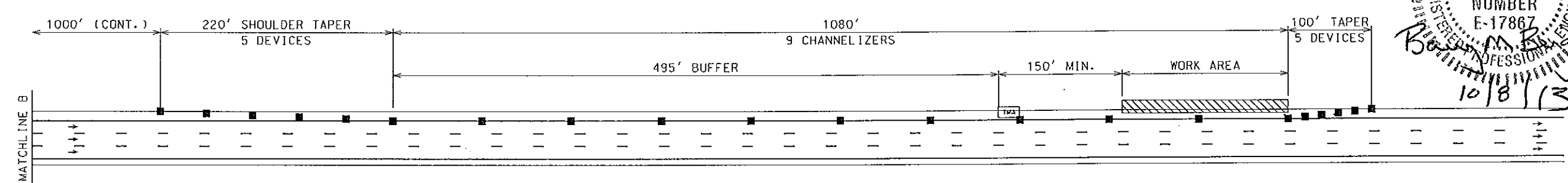

EXHIBIT A
 RIVERVIEW UNDER I-70
 TRAFFIC CONTROL
 SHEET 2 OF 3

NOT TO SCALE

IF A SEAL IS PRESENT ON THIS SHEET IT HAS BEEN ELECTRONICALLY SEALED AND DATED.

STATE OF MISSOURI
 BARRY M. BERGMAN
 REGISTERED PROFESSIONAL ENGINEER
 NUMBER E-17867
 10/8/13



TRAFFIC CONTROL LEGEND

- ▲ SIGN (SINGLE SIDED)
- TRIMLINE CHANNELIZER
- ▲ DIRECTIONAL INDICATOR BARRICADE
- ▨ WORK AREA
- TMA TRUCK OR TRAILER MOUNTED ATTENUATOR

GENERAL NOTES:

1. EXISTING SIGNS SHALL BE COVERED DURING WORKING HOURS ONLY IF IN CONFLICT WITH TRAFFIC CONTROL PLANS.
2. NO DIRECT PAYMENT WILL BE MADE FOR RELOCATING, REMOVING, COVERING, OR UNCOVERING ANY SIGNS OR TRAFFIC CONTROL DEVICES.
3. TCP QUANTITIES HAVE BEEN PROVIDED FOR ONE WORK ZONE AT A TIME. NO PAYMENT WILL BE MADE FOR ADDITIONAL TRAFFIC CONTROL SIGNS OR DEVICES IN OTHER WORK ZONES.

DISCLAIMER
 THE PROFESSIONAL WHOSE SIGNATURE AND PERSONAL SEAL APPEAR HEREON ASSUMES RESPONSIBILITY ONLY FOR WHAT APPEARS ON THIS PAGE, AND DISCLAIMS (PURSUANT TO SECTION 327.411 RSMO) SPECIFICATION, ESTIMATES, REPORTS, OR OTHER DOCUMENTS OR INSTRUMENTS NOT SEALED BY THE UNDERSIGNED PROFESSIONAL RELATING TO OR INTENDED TO BE USED FOR ANY PART OR PARTS OF THE PROJECT TO WHICH THIS PAGE REFERS.

EXHIBIT A
 SHOULDER CLOSURE
 TRAFFIC CONTROL
 SHEET 3 OF 3

NOT TO SCALE

IF A SEAL IS PRESENT ON THIS SHEET IT HAS BEEN ELECTRONICALLY SEALED AND DATED.