

**DESIGN DESIGNATION**

A.A.D.T. - 2016 = 27330  
 A.A.D.T. - 2036 = 30200  
 T = 43%  
 V = 70 M.P.H.

FUNCTIONAL CLASSIFICATION - INTERSTATE

NO PERMANENT RIGHT OF WAY

# MISSOURI HIGHWAYS AND TRANSPORTATION COMMISSION

## PRELIMINARY PLANS FOR PROPOSED

### STATE HIGHWAY

#### COOPER COUNTY

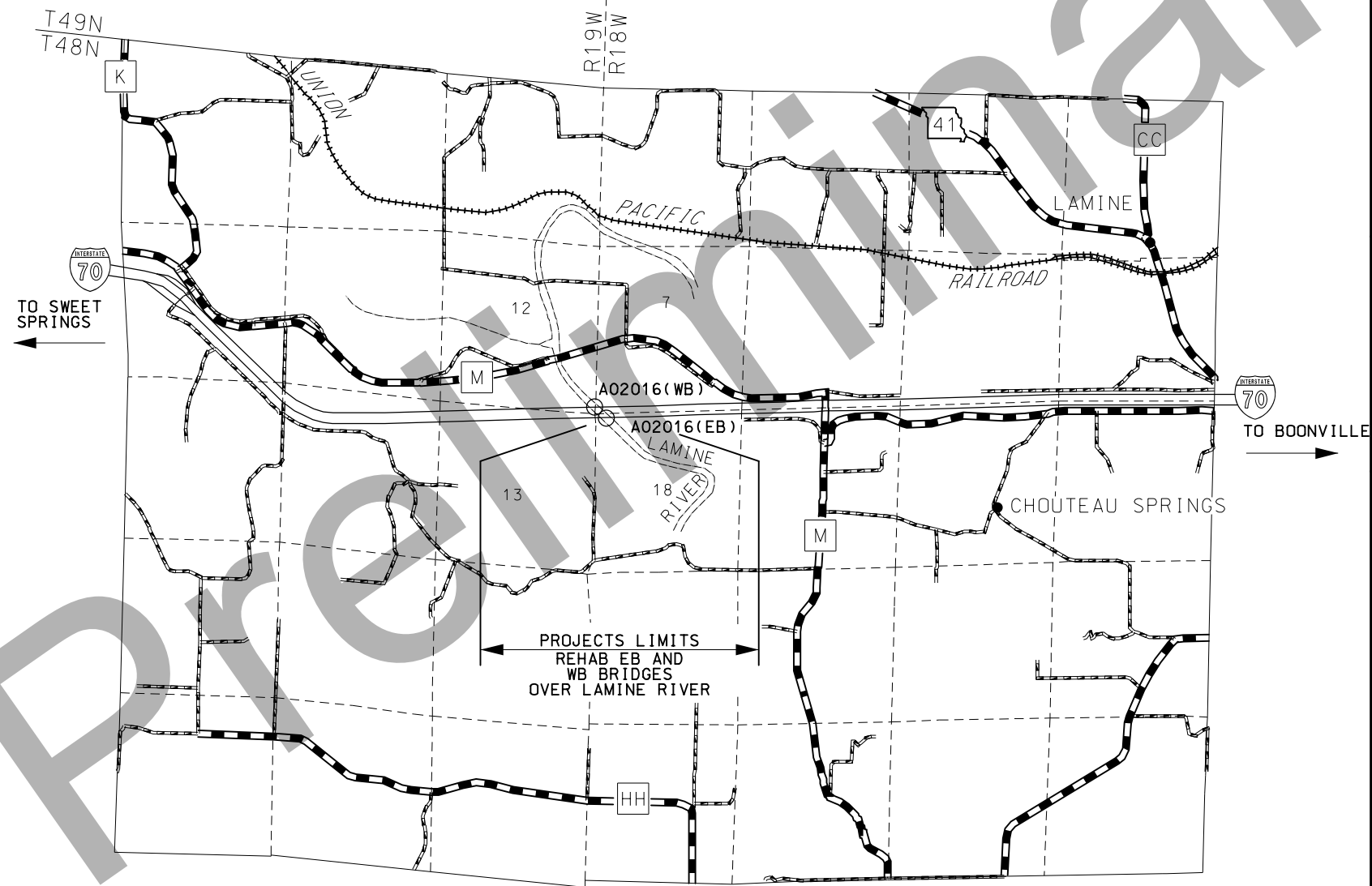

**CONVENTIONAL SYMBOLS**

(USED IN PLANS)

	EXISTING	NEW
BUILDINGS AND STRUCTURES		
GUARD RAIL		
CONCRETE RIGHT-OF-WAY MARKER		
STEEL RIGHT-OF-WAY MARKER		
LOCATION SURVEY MARKER		
UTILITIES		
FIBER OPTICS		
OVERHEAD TELEPHONE		
UNDERGROUND TELEPHONE		
OVERHEAD POWER		
UNDERGROUND POWER		
GAS		
WATER		
MANHOLE		
FIRE HYDRANT		
WATER VALVE		
WATER METER		
DROP INLET		
DITCH BLOCK		
GROUND MOUNTED SIGN		
LIGHT POLE		
H-FRAME POWER POLE		
TELEPHONE PEDESTAL		
FENCE		
CHAIN LINK		
WOVEN WIRE		
GATE POST		
BENCHMARK		

NOTE: DASHED OR OPEN SYMBOLS INDICATE EXISTING FEATURES

NOT TO SCALE

**PRELIMINARY PLANS**  
**SUBJECT TO CHANGE**  
 DATE 1/8/16

**INDEX OF SHEETS**

DESCRIPTION	SHEET NUMBER
TITLE SHEET -----	1
PLAN-PROFILE (PP)-----	2-3
TRAFFIC CONTROL SHEETS (TC)-----	4-5

"THIS MEDIA SHOULD NOT BE CONSIDERED A CERTIFIED DOCUMENT."

DATE PREPARED 1/8/2016	
ROUTE I-70	STATE MO
DISTRICT CD	SHEET NO. 1
COUNTY COOPER	
JOB NO. J513132	
CONTRACT ID.	
PROJECT NO.	
BRIDGE NO.	

DATE	DESCRIPTION

**LENGTH OF PROJECT**

BEGINNING OF PROJECT	STA. 306+00.00
END OF PROJECT	STA. 345+50.00
APPARENT LENGTH	3950.00 FEET
EQUATIONS AND EXCEPTIONS:	NONE

TOTAL CORRECTIONS	NONE
NET LENGTH OF PROJECT	3950.00 FEET
STATE LENGTH	0.748 MILES

MISSOURI HIGHWAYS AND TRANSPORTATION COMMISSION

105 WEST CAPITOL  
 JEFFERSON CITY, MO 65102  
 1-888-ASK-MODOT (1-888-275-6636)

**PRELIMINARY PLANS**  
**SUBJECT TO CHANGE**  
 DATE 1/8/16

"THIS MEDIA SHOULD NOT BE CONSIDERED A CERTIFIED DOCUMENT."

DATE PREPARED 1/8/2016	
ROUTE I-70	STATE MO
DISTRICT CD	SHEET NO. 2
COUNTY COOPER	
JOB NO. J513132	
CONTRACT ID.	

PROJECT NO.  
BRIDGE NO.

DATE	DESCRIPTION

MISSOURI HIGHWAYS AND TRANSPORTATION COMMISSION



105 WEST CAPITOL  
 JEFFERSON CITY, MO 65102  
 1-888-ASK-MODOT (1-888-275-6636)

EASTBOUND CROSSOVER ALIGNMENTS

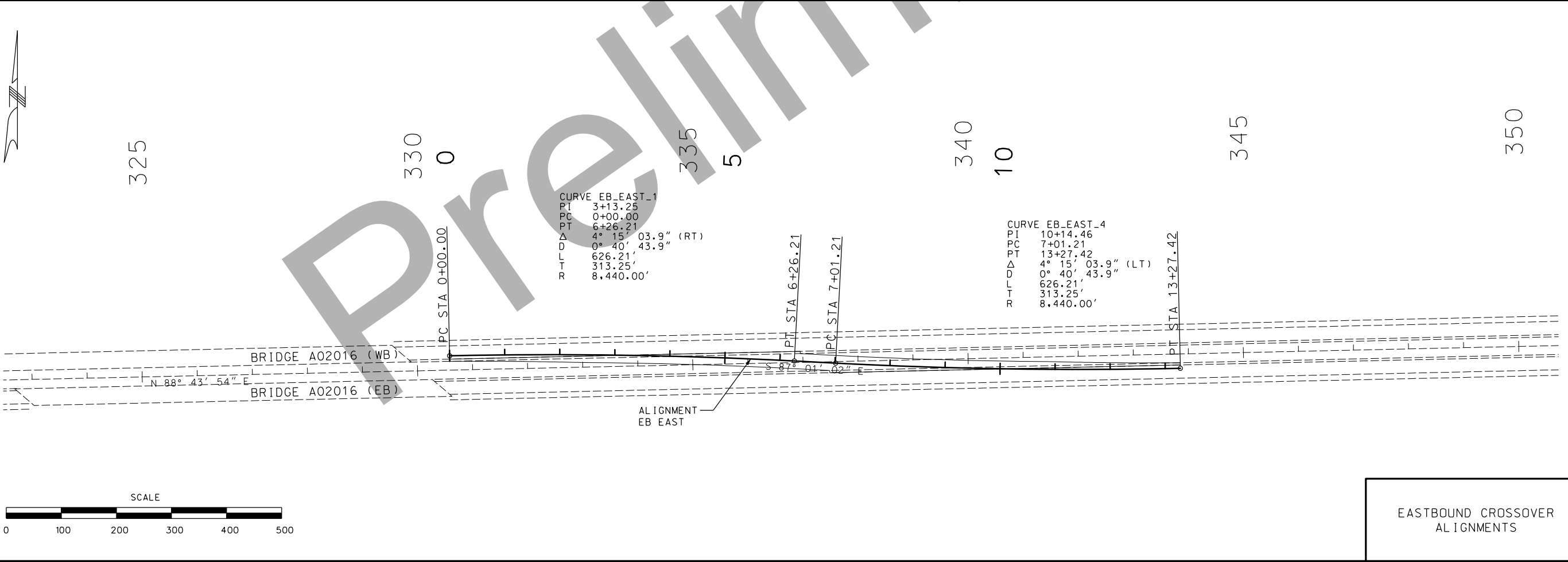
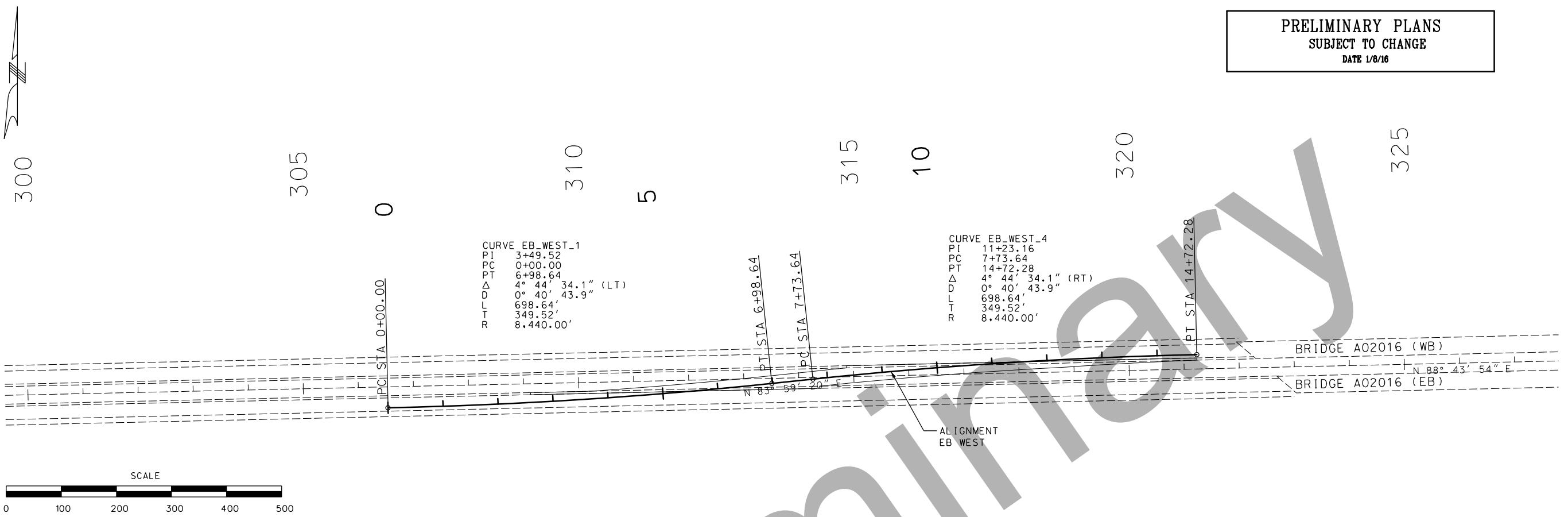

IF A SEAL IS PRESENT ON THIS SHEET IT HAS BEEN ELECTRONICALLY SEALED AND DATED.



300

305

0

310

5

315

10

320

325

CURVE WB\_WEST\_1  
 PI 3+13.25  
 PC 0+00.00  
 PT 6+26.21  
 Δ 4° 15' 03.9" (RT)  
 Δ 0° 40' 43.9"  
 Δ 626.21'  
 Δ 313.25'  
 R 8,440.00'

CURVE WB\_WEST\_4  
 PI 10+14.46  
 PC 7+01.21  
 PT 13+27.42  
 Δ 4° 15' 03.9" (LT)  
 Δ 0° 40' 43.9"  
 Δ 626.21'  
 Δ 313.25'  
 R 8,440.00'

PRELIMINARY PLANS  
 SUBJECT TO CHANGE  
 DATE 1/8/16

"THIS MEDIA SHOULD  
 NOT BE CONSIDERED  
 A CERTIFIED  
 DOCUMENT."

DATE PREPARED  
 1/8/2016

ROUTE I-70	STATE MO
DISTRICT CD	SHEET NO. 3

COUNTY  
COOPER

JOB NO.  
J513132

CONTRACT ID.

PROJECT NO.

BRIDGE NO.

DATE	DESCRIPTION

MISSOURI HIGHWAYS AND TRANSPORTATION  
 COMMISSION



105 WEST CAPITOL  
 JEFFERSON CITY, MO 65102  
 1-888-ASK-MODOT (1-888-275-6636)

WESTBOUND CROSSOVER  
 ALIGNMENTS

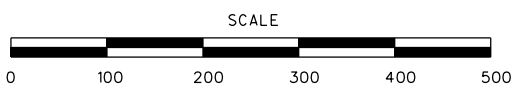

325

330

0

335

5

340

10

345

350

CURVE WB\_EAST\_1  
 PI 3+49.52  
 PC 0+00.00  
 PT 6+98.64  
 Δ 4° 44' 34.1" (LT)  
 Δ 0° 40' 43.9"  
 Δ 698.64'  
 Δ 349.52'  
 R 8,440.00'

CURVE WB\_EAST\_4  
 PI 11+23.16  
 PC 7+73.64  
 PT 14+72.28  
 Δ 4° 44' 34.1" (RT)  
 Δ 0° 40' 43.9"  
 Δ 698.64'  
 Δ 349.52'  
 R 8,440.00'

N 88° 43' 54" E

BRIDGE A02016 (WB)

BRIDGE A02016 (EB)

ALIGNMENT  
 WB EAST

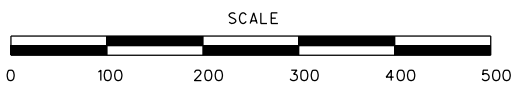

IF A SEAL IS PRESENT ON THIS SHEET IT HAS BEEN ELECTRONICALLY SEALED AND DATED.

"THIS MEDIA SHOULD NOT BE CONSIDERED A CERTIFIED DOCUMENT."

DATE PREPARED  
1/8/2016  
ROUTE I-70 STATE MO  
DISTRICT CD SHEET NO. 4  
COUNTY COOPER  
JOB NO. J513132  
CONTRACT ID.

PROJECT NO.  
BRIDGE NO.

DESCRIPTION

DATE

MISSOURI HIGHWAYS AND TRANSPORTATION COMMISSION  
105 WEST CAPITOL  
JEFFERSON CITY, MO 65102  
1-888-ASK-MODOT (1-888-275-6636)

**PRELIMINARY PLANS**  
SUBJECT TO CHANGE  
DATE 1/8/16

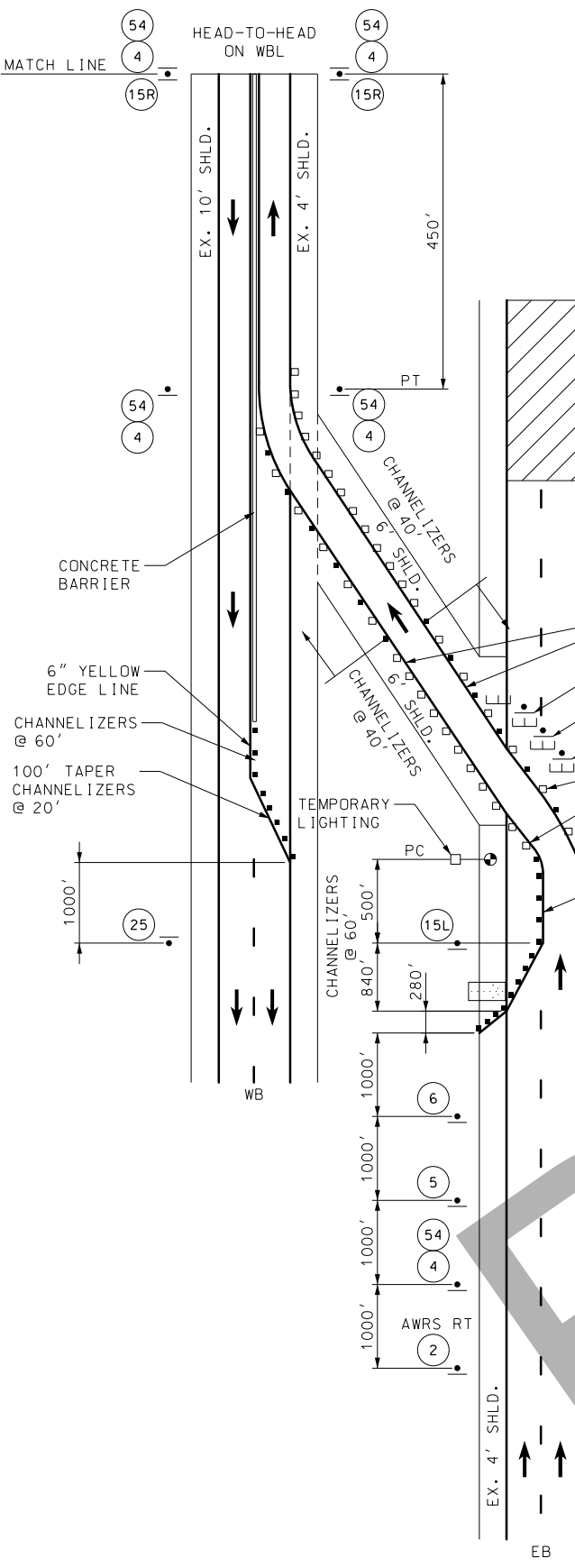

WEST CROSSOVER

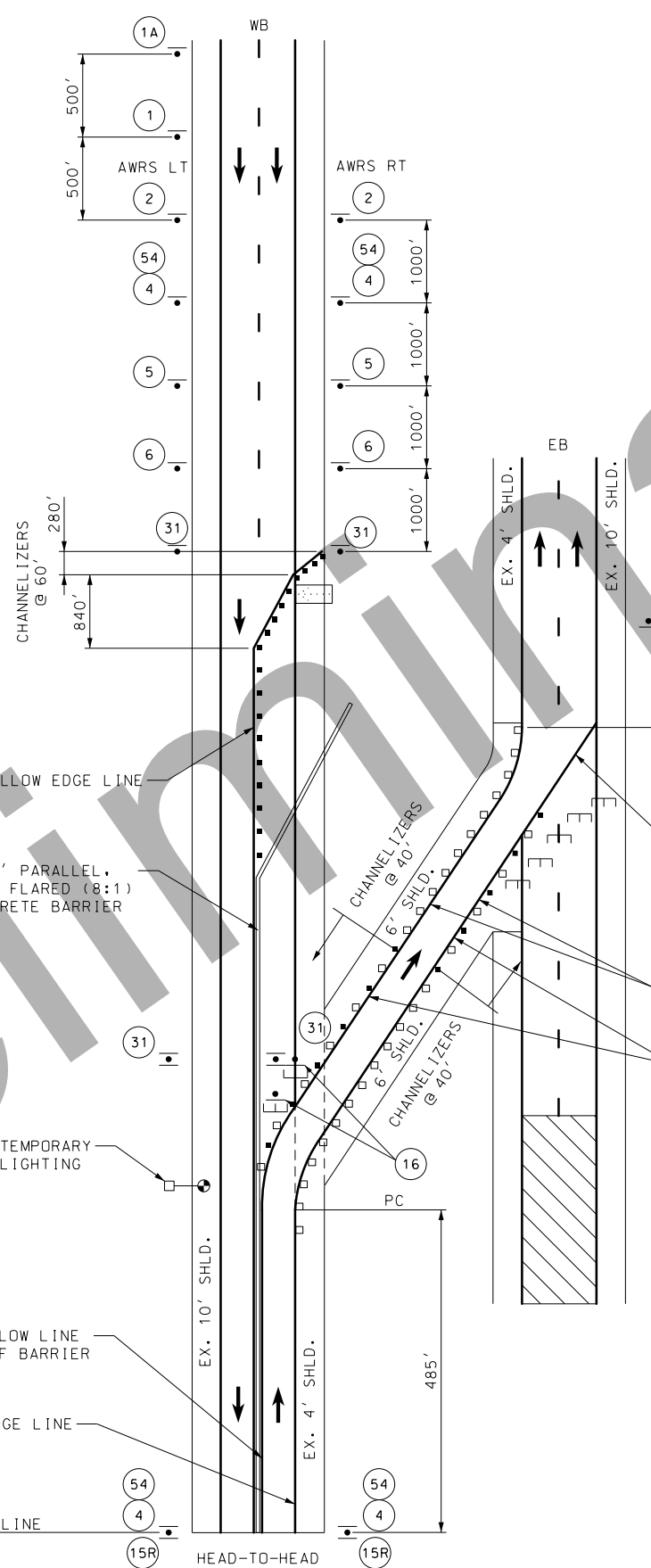

EAST CROSSOVER

**Bridge Improvements**  
FALL 2016

**Rate Our Work Zone**  
modot.org

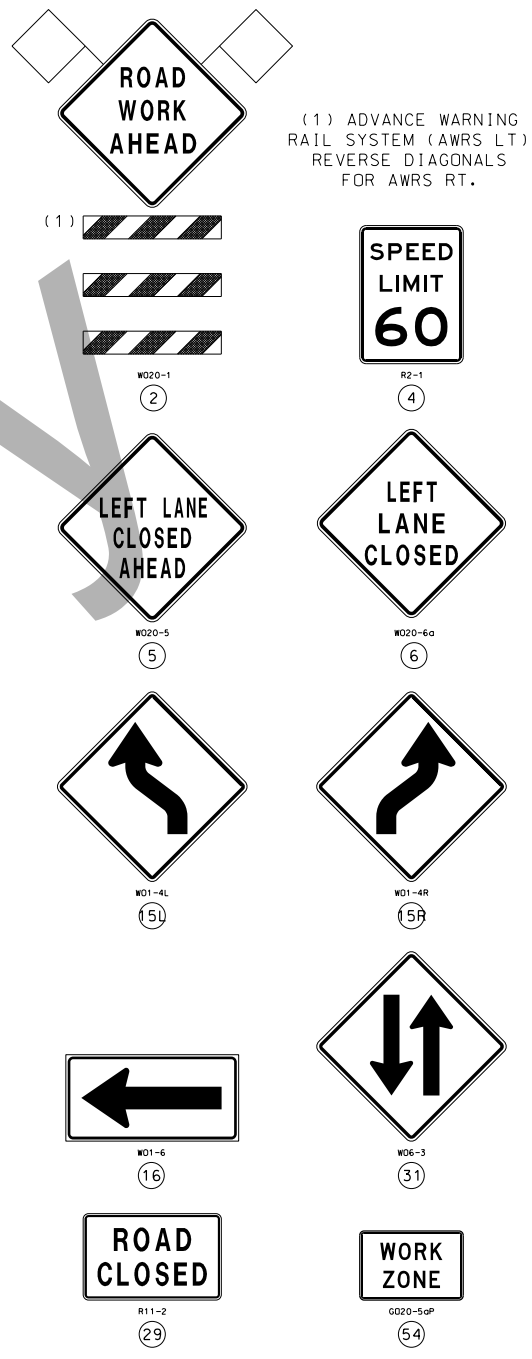

- TRAFFIC CONTROL LEGEND**
- SIGN (SINGLE SIDED)
  - ◻ SIGN (DOUBLE SIDED)
  - CHANNELIZER
  - E BARRICADE
  - TEMPORARY RAISED PAV'T MARKERS
  - ◻ FLASHING ARROW PANEL

TRAFFIC CONTROL  
EASTBOUND BRIDGE REHAB  
SHEET 1 OF 2

NOT TO SCALE

IF A SEAL IS PRESENT ON THIS SHEET IT HAS BEEN ELECTRONICALLY SEALED AND DATED.

**PRELIMINARY PLANS**  
**SUBJECT TO CHANGE**  
 DATE 1/8/16

"THIS MEDIA SHOULD NOT BE CONSIDERED A CERTIFIED DOCUMENT."

DATE PREPARED  
 1/8/2016

ROUTE I-70 STATE MO  
 DISTRICT CD SHEET NO. 5

COUNTY COOPER  
 JOB NO. J513132  
 CONTRACT ID.

PROJECT NO.  
 BRIDGE NO.

DATE	DESCRIPTION

MISSOURI HIGHWAYS AND TRANSPORTATION COMMISSION

105 WEST CAPITOL  
 JEFFERSON CITY, MO 65102  
 1-888-ASK-MODOT (1-888-275-6636)

NOT TO SCALE

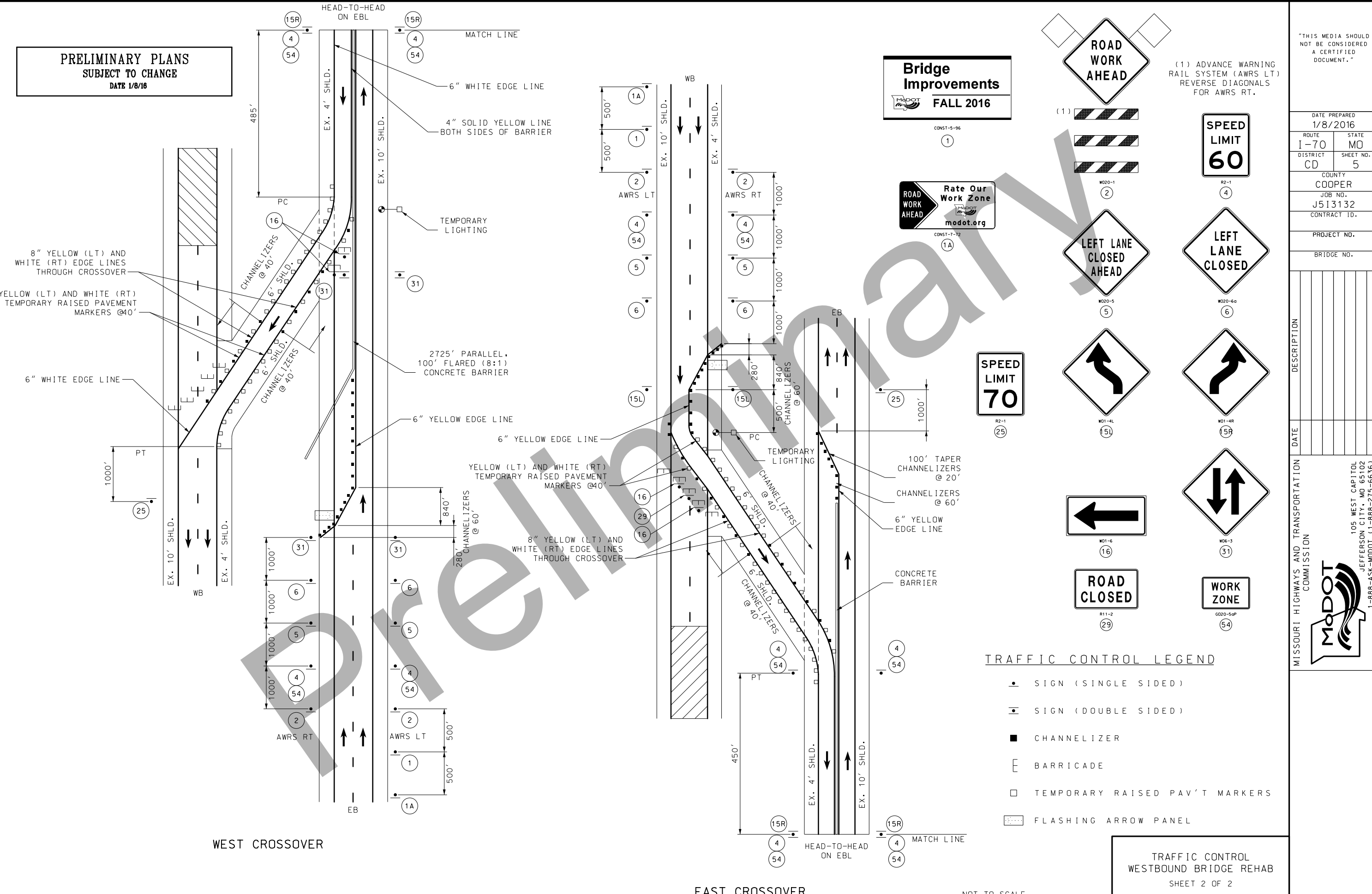

**Bridge Improvements**  
 FALL 2016

**Rate Our Work Zone**  
 modot.org

**TRAFFIC CONTROL LEGEND**

- SIGN (SINGLE SIDED)
- ◻ SIGN (DOUBLE SIDED)
- CHANNELIZER
- ⌈ BARRICADE
- TEMPORARY RAISED PAV'T MARKERS
- ⋯ FLASHING ARROW PANEL

TRAFFIC CONTROL  
 WESTBOUND BRIDGE REHAB  
 SHEET 2 OF 2