

MATCHLINE @ 226+00

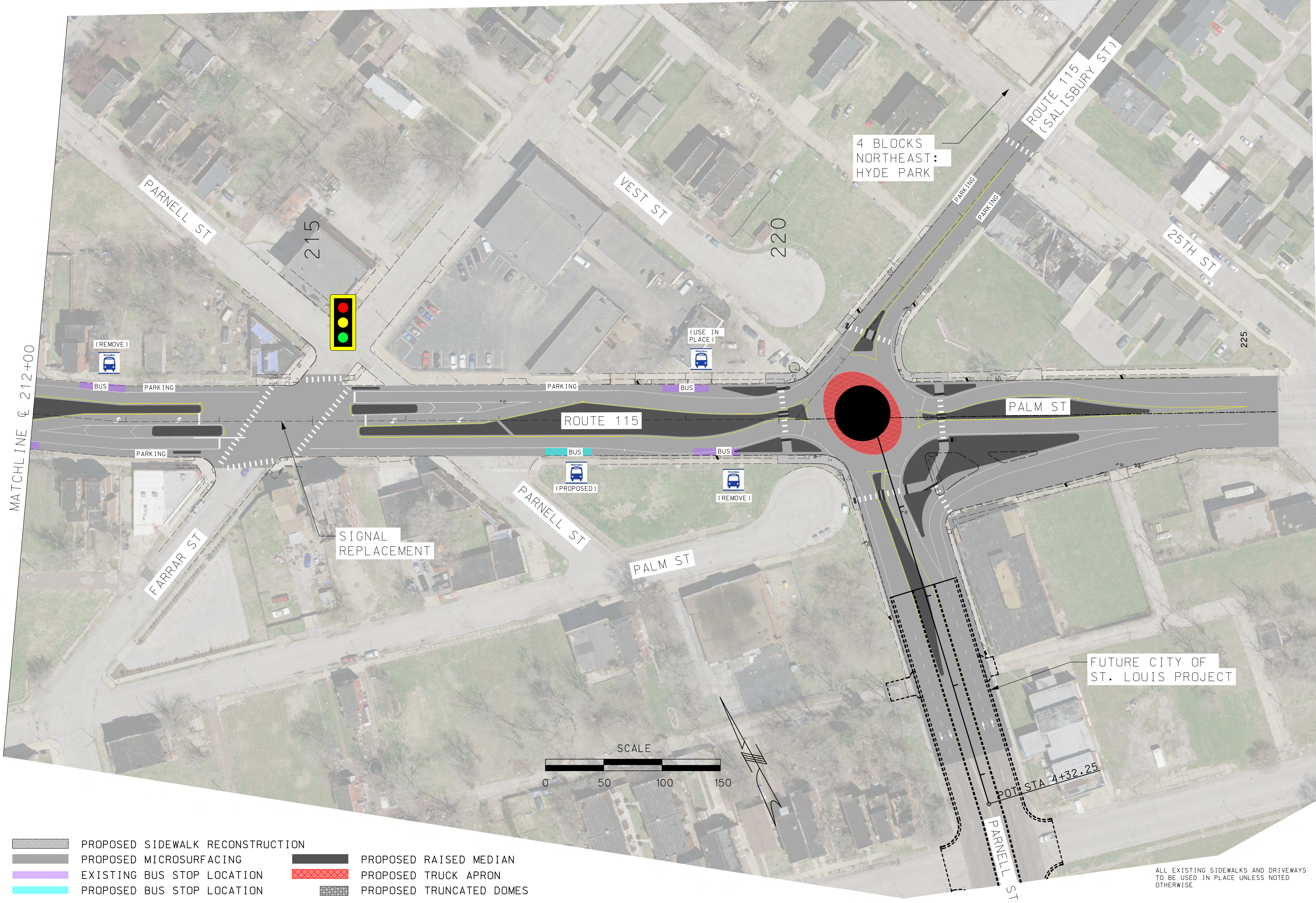

MATCHLINE @ 212+00

- PROPOSED SIDEWALK RECONSTRUCTION
- PROPOSED MICROSURFACING
- EXISTING BUS STOP LOCATION
- PROPOSED BUS STOP LOCATION
- PROPOSED RAISED MEDIAN
- PROPOSED TRUCK APRON
- PROPOSED TRUNCATED DOMES



"THIS MEDIA SHOULD NOT BE CONSIDERED A CERTIFIED DOCUMENT."

DATE PREPARED 1/16/2020	
ROUTE 115	STATE MO
DISTRICT SL	SHEET NO.
COUNTY ST LOUIS CITY	
JOB NO. J6S3258	
CONTRACT ID.	

PROJECT NO.
BRIDGE NO.

DATE	DESCRIPTION

MISSOURI HIGHWAYS AND TRANSPORTATION COMMISSION

105 WEST CAPITOL
JEFFERSON CITY, MO 65102
1-888-ASK-MODOT (1-888-275-6636)

11820 TESSON FERRY ROAD
SUITE 203
ST. LOUIS, MO 63128
(314) 943-6446

#200172588 MISSOURI ENGINEERING CERTIFICATE OF AUTHORITY

CONCEPT PLAN SHEET 9 OF 10

ALL EXISTING SIDEWALKS AND DRIVEWAYS TO BE USED IN PLACE UNLESS NOTED OTHERWISE

IF A SEAL IS PRESENT ON THIS SHEET IT HAS BEEN ELECTRONICALLY SEALED AND DATED.