



# U.S. Route 36/63 Interchange and Intersection Improvements in Macon



## Project Summary

The Missouri Department of Transportation (MoDOT), working with its consultant EFK Moen, LLC, is preparing for an interchange and intersection safety improvement project in Macon County.

## Project Purpose and Need

This project will improve mobility and capacity at the U.S. Route 63/U.S. Route 36 interchange in the city of Macon.

## Project Goals

Interchange improvements at this location include:

- A bridge rehabilitation to upgrade the current bridge joint system.
- Realignment of the U.S. Route 36 eastbound and westbound off ramps to allow for traffic signals and separate left and right turn lanes at the ramp terminals.
- Traffic signal and lighting upgrades at the U.S. Route 63 ramp terminals and the intersection at U.S. Route 63/Business Route 36/W. Briggs Drive.
- Reduced island sizes to facilitate large truck turning movements at the U.S. Route 63/Business Route 36/W. Briggs Drive intersection.
- Safety improvements at the Kellogg Avenue median crossover.

## Kellogg Ave. and U.S. 36 Intersection

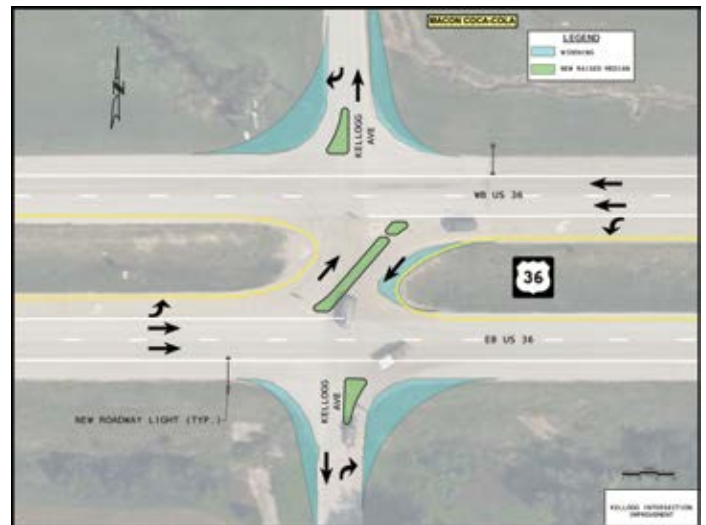

## Project Schedule

Project Milestone	Time-Frame
Public Meeting	May 5, 2025
Letting	August 15, 2025
Under Contract	September 2025
Under Construction	Fall 2025
Project Completion	Fall 2026

Visit the project website at <https://www.modot.org/https://www.modot.org/projects/us-route-63-interchange-improvements-over-us-route-36-macon-county> to view display materials, submit comments and learn more about the project.



# U.S. Route 36/63 Interchange and Intersection Improvements in Macon

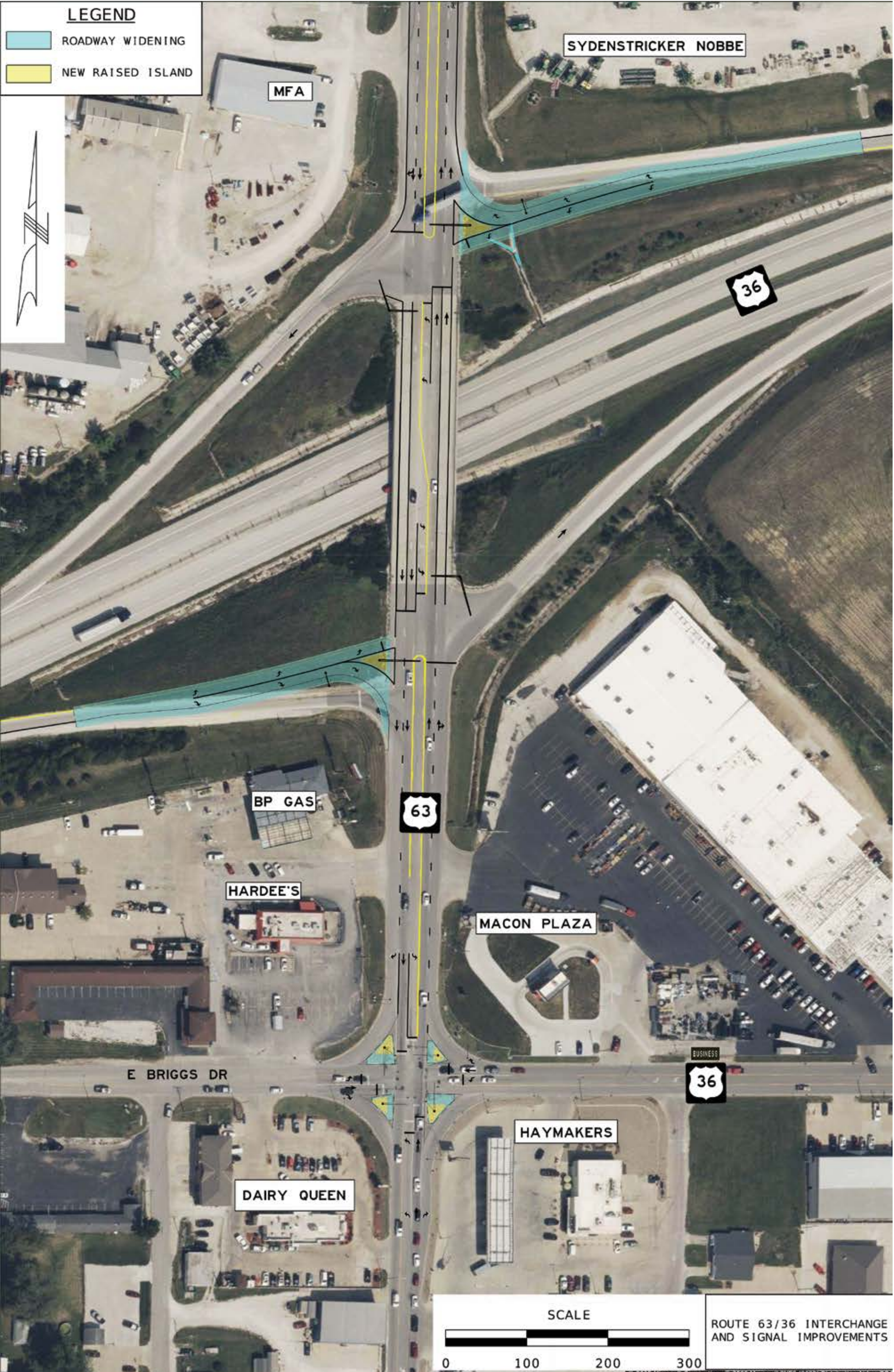

## Frequently Asked Questions

**Q: How much does the project cost?**

**A:** Approximately \$3 - \$3.5 million

**Q: What are the anticipated impacts?**

**A:** Various traffic impacts will be in place as the project progresses, including lane closures on U.S. 36 and U.S. 63 to complete the bridge work and pavement widening. Kellogg Avenue will be temporarily closed to complete the intersection safety improvements. MoDOT will work with residents and business owners to ensure alternate access is available during construction. MoDOT will make every reasonable effort to reduce delays due to construction. Customers can anticipate temporary traffic impacts throughout the project. More information regarding traffic impacts will be shared through news releases and social media for each stage of construction as details become available.

**Q: Will MoDOT need to acquire any right of way?**

**A:** The project will be constructed within the current right of way boundaries and does not require any new right of way.

**Q: How can I stay updated about the project?**

**A:** Stay updated on news about roadwork in your area by signing up for emails at [eUpdates](https://modot.org/eUpdates) at MoDOT.org

**Q: Who can I contact if I have further questions?**

**A:** Questions about the project may be directed to MoDOT's project manager or the Area Engineer listed below:

### Project Contacts



**Keith Killen**

Transportation Project Manager  
Northeast District  
[keith.killen@modot.mo.gov](mailto:keith.killen@modot.mo.gov)  
(660) 385-8222



**Emily Edgar**

Area Engineer  
Northeast District  
[emily.edgar@modot.mo.gov](mailto:emily.edgar@modot.mo.gov)  
(573) 248-8688

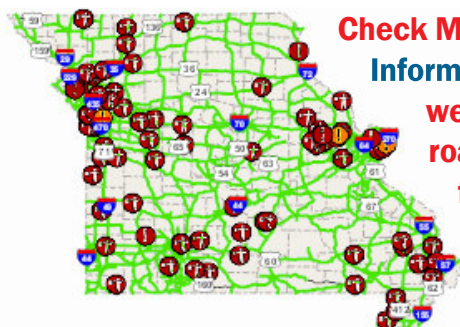

**Check MoDOT's Traveler Information Map for weather-related road conditions, flood closures and work zone locations.**



Missouri Department of Transportation  
1-888 ASK MODOT (275-6636)  
[www.modot.org/northeast](http://www.modot.org/northeast)



### Welcome to E-updates and Text Alerts

**New  
Subscriber**

[Click Here](#)

**Returning  
Subscriber**

Customer ID

Password

[Login](#)

Stay informed on road closures, events, and more through MoDOT's e-update text/email alert system. [modot.org](http://modot.org)



To stay updated on the progress of this project, sign up for email and text alerts at <https://modotweb.modot.mo.gov/eUpdatesPublic/Account/Login?ReturnUrl=/eUpdatesPublic>. For more information, contact MoDOT's Customer Service Center toll-free at 1-888-ASK-MoDOT (275-6636).