

MATCHLINE @ 226+00

MATCHLINE @ 212+00

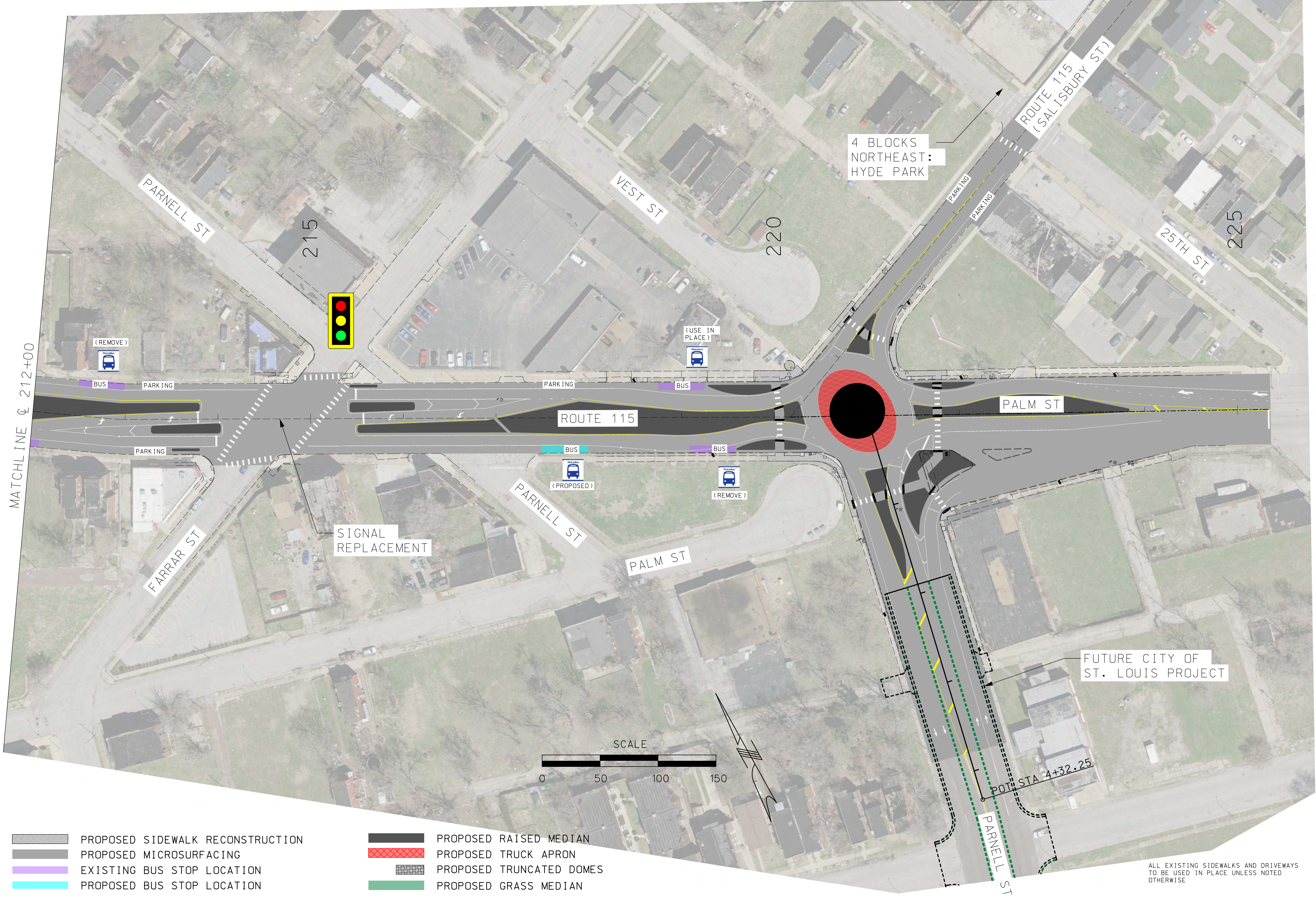

- PROPOSED SIDEWALK RECONSTRUCTION
- PROPOSED MICROSURFACING
- EXISTING BUS STOP LOCATION
- PROPOSED BUS STOP LOCATION

- PROPOSED RAISED MEDIAN
- PROPOSED TRUCK APRON
- PROPOSED TRUNCATED DOMES
- PROPOSED GRASS MEDIAN

ALL EXISTING SIDEWALKS AND DRIVEWAYS TO BE USED IN PLACE UNLESS NOTED OTHERWISE

"THIS MEDIA SHOULD NOT BE CONSIDERED A CERTIFIED DOCUMENT."

DATE PREPARED		8/4/2020	
ROUTE	STATE	115	MO
DISTRICT	SHEET NO.	SL	
COUNTY			
ST LOUIS CITY			
JOB NO.			
J6S3258			
CONTRACT ID.			
PROJECT NO.			
BRIDGE NO.			

DATE	DESCRIPTION

MISSOURI HIGHWAYS AND TRANSPORTATION COMMISSION

105 WEST CAPITOL  
JEFFERSON CITY, MO 65102  
1-888-ASK-MODOT (1-888-275-6636)

ACCESS ENGINEERING LLC  
11820 TESSON FERRY ROAD  
SUITE 203  
ST. LOUIS, MO 63128  
(314) 943-6446

#200172588-RENS  
ENGINEERING CERTIFICATE OF AUTHORITY

CONCEPT PLAN SHEET 9 OF 10