



J613290
BRIDGE REHABILITATION
I-55 OVER MERAMEC RIVER
2026-2027



STAGE 4

LEGEND

- WORK AREA
- CROSSOVER / LANE SHIFT
- TRAFFIC DIRECTION
- TEMPORARY / PERMANENT CONCRETE BARRIER
- EXISTING BRIDGE / ROADWAY
- CLOSED LANE

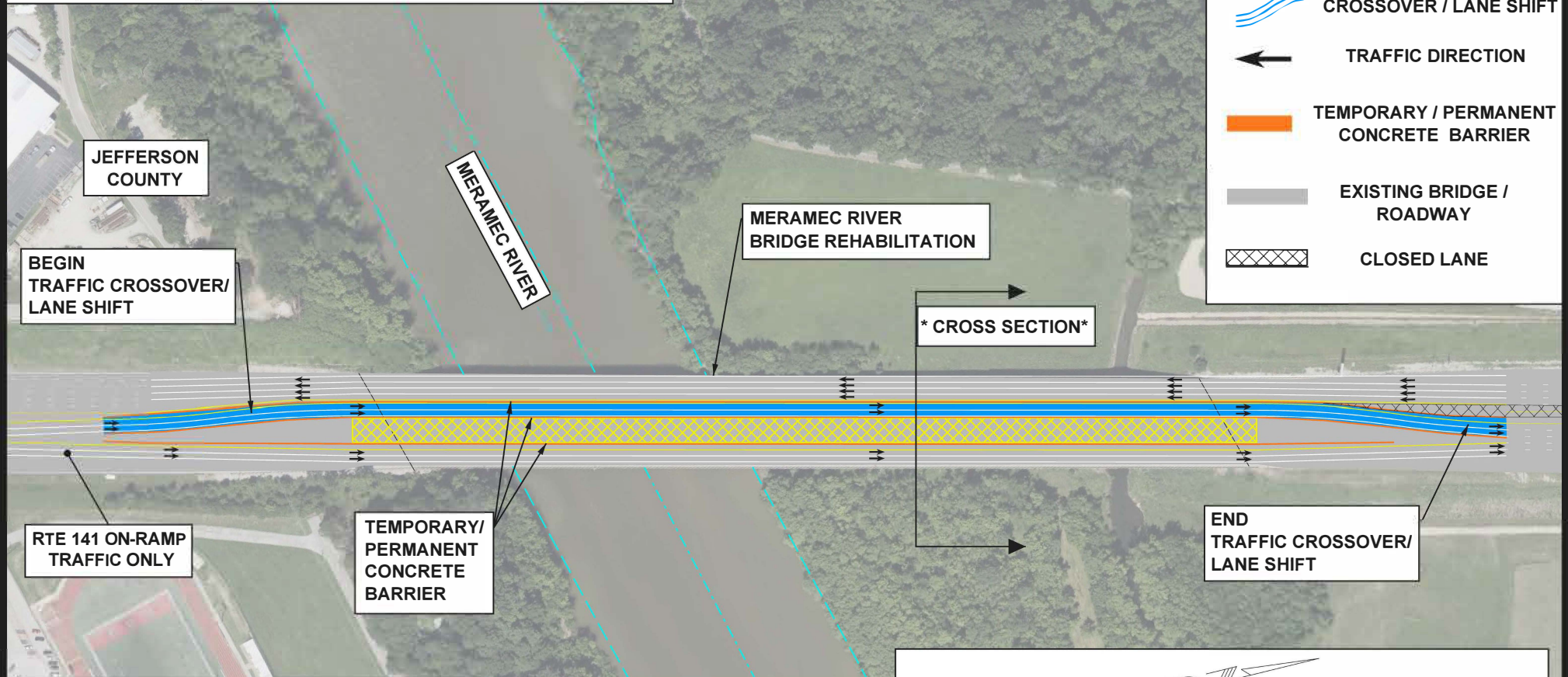

STAGE 4

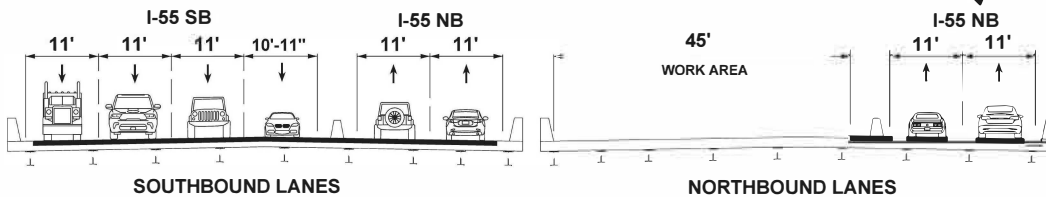

CROSS SECTION



SCALE



STAGE 4 - DESCRIPTION OF WORK

- TWO (2) NORTHBOUND LANES WILL BE SHIFTED ONTO THE COMPLETED EASTERN PORTION OF THE MERAMEC RIVER BRIDGE.
- TWO (2) ADDITIONAL NORTHBOUND LANES WILL BE PLACED ON THE WESTERN PORTION OF THE BRIDGE, WHILE THE REMAINING EASTERN BRIDGE IS REHABBED.
- FOUR (4) SOUTHBOUND LANES WILL REMAIN OPEN.