

50A 50B 50C

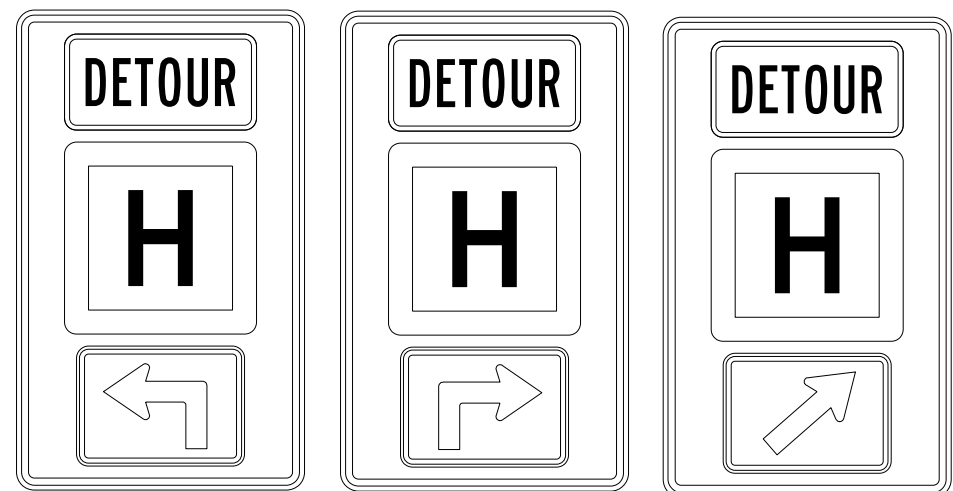

50D 50E 50F

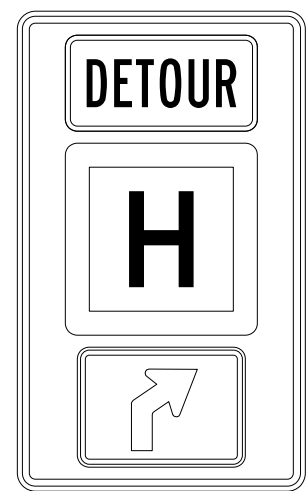

50G



R11-4

55



W020-2

18

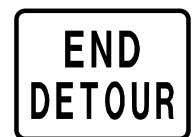

MO4-8a

52

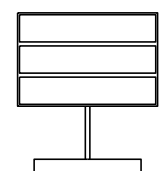

CHANGEABLE
MESSAGE SIGN
FLASH 1-ROUTE H
BRIDGE
CLOSED
FLASH 2-DETOUR
AHEAD

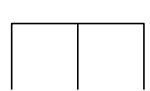

TYPE III MOVABLE
BARRICADE WITH OPTIONAL
TYPE B WARNING LIGHTS

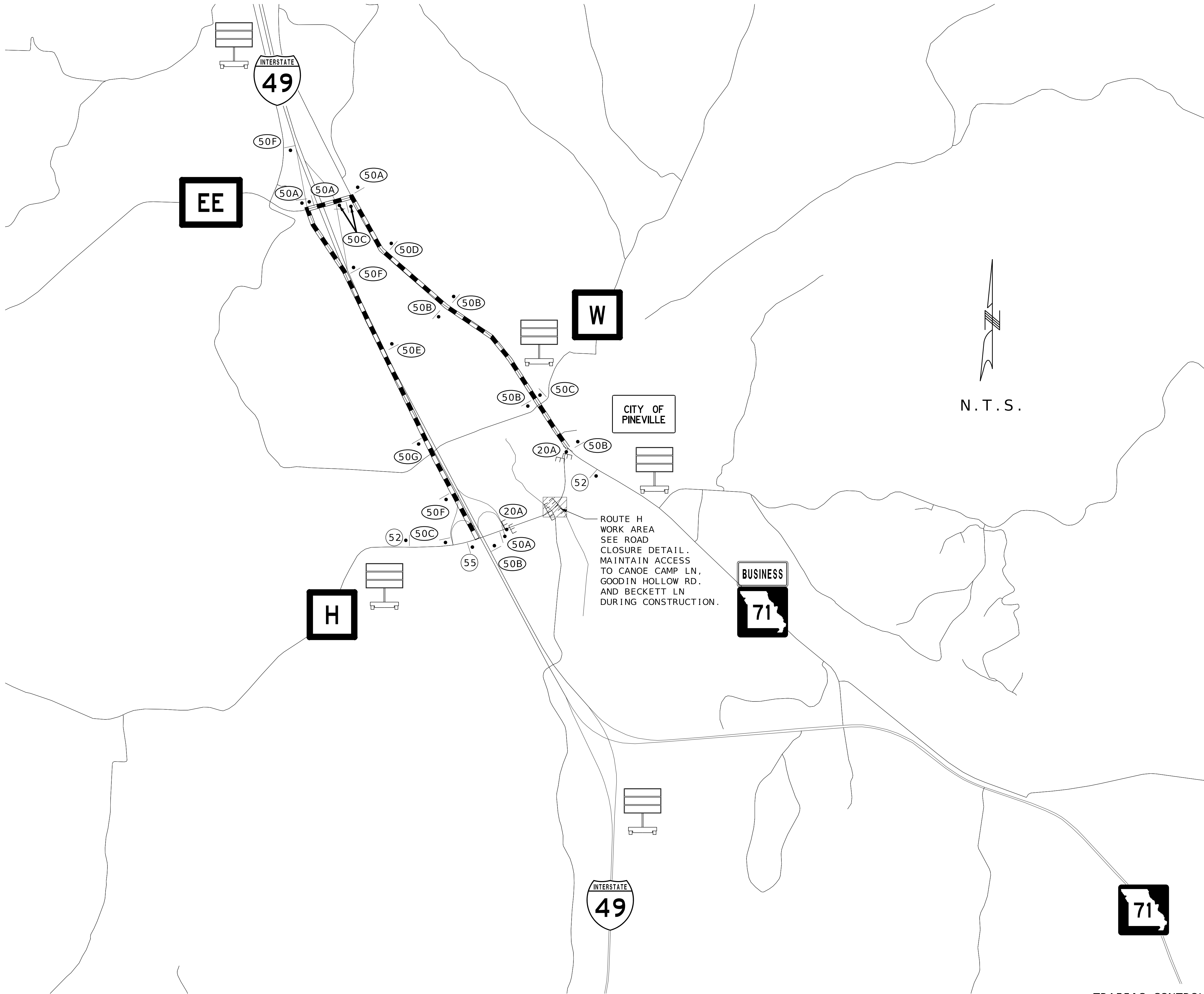

TRAFFIC CONTROL
SHEET 4 OF 4

PRELIMINARY
PLANS
NOT APPROVED
FOR
CONSTRUCTION

DATE PREPARED

1/6/2026

ROUTE H STATE MO
DISTRICT SW SHEET NO. 3

COUNTY
MCDONALD

JOB NO.
JSR0143

CONTRACT ID.

PROJECT NO.

BRIDGE NO.

| DESCRIPTION | DATE |
|-------------|------|
| | |
| | |
| | |
| | |
| | |
| | |
| | |
| | |
| | |

MISSOURI HIGHWAYS AND TRANSPORTATION
COMMISSION

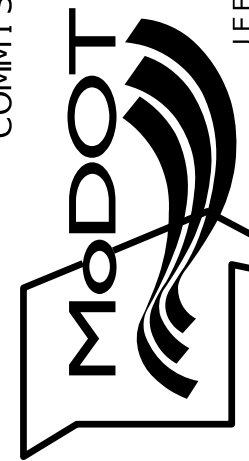

105 WEST CAPITOL
JEFFERSON CITY, MO 65102
1-888-ASK-MODOT (1-888-275-6636)

1411 East 104th St.
Kansas City, MO 64131
Tel (816) 874-4655
Fax (816) 874-4675
www.trekkgroup.com

Missouri Dept. of
Transportation

