

**ELEVATION OF EXTERIOR WING  
SHOWING OPTIONAL CONCRETE REMOVAL**  
(Interior wings similar)  
A-Bars, D-Bars, H-Bars & R-Bars not shown for clarity.

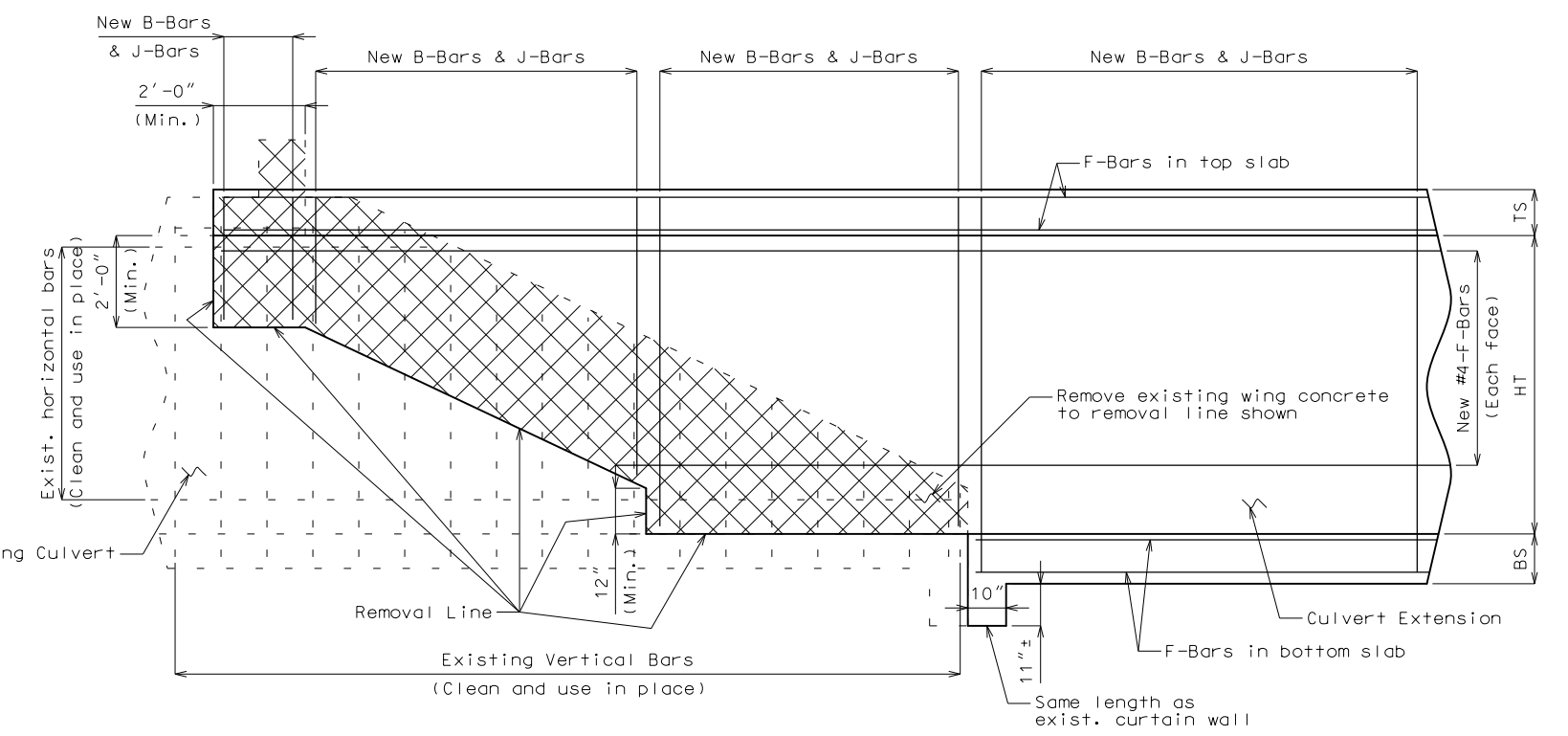

**ELEVATION OF EXTERIOR WING  
SHOWING OPTIONAL CONCRETE REMOVAL**  
(Interior wings similar)  
A-Bars & H-Bars not shown for clarity.

Standard Drawing Guidance (do not show on plans):  
Check wall thickness to see if existing and new matches. If different, see SPM.  
SPM to have design checked before using details.  
SPM could use wing beam design to possibly eliminate all removals.

"THIS MEDIA SHOULD NOT BE CONSIDERED A CERTIFIED DOCUMENT."

DATE PREPARED 5/28/2015	
ROUTE *	STATE MO
DISTRICT BR	SHEET NO. *
COUNTY *	
JOB NO. *	
CONTRACT ID.	
PROJECT NO.	
BRIDGE NO. BOX 16	

DATE	DESCRIPTION

MISSOURI HIGHWAYS AND TRANSPORTATION COMMISSION



105 WEST CAPITOL  
JEFFERSON CITY, MO 65102  
1-888-ASK-MODOT (1-888-275-6636)

**General Notes:**  
For details of Transverse Joint, see Missouri Standard Plans.  
When the headwall is removed, the top slab A-bars and F-bars shall lap the existing bars a minimum of 2'-0".