

**ADDENDUM NO. 1**

**STURBRIDGE DRIVE BRIDGE REPLACEMENT  
FEDERAL PROJECT NO. BRO-R026(001)  
PROJECT NO. 2023-803-1**

**COLE COUNTY DEPARTMENT OF PUBLIC WORKS  
May 4, 2026**

**PLAN SHEET CHANGES**

The Bidder shall incorporate the following plan sheet changes into their bid:

**SHEET C1**

- Index of Sheets has been renumbered.

**INDEX OF SHEETS**

DESCRIPTION	SHEET NUMBER
TITLE SHEET.....	C1
QUANTITIES & TYPICAL SECTIONS.....	C2
PLAN & PROFILE.....	C3
GRADING & EROSION CONTROL.....	C4
CROSS SECTIONS.....	C5
TEMPORARY CROSSING.....	C6
TEMPORARY CROSSING PROFILE.....	C7
TRAFFIC MANAGEMENT PLAN.....	C8
TRAFFIC MANAGEMENT PLAN DETAILS.....	C9
BRIDGE PLAN & ELEVATION.....	S1
GENERAL NOTES & ESTIMATED QUANTITIES.....	S2
BENT 1.....	S3–S5
BENT 2.....	S6–S8
VERTICAL DRAIN.....	S9
17-INCH BOX BEAM.....	S10
PRESTRESSED PANSLS.....	S11
CAMBER, SLAB HAUNCHING & ELEVATIONS.....	S12
SLAB.....	S13
THREE BEAM RAIL.....	S14
BRIDGE APPROACH SLAB (MINOR).....	S15
BILL OF REINFORCING STEEL.....	S16
AS-BUILT PILE DATA.....	S17
BORING DATA.....	S18



**SHEET C2**

- ASYMMETRICAL TRANSITION SECTION
  - Change Units from LIN. FOOT to EACH

CONSTRUCTION SIGNS	50.5	SQ. FOOT	
ASYMMETRICAL TRANSITION SECTION	4	EACH	⚠
TYPE A CRASHWORTHY END TERMINAL	4	EACH	

- 36" CMP FOR TEMPORARY BYPASS
  - Change Quantity from 24 LIN.FOOT to 96 LIN. FOOT

TYPE 1 AGGREGATE FOR TEMPORARY BYPASS (6 IN. THICK)	466	SQ. YARD	
36" CMP FOR TEMPORARY BYPASS	96	LIN. FOOT	⚠

**SHEET C7**

- Change (3) 35" CMP'S to (3) 36" CMP'S

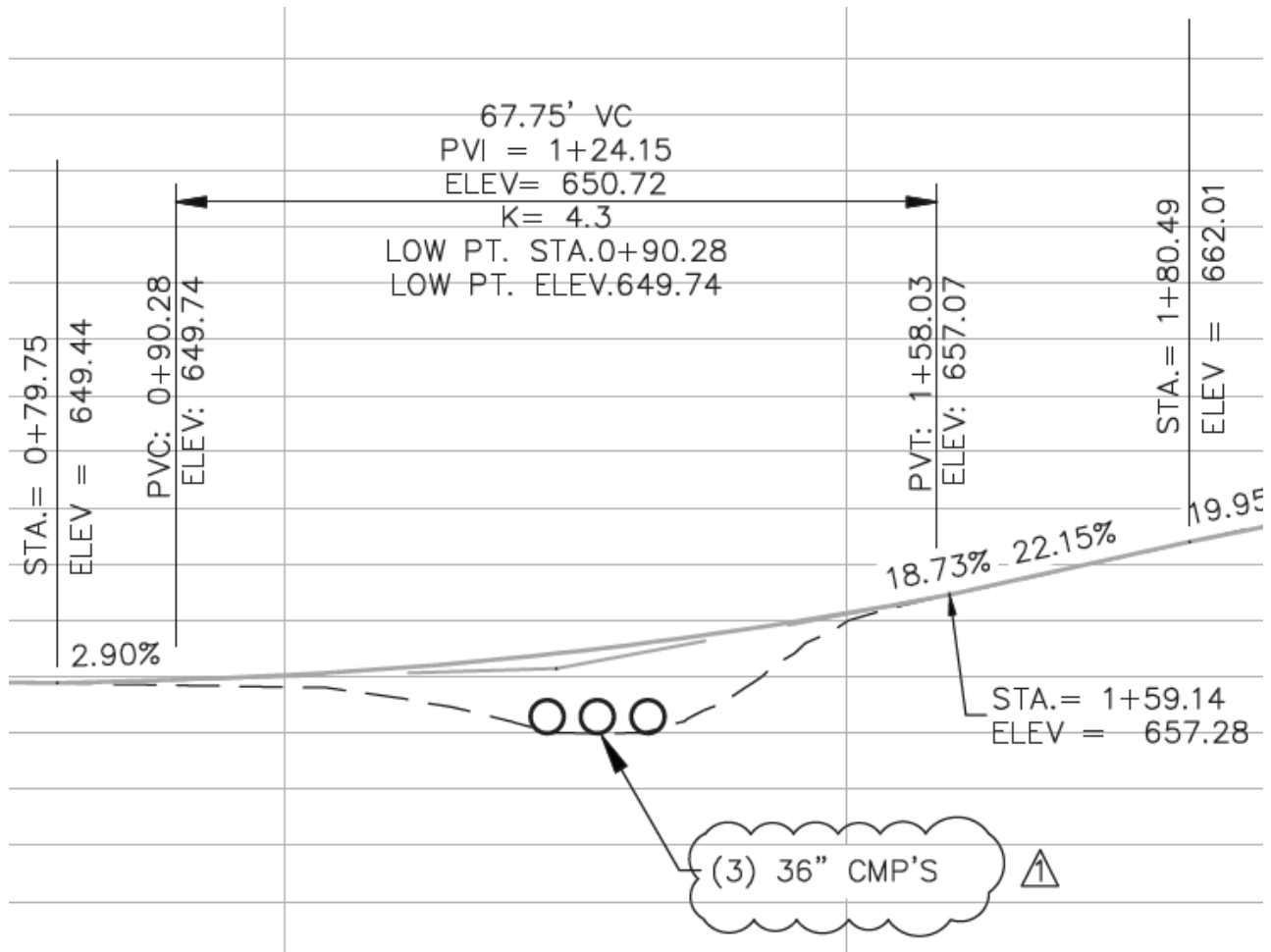

**SHEET S2**

- Add Estimated Quantity for Bridge Approach Slab (Minor)

	Laminated Neoprene Bearing Pad (Tapered)	each	3	3
	Laminated Neoprene Bearing Pad	each	3	3
⚠	Bridge Approach Slab (Minor)	sq. yard	116	116

**END OF PLAN SHEET CHANGES**

**BID FORM**

The following changes have been mad to the Bid Form:

- Item 26 – Change from SLAB ON CONCRETE NU-GIRDER to SLAB ON CONCRETE BEAM

⚠	25 CLASS B CONCRETE (SUBSTRUCTURE)	CY	24.4	_____	_____
	26 SLAB ON CONCRETE BEAM	SY	129	_____	_____
	27 VERTICAL DRAINS AT END SENT	EA	2	_____	_____

- Added Item 33 – BRIDGE APPROACH SLAB (MINOR)

⚠	32 LAMINATED NEOPRENE BEARING PAD	EA	3	_____	_____
	33 BRIDGE APPROACH SLAB (MINOR)	S.Y	116	_____	_____
			BRIDGE ITEMS SUBTOTAL	_____	_____

A new Bid Form has been provided.

**DOCUMENTS ATTACHED FOR REFERENCE**

- Revised Plan Sheets
- Updated Bid Form
- Minutes from Pre-Bid Meeting held April 28, 2026.

BY THE ORDER OF:



Mattheuw Prenger, P.E., County Engineer  
 Cole County Public Works  
 May 4, 2026

# Revised Plan Sheets

DESIGN DESIGNATION

AADT - 2019 = 30  
 AADT - 2039 = 51  
 DHV = 10%  
 T = 5%  
 V = 35 MPH

FUNCTIONAL CLASSIFICATION - RURAL LOCAL

NO NEW RIGHT OF WAY  
 TEMPORARY EASEMENT

CONVENTIONAL SYMBOLS

- IRON PIN SET (TYPICAL)
- GREAT RIVER 2001011476
- IRON PIN FOUND, AS NOTED
- ✕ CUT CROSS
- ▲ RIGHT OF WAY MARKER
- STONE
- △ CONTROL POINT
- ◆ PERMANENT BENCHMARK
- CONTOUR MAJOR
- - - CONTOUR MINOR
- DECIDUOUS TREE, SIZE AS NOTED
- CONIFER TREE, SIZE AS NOTED
- BUSH, SIZE AS NOTED
- ☆ LIGHT POLE
- ⊕ POWER POLE
- ⊕ ELECTRIC RISER
- ⊕ ELECTRIC BOX
- ⊕ ELECTRIC METER
- ⊕ GUY WIRE ANCHOR
- ⊕ PEDESTAL, AS NOTED
- ⊕ SANITARY SEWER CLEAN OUT
- ⊕ SEPTIC TANK
- ⊕ TELEPHONE RISER
- ⊕ GAS VALVE
- ⊕ GAS METER
- ⊕ WELL
- ⊕ WATER METER
- ⊕ WATER VALVE
- ⊕ FIRE HYDRANT
- ⊕ WATER HYDRANT
- ⊕ MAIL BOX
- ⊕ SIGN
- ⊕ POST
- ⊕ FLAG POLE
- ⊕ CABLE TV RISER
- SANITARY SEWER LINE
- FENCE CHAIN-LINK
- WIRE
- WOOD
- ELECTRIC LINE
- UNDERGROUND ELECTRIC LINE
- TELEPHONE LINE
- UNDERGROUND TELEPHONE LINE
- CABLE TV LINE
- GAS LINE
- WATER LINE
- GAS & WATER LINE
- FIBER OPTIC LINE
- TREE LINE

# CONSTRUCTION PLANS FOR STURBRIDGE DRIVE BRIDGE #30100012 OVER BRANCH OF GRAYS CREEK SECTION 5, TOWNSHIP 44 NORTH, RANGE 12 WEST BRO-R026(001)

## COLE COUNTY, MISSOURI

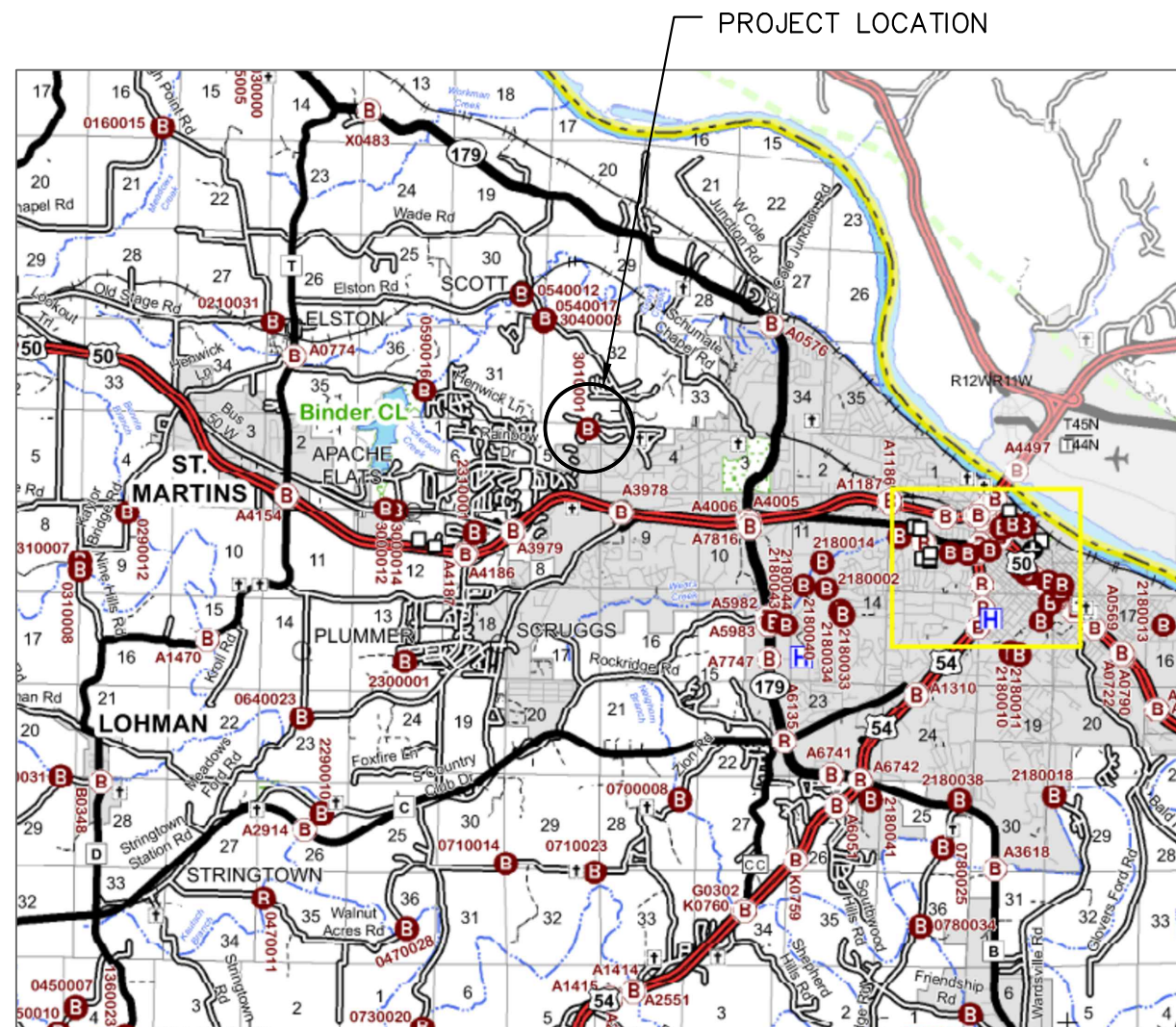

INDEX OF SHEETS

DESCRIPTION	SHEET NUMBER
TITLE SHEET.....	C1
QUANTITIES & TYPICAL SECTIONS.....	C2
PLAN & PROFILE.....	C3
GRADING & EROSION CONTROL.....	C4
CROSS SECTIONS.....	C5
TEMPORARY CROSSING.....	C6
TEMPORARY CROSSING PROFILE.....	C7
TRAFFIC MANAGEMENT PLAN.....	C8
TRAFFIC MANAGEMENT PLAN DETAILS.....	C9
BRIDGE PLAN & ELEVATION.....	S1
GENERAL NOTES & ESTIMATED QUANTITIES.....	S2
BENT 1.....	S3-S5
BENT 2.....	S6-S8
VERTICAL DRAIN.....	S9
17-INCH BOX BEAM.....	S10
PRESTRESSED PANSL.....	S11
CAMBER, SLAB HAUNCHING & ELEVATIONS.....	S12
SLAB.....	S13
THRIE BEAM RAIL.....	S14
BRIDGE APPROACH SLAB (MINOR).....	S15
BILL OF REINFORCING STEEL.....	S16
AS-BUILT PILE DATA.....	S17
BORING DATA.....	S18

Date	Revision/Issue	ADDENDUM #1
4.29.26		



BRO-R026(001)  
 COLE COUNTY, MISSOURI  
 TITLE SHEET

LENGTH OF PROJECT

BEGINNING OF PROJECT	STA 1+00.00
END OF PROJECT	STA 3+03.75
APPARENT LENGTH	203.75 FEET

SUBMITTED AND RECOMMENDED

*Matthew Penger*  
 COUNTY ENGINEER

5-2-26

4/29/2026  
 JOB 5197

C1

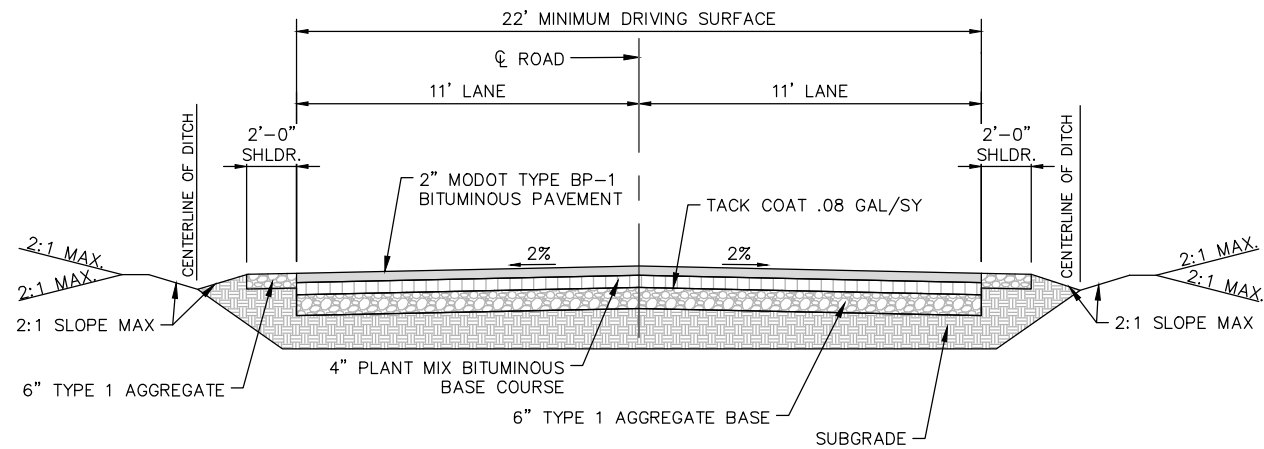

TYPICAL ASPHALT PAVING SECTION

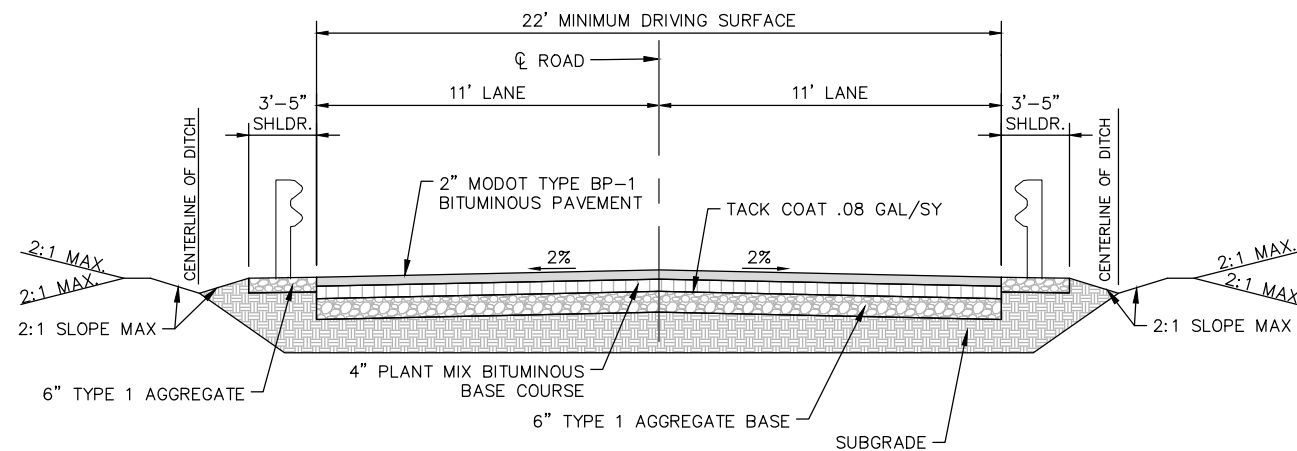

TYPICAL ASPHALT PAVING SECTION W/ GUARDRAIL

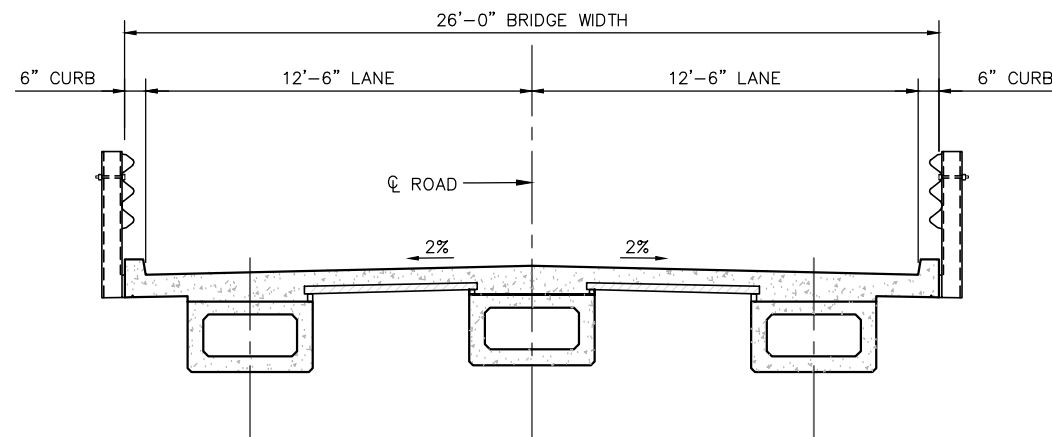

TYPICAL SECTION OF BRIDGE

ROADWAY QUANTITIES

ITEM	TOTAL	UNITS
CLEARING AND GRUBBING	0.6	ACRES
REMOVAL OF IMPROVEMENTS	1	LUMP SUM
UNCLASSIFIED EXCAVATION (ROADWAY)	67	CU. YARD
EMBANKMENT IN PLACE WITH COMPACTION	86	CU. YARD
TYPE 1 AGGREGATE FOR BASE (6 IN. THICK) (6 IN. THICK SHOULDERS)	388	SQ. YARD
BITUMINOUS PAVEMENT MIXTURE PG64-22, (BP-1)	31	TON
BITUMINOUS PAVEMENT MIXTURE PG64-22, (BASE)	62	TON
TACK COAT	14	GALLON
TYPE 2 ROCK BLANKET	94	CU. YARD
CONSTRUCTION SIGNS	50.5	SQ. FOOT
ASYMMETRICAL TRANSITION SECTION	4	EACH
TYPE A CRASHWORTHY END TERMINAL	4	EACH
TYPE III MOVEABLE BARRICADE W/LIGHTS	12	EACH
MOBILIZATION	1	LUMP SUM
CONTRACTOR FURNISHED SURVEYING AND STAKING	1	LUMP SUM
SEEDING	0.6	ACRE
SILT FENCE	215	LIN. FOOT
TYPE 1 AGGREGATE FOR TEMPORARY BYPASS (6 IN. THICK)	466	SQ. YARD
36" CMP FOR TEMPORARY BYPASS	96	LIN. FOOT

NOTE: TYPE 1 DITCH LINER, CRANE MATS AND ANY OTHER ITEMS OR WORK NECESSARY FOR THE TEMPORARY BYPASS SHALL BE CONSIDERED INCIDENTAL TO OTHER ITEMS FOR THE PROJECT.

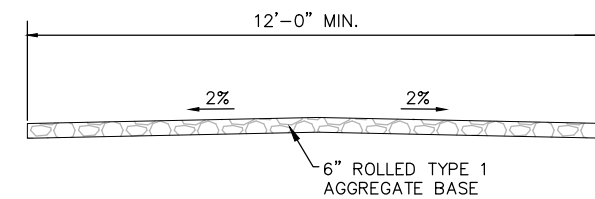

TEMPORARY CROSSING TYPICAL SECTION

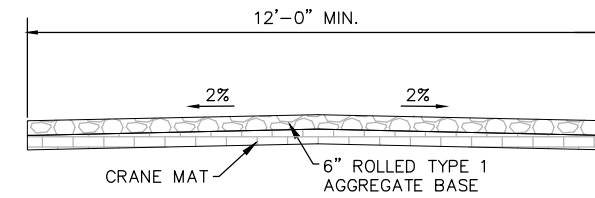

TEMPORARY CROSSING TYPICAL SECTION WITH CRANE MATS OVER GAS LINE

Survey Control Point Table

Point #	Northing	Easting	Elevation	Description
1	1006273.98	1708294.67	652.33	CP 1 60D
2	1006171.83	1708007.73	649.69	CP 2 60D
3	1006162.09	1707801.86	655.10	CP 3 60D

HORIZONTAL COORDINATES ARE BASED ON THE MISSOURI COORDINATE SYSTEM OF 1983, CENTRAL ZONE

BENCHMARK DATA

BM208: TOP OF CMP NORTH OF STURBRIDGE DRIVE AND WEST OF DEERFIELD PLACE

ELEVATION: 653.35'

Date	4.29.26
Revision/Issue	
ADDENDUM #1	

IF A SEAL IS PRESENT ON THIS SHEET IT HAS BEEN ELECTRONICALLY SEALED AND DATED.

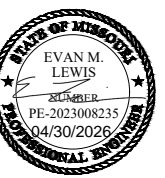

BRO-R026(001)  
 COLE COUNTY, MISSOURI  
 QUANTITIES & TYPICAL SECTIONS  
 4/29/2026  
 JOB 5197  
 C2

Z:\Shared\Projects\5197 - Cole County Starbridge Drive Bridge Replacement\Drawings\5197\_CIVIL.dwg PLOT DATE: 4/29/2026 1:11:26 PM LAST SAVE: 4/29/2026 1:06:17 PM

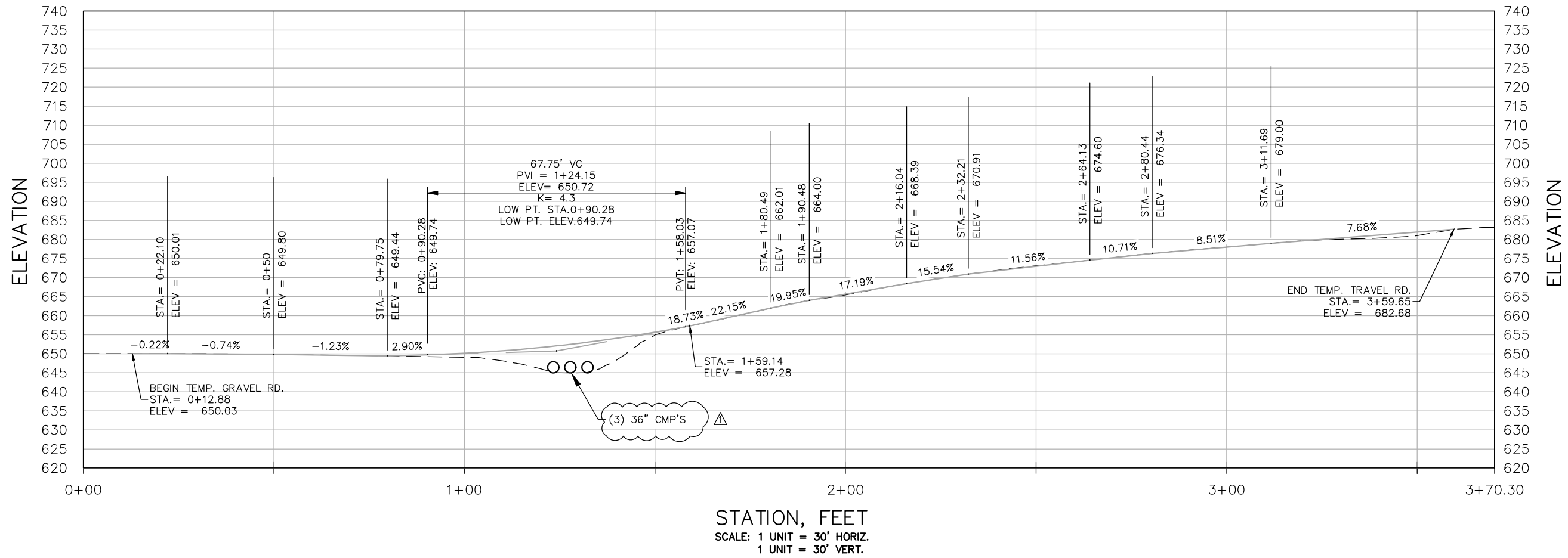

No.	ADDENDUM #1	Date	4.29.26

IF A SEAL IS PRESENT ON THIS SHEET IT HAS BEEN ELECTRONICALLY SEALED AND DATED.

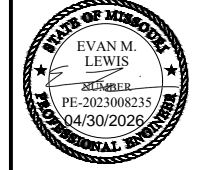

**BRO-R026(001)**  
 COLE COUNTY, MISSOURI  
**TEMPORARY CROSSING PROFILE**

4/29/2026  
 JOB 5197  
 C7

**General Notes:**

**Design Specifications:**  
2020 AASHTO LRFD Bridge Design Specifications (9th Ed.)

2011 AASHTO Guide Specifications for LRFD Seismic Bridge Design (2nd Ed.) and 2014 Interim Revisions (Seismic Details)  
Seismic Design Category = A  
Design earthquake response spectral acceleration coefficient at 1.0 second period,  $S_{D1} = 0.089$   
Acceleration Coefficient (effective peak ground acceleration coefficient),  $A_s = 0.053$

**Design Loading:**  
Vehicular = HL-93  
Future Wearing Surface = 35 lb/sf  
Earth = 120 lb/cf  
Equivalent Fluid Pressure = 45 lb/cf (Min.)  
Superstructure: Non-Composite for dead load.  
Composite for live load.

**Design Unit Stresses:**  
Class B Concrete (Substructure)  $f'_c = 3,000$  psi  
Class B-2 Concrete (Superstructure, except prestressed girders)  $f'_c = 4,000$  psi  
Reinforcing Steel (Grade 60)  $f_y = 60,000$  psi  
Structural Steel HP Pile (ASTM A709 Grade 50S)  $f_y = 50,000$  psi

For precast prestressed panel stresses, see Sheet S11.  
For prestressed girder stresses, see Sheets S10.

**Neoprene Pads:**  
Neoprene bearing pads shall be 60 durometer and shall be in accordance with Sec 716.

**Joint Filler:**  
All joint filler shall be in accordance with Sec 1057 for preformed sponge rubber expansion and partition joint filler, except as noted.

**Reinforcing Steel:**  
Minimum clearance to reinforcing steel shall be 1 1/2", unless otherwise shown.

Minimum clearance between galvanized piles and uncoated (plain) reinforcing steel including bar supports shall be 1 1/2". Nylon, PVC, or polyethylene spacers shall be used to maintain clearance. Nylon cable ties shall be used to bind the spacers to the reinforcement.

**Traffic Handling:**  
Structure to be closed during construction. Traffic to be maintained on other routes during construction. See roadway plans for traffic control.

**Miscellaneous:**  
"Sec" refers to sections in the Missouri Standard Specification of Highway Construction and supplemental specifications.

High strength bolts, nuts and washers will be sampled for quality assurance as specified in Sec 106.

Estimated Quantities				
Item		Substr.	Superstr.	Total
Class 1 Excavation	cu. yard	50		50
Removal of Bridges #3010001	lump sum			1
Galvanized Structural Steel Piles (12 in.)	linear foot	136		136
Pre-Boring for Piling	linear foot	120		120
Pile Point Reinforcement	each	8		8
<b>Class B Concrete (Substructure)</b>	<b>cu. yard</b>	<b>24.4</b>		<b>24.4</b>
Slab on Concrete Beam	sq. yard		129	129
Vertical Drains at End Bent	each		2	2
17 in., Prestressed Concrete Spread Box Beam	linear foot		129	129
Bridge Guardrail (Thrie Beam)	linear foot		100	100
6 in., Curb Barrier	linear foot		90	90
Laminated Neoprene Bearing Pad (Tapered)	each		3	3
Laminated Neoprene Bearing Pad	each		3	3
Bridge Approach Slab (Minor)	sq. yard		116	116

All concrete above the construction joint in the end bents is included in the Estimated Quantities for Slab on Concrete Beam.

All reinforcement in the end bents is included in the Estimated Quantities for Slab on Concrete Beam.

All reinforcement in the intermediate bent concrete diaphragms except reinforcement embedded in the beam cap are included in the Estimated Quantities for Slab on Concrete Beam.

All concrete above the intermediate beam cap is included in the Estimated Quantities for Slab on Concrete Beam.

Hydrologic Data	
Drainage Area	= 0.9 mi <sup>2</sup>
Design Flood Frequency	= 100 years
Design Flood Discharge	= 1,400 cfs
Design Flood (D.F.) Elevation	= 651.4 feet
Estimated Backwater	= -0.1 feet
Average Velocity Thru Opening	= 6.1 ft/s
Freeboard (50-year)	
Freeboard	= 0 feet
Roadway Overtopping	
Overtopping Flood Discharge	= 830 cfs
Overtopping Flood Frequency	= 10 years
Overtopping Flood Elevation	= 650.7 feet

Estimated Quantities for Slab on Concrete Beam		
Item		Total
Class B-2 Concrete	cu. yard	42.4
Reinforcing Steel (Epoxy Coated)	pound	9911

The table of Estimated Quantities for Slab on Concrete Beam represents the quantities used by the county in preparing the cost estimate for concrete slabs. The area of the concrete slab will be measured to the nearest square yard longitudinally from end of slab to end of slab and transversely from out to out of bridge slab (or with the horizontal dimensions as shown on the plan of slab). Payment for prestressed panels, conventional forms, all concrete and epoxy coated reinforcing steel will be considered completely covered by the contract unit price for the slab. Variations may be encountered in the Estimated Quantities but the variations cannot be used for an adjustment in the contract unit price.

Method of forming the slab shall be shown on the plans and in accordance with Sec 703. All hardware for forming the slab to be left in place as a permanent part of the structure shall be coated in accordance with ASTM A123 or ASTM B633 with a thickness Class SC 4 and a finish type I, II or III.

The Estimated Quantities for Slab on Concrete Beam are based on skewed precast prestressed end panels.

Class B-2 concrete quantity is based on minimum top flange thickness and minimum joint material thickness.

The prestressed panel quantities are not included in the table of Estimated Quantities for Slab on Concrete Beam.

Foundation Data					
Type	Design Data	Bent 1	Bent 2		
Load Bearing Pile	Pile Type & Size	HP 12x53	HP 12x53		
	Number	ea	4	4	
	Approximate Length Per Each	ft	17	17	
	Pile Point Reinforcement	ea	4	4	
	Pre-Boring for Piling	ft	15	15	
	Min. Galvanized Penetration (Elev.)	ft	Full Depth		
	Pile Driving Verification Method		DF	DF	
	Resistance Factor		0.4	0.4	
	Minimum Nominal Axial Compressive Resistance	kip	369	368	

DF = FHWA-modified Gates Dynamic Pile Formula

$$\text{Minimum Nominal Axial Compressive Resistance} = \frac{\text{Maximum Factored Loads}}{\text{Resistance Factor}}$$

Prebore for piles at Bents 1, and 2 to elevations 631.75, and 630.91 respectively. A minimum of 5 feet of prebore into rock shall also be obtained.

All piles shall be galvanized down to the minimum galvanized penetration (elevation).

Pile point reinforcement need not be galvanized. Shop drawings will not be required for pile point reinforcement.

Piles are anticipated to be driven to refusal on rock. Review all borings for depth of rock and restrict driving as appropriate to comply with hard rock driving criteria in accordance with Sec 702.

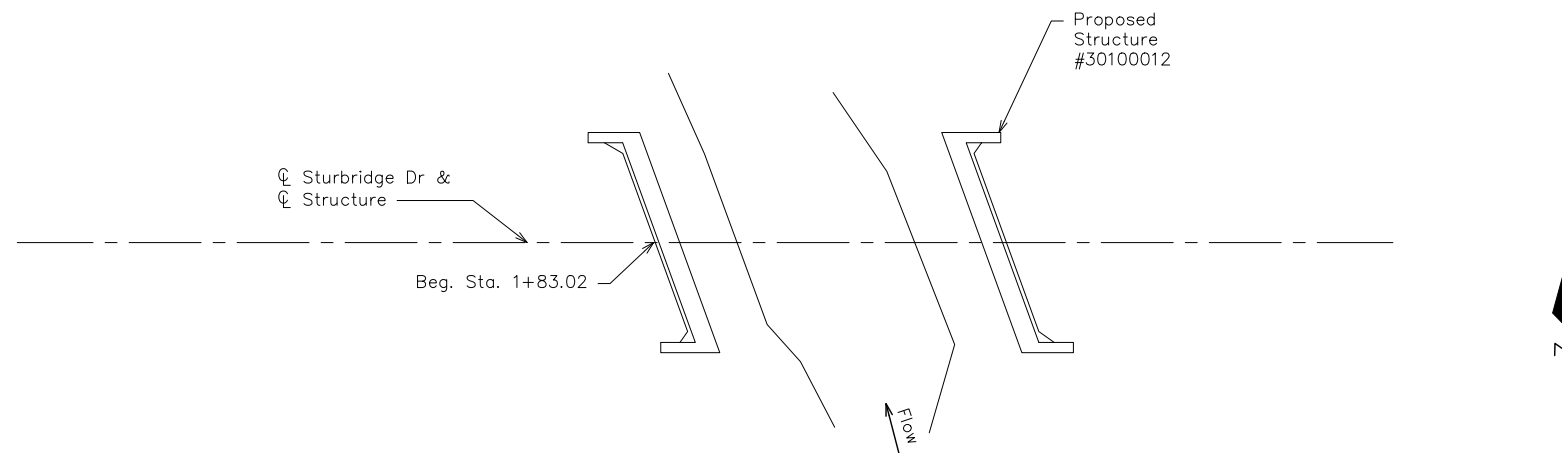

LOCATION SKETCH

Date	4.29.26
Revision/Issue	ADDENDUM #1
No.	1 2 3 4 5
IF A SEAL IS PRESENT ON THIS SHEET IT HAS BEEN ELECTRONICALLY SEALED AND DATED.	
Missouri State Certificate of Authority Numbers: 0101476, 0101477, 0101478, 0101479, 0101480, 0101481, 0101482, 0101483, 0101484, 0101485, 0101486, 0101487, 0101488, 0101489, 0101490, 0101491, 0101492, 0101493, 0101494, 0101495, 0101496, 0101497, 0101498, 0101499, 0101500, 0101501, 0101502, 0101503, 0101504, 0101505, 0101506, 0101507, 0101508, 0101509, 0101510, 0101511, 0101512, 0101513, 0101514, 0101515, 0101516, 0101517, 0101518, 0101519, 0101520, 0101521, 0101522, 0101523, 0101524, 0101525, 0101526, 0101527, 0101528, 0101529, 0101530, 0101531, 0101532, 0101533, 0101534, 0101535, 0101536, 0101537, 0101538, 0101539, 0101540, 0101541, 0101542, 0101543, 0101544, 0101545, 0101546, 0101547, 0101548, 0101549, 0101550, 0101551, 0101552, 0101553, 0101554, 0101555, 0101556, 0101557, 0101558, 0101559, 0101560, 0101561, 0101562, 0101563, 0101564, 0101565, 0101566, 0101567, 0101568, 0101569, 0101570, 0101571, 0101572, 0101573, 0101574, 0101575, 0101576, 0101577, 0101578, 0101579, 0101580, 0101581, 0101582, 0101583, 0101584, 0101585, 0101586, 0101587, 0101588, 0101589, 0101590, 0101591, 0101592, 0101593, 0101594, 0101595, 0101596, 0101597, 0101598, 0101599, 0101600, 0101601, 0101602, 0101603, 0101604, 0101605, 0101606, 0101607, 0101608, 0101609, 0101610, 0101611, 0101612, 0101613, 0101614, 0101615, 0101616, 0101617, 0101618, 0101619, 0101620, 0101621, 0101622, 0101623, 0101624, 0101625, 0101626, 0101627, 0101628, 0101629, 0101630, 0101631, 0101632, 0101633, 0101634, 0101635, 0101636, 0101637, 0101638, 0101639, 0101640, 0101641, 0101642, 0101643, 0101644, 0101645, 0101646, 0101647, 0101648, 0101649, 0101650, 0101651, 0101652, 0101653, 0101654, 0101655, 0101656, 0101657, 0101658, 0101659, 0101660, 0101661, 0101662, 0101663, 0101664, 0101665, 0101666, 0101667, 0101668, 0101669, 0101670, 0101671, 0101672, 0101673, 0101674, 0101675, 0101676, 0101677, 0101678, 0101679, 0101680, 0101681, 0101682, 0101683, 0101684, 0101685, 0101686, 0101687, 0101688, 0101689, 0101690, 0101691, 0101692, 0101693, 0101694, 0101695, 0101696, 0101697, 0101698, 0101699, 0101700, 0101701, 0101702, 0101703, 0101704, 0101705, 0101706, 0101707, 0101708, 0101709, 0101710, 0101711, 0101712, 0101713, 0101714, 0101715, 0101716, 0101717, 0101718, 0101719, 0101720, 0101721, 0101722, 0101723, 0101724, 0101725, 0101726, 0101727, 0101728, 0101729, 0101730, 0101731, 0101732, 0101733, 0101734, 0101735, 0101736, 0101737, 0101738, 0101739, 0101740, 0101741, 0101742, 0101743, 0101744, 0101745, 0101746, 0101747, 0101748, 0101749, 0101750, 0101751, 0101752, 0101753, 0101754, 0101755, 0101756, 0101757, 0101758, 0101759, 0101760, 0101761, 0101762, 0101763, 0101764, 0101765, 0101766, 0101767, 0101768, 0101769, 0101770, 0101771, 0101772, 0101773, 0101774, 0101775, 0101776, 0101777, 0101778, 0101779, 0101780, 0101781, 0101782, 0101783, 0101784, 0101785, 0101786, 0101787, 0101788, 0101789, 0101790, 0101791, 0101792, 0101793, 0101794, 0101795, 0101796, 0101797, 0101798, 0101799, 0101800, 0101801, 0101802, 0101803, 0101804, 0101805, 0101806, 0101807, 0101808, 0101809, 0101810, 0101811, 0101812, 0101813, 0101814, 0101815, 0101816, 0101817, 0101818, 0101819, 0101820, 0101821, 0101822, 0101823, 0101824, 0101825, 0101826, 0101827, 0101828, 0101829, 0101830, 0101831, 0101832, 0101833, 0101834, 0101835, 0101836, 0101837, 0101838, 0101839, 0101840, 0101841, 0101842, 0101843, 0101844, 0101845, 0101846, 0101847, 0101848, 0101849, 0101850, 0101851, 0101852, 0101853, 0101854, 0101855, 0101856, 0101857, 0101858, 0101859, 0101860, 0101861, 0101862, 0101863, 0101864, 0101865, 0101866, 0101867, 0101868, 0101869, 0101870, 0101871, 0101872, 0101873, 0101874, 0101875, 0101876, 0101877, 0101878, 0101879, 0101880, 0101881, 0101882, 0101883, 0101884, 0101885, 0101886, 0101887, 0101888, 0101889, 0101890, 0101891, 0101892, 0101893, 0101894, 0101895, 0101896, 0101897, 0101898, 0101899, 0101900, 0101901, 0101902, 0101903, 0101904, 0101905, 0101906, 0101907, 0101908, 0101909, 0101910, 0101911, 0101912, 0101913, 0101914, 0101915, 0101916, 0101917, 0101918, 0101919, 0101920, 0101921, 0101922, 0101923, 0101924, 0101925, 0101926, 0101927, 0101928, 0101929, 0101930, 0101931, 0101932, 0101933, 0101934, 0101935, 0101936, 0101937, 0101938, 0101939, 0101940, 0101941, 0101942, 0101943, 0101944, 0101945, 0101946, 0101947, 0101948, 0101949, 0101950, 0101951, 0101952, 0101953, 0101954, 0101955, 0101956, 0101957, 0101958, 0101959, 0101960, 0101961, 0101962, 0101963, 0101964, 0101965, 0101966, 0101967, 0101968, 0101969, 0101970, 0101971, 0101972, 0101973, 0101974, 0101975, 0101976, 0101977, 0101978, 0101979, 0101980, 0101981, 0101982, 0101983, 0101984, 0101985, 0101986, 0101987, 0101988, 0101989, 0101990, 0101991, 0101992, 0101993, 0101994, 0101995, 0101996, 0101997, 0101998, 0101999, 0102000, 0102001, 0102002, 0102003, 0102004, 0102005, 0102006, 0102007, 0102008, 0102009, 0102010, 0102011, 0102012, 0102013, 0102014, 0102015, 0102016, 0102017, 0102018, 0102019, 0102020, 0102021, 0102022, 0102023, 0102024, 0102025, 0102026, 0102027, 0102028, 0102029, 0102030, 0102031, 0102032, 0102033, 0102034, 0102035, 0102036, 0102037, 0102038, 0102039, 0102040, 0102041, 0102042, 0102043, 0102044, 0102045, 0102046, 0102047, 0102048, 0102049, 0102050, 0102051, 0102052, 0102053, 0102054, 0102055, 0102056, 0102057, 0102058, 0102059, 0102060, 0102061, 0102062, 0102063, 0102064, 0102065, 0102066, 0102067, 0102068, 0102069, 0102070, 0102071, 0102072, 0102073, 0102074, 0102075, 0102076, 0102077, 0102078, 0102079, 0102080, 0102081, 0102082, 0102083, 0102084, 0102085, 0102086, 0102087, 0102088, 0102089, 0102090, 0102091, 0102092, 0102093, 0102094, 0102095, 0102096, 0102097, 0102098, 0102099, 0102100, 0102101, 0102102, 0102103, 0102104, 0102105, 0102106, 0102107, 0102108, 0102109, 0102110, 0102111, 0102112, 0102113, 0102114, 0102115, 0102116, 0102117, 0102118, 0102119, 0102120, 0102121, 0102122, 0102123, 0102124, 0102125, 0102126, 0102127, 0102128, 0102129, 0102130, 0102131, 0102132, 0102133, 0102134, 0102135, 0102136, 0102137, 0102138, 0102139, 0102140, 0102141, 0102142, 0102143, 0102144, 0102145, 0102146, 0102147, 0102148, 0102149, 0102150, 0102151, 0102152, 0102153, 0102154, 0102155, 0102156, 0102157, 0102158, 0102159, 0102160, 0102161, 0102162, 0102163, 0102164, 0102165, 0102166, 0102167, 0102168, 0102169, 0102170, 0102171, 0102172, 0102173, 0102174, 0102175, 0102176, 0102177, 0102178, 0102179, 0102180, 0102181, 0102182, 0102183, 0102184, 0102185, 0102186, 0102187, 0102188, 0102189, 0102190, 0102191, 0102192, 0102193, 0102194, 0102195, 0102196, 0102197, 0102198, 0102199, 0102200, 0102201, 0102202, 0102203, 0102204, 0102205, 0102206, 0102207, 0102208, 0102209, 0102210, 0102211, 0102212, 0102213, 0102214, 0102215, 0102216, 0102217, 0102218, 0102219, 0102220, 0102221, 0102222, 0102223, 0102224, 0102225, 0102226, 0102227, 0102228, 0102229, 0102230, 0102231, 0102232, 0102233, 0102234, 0102235, 0102236, 0102237, 0102238, 0102239, 0102240, 0102241, 0102242, 0102243, 0102244, 0102245, 0102246, 0102247, 0102248, 0102249, 0102250, 0102251, 0102252, 0102253, 0102254, 0102255, 0102256, 0102257, 0102258, 0102259, 0102260, 0102261, 0102262, 0102263, 0102264, 0102265, 0102266, 0102267, 0102268, 0102269, 0102270, 0102271, 0102272, 0102273, 0102274, 0102275, 0102276, 0102277, 0102278, 0102279, 0102280, 0102281, 0102282, 0102283, 0102284, 0102285, 0102286, 0102287, 0102288, 0102289, 0102290, 0102291, 0102292, 0102293, 0102294, 0102295, 0102296, 0102297, 0102298, 0102299, 0102300, 0102301, 0102302, 0102303, 0102304, 0102305, 0102306, 0102307, 0102308, 0102309, 0102310, 0102311, 0102312, 0102313, 0102314, 0102315, 0102316, 0102317, 0102318, 0102319, 0102320, 0102321, 0102322, 0102323, 0102324, 0102325, 0102326, 0102327, 0102328, 0102329, 0102330, 0102331, 0102332, 0102333, 0102334, 0102335, 0102336, 0102337, 0102338, 0102339, 0102340, 0102341, 0102342, 0102343, 0102344, 0102345, 0102346, 0102347, 0102348, 0102349, 0102350, 0102351, 0102352, 0102353, 0102354, 01	

# Updated Bid Form



Cole County Commission  
 GRE 5197  
 BRO-R026(001)

**BID FORM**

LINE	DESCRIPTION	UNITS	QUANTITY	UNIT PRICE	AMOUNT
<b>ROADWAY ITEMS</b>					
1	CLEARING AND GRUBBING	AC.	0.6	_____	_____
2	REMOVAL OF IMPROVEMENTS	LS	1	_____	_____
3	UNCLASSIFIED EXCAVATION (ROADWAY)	CY	67	_____	_____
4	EMBANKMENT IN PLACE WITH COMPACTION	CY	86	_____	_____
5	TYPE 1 AGGREGATE FOR BASE (6 IN. THICK) (6 IN. THICK SHOULDERS)	SY	388	_____	_____
6	BITUMINOUS PAVEMENT MIXTURE PG64-22, (BP-1)	TON	31	_____	_____
7	BITUMINOUS PAVEMENT MIXTURE PG64-22, (BASE)	TON	62	_____	_____
8	TACK COAT	GAL	14	_____	_____
9	TYPE 2 ROCK BLANKET	CY	94	_____	_____
10	CONSTRUCTION SIGNS	SF	50.5	_____	_____
11	ASYMMETRICAL TRANSITION SECTION	EA	4	_____	_____
12	TYPE A CRASHWORTHY END TERMINAL	EA	4	_____	_____
13	TYPE III MOVEABLE BARRICADE W/LIGHTS	EA	12	_____	_____
14	MOBILIZATION	LS	1	_____	_____
15	CONTRACTOR FURNISHED SURVEY AND STAKING	LS	1	_____	_____
16	SEEDING	AC.	0.6	_____	_____
17	SILT FENCE	LF	215	_____	_____
18	TYPE 1 AGGREGATE FOR TEMPORARY BYPASS (6 IN. THICK)	SY	466	_____	_____
19	36" CMP FOR TEMPORARY BYPASS	LF	96	_____	_____
				<b>ROADWAY ITEMS SUBTOTAL</b>	_____
<b>BRIDGE ITEMS</b>					
20	CLASS 1 EXCAVATION	CY	50	_____	_____
21	REMOVAL OF BRIDGES (3010001)	LS	1	_____	_____
22	GALVANIZED STRUCTURAL STEEL PILES (12 IN.)	LF	136	_____	_____
23	PRE-BORING FOR PILING	LF	120	_____	_____
24	PILE POINT REINFORCEMENT	EA	8	_____	_____
25	CLASS B CONCRETE (SUBSTRUCTURE)	CY	24.4	_____	_____
26	SLAB ON CONCRETE BEAM	SY	129	_____	_____
27	VERTICAL DRAINS AT END BENT	EA	2	_____	_____
28	17 IN., PRESTRESSED CONCRETE SPREAD BOX BEAM	LF	129	_____	_____
29	BRIDGE GUARDRAIL (THRIE BEAM)	LF	100	_____	_____
30	6 IN., CURB BARRIER	LF	90	_____	_____
31	LAMINATED NEOPRENE BEARING PAD (TAPERED)	EA	3	_____	_____
32	LAMINATED NEOPRENE BEARING PAD	EA	3	_____	_____
33	BRIDGE APPROACH SLAB (MINOR)	S.Y	116	_____	_____
				<b>BRIDGE ITEMS SUBTOTAL</b>	_____
				<b>TOTAL CONTRACT</b>	=====



25 CLASS B CONCRETE (SUBSTRUCTURE)  
 26 SLAB ON CONCRETE BEAM  
 27 VERTICAL DRAINS AT END BENT



32 LAMINATED NEOPRENE BEARING PAD  
 33 BRIDGE APPROACH SLAB (MINOR)

Minutes from Pre-Bid Meeting held  
April 28, 2026

**Cole County  
Sturbridge Drive Bridge Replacement**

**Federal Project No. BRO-R026(001)  
Cole County Project No. 2023-803-1**

**Pre-Bid Meeting  
April 28, 2026**

The meeting was held at Cole County Fire Protection District beginning at 9:00 AM. Those attending the meeting are listed below:

<u>Name</u>	<u>Representing</u>	<u>Phone</u>
Mattheuw Prenger	CCPW	573-636-3614
Wayne Brenneke	Brenneke Construction LLC	573-619-4275
Matt Fazio	GRE	314-602-0038
Don Rhea	Don Schieders Exc	573-893-2251
Owen Kloeppel	CCPW	573-636-3614
Spencer Coonce	CCPW	573-636-3614
Jason Minor	CCPW	573-636-3614

**GENERAL BIDDING INFORMATION**

1. Sealed proposals on the forms prepared by Cole County will be received by the County Commission, Cole County, Missouri, at the Courthouse Annex, Room 200, 311 East High Street, Jefferson City, Missouri, until **9:00 a.m., on Thursday, May 7, 2026**, for the **Sturbridge Drive Bridge Replacement**. The proposals will be publicly opened and read aloud thereafter. Bids received after the specified time for opening will be returned unopened.
2. Prior to the time and date designated for the receipt of bids, bids may be modified or withdrawn only by notice to the County Commission at the place and prior to the time designated for receipt of bids. No bids shall be withdrawn for a period of 90 calendar days after the scheduled closing time for receipt of bids.
3. Plans and specifications may be viewed and downloaded online in the bids section at [www.colecounty.org](http://www.colecounty.org). A hard copy of the plans and specifications will not be provided unless requested in advance.
4. **All Contractors wishing to bid on this project shall submit the plan holder contact information form found in the bid manual to [ccpwprojects@colecounty.org](mailto:ccpwprojects@colecounty.org) prior to the bid opening.** A bid received from a Contractor that has not submitted this form will not be opened and therefore not read. It will be returned to the Contractor.
5. All bidders must be on MoDOT's Qualified Contractor List per Section 102.2 from the current version of the Missouri Standard Specifications for Highway Construction, including all revisions. The contractor questionnaire must be on file 7 days prior to bid opening.
6. A bid bond will be required in the amount of 5% of the bid. No personal checks will be accepted.

**Sturbridge Drive Bridge Replacement**  
**Pre-Bid Meeting**  
**Page 2**

7. A one-year Performance and Payment Bond is required.
8. Questions regarding the plans and specifications will be taken up to 24 hours prior to the date and time of the bid opening. This will allow the County to get the information out to all of the bidders. General questions regarding the bidding process will be answered up to the time of the opening.
9. Addenda may be issued on this project at any time up to 24 hours prior to the bid date and time. It shall be the responsibility of the contractor to verify if any addenda have been issued prior to submitting their bid. The County assumes no liability if a contractor fails to incorporate addenda into their bid. **Addenda will be posted on the Cole County website and will NOT be faxed.**
10. Prevailing wage rates are required on this project. The wage rates for Cole County and the Federal Wage Rates are included in the specifications.
11. The right is reserved by Cole County to reject any and all bids and to waive informalities therein.
12. Bids shall be submitted on the Proposal Form furnished by the County. All blank spaces shall be filled in on the forms by typewriter or by handwriting in ink. The bidder shall make no other stipulations in the bid form or qualify his bid in any manner. The bids shall be submitted in an opaque sealed envelope marked "**Sturbridge Drive Bridge Replacement – Project No. 2023-803-1, Construction Bid**" and shall be clearly marked with the bid date, bid time and bidder's name and address.
13. The County will accept computer generated spreadsheets for the unit price items to help alleviate problems with computation mistakes. If a spreadsheet is used, it shall be in the same format as the one included in the proposal. The sheet shall be inserted in front of the one included in the proposal form.
14. The Notice to Proceed date is anticipated to be June 1, 2026. If awarded the contract, the Contractor agrees to complete the work within **90 Calendar Days** after starting work.
15. **Liquidated damages** shall be based on the original contract amount and will be assessed per calendar day for every day that the Contractor fails to complete the work as provided in the contract documents.
16. Simultaneously with the delivery of the executed contract, the Contractor shall furnish a surety bond in the amount of 100% of the total contract sum, as security for both faithful performance of the contract and for the payment of all persons performing labor on the project under this contract as specified in the contract documents.
17. Do NOT include federal excise tax or sales and use taxes in the bid prices. This project will be a SALES TAX EXEPMT project. A copy of the federal tax exemption certificate will be furnished.

### **GENERAL PROJECT INFORMATION**

1. The Contractor is highly advised to visit the project location to observe existing site conditions.
2. The Contractor shall provide a work schedule and traffic control plan prior to beginning work.
3. OSHA safety training requirements apply. The Contractor shall provide documentation that each employee has completed the training program and each employee that has not must do so within 60 days of beginning work on the project.
4. Excessive unemployment law is in effect.
5. Pipe bid items are for furnishing and installing. The County will not furnish the pipe.
6. The County will be providing the inspection for the construction.
7. The Contractor will be required to use extreme care to not disturb the property corner pins designated as “not to be disturbed”. If they are disturbed, the County will require them to be replaced at no expense to the County.
8. The project is to be constructed to the lines and grades as shown on the plans and specifications. All of the excavations are unclassified and it will be the Contractor's responsibility to ensure the grades are obtained.
9. **Change Orders** – If there is any item that the Contractor thinks additional pay is warranted, a change order request will have to be submitted and approved by the Director or County Engineer prior to commencing any of the additional work. **This includes an overrun on quantities.** Any extra work done without approval WILL NOT be paid unless you have a really good reason.

### **UTILITIES**

All utility companies that are in the area are listed on the plans

### **TECHNICAL SPECIFICATIONS AND STANDARD PLANS**

The Technical Specifications for this project shall consist of the currently effective version of:

- Missouri Standard Specifications for Highway Construction (MSSHC), Sections 201-1092
- Missouri Standard Plans for Highway Construction (MSPHC)
- City of Jefferson Technical Specifications
- City of Jefferson Standard Drawings

except as modified or contradicted by the County's Contract, Job Special Provisions, General Provisions and Plans.

### **JOB SPECIAL PROVISIONS**

1. The provisions of this section take precedence over any other provisions in the specifications. Please read this section as project specific requirements are detailed.

**Sturbridge Drive Bridge Replacement  
Pre-Bid Meeting  
Page 4**

2. 27. TRAFFIC CONTROL PROVISIONS – All work shall be in accordance with applicable portions of Division 100 and Division 600 of the Standard Specifications.
3. 40. BLASTING – No blasting will be permitted for this project.
4. 63. TOPSOIL IN AREAS TO BE SEEDED OR SODDED – The top six (6) inches of all areas of the project to be vegetated shall be free of rocks, stones and clods prior to seeding. This may require the Contractor to utilize a mechanical rock rake, hand picking of stones, and/or placement of six (6) inches of clean topsoil in those areas to be vegetated.

**PLANS**

**MISCELLANEOUS INFORMATION**

**QUESTIONS AND ANSWERS**

Received at pre-bid meeting, by telephone, e-mail, etc. prior to issuing Addendum No. 1

- Q1.** Is the quantity of CMP for temporary bypass for 1 pipe or the total quantity?  
**A1.** The quantity should be for total pipe length. See Addendum 1 for an updated quantity.
- Q2.** What is the length of the crane pads needed for the temporary bypass?  
**A2.** The crane pads will need to be used anywhere the temporary bypass crosses the gas line.
- Q3.** Can there be a concrete alternate for the asphalt? Or can we use asphalt for the bridge approach slab?  
**A3.** No. The pavement leading up to the bridge on both sides will be asphalt. The bridge approach slabs will stay concrete as shown in the plans.
- Q4.** Do we have to use 3-36" CMP for the temporary bypass? I would like to use 1-36" and 1-72" pipe.  
**A4.** The final configuration needs to be equivalent in opening as 3-36" pipe.