

From: [Debra M. Beckwith](#)
To: [BROffice](#)
Subject: Bridge Advertisement (DSI 20-037) Slab Drain on steel Std Dwg note
Date: Wednesday, September 23, 2020 3:08:56 PM
Attachments: [image001.png](#)
[image002.png](#)

The [EPG](#) & [Bridge Std. Drawings](#) have been updated as described below:

Implementation Statement: Applies to jobs not thru Review

Revision Date	Items Revised	Description of Change
Sept. 2020	EPG: 751.50	Added note H7.8.2 in EPG and on bridge std dwgs requiring epoxy-mastic primer on galvanized drain support brackets when attached to weathering steel girders/beams. (H7.8.2) Use note when attaching to weathering steel girders and beams. The galvanized surfaces of drain support brackets shall be prepared according to the coating manufacturer's recommendation and field coated with a gray epoxy-mastic primer (non-aluminum) within a distance of 6 inches from the point of connection to the weathering steel structure.
	Bridge Standard Drawings: S_DRA03 , S_DRA10	
	MicroStation Cells: NA	
	Std. Specifications: NA	
	Standard Plans: NA	

Screen shots of S_DRA03 (S_DRA10 similar except for guidance note number):

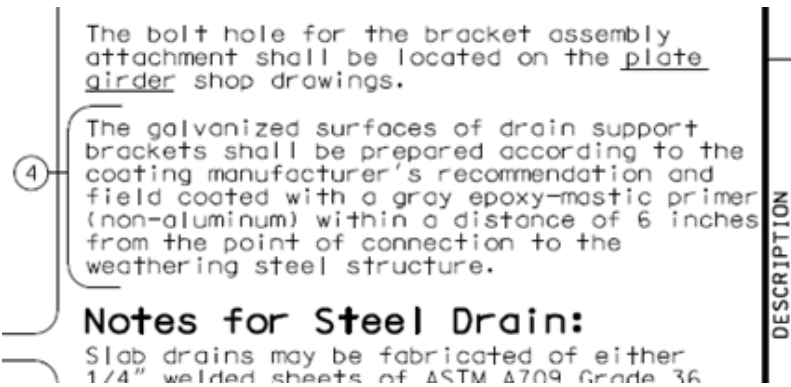

Guidance note:

④ Use with weathering steel. Delete for painted or galvanized steel.

Follow links above for more information, or to view more details about this (or any) revision, use the [Revision Index Database](#).

Instructions:

1. Select the Revision Index Database.
2. Select "Read Only" and Click "O.K."

3. Under Tables (left-hand side) double-click on Table1.
4. Scroll down to the bottom of the list to find the latest Revision.
5. Click on the link under the Effective Date to open the storage location for the Completed Revision.

Debbie M. Beckwith

Structural Specialist
Development Section
Bridge Division
MoDOT
(573)522-8718