



J6I3290
BRIDGE REHABILITATION
I-55 OVER MERAMEC RIVER
2026-2027



STAGE 1

LEGEND

- WORK AREA
- CROSSOVER / LANE SHIFT
- TRAFFIC DIRECTION
- TEMPORARY / PERMANENT CONCRETE BARRIER
- EXISTING BRIDGE / ROADWAY
- CLOSED LANE

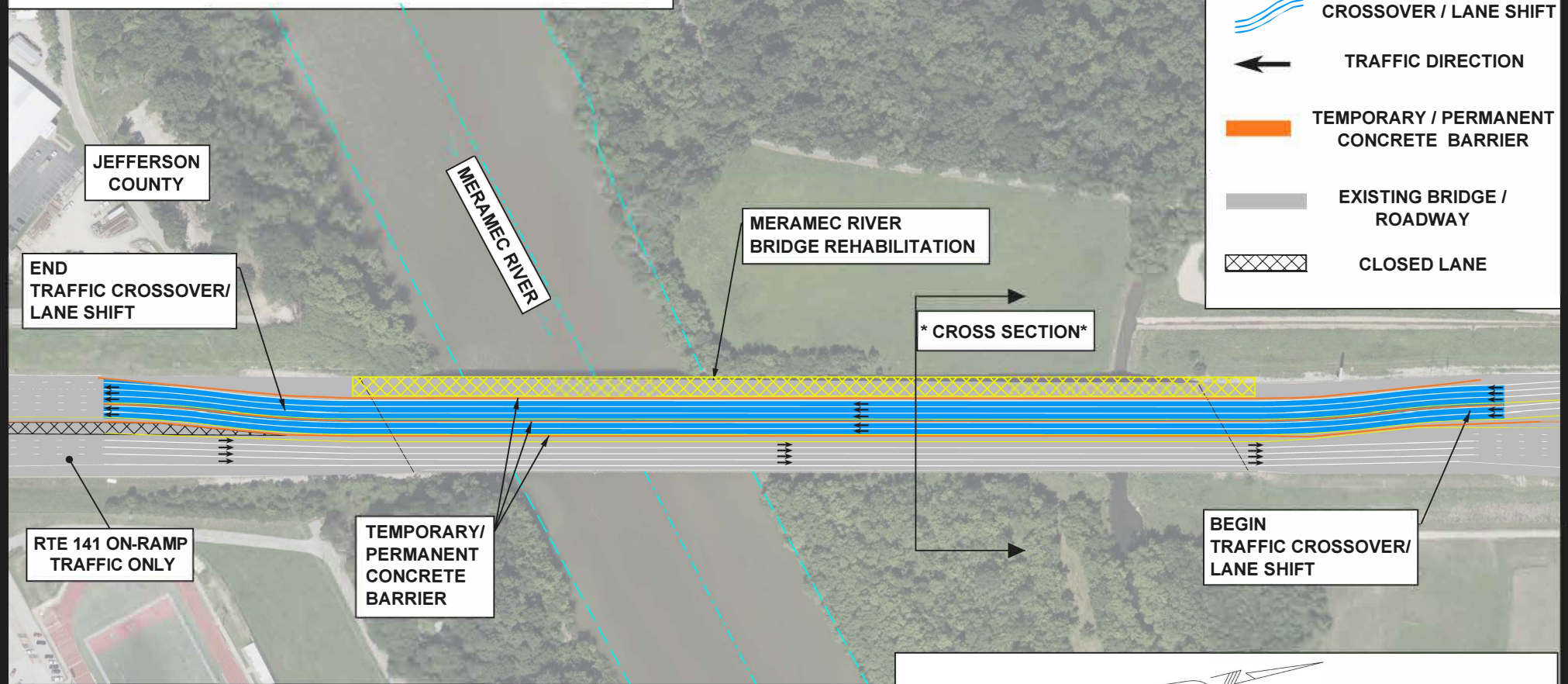

STAGE 1

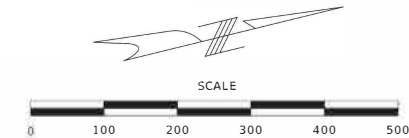
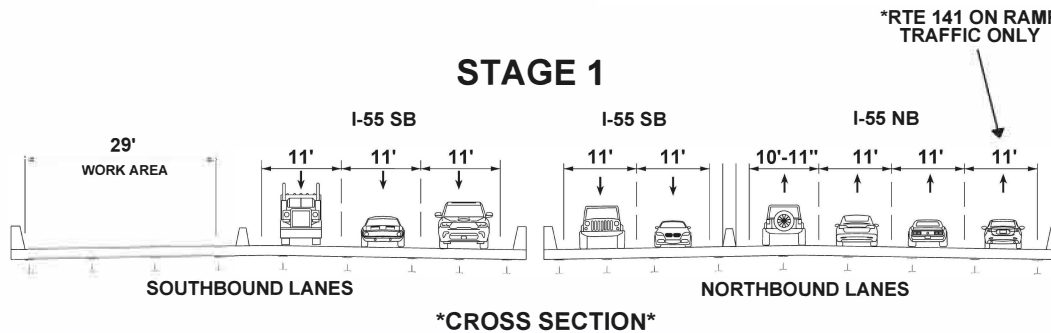

STAGE 1 - DESCRIPTION OF WORK

DURING THE WEST PORTION OF THE MERAMEC RIVER BRIDGE CLOSURE:

- THREE (3) SOUTHBOUND LANES WILL REMAIN ON THE WESTERN SECTION OF THE BRIDGE
- AN ADDITIONAL TWO (2) SOUTHBOUND LANES WILL CROSS OVER ONTO THE NORTHBOUND MERAMEC RIVER BRIDGE
- FOUR (4) NORTHBOUND LANES WILL REMAIN OPEN ON THE BRIDGE