

BIDDING AND CONTRACT DOCUMENTS
ADDENDUM NUMBER ONE
STATE PROJECT NO. 25-054A-1

DATE: April 18, 2025

WASHINGTON REGIONAL AIRPORT

CRAWFORD, MURPHY, TILLY, INC.
ONE MEMORIAL DRIVE, SUITE 500
SAINT LOUIS, MISSOURI 63102

TO: ALL PLANHOLDERS AND POTENTIAL BIDDERS

SUBJECT: ADDENDUM NUMBER ONE TO THE BIDDING DOCUMENTS FOR:
BASE BID: EXTEND RUNWAY 33
ADDITIVE ALTERNATE: EXTEND TAXIWAY A

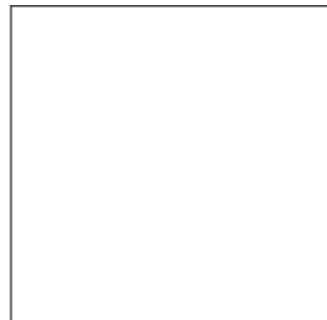

This addendum forms a part of the bidding and contract documents and modifies the original bidding documents dated April 1, 2025. This addendum must be signed on the last page and included with the submitted Bid Package. An acknowledgement sheet is also attached. This must be signed and returned to Crawford, Murphy & Tilly, Inc via fax or e-mail by **April 22, 2025**. FAILURE TO NOT RECOGNIZE THE ADDENDUM ON THE BID FORM MAY SUBJECT THE BIDDER TO DISQUALIFICATION.

The Contract Documents are revised as follows:

PROJECT MANUAL

PART D – FEDERAL AND STATE WAGE RATES

DELETE: Federal Wage Rates

REPLACE WITH: Federal Wage Rates attached to this addendum.

ITEM C-102 Temporary Air and Water Pollution, Soil Erosion, and Siltation Control, Section 102-2.6, MATERIALS, Rip Rap.

ADD – “Rip Rap shall be 18-inches in thickness.”

ITEM C-102 Temporary Air and Water Pollution, Soil Erosion, and Siltation Control, Section 102-4.1 (c.), METHOD OF MEASUREMENT.

ADD – “Rip Rap shall be 18-inches in thickness.”

ITEM P-208 AGGREGATE BASE COURSE, Section 208-2.1, MATERIALS, Aggregate base.

ADD – “Item P-208-5.2, 6” Aggregate for Haul Route shall be used for the proposed haul route and Storage and Staging Area as shown on the plans. The material used shall be at the contractor’s discretion and be able to withstand hauling and storage operations throughout the project. No additional payments will be made for fixing or repairing areas that have been damaged throughout the project because of contractor operations. All aggregate associated with this pay item shall be removed at the end of the project.”

ITEM P-208 AGGREGATE BASE COURSE, Section 208-2.2, MATERIALS, Gradation requirements.

ADD – “There are no gradation requirements for Item P-208-5.2, 6” Aggregate for Haul Route. The material used shall be at the contractor’s discretion and be able to withstand hauling and storage

operations throughout the project. No additional payments will be made for fixing or repairing areas that have been damaged throughout the project because of contractor operations."

ITEM P-208 AGGREGATE BASE COURSE, Section 208-2.3, MATERIALS, Sampling and testing.

ADD – "There are no sampling and testing requirements for Item P-208-5.2, 6" Aggregate for Haul Route. The material used shall be at the contractor's discretion and be able to withstand hauling and storage operations throughout the project. No additional payments will be made for fixing or repairing areas that have been damaged throughout the project because of contractor operations."

ITEM P-208 AGGREGATE BASE COURSE, Section 208-2.2, CONSTRUCTION METHODS.

ADD – "Item P-208-5.2, 6" Aggregate for Haul Route shall be used for the proposed haul route and Storage and Staging Area as shown on the plans. The material used shall be at the contractor's discretion and be able to withstand hauling and storage operations throughout the project. No additional payments will be made for fixing or repairing areas that have been damaged throughout the project because of contractor operations. All aggregate associated with this pay item shall be removed at the end of the project."

ITEM P-208 AGGREGATE BASE COURSE, Section 208-5.1, BASIS OF PAYMENT.

ADD – "Payment for Item P-208-5.2, 6" Aggregate for Haul Route shall also include removal of all aggregate at the end of the project."

ITEM P-605 JOINT SEALANTS FOR PAVEMENTS, Section 605-3.2, Equipment, f. Vacuum Sweeper.

ADD – "In lieu of vacuum sweeping, the joint material may be swept by hand and washed off pavement. Material shall be diluted in turf off pavement to the satisfaction of the engineer. All pavement surface and joints shall be cleaned to the satisfaction of the engineer and specifications P-501 and P-605."

ITEM P-605 JOINT SEALANTS FOR PAVEMENTS, Section 605-3.2, Equipment

ADD – "g. Waterblasting equipment. In lieu of sandblasting, the contractor may elect to use waterblasting equipment. The Contractor must demonstrate waterblasting equipment including the pumps, hose, guide and nozzle size, under job conditions, before approval in accordance with paragraph 605-3.3. The Contractor shall demonstrate, in the presence of the RPR, that the method cleans the joint and does not damage the joint."

ITEM P-605 JOINT SEALANTS FOR PAVEMENTS, Section 605-3.3, Preparation of Joints, b. Sealing

DELETE "Cleaning shall be accomplished by sandblasting as specified in paragraph 605-3.2."

ADD "Cleaning shall be accomplished by sandblasting or waterblasting as specified in paragraph 605-3.2."

PROPOSAL FORM/FORM OF CONTRACT AGREEMENT

DELETE "Pages 285-308."

ADD "Pages 285-308 attached to this addendum."

PLANS

Sheet 2 of 54

REPLACE Sheet 2 of 54 with REVISION 1.

Sheet 48 of 54

REPLACE Sheet 48 of 54 with REVISION 1.

CLARIFICATION:

1. Q1: Item P-605 requires sandblasting the joints prior to joint sealing. Can pressuring washing and cleaning with an air compressor be substituted for the sandblasting?
No, we will require sandblasting of the joints prior to joint sealing per Item P-605 in the Project Manual.
2. Can silicone sealant be substituted for the hot applied sealant?
The joint sealant will be hot applied per the P-605 specification.
3. Can Type 5 base rock be used for the haul route in lieu of the P-208 rock?
Changes to the pay item for P-208-5.2 – 6" Aggregate for Haul Route (and Access Road), have been revised as part of this addendum.
4. Are Liquidated damages are \$1500 or \$750? In the bid doc area it referenced \$1500, in the contract it references \$750.
All liquidated damages will be \$1,500 per day. Page 306 has been revised as part of this addendum.
5. Storage and staging area limits and proposed haul route limits can be reduced by contractor if the full area shown on plans isn't deemed necessary. Any modifications outside of the existing limits (beyond the limits shown on plans) must be pre-approved by the engineer before construction.
6. **P-208-5.2 is to be used to build staging area and proposed access road only.** Existing gravel haul routes (Warco Road and gravel roads in farm areas) are to be repaired or improved at the contractor's expense. (It was mistakenly stated in the prebid meeting that P-208-5.2 could be measured for payment for repairs to the existing gravel roads).
7. **A water source (well water with pump) is located next to the terminal building.**

CRAWFORD, MURPHY & TILLY, INC.**This Addendum consists of 3 pages plus 2 revised plan sheets, a revised Proposal Form, revised Federal Wage Rates and a transmittal sheet.**

Signed
(Contractor)

Date

Contractor to sign and date this Addendum #1 to acknowledge receipt. The Contractor must also fax or email to Crawford, Murphy, & Tilly, Inc. at the number listed below by **April 22, 2025**. This signed Addendum must also be acknowledged on the Proposal Form.

TRANSMITTAL

To: Crawford, Murphy & Tilly, Inc
Attention: **Tom Morris**

Re: Addendum #1

Fax 314.436.0723

From:

Date:

To verify that all contractors are in receipt of this addendum, Contractors are asked to sign and date this acknowledgement sheet. The Contractor should fax or email to Crawford, Murphy, & Tilly, Inc. at the number listed below by **April 22, 2025**.

Crawford, Murphy, & Tilly, Inc.
One Memorial Drive, Suite 500
Saint Louis, Missouri 63102

Fax: (314) 436-0723
Phone: (314) 436-5500
Email tmorris@cmtengr.com

BY: CRAWFORD, MURPHY, & TILLY, INC.

REVISED PROPOSAL FORM

PROPOSAL FORM
CITY OF WASHINGTON
State Block Grant Project No. **25-054A-1**

TO: Public Works Director

The undersigned, in compliance with the request for bids for construction of the following Project:

BASE BID: EXTENSION OF RUNWAY 33

ADDITIVE ALTERNATE NO. 1: EXTENSION OF TAXIWAY A

hereby proposes to furnish all labor, permits, material, machinery, tools, supplies and equipment to faithfully perform all work required for construction of the Project in accordance with the project manual, project drawings and issued Addenda within the specified time of performance for the following prices:

BASE BID							
BID ITEM	FAA or MoDOT SPEC.	ITEM DESCRIPTION	APPROX. QUANTIT Y AND UNITS	UNIT PRICE		EXTENSION	
				DOLLARS	CTS	DOLLARS	CTS
1	C-100- 14.1	Contractor Quality Control Plan	1 Lump Sum				
2	C-102- 5.1	Installation and Removal of Silt Fence	615 L.F.				
3	C-102- 5.2	Ditch Checks	3 Each				
4	C-105- 5.1	Mobilization (10% Limit) – Base Bid	1 Lump Sum				
5	C-105- 5.3	Engineer's Field Office	1 Lump Sum				
6	P-152- 4.1	Embankment In Place	2,679 C.Y.				
7	P-152- 4.2	Unsuitable Substrate	1,135 C.Y.				
8	P-155- 5.1	12" Lime Treated Subgrade (7%)	3,406 S.Y.				
9	P-155- 5.2	Lime	164 Ton				
10	P-208- 5.1	6" Crushed Aggregate Base Course	3,406 S.Y.				
11	P-208- 5.2	6" Aggregate For Haul Route	5,495 S.Y.				
12	P-501- 8.2	Portland Cement Concrete Pavement – 6"	3,217 S.Y.				
13	P-620- 5.1	Waterborne Paint, Yellow, With Reflective Media	6371 S.F.				
14	P-620- 5.2	Waterborne Paint, Black, Without Reflective Media	14,478 S.F.				

15	P-620-5.3	Waterborne Paint, White, With Reflective Media	37,634 S.F.				
16	P-620-5.4	Pavement Marking Removal	73,231 S.F.				
17	D-705-5.1	4" Perforated Pipe for Underdrains	785 L.F.				
18	D-705-5.2	Underdrain Cleanout/Collection Structure	3 Each				
19	D-705-5.3	Direct Connection	1 Each				
20	T-901-5.1	Seeding	7.8 Acre				
21	T-904-5.1	Sodding	1,943 S.F.				
22	T-908-5.1	Mulching	7.8 Acre				
23	L-108-5.1	1/C #8, L-824, Type C, 5KV Cable in 1" Unit Duct	1,350 L.F.				
24	L-108-5.2	PAPI 33 Circuit, 2-#4 Type USE, 1-#8 GND., In 1-1/2" Unit Duct	556 L.F.				
25	L-108-5.3	REIL 33 Circuit, 2-#4 Type USE, 1-#8 GND., In 1-1/2" Unit Duct	970 L.F.				
26	L-108-5.4	Counterpoise, Copper Guard Wire	2,876 L.F.				
27	L-115-5.1	Splice Can	2 Each				
28	L-125-5.1	Incandescent MRL Base Mounted	4 Each				
29	L-125-5.2	Incandescent Bi-Directional Base Mounted Threshold Light	8 Each				
30	L-125-5.4	Install New LED REIL and Equipment Rack	1 Each				
31	L-125-5.5	Install New LED PAPI, 4-Box System and Equipment Rack	1 Each				
32	L-125-5.7	Relocate Existing Runway Threshold Light	8 Each				
33	L-125-5.8	Remove Existing Runway Threshold Light	8 Each				
34	L-125-5.9	Remove Existing 4-Box PAPI System	1 Each				
35	L-125-5.10	Remove Existing REIL	1 Each				
36	L-125-5.11	Runway Unlighted Sign, Unlighted on New PCC Pad	1 Each				
37	SP-1-5.1	Temporary Displaced Threshold	1 Lump Sum				
TOTAL BID (Base Bid)							

ADDITIVE ALTERNATE #1							
BID ITEM	FAA or MoDOT SPEC.	ITEM DESCRIPTION	APPROX. QUANTITY AND UNITS	UNIT PRICE		EXTENSION	
				DOLLARS	CTS	DOLLARS	CTS
38	C-102-5.1	Installation and Removal of Silt Fence	314 L.F.				
39	C-102-5.2	Ditch Checks	7 Each				
40	C-102-5.3	Rip Rap	20 S.Y.				
41	C-105-5.2	Mobilization (10% Limit) – Additive Alternate	1 Lump Sum				
42	P-152-4.1	Embankment In Place	3,700 C.Y.				
43	P-152-4.2	Unsuitable Substrate	1,060 C.Y.				
44	P-155-5.1	12” Lime Treated Subgrade (7%)	3,191 S.Y.				
45	P-155-5.2	Lime	153 Ton				
46	P-208-5.1	6” Crushed Aggregate Base Course	3,191 S.Y.				
47	P-501-8.2	Portland Cement Concrete Pavement – 6”	2,896 S.Y.				
48	P-620-5.1	Waterborne Paint, Yellow, With Reflective Media	660 S.F.				
49	P-620-5.2	Waterborne Paint, Black, Without Reflective Media	1,291 S.F.				
50	D-701-5.1	Reinforced Concrete Pipe Class IV (18”)	128 L.F.				
51	D-705-5.1	4” Perforated Pipe for Underdrains	547 L.F.				
52	D-705-5.2	Underdrain Cleanout/Collection Structure	1 Each				
53	D-705-5.3	Direct Connection	1 Each				
54	D-752-5.1	18” Reinforced Concrete Flared End Section	2 Each				
55	T-901-5.1	Seeding	1.9 Acre				
56	T-904-5.1	Sodding	3,381 S.F.				
57	T-908-5.1	Mulching	1.9 Acre				
58	L-110-5.1	4-Way – 4” PVC Concrete Encased Duct Bank	55 L.F.				
59	L-125-5.3	Incandescent Base Mounted Taxiway Edge Light	2 Each				

60	L-125-5.6	Install New Taxiway Edge Reflector	30 Each				
61	L-125-5.11	Runway Unlighted Sign, Unlighted on New PCC Pad	1 Each				
TOTAL BID (Additive Alternate #1)							

Base Bid + Additive Alternate							
TOTAL BID (Base Bid + Additive Alternate #1)							

ACKNOWLEDGEMENTS BY BIDDER

- a. By submittal of a proposal, the BIDDER acknowledges and accepts that the quantities established by the OWNER are an approximate estimate of the quantities required to fully complete the Project and that the estimated quantities are principally intended to serve as a basis for evaluation of bids. The BIDDER further acknowledges and accepts that payment under this contract will be made only for actual quantities and that quantities will vary in accordance with the General Provisions subsection entitled "Alteration of Work and Quantities".
- b. The BIDDER acknowledges and accepts that the Bid Documents are comprised of the documents identified within the General Provisions. The BIDDER further acknowledges that each the individual documents that comprise the Bid Documents are complementary to one another and together establishes the complete terms, conditions and obligations of the successful BIDDER.
- c. As evidence of good faith in submitting this proposal, the undersigned encloses a bid guaranty in the form of a certified check, cashier's check or bid bond in the amount of 5% of the bid price. The BIDDER acknowledges and accepts that refusal or failure to accept award and execute a contract within the terms and conditions established herein will result in forfeiture of the bid guaranty to the owner as a liquidated damage.
- d. The BIDDER acknowledges and accepts the OWNER'S right to reject any or all bids.
- e. The BIDDER acknowledges and accepts the OWNER'S right to hold all Proposals for purposes of review and evaluation and not issue a notice of award for a period not to exceed **One Hundred and Twenty (120)** calendar days from the stated date for receipt of bids.
- f. The undersigned agrees that upon written notice of award of contract, he or she will execute the contract within thirty (30) days of the notice of award, and furthermore, and provide executed payment and performance bonds within fifteen (15) days from the date of contract execution. The undersigned accepts that failure to execute the contract and provide the required bonds within the stated timeframe shall result in forfeiture of the bid guaranty to the owner as a liquidated damage.
- g. Time of Performance: By submittal of this proposal, the undersigned acknowledges and agrees to commence work within ten (10) calendar days of the date specified in the written "Notice to Proceed" as issued by the OWNER. The undersigned further agrees to complete the Project within **Sixty Four (64)** Calendar days from the commencement date specified in the Notice to Proceed for the Base Bid and an additional **Fifteen (15)** Calendar Days will be granted if Additive Alternate #1 is awarded.
- h. The undersigned acknowledges and accepts that for each and every Calendar day the project remains incomplete and each phase is incomplete beyond the contract time of performance, the Contractor shall pay the non-penal amount of **\$1,500** per Calendar day as a liquidated damage to the OWNER.
- i. The undersigned prime contractor, if not a MoDOT certified DBE, hereby assures that they will subcontract **Nine percent (9%)** of the dollar value of the prime contract to DBE firms or make good faith efforts to meet the DBE contract goal. In addition, the prime contractor will include the DBE clauses (see Supplementary

Provision No. 6 of the Federal and State Provisions) required by the DBE Program adopted by MoDOT and the Sponsor in all contracts and subcontracts relating to this project. The undersigned will complete the DBE Participation information included herein when a DBE goal has been established, including a demonstration of good faith efforts if the DBE goal is not met. If the undersigned prime contractor is a MoDOT certified DBE firm, then the prime contractor must perform at least thirty percent (30%) of the total contract value work with its own forces, and will receive DBE credit for all work which the prime contractor and any other MoDOT certified DBE firm performs directly.

- j. The BIDDER, by submission of a proposal, acknowledges that award of this contract is subject to the provisions of the Davis-Bacon Act and the Missouri Prevailing Wage Law. The BIDDER accepts the requirement to pay prevailing wages for each classification and type of worker as established in the attached wage rate determinations as issued by the United States Department of Labor and the Missouri Division of Labor Standards. The BIDDER further acknowledges and accepts their requirement to incorporate the provision to pay the established prevailing wages in every subcontract agreement entered into by the Bidder under this project. The highest rate between the two (Federal and State) for each job classification shall be considered the prevailing wage.
- k. Compliance Reports (41 CFR Part 60-1.7): Within 30 days after award of this contract, the Contractor/Subcontractor shall file a compliance report (Standard Form 100) if s/he has not submitted a complete compliance report within 12 months preceding the date of award. This report is required if the Contractor/Subcontractor meets all of the following conditions:
 - 1. Contractors/Subcontractors are not exempt based on 41 CFR 60-1.5.
 - 2. Has 50 or more employees.
 - 3. Is a prime contractor or first tier subcontractor.
 - 4. There is a contract, subcontract, or purchase order amounting to \$50,000 or more

- l. The undersigned acknowledges receipt of the following addenda:

Addendum No. _____, dated _____	Date Received _____
Addendum No. _____, dated _____	Date Received _____
Addendum No. _____, dated _____	Date Received _____
Addendum No. _____, dated _____	Date Received _____
Addendum No. _____, dated _____	Date Received _____

REPRESENTATIONS BY BIDDER

By submittal of a proposal (bid), the BIDDER represents the following:

- a. The BIDDER has read and thoroughly examined the bid documents, including all authorized addenda.
- b. The BIDDER has a complete understanding of the terms and conditions required for the satisfactory performance of project work.
- c. The BIDDER has fully informed themselves of the project site, the project site conditions and the surrounding area.
- d. The BIDDER has familiarized themselves with the requirements of working on an operating airport and understands the conditions that may in any manner affect cost, progress or performance of the work.
- e. The BIDDER has correlated their observations with that of the project documents.
- f. The BIDDER has found no errors, conflicts, ambiguities or omissions in the project documents, except as previously submitted in writing to the owner that would affect cost, progress or performance of the work.
- g. The BIDDER is familiar with all applicable Federal, State and local laws, rules and regulations pertaining to execution of the contract and the project work.
- h. The BIDDER has complied with all requirements of these instructions and the associated project documents.

CERTIFICATIONS BY BIDDER

- a. The undersigned hereby declares and certifies that the only parties interested in this proposal are named herein and that this proposal is made without collusion with any other person, firm or corporation. The undersigned further certifies that no member, officer or agent of OWNER'S has direct or indirect financial interest in this proposal.
- b. **Trade Restriction Certification (49 U.S.C. § 50104, 49 CFR Part 30)**
The submission of an offer, the Offeror certifies that with respect to this solicitation and any resultant contract, the Offeror:
1. is not owned or controlled by one or more citizens of a foreign country included in the list of countries that discriminate against U.S. firms published by the Office of the United States Trade Representative (U.S.T.R.);
 2. has not knowingly entered into any contract or subcontract for this project with a person that is a citizen or national of a foreign country included on the list of countries that discriminate against U.S. firms as published by the U.S.T.R.; and
 3. has not entered into any subcontract for any product to be used on the project that is produced in a foreign country included on the list of countries that discriminate against U.S. firms published by the U.S.T.R.

This certification concerns a matter within the jurisdiction of an agency of the United States of America and the making of a false, fictitious, or fraudulent certification may render the maker subject to prosecution under Title 18, United States Code, Section 1001.

The Offeror/Contractor must provide immediate written notice to the Owner if the Offeror/Contractor learns that its certification or that of a subcontractor was erroneous when submitted or has become erroneous by reason of changed circumstances. The Contractor must require subcontractors provide immediate written notice to the Contractor if at any time it learns that its certification was erroneous by reason of changed circumstances.

Unless the restrictions of this clause are waived by the Secretary of Transportation in accordance with 49 CFR 30.17, no contract shall be awarded to an Offeror or subcontractor:

1. who is owned or controlled by one or more citizens or nationals of a foreign country included on the list of countries that discriminate against U.S. firms published by the U.S.T.R. or
2. whose subcontractors are owned or controlled by one or more citizens or nationals of a foreign country on such U.S.T.R. list or
3. who incorporates in the public works project any product of a foreign country on such U.S.T.R. list.

Nothing contained in the foregoing shall be construed to require establishment of a system of records in order to render, in good faith, the certification required by this provision. The knowledge and information of a contractor is not required to exceed that which is normally possessed by a prudent person in the ordinary course of business dealings.

The Offeror agrees that, if awarded a contract resulting from this solicitation, it will incorporate this provision for certification without modification in all lower tier subcontracts. The contractor may rely on the certification of a prospective subcontractor that it is not a firm from a foreign country included on the list of countries that discriminate against U.S. firms as published by U.S.T.R., unless the Offeror has knowledge that the certification is erroneous.

This certification is a material representation of fact upon which reliance was placed when making an award. If it is later determined that the Contractor or subcontractor knowingly rendered an erroneous certification, the Federal Aviation Administration (FAA) may direct through the Owner cancellation of the contract or subcontract for default at no cost to the Owner or the FAA.

d. Certification of Offeror/Bidder Regarding Debarment (2 CFR Part 180 (Subpart C), 2 CFR Part 1200, DOT Order 4200.5)

By submitting a bid/proposal under this solicitation, the Bidder or Offeror certifies that neither it nor its principals are presently debarred or suspended by any Federal department or agency from participation in this transaction.

e. Certification of Lower Tier Contractors Regarding Debarment (2 CFR Part 180 (Subpart C), 2 CFR Part 1200, DOT Order 4200.5)

The successful Bidder, by administering each lower tier subcontract that exceeds \$25,000 as a “covered transaction”, must verify each lower tier participant of a “covered transaction” under the project is not presently debarred or otherwise disqualified from participation in this federally assisted project. The successful bidder will accomplish this by:

1. Checking the System for Award Management at website: <http://www.sam.gov>;
2. Collecting a certification statement similar to the Certificate of Offeror/Bidder Regarding Debarment and Suspension, above;
3. Inserting a clause or condition in the covered transaction with the lower tier contract.

If the FAA and/or MoDOT later determines that a lower tier participant failed to disclose to a higher tier participant that it was excluded or disqualified at the time it entered the covered transaction, the FAA and/or MoDOT may pursue any available remedies, including suspension and debarment of the non-compliant participant.

f. Certification Regarding Lobbying (31 U.S.C. § 1352, 2 CFR § 200 Appendix II(J), 49 CFR Part 20, Appendix A)

The Bidder or Offer certifies by signing and submitting this bid or proposal, to the best of his or her knowledge and belief, that:

1. No Federal appropriated funds have been paid or will be paid, by or on behalf of the Bidder or Offeror, to any person for influencing or attempting to influence an officer or employee of an agency, a Member of Congress, an officer or employer of Congress, or an employee of a Member of Congress in connection with the awarding of any Federal contract, the making of any Federal grant, the making of any Federal loan, the entering into of any cooperative agreement, and the extension, continuation, renewal, amendment, or modification of any Federal contract, grant, loan, or cooperative agreement.
2. If any funds other than Federal appropriated funds have been paid or will be paid to any person for influencing or attempting to influence an officer or employee of any agency, a Member of Congress, an officer or employee of Congress, or an employee of a Member of Congress in connection with this Federal contract, grant, loan, or cooperative agreement, the undersigned shall complete and submit Standard Form-LLL, “Disclosure Form to Report Lobbying,” in accordance with its instructions.
3. The undersigned shall require that the language of this certification be included in the award documents for all sub-awards at all tiers (including subcontracts, sub-grants, and contracts under grants, loans, and cooperative agreements) and that all sub-recipients shall certify and disclose accordingly.

This certification is a material representation of fact upon which reliance was placed when this transaction was made or entered into. Submission of this certification is a prerequisite for making or entering into this transaction imposed by Section 1352, Title 31, United States Code. Any person who fails to file the

required certification shall be subject to a civil penalty of not less than \$10,000 and not more than \$100,000 for such failure.

g. Buy American Certification: (Title 49 U.S.C. § 50101)

The bidder agrees to comply with 49 U.S.C. § 50101, which provides that Federal funds may not be obligated unless all steel and manufactured goods used in AIP-funded projects are produced in the United States, unless the FAA has issued a waiver for the product; the product is listed as an Excepted Article, Material Or Supply in Federal Acquisition Regulation subpart 25.108; or is included in the FAA Nationwide Buy American Waivers Issued List.

A bidder or offeror must submit the appropriate Buy America certification included herein with their bid or offer. The Owner will reject as nonresponsive any bid or offer that does not include a completed Certificate of Buy American Compliance.

Certificate of Buy American Compliance for Manufactured Products
(Non-building construction projects, equipment acquisition projects)

As a matter of bid responsiveness, the bidder or offeror must complete, sign, date, and submit this certification statement with their proposal. The bidder or offeror must indicate how they intend to comply with 49 USC § 50101 by selecting one of the following certification statements. These statements are mutually exclusive. Bidder must select one or the other (i.e. not both) by inserting a checkmark (✓) or the letter "X".

☐

Bidder or offeror hereby certifies that it will comply with 49 USC 50101 by:

- a) Only installing steel and manufactured products produced in the United States;
- b) Installing manufactured products for which the FAA has issued a waiver as indicated by inclusion on the current FAA Nationwide Buy American Waivers Issued listing; or
- c) Installing products listed as an Excepted Article, Material or Supply in Federal Acquisition Regulation Subpart 25.108.

By selecting this certification statement, the bidder or offeror agrees:

1. To provide to the Owner evidence that documents the source and origin of the steel and manufactured product.
2. To faithfully comply with providing U.S. domestic product.
3. To furnish U.S. domestic product for any waiver request that the FAA rejects.
4. To refrain from seeking a waiver request after establishment of the contract, unless extenuating circumstances emerge that the FAA determines justified.

☐

Bidder or offeror hereby certifies it cannot comply with the 100% Buy American Preferences of 49 USC § 50101(a) but may qualify for either a Type 3 or Type 4 waiver under 49 USC § 50101(b). By selecting this certification statement, the apparent bidder or offeror with the apparent low bid agrees:

1. To submit to the Owner within 15 calendar days of the bid opening, a formal waiver request and required documentation that support the type of waiver being requested.
2. That failure to submit the required documentation within the specified timeframe is cause for a non-responsive determination which may result in rejection of the proposal.
3. To faithfully comply with providing U.S. domestic products at or above the approved U.S. domestic content percentage as approved by the FAA.
4. To refrain from seeking a waiver request after establishment of the contract, unless extenuating circumstances emerge that the FAA determines justified.

Required Documentation

Type 3 Waiver – The cost of the item components and subcomponents produced in the United States is more than 60% of the cost of all components and subcomponents of the “item”. The required documentation for a Type 3 waiver is:

- a) Listing of all product components and subcomponents that are not comprised of 100% U.S. domestic content (excludes products listed on the FAA Nationwide Buy American Waivers Issued listing and products excluded by Federal Acquisition Regulation Subpart 25.108; products of unknown origin must be considered as non-domestic products in their entirety).
- b) Cost of non-domestic components and subcomponents, excluding labor costs associated with final assembly at place of manufacture.
- c) Percentage of non-domestic component and subcomponent cost as compared to total “item” component and subcomponent costs, excluding labor costs associated with final assembly and at place of manufacture.

Type 4 Waiver – Total cost of project using U.S. domestic source product exceeds the total project cost using non-domestic product by 25%. The required documentation for a Type 4 waiver is:

- d) Detailed cost information for total project using U.S. domestic product.
- e) Detailed cost information for total project using non-domestic product.

False Statements: Per 49 USC § 47126, this certification concerns a matter within the jurisdiction of the Federal Aviation Administration and the making of a false, fictitious or fraudulent certification may render the maker subject to prosecution under Title 18, United States Code.

Date

Signature

Company Name

Title

h. Compliance with the Work Authorization Law (as required by Section 285.530, Revised Statutes of Missouri)

For all contracts where the total bid amount is in excess of \$50,000 (local match in excess of \$5,000), the Bidder, by submission of an offer and by signing the Worker Eligibility Verification Affidavit for All Contract Agreements in Excess of \$50,000, certifies that it:

1. does not knowingly employ any person who is an unauthorized alien in connection with the contracted services;
2. has enrolled and actively participates in a federal work authorization program;

A general contractor or subcontractor of any tier shall not be liable under sections 285.525 to 285.550 when such general contractor or subcontractor contracts with its direct subcontractor who violates subsection 1 of this section, if the contract binding the contractor and subcontractor affirmatively states that the direct subcontractor is not knowingly in violation of subsection 1 of this section and shall not henceforth be in such violation and the contractor or subcontractor receives a sworn affidavit under the penalty of perjury attesting to the fact that the direct subcontractor’s employees are lawfully present in the United States.

**WORKER ELIGIBILITY VERIFICATION AFFIDAVIT FOR ALL CONTRACT
AGREEMENTS IN EXCESS OF \$50,000 (Local match in excess of \$5,000)**
(for joint ventures, a separate affidavit is required for each business entity)

STATE OF _____)
) ss
COUNTY OF _____)

On this _____ day of _____, 20____, before me appeared _____, personally known to me or proved to me on the basis of satisfactory evidence to be a person whose name is subscribed to this affidavit, who being by me duly sworn, deposed as follows:

My name is _____, and I am of sound mind, capable of making this affidavit, and personally certify the facts herein stated, as required by Section 285.530, RSMo, to enter into any contract agreement with the state or any of its political subdivisions to perform any job, task, employment, labor, personal services, or any other activity for which compensation is provided, expected, or due, including but not limited to all activities conducted by business entities:

I am the _____ of _____, and I am duly authorized, directed, and/or empowered to act officially and properly on behalf of this business entity.
(title) (business name)

I hereby affirm and warrant that the aforementioned business entity is enrolled in a federal work authorization program operated by the United States Department of Homeland Security, and the aforementioned business entity shall participate in said program to verify information (employment eligibility) of newly hired employees working in connection to work under the within contract agreement. I have attached documentation to this affidavit to evidence enrollment/participation by the aforementioned business entity in a federal work authorization program, as required by Section 285.530, RSMo.

In addition, I hereby affirm and warrant that the aforementioned business entity does not and shall not knowingly employ, in connection to work under the within contract agreement, any alien who does not have the legal right or authorization under federal law to work in the United States, as defined in 8 U.S.C. § 1324a(h)(3).

I am aware and recognize that, unless certain contract and affidavit conditions are satisfied pursuant to Section 285.530, RSMo, the aforementioned business entity may be held liable under Sections 285.525 through 285.550, RSMo, for subcontractors that knowingly employ or continue to employ any unauthorized alien to work within the state of Missouri.

I acknowledge that I am signing this affidavit as a free act and deed of the aforementioned business entity and not under duress.

(Affiant Signature)

Subscribed and sworn to before me this _____ day of _____, 20____.

(Notary Public)

My commission expires:

[Documentation of enrollment/participation in a federal work authorization program is attached. Acceptable enrollment and participation documentation consists of the following two pages of the E-Verify Memorandum of Understanding: (1) A valid, completed copy of the first page identifying the business entity; and (2) A valid copy of the signature page completed and signed by the business entity, the Social Security Administration, and the Department of Homeland Security – Verification Division.]

DISADVANTAGED BUSINESS ENTERPRISE (DBE) PARTICIPATION

The information shown in this section must be completed when a DBE contract goal has been established. The percentage must equal or exceed the DBE contract goal. If the percentage is below the contract goal, then the bidder must submit complete written documentation of good faith efforts taken to meet the DBE contract goal.

- a. The undersigned submits the following list of DBEs to be used in accomplishing the work of this contract. The work, supplies or services, applicable value and percent of total federal contract each DBE is to perform or furnish is as follows:
- b. Joint venture with a DBE. The undersigned submits the following list of bid items the DBE prime is responsible for and any items that will be subcontracted out are noted with an asterisk or a similar notation. The work, applicable value and percentage of total federal contract the DBE prime is responsible for are as follows:

(A) DBE Name and Address	(B) Bid Item Number(s) Or Work Performed	(C) Dollar Value of DBE Work **	(D) Percent Applicable to DBE Goal (100%, 60%)	(E) Dollar Amount Applicable to DBE Goal (C x D)	(F) Percent of Total Contract (C / Total Contract Amount)
TOTAL DBE PARTICIPATION				\$	%

**Cannot exceed contract amount for given item of work.

Trucking services credited at 100% if the DBE owns the trucks or is leasing from a DBE firm

Merchant wholesalers (supply) are credited at 60%.

Brokered services will only receive credit for fees.

(Please reproduce the above sheet if additional space is needed.)

**THIS EXECUTED PROPOSAL FORM MUST BE SUBMITTED
IN THE ORIGINAL BOUND PROJECT MANUAL.**

SIGNATURE OF BIDDER

The undersigned states that the correct LEGAL NAME AND ADDRESS of (1) the individual bidder, (2) each partner or joint venturer (whether individuals or corporations, and whether doing business under a fictitious name), or (3) the corporation (with the state in which it is incorporated) are shown below; that (if not signing with the intention to bind themselves to become responsible and sole bidder) they are the agent of, and they are signing and executing this (as indicated in the proper spaces below) as the bid of a

() sole individual () partnership () joint venture
() corporation, incorporated under the laws of state of _____.

Executed by bidder this _____ day of _____ 20_____.

Name of individual,
all partners
or joint venturers:

Address of each:

doing business under the name of:

Address of principal place of business in
Missouri:

(If using a fictitious name, show this name
above in addition to legal names)

(If a corporation, show its name above)

ATTEST: (SEAL)

(Signature)

Secretary

(Signature)

(Title)

Please print name

Please print name

NOTE: If bidder is doing business under a fictitious name, the bid shall be executed in the legal name of the individual partners, joint ventures, or corporation, with the legal address shown, and registration of fictitious name filed with the secretary of state, as required by sections 417.200 to 417.230 RSMo. If the bidder is a corporation not organized under

the laws of Missouri, it shall procure a certificate of authority to do business in Missouri, as required by section 351.572 et seq RSMo.

PERFORMANCE BOND	BOND NUMBER
PRINCIPAL <i>(Legal Name and Business Address)</i>	
SURETY <i>(Legal Name and Business Address)</i>	STATE OF INCORPORATION
PENAL SUM OF BOND <i>(Expressed in words and numerals)</i>	CONTRACT DATE

OBLIGATION

KNOW ALL PERSONS BY THESE PRESENTS, that the above named PRINCIPAL, hereinafter referred to and called CONTRACTOR, and the above named SURETY hereby bind themselves unto **City of Washington, Missouri, Missouri, 405 Jefferson St., Washington, Mo 63090**, as OBLIGEE, hereinafter referred to and called OWNER, in the penal sum stated above, in lawful money of the United States of America to be paid to OWNER. For payment of the penal sum, we bind ourselves, our heirs, executors, administrators, successors and assigns, jointly and severally, firmly by these presents.

WHEREAS,

CONTRACTOR has entered into the written contract agreement identified hereinabove with the OWNER for the following project:

**BASE BID: EXTEND RUNWAY 33
ADDITIVE ALTERNATE NO. 1: EXTEND TAXIWAY A

WASHINGTON REGIONAL AIRPORT**

which said contract and associated contract documents, including any present or future amendment thereto, is incorporated herein by reference and is hereinafter referred to as the Contract.

CONDITION

NOW, THEREFORE, THE CONDITION OF THIS OBLIGATION is such that, if CONTRACTOR shall promptly and faithfully perform all undertakings, covenants, terms, conditions and agreements of the Contract during the original term of the Contract and any extensions thereof that are granted by the OWNER, with or without notice to the SURETY, and during the period of any guarantee or warranties required under the Contract, and if CONTRACTOR shall perform and fulfill all undertakings, covenants, terms, conditions and agreements of any and all duly authorized modifications of the Contract that hereafter are made, then this obligation shall be void; otherwise it shall remain in full force and effect subject to the following additional conditions:

1. SURETY, for value received, hereby stipulates and agrees that no change, extension of time, modification, omission, addition or change in or to the Contract, or the work performed thereunder or the specifications accompanying the same, shall in any way affect the SURETY'S obligation on this bond; and SURETY hereby agrees to waive notice of any and all such extensions, modifications, omissions, alterations, and additions to the terms of the Contract, work or specifications.
2. Whenever CONTRACTOR shall be and declared by the OWNER to be in default under the Contract, the Surety shall promptly and at the SURETY'S expense remedy the default by implementing one or more of the following actions:
 - a. Arrange for the CONTRACTOR, with consent of the OWNER, to perform and complete the Contract; or
 - b. Undertake to perform and complete the Contract itself, through its agents or through independent contractors; or
 - c. Obtain bids or negotiated proposals from qualified contractors acceptable to the OWNER for a contract for performance and completion of the Contract; arrange for a contract to be prepared for execution by the OWNER and the contractor selected with the OWNER'S concurrence, to be secured with performance and

payment bonds executed by a qualified surety equivalent to the Bonds issued on the Contract; and make available as work progresses (even though there should be a default or a succession of defaults under the contract or contracts of completion arranged under this paragraph) sufficient funds to pay the cost of completion less the balance of the contract price; but not exceeding, including other costs and damages for which the Surety may be liable hereunder, the penal sum of the bond. The term "balance of the contract price", as used in this paragraph, shall mean the total amount payable by OWNER to CONTRACTOR under the Contract and any amendments thereto, disbursed at the rate provided in the original contract, less the amount properly paid by OWNER to CONTRACTOR.

- d. With written consent of the OWNER, SURETY may waive its right to perform and complete, arrange for completion or obtain a new contractor and with reasonable promptness, investigate and determine the amount the SURETY is liable to the OWNER and tender payment therefor to the OWNER.
3. CONTRACTOR and SURETY agree that if in connection with the enforcement of this Bond, the OWNER is required to engage the services of an attorney, that reasonable attorney fees incurred by the OWNER, with or without suit, are in addition to the balance of the contract price.
4. No right of action shall accrue on this bond to or for the use of any person or corporation other than the OWNER named herein or the successors or assigns of the OWNER.

WITNESS

In witness whereof, this instrument is executed this the _____ day of _____, 20____.

INDIVIDUAL PRINCIPAL:

Company Name: _____

Signature: _____

Name and Title: _____

CORPORATE PRINCIPAL:

ATTEST: Corporate Name: _____

Signature: _____ Signature: _____

Name and Title: _____ Name and Title: _____
(Affix Corporate Seal)

SURETY:

ATTEST: Surety Name: _____

Signature: _____ Signature: _____

Name and Title: _____ Name and Title: _____
(Affix Seal) (Attach Power of Attorney)

OWNER ACCEPTANCE:

The OWNER approves the form of this Performance Bond.

ATTEST: Date: _____

Signature: _____ Signature: _____

Name and Title: _____ Name and Title: _____
(Affix Seal)

PAYMENT BOND	BOND NUMBER
PRINCIPAL (<i>Legal Name and Business Address</i>)	
SURETY (<i>Legal Name and Business Address</i>)	STATE OF INCORPORATION
PENAL SUM OF BOND (<i>Expressed in words and numerals</i>)	CONTRACT DATE

OBLIGATION

KNOW ALL PERSONS BY THESE PRESENTS, that the above named PRINCIPAL, hereinafter referred to and called CONTRACTOR, and the above named SURETY hereby bind themselves unto **The City of Washington, Missouri, Missouri, 405 Jefferson St., Washington, Mo 63090**, as OBLIGEE, hereinafter referred to and called OWNER, in the penal sum stated above, in lawful money of the United States of America to be paid to OWNER. For payment of the penal sum, we bind ourselves, our heirs, executors, administrators, successors and assigns, jointly and severally, firmly by these presents.

WHEREAS,

CONTRACTOR has entered into the written contract agreement identified hereinabove with the OWNER for the following project:

**BASE BID: EXTEND RUNWAY 33
ADDITIVE ALTERNATE NO. 1: EXTEND TAXIWAY A

WASHINGTON REGIONAL AIRPORT**

which said contract and associated contract documents, including any present or future amendment thereto, is incorporated herein by reference and is hereinafter referred to as the Contract.

CONDITION

NOW, THEREFORE, THE CONDITION OF THIS OBLIGATION is such that, if CONTRACTOR shall promptly make payment to all employees, persons, firms or corporations for all incurred indebtedness and just claims for labor, supplies, materials and services furnished for or used in connection with the performance of the Contract, then this obligation shall be void; otherwise it shall remain in full force and effect subject to the following additional conditions:

1. CONTRACTOR and SURETY indemnify and hold harmless the OWNER for all claims, demands, liens or suits that arise from performance of the Contract
2. SURETY, for value received, hereby stipulates and agrees that no change, extension of time, modification, omission, addition or change in or to the Contract, or the work performed thereunder or the specifications accompanying the same, shall in any way affect the SURETY'S obligation on this bond; and SURETY hereby agrees to waive notice of any and all such extensions, modifications, omissions, alterations, and additions to the terms of the Contract, work or specifications.
3. No final settlement between the OWNER and the CONTRACTOR shall abridge the right of any beneficiary hereunder, whose claim may be unsatisfied.
4. The amount of this bond shall be reduced by and to the extent of any payments made in good faith hereunder.
5. Amounts owed by the OWNER to the CONTRACTOR under the Contract shall be used for the performance of the Contract and to satisfy claims, if any, under any Performance Bond. By the CONTRACTOR furnishing and the OWNER accepting this Bond, they agree that all funds earned by the CONTRACTOR in the performance of the Contract are dedicated to satisfy obligations of the CONTRACTOR and the SURETY under this Bond, subject to the OWNER'S priority to use the funds for the completion of the project.

WITNESS

In witness whereof, this instrument is executed this the _____ day of _____, 20____.

INDIVIDUAL PRINCIPAL:

Company Name: _____

Signature: _____

Name and Title: _____

CORPORATE PRINCIPAL:

ATTEST:

Corporate Name: _____

Signature: _____

Signature: _____

Name and Title: _____
(Affix Corporate Seal)

Name and Title: _____

SURETY:

ATTEST:

Surety Name: _____

Signature: _____

Signature: _____

Name and Title: _____
(Affix Seal)

Name and Title: _____
(Attach Power of Attorney)

OWNER ACCEPTANCE:

The OWNER approves the form of this Payment Bond.

ATTEST:

Date: _____

Signature: _____

Signature: _____

Name and Title: _____
(Affix Seal)

Name and Title: _____

**FORM OF
CONTRACT AGREEMENT**
City of Washington
State Block Grant Project No. **25-054A-1**

THIS AGREEMENT, made as of this _____ day of _____, 20____, is

BY AND BETWEEN

the OWNER: Name: **City of Washington City Hall**

Address: **405 Jefferson**

City/State/Zip Code: **Washington, MO 63090**

And the CONTRACTOR: Name:

Address: _____

City/State/Zip Code: _____

WITNESSETH:

WHEREAS it is the intent of the Owner to make improvements at **WASHINGTON REGIONAL AIRPORT** generally described as follows:

BASE BID: EXTEND RUNWAY 33
ADDITIVE ALTERNATE NO. 1: EXTEND TAXIWAY A

hereinafter referred to as the Project.

NOW THEREFORE in consideration of the mutual covenants hereinafter set forth, OWNER and CONTRACTOR agree as follows:

Article 1 – Work

It is hereby mutually agreed that for and in consideration of the payments as provided for herein to the CONTRACTOR by the OWNER, CONTRACTOR shall faithfully furnish all necessary labor, equipment, and material and shall fully perform all necessary work to complete the Project in strict accordance with this Contract Agreement and the Contract Documents.

Article 2 – Contract Documents

CONTRACTOR agrees that the Contract Documents consist of the following: this Agreement, General Provisions, Supplementary Provisions, Specifications, Drawings, all issued addenda, Notice to Bidders, Instructions to Bidders, Proposal and associated attachments, Performance Bond, Payment Bond, Wage Rate Determinations, Insurance certificates, documents incorporated by reference, documents incorporated by attachment, and all OWNER authorized change orders issued subsequent to the date of this agreement. All documents comprising the Contract Documents are complementary to one another and together establish the complete terms, conditions and obligations of the CONTRACTOR. All said Contract Documents are incorporated by reference into the Contract Agreement as if fully rewritten herein or attached thereto.

Article 3 – Contract Price

In consideration of the faithful performance and completion of the Work by the CONTRACTOR in accordance with the Contract Documents, OWNER shall pay the CONTRACTOR an amount equal to:

\$ _____ (\$ _____)
(Amount in Written Words) (Amount in Numerals)

subject to the following;

- a. Said amount is based on the schedule of prices and estimated quantities stated in CONTRACTOR'S Bid Proposal, which is attached to and made a part of this Agreement;
- b. Said amount is the aggregate sum of the result of the CONTRACTOR'S stated unit prices multiplied by the associated estimated quantities;
- c. CONTRACTOR and OWNER agree that said estimated quantities are not guaranteed and that the determination of actual quantities is to be made by the OWNER'S ENGINEER;
- d. Said amount is subject to modification for additions and deductions as provided for within the Contract General Provisions.

Article 4 – Payment

Upon the completion of the work and its acceptance by the OWNER, all sums due the CONTRACTOR by reason of faithful performance of the work, taking into consideration additions to or deductions from the Contract price by reason of alterations or modifications of the original Contract or by reason of "Extra Work" authorized under this Contract, will be paid to the CONTRACTOR by the OWNER after said completion and acceptance.

The acceptance of final payment by the CONTRACTOR shall be considered as a release in full of all claims against the OWNER, arising out of, or by reason of, the work completed and materials furnished under this Contract.

OWNER shall make progress payments to the CONTRACTOR in accordance with the terms set forth in the General Provisions. Progress payments shall be based on estimates prepared by the ENGINEER for the value of work performed and materials completed in place in accordance with the Contract Drawings and Specifications. Progress payments are subject to retainage requirements as set forth in the General Provisions.

Article 5 – Contract Time

The CONTRACTOR agrees to commence work within ten (10) calendar days of the date specified in the OWNER'S Notice to Proceed. CONTRACTOR further agrees to complete said work within **Sixty four (64) calendar days** of the commencement date stated within the Notice to Proceed for the Base Bid and with an additional **Fifteen (15)** calendar days to complete said work if Additive Alternate #1 is awarded.

It is expressly understood and agreed that the stated Contract Time is reasonable for the completion of the Work, taking all factors into consideration. Furthermore, extensions of the Contract Time may only be permitted by execution of a formal modification to this Contract Agreement in accordance with the General Provisions and as approved by the OWNER.

Article 6 – Liquidated Damages

The CONTRACTOR and OWNER understand and agree that time is of the essence for completion of the Work and that the OWNER will suffer additional expense and financial loss if said Work is not completed within the authorized Contract Time. Furthermore, the CONTRACTOR and OWNER recognize and understand the difficulty, delay, and expense in establishing the exact amount of actual financial loss and additional expense. Accordingly, in place of requiring such proof, the CONTRACTOR expressly agrees to pay the OWNER as liquidated damages the non-penal sum of **One Thousand Five Hundred Dollars (\$1,500.00)** per day for each calendar day required in excess of the authorized Contract Time.

Furthermore, the CONTRACTOR understands and agrees that;

- a. the OWNER has the right to deduct from any moneys due the CONTRACTOR, the amount of said liquidated damages;
- b. the OWNER has the right to recover the amount of said liquidated damages from the CONTRACTOR, SURETY or both.

Article 7 – CONTRACTOR'S Representations

The CONTRACTOR understands and agrees that all representations made by the CONTRACTOR within the Proposal Form shall apply under this Agreement as if fully rewritten herein.

Article 8 – CONTRACTOR’S Certifications

The CONTRACTOR understands and agrees that all certifications made by the CONTRACTOR within the Proposal shall apply under this Agreement as if fully rewritten herein. The CONTRACTOR further certifies the following;

a. Certification of Eligibility (29 CFR Part 5.5)

- i.** By Entering into this contract, the CONTRACTOR certifies that neither he or she nor any person or firm who has an interest in the CONTRACTOR’S firm is a person or firm ineligible to be awarded Government contracts by virtue of Section 3(a) of the Davis-Bacon Act or 29 CFR 5.12(a)(1);
- ii.** No part of this contract shall be subcontracted to any person or firm ineligible for award of a Government contract by virtue of Section 3(a) of the Davis-Bacon Act or 29 CFR 5.12(a)(1);
- iii.** The penalty for making false statements is prescribed in the U.S. Criminal Code 18 U.S.C.

b. Certification of Non-Segregated Facilities (41 CFR Part 60-1.8)

The federally-assisted construction CONTRACTOR certifies that it does not and will not maintain or provide for its employees any segregated facilities at any of its establishments and that it does not and will not permit its employees to perform their services at any location under its control where segregated facilities are maintained. The Bidder agrees that a breach of this certification is a violation of the Equal Opportunity Clause in this contract.

As used in this certification, the term "segregated facilities" means any waiting rooms, work areas, restrooms and washrooms, restaurants and other eating areas, time clocks, locker rooms and other storage or dressing areas, parking lots, drinking fountains, recreation or entertainment areas, transportation, and housing facilities provided for employees that are segregated by explicit directive or are in fact segregated on the basis of race, color, religion, sex, or national origin because of written or oral policies or employee custom. The term does not include separate or single-user restrooms or necessary dressing or sleeping areas provided to assure privacy between the sexes. The Bidder agrees that (except where it has obtained identical certifications from proposed subcontractors for specific time periods) it will obtain identical certifications from proposed subcontractors prior to the award of subcontracts exceeding \$10,000 which are not exempt from the provisions of the Equal Opportunity Clause and that it will retain such certifications in its files.

Article 9 – Miscellaneous

- a.** CONTRACTOR understands that it shall be solely responsible for the means, methods, techniques, sequences and procedures of construction in connection with completion of the Work;
- b.** CONTRACTOR understands and agrees that it shall not accomplish any work or furnish any materials that are not covered or authorized by the Contract Documents unless authorized in writing by the OWNER or ENGINEER;
- c.** The rights of each party under this Agreement shall not be assigned or transferred to any other person, entity, firm or corporation without prior written consent of both parties;
- d.** OWNER and CONTRACTOR each bind itself, their partners, successors, assigns and legal representatives to the other party in respect to all covenants, agreements, and obligations contained in the Contract Documents.

Article 10 – OWNER’S Representative

The OWNER’S Representative, herein referred to as ENGINEER, is defined as follows:

**Crawford, Murphy & Tilly, Inc.
One Memorial Drive, Suite 500 St. Louis, MO 63102**

Said ENGINEER will act as the OWNER’S representative and shall assume all rights and authority assigned to the ENGINEER as stated within the Contract Documents in connection with the completion of the Project Work.

IN WITNESS WHEREOF, OWNER and CONTRACTOR have executed five (5) copies of this Agreement on the day and year first noted herein.

OWNER

Name: _____

Address: _____

By: _____

Signature

Title of Representative

ATTEST:

By: _____

Signature

Title

CONTRACTOR

Name: _____

Address: _____

By: _____

Signature

Title of Representative

ATTEST

By: _____

Signature

Title

REVISED PLAN SHEETS

Path: K:\WashMOA\23005527-00_RMY\Design\Draw\Sheets\G-002_Summary of Quantities.dwg
Date: Wednesday, April 16, 2025 1:53:15 PM

EXTEND RUNWAY 33 (BASE BID)			
ITEM #	DESCRIPTION	UNIT	RUNWAY EXTENSION QUANTITIES
C-100-14.1	CONTRACTOR QUALITY CONTROL PLAN	LS	1.0
C-102-5.1	INSTALLATION AND REMOVAL OF SILT FENCE	LF	615.0
C-102-5.2	DITCH CHECKS	EA	3.0
C-105-5.1	MOBILIZATION (10% LIMIT) - BASE BID	LS	1.0
C-105-5.3	ENGINEER'S FIELD OFFICE	LS	1.0
P-152-4.1	EMBANKMENT IN PLACE	CY	2,679.0
P-152-4.2	UNSUITABLE SUBSTRATE	CY	1,135.0
P-155-5.1	12" LIME TREATED SUBGRADE (7%)	SY	3,406.0
P-155-5.2	LIME	TON	164.0
P-208-5.1	6" CRUSHED AGGREGATE BASE COURSE	SY	3,406.0
P-208-5.2	6" AGGREGATE FOR HAUL ROUTE	SY	5,495.0
P-501-8.2	PORTLAND CEMENT CONCRETE PAVEMENT - 6"	SY	3,217.0
P-620-5.1	WATERBORNE PAINT, YELLOW, WITH REFLECTIVE MEDIA	SF	6,371.0
P-620-5.2	WATERBORNE PAINT, BLACK, WITHOUT REFLECTIVE MEDIA	SF	14,478.0
P-620-5.3	WATERBORNE PAINT, WHITE, WITH REFLECTIVE MEDIA	SF	37,634.0
P-620-5.4	PAVEMENT MARKING REMOVAL	SF	73,231.0
D-705-5.1	4" PERFORATED PIPE FOR UNDERDRAINS	LF	785.0
D-705-5.2	UNDERDRAIN CLEANOUT/COLLECTION STRUCTURE	EA	3.0
D-705-5.3	DIRECT CONNECTION	EA	1.0
T-901-5.1	SEEDING	AC	7.8
T-904-5.1	SODDING	SF	1,943.0
T-908-5.1	MULCHING	AC	7.8
L-108-5.1	1/C #8, L-824, TYPE C, 5KV CABLE IN 1" UNIT DUCT	LF	1,350.0
L-108-5.2	PAPI 33 CIRCUIT, 2-#4 TYPE USE, 1-#8 GND., IN 1-1/2" UNIT DUCT	LF	556.0
L-108-5.3	REIL 33 CIRCUIT, 2-#4 TYPE USE, 1-#8 GND., IN 1-1/2" UNIT DUCT	LF	970.0
L-108-5.4	COUNTERPOISE, COPPER GUARD WIRE	LF	2,876.0
L-115-5.1	SPLICE CAN	EA	2.0
L-125-5.1	INCANDESCENT MIRL BASE MOUNTED	EA	4.0
L-125-5.2	INCANDESCENT BI-DIRECTIONAL BASE MOUNTED THRESHOLD LIGHT	EA	8.0
L-125-5.4	INSTALL NEW LED REIL AND EQUIPMENT RACK	EA	1.0
L-125-5.5	INSTALL NEW LED PAPI, 4-BOX SYSTEM AND EQUIPMENT RACK	EA	1.0
L-125-5.7	RELOCATE EXISTING RUNWAY THRESHOLD LIGHT	EA	8.0
L-125-5.8	REMOVE EXISTING RUNWAY THRESHOLD LIGHT	EA	8.0
L-125-5.9	REMOVE EXISTING 4-BOX PAPI SYSTEM	EA	1.0
L-125-5.10	REMOVE EXISTING REIL	EA	1.0
L-125-5.11	RUNWAY UNLIGHTED SIGN, UNLIGHTED ON NEW PCC PAD	EA	1.0
SP-1-5.1	TEMPORARY DISPLACED THRESHOLD	LS	1.0

EXTEND TAXIWAY A (ADDITIVE ALTERNATE)			
ITEM #	DESCRIPTION	UNIT	TAXIWAY EXTENSION QUANTITIES
C-102-5.1	INSTALLATION AND REMOVAL OF SILT FENCE	LF	314.0
C-102-5.2	DITCH CHECKS	EA	7.0
C-102-5.3	RIP RAP	SY	20.0
C-105-5.2	MOBILIZATION (10% LIMIT) - ADDITIVE ALTERNATE	LS	1.0
P-152-4.1	EMBANKMENT IN PLACE	CY	3,700.0
P-152-4.2	UNSUITABLE SUBSTRATE	CY	1,060.0
P-155-5.1	12" LIME TREATED SUBGRADE (7%)	SY	3,191.0
P-155-5.2	LIME	TON	153.0
P-208-5.1	6" CRUSHED AGGREGATE BASE COURSE	SY	3,191.0
P-501-8.2	PORTLAND CEMENT CONCRETE PAVEMENT - 6"	SY	2,896.0
P-620-5.1	WATERBORNE PAINT, YELLOW, WITH REFLECTIVE MEDIA	SF	660.0
P-620-5.2	WATERBORNE PAINT, BLACK, WITHOUT REFLECTIVE MEDIA	SF	1,291.0
D-701-5.1	REINFORCED CONCRETE PIPE CLASS IV (18")	LF	128.0
D-705-5.1	4" PERFORATED PIPE FOR UNDERDRAINS	LF	547.0
D-705-5.2	UNDERDRAIN CLEANOUT/COLLECTION STRUCTURE	EA	1.0
D-705-5.3	DIRECT CONNECTION	EA	1.0
D-752-5.1	18" REINFORCED CONCRETE FLARED END SECTION	EA	2.0
T-901-5.1	SEEDING	AC	1.9
T-904-5.1	SODDING	SF	3,381.0
T-908-5.1	MULCHING	AC	1.9
L-110-5.1	4-WAY - 4" PVC CONCRETE ENCASED DUCT BANK	LF	55.0
L-125-5.3	INCANDESCENT BASE MOUNTED TAXIWAY EDGE LIGHT	EA	2.0
L-125-5.6	INSTALL NEW TAXIWAY EDGE REFLECTOR	EA	30.0
L-125-5.11	RUNWAY UNLIGHTED SIGN, UNLIGHTED ON NEW PCC PAD	EA	1.0



ONE MEMORIAL DRIVE, SUITE 500
ST. LOUIS, MO 63102

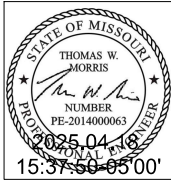

The Professional Engineer's seal affixed to this sheet applies only to the material and items shown on this sheet. All drawings, instruments or other documents not exhibiting this seal shall not be considered prepared by this engineer, and this engineer expressly disclaims any and all responsibility for such plan, drawings or documents not exhibiting this seal.

APRIL 1, 2025

EXTEND RUNWAY 33 AND
TAXIWAY A



CITY OF WASHINGTON

WASHINGTON REGIONAL
AIRPORT

WASHINGTON, MISSOURI

1	4/18/25	ADDENDUM NO. 1
MARK	DATE	DESCRIPTION
CMT PROJECT NO:		
CMT PROJECT NO:		
CAD DWG FILE: G-002 SUMMARY OF QUANTITIES		
DESIGNED BY: PHN		
DRAWN BY: PHN		
CHECKED BY: TWM		
APPROVED BY: TWM		
COPYRIGHT		

SHEET TITLE
SUMMARY OF QUANTITIES
G-002
SHEET 2 OF 54

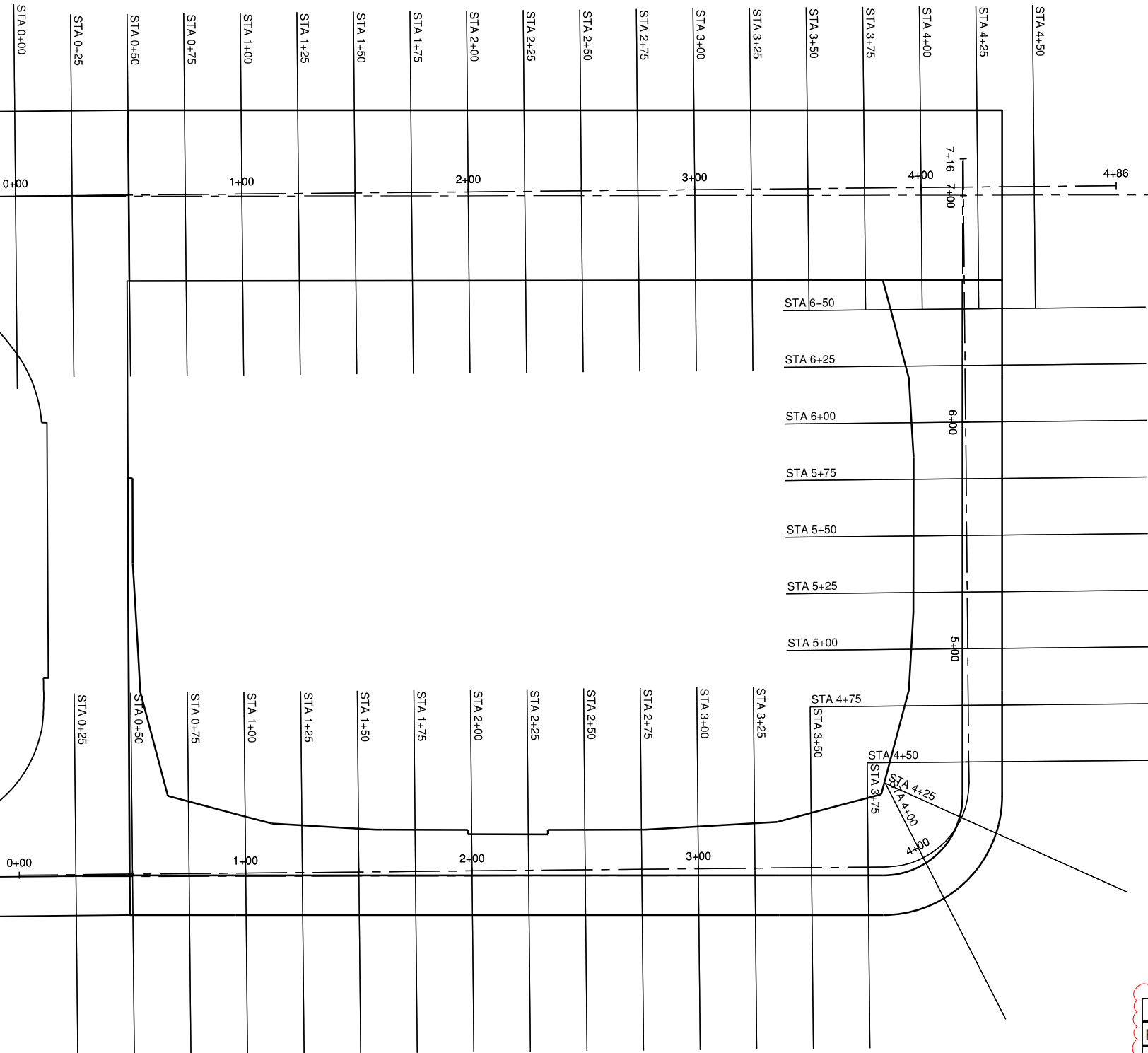
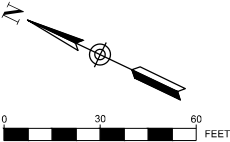

EARTHWORK TABLE		
RUNWAY CUT	2476	CY
TAXIWAY CUT	2522	CY
RUNWAY FILL	2679	CY
TAXIWAY FILL	3700	CY



ONE MEMORIAL DRIVE, SUITE 500
ST. LOUIS, MO 63102

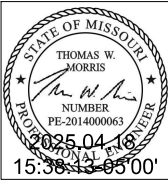

The Professional Engineer's seal affixed to this sheet applies only to the material and items shown on this sheet. All drawings, instruments or other documents not exhibiting this seal shall not be considered prepared by this engineer, and the engineer expressly disclaims any and all responsibility for such plan, drawings or documents not exhibiting this seal.

APRIL 1, 2025

EXTEND RUNWAY 33 AND
TAXIWAY A



CITY OF WASHINGTON

WASHINGTON REGIONAL
AIRPORT

WASHINGTON, MISSOURI

1	4/18/25	ADDENDUM NO. 1

MARK	DATE	DESCRIPTION
CMT PROJECT NO:		
CMT PROJECT NO:		
CAD DWG FILE: CROSS SECTION INDEX SHEET		
DESIGNED BY: PHN		
DRAWN BY: PHN		
CHECKED BY: TWM		
APPROVED BY: TWM		
COPYRIGHT		

SHEET TITLE

CROSS SECTION INDEX

C-139

SHEET 48 OF 54

FEDERAL WAGE RATES

"General Decision Number: MO20250001 04/11/2025

Superseded General Decision Number: MO20240001

State: Missouri

Construction Types: Heavy and Highway

Counties: Missouri Statewide.

HEAVY AND HIGHWAY CONSTRUCTION PROJECTS

Note: Contracts subject to the Davis-Bacon Act are generally required to pay at least the applicable minimum wage rate required under Executive Order 14026 or Executive Order 13658. Please note that these Executive Orders apply to covered contracts entered into by the federal government that are subject to the Davis-Bacon Act itself, but do not apply to contracts subject only to the Davis-Bacon Related Acts, including those set forth at 29 CFR 5.1(a)(1).

If the contract is entered into on or after January 30, 2022, or the contract is renewed or extended (e.g., an option is exercised) on or after January 30, 2022:	<ul style="list-style-type: none"> . Executive Order 14026 generally applies to the contract. . The contractor must pay all covered workers at least \$17.75 per hour (or the applicable wage rate listed on this wage determination, if it is higher) for all hours spent performing on the contract in 2025.
If the contract was awarded on or between January 1, 2015 and January 29, 2022, and the contract is not renewed or extended on or after January 30, 2022:	<ul style="list-style-type: none"> . Executive Order 13658 generally applies to the contract. . The contractor must pay all covered workers at least \$13.30 per hour (or the applicable wage rate listed on this wage determination, if it is higher) for all hours spent performing on that contract in 2025.

The applicable Executive Order minimum wage rate will be adjusted annually. If this contract is covered by one of the Executive Orders and a classification considered necessary for performance of work on the contract does not appear on this wage determination, the contractor must still submit a conformance request.

Additional information on contractor requirements and worker protections under the Executive Orders is available at <http://www.dol.gov/whd/govcontracts>.

Modification Number	Publication Date
0	01/03/2025
1	01/31/2025
2	02/07/2025

3 02/21/2025
4 04/11/2025

CARP0002-002 05/01/2024

ST. LOUIS COUNTY AND CITY

	Rates	Fringes
Carpenters.....	\$ 41.71	21.85

CARP0005-006 05/01/2024

CASS (Richards-Gebauer AFB ONLY), CLAY, JACKSON, PLATTE AND RAY
COUNTIES

	Rates	Fringes
Carpenters:		
CARPENTERS & LATHERS.....	\$ 44.63	22.40
MILLWRIGHTS & PILEDRIVERS...	\$ 44.63	22.40

CARP0011-001 05/01/2024

	Rates	Fringes
Carpenter and Piledriver		
ADAIR, AUDRAIN (West of Hwy 19), BOONE, CALLAWAY, CHARITON, COLE, COOPER, HOWARD, KNOX, LINN, MACON, MILLER, MONITEAU, MONROE, OSAGE, PUTNAM, RANDOLPH, SCHUYLER, SHELBY AND SULLIVAN COUNTIES.....	\$ 35.61	22.40
ATCHISON, ANDREW, BATES, CALDWELL, CARROLL, DAVIESS, DEKALB, GENTRY, GRUNDY, HARRISON, HENRY, HOLT, LIVINGSTON, MERCER, NODAWAY, ST. CLAIR, SALINE AND WORTH COUNTIES.....	\$ 34.98	22.40
AUDRAIN (East of Hwy.19), RALLS, MARION, LEWIS, CLARK AND SCOTLAND COUNTIES.	\$ 35.61	22.40
BARRY, BARTON, CAMDEN, CEDAR, CHRISTIAN, DADE, DALLAS, DOUGLAS, GREENE, HICKORY, JASPER, LACLEDE, LAWRENCE, MCDONALD, NEWTON, OZARK, POLK, STONE, TANEY, VERNON, WEBSTER AND WRIGHT COUNTIES.	\$ 33.25	22.40
BENTON, MORGAN AND PETTIS...	\$ 34.98	22.40
BOLLINGER, BUTLER, CAPE GIRARDEAU, DUNKLIN, MISSISSIPPI, NEW MADRID, PEMISCOT, PERRY, STE. GENEVIEVE, SCOTT, STODDARD AND WAYNE COUNTIES.....	\$ 35.37	22.40
BUCHANAN, CLINTON, JOHNSON AND LAFAYETTE COUNTIES.....	\$ 34.98	22.40
CARTER, HOWELL, OREGON AND RIPLEY COUNTIES.....	\$ 34.04	22.40

CRAWFORD, DENT, GASCONADE, IRON, MADISON, MARIES, MONTGOMERY, PHELPS, PULASKI, REYNOLDS, SHANNON AND TEXAS COUNTIES.....	\$ 35.37	22.40
FRANKLIN COUNTY.....	\$ 42.19	22.40
JEFFERSON AND ST. CHARLES COUNTIES.....	\$ 42.19	22.40
LINCOLN COUNTY.....	\$ 38.04	22.40
PIKE, ST. FRANCOIS AND WASHINGTON COUNTIES.....	\$ 36.13	22.40
WARREN COUNTY.....	\$ 38.04	22.40

ELEC0001-002 06/02/2024

BOLLINGER, BUTLER, CAPE GIRARDEAU, CARTER, DUNKLIN, FRANKLIN,
IRON, JEFFERSON, LINCOLN, MADISON, MISSISSIPPI, NEW MADRID,
PEMISCOT, PERRY, REYNOLDS, RIPLEY, ST. CHARLES, ST. FRANCOIS,
ST. LOUIS (City and County), STE. GENEVIEVE, SCOTT, STODDARD,
WARREN, WASHINGTON AND WAYNE COUNTIES

	Rates	Fringes
Electricians.....	\$ 47.04	18.196

ELEC0002-001 09/09/2024

ADAIR, AUDRAIN, BOONE, CALLAWAY, CAMDEN, CARTER, CHARITON,
CLARK, COLE, COOPER, CRAWFORD, DENT, FRANKLIN, GASCONADE,
HOWARD, HOWELL, IRON, JEFFERSON, KNOX, LEWIS, LINCON, LINN,
MACON, MARIES, MARION, MILLER, MONITEAU, MONROE, MONTGOMERY,
MORGAN, OREGON, OSAGE, PERRY, PHELPS, PIKE, PULASKI, PUTNAM,
RALLS, RANDOLPH, REYNOLDS, RIPLEY, ST. CHARLES, ST. FRANCOIS,
ST. LOUIS (City and County), STE. GENEVIEVE, SCHUYLER,
SCOTLAND, SHANNON, SHELBY, SULLIVAN, TEXAS, WARREN AND
WASHINGTON COUNTIES

	Rates	Fringes
Line Construction:		
Equipment Operator.....	\$ 47.77	24.68
Groundman & Truck Driver....	\$ 36.49	20.56
Lineman & Cable Splicer.....	\$ 55.65	27.56

ELEC0053-005 01/01/2025

ANDREW, ATCHINSON, BARRY, BARTON, BATES, BENTON, BUCHANAN,
CALDWELL, CARROLL, CASS, CEDAR, CHRISTIAN, CLAY, CLINTON, DADE,
DALLAS, DAVIES, DEKALB, DOUGLAS, GENTRY, GREENE, GRUNDY,
HARRISON, HENRY, HICKORY, HOLT, LAFAYETTE, JACKSON, JASPER,
LACLEDE, LAWRENCE, LIVINGSTON, JOHNSON, MCDONALD, MERCER,
NEWTON, NODAWAY, OZARK, PETTIS, PLATTE, POLK, RAY, SALINE, ST.
CLAIR, STONE, TANEY, VERNON, WEBSTER, WORTH AND WRIGHT COUNTIES

	Rates	Fringes
Line Construction:		
Groundman Powderman.....	\$ 37.14	1.5%+19.76
Groundman.....	\$ 34.65	1.5%+18.93
Lineman Operator.....	\$ 52.45	1.5%+26.05
Lineman.....	\$ 56.18	1.5%+24.22

ELEC0095-001 06/01/2024

BARRY, BARTON, CEDAR, DADE, JASPER, LAWRENCE, MCDONALD, NEWTON,
ST CLAIR, AND VERNON COUNTIES

	Rates	Fringes
--	-------	---------

Electricians:

Cable Splicers.....	\$ 25.40	12.19
Electricians.....	\$ 31.09	8%+18.04

* ELEC0124-007 08/26/2024

BATES, BENTON, CARROLL, CASS, CLAY, COOPER, HENRY, JACKSON,
JOHNSON, LAFAYETTE, MORGAN, PETTIS, PLATTE, RAY AND SALINE
COUNTIES:

	Rates	Fringes
--	-------	---------

Electricians.....	\$ 51.01	26.25
-------------------	----------	-------

* ELEC0257-003 03/01/2025

AUDRAIN (Except Cuivre Township), BOONE, CALLAWAY, CAMDEN,
CHARITON, COLE, CRAWFORD, DENT, GASCONADE, HOWARD, MARIES,
MILLER, MONITEAU, OSAGE, PHELPS AND RANDOLPH COUNTIES

	Rates	Fringes
--	-------	---------

Electricians:

Cable Splicers.....	\$ 30.42	16.085
Electricians.....	\$ 40.50	23.26

ELEC0350-002 12/01/2024

ADAIR, AUDRAIN (East of Highway 19), CLARK, KNOX, LEWIS, LINN,
MACON, MARION, MONROE, MONTGOMERY, PIKE, PUTNAM, RALLS,
SCHUYLER, SCOTLAND, SHELBY AND SULLIVAN COUNTIES

	Rates	Fringes
--	-------	---------

Electricians.....	\$ 37.60	22.145
-------------------	----------	--------

* ELEC0453-001 09/01/2024

	Rates	Fringes
--	-------	---------

Electricians:

CHRISITAN, DALLAS, DOUGLAS, GREENE, HICKORY, HOWELL, LACLEDE, OREGON, OZARK, POLK, SHANNON, WEBSTER and WRIGHT COUNTIES..	\$ 32.40	19.11
PULASKI and TEXAS COUNTIES..	\$ 39.70	19.84
STONE and TANEY COUNTIES....	\$ 28.65	18.34

ELEC0545-003 06/01/2024

ANDREW, BUCHANAN, CLINTON, DEKALB, ATCHISON, HOLT, MERCER,
GENTRY, HARRISON, DAVIESS, GRUNDY, WORTH, LIVINGSTON, NODAWAY,
AND CALDWELL COUNTIES

	Rates	Fringes
Electricians:.....	\$ 39.61	20.59

ELEC0702-004 01/06/2025		

BOLLINGER, BUTLER, CAPE GIRARDEAU, DUNKLIN, MADISON,
MISSISSIPPI, NEW MADRID, PEMISCOT, SCOTT, STODDARD AND WAYNE
COUNTIES

	Rates	Fringes
Line Construction:		
Groundman - Class A.....	\$ 38.18	29%+8.85
Groundman-Equipment Operator Class II (all other equipment).....	\$ 46.49	29%+8.85
Heavy-Equipment Operator Class I (all crawler type equipment D-4 and larger)...	\$ 52.13	29%+8.85
Lineman.....	\$ 74.55	29%+8.85

ENGI0101-001 05/01/2020		

ANDREW, ATCHISON, BATES, BENTON, BUCHANAN, CALDWELL, CARROLL,
CHARITON, CLINTON, COOPER, DAVIESS, DEKALB, GENTRY, GRUNDY,
HARRISON, HENRY, HOLT, HOWARD, JOHNSON, LAFAYETTE, LINN,
LIVINGSTON, MERCER, NODAWAY, PETTIS, SALINE, SULLIVAN AND WORTH
COUNTIES

	Rates	Fringes
Power equipment operators:		
GROUP 1.....	\$ 34.73	18.20
GROUP 2.....	\$ 34.33	18.20
GROUP 3.....	\$ 32.33	18.20

POWER EQUIPMENT OPERATORS CLASSIFICATIONS

GROUP 1: Asphalt roller operator, finish; asphalt paver and spreader; asphalt plant operator; auto grader or trimmer or sub-grader; backhoe; blade operator (all types); boilers - 2; booster pump on dredge; bulldozer operator; boring machine (truck or crane mounted); clamshell operator; concrete mixer paver; concrete plant operator; concrete pump operator; crane operator; derrick or derrick trucks; ditching machine; dragline operator; dredge engineman; dredge operator; drill cat with compressor mounted (self-contained) or similar type self-propelled rotary drill (not air tract); drilling or boring machine (rotary-self-propelled); finishing machine operator; greaser; high loader-fork lift-skid loader (all types); hoisting engineer (2 active drums); locomotive operator (standard guage); mechanics and welders (field and plants); mucking machine operator; pile drive operator; pitman crane or boom truck (all types); push cat; quad track; scraper operators (all types); shovel operator; sideboom cats; side discharge spreader; skimmer scoop operators; slip form paver operator (CMI, Rex, Gomeco or equal); la tourneau rooter (all tiller types); tow boat operator; truck crane; wood and log chippers (all types).

GROUP 2: A-frame truck operator; articulated dump truck; back filler operator; boilers (1); chip spreader; churn drill operator; compressor; concrete mixer operator, skip loader; concrete saws (self-propelled); conveyor operator; crusher operator; distributor operator; elevating grader operator; farm tractor (all attachments); fireman rig; float operator; form grade operator; hoisting engine (one drum); maintenance operator; multiple compactor; pavement breaker, self-propelled hydra-hammer (or similar type); paymill operator; power shield; pumps; roller operator (with or without blades); screening and washing plant; self-propelled street broom or sweeper; siphons and jets; straw blower; stump cutting machine; siphons and jets; tank car heater operator (combination boiler and booster); welding machine; vibrating machine operator (not hand held); welding machine.

GROUP 3: (a) Oiler;
(b) Oiler driver
(c) Mechanic.

HOURLY PREMIUMS:

THE FOLLOWING CLASSIFICATIONS SHALL RECEIVE (\$.25) ABOVE GROUP 1 RATE: Dragline operator - 3 yds. & over; shovel 3 yds. & over; clamshell 3 yds. & over; Crane, rigs or piledrivers, 100' of boom or over (incl. jib.), hoist - each additional active drum over 2 drums

THE FOLLOWING CLASSIFICATIONS SHALL RECEIVE (\$.50) ABOVE GROUP 1 RATE: Tandem scoop operator; crane, rigs or piledrivers 150' to 200' of boom (incl. jib.)

THE FOLLOWING CLASSIFICATIONS SHALL RECEIVE (\$.75) ABOVE GROUP 1 RATE: Crane rigs, or piledrivers 200 ft. of boom or over (including jib.)

ENGI0101-005 04/01/2022

CASS, CLAY, JACKSON, PLATTE AND RAY COUNTIES

	Rates	Fringes
Power equipment operators:		
GROUP 1.....	\$ 38.42	20.44
GROUP 2.....	\$ 37.38	20.44
GROUP 3.....	\$ 32.91	20.44
GROUP 4.....	\$ 36.26	20.44

POWER EQUIPMENT OPERATORS CLASSIFICATIONS

GROUP 1: Asphalt roller operator, finish; asphalt paver and spreader; asphalt plant operator; auto grader or trimmer or sub-grader; backhoe; blade operator (all types); boilers-2; booster pump on dredge; boring machine (truck or crane mounted); bulldozer operator; clamshell operator; concrete cleaning decontamination machine operator; concrete mixer paver; concrete plant operator; concrete pump operator; crane operator; derrick or derrick trucks; ditching machine; dragline operator; dredge engineman; dredge operator; drillcat with compressor mounted (self-contained) or similar type self propelled rotary drill (not air tract); drilling or boring machine (rotary - self-propelled); finishing machine operator; greaser; heavy

equipment robotics operator/mechanic; horizontal directional drill operator; horizontal directional drill locator; loader-forklift - skid loader (all types); hoisting engineer (2 active drums); locomotive operator (standard guage); master environmental maintenance mechanic; mechanics and welders (field and plants); mucking machine operator; piledrive operator; pitman crane or boom truck (all types); push cat; quad-track; scraper operators (all types); shovel operator; side discharge spreader; sideboom cats; skimmer scoop operator; slip-form paver (CMI, REX, Gomaco or equal); la tourneau rooter (all tiller types); tow boat operator; truck crane; ultra high perssure waterjet cutting tool system operator/mechanic; vacuum blasting machine operator/mechanic; wood and log chippers (all types)

GROUP 2: ""A"" Frame truck operator; back filler operator; boilers (1); chip spreader; churn drill operator; concrete mixer operator, skip loader; concrete saws (self-propelled); conveyor operator; crusher operator; distributor operator; elevating grader operator; farm tractor (all attachments); fireman rig; float operator; form grader operator; hoisting engine (1 drum); maintenance operator; multiple compactor; pavement breaker, self-propelled hydra- hammer (or similar type); power shield; paymill operator; pumps; siphons and jets; stump cutting machine; tank car heater operator (combination boiler and booster); compressor; roller operator (with or without blades); screening and washing plant; self-propelled street broom or sweeper; straw blower; tank car heater operator (combination boiler and booster); vibrating machine operator (not hand held)

GROUP 3: Oilers

GROUP 4: Oiler Driver (All Types)

FOOTNOTE:

HOURLY PREMIUMS FOLLOWING CLASSIFICATIONS SHALL RECEIVE (\$1.00) ABOVE GROUP 1 RATE:

Clamshells - 3 yd. capacity or over; Cranes or rigs, 80 ft. of boom or over (including jib); Draglines, 3 yd. capacity or over;

Piledrivers 80 ft. of boom or over (including jib);

Shovels & backhoes, 3 yd. capacity or over.

ENGI0101-022 05/01/2019

BARRY, BARTON, CAMDEN, CEDAR, CHRISTIAN, DADE, DALLAS, DOUGLAS, GREENE, HICKORY, JASPER, LACLEDE, LAWRENCE, MCDONALD, NEWTON, OZARK, POLK, ST. CLAIR, STONE, TANEY, VERNON, WEBSTER AND WRIGHT COUNTIES and CITY OF SPRINGFIELD

	Rates	Fringes
--	-------	---------

Power equipment operators:

GROUP 1.....	\$ 31.72	14.88
GROUP 2.....	\$ 31.37	14.88
GROUP 3.....	\$ 31.17	14.88
GROUP 4.....	\$ 29.12	14.88

POWER EQUIPMENT OPERATORS CLASSIFICATIONS

GROUP 1: Asphalt finishing machine & trench widening spreader; asphalt plant console operator; autograder; automatic slipform paver; backhoe; blade operator - all types; boat operator - tow; boilers-2; central mix concrete plant operator; clamshell operator; concrete mixer paver; crane operator; derrick or derrick trucks; ditching machine; dozer operator; dragline operator; dredge booster pump; dredge engineman; dredge operator; drill cat with compressor mounted on cat; drilling or boring machine rotary self-propelled; highloader; hoisting engine - 2 active drums; launch hammer wheel; locomotive operator; - standard guage; mechanic and welders; mucking machine; off-road trucks; piledriver operator; pitman crane operator; push cat operator; quad trac; scoop operator - all types; shovel operator; sideboom cats; skimmer scoop operators; trenching machine operator; truck crane.

GROUP 2: A-frame; asphalt hot-mix silo; asphalt plant fireman (drum or boiler); asphalt plant man; asphalt plant man; asphalt plant mixer operator; asphalt roller operator; backfiller operator; barber-greene loader; boat operator (bridges and dams); chip spreader; concrete mixer operator - skip loader; concrete plant operator; concrete pump operator; crusher operator; dredge oiler; elevating grader operator; fork lift; greaser-fleet; hoisting engine - 1; locomotive operator - narrow gauge; multiple compactor; pavement breaker; powerbroom - self-propelled; power shield; rooter; side discharge concrete spreader; slip form finishing machine; stumpcutter machine; throttle man; tractor operator (over 50 h.p.); winch truck.

GROUP 3: Boilers - 1; chip spreader (front man); churn drill operator; clef plane operator; concrete saw operator (self-propelled); curb finishing machine; distributor operator; finishing machine operator; flex plane operator; float operator; form grader operator; pugmill operator; roller operator, other than high type asphalt; screening & washing plant operator; siphons & jets; sub-grading machine operator; spreader box operator, self-propelled (not asphalt); tank car heater operator (combination boiler & booster); tractor operator (50 h.p. or less); Ulmac, Ulric or similar spreader; vibrating machine operator, not hand;

GROUP 4: Grade checker; Oiler; Oiler-Driver

HOURLY PREMIUMS:

The following classifications shall receive \$.25 above GROUP 1 rate:

Clamshells - 3 yds. or over; Cranes - Rigs or Piledrivers, 100 ft. of boom or over (including jib);
Draglines - 3 yds. or over; Hoists - each additional active drum over 2 drums; Shovels - 3 yds. or over;

The following classifications shall receive \$.50 above GROUP 1 rate:

Tandem scoop operator; Cranes - Rigs or Piledrivers, 150 ft. to 200 ft. of boom (including jib); Tandem scoop.

The following classifications shall receive \$.75 above GROUP 1 rate:

Cranes - Rigs or Piledrivers, 200 ft. of boom or over (including jib.).

ENGI0513-004 05/06/2024

FRANKLIN, JEFFERSON, LINCOLN, ST CHARLES, AND WARREN COUNTIES

	Rates	Fringes
Power equipment operators:		
GROUP 1.....	\$ 43.46	30.22
GROUP 2.....	\$ 43.46	30.22
GROUP 3.....	\$ 42.16	30.22
GROUP 4.....	\$ 41.72	30.22

POWER EQUIPMENT OPERATORS CLASSIFICATIONS

GROUP 1: Backhoe, Cable; Backhoe, Hydraulic (2 cu yds bucket and under regardless of attachment, one oiler for 2 or 3, two oilers for 4 through 6); Backhoe, Hydraulic over 2 cu yds; Cableway; Crane, Crawler or Truck; Crane, Hydraulic - Truck or Cruiser mounted, 16 tons and over; Crane, Locomotive; crane with boom including jib over 100 ft from pin to pin; Crane using rock socket tool; Derrick, Steam; Derrick Car and Derrick Boat; Dragline, 7 cu yds and over; Dredge; Gradall, Crawler or tire mounted; Locomotive, Gas, Steam & other powers; Pile Driver, Land or Floating; Scoop, Skimmer; Shovel, Power (Electric, Gas, Steam or other powers); Shovel, Power (7 cu yds and over); Switch Boat; Whirley; Air Tugger with air compressor; Anchor Placing Barge; Asphalt Spreader; Athey Force Feeder Loader, self-propelled; Backfilling Machine; Boat Operator - Push Boat or Tow Boat (job site); Boiler, High Pressure Breaking in Period; Boom Truck, Placing or Erecting; Boring Machine, Footing Foundation; Bullfloat; Cherry Picker; Combination Concrete Hoist and Mixer (such as Mixermobile); Compressor, Two 125 CFM and under; Compressor, Two through Four over 125 CFM; Compressor when operator runs throttle; Concrete Breaker (Truck or Tractor mounted); Concrete Pump (such as Pumpcrete machine); Concrete Saw (self-propelled); Concrete Spreader; Conveyor, Large (not selfpropelled) hoisting or moving brick and concrete into, or into and on floor level, one or both; Crane, Climbing (such as Linden); Crane, Hydraulic - Rough Terrain, self-propelled; Crane, Hydraulic - Truck or Cruiser mounted - under 16 tons; Drilling machine - Self-powered, used for earth or rock drilling or boring (wagon drills and any hand drills obtaining power from other sources including concrete breakers, jackhammers and Barco equipment no engineer required); Elevating Grader; Engine Man, Dredge; Excavator or Powerbelt Machine; Finishing Machine, self-propelled oscillating screed; Forklift; Generators, Two through Six 30 KW or over; Grader, Road with power blade; Greaser; Highlift; Hoist, Concrete and Brick (Brick cages or concrete skips operating or on tower, Towermobile, or similar equipment); Hoist, Three or more drums in use; Hoist, Stack; Hydro-Hammer; Lad-A-Vator, hoisting brick or concrete; Loading Machine such as Barber-Greene; Mechanic on job site

GROUP 2: Air Tugger with plant air; Boiler (for power or heating shell of building or temporary enclosures in connection with construction work); Boiler, Temporary; Compressor, One over 125 CFM; Compressor, truck mounted; Conveyor, Large (not self-propelled); Conveyor, Large (not self-propelled) moving brick and concrete (distributing) on floor level; Curb Finishing Machine; Ditch Paving Machine; Elevator (outside); Endless Chain Hoist; Fireman (as required); Form Grader; Hoist, One Drum regardless of

size (except brick or concrete); Lad-A-Vator, other hoisting; Manlift; Mixer, Asphalt, over 8 cu ft capacity; Mixer, one bag capacity or less; Mixer, without side loader, two bag capacity or more; Mixer, with side loader, regardless of size, not Paver; Mud Jack (where mud jack is used in conjunction with an air compressor, operator shall be paid \$.55 per hour in addition to his basic hourly rate for covering both operations); Pug Mill operator; Pump, Sump - self powered, automatic controlled over 2"; Scissor Lift (used for hoisting); Skid Steer Loader; Sweeper, Street; Tractor, small wheel type 50 HP and under with grader blade and similar equipment; Welding Machine, One over 400 amp; Winch, operating from truck

GROUP 3: Boat operator - outboard motor, job site; Conveyors (such as Con-Vay-It) regardless of how used; Elevator (inside); Heater operator, 2 through 6; Sweeper, Floor

GROUP 4: Crane type

HOURLY PREMIUMS:

Backhoe, Hydraulic 2 cu yds or less without oiler - \$2.00;
 Crane, climbing (such as Linden) - \$.50;
 Crane, Pile Driving and Extracting - \$.50
 Crane with boom (including job) over 100 ft from pin to pin - add \$.01 per foot to maximum of \$4.00);
 Crane, using rock socket tool - \$.50;
 Derrick, diesel, gas or electric hoisting material and erecting steel (150 ft or more above ground) - \$.50;
 Dragline, 7 cu yds and over - \$.50;
 Hoist, Three or more drums in use - \$.50;
 Scoop, Tandem - \$.50;
 Shovel, Power - 7 cu yds and over - \$.50;
 Tractor, Tandem Crawler - \$.50;
 Tunnel, man assigned to work in tunnel or tunnel shaft - \$.50;
 Wrecking, when machines are working on second floor or higher - \$.50

 ENGI0513-006 05/06/2024

ADAIR, AUDRAIN, BOLLINGER, BOONE, BUTLER, CALLAWAY, CAPE GIRARDEAU, CARTER, CLARK, COLE, CRAWFORD, DENT, DUNKLIN, GASCONADE, HOWELL, IRON, KNOX, LEWIS, MACON, MADISON, MARIES, MARION, MILLER, MISSISSIPPI, MONITEAU, MONROE, MONTGOMERY, MORGAN, NEW MADRID, OREGON, OSAGE, PEMISCOT, PERRY, PHELPS, PIKE, PULASKI, PUTNAM, RALLS, RANDOLPH, REYNOLDS, RIPLEY, ST. FRANCOIS, STE. GENEVIEVE, SCHUYLER, SCOTLAND, SCOTT, SHANNON, SHELBY, STODDARD, TEXAS, WASHINGTON, AND WAYNE COUNTIES

	Rates	Fringes
--	-------	---------

Power equipment operators:

GROUP 1.....	\$ 43.46	30.22
GROUP 2.....	\$ 43.46	30.22
GROUP 3.....	\$ 42.16	30.22
GROUP 4.....	\$ 41.72	30.22

POWER EQUIPMENT OPERATORS CLASSIFICATIONS

GROUP 1: Asphalt finishing machine & trench widening

spreader, asphalt plant console operator; autograder; automatic slipform paver; back hoe; blade operator - all types; boat operator tow; boiler two; central mix concrete plant operator; clam shell operator; concrete mixer paver; crane operator; derrick or derrick trucks; ditching machine; dozer operator; dragline operator; dredge booster pump; dredge engineman; dredge operator; drill cat with compressor mounted on cat; drilling or boring machine rotary self-propelled; highloader; hoisting engine 2 active drums; launchhammer wheel; locomotive operator standrad guage; mechanics and welders; mucking machine; piledriver operator; pitman crane operator; push cat operator; guad-trac; scoop operator; sideboom cats; skimmer scoop operator; trenching machine operator; truck crane, shovel operator.

GROUP 2: A-Frame; asphalt hot-mix silo; asphalt roller operator asphalt plant fireman (drum or boiler); asphalt plant man; asphalt plant mixer operator; backfiller operator; barber-greene loader; boat operator (bridge & dams); chip spreader; concrete mixer operator skip loader; concrete plant operator; concrete pump operator; dredge oiler; elevating graded operator; fork lift; grease fleet; hoisting engine one; locomotive operator narrow guage; multiple compactor; pavement breaker; powerbroom self-propelled; power shield; rooter; slip-form finishing machine; stumpcutter machine; side discharge concrete spreader; throttleman; tractor operator (over 50 hp); winch truck; asphalt roller operator; crusher operator.

GROUP 3: Spreader box operator, self-propelled not asphalt; tractor operator (50 h.p. or less); boilers one; chip spreader (front man); churn drill operator; compressor over 105 CFM 2-3 pumps 4" & over; 2-3 light plant 7.5 KWA or any combination thereof; clef plane operator; compressor maintenance operator 2 or 3; concrete saw operator (self-propelled); curb finishing mancine; distributor operator; finishing machine operator; flex plane operator; float operator; form grader operator; pugmill operator; riller operator other than high type asphalt; screening & washing plant operator; siphons & jets; subgrading machine operator; tank car heater (combination boiler & booster); ulmac, ulric or similar spreader; vibrating machine operator; hydrobroom.

GROUP 4: Oiler; grout machine; oiler driver; compressor over 105 CFM one; conveyor operator one; maintenance operator; pump 4" & over one.

FOOTNOTE: HOURLY PREMIUMS

Backhoe hydraulic, 2 cu. yds. or under Without oiler - \$2.00
 Certified Crane Operator - \$1.50;
 Certified Hazardous Material Operator \$1.50;
 Crane, climbing (such as Linden) - \$0.50;
 Crane, pile driving and extracting - \$0.50;
 Crane, with boom (including jib) over 100' from pin to pin add \$0.01 per foot to maximum of \$4.00;
 Crane, using rock socket tool - \$0.50;
 Derrick, diesel, gas or electric, hoisting material and erecting steel (150' or more above the ground) - \$0.50;
 Dragline, 7 cu. yds, and over - \$0.50;
 Hoist, three or more drums in use - \$0.50; Scoop, Tandem - \$0.50;
 Shovel, power - 7 cu. yds. or more - \$0.50;

Tractor, tandem crawler - \$0.50;
 Tunnel, man assigned to work in tunnel or tunnel shaft -
 \$0.50;
 Wrecking, when machine is working on second floor or higher -
 \$0.50;

 ENGI0513-007 05/06/2024

ST. LOUIS CITY AND COUNTY

	Rates	Fringes
Power equipment operators:		
GROUP 1.....	\$ 43.46	30.22
GROUP 2.....	\$ 43.46	30.22
GROUP 3.....	\$ 42.16	30.22
GROUP 4.....	\$ 41.72	30.22

POWER EQUIPMENT OPERATORS CLASSIFICATIONS

GROUP 1: Backhoe, cable or hydraulic; cableway; crane crawler or truck; crane, hydraulic-truck or cruiser mounted 16 tons & over; crane locomotive; derrick, steam; derrick car & derrick boat; dragline; dredge; gradall, crawler or tire mounted; locomotive, gas, steam & other powers; pile driver, land or floating; scoop, skimmer; shovel, power (steam, gas, electric or other powers); switch boat; whirley.

GROUP 2: Air tugger w/air compressor; anchor-placing barge; asphalt spreader; atehy force feeder loader (self-propelled); backfilling machine; backhoe-loader; boat operator-push boat or tow boat (job site); boiler, high pressure breaking in period; boom truck, placing or erecting; boring machine, footing foundation; bull- float; cherry picker; combination concrete hoist & mixer (such as mixer mobile); compressor (when operator runs throttle); concrete breaker (truck or tractor mounted); concrete pump, such as pump-crete machine; concrete saw (self-propelled), concrete spreader; conveyor, large (not self-propelled), hoisting or moving brick and concrete into, or into and on floor level, one or both; crane, hydraulic-rough terrain, self-propelled; crane hydraulic-truck or cruiser mounted-under 16 tons; drilling machines, self-powered use for earth or rock drilling or boring (wagon drills nd any hand drills obtaining power from other sources including concrete breakers, jackhammers and barco equipment-no engineer required); elevating grader; engineman, dredge; excavator or powerbelt machine; finishing machine, self-propelled oscillating screed; forklift; grader, road with power blade; highlift. greaser; hoist, stack, hydro-hammer; loading machine (such as barber-green); machanic, on job site; mixer, pipe wrapping machines; plant asphalt; plant, concrete producing or ready-mix job site; plant heating-job site; plant mixing-job site; plant power, generating-job site; pumps, two through six self-powered over 2""; pumps, electric submersible, two through six, over 4""; quad-track; roller, asphalt, top or sub-grade; scoop, tractor drawn; spreader box; sub-grader; tie tamper; tractor-crawler, or wheel type with or without power unit, power take-offs and attachments regardless of size; trenching machine; tunnel boring machine; vibrating machine automatic, automatic propelled; welding machines (gasoline or diesel) two through six; well drilling machine

GROUP 3: Conveyor, large (not self-propelled); conveyor, large (not self-propelled) moving brick and concrete distributing) on floor level; mixer two or more mixers of one bag capacity or less; air tugger w/plant air; boiler, for power or heating on construction projects; boiler, temporary; compressor (mounted on truck; curb finishing machine; ditch paving machine; elevator; endless chain hoist; form grader; hoist, one drum regardless of size; lad-a-vator; manlift; mixer, asphalt, over 8 cu. ft. capacity, without side loader, 2 bag capacity or more; mixer, with side loader, regardless of size; pug mill operator; pump, sump-self-powered, automatic controlled over 2" during use in connection with construction work; sweeper, street; welding machine, one over 400 amp.; winch operating from truck; scissor lift (used for hoisting); tractor, small wheel type 50 h.p. & under with grader blade & similar equipment; Oiler on dredge and on truck crane.

GROUP 4: Boat operator-outboard motor (job site); conveyor (such as con-vay-it) regardless of how used; sweeper, floor

HOURLY PREMIUMS:

Backhoe, hydraulic	
2 cu. yds. or under without oiler	\$2.00
Certified Crane Operator	1.50
Certified Hazardous Material Operator	1.50
Crane, climbing (such as Linden)	.50
Crane, pile driving and extracting	.50
Crane, with boom (including jib) over 100' (from pin to pin) add \$.01 per foot to maximum of	4.00
Crane, using rock socket tool	.50
Derrick, diesel, gas or electric, hoisting material and erecting steel (150' or more above ground)	.50
Dragline, 7 cu. yds. and over	.50
Hoist, three (3) or more drums in use	.50
Scoop, Tandem	.50
Shovel, power - 7 cu. yds. or more	.50
Tractor, tandem crawler	.50
Tunnel, man assigned to work in tunnel or tunnel shaft	.50
Wrecking, when machine is working on second floor or higher	.50

* IRON0010-012 04/01/2025

Rates	Fringes
-------	---------

Ironworkers:

ANDREW, BARTON, BENTON,
CAMDEN, CEDAR, CHARITON,
CHRISTIAN, COOPER, DADE,
DALLAS, DAVIESS, DE KALB,
GENTRY, GREENE, GRUNDY,
HARRISON, HICKORY, HOLT,
HOWARD, LACLEDE, LINN,
LIVINGSTON, MERCER,
MONITEAU, MORGAN, NODAWAY,
PETTIS, POLK, PUTNAM,
RANDLOPH, ST. CLAIR,
SULLIVAN, TANEY, VERNON,
WEBSTER, WRIGHT and WORTH

Counties and portions of
 ADAIR, BOONE, MACON,
 MILLER and RANDOLPH

Counties.....\$ 36.00 34.25

ATCHISON, BATES, BUCHANAN,
 CALDWELL, CARROLL, CASS,
 CLAY, CLINTON, HENRY,
 JACKSON, JOHNSON,
 LAFAYETTE, PETTIS, PLATTE,
 SALINE, AND RAY COUNTIES....\$ 39.00 34.25

 * IRON0010-020 04/01/2025

BARRY, JASPER, LAWRENCE, MCDONALD, NEWTON AND STONE Counties

Rates Fringes

Ironworkers:.....\$ 36.00 34.25

 IRON0321-002 08/01/2023

DOUGLAS, HOWELL and OZARK COUNTIES

Rates Fringes

Ironworker.....\$ 27.00 20.96

 IRON0396-004 08/07/2024

ST. LOUIS (City and County), ST. CHARLES, JEFFERSON, IRON,
 FRANKLIN, LINCOLN, WARREN, WASHINGTON, ST. FRANCOIS, STE.
 GENEVIEVE, and REYNOLDS Counties; and portions of MADISON,
 PERRY, BOLLINGER, WAYNE, and CARTER Counties

Rates Fringes

Ironworker.....\$ 41.67 31.25

 IRON0396-009 08/07/2024

AUDRAIN, CALLAWAY, COLE, CRAWFORD, DENT, GASCONADE, MARIES,
 MONTGOMERY, OSAGE, PHELPS, PIKE, PULASKI, TEXAS and WRIGHT
 Counties; and portions of BOONE, CAMDEN, DOUGLAS, HOWELL,
 LACLEDE, MILLER, MONROE, OREGON, SHANNON and RALLS Counties

Rates Fringes

Ironworker.....\$ 41.67 31.25

 IRON0577-005 06/01/2024

ADAIR, CLARK, KNOX, LEWIS, MACON, MARION, MONROE, RALLS,
 SCHUYLER, SCOTLAND, AND SHELBY COUNTIES

Rates Fringes

Ironworker.....\$ 34.05 25.30

 IRON0782-003 08/01/2023

CAPE GIRARDEAU, MISSISSIPPI, NEW MADRID, SCOTT, & STODDARD
 Counties; and portions of BOLLINGER, BUTLER, CARTER, DUNKLIN,

MADISON, PEMISCOT, PERRY, RIPLEY, and WAYNE Counties

	Rates	Fringes
--	-------	---------

Ironworkers:

Locks, Dams, Bridges and other major work on the Mississippi and Ohio River only.....	\$ 38.77	29.51
All Other Work.....	\$ 33.47	24.12

LAB00042-003 03/01/2023

ST. LOUIS (City and County)

	Rates	Fringes
--	-------	---------

LABORER

Plumber Laborer.....	\$ 36.65	17.12
----------------------	----------	-------

LAB00042-005 03/01/2023

ST. LOUIS (City and County)

	Rates	Fringes
--	-------	---------

LABORER

Dynamiter, Powderman.....	\$ 36.65	17.12
Laborers, Flaggers.....	\$ 36.65	17.12
Wrecking.....	\$ 36.65	17.12

LAB00110-005 05/01/2024

Jefferson and Washington Counties

	Rates	Fringes
--	-------	---------

LABORER (Jefferson County)

GROUP 1.....	\$ 38.24	15.55
GROUP 2.....	\$ 38.24	15.55

LABORER (Washington County)

GROUP 1.....	\$ 35.13	15.55
GROUP 2.....	\$ 35.12	15.55

LABORERS CLASSIFICATIONS

GROUP 1 - General laborer-flagman, carpenter tenders; salamander Tenders; Dump Man; Ticket Takers; loading trucks under bins, hoppers, and conveyors; track man; cement handler; dump man on earth fill; georgie buggy man; material batch hopper man; spreader on asphalt machine; material mixer man (except on manholes); coffer dams; riprap pavers rock, block or brick; scaffolds over ten feet not self-supported from ground up; skip man on concrete paving; wire mesh setters on concrete paving; all work in connection with sewer, water, gas, gasoling, oil, drainage pipe, conduit pipe, tile and duct lines and all other pipe lines; power tool operator; all work in connection with hydraulic or general dredging operations; form setters, puddlers (paving only); straw blower nozzle man; asphalt plant platform man; chuck tender; crusher feeder; men handling creosote ties or creosote materials; men working with and handling epoxy material; topper of standing trees; feeder man on wood pulverizers, board and willow mat

weavers and cable ties on river work; deck hands; pile dike and revetment work; all laborers working on underground tunnels less than 25 ft. where compressed air is not used; abutment and pier hole men working six (6) ft. or more below ground; men working in coffer dams for bridge piers and footing in the river; barco tamper; jackson or any other similar tamp; cutting torch man; liners, curb, gutters, ditch lines; hot mastic kettlemen; hot tar applicator; hand blade operator; mortar men or brick or block manholes; rubbing concrete, air tool operator under 65 lbs.; caulker and lead man; chain or concrete saw under 15 h.p.; signal Gan; Guard rail and sign erectors.

GROUP 2 - Skilled laborers - Vibrator man; asphalt raker; head pipe layer on sewer work; batterboard man on pipe and ditch work; cliff scalers working from bosun's chairs; scaffolds or platforms on dams or power plants over 10 ft. high; air tool operator over 65 lbs.; stringline man on concrete paving; sandblast man; laser beam man; wagon drill; churn drill; air track drill and all other similar type drills, gunite nozzle man; pressure grout man; screed man on asphalt; concrete saw 15 h.p. and over; grade checker; strigline man on electronic grade control; manhole builder; dynamite man; powder man; welder; tunnel man; waterblaster - 1000 psi or over; asbestos and/or hazardous waste removal and/or disposal

LAB00579-005 05/01/2023

	Rates	Fringes
--	-------	---------

LABORER (ANDREW, ATCHISON,
BUCHANAN, CALDWELL, CLINTON,
DAVISS, DEKALB, GENTRY,
GRUNDY, HARRISON, HOLT,
LIVINGSTON, MERCER, NODAWAY
and WORTH COUNTIES.)

GROUP 1.....	\$ 29.04	16.59
GROUP 2.....	\$ 29.39	16.59

LABORER (BARRY, BARTON,
BATES, BENTON, CAMDEN,
CARROLL, CEDAR, CHRISTIAN,
DADE, DALLAS, DOUGLAS,
GREENE, HENRY. HICKORY,
JASPER, JOHNSON, LACLEDE,
LAWRENCE, MCDONALD, MORGAN,
NEWTON, OZARK, PETTIS, POLK,
ST.CLAIR, SALINE, STONE,
TANEY, VERNON, WEBSTER and
WRIGHT COUNTIES)

GROUP 1.....	\$ 28.23	15.60
GROUP 2.....	\$ 28.78	15.60

LABORER (LAFAYETTE COUNTY)

GROUP 1.....	\$ 29.78	15.85
GROUP 2.....	\$ 30.13	15.85

LABORERS CLASSIFICATIONS

GROUP 1: General Laborers - Carpenter tenders; salamander tenders; loading trucks under bins; hoppers & conveyors; track men & all other general laborers; air tool operator; cement handler-bulk or sack; dump man on earth fill; georgie buggy man; material batch hopper man; material

mixer man (except on manholes); coffer dams; riprap pavers - rock, block or brick; signal man; scaffolds over ten feet not self-supported from ground up; skipman on concrete paving; wire mesh setters on concrete paving; all work in connection with sewer, water, gas, gasoline, oil drainage pipe, conduit pipe, tile and duct lines and all other pipe lines; power tool operator, all work in connection with hydraulic or general dredging operations; puddlers (paving only); straw blower nozzle man; asphalt plant platform man; chuck tender; crusher feeder; men handling creosote ties or creosote materials; men working with and handling epoxy material or materials (where special protection is required); rubbing concrete; topper of standing trees; batter board man on pipe and ditch work; feeder man on wood pulverizers; board and willow mat weavers and cable tiers on river work; deck hands; pile dike and revetment work; all laborers working on underground tunnels less than 25 feet where compressed air is not used; abutment and pier hole men working six (6) feet or more below ground; men working in coffer dams for bridge piers and footings in the river; ditchliners; pressure groutmen; caulker; chain or concrete saw; cliffscalers working from scaffolds, bosuns' chairs or platforms on dams or power plants over (10) feet above ground; mortarmen on brick or block manholes; toxic and hazardous waste work.

GROUP 2: Skilled Laborers - Head pipe layer on sewer work; laser beam man; Jackson or any other similar tamp; cutting torch man; form setters; liners and stringline men on concrete paving, curb, gutters; hot mastic kettleman; hot tar applicator; sandblasting and gunite nozzle men; air tool operator in tunnels; screed man on asphalt machine; asphalt raker; barco tamper; churn drills; air track drills and all similar drills; vibrator man; stringline man for electronic grade control; manhole builders-brick or block; dynamite and powder men; grade checker.

LAB00660-004 05/01/2024

Clark, Knox, Lewis, Marion, Pike, Ralls, Scotland, Shelby Counties

	Rates	Fringes
LABORER		
GROUP 1.....	\$ 35.13	15.55
GROUP 2.....	\$ 35.13	15.55

LABORERS CLASSIFICATIONS

GROUP 1 - General laborer-flagman, carpenter tenders; salamander Tenders; Dump Man; Ticket Takers; loading trucks under bins, hoppers, and conveyors; track man; cement handler; dump man on earth fill; georgie buggy man; material batch hopper man; spreader on asphalt machine; material mixer man (except on manholes); coffer dams; riprap pavers rock, block or brick; scaffolds over ten feet not self-supported from ground up; skip man on concrete paving; wire mesh setters on concrete paving; all work in connection with sewer, water, gas, gasoling, oil, drainage pipe, conduit pipe, tile and duct lines and all other pipe lines; power tool operator; all work in connection with hydraulic or general dredging operations; form setters,

puddlers (paving only); straw blower nozzle man; asphalt plant platform man; chuck tender; crusher feeder; men handling creosote ties or creosote materials; men working with and handling epoxy material; topper of standing trees; feeder man on wood pulverizers, board and willow mat weavers and cabelee tiers on river work; deck hands; pile dike and revetment work; all laborers working on underground tunnels less than 25 ft. where compressed air is not used; abutment and pier hole men working six (6) ft. or more below ground; men working in coffer dams for bridge piers and footing in the river; barco tamper; jackson or any other similar tamp; cutting torch man; liners, curb, gutters, ditch lines; hot mastic kettlemen; hot tar applicator; hand blade operator; mortar men or brick or block manholes; rubbing concrete, air tool operator under 65 lbs.; caulker and lead man; chain or concrete saw under 15 h.p.; signal Gan; Guard rail and sign erectors.

GROUP 2 - Skilled laborers - Vibrator man; asphalt raker; head pipe layer on sewer work; batterboard man on pipe and ditch work; cliff scalers working from bosun's chairs; scaffolds or platforms on dams or power plants over 10 ft. high; air tool operator over 65 lbs.; stringline man on concrete paving; sandblast man; laser beam man; wagon drill; churn drill; air track drill and all other similar type drills, gunite nozzle man; pressure grout man; screed man on asphalt; concrete saw 15 h.p. and over; grade checker; strigline man on electronic grade control; manhole builder; dynamite man; powder man; welder; tunnel man; waterblaster - 1000 psi or over; asbestos and/or hazardous waste removal and/or disposal

LAB00660-006 03/04/2024

Lincoln, Montgomery, St Charles and Warren Counties

	Rates	Fringes
LABORER (Common or General).....	\$ 36.91	15.62
Lincoln, Monntomery, and		
Warrner Counties.....	\$ 37.69	15.97
St. Charles County.....	\$ 39.11	15.97

LAB00662-001 05/01/2024

Callaway, Cole, Miller and Moniteau Counties

	Rates	Fringes
LABORER		
GROUP 1.....	\$ 38.24	15.55
GROUP 2.....	\$ 38.24	15.55

LABORERS CLASSIFICATIONS

GROUP 1 - General laborer-flagman, carpenter tenders; salamander Tenders; Dump Man; Ticket Takers; loading trucks under bins, hoppers, and conveyors; track man; cement handler; dump man on earth fill; georgie buggy man; material batch hopper man; spreader on asphalt machine; material mixer man (except on manholes); coffer dams; riprap pavers rock, block or brick; scaffolds over ten feet not self-supported from ground up; skip man on concrete

paving; wire mesh setters on concrete paving; all work in connection with sewer, water, gas, gasoling, oil, drainage pipe, conduit pipe, tile and duct lines and all other pipe lines; power tool operator; all work in connection with hydraulic or general dredging operations; form setters, puddlers (paving only); straw blower nozzle man; asphalt plant platform man; chuck tender; crusher feeder; men handling creosote ties or creosote materials; men working with and handling epoxy material; toppler of standing trees; feeder man on wood pulverizers, board and willow mat weavers and cable ties on river work; deck hands; pile dike and revetment work; all laborers working on underground tunnels less than 25 ft. where compressed air is not used; abutment and pier hole men working six (6) ft. or more below ground; men working in coffer dams for bridge piers and footing in the river; barco tamper; jackson or any other similar tamp; cutting torch man; liners, curb, gutters, ditch lines; hot mastic kettlemen; hot tar applicator; hand blade operator; mortar men or brick or block manholes; rubbing concrete, air tool operator under 65 lbs.; caulker and lead man; chain or concrete saw under 15 h.p.; signal Gan; Guard rail and sign erectors.

GROUP 2 - Skilled laborers - Vibrator man; asphalt raker; head pipe layer on sewer work; batterboard man on pipe and ditch work; cliff scalers working from bosun's chairs; scaffolds or platforms on dams or power plants over 10 ft. high; air tool operator over 65 lbs.; stringline man on concrete paving; sandblast man; laser beam man; wagon drill; churn drill; air track drill and all other similar type drills, gunite nozzle man; pressure grout man; screed man on asphalt; concrete saw 15 h.p. and over; grade checker; stringline man on electronic grade control; manhole builder; dynamite man; powder man; welder; tunnel man; waterblaster - 1000 psi or over; asbestos and/or hazardous waste removal and/or disposal

* LAB00663-002 04/01/2025

CASS, CLAY, JACKSON, PLATTE AND RAY COUNTIES

	Rates	Fringes
LABORER		
GROUP 1.....	\$ 36.24	15.87
GROUP 2.....	\$ 37.45	15.87

LABORERS CLASSIFICATIONS

GROUP 1: General laborers, Carpenter tenders, salamander tenders, loading trucks under bins, hoppers and conveyors, track men and all other general laborers, air tool operator, cement handler (bulk or sack), chain or concrete saw, deck hands, dump man on earth fill, Georgie Buggies man, material batch hopper man, scale man, material mixer man (except on manholes), coffer dams, abutments and pier hole men working below ground, riprap pavers rock, black or brick, signal man, scaffolds over ten feet not self-supported from ground up, skipman on concrete paving, wire mesh setters on concrete paving, all work in connection with sewer, water, gas, gasoling, oil, drainage pipe, conduit pipe, tile and duct lines and all other pipelines, power tool operator, all work in connection with

hydraulic or general dredging operations, straw blower nozzle man, asphalt plant platform man, chuck tender, crusher feeder, men handling creosote ties on creosote materials, men working with and handling epoxy material or materials (where special protection is required), topper of standing trees, batter board man on pipe and ditch work, feeder man on wood pulverizers, board and willow mat weavers and cable tiers on river work, deck hands, pile dike and revetment work, all laborers working on underground tunnels less than 25 feet where compressed air is not used, abutment and pier hole men working six (6) feet or more below ground, men working in coffer dams for bridge piers and footings in the river, ditchliners, pressure groutmen, caulker and chain or concrete saw, cliffscalers working from scaffolds, bosuns' chairs or platforms on dams or power plants over (10) feet above ground, mortarmen on brick or block manholes, signal man.

GROUP 2: Skilled Laborer - spreader or screed man on asphalt machine, asphalt raker, grade checker, vibrator man, concrete saw over 5 hp., laser beam man, barco tamper, jackson or any other similar tamp, wagon driller, churn drills, air track drills and other similar drills, cutting torch man, form setters, liners and stringline men on concrete paving, curb, gutters and etc., hot mastic kettelman, hot tar applicator, hand blade operators, mortar men on brick or block manholes, sand blasting and gunnite nozzle men, rubbing concrete, air tool operator in tunnels, head pipe layer on sewer work, manhole builder (brick or block), dynamite and powder men.

LAB00840-011 05/01/2024

Crawford, Dent, Franklin, Gasconade, Howell, Maries, Oregon, Osage, Phelps, Pulaski, Shannon and Texas Counties

	Rates	Fringes
LABORER (Crawford, Dent, Gasconade, Howell, Maries, Oregon, Osage, Phelps, Pulaski, Shannon and Texas Counties)		
GROUP 1.....	\$ 35.13	15.55
GROUP 2.....	\$ 35.13	15.55
LABORER (Franklin County)		
GROUP 1.....	\$ 38.19	15.55
GROUP 2.....	\$ 38.19	15.55

LABORERS CLASSIFICATIONS

GROUP 1 - General laborer-flagman, carpenter tenders; salamander Tenders; Dump Man; Ticket Takers; loading trucks under bins, hoppers, and conveyors; track man; cement handler; dump man on earth fill; georgie buggy man; material batch hopper man; spreader on asphalt machine; material mixer man (except on manholes); coffer dams; riprap pavers rock, block or brick; scaffolds over ten feet not self-supported from ground up; skip man on concrete paving; wire mesh setters on concrete paving; all work in connection with sewer, water, gas, gasoling, oil, drainage pipe, conduit pipe, tile and duct lines and all other pipe lines; power tool operator; all work in connection with

hydraulic or general dredging operations; form setters, puddlers (paving only); straw blower nozzle man; asphalt plant platform man; chuck tender; crusher feeder; men handling creosote ties or creosote materials; men working with and handling epoxy material; topper of standing trees; feeder man on wood pulverizers, board and willow mat weavers and cabelee tiers on river work; deck hands; pile dike and revetment work; all laborers working on underground tunnels less than 25 ft. where compressed air is not used; abutment and pier hole men working six (6) ft. or more below ground; men working in coffer dams for bridge piers and footing in the river; barco tamper; jackson or any other similar tamp; cutting torch man; liners, curb, gutters, ditch lines; hot mastic kettlemen; hot tar applicator; hand blade operator; mortar men or brick or block manholes; rubbing concrete, air tool operator under 65 lbs.; caulker and lead man; chain or concrete saw under 15 h.p.; signal Gan; Guard rail and sign erectors.

GROUP 2 - Skilled laborers - Vibrator man; asphalt raker; head pipe layer on sewer work; batterboard man on pipe and ditch work; cliff scalers working from bosun's chairs; scaffolds or platforms on dams or power plants over 10 ft. high; air tool operator over 65 lbs.; stringline man on concrete paving; sandblast man; laser beam man; wagon drill; churn drill; air track drill and all other similar type drills, gunite nozzle man; pressure grout man; screed man on asphalt; concrete saw 15 h.p. and over; grade checker; strigline man on electronic grade control; manhole builder; dynamite man; powder man; welder; tunnel man; waterblaster - 1000 psi or over; asbestos and/or hazardous waste removal and/or disposal

LAB00955-012 05/01/2024

Adair, Audrain, Boone, Chariton, Cooper, Howard, Linn, Macon, Monroe, Putnam, Randolph, Schuyler and Sullivan Counties

	Rates	Fringes
LABORER		
GROUP 1.....	\$ 35.13	15.55
GROUP 2.....	\$ 35.13	15.55

LABORERS CLASSIFICATIONS

GROUP 1 - General laborer-flagman, carpenter tenders; salamander Tenders; Dump Man; Ticket Takers; loading trucks under bins, hoppers, and conveyors; track man; cement handler; dump man on earth fill; georgie buggy man; material batch hopper man; spreader on asphalt machine; material mixer man (except on manholes); coffer dams; riprap pavers rock, block or brick; scaffolds over ten feet not self-supported from ground up; skip man on concrete paving; wire mesh setters on concrete paving; all work in connection with sewer, water, gas, gasoling, oil, drainage pipe, conduit pipe, tile and duct lines and all other pipe lines; power tool operator; all work in connection with hydraulic or general dredging operations; form setters, puddlers (paving only); straw blower nozzle man; asphalt plant platform man; chuck tender; crusher feeder; men handling creosote ties or creosote materials; men working

with and handling epoxy material; topper of standing trees; feeder man on wood pulverizers, board and willow mat weavers and cabelee tiers on river work; deck hands; pile dike and revetment work; all laborers working on underground tunnels less than 25 ft. where compressed air is not used; abutement and pier hole men working six (6) ft. or more below ground; men working in coffer dams for bridge piers and footing in the river; barco tamper; jackson or any other similar tamp; cutting torch man; liners, curb, gutters, ditch lines; hot mastic kettlemen; hot tar applicator; hand blade operator; mortar men or brick or block manholes; rubbing concrete, air tool operator under 65 lbs.; caulker and lead man; chain or concrete saw under 15 h.p.; signal Gan; Guard rail and sign erectors.

GROUP 2 - Skilled laborers - Vibrator man; asphalt raker; head pipe layer on sewer work; batterboard man on pipe and ditch work; cliff scalers working from bosun's chairs; scaffolds or platforms on dams or power plants over 10 ft. high; air tool operator over 65 lbs.; stringline man on concrete paving; sandblast man; laser beam man; wagon drill; churn drill; air track drill and all other similar type drills, gunite nozzle man; pressure grout man; screed man on asphalt; concrete saw 15 h.p. and over; grade checker; strigline man on electronic grade control; manhole builder; dynamite man; powder man; welder; tunnel man; waterblaster - 1000 psi or over; asbestos and/or hazardous waste removal and/or disposal

LAB01104-005 05/01/2024

Bollinger, Butler, Cape Girardeau, Carter, Dunklin, Iron, Madison, Mississippi, New Madrid, Pemiscot, Perry, Reynolds, Ripley, Scott, St Francois, Ste Genevieve, Stoddard and Wayne Counties

	Rates	Fringes
LABORER		
GROUP 1.....	\$ 35.13	15.55
GROUP 2.....	\$ 35.13	15.55

LABORERS CLASSIFICATIONS

GROUP 1 - General laborer-flagman, carpenter tenders; salamander Tenders; Dump Man; Ticket Takers; loading trucks under bins, hoppers, and conveyors; track man; cement handler; dump man on earth fill; georgie buggy man; material batch hopper man; spreader on asphalt machine; material mixer man (except on manholes); coffer dams; riprap pavers rock, block or brick; scaffolds over ten feet not self-supported from ground up; skip man on concrete paving; wire mesh setters on concrete paving; all work in connection with sewer, water, gas, gasoling, oil, drainage pipe, conduit pipe, tile and duct lines and all other pipe lines; power tool operator; all work in connection with hydraulic or general dredging operations; form setters, puddlers (paving only); straw blower nozzle man; asphalt plant platform man; chuck tender; crusher feeder; men handling creosote ties or creosote materials; men working with and handling epoxy material; topper of standing trees; feeder man on wood pulverizers, board and willow mat

weavers and cablee tiers on river work; deck hands; pile dike and revetment work; all laborers working on underground tunnels less than 25 ft. where compressed air is not used; abutment and pier hole men working six (6) ft. or more below ground; men working in coffer dams for bridge piers and footing in the river; barco tamper; jackson or any other similar tamp; cutting torch man; liners, curb, gutters, ditch lines; hot mastic kettlemen; hot tar applicator; hand blade operator; mortar men or brick or block manholes; rubbing concrete, air tool operator under 65 lbs.; caulker and lead man; chain or concrete saw under 15 h.p.; signal Gan; Guard rail and sign erectors.

GROUP 2 - Skilled laborers - Vibrator man; asphalt raker; head pipe layer on sewer work; batterboard man on pipe and ditch work; cliff scalers working from bosun's chairs; scaffolds or platforms on dams or power plants over 10 ft. high; air tool operator over 65 lbs.; stringline man on concrete paving; sandblast man; laser beam man; wagon drill; churn drill; air track drill and all other similar type drills, gunite nozzle man; pressure grout man; screed man on asphalt; concrete saw 15 h.p. and over; grade checker; strigline man on electronic grade control; manhole builder; dynamite man; powder man; welder; tunnel man; waterblaster - 1000 psi or over; asbestos and/or hazardous waste removal and/or disposal

PAIN0002-002 09/01/2007

CLARK, FRANKLIN, JEFFERSON, LEWIS, LINCOLN, MARION, PIKE, RALLS, ST. CHARLES, ST. LOUIS (CITY & COUNTY), AND WARREN COUNTIES

	Rates	Fringes
Painters:		
Brush and Roller; Taper.....	\$ 28.61	10.24
High work over 60 feet.....	\$ 29.11	10.24
Lead Abatement.....	\$ 29.36	10.24
Pressure Roller; High work under 60 ft.....	\$ 28.86	10.24
Spray & Abrasive Blasting; Water Blasting (Over 5000 PSI).....	\$ 30.61	10.24
Taper (Ames Tools & Bazooka).....	\$ 30.21	10.24

PAIN0002-006 04/01/2023

ADAIR, AUDRAIN, BOONE, CALLAWAY, CHARITON, COLE, GASCONADE, HOWARD, KNOX, LINN, MACON, MONROE, MONTGOMERY, OSAGE, PUTNAM, RANDOLPH, SCHUYLER, SCOTLAND, SHELBY AND SULLIVAN COUNTIES and the City of Booneville.

	Rates	Fringes
Painters:		
Bridges, Dams, Locks or Powerhouses.....	\$ 28.49	15.03
Brush and Roll; Taping, Paperhanging.....	\$ 26.49	15.03

Epoxy or Any Two Part Coating; Sandblasting; Stage or other Aerial Work - Platforms over 50 feet high; Lead Abatement.....	\$ 27.49	15.03
Spray; Structural Steel (over 50 feet).....	\$ 27.49	15.03
Tapers using Ames or Comparable Tools.....	\$ 27.24	15.03

PAIN0003-004 04/01/2019

CASS, CLAY, CLINTON, JACKSON, JOHNSON, LAFAYETTE, PLATTE & RAY
COUNTIES

	Rates	Fringes
--	-------	---------

Painters:

Bridgeman; Lead Abatement; Sandblast; Storage Bin & Tanks.....	\$ 33.41	17.76
Brush & Roller.....	\$ 30.54	17.76
Drywall.....	\$ 31.74	17.76
Paper Hanger.....	\$ 31.04	17.76
Stageman; Beltman; Steelman; Elevator Shaft; Bazooka, Boxes and Power Sander; Sprayman; Dipping...	\$ 32.41	17.76
Steeplejack.....	\$ 36.98	17.76

PAIN0003-011 04/01/2019

BATES, BENTON, CALDWELL, CARROLL, COOPER, DAVIESS, GRUNDY,
HARRISON, HENRY, LIVINGSTON, MERCER, MONITEAU, MORGAN, PETTIS &
SALINE COUNTIES

	Rates	Fringes
--	-------	---------

Painters:

Bridgeman; Lead Abatement; Sandblast; Storage Bin & Tanks.....	\$ 26.73	17.76
Brush & Roller.....	\$ 24.43	17.76
Drywall.....	\$ 25.39	17.76
Paper Hanger.....	\$ 24.83	17.76
Stageman; Beltman; Steelman; Elevator Shaft; Bazooka, Boxes and Power Sander; Sprayman; Dipping...	\$ 26.35	17.76
Steeplejack.....	\$ 29.58	17.76

* PAIN1185-008 04/01/2025

CAMDEN, CRAWFORD, DENT, LACLEDE, MARIES, MILLER, PHELPS,
PULASKI AND TEXAS COUNTIES

	Rates	Fringes
--	-------	---------

Painters:

Brush and Roller.....	\$ 33.90	17.21
Floor Work.....	\$ 34.90	17.21
Lead Abatement.....	\$ 33.25	17.21

Spray.....	\$ 34.90	17.21
Structural Steel, Sandblasting and All Tank Work.....	\$ 35.90	17.21
Taping, Paperhanging.....	\$ 34.90	17.21

* PAIN1292-002 09/01/2024

BOLLINGER, BUTLER, CAPE GIRARDEAU, CARTER, DUNKLIN,
MISSISSIPPI, NEW MADRID, OREGON, PEMISCOT, PERRY, REYNOLDS,
RIPLEY, SCOTT, SHANNON, STODDARD and WAYNE COUNTIES

	Rates	Fringes
--	-------	---------

Painters:

Bridges, Stacks & Tanks.....	\$ 35.30	17.65
Brush & Roller.....	\$ 29.80	17.65
Spray & Abrasive Blasting; Waterblasting (over 5000 PSI).....	\$ 31.80	17.65

Height Rates (All Areas):

Over 60 ft. \$0.50 per hour.

Under 60 ft. \$0.25 per hour.

* PAIN1292-003 09/01/2024

IRON, MADISON, ST. FRANCOIS, STE. GENEVIEVE and WASHINGTON
COUNTIES

	Rates	Fringes
--	-------	---------

Painters:

Bridges, Stacks & Tanks.....	\$ 35.30	17.65
Brush & Roller.....	\$ 30.95	17.65
Spray & Abrasive Blasting; Waterblasting (Over 5000 PSI).....	\$ 32.95	17.65

Height Rates (All Areas):

Over 60 ft. \$0.50 per hour

Under 60 ft. \$0.25 per hour.

PAIN2012-001 04/01/2023

ANDREW, ATCHISON, BUCHANAN, DE KALB, GENTRY, HOLT, NODAWAY &
WORTH COUNTIES

	Rates	Fringes
--	-------	---------

Painters:

Brush & Roller.....	\$ 34.22	19.13
Sandblaster.....	\$ 38.46	19.13
Steeplejack.....	\$ 42.03	19.13

PAIN2015-001 04/01/2012

BARRY, BARTON, CEDAR, CHRISTIAN, DADE, DALLAS, DOUGLAS, GREENE,
HICKORY, HOWELL, JASPER, LAWRENCE, MCDONALD, NEWTON, OZARK,
POLK, ST. CLAIR, STONE, TANEY, VERNON, WEBSTER, and WRIGHT

COUNTIES

	Rates	Fringes
Painters:		
Finisher.....	\$ 20.18	11.33
Painter.....	\$ 19.75	11.76
Sandblaster, High Man, Spray Man, Vinyl Hanger, Tool Operator.....	\$ 21.18	11.33

 * PLAS0518-006 03/01/2025

BARRY, BARTON, CEDAR, CHRISTIAN, DADE, DALLAS, DOUGLAS, GREENE,
 HICKORY, JASPER, LACLEDE, LAWRENCE, MCDONALD, NEWTON, OZARK,
 POLK, ST. CLAIR, STONE, TANEY, VERNON, WEBSTER, AND WRIGHT
 COUNTIES

	Rates	Fringes
CEMENT MASON/CONCRETE FINISHER...	\$ 30.37	12.43

 * PLAS0518-007 04/01/2025

CASS (Richards-Gebaur AFB only), CLAY, JACKSON, PLATTE AND RAY
 COUNTIES

	Rates	Fringes
Cement Masons:.....	\$ 39.06	18.71

 * PLAS0518-011 04/01/2025

ANDREW, ATCHISON, BATES, BUCHANNAN, CLINTON, DEKALB, GENTRY,
 HENRY, HOLT, JOHNSON, LAFAYETTE, NODAWAY & WORTH COUNTIES

	Rates	Fringes
CEMENT MASON/CONCRETE FINISHER...	\$ 40.13	20.50

 * PLAS0518-019 03/01/2025

Adair, Audrain, Benton, Boone, Callaway, Caldwell, Camden,
 Carroll, Chariton, Cole, Cooper, Daviess, Gasconade, Grundy,
 Harrison, Howard, Linn, Livingston, Macon, Maries, Mercer,
 Miller, Moniteau, Monroe, Montgomery, Morgan, Osage, Pettis,
 Putnam, Randolph, Saline, Schuyler, Shelby and Sullivan Counties

	Rates	Fringes
CEMENT MASON/CONCRETE FINISHER...	\$ 33.52	15.88

 PLAS0527-001 04/01/2023

	Rates	Fringes
CEMENT MASON FRANKLIN, LINCOLN AND WARREN COUNTIES.....	\$ 37.29	20.23
JEFFERSON, ST. CHARLES		

COUNTIES AND ST. LOUIS

(City and County).....\$ 38.46 20.13

PLAS0527-004 06/01/2023CRAWFORD, DENT, IRON, MADISON, MARION, PHELPS, PIKE, PULASKI,
RALLS, REYNOLDS, ST. FRANCOIS, STE. GENEVIEVE, SHANNON, TEXAS,
WASHINGTON COUNTIES

Rates Fringes

CEMENT MASON.....\$ 32.00 19.72

PLAS0908-001 05/01/2024BOLLINGER, BUTLER, CAPE GIRARDEAU, CARTER, DUNKLIN, HOWELL,
MISSISSIPPI, NEW MADRID, OREGON, PEMISCOT, PERRY, RIPLEY,
SCOTT, STODDARD, AND WAYNE COUNTIES

Rates Fringes

CEMENT MASON.....\$ 33.50 18.78

PLUM0008-003 06/01/2024

CASS, CLAY, JACKSON, JOHNSON, AND PLATTE COUNTIES

Rates Fringes

Plumbers.....\$ 56.63 24.54

PLUM0008-017 06/01/2024BATES, BENTON, CARROLL, HENRY, LAFAYETTE, MORGAN, PETTIS, RAY,
ST. CLAIR, SALINE AND VERNON COUNTIES

Rates Fringes

Plumbers.....\$ 56.63 24.54

PLUM0045-003 08/01/2024ANDREW, ATCHISON, BUCHANAN, CALDWELL, CLINTON, DAVIESS, DEKALB,
GENTRY, HARRISON, HOLT, NODAWAY AND WORTH COUNTIES

Rates Fringes

Plumbers and Pipefitters.....\$ 47.45 26.15

PLUM0178-003 11/01/2024BARRY, CEDAR, CHRISTIAN, DADE, DALLAS, DOUGLAS, GREENE,
HICKORY, LACLEDE, LAWRENCE, POLK, STONE, TANEY, WEBSTER AND
WRIGHT COUNTIES

Rates Fringes

Plumbers and Pipefitters.....\$ 39.35 15.72

PLUM0178-006 11/01/2022

BARTON, JASPER, MCDONALD AND NEWTON COUNTIES

	Rates	Fringes
Plumbers and Pipefitters		
Projects \$750,000 & under...	\$ 32.78	15.32
Projects over \$750,000.....	\$ 35.75	15.32

 PLUM0533-004 06/01/2024

BATES, BENTON, CARROLL, CASS, CLAY, HENRY, HICKORY, JACKSON,
 JOHNSON, LAFAYETTE, MORGAN, PETTIS, PLATTE, RAY, SALINE, ST.
 CLAIR AND VERNON COUNTIES

	Rates	Fringes
Pipefitters.....	\$ 55.56	25.80

 PLUM0562-004 07/01/2023

ADAIR, AUDRAIN, BOLLINGER, BOONE, BUTLER, CALLAWAY, CAMDEN, CAPE
 GIRARDEAU, CARTER, CHARITON, CLARK, COLE, COOPER, CRAWFORD,
 DENT, DUNKLIN, FRANKLIN, GASCONADE, GRUNDY, HOWARD, HOWELL,
 IRON, JEFFERSON, KNOX, LEWIS, LINCOLN, LINN, LIVINGSTON, MACON,
 MADISON, MARIES, MARION, MERCER, MILLER, MISSISSIPPI, MONITEAU,
 MONROE, MONTGOMERY, NEW MADRID, OREGON, OSAGE, PEMISCOTT,
 PERRY, PHELPS, PIKE, PULASKI, PUTNAM, RALLS, RANDOLPH,
 REYNOLDS, RIPLEY, ST. CHARLES, ST. FRANCOIS, STE. GENEVIEVE, ST.
 LOUIS, SCHUYLER, SCOTLAND, SCOTT, SHANNON, SHELBY, STODDARD,
 SULLIVAN, TEXAS, WARREN, WASHINGTON, AND WAYNE COUNTIES.

	Rates	Fringes
Plumbers and Pipefitters		
Mechanical Contracts		
including all piping and		
temperature control work		
\$7.0 million & under.....	\$ 46.66	21.99
Mechanical Contracts		
including all piping and		
temperature control work		
over \$7.0 million.....	\$ 46.66	21.99

 PLUM0562-016 07/01/2023

CAMDEN, COLE, CRAWFORD, FRANKLIN, JEFFERSON, MARIES, MILLER,
 MONITEAU, OSAGE, PHELPS, PULASKI, ST. CHARLES, ST. LOUIS (City
 and County), WARREN and WASHINGTON COUNTIES

	Rates	Fringes
Plumbers		
Mechanical Contracts		
including all piping and		
temperature control work		
\$7.0 million & under.....	\$ 46.66	21.99
Mechanical Contracts		
including all piping and		
temperature control work		
over \$7.0 million.....	\$ 46.66	21.99

TEAM0013-001 05/01/2024

	Rates	Fringes
Truck drivers (ADAIR, BUTLER, CLARK, DUNKIN, HOWELL, KNOX, LEWIS, OREGON, PUTNAM, RIPLEY, SCHUYLER AND SCOTLAND COUNTIES)		
GROUP 1.....	\$ 34.29	15.75
GROUP 2.....	\$ 34.44	15.75
GROUP 3.....	\$ 34.56	15.75
GROUP 4.....	\$ 34.45	15.75
Truck drivers (AUDRAIN, BOLLINGER, BOONE, CALLAWAY, CAPE GIRARDEAU, CARTER, COLE, CRAWFORD, DENT, GASCONADE, IRON, MACON, MADISON, MARIES, MARION, MILLER, MISSISSIPPI, MONROE, MONTGOMERY, NEW MADRID, OSAGE, PEMISCOT, PERRY, PHELPS, PIKE, PULASKI, RALLS, REYNOLDS, ST. FRANCOIS, STE. GENEVIEVE, SCOTT, SHANNON, SHELBY, STODDARD, TEXAS, WASHINGTON AND WAYNE COUNTIES)		
GROUP 1.....	\$ 35.02	15.75
GROUP 2.....	\$ 35.17	15.75
GROUP 3.....	\$ 35.29	15.75
GROUP 4.....	\$ 35.18	15.75
Truck drivers (FRANKLIN, JEFFERSON and ST. CHARLES COUNTIES)		
GROUP 1.....	\$ 37.38	15.75
GROUP 2.....	\$ 37.53	15.75
GROUP 3.....	\$ 37.60	15.75
GROUP 4.....	\$ 37.49	15.75
Truck drivers (LINCOLN and WARREN COUNTIES)		
GROUP 1.....	\$ 36.03	15.75
GROUP 2.....	\$ 37.18	15.75
GROUP 3.....	\$ 36.25	15.75
GROUP 4.....	\$ 36.14	15.75

TRUCK DRIVERS CLASSIFICATIONS:

GROUP 1: Flat Bed Trucks, Single Axle; Station Wagons;
Pickup Trucks; Material Trucks, Single Axle; Tank Wagon,
Single Axle

GROUP 2: Agitator and Transit Mix Trucks

GROUP 3: Flat Bed Trucks, Tandem Axle; Articulated Dump
Trucks; Material Trucks, Tandem Axle; Tank Wagon, Tandem
Axle

GROUP 4: Semi and/or Pole Trailers; Winch, Fork & Steel
Trucks; Distributor Drivers and Operators; Tank Wagon,
Semi-Trailer; Insley Wagons, Dumpsters, Half-Tracks,
Speedace, Euclids and other similar equipment; A-Frame and
Derrick Trucks; Float or Low Boy

TEAM0056-001 05/01/2024

Rates Fringes

Truck drivers (ANDREW,
BARTON, BATES, BENTON,
CALDWELL, CAMDEN, CARROLL,
CEDAR, CHARITON, CHRISTIAN,
CLINTON, COOPER, DADE,
DALLAS, DAVIESS, DEKALB,
DOUGLAS, GREENE, HENRY,
HICKORY, HOWARD, JASPER,
LACLEDE, LAWRENCE, LINN,
LIVINGSTON, MONITEAU, MORGAN,
NEWTON, PETTIS, POLK,
RANDOLPH, ST. CLAIR, SALINE,
VERNON, WEBSTER AND WRIGHT
COUNTIES)

GROUP 1.....	\$ 34.72	15.75
GROUP 2.....	\$ 34.88	15.75
GROUP 3.....	\$ 34.87	15.75
GROUP 4.....	\$ 34.99	15.75

Truck drivers: (ATCHISON,
BARRY, GENTRY, GRUNDY,
HARRISON, HOLT, MCDONALD,
MERCER, NODAWAY, OZARK,
STONE, SULLIVAN, TANEY AND
WORTH COUNTIES)

GROUP 1.....	\$ 33.99	15.75
GROUP 2.....	\$ 34.15	15.75
GROUP 3.....	\$ 34.14	15.75
GROUP 4.....	\$ 34.26	15.75

Truck drivers; (BUCHANAN,
JOHNSON AND LAFAYETTE
COUNTIES)

GROUP 1.....	\$ 35.93	15.75
GROUP 2.....	\$ 36.04	15.75
GROUP 3.....	\$ 36.08	15.75
GROUP 4.....	\$ 36.08	15.75

TRUCK DRIVER CLASSIFICATIONS

GROUP 1: Flat bed trucks single axle; station wagons; pickup trucks; material trucks single axle; tank wagons single axle.

GROUP 2: Agitator and transit mix-trucks.

GROUP 3: Flat bed trucks tandem axle; articulated dump trucks; material trucks tandem axle; tank wagons tandem axle.

GROUP 4: Semi and/or pole trailers; winch, fork & steel trucks; distributor drivers & operators; tank wagons semi-trailer; insley wagons, dumpsters, half-tracks, speedace, euclids & other similar equipment; A-frames and derrick trucks; float or low boy.

TEAM0245-001 03/26/2012

BARRY, BARTON, CAMDEN, CEDAR, CHRISTIAN, DALLAS, DENT, DOUGLAS,
GREENE, HICKORY, HOWELL, JASPER, LACLEDE, LAWRENCE, MCDONALD,
MILLER, NEWTON, OZARK, PHELPS, POLK, PULASKI, SHANNON, STONE,
TANEY, TEXAS, VERNON, WEBSTER AND WRIGHT COUNTIES

	Rates	Fringes
--	-------	---------

Truck drivers:

Traffic Control Service		
Driver.....	\$ 20.45	0.00

PAID HOLIDAYS: New Year's Day, Decoration Day, July 4th, Labor Day, Thanksgiving Day, Christmas Day, employee's birthday and 2 personal days.

TEAM0541-001 04/01/2024

CASS, CLAY, JACKSON, PLATTE AND RAY COUNTIES

	Rates	Fringes
--	-------	---------

Truck drivers:

GROUP 1.....	\$ 37.81	15.65
GROUP 2.....	\$ 37.24	15.65
GROUP 3.....	\$ 36.72	15.65

TRUCK DRIVERS CLASSIFICATIONS

GROUP 1: Mechanics and Welders, Field; A-Frame Low Boy-Boomer Driver.

GROUP 2: Articulated Dump Truck; Insley Wagons: Dump Trucks, Excavating, 5 cu yds and over; Dumpsters; Half-Tracks: Speedace: Euclids & similar excavating equipment Material trucks, Tandem Two teams; Semi-Trailers; Winch trucks-Fork trucks; Distributor Drivers and Operators; Agitator and Transit Mix; Tank Wagon Drivers, Tandem or Semi; One Team; Station Wagons; Pickup Trucks; Material Trucks, Single Axle; Tank Wagon Drivers, Single Axle

GROUP 3: Oilers and Greasers - Field

TEAM0682-002 05/01/2024

ST LOUIS CITY AND COUNTY

	Rates	Fringes
--	-------	---------

Truck drivers:

GROUP 1.....	\$ 36.64	8.86+a+b+c
GROUP 2.....	\$ 36.64	8.86+a+b+c
GROUP 3.....	\$ 36.64	8.86+a+b+c

a. PENSION: 5/1/2012 - \$182.20 per week.

b. HAZMAT PREMIUM: If Hazmat certification on a job site is required by a state or federal agency or requested by project owner or by the employer, employees on that job site shall receive \$1.50 premium pay.

TRUCK DRIVERS CLASSIFICATIONS

GROUP 1 - Pick-up trucks; forklift, single axle; flatbed trucks; job site ambulance, and trucks or trailers of a water level capacity of 11.99 cu. yds. or less

GROUP 2 - Trucks or trailers of a water level capacity of

12.0 cu yds. up to 22.0 cu yds. including euclids, speedace and similar equipment of same capacity and compressors

GROUP 3 - Trucks or trailers of a water level capacity of 22.0 cu. yds & over including euclids, speedace & all floats, flatbed trailers, boom trucks, winch trucks, including small trailers, farm wagons tilt-top trailers, field offices, tool trailers, concrete pumps, concrete conveyors & gasoline tank trailers and truck mounted mobile concrete mixers

FOOTNOTE FOR TRUCK DRIVERS:

c. PAID HOLIDAYS: Christmas Day, Independence Day, Labor Day, Memorial Day, Veterans Day, New Years Day, Thanksgiving Day

d. PAID VACATION: 3 days paid vacation for 600 hours of service in any one contract year; 4 days paid vacation for 800 hours of service in any one contract year; 5 days paid vacation for 1,000 hours of service in any one contract year. When such an employee has completed 3 years of continuous employment with the same employer and then works the above required number of hours, he shall receive double the number of days of vacation specified above. When such an employee has completed 10 years of continuous employment with the same employer and then works the above required number of hours, he shall receive triple the number of days of vacation specified above. When such an employee has completed 15 years of continuous employment with the same employer and then works the above required number of hours, he shall receive 4 times the number of days of vacation specified above.

WELDERS - Receive rate prescribed for craft performing operation to which welding is incidental.
=====

Note: Executive Order (EO) 13706, Establishing Paid Sick Leave for Federal Contractors applies to all contracts subject to the Davis-Bacon Act for which the contract is awarded (and any solicitation was issued) on or after January 1, 2017. If this contract is covered by the EO, the contractor must provide employees with 1 hour of paid sick leave for every 30 hours they work, up to 56 hours of paid sick leave each year. Employees must be permitted to use paid sick leave for their own illness, injury or other health-related needs, including preventive care; to assist a family member (or person who is like family to the employee) who is ill, injured, or has other health-related needs, including preventive care; or for reasons resulting from, or to assist a family member (or person who is like family to the employee) who is a victim of, domestic violence, sexual assault, or stalking. Additional information on contractor requirements and worker protections under the EO is available at <https://www.dol.gov/agencies/whd/government-contracts>.

Unlisted classifications needed for work not included within the scope of the classifications listed may be added after award only as provided in the labor standards contract clauses (29CFR 5.5 (a) (1) (iii)).

The body of each wage determination lists the classifications and wage rates that have been found to be prevailing for the type(s) of construction and geographic area covered by the wage determination. The classifications are listed in alphabetical order under rate identifiers indicating whether the particular rate is a union rate (current union negotiated rate), a survey rate, a weighted union average rate, a state adopted rate, or a supplemental classification rate.

Union Rate Identifiers

A four-letter identifier beginning with characters other than ""SU"", ""UAVG"", ?SA?, or ?SC? denotes that a union rate was prevailing for that classification in the survey. Example: PLUM0198-005 07/01/2024. PLUM is an identifier of the union whose collectively bargained rate prevailed in the survey for this classification, which in this example would be Plumbers. 0198 indicates the local union number or district council number where applicable, i.e., Plumbers Local 0198. The next number, 005 in the example, is an internal number used in processing the wage determination. The date, 07/01/2024 in the example, is the effective date of the most current negotiated rate.

Union prevailing wage rates are updated to reflect all changes over time that are reported to WHD in the rates in the collective bargaining agreement (CBA) governing the classification.

Union Average Rate Identifiers

The UAVG identifier indicates that no single rate prevailed for those classifications, but that 100% of the data reported for the classifications reflected union rates. EXAMPLE: UAVG-OH-0010 01/01/2024. UAVG indicates that the rate is a weighted union average rate. OH indicates the State of Ohio. The next number, 0010 in the example, is an internal number used in producing the wage determination. The date, 01/01/2024 in the example, indicates the date the wage determination was updated to reflect the most current union average rate.

A UAVG rate will be updated once a year, usually in January, to reflect a weighted average of the current rates in the collective bargaining agreements on which the rate is based.

Survey Rate Identifiers

The ""SU"" identifier indicates that either a single non-union rate prevailed (as defined in 29 CFR 1.2) for this classification in the survey or that the rate was derived by computing a weighted average rate based on all the rates reported in the survey for that classification. As a weighted average rate includes all rates reported in the survey, it may include both union and non-union rates. Example: SUFL2022-007 6/27/2024. SU indicates the rate is a single non-union prevailing rate or a weighted average of survey data for that classification. FL indicates the State of Florida. 2022 is the year of the survey on which these classifications and rates are based. The next number, 007 in the example, is an internal number used in producing the wage determination. The date, 6/27/2024 in the example, indicates the survey completion date for the classifications and rates under that identifier.

?SU? wage rates typically remain in effect until a new survey is conducted. However, the Wage and Hour Division (WHD) has the discretion to update such rates under 29 CFR 1.6(c)(1).

State Adopted Rate Identifiers

The ""SA"" identifier indicates that the classifications and prevailing wage rates set by a state (or local) government were adopted under 29 C.F.R 1.3(g)-(h). Example: SAME2023-007 01/03/2024. SA reflects that the rates are state adopted. ME refers to the State of Maine. 2023 is the year during which the state completed the survey on which the listed classifications and rates are based. The next number, 007 in the example, is an internal number used in producing the wage determination. The date, 01/03/2024 in the example, reflects the date on which the classifications and rates under the ?SA? identifier took effect under state law in the state from which the rates were adopted.

WAGE DETERMINATION APPEALS PROCESS

1) Has there been an initial decision in the matter? This can be:

- a) a survey underlying a wage determination
- b) an existing published wage determination
- c) an initial WHD letter setting forth a position on a wage determination matter
- d) an initial conformance (additional classification and rate) determination

On survey related matters, initial contact, including requests for summaries of surveys, should be directed to the WHD Branch of Wage Surveys. Requests can be submitted via email to davisbaconinfo@dol.gov or by mail to:

Branch of Wage Surveys
Wage and Hour Division
U.S. Department of Labor
200 Constitution Avenue, N.W.
Washington, DC 20210

Regarding any other wage determination matter such as conformance decisions, requests for initial decisions should be directed to the WHD Branch of Construction Wage Determinations. Requests can be submitted via email to BCWD-Office@dol.gov or by mail to:

Branch of Construction Wage Determinations
Wage and Hour Division
U.S. Department of Labor
200 Constitution Avenue, N.W.
Washington, DC 20210

2) If an initial decision has been issued, then any interested party (those affected by the action) that disagrees with the decision can request review and reconsideration from the Wage and Hour Administrator (See 29 CFR Part 1.8 and 29 CFR Part 7). Requests for review and reconsideration can be submitted via email to dba.reconsideration@dol.gov or by mail to:

Wage and Hour Administrator

U.S. Department of Labor
200 Constitution Avenue, N.W.
Washington, DC 20210

The request should be accompanied by a full statement of the interested party's position and any information (wage payment data, project description, area practice material, etc.) that the requestor considers relevant to the issue.

3) If the decision of the Administrator is not favorable, an interested party may appeal directly to the Administrative Review Board (formerly the Wage Appeals Board). Write to:

Administrative Review Board
U.S. Department of Labor
200 Constitution Avenue, N.W.
Washington, DC 20210.

=====

END OF GENERAL DECISION"