



**ADDENDUM NUMBER 3  
REQUEST FOR BID  
FOR PROJECT NO. 70191308  
BLUE RIVER TRAIL CONNECTOR –  
MARTHA TRUMAN ROAD  
PARKS AND RECREATION DEPARTMENT  
CITY OF KANSAS CITY, MISSOURI**

ISSUE DATE: **10/30/2024**

Proposers are hereby notified that the above project, for which Bids are to be received on **November 6, 2024**, is amended as follows:

**Revise Drawing Sheet 6 to add CONCRETE FENCE location at north end of trail as shown on drawing.**

**Revise Drawing Sheet 15 to add CONCRETE FENCE detail.**

**Revise 00412 Unit Prices Bid Form as follows:**

**Change line item #18 quantity from 20 LF to 32 LF**

**Add Bollard line item #24, quantity of 2, unit "EA"**

**Move Asphalt Pavement Replacement and Repair line item to item #25**

The following is provided to Proposers for information only:

Q1.	Addendum #2 refers to the Contractor needing to pay for all permits. Is this project on anyone else's ROW other than P&R? If so, please tell us who?
A1.	<b>Part of this project is in Minor Park which is owned by Kansas City, Missouri Parks and Recreation Department. Part of this project is in the Blue River Greenway which is owned by Jackson County Parks + Recreation Department. There is a cooperative agreement between the two entities for this the Blue River Trail Corridor extending through multiple areas and its amendment was documented August 13, 2018 as Resolution 19953 by Jackson County, Missouri to include the area surrounding this trail.</b>
Q2.	Will P&R be waiving all permit fees (including for traffic control permit and/or excavation permit)?
A2.	<b>City of Kansas City, Missouri permit fees will be waived for this project.</b>
Q3.	Is there a specific Trail Head Marker Supplier?
A3.	<b>No. Allied Concrete Products in Grandview, Missouri or equivalent have been used before and would be acceptable.</b>

**NOTE: Proposers must acknowledge receipt of this Addendum 3. This signed addendum notice must accompany your proposal.**

---

**CERTIFICATE BY BIDDER/PROPOSER**

I acknowledge receipt of this Addendum No. 3 for Project No. 70191308 Project: Blue River Trail Connector - Martha Truman Road and that the bid is in accordance with the information, instructions, and stipulations set forth herein.

By \_\_\_\_\_

Company \_\_\_\_\_

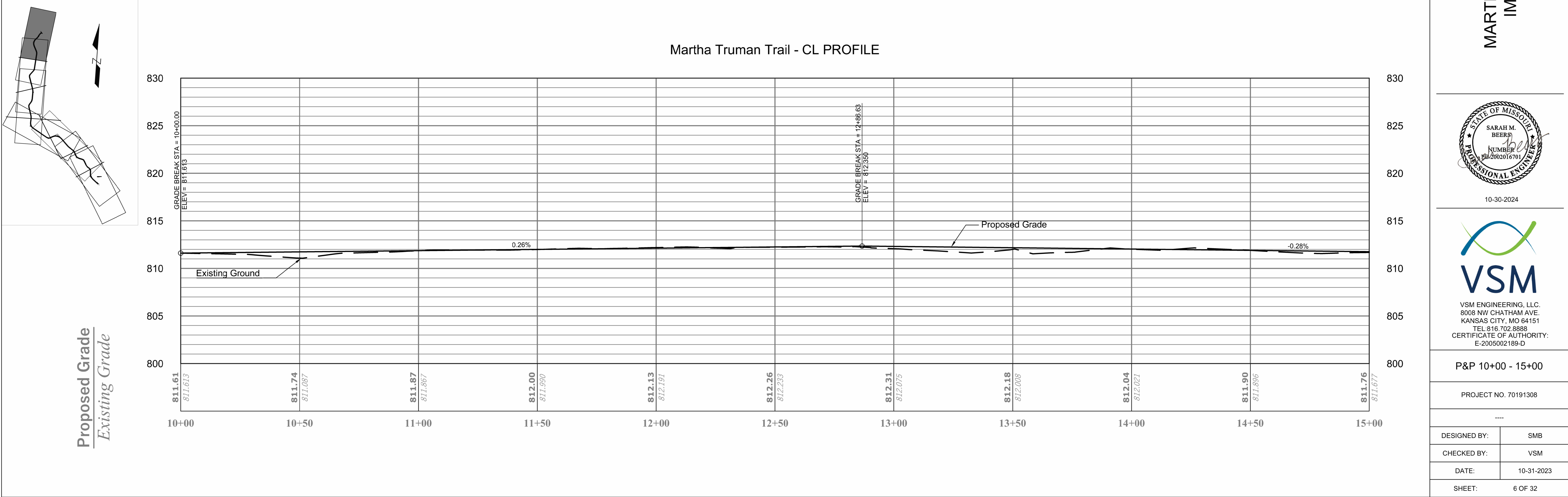



## FIGURE 5—TREE PROTECTION

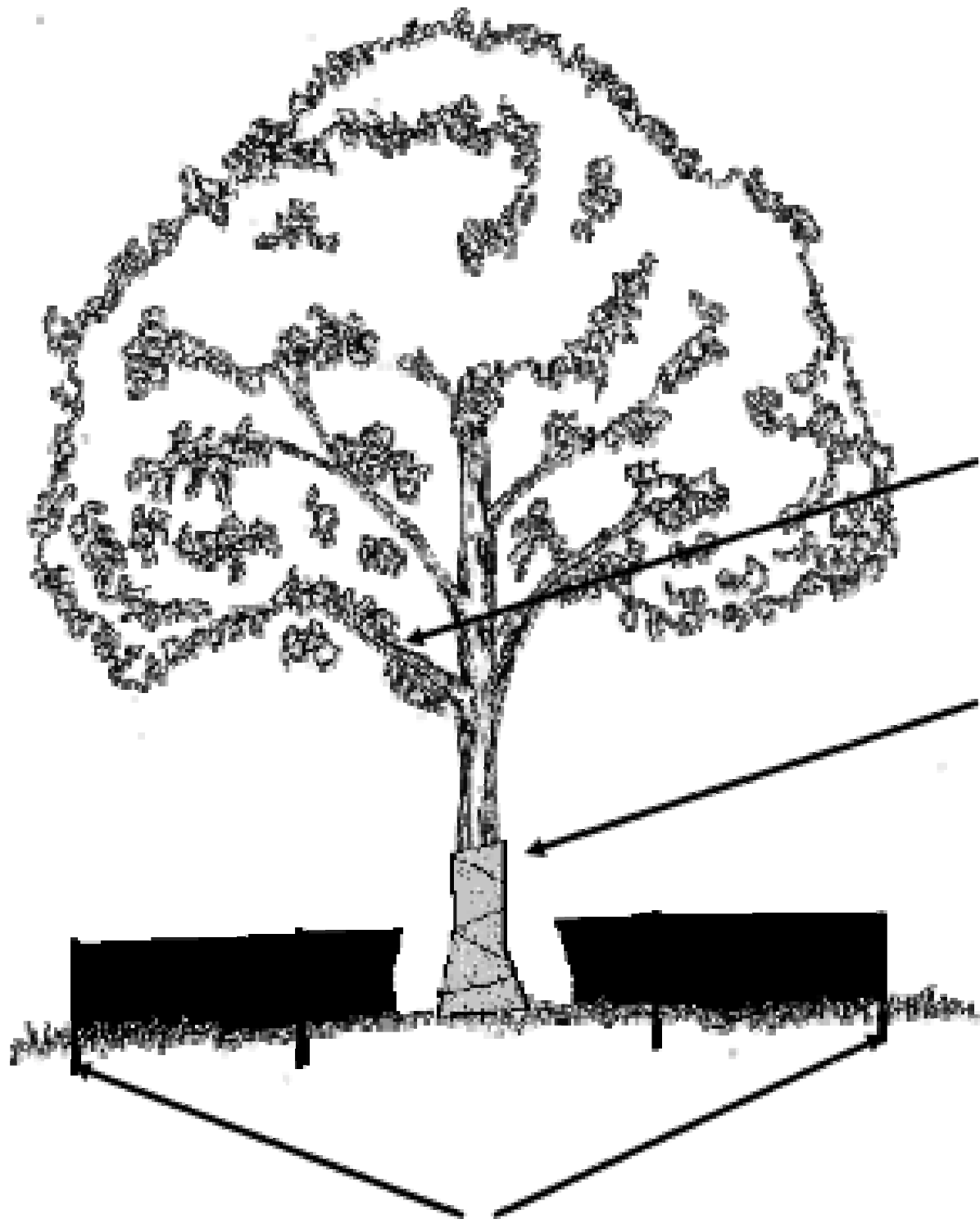

**TREE PROTECTION AREA**

The area inside a perimeter established at the Critical Root Zone (CRZ). The CRZ is equal to the dripline (furthest extent of tree canopy) or is equal to one foot radially from the tree for every one inch of trunk diameter at breast height (DBH), whichever is greater.

**ZONE 2  
LOWER CANOPY PROTECTION.**

**Contact City Forester if any pruning is needed prior to work if potential for damage exists.**

### ZONE 3 TRUNK PROTECTION.

Required if construction equipment involved within ten feet or less (permitted inside the CRZ only if equipment is operated exclusively on existing hardscape and no soil compaction takes place).

## NOTES

Fencing Height must be at least 48."

**Attach "Tree Protection Area" Signs (template available from City Forester) to Fencing every 50 feet.**

The Tree Protection Area shall not be modified or removed prior to consent of the City Forester.

Materials, debris, equipment, and site amenities shall not be stored within the Tree Protection Area.

Entrance to the Tree Protection Area is not permitted without consent of the City Forester.

### Tree Protection Detail – Individual Tree

NOT TO SCALE

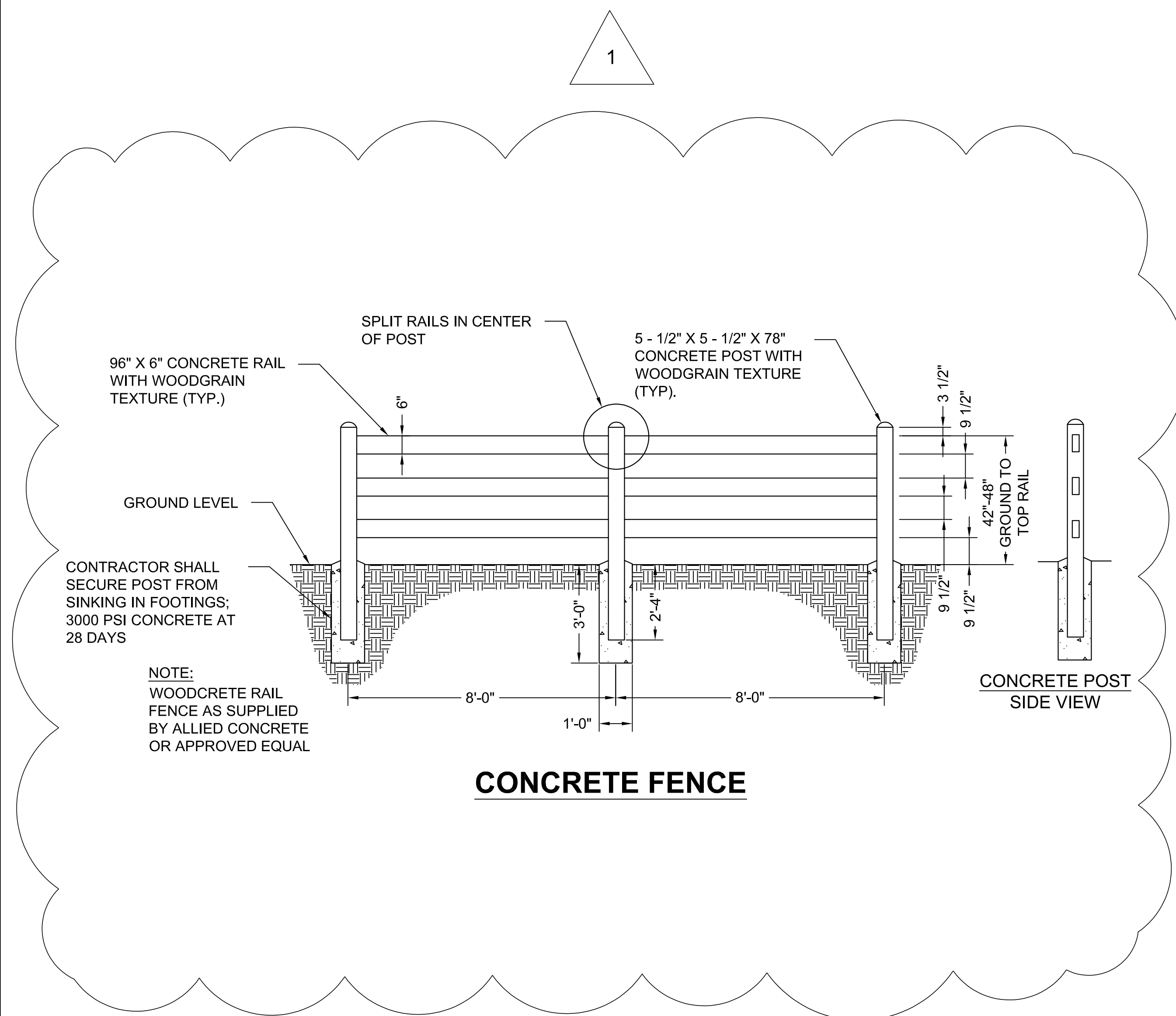

NO. REV.	DATE	REVISION DESCRIPTION
0	9-9-2022	60% SUBMITTAL
1	1-31-2023	100% SUBMITTAL
2	3-10-2023	MODOT SUBMITTAL
3	10-31-2023	100% CONSTRUCTION PLANS
1	10-29-2024	ADDENDUM #3



# MARTHA TRUMAN TRAIL IMPROVEMENTS



10-30-2024



VSM ENGINEERING, LLC.  
8008 NW CHATHAM AVE.  
KANSAS CITY, MO 64151  
TEL: 816.702.8888

CERTIFICATE OF AUTHORITY:  
E-2005002189-D

<b>DETAIL SHEET 1</b>	
PROJECT NO. 70191308	
—	
DESIGNED BY:	SMB
CHECKED BY:	VSM
DATE:	10-31-2023
SHEET:	15 OF 32



Bidder: \_\_\_\_\_

CITY OF FOUNTAINS  
HEART OF THE NATION



KANSAS CITY  
MISSOURI

## UNIT PRICES BID

Project Number: TAP 3301(519) City No. 70191308

Project Title: Blue River Martha Truman Connector Trail

Revised per Addendum #3

**NOTE: IN THE EVENT OF DISCREPANCY, UNIT PRICE SHALL GOVERN.**

Item No.	Unit	Quantity	Item Description:	Unit Price	Extension
1	LS	1	Mobilization		
2	LS	1	Contractor Furnished Surveying		
3	LS	1	Clearing, Grubbing, Demolition		
4	CY	630	Excavation		
5	CY	1620	Embankment		
6	SY	3538	6" Concrete Trail with WWF Reinforcement		
7	SY	3538	4" MoDOT Type 5 Aggregate Base		
8	EA	3	Rock Ditch Check		
9	LF	3184	Silt Fence		
10	LF	44	30" RCP Culvert Pipe		
11	EA	2	Single 30" Culvert End Section		
12	SY	36	KCMO Parks Standard 8" Commercial Drive		
13	LF	44	Concrete Grout Backfill for Culvert		
14	CY	18	Rip Rap		
15	EA	4	Trail Mile Marker		
16	SF	8	Other Permanent Signage		
17	LS	1	Tree Protection		
18	LF	32	Concrete Fencing at Trail Heads		
19	AC	0.58	Seeding and Straw Mat		
20	EA	2	Sign: Road Work Ahead (W-20-1)		
21	EA	2	Sign: End Road Work (G-20-2)		
22	EA	2	Sign: Flagger (W-20-7a)		
23	EA	2	Flagger		
24	EA	2	Bollard		
25	SY	4	Asphalt Pavement Replacement and Repair		



## UNIT PRICES BID

Project Number: TAP 3301(519) City No. 70191308

Project Title: Blue River Martha Truman Connector Trail

Revised per Addendum #3

**NOTE: IN THE EVENT OF DISCREPANCY, UNIT PRICE SHALL GOVERN.**

[illegible]

Note: May be printed, for manual fill-in, or filled in on electronic excel spreadsheet version. This form is provided for the convenience of the bidder. This Spreadsheet contains no formulas created by its authors or editors. By use of this form, the Bidder waives all of bidders claims against City and further waives all defenses from a claim made by City that may arise from any clerical mistakes, mathematical mistakes or other mistakes resulting from the use of this Spreadsheet Form.

PROJECT 70191308