



Date: December 13, 2023

Dear Consultant:

The City of Washington is requesting the services of a consulting engineering firm to perform the described professional services for the project included on the attached list. If your firm would like to be considered for these consulting services, you may express your interest by responding to the appropriate office, which is indicated on the attachments. Limit your letter of interest to no more than 5 pages. This letter should include any information which might help us in the selection process, such as the persons or team you would assign to each project, the backgrounds of those individuals, and other projects your company has recently completed or are now active. It is required that your firm's Statement of Qualification (RSMo 8.285 through 8.291) be submitted with your firm's Letter of Interest, or be on file with with City of Washington. The statement of qualification is not included in the total page count limit.

DBE firms must be listed in the MRCC DBE Directory located on MoDOT's website at [www.modot.gov](http://www.modot.gov), in order to be counted as participation towards an established DBE Goal. We encourage DBE firms to submit letters of interest as prime consultants for any project they feel can be managed by their firm.

It is required that your firm be prequalified with MoDOT and listed in [MoDOT's Approved Consultant Prequalification List](#), or your firm will be considered non-responsive.

We request all letters be received by 12:00 pm, CDT on Tuesday, January 9, 2023 at the office of:

Engineering Department  
City of Washington  
405 Jefferson Street  
Washington, MO 63090

The RFQ shall be delivered in a sealed envelope with "RFQ – Third Street – Roadway and ADA Compliance" clearly marked on the outside.

Sincerely,

Charles Stankovic, PE  
Interim City Engineer



<b>City of Washington, Project: Third Street – Roadway and ADA Compliance</b>	
Federal Aid No:	STBG-6401(603)
Location:	Third Street from Jefferson St. to High St.
Proposed Improvement:	A two-inch asphalt resurfacing with full with cold mill, removal and replacement of all sidewalks and c/g to meet ADA regulations. Brick paver crosswalks in downtown intersections and stormwater improvements. Retaining walls where necessary.
Length:	0.75 miles
Approximate Construction Cost:	\$2,221,763
DBE Goal Determination:	10%
Consultant Services Required:	<i>The engineering responsibilities may include but are not limited to the following:</i>  <i>The preparation of conceptual plans, preliminary plans, contract plans, and Right-of-Way plans. Design services may include, Right-of-Way plans, surveying geotechnical investigations, ADA compliance survey, subsurface utility exploration, public involvement, environmental and historic preservation services/permits, Right-of-way acquisition, contract documents, assisting with the bidding process, construction support / construction inspection, utility coordination/permits and traffic controls, including preparation of PS&amp;E and final documents.</i>
Other Comments:	Submit 4 copies of RFQ
Contact:	Charles Stankovic, PE 405 Jefferson Street Washington, MO 63090 636-390-1014 cstankovic@washmo.gov
Deadline:	12:00 pm, CDT on Tuesday, January 9, 2023

Pursuant to the Brooks Act for Consultant Selection – the following criteria will be the basis for selection.

Experience and Technical Competence -	30	Max Points
Capacity and Capability -	25	Max Points
Availability of staff assigned to the project	10	Max Points
Past Record of Performance -	25	Max Points
Outline consultants QA/QC plans	10	Max Point





## Surface Transportation Block Grant Program

2023 Call for Projects

For the St. Louis Region

### Road Project Type

---

Sponsoring Agency:

---

Project Title:

---

Federal Amount Requested:

---

**Applications Due: February 9, 2023 by 4:00 pm**



**EAST-WEST GATEWAY**  
Council of Governments

Creating Solutions Across Jurisdictional Boundaries

November 2022



## SURFACE TRANSPORTATION BLOCK GRANT PROGRAM (STP-S)

### ROAD – PROJECT APPLICATION FORM

Please refer to the STP-S Project Development Workbook and the STP-S Scoring Criteria Guide for more information on the program requirements, available funding, and scoring criteria. The STP-S Project Development Workbook, STP-S Scoring Criteria Guide, and supplemental materials are available on the East-West Gateway Council of Governments (EWG) [STP-S Call for Projects](http://www.ewgateway.org/transportation-planning/transportation-improvement-program/competitive-transportation-programs/call-for-projects-stp-s/) web page: <http://www.ewgateway.org/transportation-planning/transportation-improvement-program/competitive-transportation-programs/call-for-projects-stp-s/>

#### PLEASE NOTE:

This project application form is for the road project type. There are separate project application forms for the other project types, including: bridge, traffic flow, safety, active transportation, transit, and freight/economic development. If your agency is interested in applying for those project types, please obtain the application form from the EWG STP-S Call for Projects web page, or contact EWG staff for more information.

The call for projects begins on **November 4, 2022** and ends on **February 9, 2023** at 4:00 pm. Applications received after the deadline will not be accepted. Submit the completed application and necessary attachments electronically to EWG at [stps@ewgateway.org](mailto:stps@ewgateway.org). Save the electronic copy as a PDF file using the following format: 2023STPS\_[Sponsor]\_[Project Name].pdf. The electronic submission must include scanned signatures and attachments. Please submit one application per email. You will receive an email confirmation within one business day of submittal. If you do not receive confirmation or have questions about the application, contact EWG staff. The information provided in this application is public record.

#### APPLICATION FEE

An application fee is required for each project that is submitted for consideration. The application fee is ½ of one percent of the federal funds being requested. For example, a project sponsor requesting \$800,000 in federal funding would be required to pay a \$4,000 application fee. Counties make annual contributions to EWG and, as such, a credit equal to their annual contribution is applied against their application fee. Counties will be invoiced for any amount above the annual contribution credit.

The TIP Application Fee Payment Information Form must be included with the TIP application fee. This form is available on the STP-S Call for Projects web page. Application fees may be submitted by check via mail or through electronic funds transfer (EFT). Mailed application fees must be postmarked by February 9, 2023. For check payments, send the TIP Application Fee Payment Information Form and check to:

TIP Application  
East-West Gateway Council of Governments  
1 S. Memorial Drive, Suite 1600  
St. Louis, MO 63102-2451

For EFT payments, send the TIP Application Fee Payment Information Form via email to [tipappfees@ewgateway.org](mailto:tipappfees@ewgateway.org). EFT payments are due by February 16, 2023.

#### CONTACT INFORMATION

Jason Lange, TIP Coordinator  
East-West Gateway Council of Governments  
1 S. Memorial Drive, Suite 1600  
St. Louis, MO 63102-2451  
E-mail: [stps@ewgateway.org](mailto:stps@ewgateway.org)



## PROJECT CHECKLIST AND SUBMITTAL REQUIREMENTS

The evaluation and scoring of all projects will be based on the answers provided in the application and the attachments submitted.

The materials should be submitted in the following order.

### Project Application:

- ☐ **Completed STP-S application**
- ☐ **Scanned required signatures** – Notification of Title VI & Nondiscrimination Requirements, Financial Certification of Matching Funds, Person of Responsible Charge Certification, Right-of-Way Acquisition Certification Statement, Policy on Reasonable Progress Certification (Missouri only).

### Attachment A:

- ☐ **Project location map** – depict the location of the project on a base map such as a town road map, GIS map, aerial photo, or another base map suitable to clearly show the project's overall location. Provide on an 8 ½ x 11 page. Project location is used by EWG to determine:
  - geographic scale project categorization (i.e., 'within community' or 'outside community')
  - score for Environmental Justice
  - score for employment density
  - score for intermodal connections
- ☐ **Detailed cost estimate** – use Estimate of Project Costs excel file provided by EWG.
- ☐ **Letter of permission from facility owner** – provide if sponsor does not own roadway.
- ☐ **Letter of support from match source** – provide if individual, business, other local public agency, or other third-party is providing matching funds.
- ☐ **Coordination letter(s)** – provide if sponsor requires coordination with other agencies to implement the project (e.g., Bi-State Development, Madison County Transit District, St. Clair County Transit District).

### Attachment B:

- ☐ **Photographs** – attach photo(s) of the current roadway.
- ☐ **Detailed map** – if applicable, provide a map showing:
  - locations of all proposed safety countermeasures along project limits (i.e., if chevrons are being added to a curve, mark the curve where the chevrons will be added)
  - transit routes along project limits
  - community resources along project limits (e.g., park/trail, full service grocery store, civic building, library, health center, recreation center)
  - schools (grades K-12 and college/university) located within ½ mile of project limits
  - freight facilities along project limits (e.g., intermodal freight facility, major freight generator, logistic center, manufacturing or warehouse industrial land, port facility)
- ☐ **Typical section** – show details of before and after roadway improvements.
- ☐ **Road condition** – use Road Condition Evaluation Form provided by EWG.



Attachment C:

☐

**Crash reports** – attach full crash reports for all fatal and serious injury crashes and up to 10 minor injury and/or property damage only crashes that coincide with the safety countermeasure within the project limits from 2016-2020. Redact any personal information (e.g., names, addresses, etc.). Crash reports are not required if the project has no safety countermeasures.

Attachment D: (optional)

☐

**Documentation of an approved or adopted plan, ordinance, and/or policy that supports the project** – do not attach entire plan documents, only include the necessary pages.

☐

**Letters of support** – endorsements or petitions from associations, boards, school districts, residents, businesses, etc. Only attach letters of support that pertain to specific project.

☐

**Documentation of public involvement process** – public meeting minutes, newspaper clippings, press announcements, etc.

Attachment E:

☐

**ITS architecture consistency** – submit ITS Architecture Project Consistency Statement Form provided by EWG if project includes ITS elements or modifies existing ITS.



SPONSOR INFORMATION									
Sponsoring agency:									
Secondary sponsor agency (if applicable):									
<b>Chief Elected Official/Chief Executive Director:</b>									
Name:					Title:				
Street address:									
City:		State:		County:		ZIP code:			
<b>Project contact:</b>									
Name:					Title:				
Agency:									
Street address:									
City:		State:		County:		ZIP code:			
Phone Number:					E-mail address:				
<b>Application contact:</b>									
Name:					Phone Number:				
E-mail address:									
PROJECT INFORMATION									
Project title:									
Project status: <input type="checkbox"/> New project <input type="checkbox"/> Continuation of STP-S/CMAQ/TAP project <input type="checkbox"/> Add to existing non-federally funded project				Is this application request for a piece of a larger project (phase) or the entire length of project? <input type="checkbox"/> Phase <input type="checkbox"/> Full project					
If project is a continuation of another project that was previously programmed in the TIP, provide TIP ID # of existing project and also explain this relationship:  									
If this project is a phase of a full project, how many phases are left to complete the project? Briefly explain each phase (i.e., project limits and general improvements):  									
Has your agency received federal funds for this specific road segment within the last 10 years? <input type="checkbox"/> Yes <input type="checkbox"/> No									
If yes, when?									
Year of original roadway construction or most recent reconstruction:									
Year of last roadway resurfacing:									
Does this project touch MoDOT or IDOT right-of-way? <input type="checkbox"/> Yes <input type="checkbox"/> No <i>If yes, a letter of support for this project is required from the state DOT.</i>									
Does the sponsoring agency own and maintain this facility? <input type="checkbox"/> Yes <input type="checkbox"/> No <i>If no, a letter of support for this project is required from the facility owner.</i>									
If no, who owns the facility?									



ROADWAY INFORMATION			
Name of street or facility to be improved:			
Project length (miles):			
Project limits – north/west reference point, cross street, or intersection:			
Project limits – south/east reference point, cross street, or intersection:			
Federal functional classification of road (per EWG) <sup>1</sup> :			
Average roadway pavement condition (PASER):			
	<b>CURRENT:</b>	<b>PROPOSED:</b>	
Traffic volumes (AADT):	Year:	Year:	
Identify source of AADT <sup>2</sup> :			
Speed limit of street (mph):			
Number of through lanes (both directions):			
Number of turn lanes:			
Two-way left turn lanes?	<input type="checkbox"/> Yes <input type="checkbox"/> No	<input type="checkbox"/> Yes <input type="checkbox"/> No	
Typical lane width (feet):			
Outside lane width (feet):			
Shoulder width (feet):			
On-street parking allowed?	<input type="checkbox"/> Yes <input type="checkbox"/> No	<input type="checkbox"/> Yes <input type="checkbox"/> No	
Curb and gutter?	<input type="checkbox"/> Yes <input type="checkbox"/> No	<input type="checkbox"/> Yes <input type="checkbox"/> No	
Sidewalks?	<input type="checkbox"/> One side <input type="checkbox"/> Both sides <input type="checkbox"/> None	<input type="checkbox"/> One side <input type="checkbox"/> Both sides <input type="checkbox"/> None	
Sidewalk width (feet):			
Existing sidewalk surface condition <sup>3</sup> :	<input type="checkbox"/> Poor <input type="checkbox"/> Fair <input type="checkbox"/> Good <input type="checkbox"/> Excellent <input type="checkbox"/> None	n/a	
Estimated sidewalk to be built (square yards):	n/a		
Sidewalk/roadway separation width (feet):			
On-road bicycle facility <sup>4</sup> ?	<input type="checkbox"/> Yes <input type="checkbox"/> No	<input type="checkbox"/> Yes <input type="checkbox"/> No	
On-road bicycle facility width:			
Shared-use path/sidepath?	<input type="checkbox"/> Yes <input type="checkbox"/> No	<input type="checkbox"/> Yes <input type="checkbox"/> No	
Shared-use path/sidepath width (feet):			
Estimated shared-use path to be built (square yards):	n/a		
Number of new and/or reconstructed curb ramps:	n/a		

<sup>1</sup> EWG Functional Classification maps: <http://www.ewgateway.org/transportation-planning/roadway-functional-classification/>.

<sup>2</sup> If source is state DOT, use data from most recent available year. If source is a count conducted by the local agency, must be within five years.

<sup>3</sup> **Poor:** the sidewalk has deep cracking and buckling, poor drainage, or tree root damage). Impassable to mobility impaired pedestrians. **Fair:** the sidewalk contains cracks or an uneven and distressed surface. Hinders mobility of the average pedestrian. **Good:** the sidewalk is free from significant cracking, buckling, or gravel surfaces. Unlikely to hinder mobility of the average pedestrian. **Excellent:** the sidewalk is in like new condition and contains no cracking or buckling. Does not hinder mobility of the average pedestrian. **None:** no sidewalk is present.

<sup>4</sup> On-road bicycle facility includes: bike lanes (separated, buffered, and standard). **Shared-lane markings (sharrows) and share the road/bikes may use full lane signage are not bicycle facilities.** View the EWG Bicycle Planning Guide for a description on bicycle facilities: [https://www.ewgateway.org/wp-content/uploads/2018/07/BicyclePlanningGuide\\_June2018.pdf](https://www.ewgateway.org/wp-content/uploads/2018/07/BicyclePlanningGuide_June2018.pdf).



**LAND ACQUISITION INFORMATION**

Status of right-of-way acquisition (all properties, permanent and/or temporary easements, Temporary Slope Construction License (TSCL), and other rights-of-way):

- ☐ All acquired or none needed  
☐ In process  
☐ Not started

If applicable, list the number of parcels to be acquired (all properties, permanent and/or temporary easements, TSCL, and other rights-of-way):

If any residential or commercial displacements are anticipated, give details on how many and if they are residential and/or commercial:

Right-of-way acquisition by:

Right-of-way condemnation by:

Will the project traverse any public property, such as a public park that has used federal funds (e.g., Land and Water Conservation Funds) in the past?

- ☐ Yes ☐ No ☐ Unknown

**UTILITY COORDINATION**

*Note: project sponsor must coordinate with utilities prior to construction.*

Will the project involve any coordination with utilities?

- ☐ Yes ☐ No

*If yes, check the appropriate box to select the type of utility. Then give the names of the utility companies.*

☐ Electric

☐ Phone

☐ Gas

☐ Water

☐ Cable TV

☐ Storm sewer

☐ Sanitary sewer

☐

☐

Give details concerning potential utility conflicts, problems, or issues:

Utility coordination completed by:

Designed by:

Inspected by:



RAILROAD COORDINATION	
Does the project traverse any property owned by a railroad? <input type="checkbox"/> Yes <input type="checkbox"/> No	
Is there a railroad within 500' of project limits? <input type="checkbox"/> Yes <input type="checkbox"/> No	
Name of railroad:	
Number of crossings impacted:	
Are the crossings active?	<input type="checkbox"/> Yes <input type="checkbox"/> No
Width of crossing:	
What is the crossing type? <input type="checkbox"/> Timber <input type="checkbox"/> Rubberized <input type="checkbox"/> Asphalt <input type="checkbox"/> Concrete <input type="checkbox"/> Other	
Describe other:	
PROJECT MAINTENANCE	
List any regular maintenance tasks anticipated over the next 25 years:	
Estimated annual cost to maintain facility and funding source(s):	
AMERICANS WITH DISABILITIES ACT	
Under the 1990 Americans with Disabilities Act (ADA), Title II requires public entities with more than 50 employees to complete a self-evaluation and create an effective ADA transition plan <sup>5</sup> .	
Does your local public agency have more than 50 employees? <input type="checkbox"/> Yes <input type="checkbox"/> No	
If yes, does your agency have an adopted ADA transition plan? <input type="checkbox"/> Yes <input type="checkbox"/> No	
If your agency has an ADA transition plan, when was it adopted?	
If ADA transition plan is not adopted, when is it expected to be adopted?	

<sup>5</sup> FHWA Questions and Answers about ADA/Section 504: [https://www.fhwa.dot.gov/civilrights/programs/ada/ada\\_sect504qa.cfm](https://www.fhwa.dot.gov/civilrights/programs/ada/ada_sect504qa.cfm).



#### PROJECT DESCRIPTION

Define the **scope** and **specific elements** of the project. Describe current conditions / problems / issues that the project will address. Be as specific as possible.

#### COMMUNITY SUPPORT

Describe the public involvement activities to date on the proposed project:



PROJECT DEVELOPMENT SCHEDULE					
Note: many stages can occur concurrently.					
Activity Description	Start Date (MM/YYYY)	Finish Date (MM/YYYY)	Time Frame (Months)		
Receive notification letter	10/2023	10/2023	1		
Execute agreement (project sponsor and DOT)					
<b>Engineering services contract submitted and approved*</b>					
Obtain environmental clearances (106, CE2, T&E, etc.)					
Public meeting/hearing					
Develop and submit preliminary plans					
Preliminary plans approved					
Develop and submit right-of-way plans					
Review and approval of right-of-way plans					
<b>Submit and receive approval for notice to proceed for right-of-way acquisition (A-Date)*</b>					
Right-of-way acquisition					
Utility coordination					
Develop and submit PS&E					
<b>District approval of PS&amp;E/advertise for bids*</b>					
Submit and receive bids for review and approval					
Project implementation/construction					
* Finish date must match fiscal year for each milestone shown in <b>bold</b> text.					
FINANCIAL PLAN					
Note: federal participation for a phase of work must not exceed 80% in Missouri for all phases of work and 80% in Illinois for construction/construction engineering phase only. In Illinois, PE and right-of-way must be paid with local funds.					
Activity <sup>6</sup>	Starting Federal Fiscal Year <sup>7</sup>	Total Phase Cost	STP-S Funds Requested	Sponsor Share	Sponsor Share Percentage
PE / Planning / Environmental Studies	FY				
Right-of-Way (ROW)	FY				
Construction Engineering	FY				
Construction / Implementation	FY				
<b>TOTAL PROJECT COST</b>					
Identify the source(s) of local matching funds (e.g., state DOT, city, county, county road board, county motor fuel tax, private entity), and the amount for each source:					

<sup>6</sup> **Illinois:** construction/construction engineering funds are available in FY 2027.

**Missouri:** preliminary engineering (PE) funds are available in FY 2024, right-of-way (ROW) in FY 2024 (only if PE is locally funded) OR FY 2025, and construction/construction engineering in FY 2026 (if ROW is scheduled for FY 2024) OR FY 2027.

<sup>7</sup> Fiscal years are federal fiscal years (October 1 through September 30).



SAFETY		
Were there any crashes along project limits from 2016-2020? <b>Note:</b> a project can still potentially receive partial points if it does not have crashes, but includes a preventive safety countermeasure. <input type="checkbox"/> Yes <input type="checkbox"/> No		
<b>Total number of crashes by severity type along project limits:</b>		
Fatal (K on the KABCO scale):		
Serious injury (A on the KABCO scale):		
Minor injury (B and C on the KABCO scale):		
Property damage only (O on the KABCO scale):		
Total number of crashes from 2016-2020 along project limits:		
Does the project include safety countermeasure(s)? <input type="checkbox"/> Yes <input type="checkbox"/> No		
If yes, identify the safety countermeasure(s) proposed, its Crash Modification Factor (CMF), and the CMF ID below (e.g., installation of safety edge treatment – CMF: 0.92 – CMF ID: 4303):		
<b>Countermeasure</b>	<b>CMF</b>	<b>CMF ID</b>
<b>Note:</b> a list of safety countermeasures and their CMFs is provided in Appendix C of the STP-S Scoring Criteria Guide. In addition, the FHWA Crash Modification Factors Clearinghouse provides a searchable database of safety countermeasures: <a href="http://www.cmfclearinghouse.org/">http://www.cmfclearinghouse.org/</a> .		
Describe how the proposed safety countermeasure(s) will address the crashes occurring along the project limits:		
Are there any undocumented safety issues? <input type="checkbox"/> Yes <input type="checkbox"/> No		
If yes, describe the undocumented safety issue(s) and explain how the preventive safety countermeasure(s) will address the issue:		



## MULTIMODAL

Does the proposed project incorporate any of the following bicycle-related improvements?

- ☐ Separated bike lane/cycle track/protected bike lane
- ☐ Shared-use path/trail/arterial sidepath
- ☐ Buffered bike lane
- ☐ Standard bike lane (not buffered)
- ☐ Marked shared roadway (shared-lane markings, “sharrow”)
- ☐ Paved shoulder
- ☐ Wayfinding or end of trip facilities
- ☐ Other
- ☐ None

Describe the bicycle-related improvements (including ‘other’) in detail:

Does the proposed project incorporate any of the following pedestrian-related improvements?

- ☐ New sidewalks (where none currently exist)
- ☐ Sidewalk spot slab improvements
- ☐ Sidewalk reconstruction
- ☐ Construction of new curb ramps (where none currently exist)
- ☐ Curb ramp reconstruction
- ☐ Sidewalk/roadway separation
- ☐ Wayfinding, furniture, or other end of trip facilities
- ☐ Pedestrian-scale lighting (e.g., glare shielded, lower height (12’ to 16’), in-pavement)
- ☐ Other
- ☐ None

Describe the pedestrian-related improvements (including ‘other’) in detail:

Approximately what percentage of the project limits includes new or reconstructed sidewalk or shared-use path?



Does the proposed project incorporate any of the following intersection or crossing treatments?

- ☐ Pedestrian signals/push buttons
- ☐ Countdown timers
- ☐ Leading pedestrian interval (LPI)
- ☐ Bicycle signals or bicycle detection
- ☐ Rectangular Rapid-Flashing Beacon (RRFB)
- ☐ Pedestrian Hybrid Beacon (PHB or HAWK)
- ☐ Marked crosswalks (standard parallel crosswalk markings or brick crosswalk)
- ☐ High-visibility crosswalks (e.g., ladder, zebra, or continental crosswalk markings)
- ☐ Raised crosswalks
- ☐ Midblock crossings
- ☐ Pedestrian refuge islands
- ☐ Curb radius reduction
- ☐ Curb extension or bulb-outs
- ☐ Bicycle boxes
- ☐ Colored pavement crossings for bicycles lanes marked through intersection
- ☐ Other
- ☐ None

Describe the intersection or crossing treatments (including 'other') in detail and identify crosswalk locations:

If the project incorporates any safety, traffic calming, or design improvements, describe the improvements (e.g., improvements at a rail-grade crossing, intersection improvements, road diets, bulb-outs, raised median barriers, center islands, roadway markings, improved signage and signals):

Does the project improve access to transit stops, stations, park-and-ride lots, or other major transit facilities?

☐ Yes ☐ No

If yes, identify the bus route and/or transit facility:



Does the project incorporate improvements to existing transit stops or stations (e.g., 5' x 8' ADA landing pads, benches, shelters)?

☐ Yes ☐ No

If yes, identify the improvements:

Does the project provide direct access (i.e., adjacent) to a school (grades K-12 and college/university)?

☐ Yes ☐ No

Is the project within ½ mile of a school?

☐ Yes ☐ No

If yes, identify the school(s):

School Name	Proximity to Project
	<input type="checkbox"/> Direct <input type="checkbox"/> Within ½ mile
	<input type="checkbox"/> Direct <input type="checkbox"/> Within ½ mile
	<input type="checkbox"/> Direct <input type="checkbox"/> Within ½ mile
	<input type="checkbox"/> Direct <input type="checkbox"/> Within ½ mile

Does the project provide direct access (i.e., adjacent) to a community resource (e.g., park/trail, full service grocery store, civic building, library, health center, recreation center)?

☐ Yes ☐ No

If yes, identify all community resources (planned or existing) that the project directly serves:

#### SYSTEM RELIABILITY

Does the project include management and operations strategies that optimize the performance of the road (e.g., ITS technologies, traffic operational improvements)?

☐ Yes ☐ No

If yes, explain the strategy and how it improves the reliability of the transportation system:



### INTERMODAL CONNECTIONS

Is the project located within an industrial site area (per St. Louis Regional Freight Study)?

☐ Yes ☐ No

If yes, what is the name of the industrial site area (e.g., Broadway-Arsenal, Earth City, GM Plant)?

Is the project adjacent to or does it directly impact an intermodal freight facility, major freight generator, logistic center, manufacturing and warehouse industrial facility, or port facility?

☐ Yes ☐ No

If yes, identify the facility or major freight generator:

Identify any commercial vehicle countermeasures proposed, and explain how the project provides improvement to the movement of freight to and from the industrial site area, facility, or major freight generator:

### ENVIRONMENT

Does the project incorporate any of the following green infrastructure improvements?

- ☐ Bioswales
- ☐ Rain gardens
- ☐ Pervious pavements
- ☐ Green bulb-outs
- ☐ Solar powered lighting fixtures
- ☐ Other
- ☐ None

Describe the green infrastructure improvements (including 'other') in detail:



## NOTIFICATION OF TITLE VI & NONDISCRIMINATION REQUIREMENTS

### Title VI

A recipient of any federal funds from the U.S. Department of Transportation (“DOT”) must comply with federal statutes, regulations, executive orders, and other pertinent directives that govern nondiscrimination in federally assisted programs. Below is a list of the statutes and regulations that may apply to a recipient’s program; however, other federal requirements regarding nondiscrimination may be imposed by DOT.

- A. Title VI of the Civil Rights Act of 1964, 78 Stat. 252, 42 U.S.C. §§ 2000d *et seq.*
- B. All requirements imposed by or pursuant to the Code of Federal Regulations, Title 49: Transportation, Subtitle A: Office of the Secretary of Transportation, Part 21: *Nondiscrimination in Federally-Assisted Programs of the Department of Transportation—Effectuation of Title VI of the Civil Rights Act of 1964.*

As part of federal requirements, a recipient of funds from DOT must ensure that it has written policies and procedures in place to ensure nondiscrimination in its programs, up to and including, developing a Title VI Plan.

### Nondiscrimination

A recipient of any federal funds from the U.S. Department of Transportation (“DOT”) must comply with federal statutes, regulations, executive orders, and other pertinent directives that govern nondiscrimination in federally assisted programs. Below is a list of the statutes and regulations that may apply to a recipient’s program; however, other federal requirements regarding nondiscrimination may be imposed by DOT.

- A. Title VI of the Civil Rights Act of 1964, as amended, 42 U.S.C. § 2000d, and implementing regulations at 49 CFR Part 21 – *Nondiscrimination in Federally Assisted Programs of the Department of Transportation—Effectuation of Title VI of the Civil Rights Act.*
- B. The equal employment opportunity provisions of 49 U.S.C. § 5332 and Title VII of the Civil Rights Act of 1964, 42 U.S.C. §§ 2000e *et seq.*, and implementing regulations, including;
  - 1. 41 CFR Part 60 – *Office of Federal Contract Compliance Programs, Equal Employment Opportunity, Department of Labor.*
- C. Title IX of the Education Amendments of 1972, as amended, 20 U.S.C. §§ 1681 *et seq.*, and implementing regulations at 49 CFR Part 25 – *Nondiscrimination on the Basis of Sex in Education Programs or Activities Receiving Federal Financial Assistance.*
- D. Section 504 of the Rehabilitation Act of 1973, as amended, 29 U.S.C. § 794, and the Americans with Disabilities Act of 1990, as amended, 42 U.S.C. §§ 12101 *et seq.*, and implementing regulations, including:
  - 1. 49 CFR Part 27—*Nondiscrimination on the Basis of Handicap in Programs and Activities Receiving or Benefiting from Federal Financial Assistance.*
  - 2. 49 CFR Part 37—*Transportation Services for Individuals with Disabilities (ADA).*
  - 3. 36 CFR Part 1192 and 49 CFR Part 38—*Americans with Disabilities (ADA) Accessibility Specifications for Transportation Vehicles.*
  - 4. 28 CFR Part 35—*Nondiscrimination on the Basis of Disability in State and Local Government Services.*
  - 5. 28 CFR Part 36—*Nondiscrimination on the Basis of Disability by Public Accommodations and in Commercial Facilities.*
  - 6. 41 CFR Subpart 101 – 119—*Accommodations for the Physically Handicapped.*
  - 7. 29 CFR Part 1630—*Regulations to Implement the Equal Employment Provisions of the Americans with Disabilities Act.*
  - 8. 47 CFR Part 64, Subpart F—*Telecommunications Relay Services and Related Customer Premises Equipment for the Hearing and Speech Disabled.*
  - 9. 36 CFR Part 1194—*Electronic and Information Technology Accessibility Standards.*



10. 49 CFR Part 609—*Transportation for Elderly and Handicapped Persons*.
  11. Federal civil rights and nondiscrimination directives implementing those federal laws and regulations, unless the federal government determines otherwise in writing.
- E. The Age Discrimination Act of 1975, as amended, 42 U.S.C. §§ 6101 *et seq.*
  - F. The Age Discrimination in Employment Act, 29 U.S.C. §§ 621 through 634, and implement regulations of the U.S. Equal Employment Opportunity Commission at 29 CFR Part 1625—*Age Discrimination in Employment Act*.
  - G. The Drug Abuse Office and Treatment Act of 1972, as amended, 21 U.S.C. §§ 1101 *et seq.*, the Comprehensive Alcohol Abuse and Alcoholism Prevention, Treatment and Rehabilitation Act of 1970, as amended, 42 U.S.C. §§ 4541 *et seq.*, and the Public Health Service Act of 1912, as amended, 42 U.S.C. §§ 290dd through 290dd-2.
  - H. Executive Order 12898—Federal Actions to Address Environmental Justice in Minority Populations and Low-Income Populations, 42 U.S.C. § 4321 note, and DOT Order 5620.3 at Federal Register Vol. 62 No. 18377—*Department of Transportation Actions to Address Environmental Justice in Minority Populations and Low-Income Populations*.
  - I. Executive Order 13166 – Improving Access to Services for Persons with Limited English Proficiency, 42 U.S.C. § 2000d – 1 note, and implementing policy guidance at Federal Register Vol. 70 No. 74087—*DOT Policy Guidance Concerning Recipients’ Responsibilities to Limited English Proficiency (LEP) Person*.

By submitting its application as part of the TIP process and signing below, the Project Sponsor certifies that it has reviewed the federal requirements regarding nondiscrimination in federally assisted programs and believes that the Project Sponsor complies with the required policies and procedures.

Also, the Project Sponsor acknowledges its understanding that if the Project Sponsor does not have the required policies and procedures in place prior to federal funds being obligated, then the Project Sponsor’s project may become ineligible for federal funding.

\_\_\_\_\_  
Name (print)

\_\_\_\_\_  
Title

  
Signature

\_\_\_\_\_  
Date



## FINANCIAL CERTIFICATION OF MATCHING FUNDS

This is to ensure sufficient funds are available to pay the non-federal share of project expenditures for the following project to be funded under the provisions of the Infrastructure Investment and Jobs Act (IIJA).

Project Title: 3rd Street-Roadway & ADA Compliance

Local Match Amount: \$515,439

Sponsoring Agency: City of Washington

### Chief Elected Official (or Chief Executive Officer):

Name (print): Mayor Doug Hagedorn

Signature: 

Date: 1/18/2023

### Chief Financial Officer:

Name (print): Mary Sprung

Signature: 

Date: 1/18/2023



## PERSON OF RESPONSIBLE CHARGE CERTIFICATION

The key regulatory provision, 23 CFR 635.105 – Supervising Agency, provides that the State Transportation Agency (STA) is responsible for construction of federal-aid projects, whether it or a local public agency (LPA) performs the work. The regulation provides that the STA and LPA must provide its full-time employee to be in “responsible charge” of the project.

The undersigned employee(s) of the Project Sponsor will act as person of responsible charge. If at any point the employee leaves the LPA, the LPA is responsible for finding a suitable replacement and notifying EWG. If the person of responsible charge is found to not be a full-time employee of the LPA, it will result in the loss of federal funds for this project. One employee can act as person of responsible charge for all three phases. All three phases must be signed.

### Person of Responsible Charge – Design Phase

Name (print): \_\_\_\_\_

Title: \_\_\_\_\_ Email: \_\_\_\_\_

Signature:  \_\_\_\_\_

Date: \_\_\_\_\_

### Person of Responsible Charge – Right-of-Way Acquisition Phase

Name (print): \_\_\_\_\_

Title: \_\_\_\_\_ Email: \_\_\_\_\_

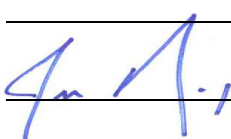
Signature:  \_\_\_\_\_

Date: \_\_\_\_\_

### Person of Responsible Charge – Construction/Implementation Phase

Name (print): \_\_\_\_\_

Title: \_\_\_\_\_ Email: \_\_\_\_\_

Signature:  \_\_\_\_\_

Date: \_\_\_\_\_



## RIGHT-OF-WAY ACQUISITION CERTIFICATION STATEMENT

The State Department of Transportation and the Federal Highway Administration (FHWA) have the right and responsibility to review and monitor the acquisition procedures of any federally funded transportation project for adherence to The Uniform Relocation Assistance and Real Property Acquisition Policies Act of 1970. Those projects found in non-compliance may jeopardize all or part of their federal funding.

A. The Project Sponsor hereby certifies that any right-of-way, and/or permanent or temporary easements necessary for this project, obtained prior to this application, were acquired in accordance with The Uniform Relocation Assistance and Real Property Acquisition Policies Act of 1970.

B. The Project Sponsor also certifies that any additional right-of-way, and/or permanent or temporary easements, subsequently required to complete the project, will be acquired according to The Uniform Relocation Assistance and Real Property Acquisition Policies Act of 1970.

\_\_\_\_\_  
Name (print)

\_\_\_\_\_  
Title

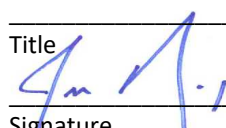
  
\_\_\_\_\_  
Signature

\_\_\_\_\_  
Date



## **POLICY ON REASONABLE PROGRESS CERTIFICATION – MISSOURI SPONSORS ONLY**

Following on the next page is a copy of the policy on reasonable progress adopted by the East-West Gateway Council of Governments Board of Directors.

The undersigned representative of the Project Sponsor hereby certifies that s/he has read this policy and understands its requirements. The representative acknowledges that failure to meet all of the reasonable progress requirements could result in federal funds being revoked and returned to the regional funding pool, as dictated by the policy.

\_\_\_\_\_  
Name (print)

\_\_\_\_\_  
Title

\_\_\_\_\_  
Signature

\_\_\_\_\_  
Date



## **POLICY ON REASONABLE PROGRESS – MISSOURI SPONSORS ONLY**

### Reasonable Progress

For projects or programs included in the Transportation Improvement Program (TIP), “reasonable progress” will have been made if the project has advanced to the point of obligating all federal funds programmed for that project in the current fiscal year, regardless of the phase of work (*i.e., preliminary engineering, right-of-way acquisition, or plans, specifications, and estimates*). If a project fails to obligate the programmed federal funds by September 30 of the current year, the funding will be forfeited and returned to the regional funding pot. Actual progress toward implementation is measured against the schedule submitted by the Project Sponsor in the project application.

### Policy Procedures and Enforcement

Projects that do not obligate all federal funds by the Board-approved suspense date will be removed from the TIP and the federal funds associated with those projects will be returned to the regional funding pool for redistribution. The removal of projects from the TIP will require no further Board action and the sponsor will have to repay any federal funds already spent if the funding is forfeited.

If a project is realizing delays that will put the federal funding at risk of forfeiture (*i.e., not meet a September 30 deadline*), the Project Sponsor will have the opportunity to ask for consideration of a “one-time extension” in their project schedule. The one-time extension can only be requested for the implementation/construction phase of the project. The extension request will only be considered once a year, and has to be made before June 1 of the current fiscal year of the TIP.

To be considered for this extension the Project Sponsor has to demonstrate on all counts: a) the delay is beyond their control and the sponsor has done due diligence in progressing the project; b) federal funds have already been obligated on the project or in cases that no federal funds are used for PE and/or ROW acquisition, there has been significant progress toward final plan preparation; and c) there is a realistic strategy in place to obligate all funds.

One-time extensions of up to three (3) months may be granted by EWG staff and one-time extensions greater than three (3) months, but not more than nine (9) months, will go to the Board of Directors for their consideration and approval. Projects requesting schedule advancements will be handled on a case-by-case basis, subject to available funding, and are subject to the Board-adopted rules for TIP modifications.

### Project Monitoring

An extensive monitoring program has been developed to help track programmed projects and ensure that funding commitments and plans are met. Monthly tracking reports are developed and posted on the EWG website, utilizing project information provided by the Project Sponsor, IDOT, and MoDOT district offices. Additionally, project sponsors are contacted at least every three (3) months by EWG staff for project status updates.



# Third Street - Roadway and ADA Compliance Project Location Map

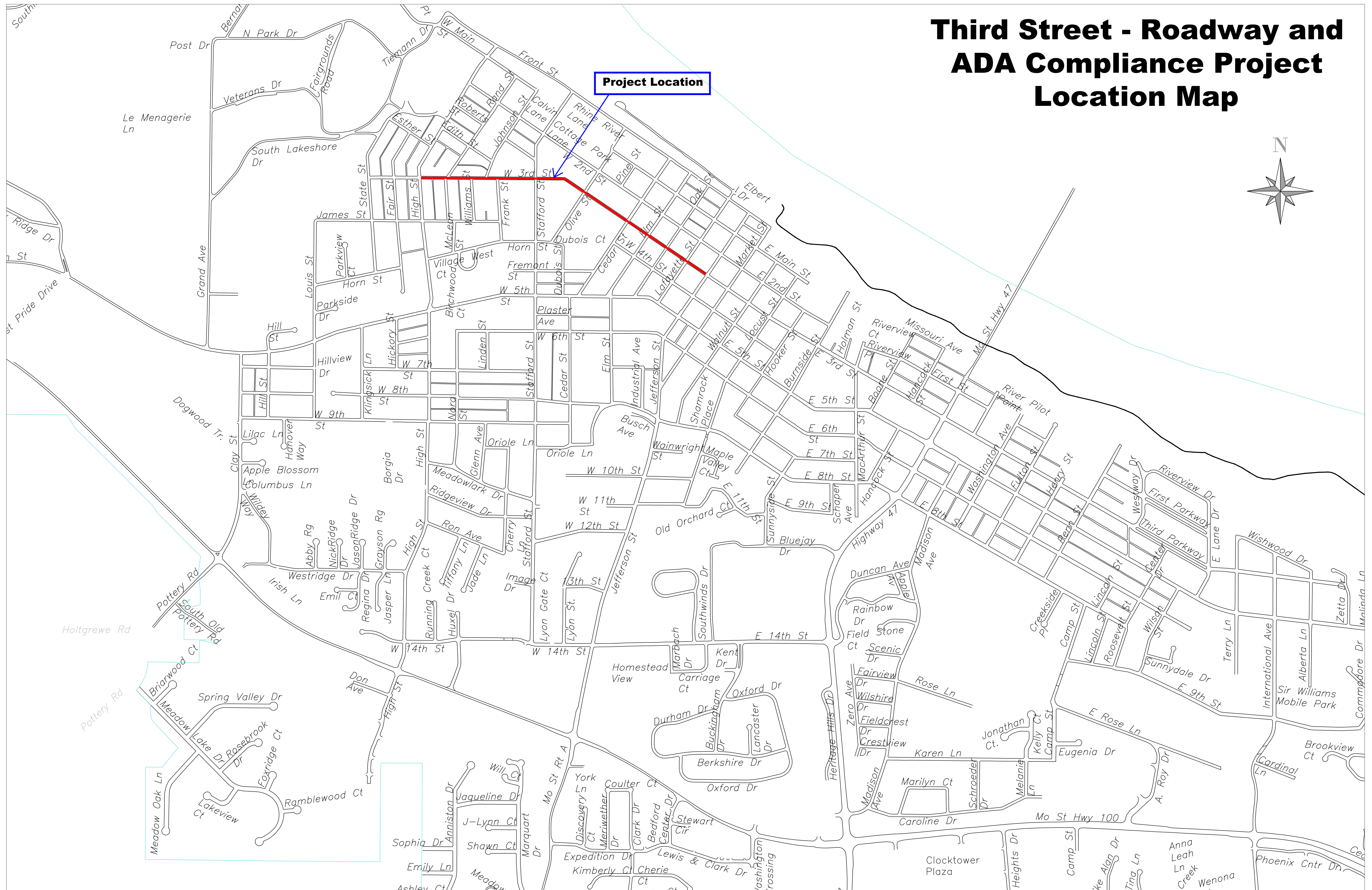
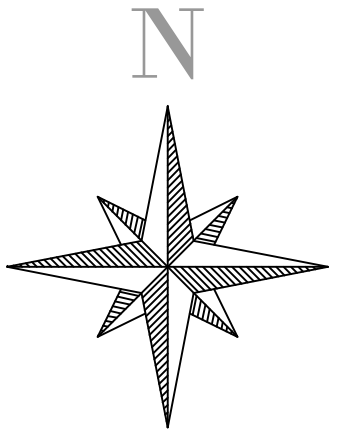



### Estimate of Project Costs

Project Sponsor:	City of Washington
------------------	--------------------

Project Title: Third Street - Roadway and ADA Compliance
--

Date: \_\_\_\_\_

Specific Roadway Items	
1	1.0000
2	2.0000
3	3.0000
4	4.0000
5	5.0000
6	6.0000
7	7.0000
8	8.0000
9	9.0000
10	10.0000
11	11.0000
12	12.0000
13	13.0000
14	14.0000
15	15.0000
16	16.0000
17	17.0000
18	18.0000
19	19.0000
20	20.0000
21	21.0000
22	22.0000
23	23.0000
24	24.0000
25	25.0000
26	26.0000
27	27.0000
28	28.0000
29	29.0000
30	30.0000
31	31.0000
32	32.0000
33	33.0000
34	34.0000
35	35.0000
36	36.0000
37	37.0000
38	38.0000
39	39.0000
40	40.0000
41	41.0000
42	42.0000
43	43.0000
44	44.0000
45	45.0000
46	46.0000
47	47.0000
48	48.0000
49	49.0000
50	50.0000
51	51.0000
52	52.0000
53	53.0000
54	54.0000
55	55.0000
56	56.0000
57	57.0000
58	58.0000
59	59.0000
60	60.0000
61	61.0000
62	62.0000
63	63.0000
64	64.0000
65	65.0000
66	66.0000
67	67.0000
68	68.0000
69	69.0000
70	70.0000
71	71.0000
72	72.0000
73	73.0000
74	74.0000
75	75.0000
76	76.0000
77	77.0000
78	78.0000
79	79.0000
80	80.0000
81	81.0000
82	82.0000
83	83.0000
84	84.0000
85	85.0000
86	86.0000
87	87.0000
88	88.0000
89	89.0000
90	90.0000
91	91.0000
92	92.0000
93	93.0000
94	94.0000
95	95.0000
96	96.0000
97	97.0000
98	98.0000
99	99.0000
100	100.0000

[illegible]

Specific Bicycle Items	
1. Bicycle frame	2. Bicycle wheels
3. Bicycle tires	4. Bicycle handlebars
5. Bicycle seat	6. Bicycle pedals
7. Bicycle chain	8. Bicycle gears
9. Bicycle brakes	10. Bicycle lights
11. Bicycle bell	12. Bicycle fenders
13. Bicycle rack	14. Bicycle lock
15. Bicycle pump	16. Bicycle repair kit
17. Bicycle helmet	18. Bicycle gloves
19. Bicycle socks	20. Bicycle shoes
21. Bicycle jersey	22. Bicycle shorts
23. Bicycle cap	24. Bicycle bag
25. Bicycle water bottle	26. Bicycle repair stand
27. Bicycle tool	28. Bicycle chain lube
29. Bicycle tire patch	30. Bicycle tire sealant
31. Bicycle chain link	32. Bicycle chain guide
33. Bicycle chain tensioner	34. Bicycle chain protector
35. Bicycle chain cleaner	36. Bicycle chain spray
37. Bicycle chain brush	38. Bicycle chain oil
39. Bicycle chain wax	40. Bicycle chain grease
41. Bicycle chain lube	42. Bicycle chain spray
43. Bicycle chain brush	44. Bicycle chain oil
45. Bicycle chain wax	46. Bicycle chain grease
47. Bicycle chain lube	48. Bicycle chain spray
49. Bicycle chain brush	50. Bicycle chain oil
51. Bicycle chain wax	52. Bicycle chain grease
53. Bicycle chain lube	54. Bicycle chain spray
55. Bicycle chain brush	56. Bicycle chain oil
57. Bicycle chain wax	58. Bicycle chain grease
59. Bicycle chain lube	60. Bicycle chain spray
61. Bicycle chain brush	62. Bicycle chain oil
63. Bicycle chain wax	64. Bicycle chain grease
65. Bicycle chain lube	66. Bicycle chain spray
67. Bicycle chain brush	68. Bicycle chain oil
69. Bicycle chain wax	70. Bicycle chain grease
71. Bicycle chain lube	72. Bicycle chain spray
73. Bicycle chain brush	74. Bicycle chain oil
75. Bicycle chain wax	76. Bicycle chain grease
77. Bicycle chain lube	78. Bicycle chain spray
79. Bicycle chain brush	80. Bicycle chain oil
81. Bicycle chain wax	82. Bicycle chain grease
83. Bicycle chain lube	84. Bicycle chain spray
85. Bicycle chain brush	86. Bicycle chain oil
87. Bicycle chain wax	88. Bicycle chain grease
89. Bicycle chain lube	90. Bicycle chain spray
91. Bicycle chain brush	92. Bicycle chain oil
93. Bicycle chain wax	94. Bicycle chain grease
95. Bicycle chain lube	96. Bicycle chain spray
97. Bicycle chain brush	98. Bicycle chain oil
99. Bicycle chain wax	100. Bicycle chain grease

[illegible]









# Third Street - Roadway and ADA Compliance Project Detailed Map





# Third Street

## Typical Roadway Sections

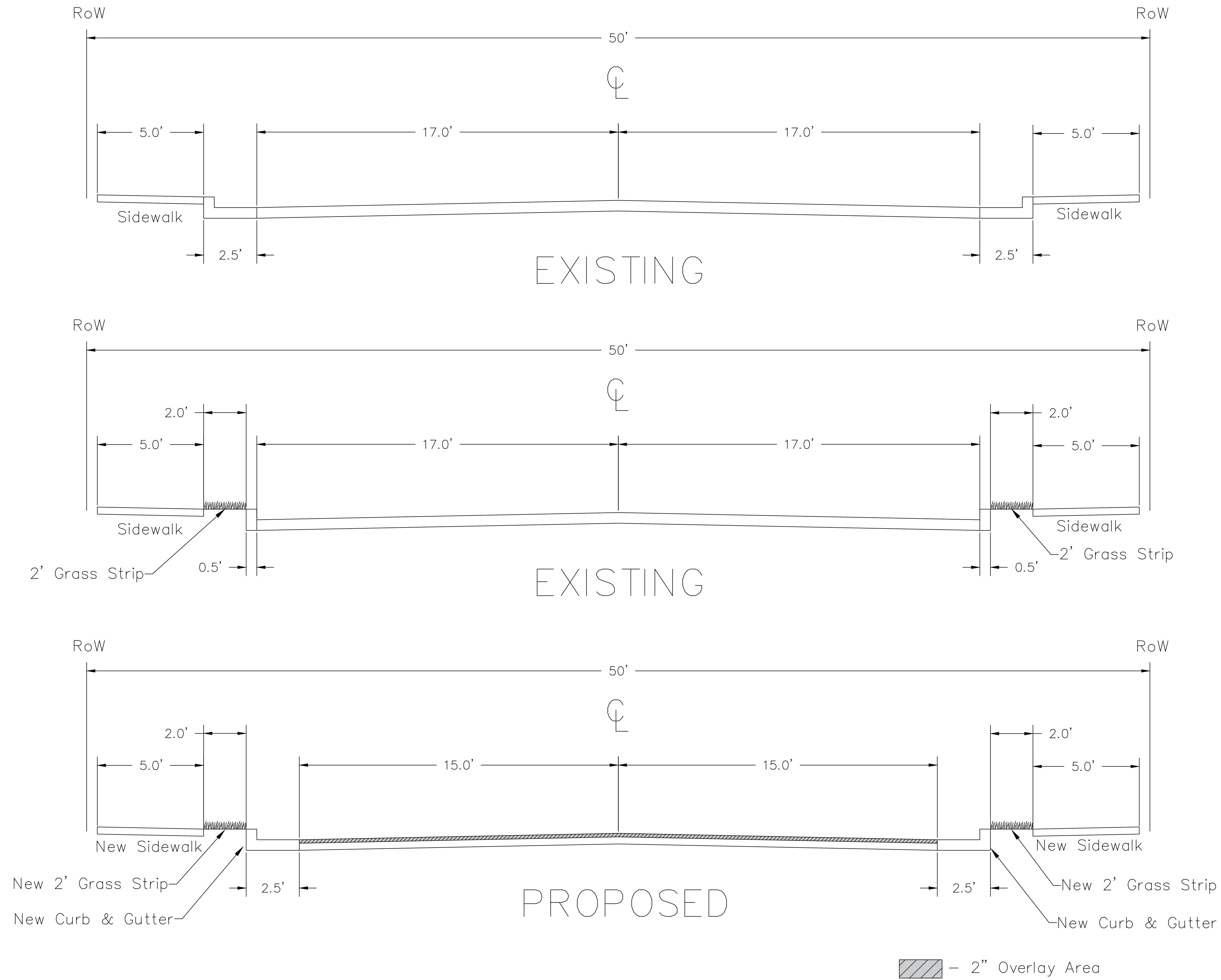





# Third Street - Road Condition Evaluation Locations Map





## Road Condition Evaluation Form

East-West Gateway Council of Governments (EWG) uses the Pavement Surface Evaluation and Rating (PASER) Manual to evaluate pavement condition. This visual rating system developed by the University of Wisconsin Transportation Information Center uses ratings ranging from 1 (failed) to 10 (excellent). If sponsors are unfamiliar with PASER, they are encouraged to review the PASER manuals online:

Asphalt Manual: [https://epd.wisc.edu/tic/wp-content/uploads/sites/3/2019/12/Asphalt-PASER\\_02\\_rev13.pdf](https://epd.wisc.edu/tic/wp-content/uploads/sites/3/2019/12/Asphalt-PASER_02_rev13.pdf)

Concrete Manual: [https://epd.wisc.edu/tic/wp-content/uploads/sites/3/2019/12/Concrete-PASER\\_02\\_rep15.pdf](https://epd.wisc.edu/tic/wp-content/uploads/sites/3/2019/12/Concrete-PASER_02_rep15.pdf)

### INSTRUCTIONS:

The first evaluation should be performed at the beginning of the project limits, with subsequent evaluations occurring at a uniform distance each 1/8 mile (660 feet) along the roadway until reaching the other end of the limits. If the project is less than 3/8 mile (1,980 feet), conduct three evaluations at a uniform distance (e.g., a 1/4 mile project would include three evaluations, spaced 440' apart). If the project is greater than one mile in length, conduct at least eight evaluations at a uniform distance (e.g., a 1 1/2 mile project would include eight evaluations, spaced 990' apart).

Record the PASER rating for each location in the table below. Individual location ratings must be whole numbers. If multiple roadways are within the project limits, simply list the new roadway name in the column on the left. You may attach another sheet with additional locations if needed. Attach an evaluation sheet for each location (see next pages), a picture of each location, and a map showing all evaluation locations. Select the evaluation sheet that matches the surface type (asphalt or concrete).

Roadway Name	Location #	Distance from start point	PASER Rating
	1	START	
	2		
	3		
	4		
	5		
	6		
	7		
	8		
	9		
	10		
	11		
	12		
	13		
	14		
	15		
	16		
AVERAGE PASER:			



## Asphalt Evaluation Sheet

(Provide this page for each location.)

Roadway Name: \_\_\_\_\_

Date: \_\_\_\_\_

Evaluation Location #: \_\_\_\_\_ Distance from Start Point: \_\_\_\_\_

Location PASER Rating  
(whole number 1-10): \_\_\_\_\_

Check all that apply:

Raveling

Rutting

Transverse Cracks

Longitudinal Cracks

Flushing

Distortion

Reflection Cracks

Block Cracks

Polishing

Patches

Slippage Cracks

Alligator Cracks

Potholes

Comments:

Drainage:

Comments:







## Asphalt Evaluation Sheet

(Provide this page for each location.)

Roadway Name: \_\_\_\_\_

Date: \_\_\_\_\_

Evaluation Location #: \_\_\_\_\_ Distance from Start Point: \_\_\_\_\_ Location PASER Rating  
(whole number 1-10): \_\_\_\_\_

Check all that apply:

Raveling	Rutting	Transverse Cracks	Longitudinal Cracks
Flushing	Distortion	Reflection Cracks	Block Cracks
Polishing	Patches	Slippage Cracks	Alligator Cracks
Potholes			

Comments:

Drainage:

Comments:







## Asphalt Evaluation Sheet

(Provide this page for each location.)

Roadway Name: \_\_\_\_\_

Date: \_\_\_\_\_

Evaluation Location #: \_\_\_\_\_ Distance from Start Point: \_\_\_\_\_ Location PASER Rating  
(whole number 1-10): \_\_\_\_\_

Check all that apply:

Raveling	Rutting	Transverse Cracks	Longitudinal Cracks
Flushing	Distortion	Reflection Cracks	Block Cracks
Polishing	Patches	Slippage Cracks	Alligator Cracks
Potholes			

Comments:

Drainage:

Comments:







## Asphalt Evaluation Sheet

(Provide this page for each location.)

Roadway Name: \_\_\_\_\_

Date: \_\_\_\_\_

Evaluation Location #: \_\_\_\_\_ Distance from Start Point: \_\_\_\_\_ Location PASER Rating  
(whole number 1-10): \_\_\_\_\_

Check all that apply:

Raveling	Rutting	Transverse Cracks	Longitudinal Cracks
Flushing	Distortion	Reflection Cracks	Block Cracks
Polishing	Patches	Slippage Cracks	Alligator Cracks
Potholes			

Comments:

Drainage:

Comments:







## Asphalt Evaluation Sheet

(Provide this page for each location.)

Roadway Name: \_\_\_\_\_

Date: \_\_\_\_\_

Evaluation Location #: \_\_\_\_\_ Distance from Start Point: \_\_\_\_\_ Location PASER Rating  
(whole number 1-10): \_\_\_\_\_

Check all that apply:

Raveling	Rutting	Transverse Cracks	Longitudinal Cracks
Flushing	Distortion	Reflection Cracks	Block Cracks
Polishing	Patches	Slippage Cracks	Alligator Cracks
Potholes			

Comments:

Drainage:

Comments:







## Asphalt Evaluation Sheet

(Provide this page for each location.)

Roadway Name: \_\_\_\_\_

Date: \_\_\_\_\_

Evaluation Location #: \_\_\_\_\_ Distance from Start Point: \_\_\_\_\_ Location PASER Rating  
(whole number 1-10): \_\_\_\_\_

Check all that apply:

Raveling	Rutting	Transverse Cracks	Longitudinal Cracks
Flushing	Distortion	Reflection Cracks	Block Cracks
Polishing	Patches	Slippage Cracks	Alligator Cracks
Potholes			

Comments:

Drainage:

Comments:







## Asphalt Evaluation Sheet

(Provide this page for each location.)

Roadway Name: \_\_\_\_\_

Date: \_\_\_\_\_

Evaluation Location #: \_\_\_\_\_ Distance from Start Point: \_\_\_\_\_

Location PASER Rating  
(whole number 1-10): \_\_\_\_\_

Check all that apply:

Raveling

Rutting

Transverse Cracks

Longitudinal Cracks

Flushing

Distortion

Reflection Cracks

Block Cracks

Polishing

Patches

Slippage Cracks

Alligator Cracks

Potholes

Comments:

Drainage:

Comments:







RESOLUTION NO. 22-13483 INTRODUCED BY SULLENTROP/HOLTMEIER

A RESOLUTION AUTHORIZING THE CITY OF WASHINGTON TO APPLY FOR FUNDING THROUGH THE EAST-WEST GATEWAY COUNCIL OF GOVERNMENTS TO PROVIDE FOR THE THIRD STREET ROADWAY AND ADA COMPLIANCE PROJECT, IN THE CITY OF WASHINGTON, FRANKLIN COUNTY, MISSOURI

WHEREAS, this section of Third Street provides a vital transportation corridor from Jefferson Street to High Street; and

WHEREAS, the pedestrian crosswalks are not ADA compliant and are in disrepair; and

WHEREAS, curb and gutter is in need of reconstruction; and

WHEREAS, sidewalks and ADA ramps will be removed and replaced to repair their deteriorating condition and bring into ADA compliance to support a bikeable/walkable community; and

WHEREAS, grant money for such project is available through the East-West Gateway Council of Governments; and

NOW, THEREFORE, be it resolved by the Council of the City of Washington Missouri, as follows:

SECTION 1: That the City of Washington, Missouri shall complete, accept, execute and submit a Surface Transportation Block Grant Application with the East-West Gateway Council of Governments for the purpose of soliciting federal funds for the High Street Reconstruction and ADA Improvements Project.

SECTION 2: That the City Engineer is hereby authorized and directed to execute said Surface Transportation Block Grant Application on behalf of the City of Washington, Missouri.

SECTION 3: That the said Surface Transportation Block Grant Application provides for the process of granting an agreement between the Missouri Department of Transportation and the City of Washington, Missouri, for federal financial assistance in the maximum amount of 80% in federal funds and the minimum amount of 20% in City local match to assist with the project described herein.

<i>Application Fee</i>	\$	7,384
<i>Grant</i>	\$	1,476,960
<i>City Match</i>	\$	369,240
<i>Total</i>	\$	1,853,584



SECTION 4: That this Resolution shall be in full force and effect from and after the date of its adoption.

Passed: 01-18-22

ATTEST: *Sheri K. Kamp*

*Sandy K. King*  
President of City Council

Approved: 01-18-22

ATTEST: *Sheri K. Kamp*

*Sandy K. King*  
Mayor of Washington, Missouri



RESOLUTION NO. 18-11875 INTRODUCED BY: PETTET/HOLTMEIER

A RESOLUTION SUPPORTING AN ADA TRANSITION  
PLAN IN THE CITY OF WASHINGTON, MISSOURI.

WHEREAS, the City of Washington is required by Title II of the American with Disabilities Act (ADA) to ensure programs and services are accessible to persons with disabilities (28 CFR 35.149-35.151); and

WHEREAS, this requirement extends to physical access at government facilities and pedestrian facilities in public rights-of-way; and

WHEREAS, The City of Washington ADA Transition Plan provides a plan, identifies existing conditions, and provides schedule to ensure compliance with the ADA.

NOW, THEREFORE, BE IT RESOLVED, by the City Council of the City of Washington, Missouri, as follows:

SECTION 1: The City of Washington ADA Transition Plan, with all included maps, descriptive matter, appendices and other matters contained therein, is hereby supported and is marked Exhibit A, attached hereto and incorporated herein by reference.

Adopted this 4th day of June, 2018 by the City Council of the City of Washington, Missouri.

PASSED: 06-04-18

ATTEST: Sherri Kulkamp  
Deputy City Clerk

Sandy Roney  
President of City Council

APPROVED: 06-04-18

ATTEST: Sherri Kulkamp  
Deputy City Clerk

Sandy Roney  
Mayor of Washington, Mo.



JR

EXHIBIT A

Ex



**CITY OF WASHINGTON ADA  
TRANSITION PLAN**

Washington, MO  
May 30, 2018

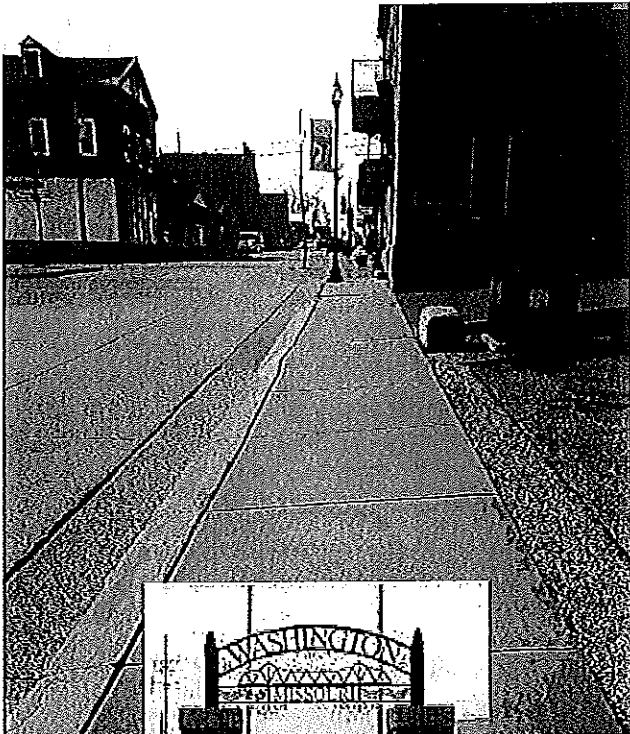



**REGULAR MEETING OF WASHINGTON, MISSOURI CITY COUNCIL**  
**TUESDAY, JANUARY 17, 2023 - 7:00 P.M.**  
**COUNCIL CHAMBER, 405 JEFFERSON STREET, WASHINGTON, MISSOURI**

<b><u>1. INTRODUCTORY ITEMS:</u></b>	<b><u>SUGGESTED COUNCIL ACTION</u></b>	
Roll Call / Pledge of Allegiance		
Approval of the Minutes from the January 3, 2023 Council Meeting	Need Motion/Mayor	Memo
<u>Approval and Adjustment of Agenda including Consent Agenda</u>	Need Motion/Mayor	Memo
a. Collector's Report Summary – September 2022		
b. Investment Report Summary – September 2022		
c. Collector's Report Summary – October 2021 – September 2022		
d. 2019 Landfill Tickets Destruction Request		
e. Final Payment Request – Phoenix Park Playground Fence		
<b><u>2. PRIORITY ITEMS:</u></b>		
a. Certificate of Appreciation – Washington Lions Club	Mayor	
<b><u>Mayor's Presentations, Appointments &amp; Reappointments</u></b>		
<b><u>3. PUBLIC HEARINGS:</u></b>		
a. Special Use Permit – 1104 Jefferson Street – Short Term Rental	Accept Into Minutes	Memo
b. An ordinance granting a special use permit to utilize 1104 Jefferson Street as a vacation rental in the City of Washington, Franklin County, Missouri.	Read/Second/Vote/Mayor	Memo
<b><u>4. CITIZENS COMMENTS:</u></b>		
<b><u>5. UNFINISHED BUSINESS:</u></b>		
<b><u>6. REPORT OF DEPARTMENT HEADS:</u></b>		
a. 2022 Building Report	Accept Into Minutes	
b. Downtown Washington, Inc. Annual Report	Approve/Mayor	Memo
c. Sporlan Valve Plant No. 1 Update	Discussion	
d. Rabbit Trail Drive/Phoenix Center Drive/International – CMAQ Application	Discussion	
<b><u>7. ORDINANCES/RESOLUTIONS:</u></b>		
a. An ordinance imposing a sales tax at a rate of three percent on all tangible personal property retail sales of adult use marijuana sold within the City of Washington, Missouri, pursuant to Article XIV, Section 2.6(5) of the Missouri Constitution subject to the approval by the voters of the City at the General Municipal Election to be held on April 4, 2023; designating the form of ballot; and directing the City Clerk to provide notice of said election.	Read & Int/Read/Vote/Mayor	



b. An ordinance authorizing and directing the execution of a use agreement by and between the City of Washington, Missouri and the Missouri State Highway Patrol.	Read/Second/Vote/Mayor	Memo
c. An ordinance authorizing and directing the execution of an easement deed by and between the City of Washington, Missouri and Marsha Kjellberg.	Read/Second/Vote/Mayor	Memo
d. An ordinance amending Ordinance No. 22-13581 and enacting in lieu thereof an ordinance authorizing and directing the execution of an easement deed by and between the City of Washington, Missouri and Charles C. Schroepfer.	Read/Second/Vote/Mayor	Memo
e. An ordinance authorizing and directing the execution of a temporary construction easement agreements by and between the City of Washington, Missouri and LB Jr & William W Eckelkamp Trs, St Peters United Church of Christ, Kevin R & Brenda S Peters, Sal Maniaci, Richard T Moore & Angela J Mosbach, Debie L Brewer, Louis B Eckelkamp Inc., Anders Holdings LLC, Roger C & Deborah A Aholt Joint Revocable Trust, Stacie M Edwards, Eckelkamp Enterprises LLC, Cowboys Holdings LLC, 4 ZS Enterprises LLC, Geneva Lakes LLC, Caleb Thomas, Tina M Behlmann Revocable Trust, Jayne M Barringhaus, Morgan Moorhead & Justin Lowrance, Franklin County Vacuum LLC, Michel E Vollmer, Ralph F & Marceline Teague, Adam D Vehige, Jimmy L & Carly T Cooper, Molly Femmer, Michael & Molly Root Joint Living Trust, Darren E & Amy L Hellmann, Eckelkamp Inv Co, Eckelkamp Ent, Jefferson Street Developers LLC, Parker-Hannifin Corp, Harms-Troesser Properties LLC, Arco Properties LLC, Veterans of Foreign Wars, Big Boys Properties LLC, Midwest Real Estate Company LLC, Barry J Grus Revocable Trust, Brinker Joint Revocable Trust, Donna M Woolery, Alta M Smith, Kleekamp Brothers Dev LLC, BVE Holdings LLC, Weiss Property Management LLC, Gary A & Donna J Hamann Joint Revocable Trust, Jeremy & Jennifer Bryant, Roger & Susan Langkopf, Roger D & Susan L Langkopf, Uptick Enterprises LLC, Daniel F & Kayce A Strohmeyer, Jerome F Kuenzel Revocable Living Trust & Donna M Kuenzel Revocable Living Trust, Loretta Kossakowski, Dominica Diane Alfermann, Allen Revocable Trust, 1400 Jefferson LLC, Union Electric Co, JDTF Family Properties LLC, Rockwood Asset Management 6 LLC, Cataldo & Liberata S Alu and Lester A Stumpe Trust Etal	Read/Second/Vote/Mayor	Memo
f. An ordinance authorizing and directing the execution of a contract agreement with N.B. West Contracting Company for the 2023 Overlay Project and Amend the 2023 Budget.	Read/Second/Vote/Mayor	Memo
g. An ordinance approving Amendment No. 1 to the development plan for acquisition of an industrial tract commonly known as the Richard Oldenburg Industrial Park providing for the sale of a lot to Precoat Metal Washington, LLC.	Read/Second/Vote/Mayor	Memo
h. An ordinance approving a boundary adjustment for Wash Mo Main Street Development Plat in the City of Washington, Franklin County, Missouri.	Read & Int/Read/Vote/Mayor	
i. A resolution authorizing the City of Washington, Missouri to apply for funding through the East-West Gateway Council of Governments to provide for the Third Street Roadway and ADA Compliance Project in the City of Washington, Franklin County, Missouri.	Read/Second/Vote/Mayor	Memo
<b>8. <u>COMMISSION, COMMITTEE AND BOARD REPORTS:</u></b>		
a. Preliminary Plat Approval – Richard Oldenburg Industrial Park Plat 1	Accept/Approve/Mayor	Memo
b. An ordinance approving the final plat of Richard Oldenburg Industrial Park Plat 1 in the City of Washington, Franklin County, Missouri.	Read & Int/Read/Vote/Mayor	



**9. MAYOR'S REPORT:**

- a. Second Council Meeting in February – Tuesday, February 21, 2023 due to President's Day Holiday

**10. CITY ADMINISTRATOR'S REPORT:**

**11. COUNCIL COMMENTS:**

**12. CITY ATTORNEY'S REPORT:**

Public Vote on whether or not to hold a closed meeting to discuss personnel, legal and real estate matters pursuant to Section 610.021 RSMo (2000).

Roll Call Vote

**13. INFORMATION:**

**14. ADJOURNMENT:**

NOTICE: COPIES OF THE PROPOSED ORDINANCES ON THIS AGENDA ARE AVAILABLE FOR PUBLIC INSPECTION PRIOR TO THE TIME THE BILL IS UNDER CONSIDERATION BY THE CITY COUNCIL.

POSTED BY SHERRI KLEKAMP, CITY CLERK, JANUARY 11, 2023

A COPY OF THIS NOTICE IS ALSO AVAILABLE ONLINE AT [www.washmo.gov](http://www.washmo.gov)