

192

STATE MO	JOB NO.	SHEET NO. 713
DIST NO. 7	PROJECT NO. 85-776(5)	ROUTE FF
PP Sheet No. 10	COUNTY Jasper / Newton	(FINAL)
PP Sheet No. 10		(CONTR)

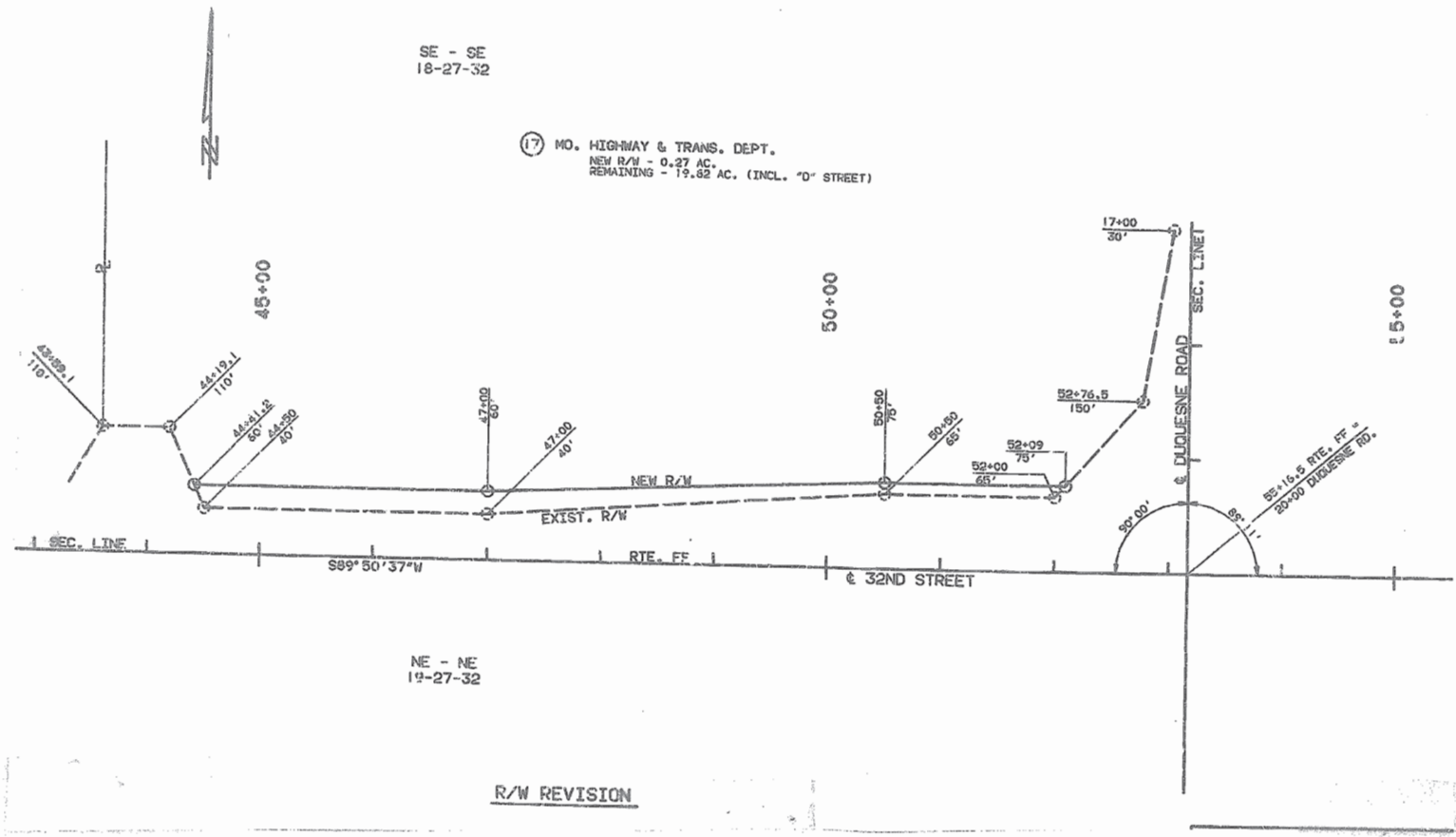

DESIGN DESIGNATION

A.D.T. - 1985 - J-670
 A.D.T. - 2203-B34D
 D - 60%
 T = 43
 V = 46 (I.P.H.)

MISSOURI HIGHWAY AND TRANSPORTATION COMMISSION PLANS FOR PROPOSED STATE HIGHWAY

FEDERAL AID PROJECT
 JASPER - NEWTON COUNTIES

COUNTY JASPER - NEWTON
 ROUTE FF
 PROJECT RS-776 (5)
 JOB NO. 7-U-FF-216

INDEX OF SHEETS

DESCRIPTION	SHEET NO.
TITLE SHEET	1
TYPICAL SECTIONS (2 SHEETS)	2
SUMMARY V (SHEET)	3A
SUMMARY I (5 SHEETS)	24
PLAN-PROFILE	7-16
REFERENCE POINTS	17
SPECIAL SHEETS (3)	18-20
LIGHTING	21-22
SIGNALS (1 Sheet)	21-22
SIGNING	23-24
CULVERT SECTIONS <i>Ch. Reynolds</i>	23-24
BRIDGE DRAWINGS	25
STANDARD PLANS INDEX	25
CROSS SECTIONS	26-34
COMPUTER DATA	



**CONVENTIONAL SIGNS
 (USED IN PLANS)**

BUILDINGS AND STRUCTURES	
GUARD RAIL	
CONCRETE RIGHT-OF-WAY MARKER	
FLUSH RIGHT-OF-WAY MARKER	
FENCE	
CHAIN LINK	
WOVEN WIRE	
GATE	
UTILITIES	
TELEPHONE	
POWER	
GAS	
WATER	
UNDERGROUND	
GAS	
WATER	
TELEPHONE	
SAN. SEWER	

NOTE: DASHED OR OPEN SYMBOL INDICATES EXISTING FEATURE

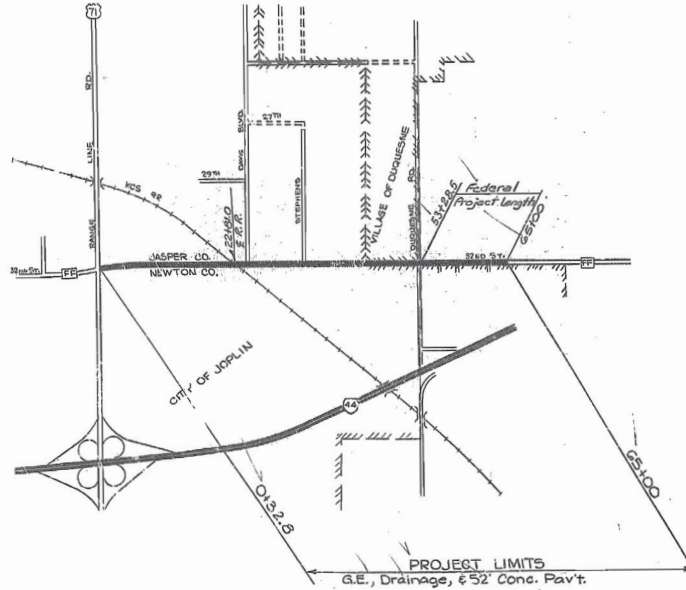

LENGTH OF PROJECT

END OF PROJECT	STA. 0+5.00
BEGINNING OF PROJECT	STA. 0+32.5
APPARENT LENGTH	6407.2 FEET
EQUATIONS AND EXCEPTIONS	None
TOTAL CORRECTIONS	0.0 FEET
NET LENGTH OF PROJECT	6407.2 FEET
STATE LENGTH	1.225 MILES
FEDERAL LENGTH 53% 28.5% 65% 100%	11715 FEET
FEDERAL LENGTH	0.222 MILES

MISSOURI HIGHWAY AND TRANSPORTATION COMMISSION

SUBMITTED

 CHIEF ENGINEER DATE

**U.S. DEPARTMENT OF TRANSPORTATION
 FEDERAL HIGHWAY ADMINISTRATION**

APPROVED

 DIVISION ENGINEER DATE



491

7	MO.	STATE	JOB NO. 7-U.F.F.-218	SHEET NO.	2
7	JASPER - NEWTON	PROJ. NO.	RS-776(3)	CONTRACT	
		COUNTY		DATE	

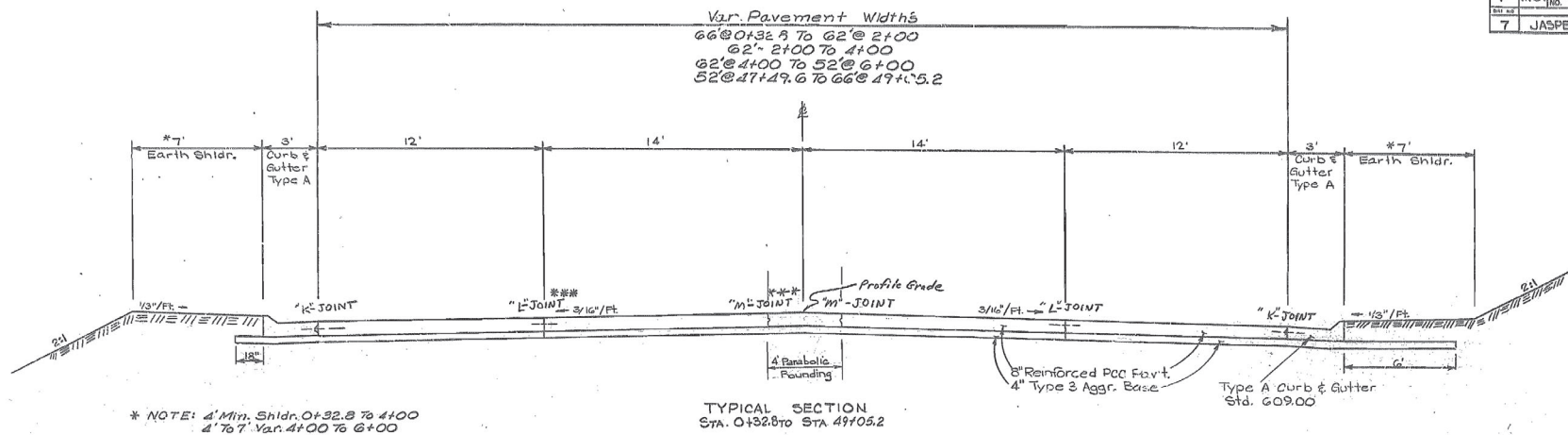

* NOTE: 4' Min. Shldr. 0+32.8 To 4+00
4' To 7' Var. 4+00 To 6+00

TYPICAL SECTION
STA. 0+32.8 TO STA. 49+05.2

NOTE: See Construction Plans For Var. Pavement Widths Sta. 0+32.8 To Sta. 6+00 and Sta. 47+49.6 To Sta. 49+05.2

*** option of one "M"-Joint
"K"-Joint may be used in lieu of "L"-Joint at any location on project

STAGE CONSTRUCTION

Grading & Paving:
Grading See Typ. Sec. Sheet 2 of 4
Paving See Spec. Sheet No. 1 and 2

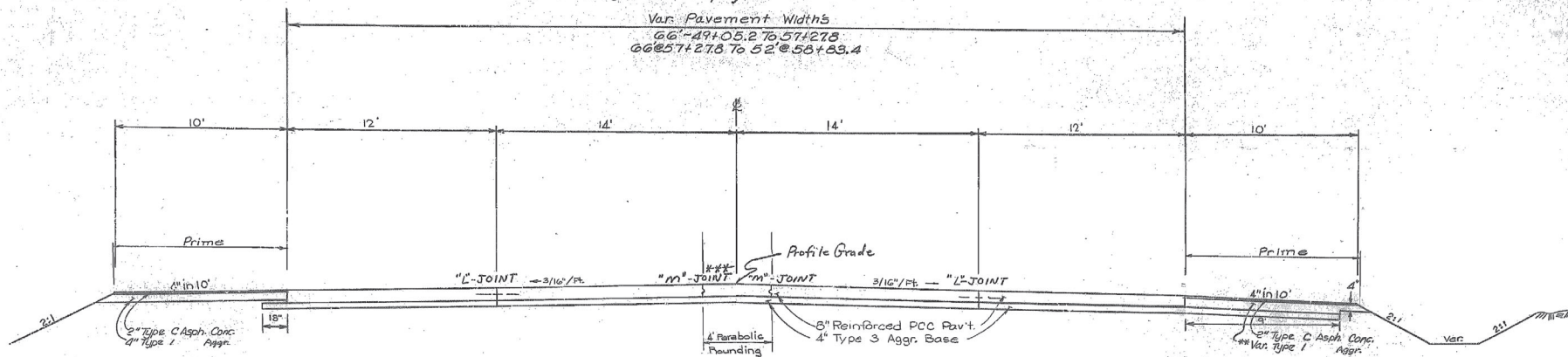

TYPICAL SECTION
STA. 49+05.2 TO STA. 65+00

NOTE: See Construction Plans For Var. Pavement Widths Sta. 49+05.2 To Sta. 58+83.4

** Note: Var. Thickness Type 1 Aggr. Base For Shoulders Paid for as 4" Type 1 Aggr. Base S.Y.

7	MO	25-776(5)	2
7	JASPER-NEWTON	FF	

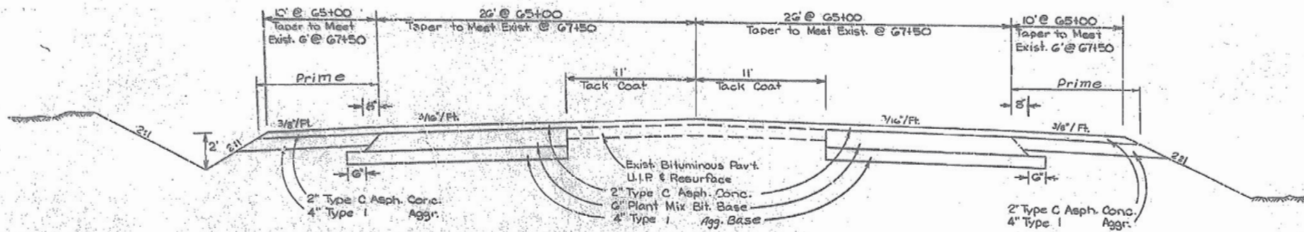

TYPICAL SECTION
Pav't. Taper @ End of Proj.
Sta. 65100 to 67150

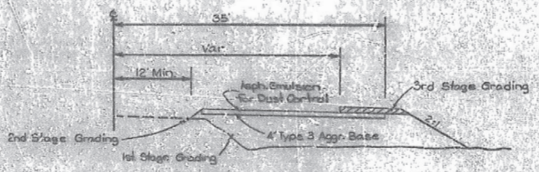

1st & 2nd Stage Grading
Sta. 41100 to 67150

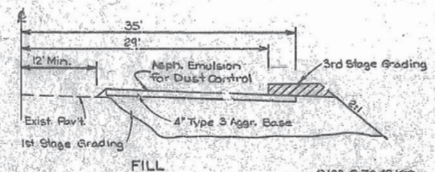

TYPICAL SECTION
1st & 3rd Stage Grading

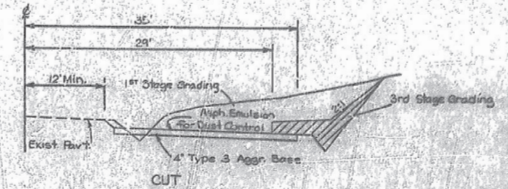

0132.8 TO 41100
Curb & Gutter Section

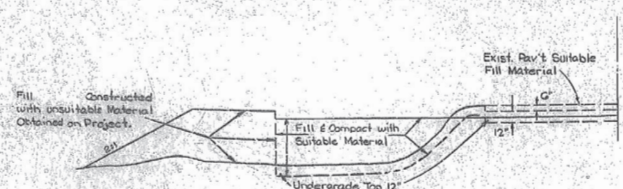

TYPICAL HALF SECTION
FILL

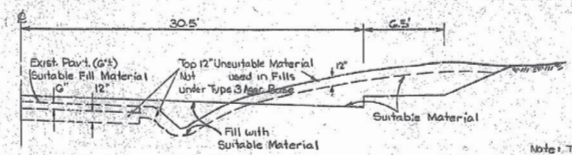

TYPICAL HALF SECTION
CUT

TYPICAL SECTIONS
Undergrading Unsuitable Material
4100 to 37100

Note: The Contractor May Stockpile Excess Unsuitable Material on R/W Lt. of Sta. 25100 to 34100 for Completion of Grading (Min. 4100 to 49100). Disposing of Excess Unsuitable Material after Grading is Completed will be at the Contractors Expense and Considered Completely Covered in Other Items

TYPICAL SECTION
Roadway
Stage Const.
Unsuitable Material
Sheet 2 of 4

493

FINAL PLANS

NO. 152	STATE	JOB NO. 7-U-FF-218	SHEET NO.
7	MO.	25-776(5)	2
7	JASPER - NEWTON	FF	

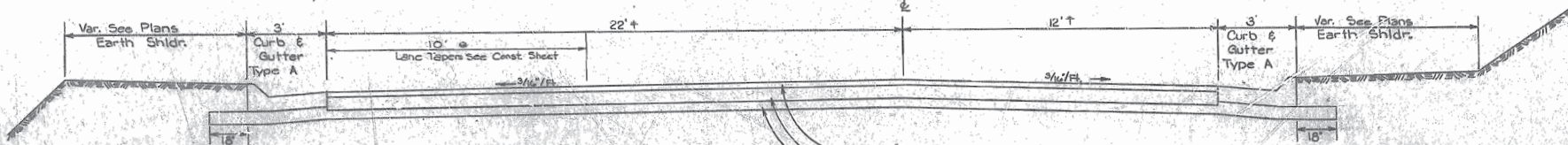

Const Lane Taper Full Depth
Sls 7+20.5 to 8+20.5
Tack on Exist Pavt Davis
to be Resurfaced
Sls 7+00.5 to 8+74.6
2" Type 'C' Asph. Conc.
Stepena St. 8+54 to 8+56.2
(See Typical Sec. on Curb Sec. sh #25)

2" Type 'C' Asph. Conc.
6" Plant Mix Bit. Base
4" Type 1 Aggr.

TYPICAL SECTION
Davis St. & Stephens St.
See Const. Plan Sheets 7 & 9 for Details

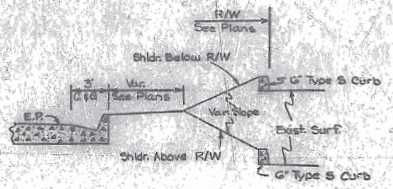

SECTION A-A

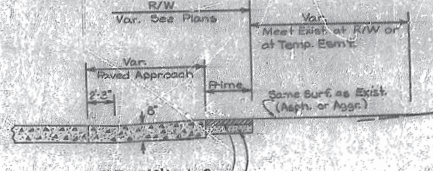
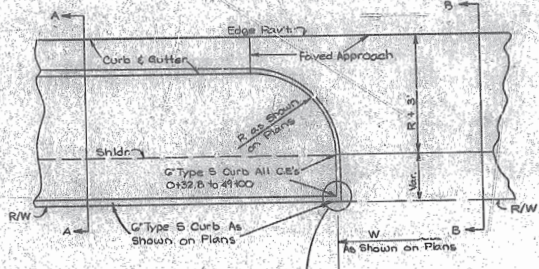

SECTION B-B

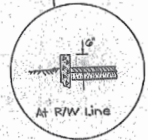

At R/W Line

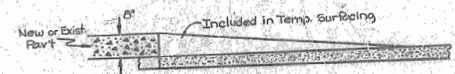

TYPICAL SECTION
Transition from Pavt. to
Base to Carry Traffic in
Const. Area.

4974

7	MO	PROJ. NO. 25-776 (5)	SHEET NO. 2
7	JASPER - NEWTON	FF	

- * Construct Shldr. Full Depth 21+52.9 to 22+00 (Most Exist)
- Tack on Exist Surf. To be Resurfaced 21+52.9 to 22+00 2" Type C Asph. Conc.

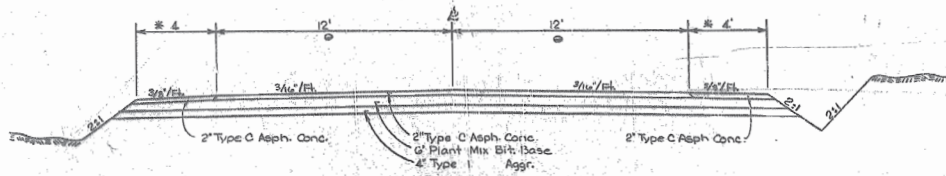

TYPICAL SECTION
DUQUESNE ROAD
(SOUTH)
20+33 to 21+52.9

NOTE: See Construction Plans Sheet 12 6' 14
for Pavement Widths & Tapers.

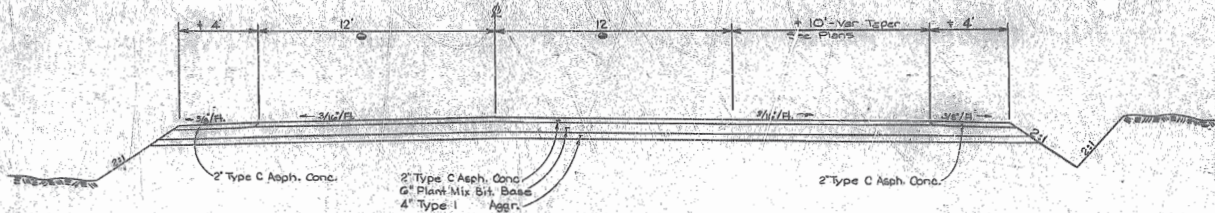
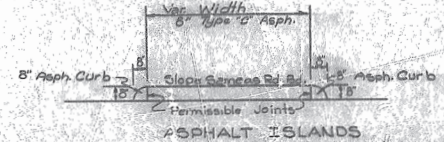

TYPICAL SECTION
DUQUESNE ROAD
(NORTH)
18+00 to 19+67

- * Construct Shldr. & Taper Full Depth 17+00 to 18+00 (Most Exist)
- Tack on Exist Surf. to be Resurfaced 17+00 to 18+00 2" Type C Asph. Conc.

495-5

MISSOURI HIGHWAY AND TRANSPORTATION COMMISSION

SUMMARY OF QUANTITIES

SHEET NO.	JOB NO. 7-U-FF-218	SHEET NO. 2A
PROJECT NO.	RS-776(5)	ROUTE
COUNTY	JASPER-NEWTON	FF

SHEET 1 of 1

ITEM	DESCRIPTION	UNIT	QUANTITY
201-10.00	CLEARING	ACRE	3.1
201-20.00	GRUBBING	ACRE	2.3
202-20.10	REMOVAL OF IMPROVEMENTS	LUMP SUM	1
203-10.00	CLASS A EXCAVATION	CU YD	37467
203-60.00	COMPACTING EMBANKMENT	CU YD	27569
203-70.00	COMPACTING IN CUT	CU YD	6680
205-10.00	OVERHAUL (STATION)	STA YD	422,891
206-30.00	CLASS 3 EXCAVATION	CU YD	4600
208-10.00	INTERCEPTION DITCH	100 FT	3
301-10.11	ASPHALT CEMENT (BITUMINOUS BASE) 60-70	TON	795
301-20.00	MINERAL AGGREGATE (BITUMINOUS BASE)	TON	1576
304-30.43	TYPE 1 AGGREGATE FOR BASE (4 IN. THICK)	SQ YD	9423
304-33.43	TYPE 3 AGGREGATE FOR BASE (4 IN. THICK)	SQ YD	47,405
310-70.01	GRAVEL (A) OR CRUSHED STONE (B) OR CHALK (C)	CU YD	0
380-90.00	TEMPORARY SURFACING	CU YD	134
403-10.11	ASPHALT CEMENT (ASPHALTIC CONCRETE) 60-70	TON	650
403-80.00	MINERAL AGGREGATE (ASPHALTIC CONCRETE) (TYPE C MIX)	TON	1379
407-10.00	TACK COAT	GALLON	150
407-20.00	SANDING TACK	CU YD	12
408-10.10	PRIME-LIQUID ASPHALT MC 30	GALLON	1110
408-10.20	PRIME-EMULSIFIED ASPHALT SS-1	GALLON	5700
502-11.00	CONCRETE PAVEMENT (8 IN. NON-REINF)	SQ YD	98
502-12.00	CONCRETE PAVEMENT (8 IN. REINFORCED)	SQ YD	39,566.0
601-10.00	FIELD LABORATORIES	LUMP SUM	1
608-50.00	PAVED APPROACH, 8 IN.	SQ YD	1386.4
609-10.10	CONCRETE CURB (6 IN. HEIGHT AND UNDER) TYPE 5	LIN FT	597
609-10.41	CONCRETE GUTTER TYPE A	LIN FT	24
609-10.91	CURB AND GUTTER TYPE A	LIN FT	8450
609-10.60	PAVED DITCH	SQ YD	3768.2
609-20.15	INTEGRAL CURB TYPE D	LIN FT	16
609-30.13	ASPHALT CURB	LIN FT	402
609-70.00	ROCK LINING	CU YD	350
612-10.30	MOVABLE BARRICADES	EACH	10
614-10.10	BRATES AND BEARING PLATES	PCUNE	2150
614-30.12	FRAME AND CURB, TYPE 2	EACH	5
614-30.13	FRAME AND CURB, TYPE 1	EACH	18
614-30.20	CURB INLET	EACH	6
616-10.00	CONSTRUCTION SIGNS	SQ FT	644

ITEM	DESCRIPTION	UNIT	QUANTITY
616-10.10	RELOCATED SIGNS	SQ FT	38
616-10.20	DRUMS	EACH	62
616-10.47	TYPE III OBJECT MARKER	EACH	60
616-10.50	FLASHING ELECTRIC LIGHT	EACH	4
618-10.00	MOBILIZATION	LUMP SUM	1
621-04.21	TEMPORARY PAVEMENT STRIPING, 4 IN., SOLID YELLOW	100 FT	13
621-04.22	TEMPORARY PAVEMENT STRIPING 4 IN., INTERMITTENT YELLOW	100 FT	57
621-10.00	PAVEMENT STRIPE REMOVAL	100 FT	69
725-02.24	24 IN. PIPE CULVERT GROUP II	LIN FT	103
725-20.08	CORRUGATED GALVANIZED METAL PIPE-ARCH TYPE B-8A	LIN FT	36
725-20.09	CORRUGATED GALVANIZED METAL PIPE-ARCH TYPE D-9A	LIN FT	1144
726-13.12	12 IN. CLASS III REINFORCED CONCRETE PIPE CULVERT	LIN FT	891
726-13.15	15 IN. CLASS III REINFORCED CONCRETE PIPE CULVERT	LIN FT	840
726-13.18	18 IN. CLASS III REINFORCED CONCRETE PIPE CULVERT	LIN FT	935
726-13.24	24 IN. CLASS III REINFORCED CONCRETE PIPE CULVERT	LIN FT	947
726-13.30	30 IN. CLASS III REINFORCED CONCRETE PIPE CULVERT	LIN FT	985
726-13.42	42 IN. CLASS III REINFORCED CONCRETE PIPE CULVERT	LIN FT	660
726-13.60	60 IN. CLASS III REINFORCED CONCRETE PIPE CULVERT	LIN FT	166
726-99.32	32 IN. X 49 IN. CLASS III (HORIZ.) ELLIPTICAL REINFORCED CONCRETE CULVERT PIPE	LIN FT	131
726-99.34	34 IN. X 50 IN. CLASS III (HORIZ.) ELLIPTICAL REINFORCED CONCRETE CULVERT PIPE	LIN FT	104
731-00.48	PRECAST CONCRETE MANHOLE - 48 IN.	FT	23
731-10.22	PRECAST CONCRETE DROP INLET 2 FT X 2 FT	FT	95
731-10.30	PRECAST CONCRETE DROP INLET 3 FT X 2 FT-6 IN.	FT	77
731-10.32	PRECAST CONCRETE DROP INLET 3 FT X 2 FT	FT	4
731-10.42	PRECAST CONCRETE DROP INLET 4 FT X 2 FT	FT	5
732-00.12	12 IN. FLARED END SECTION	EACH	4
732-00.15	15 IN. FLARED END SECTION	EACH	1
732-00.18	18 IN. FLARED END SECTION	EACH	2
732-00.24	24 IN. FLARED END SECTION	EACH	2
732-00.30	30 IN. FLARED END SECTION	EACH	12
732-00.42	42 IN. FLARED END SECTION	EACH	14
732-00.60	60 IN. FLARED END SECTION	EACH	6
802-20.00	TYPE 2 MULCH	ACRE	7.2
802-99.88	MULCH OVERSPRAY	ACRE	7.2
805-10.00	SEEDING	ACRE	8.5
806-30.00	NETTING TYPE III	SQ YD	0
901-10.10	RELOCATED POLE	EACH	1
902-99.99	RELOCATED TRAFFIC SIGNAL	L.S.	1

ITEM	DESCRIPTION	UNIT	QUANTITY
<i>CONTINGENT ITEMS</i>			
50101	Water By-Pass	Dol.	5,219.25
50102	Remove C&G Sta. 13f	L.S.	1
50103	Lid for Tube S-1 D.I.	L.S.	1
50104	Asphalt Density Samples	Each	5

Accepted: October 21, 1986

Prepared By: Patrick J. Kenny

Resident Engineer: *Ronald R. Loomis* Date: 11/3/86

Dist. Office: *Ronald R. Loomis* Date: 1-16-87

Main Office: _____ Date: _____

Maul J. Loomis 3-25-87

6
 496
 JASPER-NEWTON
 FF
 RS-776(5)



SUMMARY OF QUANTITIES

Sheet 1 of 3

DIST. NO.	COUNTY	ROUTE
7	JASPER NEWTON	FF

REMOVAL OF IMPROVEMENTS

Lump Sum = 1 *Removed as per Plan*

ENTRANCE & SIDE ROAD CULVERT PIPES & APPROACHES

Sheet	Sta.	Type	Loc.	Std.	%	Arch	Overfill	W/H	1 Day	1 Day	Remarks
						Grade	RB/B.G	Height			
10	20100	XCE	Rt.	203.31	-8.5			30'		57.5	No Pipe
13	20450	XCE	Rt.	203.31	+7.9	54"	1	30'		95.8	Reveal Posts on R/L
13	20400	XCE	Rt.	203.31	+6.4	44"	1	24'		69.5	" " " "
13	24422	XCE	Rt.	203.31	+4.1	46"	1	28'		80.2	" " " "
13	26121	EE	Rt.	203.31	-4.0	30"	1	20'			" " " "
Total ~									261144	303	

PRE-CAST CONCRETE MANHOLE

Storm	Sheet	Sta.	Loc.	No.	Size	Pipe	Feet	Frame	CL 3	Std.	75100
						Opening	48"	40over	C.V.		
2	4	2219.7	Rt. &	2-5M	48"	1:17.2:20	4	1	2		
	4	2219.7	Rt. &		5'6"	2:20	6	1	2		
	15	22167.4	Rt. &		4'8"	2:20	4	1	10		
	15	21147.9	Rt. &		4'9"	2:20	5	1	11		
	15	23117.0	Rt. &		4'8"	2:20	4	1	10		
Total ~									23	5	46

477

MISSOURI STATE HIGHWAY COMMISSION

Job No. 7-U-F-218

sheet 2 of 5

FED. ROAD DIVISION	STATE	PROJECT	SHEET NO.
5	MO.	25-776.5	2B
DIST. NO.	COUNTY	ROUTE	
7	IASPER - NEWTON	FF	

SUMMARY OF QUANTITIES

Reinforced Concrete Elliptical Culvert, Class III						Group II Pipes						Right-of-Way Markers (constructed by others)											
Sheet	Sta	Loc.	Pipe Size	C.I. 3	Remarks	Sheet	Sta.	Loc.	Size	C.I. 3	Remarks	Sheet	Sta.	Location	Remarks								
10	22125	R	24x48	24x55	109' 20' 22	Horizontal Pipe With 21 Bevel Ends	14	22127	Rt	20'	11'	Bevel End 21:1	3	1130	41.8	1' 2nd Lane							
10	23124	R	104'	105'	104' 20.5'	Horizontal Pipe With 21 Bevel Ends	15	22128	Rt	20'	15'	Bevel End 21:1	3	1140.4	20'	40'	2'						
Total ~ 101'						Totals ~ 103'						Totals ~ 59'											
Rock Lining						Interception Ditch																	
Sheet	Sta	Loc.	Culv. size	Depth ft	Width ft	Length ft	C.V	Remarks	Sheet	Sta	to Sta	Location	100 Lin. Ft.	Remarks									
15	21120	Rt	2-30"	1'	16'	16'	9'		9	21120	4110'	Lt	262'	See 6/11 (Field Measured)									
15	21120	Lt	2-30"	1'	16'	58'	9'								Total ~ 262'								
15	21132	Rt	2-30"	1'	16'	16'	9'								Use ~ 3'								
15	25115	Rt	2-30"	1'	16'	16'	9'																
15	21120	Rt	4-42"	3'	32'	50'	1.89'																
10	22125	Rt	24x48	2'	12'	20'	1.8'	Elliptical Pipe															
10	20124	Rt	24x48	2'	12'	20'	1.8'	Elliptical Pipe															
10	21125	Rt	5-60"	2'	36'	25'	1.67'	Pavement Road															
Total ~ 350' Plan																							
Clearing & Grubbing						Paved Ditch																	
Sheet	Units	Grub.	Units	Clear	Remarks	Sheet	Sta	to Sta	Location	ditch width ft	depth ft	Length ft	Slope	S.V.	Remarks								
15	0	0	0	0		7	22130		Lt	3'10"	Var	45'	15:1	15:1	7222' Pt of Davis Blvd								
15	51	56	59	59		7	25115		Lt	8'	Var	20'	2:1	2:1	5681' Lt of Davis Blvd								
15	42	53	53	53		9	21132	29122.5'	Lt	7'	Var	45'	2:1	2:1	7818'								
10	109	132	132	132		9	23157		Lt	4'2"	1'	Var	2:1	2:1	2452' Rt of Stephens Str								
13	16	30	30	30		11	21120	22130'	Lt	4'	3'	50'	2:1	2:1	221151' 68.87'								
Totals ~ 236'						Totals ~ 3768.19'						Totals ~ 3768.2'											
Type III, Netting																							
Sheet	Sta	to Sta	Loc.	ditch	Steps	S.V.	Remarks																
(Not Constructed)																							
Total ~ 0																							

8888

MISSOURI STATE HIGHWAY COMMISSION

Job No 7-U-FF-218

FED. ROAD DIVISION	STATE	PROJECT	SHEET NO.
5	MO.	R5-776(5)	25
DIS. NO.	COUNTY	ROUTE	
7	JASPER NEWTON	FF	

SUMMARY OF QUANTITIES

Sheet 4 of 5

PAVED APPROACHES										CURB & GUTTER (TYPE A) FIELD MEASURED										FIELD MEASURED									
Sheet	Sta.	Loc.	Width	Length	Return	Radius	Dist. Over	1' Apr.	Base %/ft	Remarks	Sheet	Sta.	Loc.	Lin.	Remarks	Sheet	Sta.	Loc.	Lin.	Remarks									
1403	CE. RT.	10'	8'	5'	5'	172'	24.0'				3	210249	01628	RT.	78.8	S.E. Quad. Rangeline & FF	3	0179	RT.	6.4	Bl. Side Ent.								
1485	WE. LT.	10'	10'	5'	5'	49.0'					3	1522	1472	RT.	26.9		3	1471	RT.	7.0	Bl. Side Ent.								
1487	WE. RT.	20'	10'	5'	5'	26.7'	0			Built to CE. stl.	3	2402	2428	RT.	28.0		3	1477	RT.	2.0	Bl. Side Ent.								
1488	WE. RT.	20'	10'	5'	5'	26.7'	0				3	2458	2461	RT.	79.8		3	1478	RT.	2.0	Bl. Side Ent.								
1489	WE. RT.	20'	10'	5'	5'	26.7'	0			Shortened due to Exposed Area	3	2461	2400	RT.	18.1		3	1479	RT.	2.0	Bl. Side Ent.								
1490	WE. RT.	20'	10'	5'	5'	26.7'	0				3	2405	2405	RT.	16.51		3	1480	RT.	2.0	Bl. Side Ent.								
1491	WE. LT.	20'	8'	5'	5'	21.2'	0			Widened to meet exist. improvements	3	2449	2409	RT.	289.5		3	1481	RT.	2.0	Bl. Side Ent.								
1492	WE. LT.	20'	8'	5'	5'	21.2'	0				3	2475	2428	RT.	283.5		3	1482	RT.	2.0	Bl. Side Ent.								
1493	WE. LT.	20'	10'	7'	7'	29.3'	0				3 & 6	2472	2402	RT.	299		3	1483	RT.	2.0	Bl. Side Ent.								
1494	WE. LT.	20'	10'	7'	7'	29.3'	0				3	2472	2402	RT.	299		3	1484	RT.	2.0	Bl. Side Ent.								
1495	WE. LT.	20'	10'	7'	7'	29.3'	0			Cost to be paid by prop. owner	3	2472	2417	RT.	299		3	1485	RT.	2.0	Bl. Side Ent.								
1496	WE. LT.	20'	10'	7'	7'	29.3'	0				3	2472	2417	RT.	299		3	1486	RT.	2.0	Bl. Side Ent.								
1497	WE. LT.	20'	10'	7'	7'	29.3'	0				3	2472	2417	RT.	299		3	1487	RT.	2.0	Bl. Side Ent.								
1498	WE. LT.	20'	10'	7'	7'	29.3'	0				3	2472	2417	RT.	299		3	1488	RT.	2.0	Bl. Side Ent.								
1499	WE. LT.	20'	10'	7'	7'	29.3'	0				3	2472	2417	RT.	299		3	1489	RT.	2.0	Bl. Side Ent.								
1500	WE. LT.	20'	10'	7'	7'	29.3'	0				3	2472	2417	RT.	299		3	1490	RT.	2.0	Bl. Side Ent.								
1501	WE. LT.	20'	10'	7'	7'	29.3'	0				3	2472	2417	RT.	299		3	1491	RT.	2.0	Bl. Side Ent.								
1502	WE. LT.	20'	10'	7'	7'	29.3'	0				3	2472	2417	RT.	299		3	1492	RT.	2.0	Bl. Side Ent.								
1503	WE. LT.	20'	10'	7'	7'	29.3'	0				3	2472	2417	RT.	299		3	1493	RT.	2.0	Bl. Side Ent.								
1504	WE. LT.	20'	10'	7'	7'	29.3'	0				3	2472	2417	RT.	299		3	1494	RT.	2.0	Bl. Side Ent.								
1505	WE. LT.	20'	10'	7'	7'	29.3'	0				3	2472	2417	RT.	299		3	1495	RT.	2.0	Bl. Side Ent.								
1506	WE. LT.	20'	10'	7'	7'	29.3'	0				3	2472	2417	RT.	299		3	1496	RT.	2.0	Bl. Side Ent.								
1507	WE. LT.	20'	10'	7'	7'	29.3'	0				3	2472	2417	RT.	299		3	1497	RT.	2.0	Bl. Side Ent.								
1508	WE. LT.	20'	10'	7'	7'	29.3'	0				3	2472	2417	RT.	299		3	1498	RT.	2.0	Bl. Side Ent.								
1509	WE. LT.	20'	10'	7'	7'	29.3'	0				3	2472	2417	RT.	299		3	1499	RT.	2.0	Bl. Side Ent.								
1510	WE. LT.	20'	10'	7'	7'	29.3'	0				3	2472	2417	RT.	299		3	1500	RT.	2.0	Bl. Side Ent.								
1511	WE. LT.	20'	10'	7'	7'	29.3'	0				3	2472	2417	RT.	299		3	1501	RT.	2.0	Bl. Side Ent.								
1512	WE. LT.	20'	10'	7'	7'	29.3'	0				3	2472	2417	RT.	299		3	1502	RT.	2.0	Bl. Side Ent.								
1513	WE. LT.	20'	10'	7'	7'	29.3'	0				3	2472	2417	RT.	299		3	1503	RT.	2.0	Bl. Side Ent.								
1514	WE. LT.	20'	10'	7'	7'	29.3'	0				3	2472	2417	RT.	299		3	1504	RT.	2.0	Bl. Side Ent.								
1515	WE. LT.	20'	10'	7'	7'	29.3'	0				3	2472	2417	RT.	299		3	1505	RT.	2.0	Bl. Side Ent.								
1516	WE. LT.	20'	10'	7'	7'	29.3'	0				3	2472	2417	RT.	299		3	1506	RT.	2.0	Bl. Side Ent.								
1517	WE. LT.	20'	10'	7'	7'	29.3'	0				3	2472	2417	RT.	299		3	1507	RT.	2.0	Bl. Side Ent.								
1518	WE. LT.	20'	10'	7'	7'	29.3'	0				3	2472	2417	RT.	299		3	1508	RT.	2.0	Bl. Side Ent.								
1519	WE. LT.	20'	10'	7'	7'	29.3'	0				3	2472	2417	RT.	299		3	1509	RT.	2.0	Bl. Side Ent.								
1520	WE. LT.	20'	10'	7'	7'	29.3'	0				3	2472	2417	RT.	299		3	1510	RT.	2.0	Bl. Side Ent.								
1521	WE. LT.	20'	10'	7'	7'	29.3'	0				3	2472	2417	RT.	299		3	1511	RT.	2.0	Bl. Side Ent.								
1522	WE. LT.	20'	10'	7'	7'	29.3'	0				3	2472	2417	RT.	299		3	1512	RT.	2.0	Bl. Side Ent.								
1523	WE. LT.	20'	10'	7'	7'	29.3'	0				3	2472	2417	RT.	299		3	1513	RT.	2.0	Bl. Side Ent.								
1524	WE. LT.	20'	10'	7'	7'	29.3'	0				3	2472	2417	RT.	299		3	1514	RT.	2.0	Bl. Side Ent.								
1525	WE. LT.	20'	10'	7'	7'	29.3'	0				3	2472	2417	RT.	299		3	1515	RT.	2.0	Bl. Side Ent.								
1526	WE. LT.	20'	10'	7'	7'	29.3'	0				3	2472	2417	RT.	299		3	1516	RT.	2.0	Bl. Side Ent.								
1527	WE. LT.	20'	10'	7'	7'	29.3'	0				3	2472	2417	RT.	299		3	1517	RT.	2.0	Bl. Side Ent.								
1528	WE. LT.	20'	10'	7'	7'	29.3'	0				3	2472	2417	RT.	299		3	1518	RT.	2.0	Bl. Side Ent.								
1529	WE. LT.	20'	10'	7'	7'	29.3'	0				3	2472	2417	RT.	299		3	1519	RT.	2.0	Bl. Side Ent.								
1530	WE. LT.	20'	10'	7'	7'	29.3'	0				3	2472	2417	RT.	299		3	1520	RT.	2.0	Bl. Side Ent.								
1531	WE. LT.	20'	10'	7'	7'	29.3'	0				3	2472	2417	RT.	299		3	1521	RT.	2.0	Bl. Side Ent.								
1532	WE. LT.	20'	10'	7'	7'	29.3'	0				3	2472	2417	RT.	299		3	1522	RT.	2.0	Bl. Side Ent.								
1533	WE. LT.	20'	10'	7'	7'	29.3'	0				3	2472	2417	RT.	299		3	1523	RT.	2.0	Bl. Side Ent.								
1534	WE. LT.	20'	10'	7'	7'	29.3'	0				3	2472	2417	RT.	299		3	1524	RT.	2.0	Bl. Side Ent.								
1535	WE. LT.	20'	10'	7'	7'	29.3'	0				3	2472	2417	RT.	299		3	1525	RT.	2.0	Bl. Side Ent.								
1536	WE. LT.	20'	10'	7'	7'	29.3'	0				3	2472	2417	RT.	299		3	1526	RT.	2.0	Bl. Side Ent.								
1537	WE. LT.	20'	10'	7'	7'	29.3'	0				3	2472	2417	RT.	299		3	1527	RT.	2.0	Bl. Side Ent.								
1538	WE. LT.	20'	10'	7'	7'	29.3'	0				3	2472	2417	RT.	299		3	1528	RT.	2.0	Bl. Side Ent.								
1539	WE. LT.	20'	10'	7'	7'	29.3'	0				3	2472	2417	RT.	299		3	1529	RT.	2.0	Bl. Side Ent.								
1540	WE. LT.	20'	10'	7'	7'	29.3'	0				3	2472	2417	RT.	299		3	1530	RT.	2.0	Bl. Side Ent.								
1541	WE. LT.	20'	10'	7'	7'	29.3'	0				3	2472	2417	RT.	299		3	1531	RT.	2.0	Bl. Side Ent.								
1542	WE. LT.	20'	10'	7'	7'	29.3'	0				3	2472	2417	RT.	299		3	1532	RT.	2.0	Bl. Side Ent.								
1543	WE. LT.	20'	10'	7'	7'	29.3'	0				3	2472	2417	RT.	299		3	1533	RT.	2.0	Bl. Side Ent.								
1544	WE. LT.	20'	10'	7'	7'	29.3'	0				3	2472	2417	RT.	299		3	1534	RT.	2.0	Bl. Side Ent.								
1545	WE. LT.	20'	10'	7'	7'	29.3'	0				3	2472	2417	RT.	299		3	1535	RT.	2.0	Bl. Side Ent.								
1546	WE. LT.	20'	10'	7'	7'	29.3'	0				3	2472	2417	RT.	299		3	1536	RT.	2.0	Bl. Side Ent.								
1547	WE. LT.	20'	10'	7'	7'	29.3'	0				3	2472	2417	RT.	299		3	1537	RT.	2.0	Bl. Side Ent.								
1548	WE. LT.	20'	10'	7'	7'	29.3'	0				3	2472	2417	RT.	299		3	1538	RT.	2.0	Bl. Side Ent.								
1549	WE. LT.	20'	10'	7'	7'	29.3'	0				3	2472	2417	RT.	299		3	1539	RT										

SUMMARY OF QUANTITIES

STATE	MO.	JOB NO. 7-U-FF-215	SHEET NO. 2B
DIST. NO.	7	PROJECT NO. R5-776(5)	ROUTE FF
COUNTY JASPER - NEWTON			

Sheet 5 of 5

SIGN	SIZE (INCHES)	AREA (SQ. FT.)	QUANTITY	TOTAL AREA (SQ. FT.)	QUANTITY RELOCATED	TOTAL RELOCATED AREA (SQ. FT.)	SIGN LEGEND
WARNING SIGNS							
W1-1L	48x48	18.0					TURN (SYMBOL LEFT ARROW)
W1-1R	48x48	18.0					TURN (SYMBOL RIGHT ARROW)
W1-2L	48x48	18.0					CURVE (SYMBOL LEFT ARROW)
W1-2R	48x48	18.0					CURVE (SYMBOL RIGHT ARROW)
W1-3L	48x48	18.0	1	18.0			REVERSE TURN (SYMBOL LEFT ARROW)
W1-3R	48x48	18.0					REVERSE TURN (SYMBOL RIGHT ARROW)
W1-4L	48x48	18.0					REVERSE CURVE (SYMBOL LEFT ARROW)
W1-4R	48x48	18.0					REVERSE CURVE (SYMBOL RIGHT ARROW)
W1-6	42x24	8.0					HORIZONTAL ARROW (SYMBOL)
W1-6a	72x36	18.0					HORIZONTAL ARROW (SYMBOL)
W1-7	48x24	8.0					DOUBLE HEAD HORIZONTAL ARROW (SYMBOL)
W1-7a	72x36	18.0					DOUBLE HEAD HORIZONTAL ARROW (SYMBOL)
W1-8	18x24	3.0					CHEVRON (SYMBOL)
W3-1	48x48	18.0					STOP AHEAD
W3-2	48x48	18.0					YIELD AHEAD
W3-3	48x48	18.0					SIGNAL AHEAD (SYMBOL)
W3-3X	24x18	3.0					SIGNAL AHEAD (PLAQUE)
W3-4	48x48	18.0	2	36.0			BE PREPARED TO STOP
W5-1	48x48	18.0					ROAD NARROWS
W5-3	48x48	18.0					ONE LANE BRIDGE
W6-1	48x48	18.0					DIVIDED HIGHWAY
W6-2	48x48	18.0					DIVIDED HIGHWAY ENDS
W6-3	68x48	18.0					TWO WAY TRAFFIC
W6-1	48x48	18.0					BUMP
W6-2	48x48	18.0					DIP
W6-3	48x48	18.0					PAVEMENT ENDS
W6-4	48x48	18.0					SOFT SHOULDER
W6-5	48x48	18.0					SLIPPERY WHEN WET (SYMBOL)
W6-5X	24x18	3.0	1	3.0			SLIPPERY WHEN WET (PLAQUE)
W6-6	48x48	18.0	1	18.0			TRUCK CROSSING
W6-7	48x48	18.0					LOOSE GRAVEL
W6-8	48x48	18.0					LOW SHOULDER
W6-1	48x48	18.0					RIGHT LANE ENDS (Includes LEFT/CENTER plate)
W6-2	48x48	18.0					LANE ENDS MERGE RIGHT (Includes LEFT plate)
W10-1	42 Diameter	8.6					RAILROAD CROSSING
W12-1	24x24	4.8					DOUBLE DOWN ARROW (SYMBOL)
W12-2	48x48	18.0					LOW CLEARANCE (SYMBOL)
W12-2X	24x18	3.0					LOW CLEARANCE (PLAQUE)
W12-3	144x24	24.0					OVERHEAD LOW CLEARANCE (FEET AND INCHES)
W12-1	24x24	4.8					ADVISORY SPEED PLAQUE
W20-1	48x48	18.0	8	144.0			ROAD CONSTRUCTION AHEAD (Includes RAMP/BRIDGE plate)
W20-2	48x48	18.0		16.0			DETOUR AHEAD (Includes 500 FT./1000 FT. plate)
W20-3	48x48	18.0					ROAD CLOSED AHEAD (Includes 500 FT./1000 FT. plate)
W20-4	48x48	18.0	2	36.0			ONE LANE ROAD AHEAD
W20-5	48x48	18.0	1	18.0			RIGHT LANE CLOSED AHEAD (Includes LEFT/CENTER plate)
W20-6	48x48	18.0					RIGHT LANE CLOSED (Includes LEFT/CENTER plate)
W20-9	48x48	18.0	2	36.0			FLAGMAN AHEAD (Includes 500 FT./1000 FT. plate)
W21-1	48x48	18.0	5	90.0	2	36.0	OPEN TRENCH
W21-2	48x48	18.0					FRESH OIL
W21-4	48x48	18.0	1	18.0			SHOULDER WORK AHEAD
W21-7	24x36	9.0					SAND BLASTING
W26-1	24x48	1.8					1000 FT.-1000 FT. (BACK TO BACK DISTANCE PLAQUE)
W26-2	24x48	1.8					200 FT.-500 FT. (BACK TO BACK DISTANCE PLAQUE)
W26-3a	24x48	1.8					1/2 MILE-1 MILE (BACK TO BACK DISTANCE PLAQUE)

SIGN	SIZE (INCHES)	AREA (SQ. FT.)	QUANTITY	TOTAL AREA (SQ. FT.)	QUANTITY RELOCATED	TOTAL RELOCATED AREA (SQ. FT.)	SIGN LEGEND	
REGULATORY SIGNS								
R1-1	48x48	18.0	1	18.0			STOP	
R1-2	48x48x48	6.93	2	13.86			YIELD	
R1-2x	36x36	9.0	2	18.0			TO ONCOMING TRAFFIC (PLAQUE)	
R1-3	20x8	1.25	1	1.25			4-WAY (PLAQUE)	
R1-5	20x8	1.25					3-WAY (PLAQUE)	
R2-1	36x48	12.0	1	12.0			SPEED LIMIT (SMBE)	
R2-5	36x48	12.0	1	12.0			REDUCED SPEED AHEAD	
R3-1	36x48	12.0					NO RIGHT TURN	
R3-2	36x48	12.0					NO LEFT TURN	
R3-3	36x36	9.0					NO TURN	
R3-4	36x48	12.0					NO U-TURN	
R3-7R	36x30	6.25					RIGHT LANE MUST TURN RIGHT	
R3-7L	36x30	6.25					LEFT LANE MUST TURN LEFT	
R4-1	36x48	12.0					DO NOT PASS	
R4-2	36x48	12.0					PASS WITH CARE	
R4-7	36x48	12.0					KEEP RIGHT (HORIZONTAL ARROW)	
R4-8	36x48	12.0					KEEP LEFT (HORIZONTAL ARROW)	
R4-17	36x36	9.0					KEEP RIGHT	
R4-18	36x36	9.0					KEEP LEFT	
R5-1	36x30	6.25					DO NOT ENTER	
R5-1a	36x24	5.0					WRONG WAY	
R5-1L	48x18	6.0					ONE WAY ARROW (LEFT)	
R5-1R	48x18	6.0					ONE WAY ARROW (RIGHT)	
R6-2L	24x30	5.0					ONE WAY (LEFT)	
R6-2R	24x30	5.0					ONE WAY (RIGHT)	
R11-2	48x30	10.0					ROAD CLOSED	
R11-3	60x30	12.5					ROAD CLOSED --- MILES AHEAD LOCAL TRAFFIC ONLY	
R11-4	60x30	12.5					ROAD CLOSED TO THRU TRAFFIC	
GUIDE SIGNS								
G20-1	60x36	15.0					ROAD CONSTRUCTION NEXT --- MILES	
G20-2	60x24	10.0	5	50.0			END CONSTRUCTION	
M4-8	30x15	3.13					DETOUR (PLAQUE)	
M4-8R	48x36	12.0					DETOUR (RIGHT ARROW)	
M4-8L	48x36	12.0					DETOUR (LEFT ARROW)	
M4-10R	48x18	6.0					DETOUR (ARROW RIGHT)	
M4-10L	48x18	6.0					DETOUR (ARROW LEFT)	
M4-11	24x18	3.0					DETOUR ENDS	
M5-1R	21x15	2.19					ADVANCE RIGHT TURN ARROW	
M5-1L	21x15	2.19					ADVANCE LEFT TURN ARROW	
TOTALS								
616-10.05 CONSTRUCTION SIGNS				644.0				
616-10.10 RELOCATED SIGNS					38.0			

ITEM NUMBER	SIZE (INCHES)	TOTAL QUANTITY	DESCRIPTION
616-10.20	36x18	1	DRUM
616-10.25	One Roll	1	TYPE I BARRICADE
	8x26		
616-10.30	Two Rolls	1	TYPE II BARRICADE
	8x26		
616-10.40	36x72	1	FLASHING ARROW PANEL
616-10.45	18x18	1	TYPE I OBJECT MARKER
616-10.46	6x12	1	TYPE II OBJECT MARKER
616-10.47	8x24	1	TYPE III OBJECT MARKER
616-10.50	8x8	1	FLASHING ELECTRIC LIGHT
616-10.51	-	1	WARNING LIGHT TYPE A
616-10.52	-	1	WARNING LIGHT TYPE B
616-10.53	-	1	WARNING LIGHT TYPE C
616-10.60	-	1	RAISED PAVEMENT MARKER
612-10.30	Three Rolls	1	MOVABLE BARRICADE
	72x144		

All Signs, Plates, and Plaques shall be faced with Type 1 Reflective Sheeting in Accordance with Sec 1042.

Sign Dimensions Shown are Minimums. No Additional Payment if Contractor Uses Larger Signs.

No additional area or payments will be made for PLATES which are to be included with certain signs.

ALL PLAQUES shall have a black border. PLATES do not have a border.

587

(M)

FINAL PLANS

STATE	MO.	JOB NO.	7-L-FF-218	SHEET NO.	3
PROJECT NO.	25-776(3)	CITY	JOPLIN	DATE	
DRAWN BY	Jasper-Newton	DATE	FF		

Bearings Shown
Are from Old Plans

Land Survey Monument
46.9' Lt. Sta. 0108.4
S.W. Cor. Sec. 13
T-27-N R-32-W
State Land Survey
Authority Documents
677-100

① GENERAL MILL'S RESTAURANT
GROUP INC.

SW 4 SW 4
18-27-32

CITY OF JOPLIN MO.

④ COMMONWEALTH THEATRES
REALTY INC.

0+00 Rte. FF East
0+175.0 Rte. FF West
209+38.8 Rte. 71

JASPER CO.
NEWTON Co.
210+24.9 DK.
Equip. 105+35.3 Ahd

② MARY L. CHARLES
STRAYER
New R/W: 828 S.F.
Rmdr. = 43,097 S.F.

③ EMPIRE
DIST. ELECTRIC
Temp. Limit 500 S.F.

⑨ JOHN Q. & JUANITA R.
HAMMONS
See Sheet No. 5

Right-Of-Way Limits For This Project Extend From
Sta. 0+73 to Sta. 6+50, A Distance of 1.265 Miles.

project begins at a point 46.9 feet
S 23° 36' 12" W and 24.2 feet west
from the Southwest Corner of
Section 13, T27N, R32W.
all other bearings at this point is
incidental to project.

Compacting Embankment
1.263 Cu. Yds. (incl. 11.0% for settl.)
D.H. = 64.8' (incl. 2.5' for 1.0% slope)

Excavation
1.6 A Excavation = 1688 Cu. Yds. (incl. 22.0% for settl.)
1.6 B Excavation = 1708 Cu. Yds. (incl. 22.0% for settl.)
Compacting Embankment = 2046 Cu. Yds. (incl. 13.0% for settl.)
D.H. = 412.5' (incl. 2.5' for 1.0% slope)

- UTILITY OWNERSHIPS**
- Empire District Electric Company
605 6th St., Joplin, Mo. 64501
(417) 623-4100
 - Gas Service Company
305 Main Street, Joplin, Mo. 64501
(417) 623-1100
 - Joplin Water Company
South 4th St., Joplin, Mo. 64501
(417) 623-2100
 - Continuation Bell Telephone Co.
2400 Briggs Ave., Joplin, Mo. 64501
(417) 781-9830

Northwest Central Pipeline Co.
P.O. Box 236, North Miami Oklahoma 74152
(918) 222-2502

BENCH MARK U.S. G.S. DATUM
B.M. #1 on N. End Conc. Pump Island
105' RL Sta. 0143.4 - ELEV. 1021.28
B.M. #12 " on S. side of Light pole base
155' Lt. Sta. 41.60 - Elev. 1021.93

RIGHT OF WAY
UTILITY & REMOVAL PLANS

SCALE	1" = 100'
DATE	
BY	
CHECKED BY	
APPROVED BY	

5802
1/2

FINAL PLANS

7	MO	7-U-FF-218	4
7	JASPER	NEWTON	FF



208

2

3

4

5

208+18.0 103' Lt
 R: 70'
 $\Delta = 98.56^\circ$
 L: 120.81'
 T: 81.35'

STORM SEWER SYSTEM # 2

0100 Rte. FF East.
 209+138.8 Rte. 71

209

STORM SEWER SYSTEM # 1

210
 210+08.5 Lt. 81.75'
 50' R
 $\Delta = 79.91^\circ$
 L: 69.73'
 T: 41.89'

EQUA 210+24.7 Bk.
 105+85.3 Ahd.

210

FLUSH MEDIAN

SCALE 1" = 20'

CONSTRUCTION PLANS

DATE	
BY	
CHECKED	
APPROVED	
DESIGNED	
DRAWN	
IN CHARGE	

DATE	
BY	
CHECKED	
APPROVED	
DESIGNED	
DRAWN	
IN CHARGE	

503
 13

7	MC	PROJECT NO. 23-776(5)	5
7	JASPER-NEWTON	FF	12

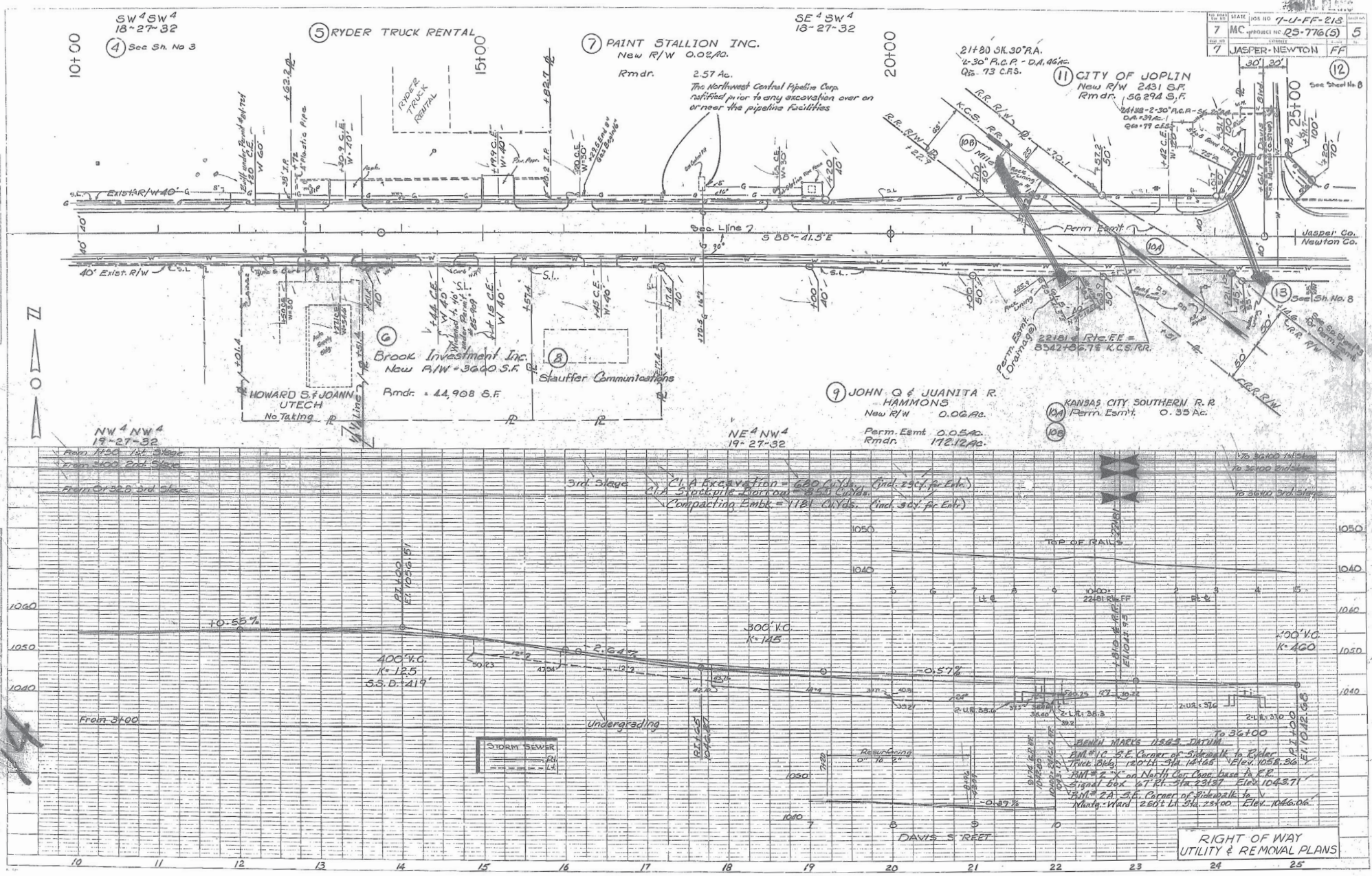

PLAN
 DRAWN BY
 CHECKED BY
 DATE

PROFILE
 DRAWN BY
 CHECKED BY
 DATE

504/105

FINAL PLANS

7	MO.	PROJ. NO.	25-776(3)	DATE	10
7	JASPER-NEWTON	COUNTY	FF	SCALE	1" = 20'

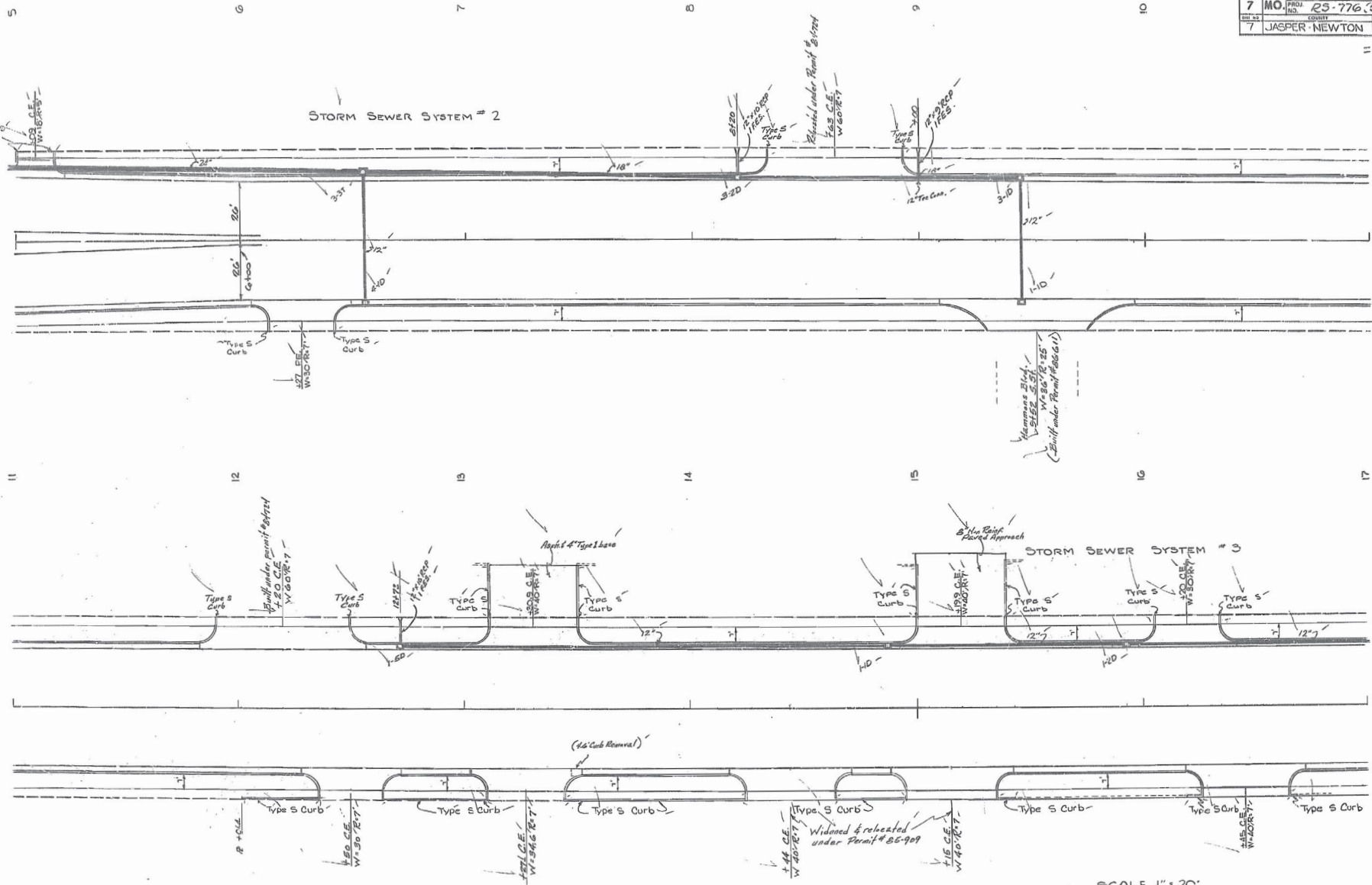

SCALE 1" = 20'

CONSTRUCTION PLANS

DATE	BY	CHKD.

DATE	BY	CHKD.

505
15

FINAL PLANS

STATE	JOB NO.	7-LI-FF-20	SHEET NO.	7
MO	PROJ. NO.	RS-776(5)	TOTAL SHEETS	7
7	ENGINEER	JASPER NEWTON	DATE	FF

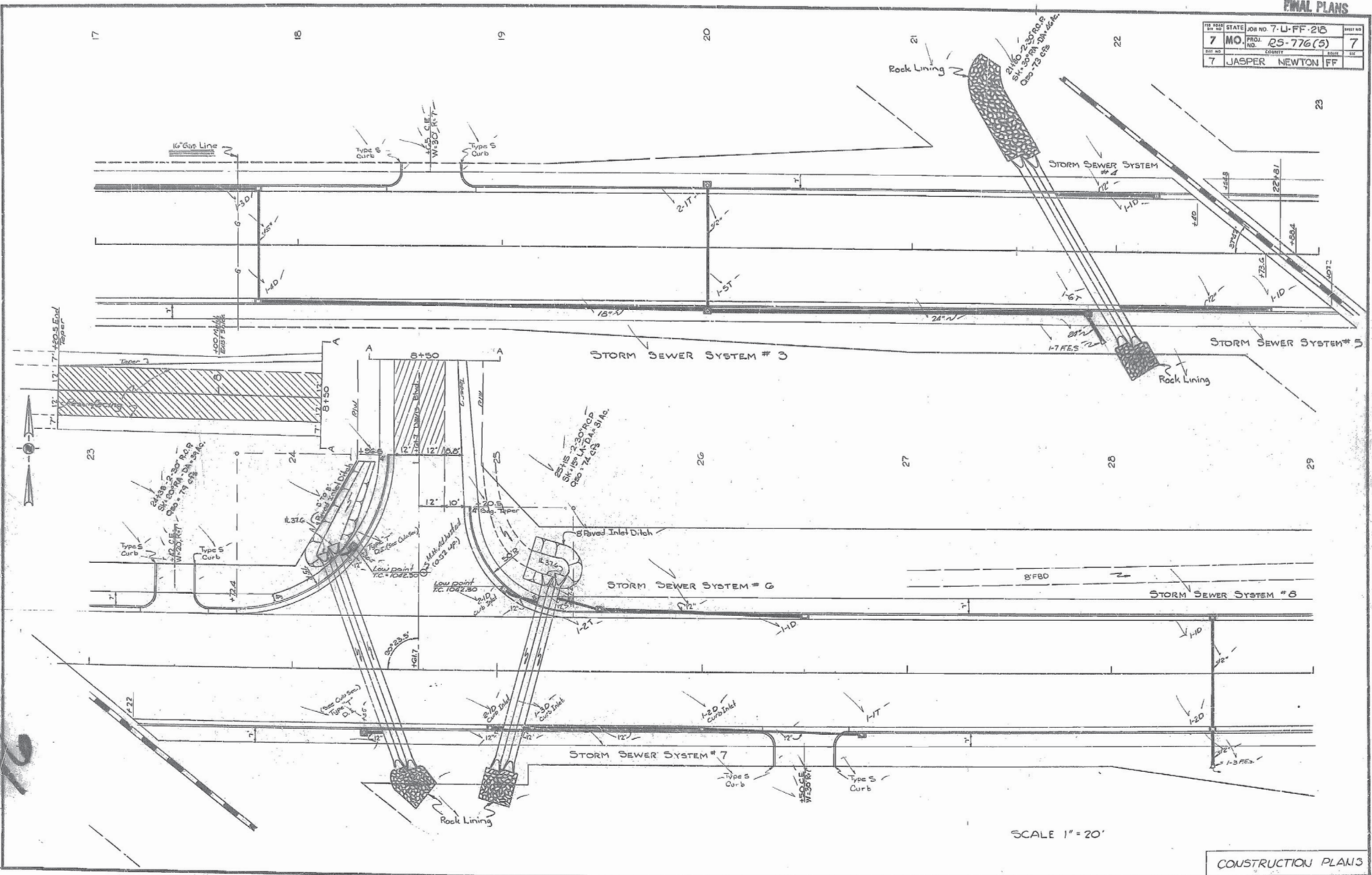

SCALE 1" = 20'

CONSTRUCTION PLANS

DATE	BY	REVISION

DATE	BY	REVISION

586
16

PLAN
 SCALE: AS SHOWN
 NOTES:
 1. ALL DIMENSIONS ARE IN FEET UNLESS OTHERWISE SPECIFIED.
 2. SEE SHEET 7 FOR R/W BOUNDARIES.
 3. SEE SHEET 8 FOR ADJACENT PROPERTIES.

7-U-FF-218
 7 MO. PROJECT NO. 25-776(5)
 7 Jasper - Newton FF

(14) CITY OF JOPLIN
 New R/W ~ 0.17 Ac.
 Rmndr ~ 10.83 Ac.

(12) THE INTER-STATE GROCER COMPANY
 A MISSOURI CORP
 New R/W ~ 0.65 Ac.
 Perm Esmt ~ 0.08 Ac.
 Rmndr ~ 7.67 Ac.

SW⁴ SE⁴
 18-27-32

30+00

30' EXIST.
 R/W

30' EXIST. R/W

25+100

25+15 - 2'-30" R.C.P.
 S.C. 15" I.D. D.A. - 31Ac.
 Q20-74 C.F.S.

29+00 - 4'-4" R.C.P.
 O.A. = 283Ac.
 Q20-345 C.F.S.

Perm Esmt
 (Drainage)

JAS PER CO.
 NEWTON CO.

588° 41.5'E

Sec. Line

(13) See Sheet
 No. 10

40' EXIST. R/W

Perm Esmt
 (Drainage)

NW⁴ NE⁴
 19-27-32

(15) Polen & Maughmer, Inc.
 The Industrial Development
 Authority of Joplin
 New R/W ~ 0.16 Ac.
 Perm. Esmt ~ 0.32 Ac.

(See Sp. Sheet #3
 New Perm. Esmt)

1st Stage
 C.I.A. Excavation = 1171 Cu. Yds. (incl. 25% of 1st St. for 1st St.)
 Undergrading C.I.A. = 1052 Cu. Yds.
 C.I.A. Borrow = 4000 Cu. Yds.
 Compacting Embl. = 3607 Cu. Yds. (incl. 10% of 1st St. for 1st St.)
 C.H. = 28,000 Sta. Yds.

2nd Stage
 C.I.A. Excavation = 1106 Cu. Yds. (incl. 50% of 1st St. for 1st St. & 2nd St. for 1st St.)
 Undergrading C.I.A. = 2,099 Cu. Yds.
 C.I.A. Borrow = 2,621 Cu. Yds.
 Compacting Embl. = 2,154 Cu. Yds. (incl. 10% of 1st St. for 1st St.)
 C.H. = 129,216 Sta. Yds.

3rd Stage
 C.I.A. Excavation = 0
 Stockpile Borr. C.I.A. = 278 Cu. Yds.
 Compacting Embl. = 752 Cu. Yds. (incl. 25% of 1st St.)

Rmndr = 22.91 Ac.

10' 25+17 1st Stage
 70' 26+00 End Stage
 70' 26+00 3rd Stage

100' V.C.
 K=460

100' V.C.
 K=762

100' V.C.
 K=127
 55D=420'

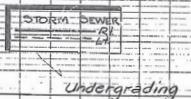
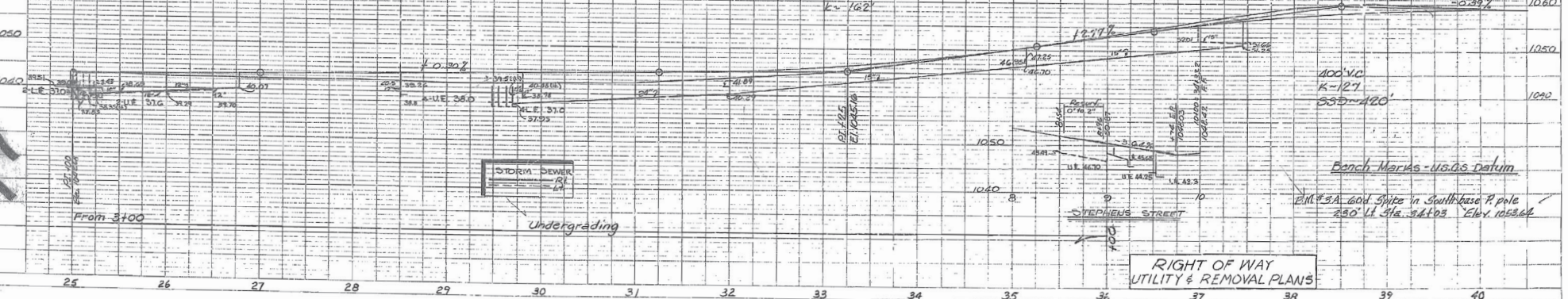

RIGHT OF WAY
 UTILITY & REMOVAL PLANS

587
 17

PLAN
 NOT TO SCALE
 ALL DIMENSIONS IN FEET UNLESS OTHERWISE NOTED

PIEDMONT
 CIVIL ENGINEERS
 1000 N. 10th St., Suite 100
 Joplin, MO 64504
 (417) 783-1111

509

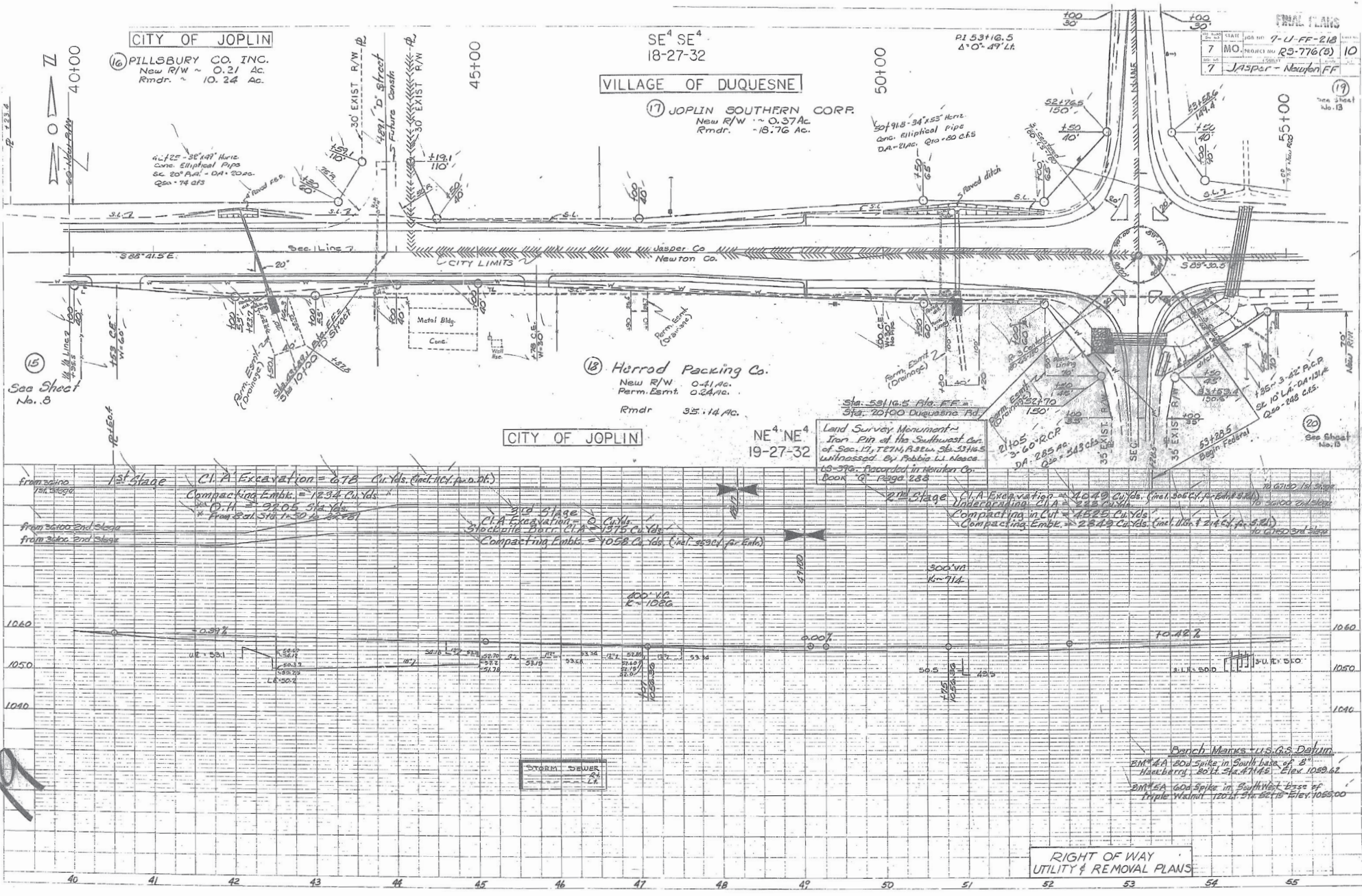

FINAL PLANS

STATE	JOB NO	T-U-PF-218	SHEET NO
7 MO	PROJ. NO.	RS-776(5)	11
CITY	COUNTY		
7 JASPER	NEWTON	PF	

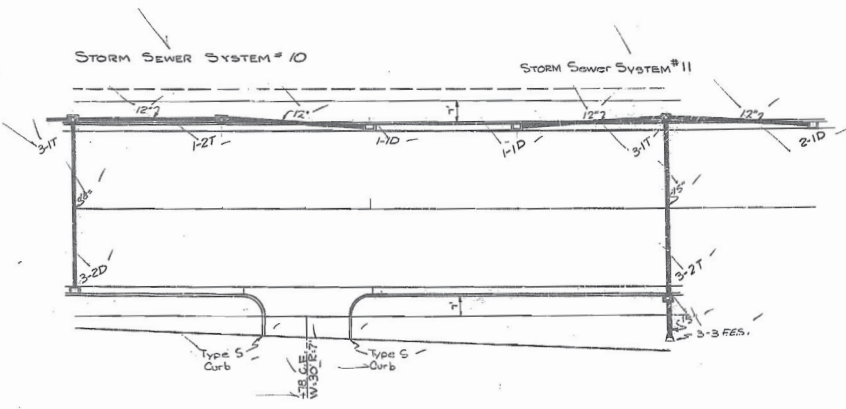
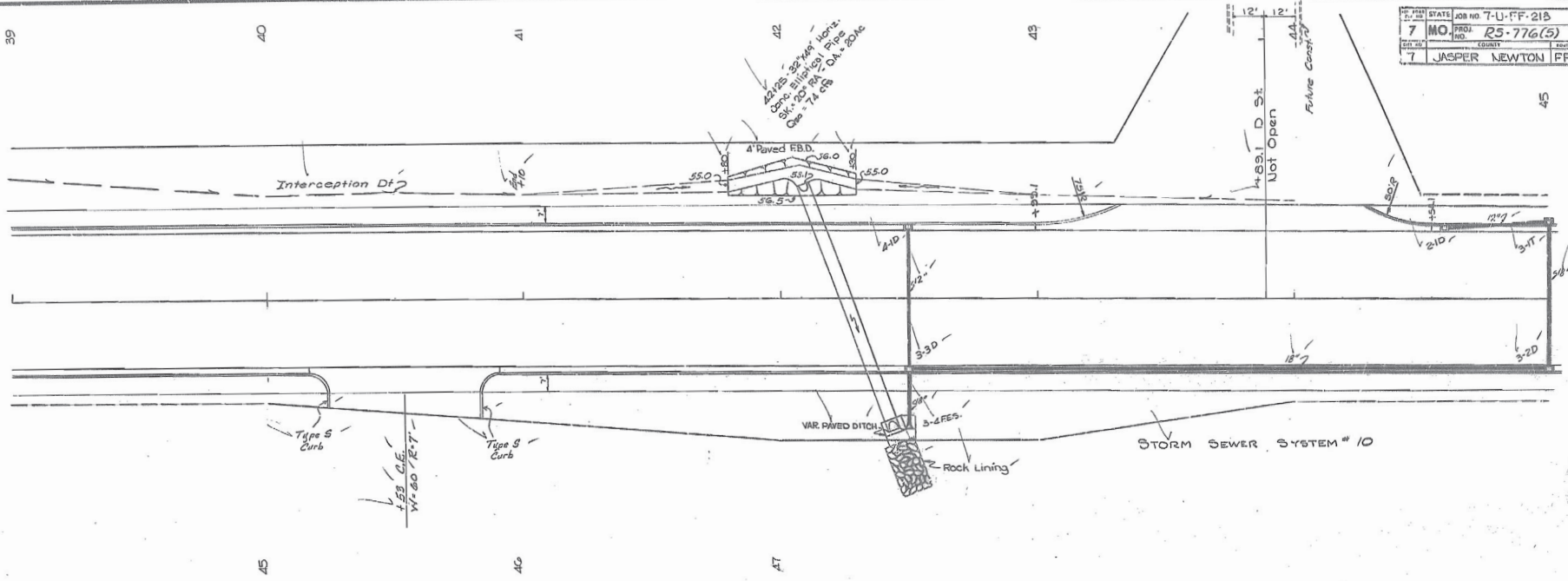

SCALE 1" = 20'

CONSTRUCTION PLANS

DATE	BY	CHKD.

DATE	BY	CHKD.

570
20



PROJECT NO.	STATE	JOB NO.	DATE
7	MO.	7-U-FF-218	12
DATE	COUNTY	SHEET NO.	OF
7	JASPER-NEWTON	FF	12

P.I. 18+47.2
 $\Delta = 1^\circ 10' 41''$

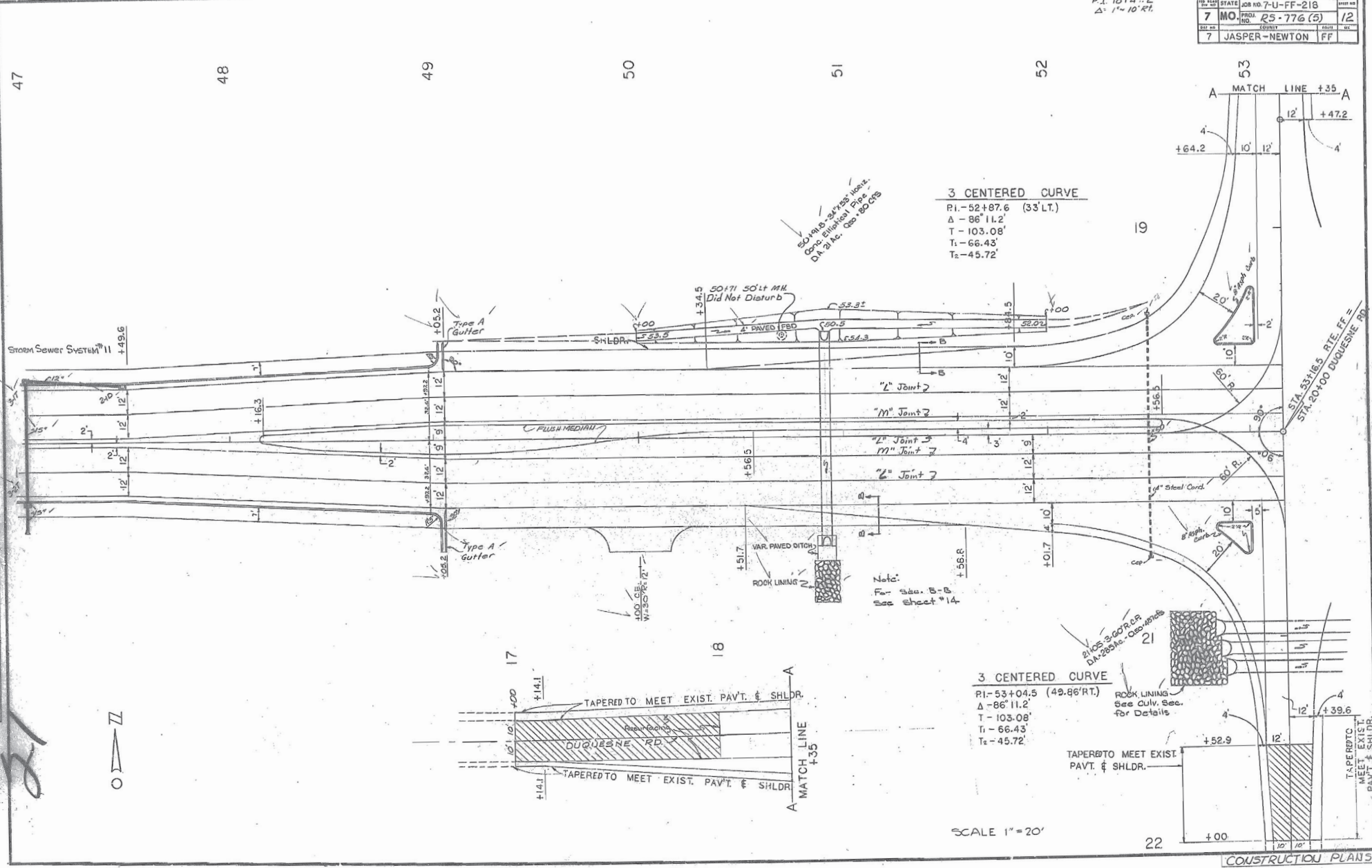

3 CENTERED CURVE
 P.I. - 52+87.6 (33' LT.)
 Δ - 86° 11.2'
 T - 103.08'
 T₁ - 66.43'
 T₂ - 45.72'

Note:
 P.I. - See B-B
 See Sheet #14

3 CENTERED CURVE
 P.I. - 53+04.5 (49.86' RT.)
 Δ - 86° 11.2'
 T - 103.08'
 T₁ - 66.43'
 T₂ - 45.72'

SCALE 1" = 20'

DATE	
BY	
CHECKED	
APPROVED	
DESIGNED	
DRAWN	
PLANNED	
ENGINEER	
PROJECT	
NO.	
DATE	

DATE	
BY	
CHECKED	
APPROVED	
DESIGNED	
DRAWN	
PLANNED	
ENGINEER	
PROJECT	
NO.	
DATE	

5/11/21



STATE	MO.	PROJECT NO.	7-U-FF-218
COUNTY	Jasper	NEW R/W	RS-776(5) 13
DATE	7	CONTRACT	Jasper - Newton FF

SW⁴ SW⁴
17-27-32

(19) ACME LAND CO.
New R/W 0.72 Ac.
Rmkr. 299.98 Ac.

65+00

55+00

60+00

1/4 LINE
F-30-5

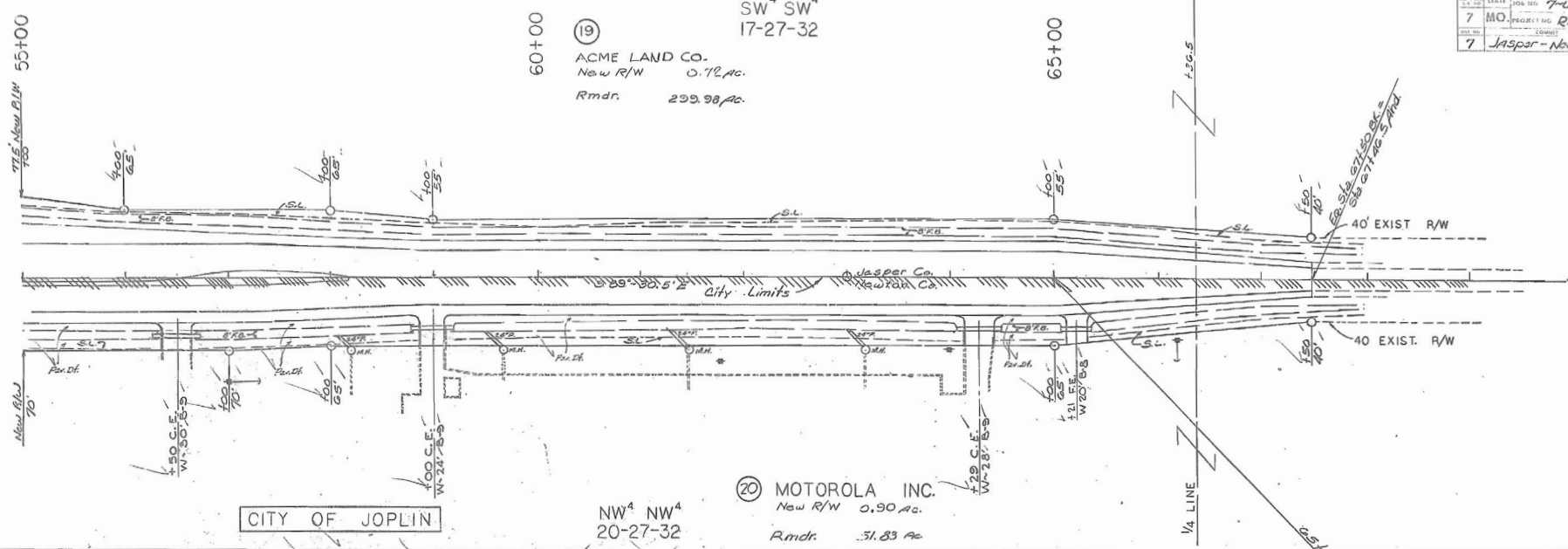

CITY OF JOPLIN

NW⁴ NW⁴
20-27-32

(20) MOTOROLA INC.
New R/W 0.90 Ac.
Rmkr. 51.83 Ac.

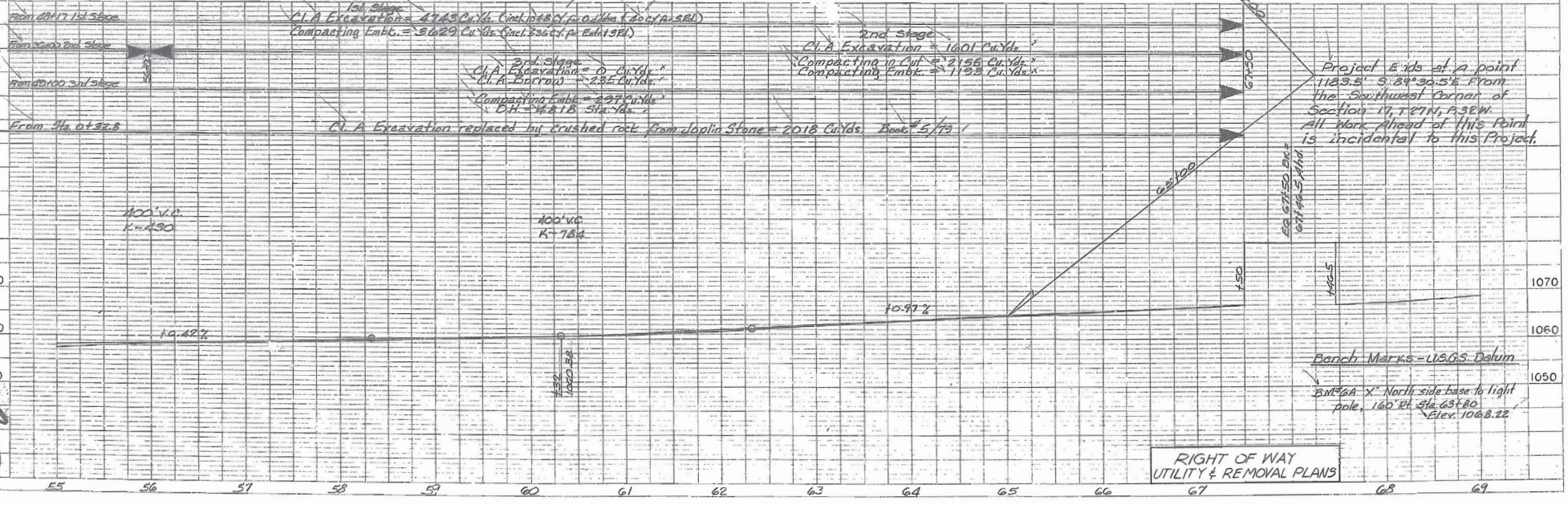

PLAN
DATE: 11/14/01
DRAWN BY: J.E.
CHECKED BY: J.E.
SCALE: AS SHOWN
PROJECT NO.: 7-U-FF-218

PROFILE
DATE: 11/14/01
DRAWN BY: J.E.
CHECKED BY: J.E.
SCALE: AS SHOWN
PROJECT NO.: 7-U-FF-218

578
28

STATE	JOB NO.	7-U-FF-218	DATE	
7 MO.	PROJ. NO.	R5-776 (5)	SCALE	1/4"
7	COUNTY	JASPER-NEWTON	FF	1/2"

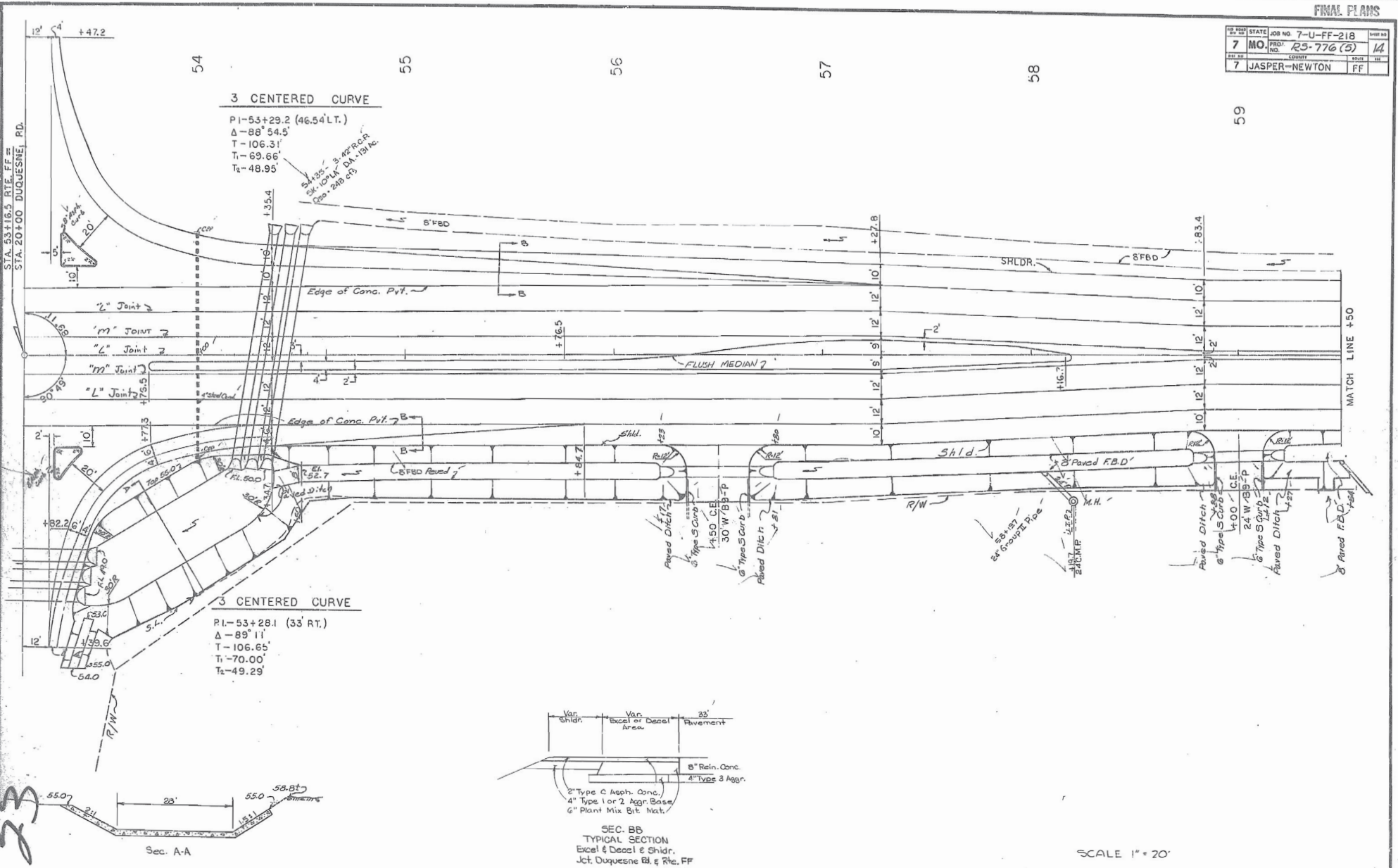

DATE	
BY	
CHECKED	
APPROVED	
DESIGNED	
DRAWN	
PLANNED	
REVISIONS	

DATE	
BY	
CHECKED	
APPROVED	
DESIGNED	
DRAWN	
PLANNED	
REVISIONS	

573
23

3 CENTERED CURVE
 PI-53+28.1 (33 RT.)
 Δ-89° 11'
 T-106.65'
 T1-70.00'
 T2-49.29'

Sec. A-A

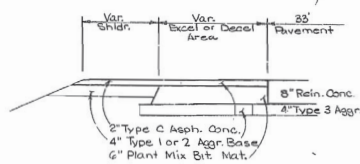

SEC. BB
 TYPICAL SECTION
 Excav. & Devel. & Shldr.
 Jct. Duquesne Bl. & Rte. FF

SCALE 1" = 20'

FINAL PLANS

JOB NO.	STATE	JOB NO.	7-13-FF-218	PROJECT NO.	
7	MO.	PROJ. NO.	RS-776(5)	15	
		COUNTY			
7	JASPER-NEWTON	FF			

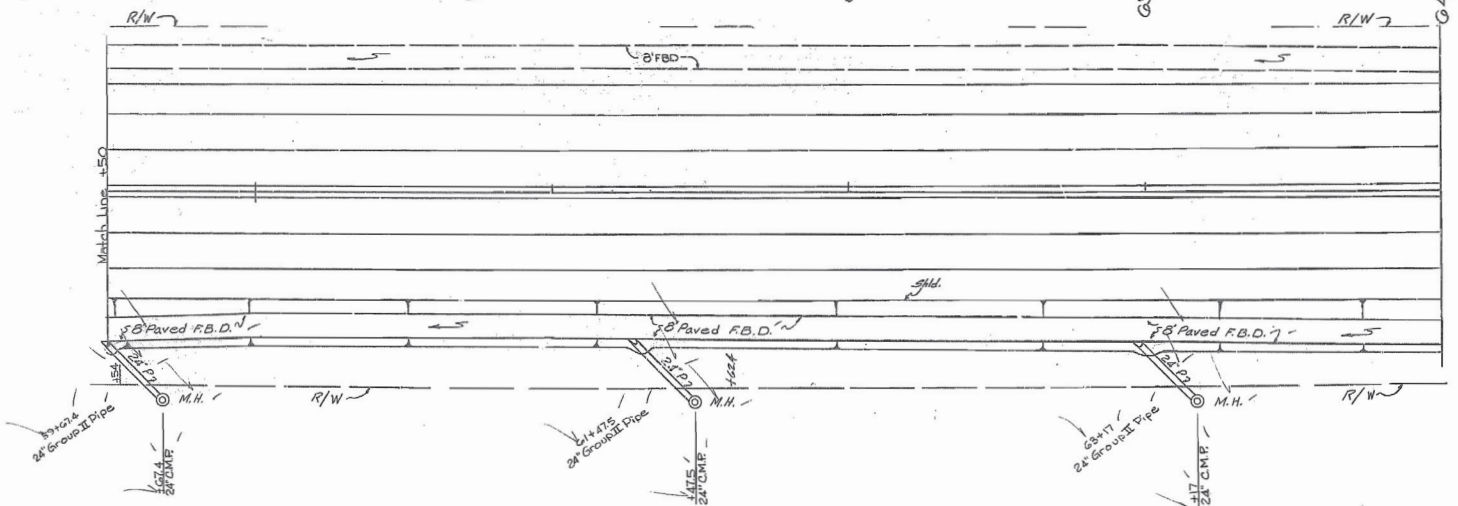
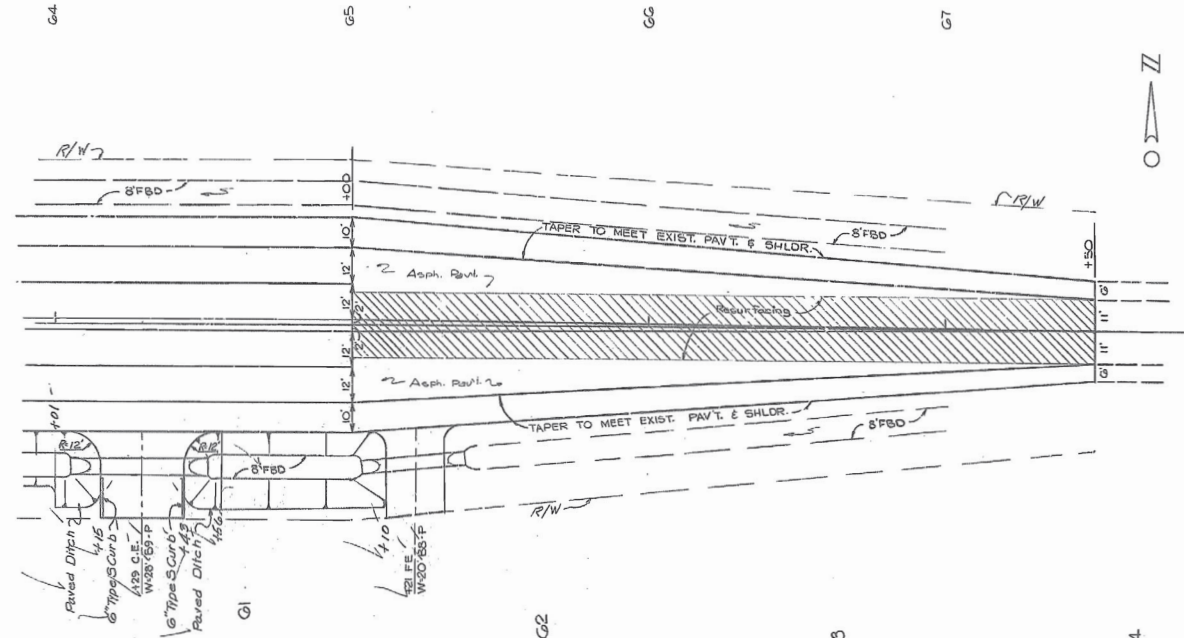

CONSTRUCTION PLANS

DATE	
BY	
CHECKED	
APPROVED	
SCALE	
PROJECT	
NO.	

DATE	
BY	
CHECKED	
APPROVED	
SCALE	
PROJECT	
NO.	

Handwritten initials/signature.

FINAL PLANS

JOB NO.	STATE	JOB NO.	7-4-FF-218	SHEET NO.
7	MO.	PROJ. NO.	23-776(5)	17
		COUNTY	JASPER - NEWTON	FF

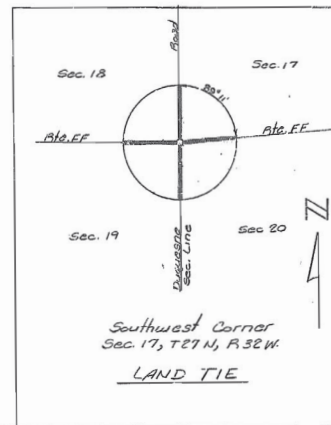
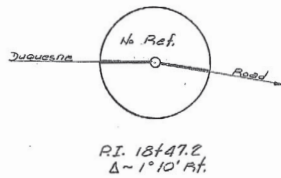
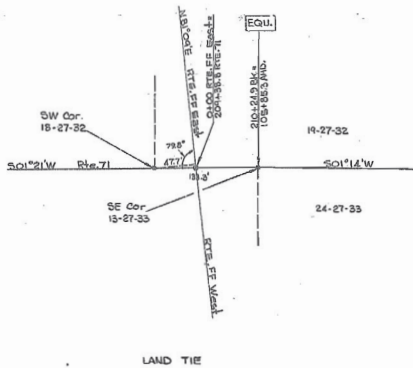
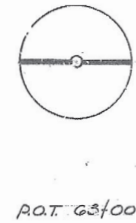
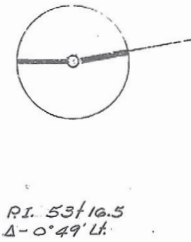
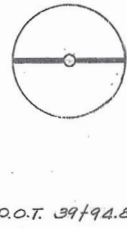
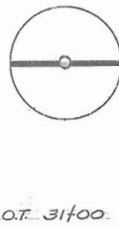
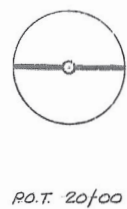
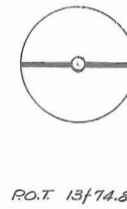
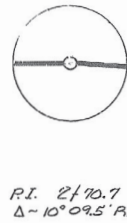
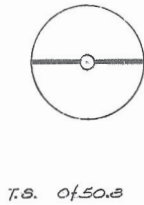
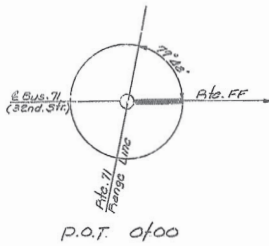

REFERENCE POINTS

DATE	
SCALE	
BY	
CHECKED	
APPROVED	
REVISIONS	

DATE	
SCALE	
BY	
CHECKED	
APPROVED	
REVISIONS	

5/16
26

NO. 7	STATE MO	JOB NO. T-U-FF-218	SHEET NO. 13
PROJ. NO. 25-776(5)	CONTRACTOR JASPER - NEWTON	DATE 11/77	SCALE

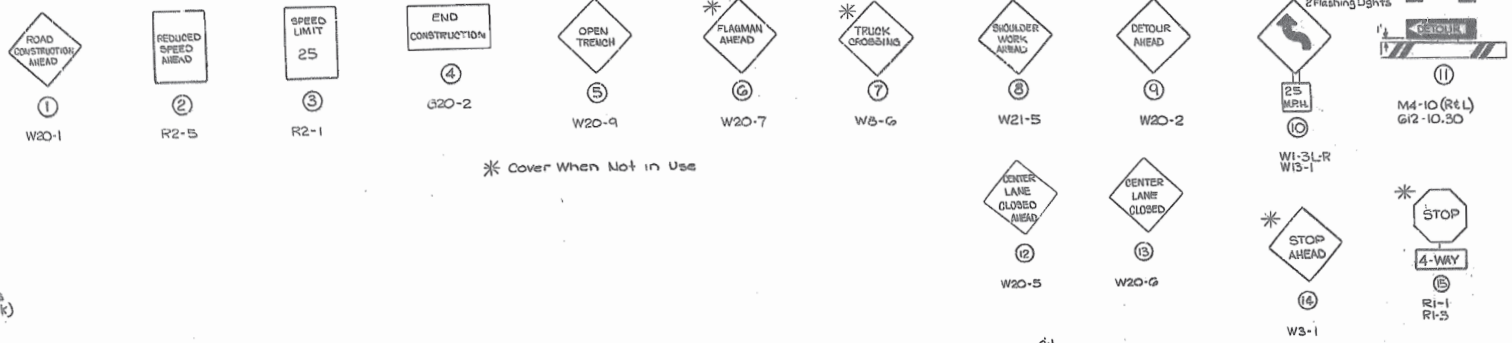

- - Drums with Type 3 Object Markers (Mounted Back to Back)
- F - Mobile Barricades
- - Flagman
- - Sign Location
- ∇ - Type 3 Object Markers (Back to Back)
- - Drums (Back to Back)

* Cover When Not in Use

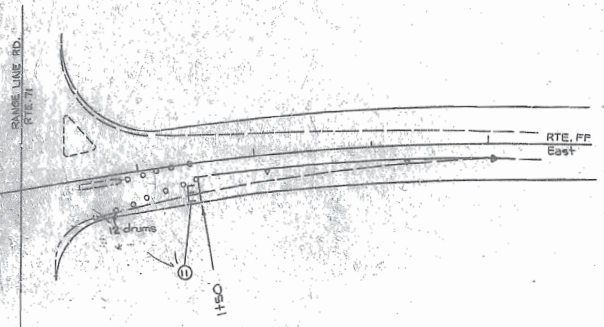
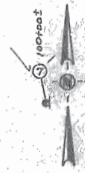
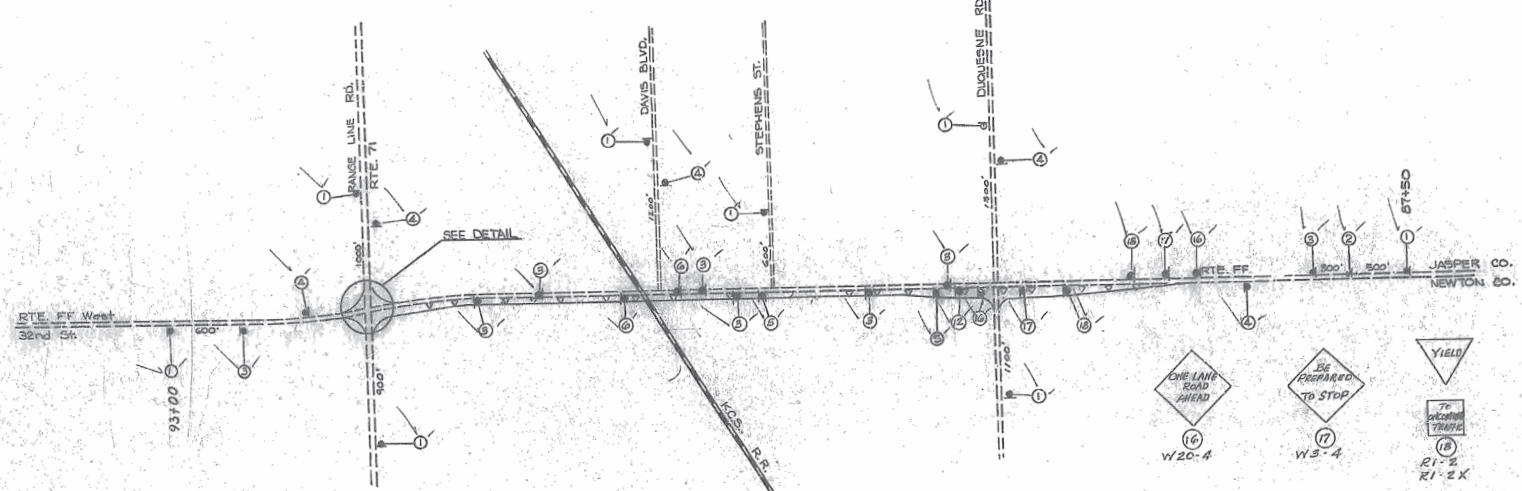

DETAIL 1ST STAGE

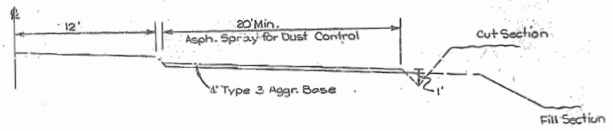

1ST STAGE
TRAFFIC CONTROL
Special Sheet No. 1

DATE	
BY	
CHECKED	
APPROVED	

NO.	
DATE	
BY	
CHECKED	
APPROVED	

577
21

STATE	JOB NO	7-U-FF-218	DATE	
7 MO	PROJ. NO.	25-776(5)	19	
SHEET NO.		7	OF	
7 JASPER NEWTON FF				

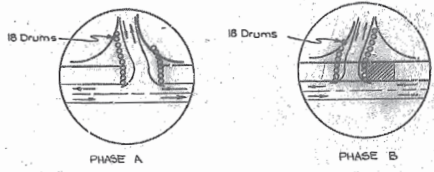
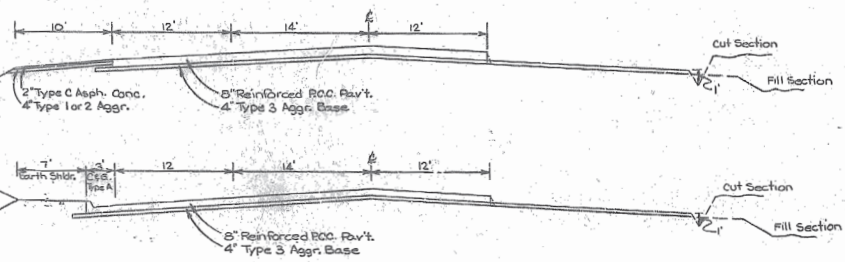
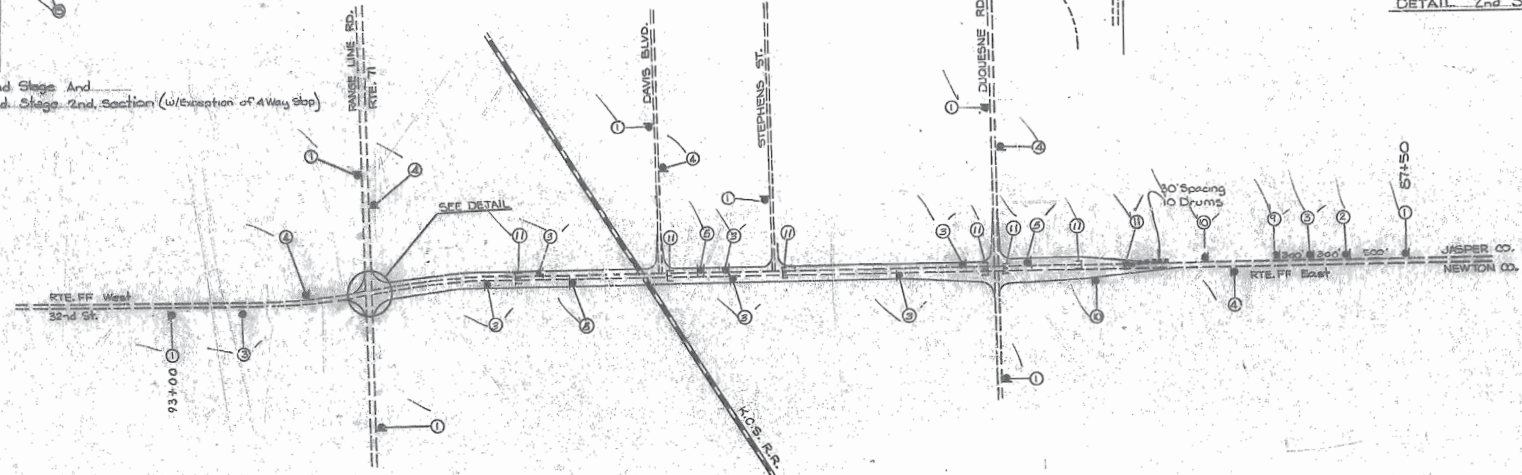
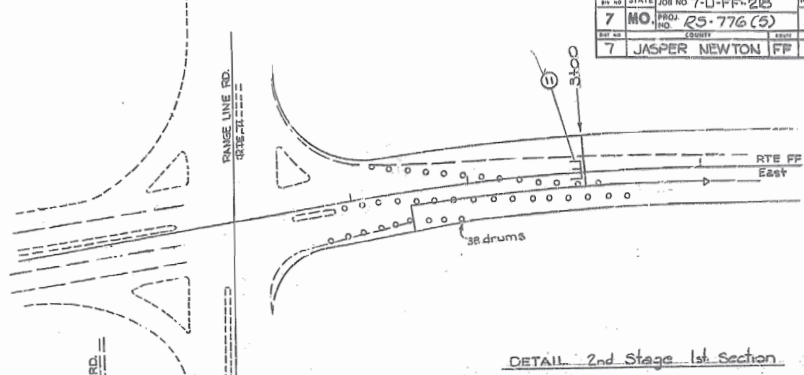
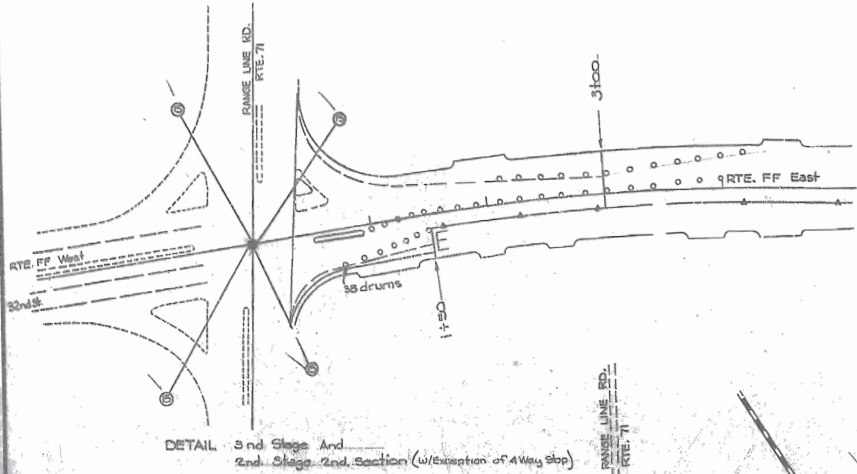

ENTRANCES & SIDE ROADS
 Did remain open to traffic during paving by skipping a portion of paving at these entrances and side roads, then after the cong. had cured, the contractor did reroute traffic over new pavement while paving the portion previously skipped.

2nd STAGE
TRAFFIC CONTROL
 Special Sheet No. 2

DATE	BY	REVISION

DATE	BY	REVISION

578-28

NO.	STATE	JOB NO.	7-U-FF-218	DATE
7	MO.	NO.	23-776(5)	20
NO.	COUNTY	TOWNSHIP	RANGE	SECTION
7	JASPER-NEWTON	FF		



Approx. 2250 Feet to Sta. 65+00
End of Proj. Job No. 7-U-FF-218

See Sheet # 5

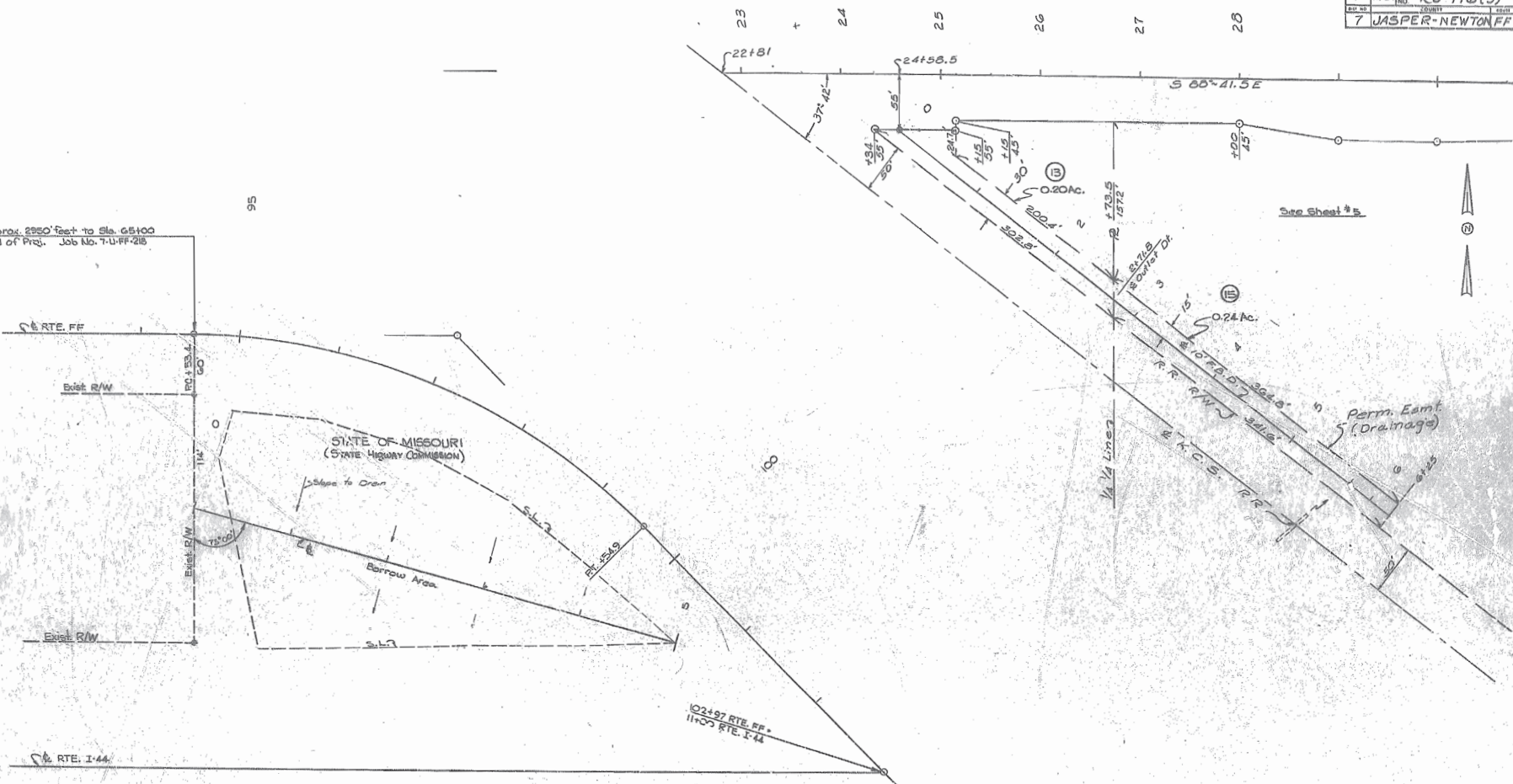

Note: The design grade established for this borrow area is approximate. During the construction phase of the project, it was revised as necessary to provide the proper quantity of fill material to complete the roadway grading.

Scale 1" = 50'

Outlet Ditch Esmt.
Rt 24+58.5
Borrow Area

SPECIAL SHEET No. 3

5719
29

JOB NO.	7-U-FF-216	SHEET NO.	
PROJECT NO.	25-776(5)	SHEET NO.	21
DIST. NO.		COUNTY	EDGAR
		CITY	FF
	7 JASPER-NEWTON		

TRAFFIC SIGNAL SYMBOLS

	OPTICALLY LIMITING SIGNAL HEAD		CAPPED CONDUIT
	CONVENTIONAL SIGNAL HEAD		CONDUIT IN TRENCH
	OPTICALLY LIMITING AND CONVENTIONAL SIGNAL HEAD		CONDUIT PUSHED
	SIGNAL HEAD WITH BACKPLATE		EXISTING CONDUIT
	SIGNAL HEAD-PEDESTRIAN		STEEL CONDUIT ON BRIDGE
	POST MOUNTED SIGNAL HEAD WITH SIGN		CONDUIT IN MEDIAN
	STOP LINE	3"	SIZE OF CONDUIT
	LANE USE	3-2c #12	NUMBER & SIZE OF CABLE
	TYPE A BASE		SIGNAL FACE NUMBER
	TYPE B BASE		POST NUMBER
	TYPE C BASE		DETECTOR NUMBER
	EXISTING POST BASE		PULL BOX NUMBER
	WOOD POLE WITH DOWN GUY	R	RED LENS (CIRCULAR)
	CONTROLLER	FR	FLASHING RED (CIRCULAR)
	EXISTING CONTROLLER	Y	YELLOW LENS (CIRCULAR)
	PULL BOX, TYPE 1	FY	FLASHING YELLOW (CIRCULAR)
	PULL BOX, TYPE 2	YL	YELLOW LEFT ARROW LENS
	SERVICE POLE AND POWER SUPPLY	YRt	YELLOW RIGHT ARROW LENS
	EXISTING PULL BOX	G	GREEN LENS (CIRCULAR)
	SPAN WIRE WITH SIGNAL HEAD	S	GREEN STRAIGHT ARROW LENS
	LUMINAIRE (WHEN SPECIFIED)	L	GREEN LEFT ARROW LENS
	MAST ARM WITH SIGNAL HEADS	Rt	GREEN RIGHT ARROW LENS
	MAST ARM WITH OVERHEAD SIGN	DL	DOWN LIGHT
	LIGHT & POLE	R	12 INCH LENS
	INDUCTION LOOP DETECTOR	G	TUNNEL VISOR
	PUSH BUTTON DETECTOR	EYE	TUNNEL VISOR WITH EXTERNAL LOUVER

W	WALK INDICATION
DW	DON'T WALK INDICATION
FDW	FLASHING DON'T WALK INDICATION

COMMISSION FURNISHED SIGNS

SIGN NUMBER	
1	R10-10L - LEFT TURN SIGNAL (24 x 30)
2	R10-10R - RIGHT TURN SIGNAL (24 x 30)
3	R3-5L - LEFT ARROW (SYMBOL)-ONLY (30 x 36)
4	R3-5R - RIGHT ARROW (SYMBOL)-ONLY (30 x 36)
5	R3-5S - STRAIGHT ARROW (SYMBOL)-ONLY (30 x 36)
6	R3-6L - LEFT ARROW-STRAIGHT ARROW (SYMBOL) (30 x 36)
7	R3-6R - RIGHT ARROW-STRAIGHT ARROW (SYMBOL) (30 x 36)
8	R3-2 - NO LEFT TURN (SYMBOL) (24 x 24)
9	R3-2x - NO LEFT TURN (PLAQUE) (24 x 18)
10	R3-1 - NO RIGHT TURN (SYMBOL) (24 x 24)
11	R3-1x - NO RIGHT TURN (PLAQUE) (24 x 18)
12	R3-3a - NO TURNS (24 x 24)

WHEN USED SPECIFY BOTH SIGNS

WHEN USED SPECIFY BOTH SIGNS

TRAFFIC SIGNAL & LIGHTING RELOCATION

FINAL PLANS

STATE	JOB NO.	7-11-FF-218	DATE
7 MO	PROJ. NO.	25-776(5)	22
7	JASPER-NEWTON	FF	

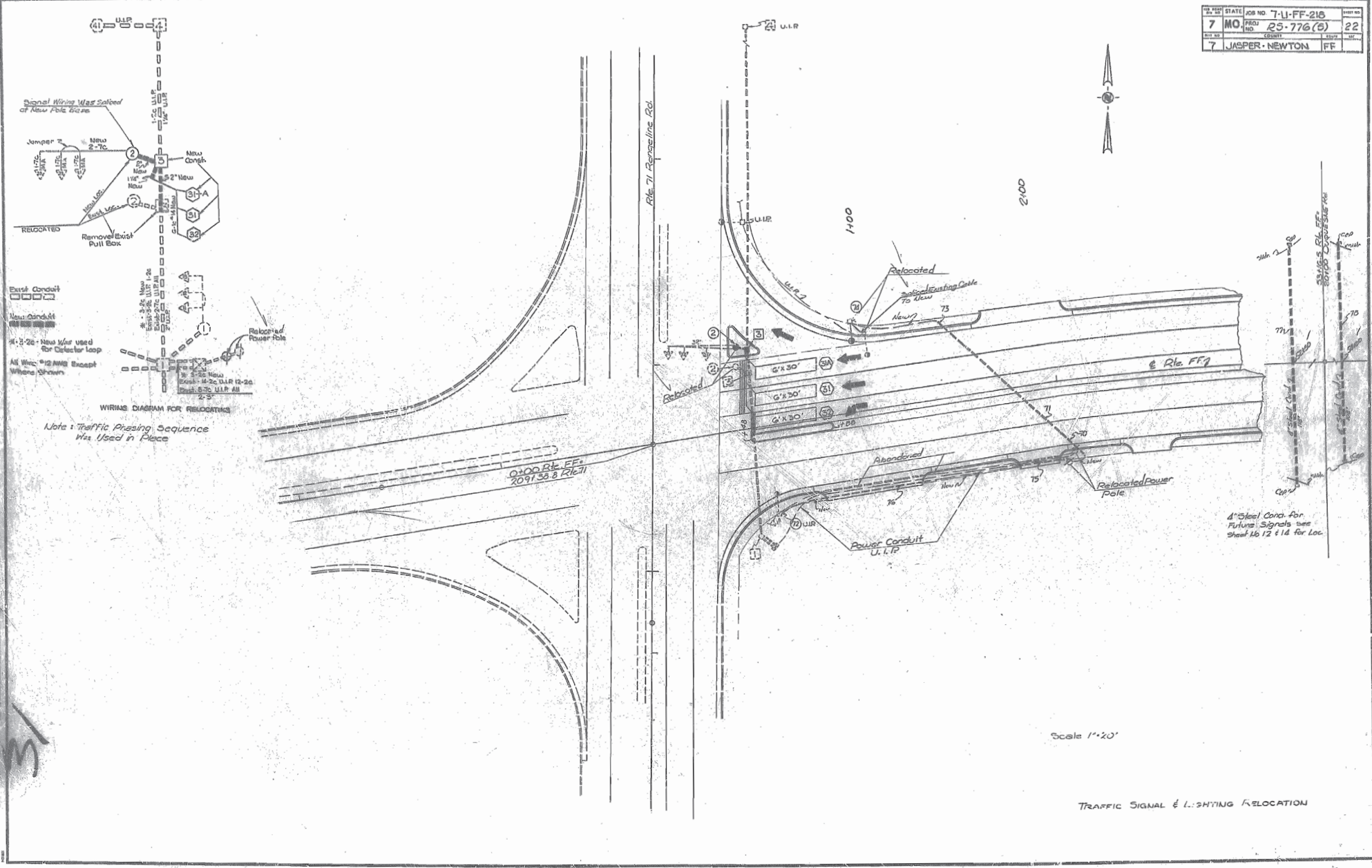

Signal Wiring Was Solved at New Pole Base



Exist Conduit
New Conduit
4-2-22 - New Wire used for Detector Loop
All Wire 12 AWG Except Where Shown

WIRING DIAGRAM FOR RELOCATING

Note: Traffic Phasing Sequence Was Used in Place

0+00 Rte. FF7
2091 33.8 R1671

Scale 1"=20'

TRAFFIC SIGNAL & LIGHTING RELOCATION

DATE	BY	CHKD.

DATE	BY	CHKD.

58/25
153

JOB NO 7-U-FF-216	SHEET NO 228
PROJECT NO RS-776(5)	DATE 1/28
COUNTY 7 JASPER-NEWTON	TOWN FF

Sheet 1 of 2

CONTROLLER AND AUXILIARY EQUIPMENT																
LOCATION		ACTUATED				PRE-TIMED				ON-OFF SWITCH	COORDINATION UNIT			TONE UNIT		REMARKS
APPROACH	STATION	OFFSET	PHASE MODULE		TYPE				TYPE	MASTER	LOCAL	TIME BASE	TRANSMITTER	RECEIVER		
			S	D	P	SP	DP	M-N	M-I	M-M	TYPE I	TYPE 2	I	II		
u.w.p.	East	Controller														

POWER SUPPLY									
LOCATION			POWER SUPPLY ASSEMBLY		CIRCUIT BREAKER TRIP RATING			SERVICE POLE	
APPROACH	STATION	OFFSET	DRAWING 90215	DRAWING	MAIN BREAKER	CONT-ROLLER BREAKER	LIGHTING BREAKER	CONTRACT FURNISH	UTILITY COMPANY
Rt. FF	2100	40' Rt	Type		Ampt	Ampt	Ampt	Cl. Ft.	Ft.

POST NUMBER PULL BOX NUMBER DETECTOR NUMBER	LOCATION			BASES			DETECTOR				POST																COMMISSION FURNISHED SIGNS							
	APPROACH	STATION	OFFSET	A	B	C	PULL BOX	PUSH BUTTON	MAGNETIC	INDUCTION LOOP	CALL UNIT	TIME DELAY UNIT	TOP MOUNT	TYPE C-2								TYPE B								SPAN WIRE	WOOD STEEL			
				5	10	5	10	TYPE I	TYPE II	7	10	ARM LENGTH				SIGN SPACING				LEFT ARM E				RIGHT ARM K				INCLUDED ANGLE	LUMINAIRE BRACKET ARM (FEET)					
												A	A	A	A	B	C	D	E	E	E	E	E	F	G	H	F					G	H	L
2	Rt. FF	0+47.0	40' Lt				2.51							C Relocated Existing Posts, Signals, Signs w/Bracket																				
3	Rt. FF	0+54	38' Lt																															
3/A	Rt. FF	0+54.7	28' Lt																															
31	Rt. FF	0+52.3	18' Lt																															
32	Rt. FF	0+50.9	2' Lt																															
34	Rt. FF	1109	45' Lt											(Relocated Light Pole & Base)																				
35	Rt. FF	2100	40' Lt											(Relocated Power Pole)																				
							**TOTAL	2.51	1			3																						

POST NUMBER	FACE NUMBER	DOWN LIGHT	LUMINAIRE LOW MOUNT	INDICATIONS																								VISORS 12" LENS	ST. TUN	LOUVERS	BACKPLATES				BRACKET				ONE-FACE SECTIONS										TWO-FACE SECTIONS										REMARKS										
				12" LENS CONVENTIONAL												12" LENS OPTICALLY LIMITED															LENSES		TYPE		SECTIONS					SECTIONS																													
				R	Y	O	S	L	R	Y	L	W	D	W	R	Y	G	S	L	R	Y	L	W	D	W	R	1				2	3	4	1	2	3	4	5	11	22	33	34	35	44	45																								
				(Used Relocated Post & Signal)																											A	B	C	D	E	F	12	1	2	3	4	5	I	II	III	IV	T	S	C	B	T	S	T	S	C	B	S	C		B	S	C	B	T	S	B	T	S	T
TOTAL																																																																					

*ITEMS FOR WHICH SEPARATE PAYMENT WILL NOT BE MADE
 OPTICALLY LIMITED
 CONVENTIONAL
 COMBINATION O.L.& CONV.
 LEGEND
 B-MAST ARM MOUNT
 C-SPAN WIRE MOUNT
 T-TOP MOUNT
 S-SIDE MOUNT
 ALL ITEMS INCLUDED IN COST OF RELOCATED TRAFFIC SIGNAL OR LIGHT POLE

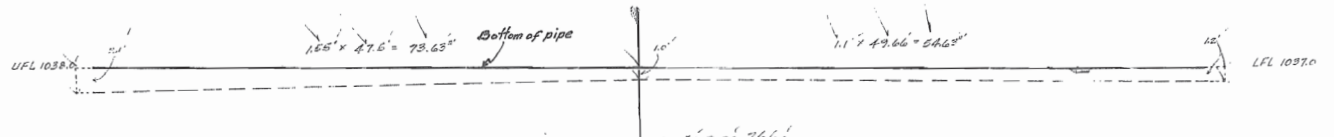

Sheet # E Page 20 7/17/65
 Sta. 29+60 Extra C1'S Exc. for unsound material below pipes.
 4" 42" x 84" Cl. III R.C.P. Outside dia. = 42.6"
 Sta. 29+49, 29+56.3, 29+53.6, 29+70.3
 $(0.63' \times 78.63') \times 29.15' = 138.47 \text{ CY USE 138.47 C.Y. C1'S Exc.}$

Sheet # E Page 21 7/17/65
 Sta. 21+80 Extra C1'S Exc. due to unsound material below bottom of pipe, as per 206.63
 54.6" dia. & 25.24' Cl. III R.C.P. in 1st and 2nd sections.
 Sta. 21+76.5 & Sta. 21+86' 30" R.C.P.
 $OD = 3.08', 15.475' \times 30', (50.475' \times 25.24' \times 2) = 16.40 \text{ C.Y.}$
 $16.40 \times 2 = 32.80 \text{ C.Y. USE 33.0 C.Y. C1'S Exc.}$

Additional C1's 3
Exc.

12-19-65
J.L. Newton
1/8" Scale

35

MISSOURI HIGHWAY AND TRANSPORTATION COMMISSION
STANDARD PLANS

SP-2
OCTOBER, 1984

✓	NO.	DESCRIPTION
✓	203.00E	EXCAVATION & EMBANKMENT
✓	203.02C	UNDERDRAINING
✓	203.02A	TABULATED EARTHWORK & SECTION DATA
✓	203.02A	SUPERELEVATION SPALS & WIDENING (UNDIVIDED)
✓	203.02A	SUPERELEVATION SPALS & WIDENING (DIVIDED)
✓	203.02A	ENTRANCES & APPROACHES (LESS THAN 400 ADT)
✓	203.02B	ENTRANCES & APPROACHES (20' - 100' THAN 400' ADT - NO SAFETY ZONE)
✓	203.02C	ENTRANCES & APPROACHES (GREATER THAN 400 ADT - SAFETY ZONE)
✓	203.02A	RAILBOX TURNOUTS
✓	203.40D	TYPICAL DETAILS-RAMPS FOR INTERCHANGES (NO SAFETY ZONE)
✓	203.41D	TYPICAL DETAILS-RAMPS FOR INTERCHANGES (SAFETY ZONE)
✓	203.50J	TYPICAL CROSS-OVERS (DIVIDED HIGHWAYS)
✓	204.00D	EMBANKMENT CONTROL MEASURING DEVICES
✓	502.00J	CONCRETE PAVEMENT APPURTENANCES
✓	502.10C	DOWEL SUPPORTING UNITS
✓	503.00H	CONCRETE APPROACH SLABS TO BRIDGES (ALSO INCLUDE 502.00)
✓	602.00A	RIGHT-OF-WAY & DRAIN MARKERS
✓	604.05A	PIPE CULVERT HEADWALLS - TYPE S
✓	604.20B	HEADWALL-WITH ENERGY DISSIPATOR - 16"
✓	604.20B	HEADWALL-WITH ENERGY DISSIPATOR - 24"
✓	604.20B	HEADWALL-WITH ENERGY DISSIPATOR - 30"
✓	604.20B	HEADWALL-WITH ENERGY DISSIPATOR - 36"
✓	604.20B	HEADWALL-WITH ENERGY DISSIPATOR - 42"
✓	604.20B	HEADWALL-WITH ENERGY DISSIPATOR - 48"
✓	604.20B	DROP INLET - TYPE B
✓	604.21B	DROP INLET - TYPE C
✓	604.22B	DROP INLET - TYPE D
✓	604.23B	DROP INLET - TYPE E
✓	604.24B	DROP INLET - TYPE EE
✓	604.25B	DROP INLET - TYPE F
✓	604.26C	DROP INLET - TYPE G
✓	604.27C	DROP INLET - TYPE S (3 SHEETS)
✓	604.28D	DROP INLET - TYPE T (ALSO INCLUDE 614.30)
✓	604.29C	DROP INLET - TYPE X
✓	604.30F	CONCRETE MANHOLES (ALSO INCLUDE 614.30)
✓	604.40E	PIPE COLLARS
✓	605.10A	CLASS A UNDERDRAINS
✓	606.00S	GUARD RAIL (2 SHEETS)
✓	606.20G	BRIDGE ANCHOR SECTION - BRUSH CURB (ALSO INCLUDE 606.00)
✓	606.21E	BRIDGE ANCHOR SECTION - CURB TYPE (ALSO INCLUDE 606.00)
✓	606.22D	BRIDGE ANCHOR SECTION - SAFETY BARRIER CURB (INCLUDE 606.00)
✓	606.20E	TERMINAL SECTION (ALSO INCLUDE 606.00)
✓	606.40A	GUARD CABLE
✓	607.10P	CHAIN LINK FENCE
✓	607.11B	CHAIN LINK FENCE FOR RETAINING WALLS
✓	607.20E	WOVEN WIRE FENCE (ALSO INCLUDE 607.10)

✓	NO.	DESCRIPTION
✓	608.00C	PAVED APPROACHES
✓	608.10F	CONCRETE SIDEWALK & WHEELCHAIR RAMPS
✓	608.20B	CONCRETE STEPS
✓	609.00D	CONCRETE CURB - CURB & OUTER - OUTER
✓	609.15A	PAVED DITCHES
✓	609.40D	DRAIN BASIN, SHUR. PAVING & FIL SLOPE AT BR. ENDS
✓	609.40A	DITCH LINER
✓	609.70C	ROCK LINING FOR CULVERT OUTLETS
✓	610.20E	BRICK MANHOLES (ALSO INCLUDE 614.30)
✓	611.60K	CONCRETE SLOPE PROTECTION
✓	612.10K	BARRICADES AND FLASHER SIGNS
✓	614.10K	CURB INLETS, GRATES & BEARING PLATES
✓	614.20C	MANHOLE FRAMES & COVERS
✓	615.00A	OFFICE FOR ENGINEER
✓	616.10C	TRAFFIC CONTROL DEVICES (2 SHEETS) (ALSO INCLUDE 903.01)
✓	617.00S	CONCRETE MEDIAN BARRIER (2 SHEETS)
✓	702.01E	16" CONCRETE PILES (APPROVED TYPES) (2 SHEETS)
✓	702.02B	CAST-IN-PLACE CONCRETE PILES (APPROVED TYPES)
✓	703.11D	CONCRETE BOX CULVERTS, HIS LOADING (3 SHEETS) (INCL. 706.35)
✓	703.16C	CONCRETE BOX CULVERTS, HIS LOADING (3 SHEETS) (FLARED WINGS) (INCL. 706.35)
✓	703.20D	CONCRETE BOX CULVERTS, HS20 LOADING (3 SHEETS) (INCL. 706.35)
✓	703.21C	CONCRETE BOX CULVERTS, HS20 LOADING (3 SHEETS) (FLARED WINGS) (INCL. 706.35)
✓	703.24D	CONCRETE BOX CULVERTS, SKEW DATA (703.16, 703.20, 703.30) (INCL. 706.35)
✓	703.25C	CONCRETE BOX CULVERTS, SKEW DATA (703.16 & 703.21) (3 SHEETS) (FLARED WINGS) (INCL. 706.35)
✓	703.30C	CONCRETE BOX CULVERTS, 4' SPANS & LESS - ALL LOADING (INCL. 706.35)
✓	703.35B	CONCRETE BOX CULVERTS, CUTTING DETAILS (STRAIGHT WINGS) (INCL. 706.35)
✓	703.36A	CONCRETE BOX CULVERTS, CUTTING DETAILS (FLARED WINGS) (INCL. 706.35)
✓	703.50E	CONCRETE DOUBLE BOX STRUCTURE - SQUARE (INCL. 706.35)
✓	703.51D	CONCRETE DOUBLE BOX STRUCTURE - SKEWED (INCL. 706.35)
✓	703.52E	CONCRETE DOUBLE BOX STRUCTURE - CUT SECTIONS (INCL. 706.35)
✓	703.53C	DOUBLE BOX STRUCTURE REINFORCEMENT - HIS LOADING (6 SHEETS)
✓	703.54C	DOUBLE BOX STRUCTURE REINFORCEMENT - HS20 OR HS20 LOADING (6 SHEETS)
✓	703.55B	CONCRETE DOUBLE BOX STRUCTURE (FLARED WINGS) SQUARE (INCL. 706.35)
✓	703.56B	CONCRETE DOUBLE BOX STRUCTURE (FLARED WINGS) SKEWED (INCL. 706.35)
✓	703.60C	CONCRETE BOX STRUCTURE - PIPE INLET
✓	706.30D	REINFORCING BAR SUPPORTS
✓	706.35D	BAR SUPPORTS FOR CONCRETE REINFORCEMENT
✓	712.40B	STEEL DAMS FOR BRIDGES (6" CHANNEL)
✓	712.41B	STEEL DAMS FOR BRIDGES (8" CHANNEL)
✓	725.31C	METAL CURTAIN WALL AND METAL INLETS
✓	726.30C	CULVERT INSTALLATION METHODS
✓	731.00N	PRECAST MANHOLES (ALSO INCLUDE 614.30)
✓	731.10F	PRECAST DROP INLETS (4 SHEETS) (ALSO INCLUDE 614.30 & 614.10)
✓	732.00K	FLARED END SECTION (2 SHEETS)
✓	806.00C	EROSION CONTROL NETTING (INSTALLATION) TYPE I
✓	806.02	STAPLE PLACEMENT FOR TYPE III NETTING

STATE MO.	JOB NO. 7-LI-FF-218	SHEET NO. 25
DIST. NO. 7	PROJECT NO. RS-776(15)	ROUTE FF
	COUNTY LASPER - NEWTON	

✓	NO.	DESCRIPTION
HIGHWAY LIGHTING		
✓	901.00I	POLES & APPURTENANCES - 30' (3 SHEETS)
✓	901.01O	POLES & APPURTENANCES - 45' (3 SHEETS)
✓	901.05A	CONTROL PANEL CABINET DETAILS (2 SHEETS) (NOTE BELOW)
✓	901.12A	POLE MOUNT, CONT. STA.-SECONDARY SERV.-480 V MULTI. CIR. (NOT METERED)
✓	901.15C	POLE MOUNT, CONT. STA.-SEC. SERV.-240, 240, & 480 V MULTI. CIR.
✓	901.16B	POLE MOUNT, CONT. STA.-SEC. SERV.-480 V MULTI. CIR. (METERED)
✓	901.18B	POLE MOUNT, CONT. STA.-SEC. SERV.-120/240 V MULTI. CIR.
✓	901.19B	POLE MOUNT, CONT. STA.-SEC. SERV.-240 V MULTI. CIR. (NOT METERED)
✓	901.20B	POLE MOUNT, CONT. STA.-SEC. SERV.-120/240 V MULTI. CIR. (SIG. METERED)
✓	901.22C	POLE MOUNT, CONT. STA.-SEC. SERV.-120/240 & 480 V MULTI. CIR. (BOTH METERED)
✓	901.23C	POLE MOUNT, CONT. STA.-SEC. SERV.-240 V MULTI. CIR. (METERED)
✓	901.24B	POLE MOUNT, CONT. STA.-SEC. SERV.-240 V MULTI. CIR. (L'S & SIGS-BOTH METERED)
✓	901.25B	BASE MOUNT, CONT. STA.-SEC. SERV.-120/240 V MULTI. CIR.
NOTE: ALSO INCLUDE 901.05 WITH 901.12 THROUGH 901.25 EXCEPT 901.18		
TRAFFIC SIGNALS		
✓	902.00D	SIGNAL HEADS, LENSES AND MOUNTING
✓	902.10E	PULL BOXES, CONTROLLERS, COND. LOCATION
✓	902.15A	POWER SUPPLY ASSEMBLY
✓	902.21B	TELEPHONE INTERCONNECT
✓	902.30E	CONCRETE BAYES
✓	902.40F	TUBULAR STEEL POST
✓	902.50E	DETECTORS
✓	902.60E	SPAN WIRE DETAILS - STEEL POST
✓	902.70A	SPAN WIRE DETAILS - WOOD POLE
HIGHWAY SIGNING		
✓	903.01C	ALPHABETS (2 SHEETS)
✓	903.02T	HIGHWAY SIGNING (7 SHEETS)
✓	903.03AF	SIGN MOUNTING DETAILS (6 SHEETS)
✓	903.04D	WEIGHT STATION SIGNING
✓	903.05C	TUBULAR SPAN SUPPORT - ONE TUBE, TYPE S
✓	903.06C	TUBULAR SPAN SUPPORT - TWO TUBE, TYPE S
✓	903.07C	TUBULAR CANTILEVER SUPPORTS, TYPE C
✓	903.08C	TUBULAR BUTTERFLY SUPPORTS, TYPE B
✓	903.09C	LIGHTING SUPPORT BRACKET
✓	903.10S	SIGN TRUSSES - OVERHEAD ALUMINUM (8 SHEETS) (INCL. 903.03)
✓	903.12L	SIGN TRUSSES - BUTTERFLY & CANTILEVER - STEEL (7 SHEETS) (INCL. 903.03)
✓	903.60D	SIGN TRUSSES - OVERHEAD STEEL (7 SHEETS) (INCL. 903.03)

NOTES: Plans for this project were developed using Drawings from this index.

Revised since April, 1983

534 36