

ROUNDBABOUT - 8 CONFLICT POINTS

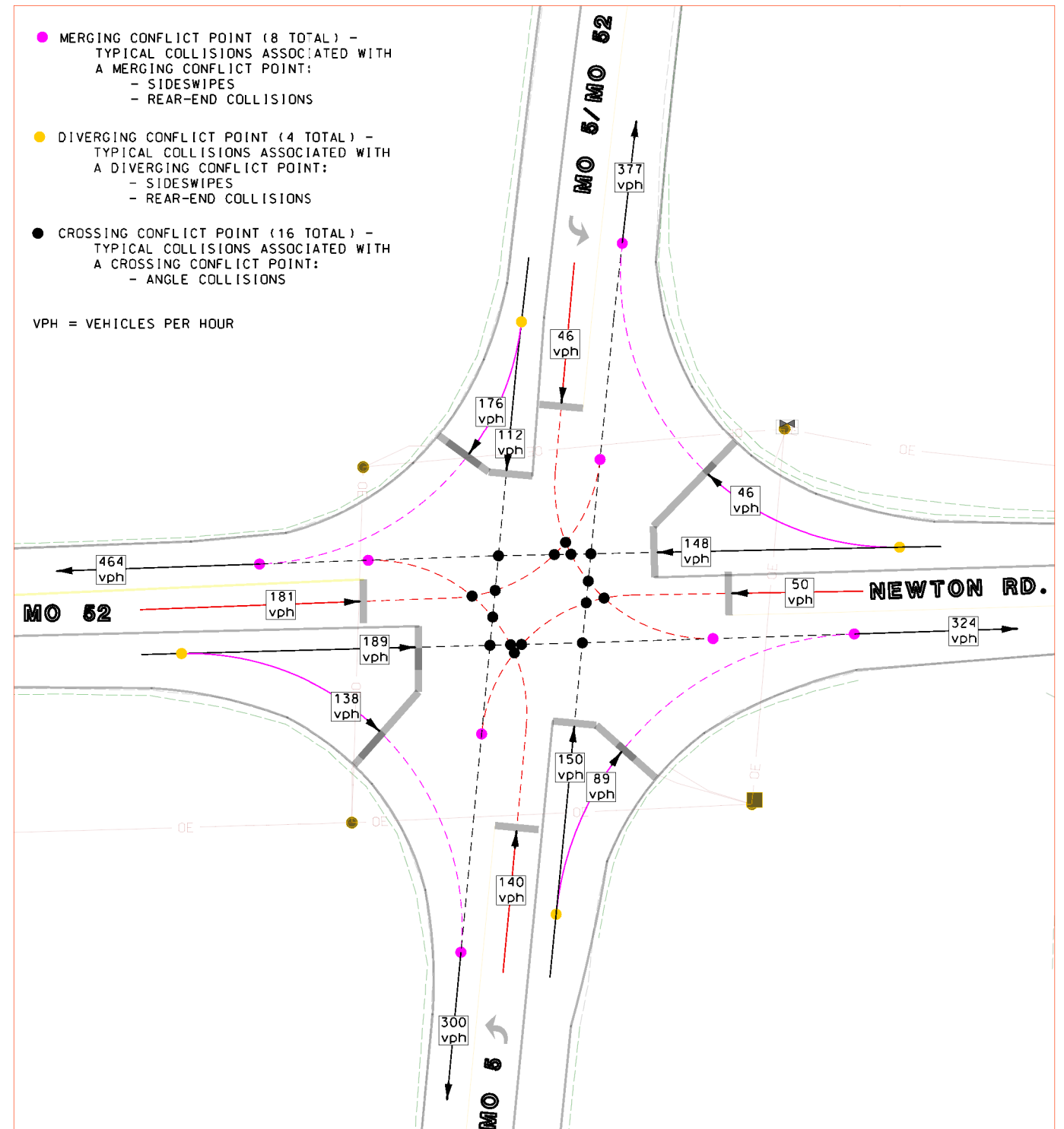

FOUR-LEGGED INTERSECTION - 28 CONFLICT POINTS

- MERGING CONFLICT POINT (4 TOTAL) - TYPICAL COLLISIONS ASSOCIATED WITH A MERGING CONFLICT POINT:
 - SIDESWIPES
 - REAR-END COLLISIONS
- DIVERGING CONFLICT POINT (4 TOTAL) - TYPICAL COLLISIONS ASSOCIATED WITH A DIVERGING CONFLICT POINT:
 - SIDESWIPES
 - REAR-END COLLISIONS

VPH = VEHICLES PER HOUR

- MERGING CONFLICT POINT (8 TOTAL) - TYPICAL COLLISIONS ASSOCIATED WITH A MERGING CONFLICT POINT:
 - SIDESWIPES
 - REAR-END COLLISIONS
- DIVERGING CONFLICT POINT (4 TOTAL) - TYPICAL COLLISIONS ASSOCIATED WITH A DIVERGING CONFLICT POINT:
 - SIDESWIPES
 - REAR-END COLLISIONS
- CROSSING CONFLICT POINT (16 TOTAL) - TYPICAL COLLISIONS ASSOCIATED WITH A CROSSING CONFLICT POINT:
 - ANGLE COLLISIONS

VPH = VEHICLES PER HOUR

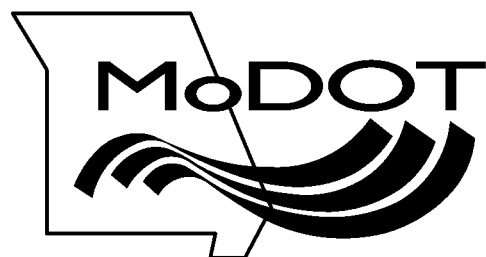

**MORGAN COUNTY
MISSOURI ROUTE 5 & 52 WEST JUNCTION
ROUNDBABOUT and FOUR-LEGGED INTERSECTION COMPARISON**

NOTE:
1. VEHICLE PER HOUR (vph) QUANTITIES ARE PROJECTED TO THE YEAR 2044.