

FRONTAGE ROADS: For clarification, this exhibit differentiates between frontage roads that are reasonably foreseen to be constructed with the initial reconstruction and widening of the I-70 from those that may be constructed in the future as needs arise and funding becomes available. It is a goal of MoDOT to work toward one continuous frontage road along I-70, on one side or the other. Some sections of frontage road shown on this exhibit may never be constructed; however, impacts were assessed in this document for the entire footprint.

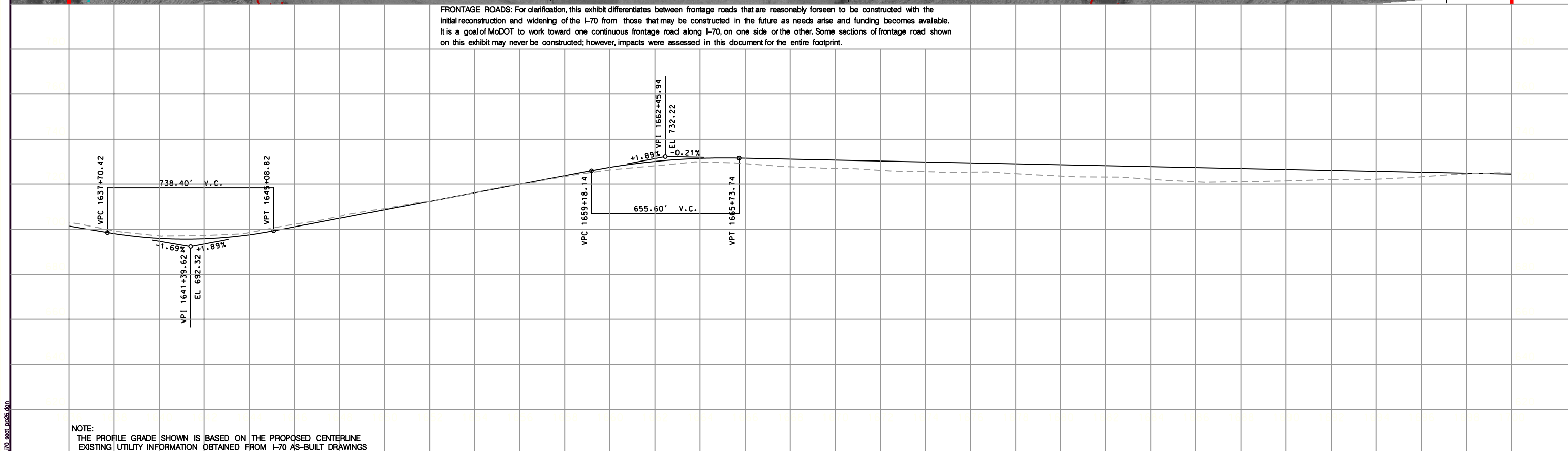

NOTE:
THE PROFILE GRADE SHOWN IS BASED ON THE PROPOSED CENTERLINE
EXISTING UTILITY INFORMATION OBTAINED FROM I-70 AS-BUILT DRAWINGS

SCALE

0 100 200 300 400 500

LEGEND

— Proposed Right-Of-Way	— Existing Underground Gas	— Cemeteries/Churches	— NWI Emergent
- - - Existing Right-Of-Way Line	— Existing Underground Telephone	— Conservation Areas	— NWI Forested
- - - Existing Property Lines	— New Pavement on Existing Pavement Location	— CRP	— NWI Scrub/Shrub
— Overpass	— New Pavement	— Hazardous Waste	— WRP
— Proposed Centerline	— Frontage Road	— NRCS Wetlands	— Residential Displacement
— Proposed Edge of Shoulder	— Future Frontage Road	— Ponds	— Business Displacement
— Existing Overhead Power		— Potential Architectural Resources	— Outbuildings/Other Structures Displacement



Interstate 70 Section of Independent Utility No.2 - Odessa to Boonville Subsection ML8

SHEET

A-32

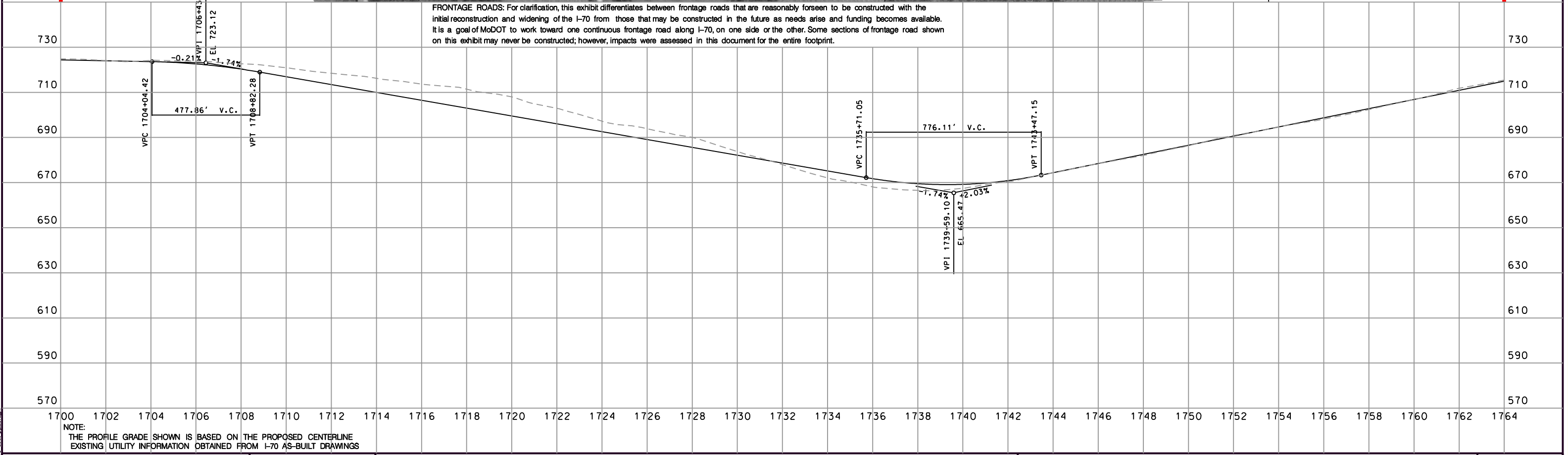
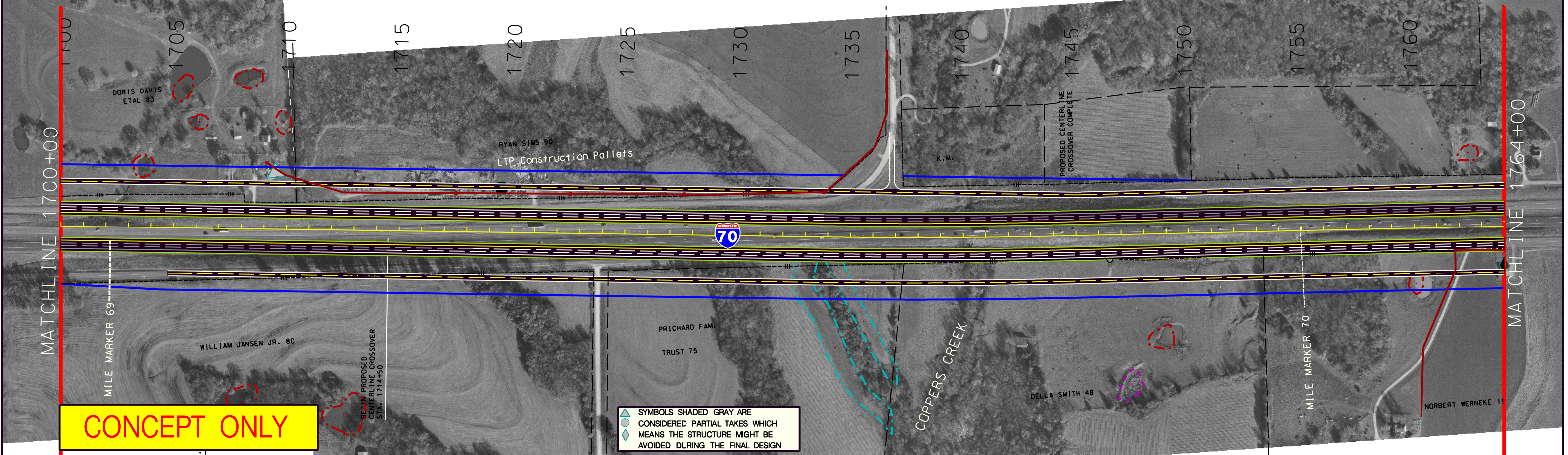
AERIAL PHOTOGRAPH NOVEMBER 2000

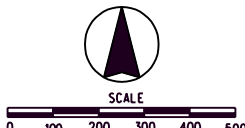



LEGEND

Proposed Right-Of-Way	Existing Underground Gas	Cemeteries/Churches	NWI Emergent
Existing Right-Of-Way Line	Existing Underground Telephone	Conservation Areas	NWI Forested
Existing Property Lines	New Pavement on Existing Pavement Location	CRP	NWI Scrub/Shrub
Overpass	New Pavement	Hazardous Waste	WRP
Proposed Centerline	Frontage Road	NRCS Wetlands	Residential Displacement
Proposed Edge of Shoulder	Future Frontage Road	Ponds	Business Displacement
Existing Overhead Power		Potential Architectural Resources	Outbuildings/Other Structures Displacement



Interstate 70 Section of Independent Utility No.2 - Odessa to Boonville Subsection ML8

SHEET

A-33

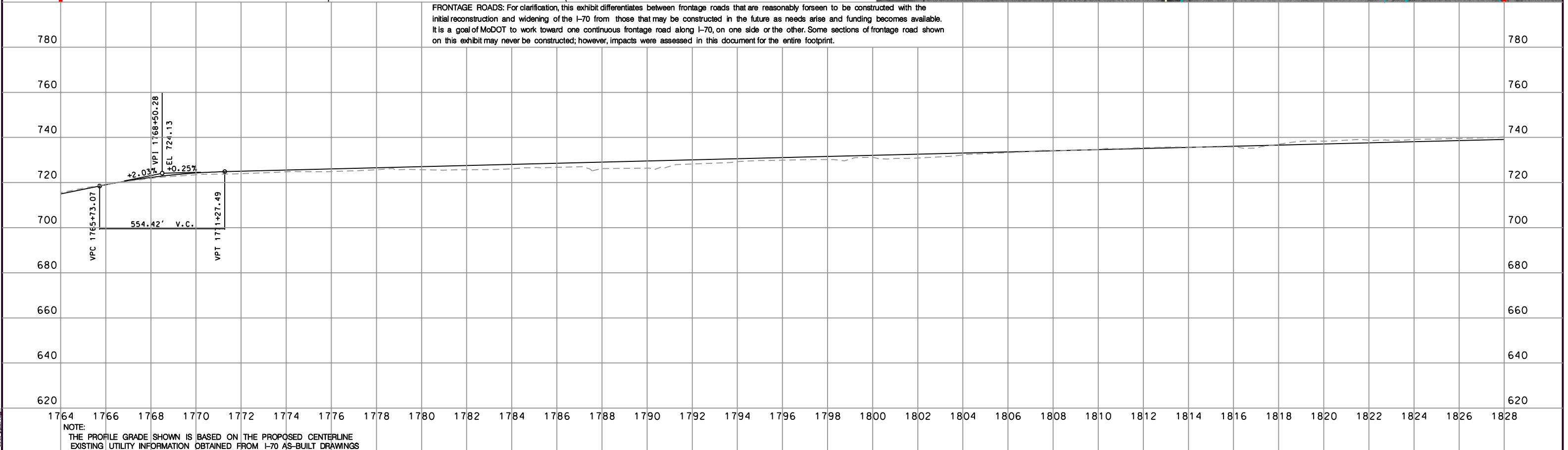
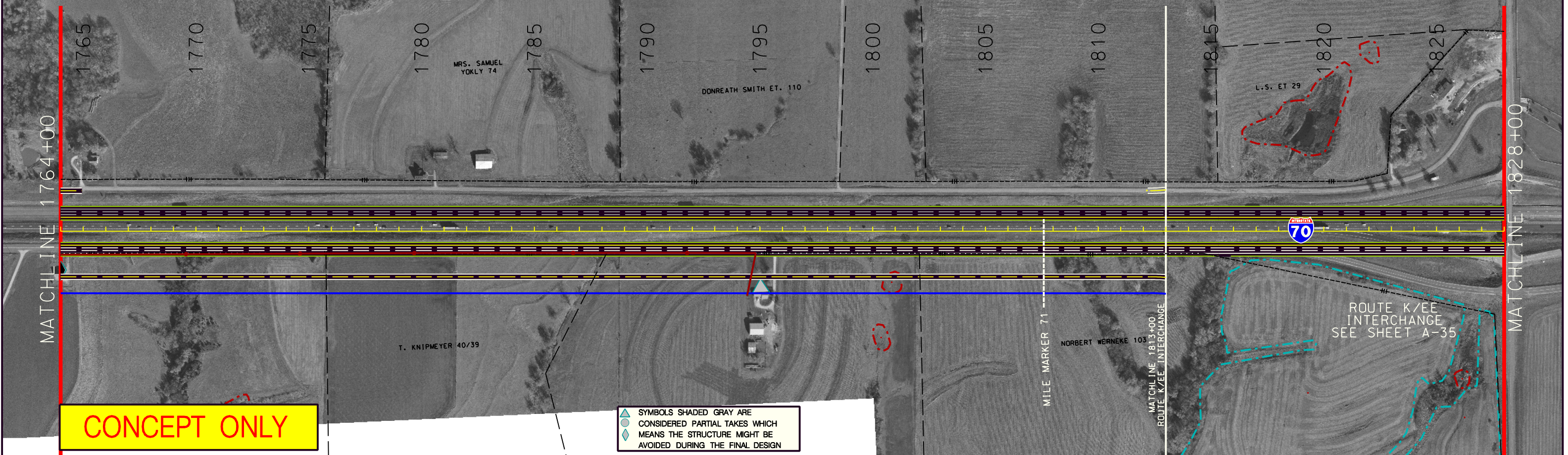
AERIAL PHOTOGRAPH NOVEMBER 2000

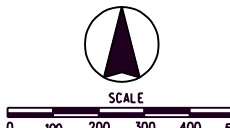



LEGEND

Proposed Right-Of-Way	Existing Underground Gas	Cemeteries/Churches	NWI Emergent
Existing Right-Of-Way Line	Existing Underground Telephone	Conservation Areas	NWI Forested
Existing Property Lines	New Pavement on Existing Pavement Location	CRP	NWI Scrub/Shrub
Overpass	New Pavement	Hazardous Waste	WRP
Proposed Centerline	Frontage Road	NRCS Wetlands	Residential Displacement
Proposed Edge of Shoulder	Future Frontage Road	Ponds	Business Displacement
Existing Overhead Power		Potential Architectural Resources	Outbuildings/Other Structures Displacement

Interstate 70 Section of Independent Utility No.2 - Odessa to Boonville Subsection ML8

SHEET

A-34

AERIAL PHOTOGRAPH NOVEMBER 2000

CONCEPT ONLY

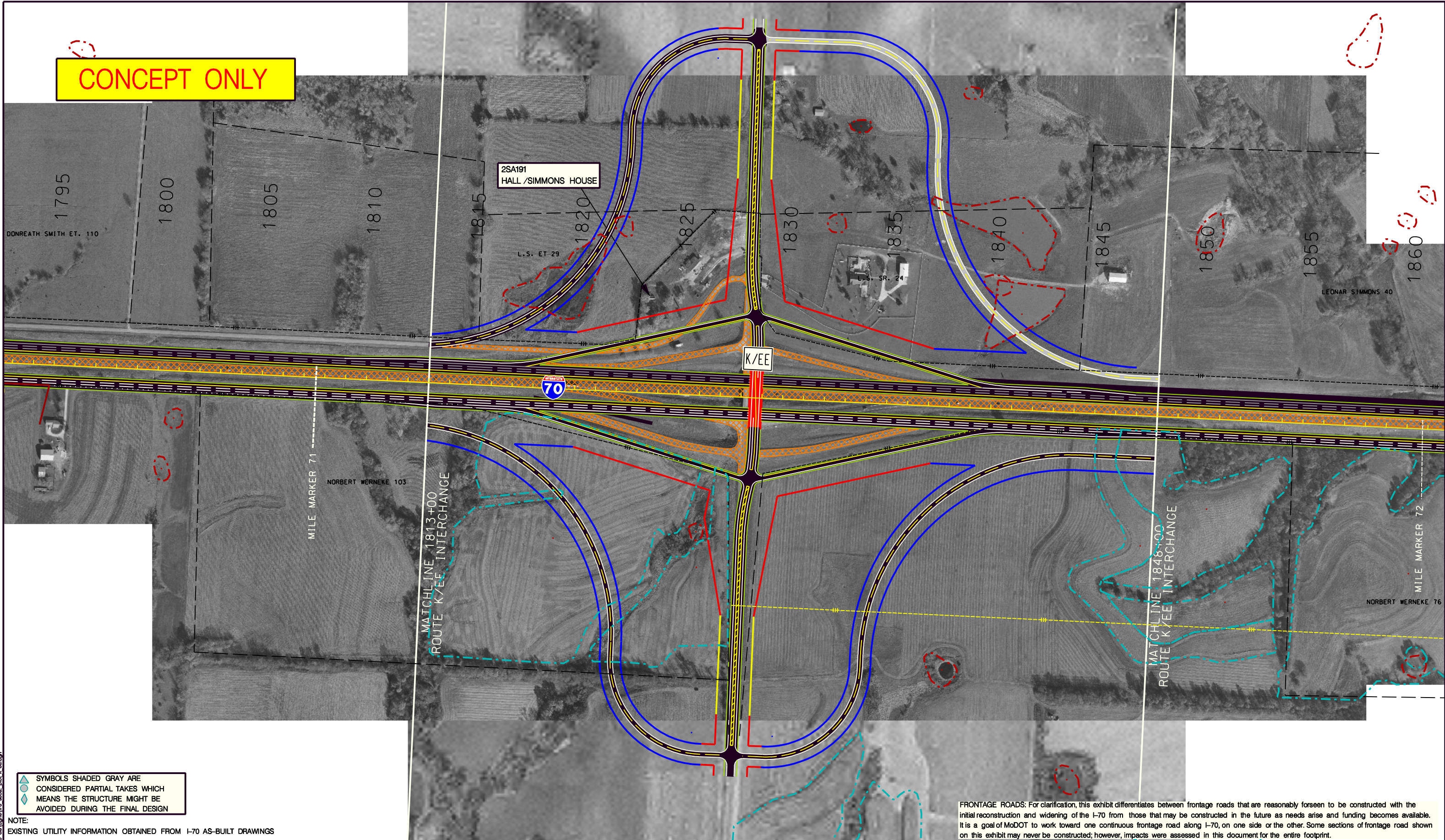

SYMBOLS SHADED GRAY ARE
CONSIDERED PARTIAL TAKES WHICH
MEANS THE STRUCTURE MIGHT BE
AVOIDED DURING THE FINAL DESIGN

NOTE:
EXISTING UTILITY INFORMATION OBTAINED FROM I-70 AS-BUILT DRAWINGS

FRONTAGE ROADS: For clarification, this exhibit differentiates between frontage roads that are reasonably foreseen to be constructed with the initial reconstruction and widening of the I-70 from those that may be constructed in the future as needs arise and funding becomes available. It is a goal of MoDOT to work toward one continuous frontage road along I-70, on one side or the other. Some sections of frontage road shown on this exhibit may never be constructed; however, impacts were assessed in this document for the entire footprint.

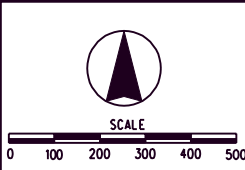
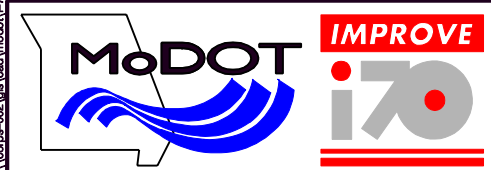

LEGEND		Access Controlled Right-Of-Way		Culvert (Plan View Only)		Cemeteries/Churches		NWI Emergent
		Limited Access Right-Of-Way		Existing Overhead Power		Conservation Areas		NWI Forested
		Normal Access Right-Of-Way		Existing Underground Gas		CRP		NWI Scrub/Shrub
		Overpass		Existing Underground Tele		Hazardous Waste		WRP
		Pavement Obliteration		New Pavement on Existing Right-Of-Way		NRCS Wetlands		Residential Displacement
		Existing Right-Of-Way Line		Existing Pavement Location		Ponds		Business Displacement
		Existing Property Lines		New Pavement		Potential Architectural Resources		Outbuildings/Other Structures Displacement
		Proposed Centerline		Frontage Road				
		Proposed Edge of Shoulder						

Interstate 70 Section of Independent Utility No.2 - Odessa to Boonville Route K/EE Interchange