

Addendum No. 2
To
Contract Documents, Specifications, and Drawings
For
Valentine Ford Road BRO-B037(10)

The Contract Documents, Specifications, and Drawings covering the construction of the Valentine Ford Road BRO-B037(10) Project are hereby amended as follows:

GENERAL

- A. Clarification on the bid submittal and opening information and requirements:
 - a. For bidders wishing to mail in their bid, the only option is to make sure it is mailed to the courthouse by 4 pm the day before the bid opening, which is Oct. 6. Bidders may also hand deliver bids to the Courthouse in Hermann any time on/before that same time/date. If bidders cannot get their bid to the courthouse by 4 pm October 6th, the only option is to hand deliver it to Owensville City Hall before 9:30 am, October 7th, which is where the commission will be to open bids. Owensville is not accepting/receiving mail deliveries of bid documents.

PLANS

- B. The attached C-200, dated 9-30-21, shall replace previous editions.
 - a. C-200 - line item for Embankment in Place was modified to indicate 300 Ton.
 - b. This quantity applies only to potentially necessary imported suitable material to bring the roadway to subgrade elevation.

BID DOCUMENTS

- C. Schedule of Prices, Page 9 shall replace previous editions.
 - a. Revised the unit price for Embankment in Place to 300 Ton.

Bidder shall acknowledge receipt of this addendum by completing the acknowledgement space provided in the Bid Form.

Date: September 30, 2021

ARCHER-ELGIN
Engineering, Surveying & Architecture
Rolla, Missouri

SCHEDULE OF PRICES

SITE AND ROADWAY

<u>Item No.</u>	<u>Item Description</u>	<u>Est. Qty.</u>	<u>Unit</u>	<u>Unit Price \$</u>	<u>Ext Figure \$</u>
1	Clearing and grubbing	1	LS		
2	Embankment in Place W/Compaction	300	TON		
3	Double 60" RCP Pipe	80	LF		
4	Double 60" RCP Flared End Section	2	EA		
5	Unclassified Excavation (Roadway)	940	CY		
6	Type 5 Aggregate Base (6" thick)	670	SY		
7	Type 3 Rock Blanket	1195	SY		
8	Traffic Control	1	LS		
9	Contractor-Furnished Survey and Staking	1	LS		
10	Seed & Mulch	1	AC		
11	18" CMP	47.5	LF		
SUBTOTAL					

BRIDGE

11	Unclassified Excavation (substructure)	1	LS		
12	Removal of Ford (existing structure)	1	LS		
13	Mobilization	1	LS		
14	Structural Steel Pile – 12"	528	LF		
15	Structural Steel Pile – 8"	132	LF		
16	Dynamic Pile Testing	4	EA		
17	Pile Point Reinforcement	18	EA		
18	Class B Concrete (Substructure)	158	CY		
19	36" wide Precast Deck Beam	960	LF		
20	Reinforcing Steel (bridge)	12,281	LB		
21	Plain Neoprene Bearing Pad	97	LF		
SUBTOTAL					

BASE BID TOTAL:

(Words)

(Figures)

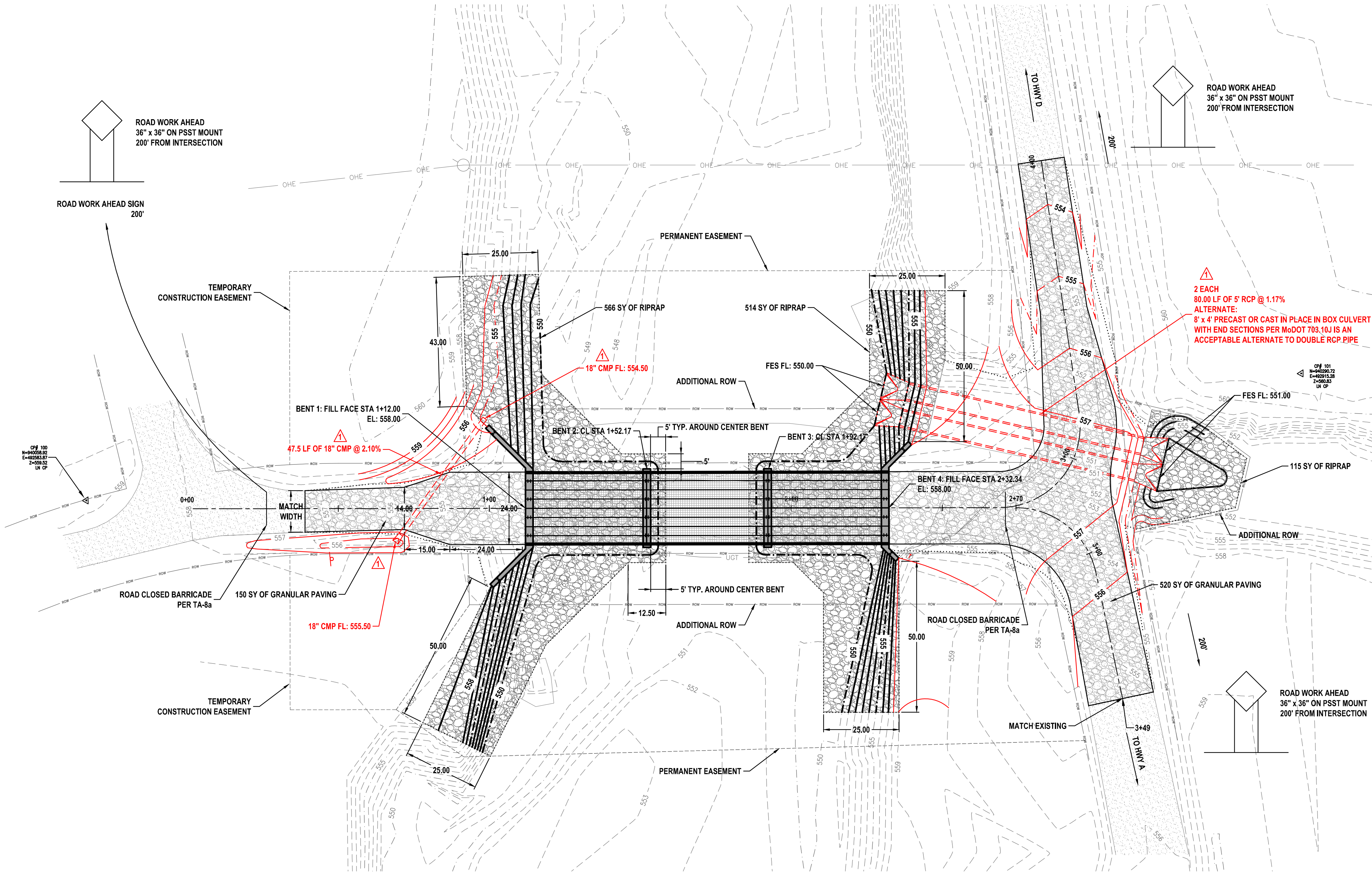

Bridge Quantities		
Item Description	Total	Unit
Unclassified Excavation (substructure)	1	LS
Removal of Ford (existing structure)	1	LS
Mobilization	1	LS
Structural Steel Pile (12 inch)	528	LF
Structural Steel Pile (8 inch)	132	LF
Dynamic Pile Testing	4	EA
Pile Point Reinforcement	18	EA
Class B Concrete (substructure)	158	CY
36" Precast Deck Beam	960	LF
Reinforcing Steel (bridge)	12,281	LBS
Plain Neoprene Bearing Pad (60 duro.)	97	LF