

# ADDENDUM # 1

TO THE DRAWINGS AND SPECIFICATIONS FOR:  
**Mexico Road Resurfacing and Pedestrian Bridge  
Project Phase 3 STP 4950-603, BID NO 21-031**  
City of O'Fallon, Missouri  
100 North Main Street  
O'Fallon, Missouri 63366

City of O'Fallon, Missouri  
100 North Main Street  
O'Fallon, MO 63366  
636-379-5513  
E-mail: ptaimonchuk@ofallon.mo.us

JULY 2, 2021

## INFORMATION

The following are additions or clarifications and are to become part of the Project Specifications:

- **Form C220 requirement:** After award and prior to start of construction, contractor will be required to submit MODOT form C220 “request to subcontract work” for all proposed subcontractors.
- **Notice to Proceed Information:** if the NTP is delayed by the City, the finish date of the contract will be adjusted to reflect the amount of calendar days the NTP was delayed from date listed in specifications.
- **Asphalt Testing:** A field laboratory will not be required for monitoring mixtures. All required QC and QA testing shall be performed in an approved laboratory. QLA and PWL will not be required. There will be no unit price adjustments (bonus or deduct) for asphalt pay items; the contractor shall still meet all specification requirements, deficient material or quality will not be accepted.
- **Asphalt Index Provision:** Contractor may elect to accept the Asphalt Cement Price Index at bid time. The contractor must check the appropriate box on the Bid Form (which has been updated and attached to this addendum)
- **Temporary Pavement Markings shall follow MODOT specifications Section 620.10**
- **Temporary Pavement Markings:** There will be no measurement or payment made for any temporary pavement markings regardless of type, when used as temporary pavement marking due to obliteration of existing markings as defined in MODOT Sec 620.10.1.2.
  - NOTE: contractor shall, at the contractor’s expense, provide and maintain temporary pavement marking. Temporary pavement marking shall be placed in accordance with MODOT standard plan 620.10G (attached to this addendum for convenience). Temporary pavement marking paint shall not be used on final surface, removable temporary tape or temporary raised pavement markers are acceptable.

The following items have been amended for the Project Specifications:

- **Bidder shall replace pages 78 through 81 of 252 with the attached addendum No. 1 pages 78 through 81 of 252.**

The following pages have been amended for the itemized bid form:

- **Bidder shall replace pages 12 through 14 of 252 with the attached addendum No. 1 Revised Bid Form pages 12 through 14 of 252.**

The following plan sheets have been amended:

- **Quantity sheets 1 through 4 shall be replaced with the attached addendum No. 1 quantity sheets 1 through 4**

Attachments:

- Revised Itemized Bid Form Pages 12-14 of 252
- Revised Specification Pages 78-81 of 252
- Plan Sheets Quantity Sheets 1-4
- MODOT Standard Plan Sheets 620.10G

Please ensure your bids comply with this addendum, as noted in the forms accompanying this notice.

**END OF ADDENDUM**

ADDENDUM NO 1 - REVISED BID FORM

Project:		Mexico Road Resurfacing			
Federal Project No:		STP 4950(603)			
BID TABULATION					
ITEM NO.	DESCRIPTION	QUANTITY	UNIT	UNIT COST	COST
<b>ROADWAY</b>					
10	2022010	REMOVAL OF IMPROVEMENTS	1	L.S.	
20	2031000	CLASS A EXCAVATION	71	C.Y.	
30	2035500	EMBANKMENT IN PLACE	10	C.Y.	
40	2036000	COMPACTING EMBANKMENT	55	C.Y.	
50	2072000	LINEAR GRADING CLASS 2	4.8	STA.	
60	2079903	MISC. {LINEAR GRADING FOR ADA FACILITIES}	1986	L.F.	
70	3049905	MISC. {MODIFIED TYPE 5 AGGREGATE BASE (4-IN THICK)}	1393.3	S.Y.	
71	3049905	MISC. {MODIFIED TYPE 5 AGGREGATE BASE (5-IN THICK)}	1502.4	S.Y.	
80	4030011	ASPHALTIC CONCRETE MIXTURE PG 70-22 (SP095CLP MIX)	5747.1	TON	
90	4071005	TACK COAT	7210	GAL	
100	5021308	"CONCRETE PAVEMENT (8 IN. NON-REINFORCED, 15 FT. JOINTS)"	64.7	S.Y.	
110	6042010	ADJUSTING MANHOLE	3	EACH	
130	6083006	6 IN. CONCRETE MEDIAN STRIP	54.2	S.Y.	
140	6085008	"PAVED APPROACH, 8 IN."	1437.7	S.Y.	
150	6091052	CURB AND GUTTER TYPE B	296	L.F.	
160	6113020	FURNISHING TYPE 2 ROCK BLANKET	76	C.Y.	
170	6113040	PLACING TYPE 2 ROCK BLANKET	76	C.Y.	
180	6123000A	TRUCK OR TRAILER MOUNTED ATTENUATOR (TMA)	2	EACH	
190	6131010	FURNISHING AND PLACING CONCRETE MATERIAL FOR FULL DEPTH PAVEMENT REPAIR	240	S.Y.	
200	6131012	SUBGRADE COMPACTION (6 IN. DEPTH) (PAVEMENT REPAIR)	24	S.Y.	
210	6131014	FULL DEPTH PAVEMENT REPAIR SAW CUT (FOR PERIMETER AND INTERNAL SAW CUTS)	1080	L.F.	
220	6131015	"DOWEL BAR (DRILLING, FURNISHING AND INSTALLATION) FOR FULL DEPTH PAVEMENT REPAIR"	600	EACH	
230	6131018	"TIE BAR (DRILLING, FURNISHING AND INSTALLATION) FOR FULL DEPTH PAVEMENT REPAIR (TYPE L JOINTS)"	24	EACH	
240	6139905	MISC. {MODIFIED TYPE 5 AGGREGATE FOR BASE (5-IN THICK) (PAVEMENT REPAIR)}	24	S.Y.	
250	6161005	CONSTRUCTION SIGNS	1678	S.F.	
260	6161008	ADVANCED WARNING RAIL SYSTEM	18	EACH	
270	6161009	FLAG ASSEMBLY	12	EACH	
280	6161025	CHANNELIZER (TRIM LINE)	300	EACH	
290	6161030	TYPE III MOVEABLE BARRICADE	17	EACH	
300	6161033	DIRECTIONAL INDICATOR BARRICADE	40	EACH	
310	6161040	FLASHING ARROW PANEL	2	EACH	
320	6161098A	"CHANGEABLE MESSAGE SIGN WITHOUT COMMUNICATION INTERFACE, CONTRACTOR FURNISHED, CONTRACTOR RETAINED"	4	EACH	
330	6169902	MISC. {ADA COMPLIANT TYPE III MOVABLE BARRICADE}	25	EACH	
340	6181000	MOBILIZATION	1	L.S.	
350	6191000	PAVEMENT EDGE TREATMENT	939	L.F.	
360	6221001	COLDMILLING BITUMINOUS PAVEMENT FOR REMOVAL OF SURFACING (3 IN. THICK OR LESS)	72102	S.Y.	
370	6240101A	SUBSURFACE DRAINAGE GEOTEXTILE	114	S.Y.	
380	6274000	CONTRACTOR FURNISHED SURVEYING AND STAKING	1	L.S.	
390	8031000A	TURF TYPE TALL FESCUE SODDING	1363	S.Y.	
400	8059919	MISC. {SEEDING - STREAM MIX}	0.1	ACRE	
410	8061005	ROCK DITCH CHECK	241	L.F.	
420	8061007A	CURB INLET CHECK	67	EACH	
430	8061016	SEDIMENT REMOVAL	108	C.Y.	
440	8061017	TEMPORARY SEEDING AND MULCHING	0.4	ACRE	

ADDENDUM NO 1 - REVISED BID FORM

450	8061019	SILT FENCE	2977	L.F.		
<b>ROADWAY SUBTOTAL:</b>						
<b>SIGNALS</b>						
460	9020811	"SIGNAL HEAD, TYPE 1S, PEDESTRIAN"	20	EACH		
470	9020833	SH-FLAT SHEET - SIGNAL SIGN	22	S.F.		
480	9020834	"SIGNAL SIGN, MOUNTING HARDWARE"	24	EACH		
490	9022708	"POST, SIGNAL 8 FT. OR 2.4 M"	3	EACH		
500	9024975	VIDEO DETECTION SYSTEM	1	EACH		
510	9025300	"CONDUIT, 3 IN., TRENCH WITH TRACER WIRE"	317	L.F.		
520	9027300	"CONDUIT, 3 IN., PUSHED WITH TRACER WIRE"	46	L.F.		
530	9028308	"CABLE, 16 AWG 2 CONDUCTOR"	2770	L.F.		
540	9028310	"CABLE, 16 AWG 5 CONDUCTOR"	330	L.F.		
550	9028811	"PULL BOX, PREFORMED CLASS 2"	1	EACH		
560	9029100	"BASE, CONCRETE"	1.3	C.Y.		
570	9029902	MISC. {REMOTE PUSHBUTTON POST}	16	EACH		
580	9029902	MISC. {PUSH BUTTON EXTENSION}	3	EACH		
590	9029902	MISC. {AUDIBLE PEDESTRIAN PUSHBUTTON AND SIGNING}	24	EACH		
<b>SIGNAL SUBTOTAL:</b>						
<b>SIGNING</b>						
600	9031010	"CONCRETE FOOTINGS, EMBEDDED"	0.9	C.Y.		
610	9031220	PIPE POSTS	420	LBS		
620	9031280	2.5 IN. PSST POST - 12 GA.	24	L.F.		
630	9031281	POST ANCHOR FOR 2.5 IN. PSST - 7 GA.	6	L.F.		
640	9035004A	SH-FLAT SHEET	58	S.F.		
<b>SIGNING SUBTOTAL:</b>						
<b>PAVEMENT MARKING</b>						
650	6200009	"PREFORMED THERMOPLASTIC PAVEMENT MARKING, 6 IN. WHITE"	1662	L.F.		
660	6200015	"PREFORMED THERMOPLASTIC PAVEMENT MARKING, 24 IN. WHITE"	707	L.F.		
670	6200021	"PREFORMED THERMOPLASTIC PAVEMENT MARKING, LEFT/RIGHT ARROW"	66	EACH		
680	6200027	"PREFORMED THERMOPLASTIC PAVEMENT MARKING, COMBINATION STR/LT/RT"	2	EACH		
690	6200036	"PREFORMED THERMOPLASTIC PAVEMENT MARKING, 30 IN WHITE MIDBLOCK"	131	EACH		
700	6200042	"PREFORMED THERMOPLASTIC PAVEMENT MARKING, 12 IN WHITE, YIELD LINE TRIANGLES"	25	EACH		
710	6205901A	"4 IN. YELLOW HIGH BUILD WATERBORNE PAVEMENT MARKING PAINT, TYPE L BEADS"	26794	L.F.		
720	6205902A	"6 IN. WHITE HIGH BUILD WATERBORNE PAVEMENT MARKING PAINT, TYPE L BEADS"	9060	L.F.		
730	<del>6208063</del>	<del>TEMPORARY PAVEMENT MARKING</del>	0	<del>EACH</del>		
740	<del>6208076</del>	<del>4 IN TEMPORARY PAVEMENT MARKING PAINT</del>	0	<del>L.F.</del>		
<b>PAVEMENT MARKING SUBTOTAL:</b>						
<b>PEDESTRIAN FACILITIES</b>						
750	6081010	CONCRETE CURB RAMP	816.8	S.Y.		
760	6081012	TRUNCATED DOMES	911	S.F.		
770	6086004	"CONCRETE SIDEWALK, 4 IN."	544	S.Y.		
<b>PEDESTRIAN FACILITIES SUBTOTAL:</b>						
<b>BRIDGE</b>						
780	2061000	CLASS 1 EXCAVATION	30	C.Y.		
790	5031011A	BRIDGE APPROACH SLAB	27	S.Y.		
800	6071066	(72 IN.) PEDESTRIAN FENCE (STRUCTURES)	44	L.F.		
810	7021212	GALVANIZED STRUCTURAL STEEL PILES (12 IN)	168	L.F.		
820	7027000	PILE POINT REINFORCEMENT	6	EACH		
830	7032003	CLASS B CONCRETE (SUBSTRUCTURE)	28.6	C.Y.		
840	7034212	SLAB ON STEEL	213	S.Y.		

ADDENDUM NO 1 - REVISED BID FORM

850	7101000	REINFORCING STEEL (EPOXY COATED)	5740	LBS	
860	7129902	ANCHOR BOLTS	8	EACH	
870	7151001	VERTICAL DRAIN AT END BENTS	2	EACH	
880	7189902	PEDESTRIAN TRUSS SUPERSTRUCTURE	1	EACH	
<b>BRIDGE SUBTOTAL:</b>					

**GRAND TOTAL:**

**GRAND TOTAL WRITTEN IN WORDS:**

<b>GRAND TOTAL WRITTEN IN WORDS:</b>
--------------------------------------

BIDDER Company Name	
BIDDER Contact Person Name	
Address	
City/State/Zip	
Phone Number	
Email Address	

1. BIDDER has examined and carefully studied the Bidding Documents, the other related data identified in the Bidding Documents and the following Addenda receipt of all which is hereby acknowledged.

No. \_\_\_\_\_ Dated \_\_\_\_\_

No. \_\_\_\_\_ Dated \_\_\_\_\_

No. \_\_\_\_\_ Dated \_\_\_\_\_

**ACCEPTANCE FOR PROVISION FOR ASPHALT CEMENT PRICE INDEX, SEAL COAT PRICE INDEX, UNDERSEAL PRICE INDEX OR UBAWS MEMBRANE PRICE INDEX:** Bidders have the option to accept the provision for Asphalt Cement Price Index, Seal Coat Price Index, Underseal Price Index and/or UBAWS Membrane Price Index in accordance with the General Provisions. The bidder must mark each box below if they choose to accept the provision. The Asphalt Cement Provision applies only to projects that have a quantity of asphalt wet ton mix pay items or converted square yard quantity over 1,000 tons, the Seal Coat Provision applies only to projects that have a quantity that exceeds 50,000 square yards, the Underseal Provision applies only to any projects that have a quantity that exceeds 10,000 gallons, and the UBAWS Membrane provision applies only to projects that have a quantity that exceeds 5,000 square yards. The above quantity limits apply to an individual project or any number of projects in the contract combination.

Asphalt Cement     
  Seal Coat     
  Underseal     
  UBAWS Membrane

local police and governmental authorities will be damaged in various ways, including but not limited to, increased construction administration cost, potential liability, traffic and traffic flow regulation cost, traffic congestion and motorist delay, with its resulting cost to the traveling public. These damages are not reasonably capable of being computed or quantified. Therefore, the contractor will be charged with liquidated damages specified in the amount of **\$500 per day per entrance for each full day** that the entrance is not fully complete and open to traffic, in excess of the limitation as specified elsewhere in this special provision. It shall be the responsibility of the engineer to determine the quantity of excess closure time.

**1.1** The said liquidated damages specified will be assessed regardless if whether it would otherwise be charged as liquidated damages under the Missouri Standard Specification for Highway Construction.

J. Miscellaneous Construction Requirements

ADDENDUM #1

**1.0 Base.** All subbase shall conform to a modified MoDOT Type 5 base (minimum five inches thick under pavement and four inches under sidewalk). The modified MoDOT Type 5 rock shall meet all the requirements of MoDOT Type 5 base and is required to have no more than ten percent (10%) fines passing a no. 200 sieve.

**2.0 Clearing and Grubbing.** No direct pay shall be made for any clearing or grubbing required to construct this project. This shall include any tree and brush clearing and grubbing under the new pedestrian bridge, and approximately 10 feet beyond the extreme edges of the new pedestrian bridge. All trees and brush between the new pedestrian bridge and the existing roadway shall be cleared and grubbed. No trees shall be removed within the temporary construction easement without written permission from the USACOE.

**3.0 Field Verification.** Plan details for this contract work are based upon available plans, utility maps, and field surveys performed in conjunction with plan preparation for this proposed work. No warranty is made on either the accuracy or completeness of these available documents. It is the contractor's (bidder's) responsibility to assess the actual field conditions and verify the location of all utilities and verify whichever dimensions are required for the performance of the work. In addition, the contractor shall be matching existing cross slopes (unless otherwise noted in the plans) and is responsible for adjusting actual propose drainage structures, if necessary, from those shown in the construction documents. No direct payment shall be made for any expense incurred by the contractor for his/her compliance with this provision.

**4.0 Hauling over Streets.** Streets over which hauling is performed shall be kept reasonably clean of spillers or tracked-on materials at all times and shall be thoroughly cleaned of such materials daily, within one hour after the suspension of hauling operations if said street is used by the traveling public. The contractor must be aware that emergency vehicles may be required to pass during hauling operations and the contractor shall be in a position to allow passage of such emergency vehicles. No direct payment shall be made for any expense incurred by the contractor for his/her compliance with this provision.

**5.0** All materials, time, equipment and labor required to comply with this special provision

shall be considered completely covered by the bid items provided in the contract.

K. Parcel No. 12 - HD Development of Maryland, Inc

**1.0 Description.** The work required within the temporary construction easement of Parcel No. 12 - HD Development of Maryland, Inc shall comply with the following:

**1.1** The contractor shall be required to name HD Development of Maryland, Inc. as an additional insured on all insurance policies required for project. Certified copies of the contractor's insurance shall be submitted to the City prior to the start of work.

**1.2** Per the U.S. Army Corps of Engineers' determination (MVS-2018-719) and as described in Deed Book 2252 and Page 1585, this temporary construction easement falls within a Stream/Wetland Mitigation area and conservation easement. The City and the contractor's use of this temporary construction easement shall have the following requirements:

- No trees shall be removed without written permission from the USACOE.
- Any disturbance shall be re-vegetated upon project completion.

**2.0** All materials, time, equipment and labor required to comply with this special provision shall be considered completely covered by the bid items provided in the contract.

L. Concrete Construction Requirements.

**1.0 Material Requirements.** All material for shall comply with the Sec 502, 503, 608, 609, 613, and 703 except as follows:

**ADDENDUM #1**

**1.1 Concrete Mix.** All concrete used for public infrastructure (streets, sidewalks, trails and curbs) within the jurisdiction of the City of O'Fallon shall be approved by the Eastern Missouri Pavement Consortium (EMPC). Acceptable mix designs may be found at <http://www.empcpavement.org/>. The contractor will need to create a free online account to view approved mix designs that will be required for concrete pavement for City streets.

**2.0 Construction Requirements.** All construction shall comply with the Sec 502, 503, 608, 609 and 613 except as follows:

**2.1 Mixing and Placement Limitations.** No concrete shall be mixed, placed or finished when the natural light is insufficient, unless an adequate and approved artificial lighting system is operated. Concreting operations shall not begin or continue:

- 1) During rain;
- 2) On any surface with standing water;
- 3) On any unstable subgrade or aggregate base;
- 4) When weather conditions prevent the proper handling or finishing of the mixture.

**2.2 Cold Weather.** The contractor shall provide a method, meeting the approval of the engineer, of monitoring the concrete that demonstrates that the concrete has been protected

from freezing. Regardless of precautions taken, the contractor shall assume all risks, and all frozen concrete shall be replaced at the contractor's expense. Cold weather is defined as period when the ambient air temperature has fallen to or is expected to fall below 40°F during the protection period (time required to produce the in-place compressive strength required). Concrete operations shall not continue:

- 1) During cold weather. Pouring operations will not begin until the ambient air temperature has reached 35°F and rising, with a predicted (National Weather Service) high temperature of 40°F or above and will be discontinued when the ambient air temperature in the shade falls below 35°F;
- 2) On or against any frozen surface;
- 3) On or against any pavement, reinforcement, forms or base material (to a depth of the thickness of the base material specified) that is at or below 35°F;
- 4) Unless authorized by the engineer during critical temperature periods (below 35°F); or
- 5) When the concrete temperature at the time of placement is less than that specified for the plan thickness as defined below:

<u>Least Dimension of Section (LD, inches)</u>	<u>Concrete Mixing and Placement Temperature, (°F)</u>			
	<u>Concrete Temperature at Time of Mixing</u>		<u>Concrete Temperature at the Time of Placement</u>	
	<u>Minimum</u>	<u>Maximum</u>	<u>Minimum</u>	<u>Maximum</u>
LD < 12	60	80	55	75
12 ≤ LD < 36	55	75	50	70
36 ≤ LD ≤ 72	50	70	45	65
LD > 72	45	65	40	60

Note: Seal concrete temperature at the time of placement shall be at least 60°F.

**2.2.1** If the engineer approval has been granted for the contractor to place the concrete while the ambient temperature is at or lower than 45°F, the producer shall take precautionary measures to prevent damage by freezing.

**3.0 Basis of Payment.** Payment for furnishing all labor, equipment, materials, labor, and tools necessary to place concrete shall be completely covered by the contract unit price for:

<u>Item No.</u>	<u>Description</u>	<u>Unit</u>
502-13.08	Concrete Pavement (8-IN Non-Reinforced, 15-ft Joints)	SY
608-30.06	6-IN Concrete Median Strip	SY



608-50.08	Paved Approach, 8-IN	SY
609-10.52	Curb and Gutter, Type B	LF
613-10.10	Furnishing and Placing Concrete Material for Full Depth Pavement Repair	SY
608-10.10	Concrete Curb Ramp	SY
608-60.04	Concrete Sidewalk, 4-IN	SY
503-10.11A	Bridge Approach Slab	SY
703-20.03	Class B Concrete (Substructure)	CY

ADDENDUM #1

M. Asphalt Construction Requirements.

**1.0 Material Requirements.** All material for shall comply with Sec 403 and 407 except as follows:

**2.0 Construction Requirements.** All construction shall comply with Sec 403 and 407 except as follows:

**2.1 Weather Limitations.** The asphaltic concrete shall not be placed:

- 1) When either the ambient temperature or the temperature of the surface on which the mixture is to be placed is below 50°F for the wedge or surfaces courses or below 40°F for base courses;
- 2) On any wet or frozen surfaces;
- 3) When weather conditions prevent the proper handling, compaction, or finishing of the mixture;
- 4) Between November 1<sup>st</sup> and March 1<sup>st</sup>, except when authorized by the engineer.

**3.0 Basis of Payment.** Payment for furnishing all labor, equipment, materials, labor, and tools necessary to resurfacing shall be completely covered by the contract unit price for:

<u>Item No.</u>	<u>Description</u>	<u>Unit</u>
403-00.11	Asphaltic Concrete Mixture PG 70-22 (SP095CLP Mix)	TON
407-10.05	Tack Coat	GAL

N. Removal of Improvements

**1.0 Description.** This work shall be in accordance with Section 202 of the *Standard Specifications*, except as herein modified.

This bid item shall include all labor, material, and equipment necessary to remove and dispose of the concrete, asphalt and aggregate pavement on roads and driveways, within the scope of the project. The removed pavements shall not be used for fill, unless allowed by the engineer. Otherwise, existing pavement disposal shall be disposed of in accordance with all applicable Federal, State and local laws.

**REMOVAL OF IMPROVEMENTS**

SHEET NO	STA	STA	LOC	ROADWAY	LF	SF	EACH	DESCRIPTIONS	REMARKS
4	0+00	9+30	LT	MEXICO RD	301			SAWCUT	
4	0+00	9+30	LT	MEXICO RD		657		SIDEWALK	
4	0+00	9+30	LT	MEXICO RD	54			CONCRETE CURB & GUTTER	
4	0+00	9+30	LT	MEXICO RD	113			CONCRETE CURB	
4	0+00	9+30	LT	MEXICO RD		1748		CONCRETE APPROACH	
5	9+30	10+45	LT&RT	MEXICO RD	207			SAWCUT	PAINTED PONY DR & GOVERNOR'S RUN CT
5	9+30	10+45	LT&RT	MEXICO RD	118			CONCRETE CURB	PAINTED PONY DR & GOVERNOR'S RUN CT
5	9+30	10+45	LT&RT	MEXICO RD		688		SIDEWALK	PAINTED PONY DR & GOVERNOR'S RUN CT
5	9+55	10+42	LT	MEXICO RD		1365		CONCRETE APPROACH	PAINTED PONY DR & GOVERNOR'S RUN CT
5	9+80		LT	MEXICO RD			1	STOP SIGN	PAINTED PONY DR & GOVERNOR'S RUN CT
6	19+75	30+30	LT&RT	MEXICO RD	204			SAWCUT	TURTLE CREEK DR & CROOKED STICK DR
6	23+74	24+41	LT&RT	MEXICO RD			8	8 PED HEADS, 8 PUSH BUTTONS & 8 PED SIGNS	TURTLE CREEK DR & CROOKED STICK DR
6	24+27	24+31	LT&RT	MEXICO RD		832		SIDEWALK	TURTLE CREEK DR & CROOKED STICK DR
6	24+27	24+31	LT&RT	MEXICO RD	139			CONCRETE CURB	TURTLE CREEK DR & CROOKED STICK DR
6	24+27	24+31	LT&RT	MEXICO RD		387		CONCRETE APPROACH	TURTLE CREEK DR & CROOKED STICK DR
7	30+30	40+75	RT	MEXICO RD	66			SAWCUT	NORWOOD HILLS DR
7	30+30	40+75	RT	MEXICO RD		450		SIDEWALK	NORWOOD HILLS DR
7	30+30	40+75	RT	MEXICO RD	37			CONCRETE CURB	NORWOOD HILLS DR
7	30+30	40+75	RT	MEXICO RD		98		CONCRETE APPROACH	NORWOOD HILLS DR
8	40+75	51+40	LT&RT	MEXICO RD	443			SAWCUT	
8	40+75	51+40	LT&RT	MEXICO RD		1150		SIDEWALK	
8	40+75	51+40	LT&RT	MEXICO RD	236			CONCRETE CURB	
8	40+75	51+40	LT&RT	MEXICO RD		3715		CONCRETE APPROACH	
9	51+40	62+00	LT&RT	MEXICO RD	203			SAWCUT	ROCK ELEMENTARY SCHOOL
9	51+40	62+00	LT&RT	MEXICO RD		809		SIDEWALK	ROCK ELEMENTARY SCHOOL
9	51+40	62+00	LT&RT	MEXICO RD	143			CONCRETE CURB	ROCK ELEMENTARY SCHOOL
9	51+40	62+00	LT&RT	MEXICO RD		387		CONCRETE APPROACH	ROCK ELEMENTARY SCHOOL
9	58+89	59+63	LT&RT	MEXICO RD			8	8 PED HEADS, 8 PUSH BUTTONS & 8 PED SIGNS	ROCK ELEMENTARY SCHOOL
10	66+74	67+64	LT	MEXICO RD	66			SAWCUT	PINEHURST VIEW DR
10	66+91	67+02	LT	MEXICO RD		281		SIDEWALK	PINEHURST VIEW DR
10	66+91	67+02	LT	MEXICO RD	41			CONCRETE CURB	PINEHURST VIEW DR
10	66+91	67+02	LT	MEXICO RD		117		CONCRETE APPROACH	PINEHURST VIEW DR
11	71+50	82+50	LT&RT	MEXICO RD	573			SAWCUT	
11	71+50	82+50	LT	MEXICO RD		1285		SIDEWALK	
11	71+50	82+50	LT&RT	MEXICO RD	270			CONCRETE CURB	
11	71+50	82+50	LT&RT	MEXICO RD		5967		CONCRETE APPROACH	
11	80+67		LT	MEXICO RD			1	STOP SIGN	
12	89+89	91+00	LT	MEXICO RD	164			SAWCUT	WINTERHAVEN DR
12	89+89	91+00	LT	MEXICO RD		220		SIDEWALK	WINTERHAVEN DR
12	89+89	91+00	LT	MEXICO RD	83			CONCRETE CURB	WINTERHAVEN DR
12	89+89	91+00	LT	MEXICO RD		1294		CONCRETE APPROACH	WINTERHAVEN DR
13	94+48	99+73	LT&RT	MEXICO RD	273			SAWCUT	
13	94+48	99+73	LT&RT	MEXICO RD		1264		SIDEWALK	
13	94+48	99+73	LT&RT	MEXICO RD	108			CONCRETE CURB	
13	94+48	99+73	LT&RT	MEXICO RD		286		CONCRETE APPROACH	
13	98+29		RT	MEXICO RD			1	YIELD SIGN	
13	98+38	99+32	RT	MEXICO RD		282		CONCRETE PAVEMENT	MEXICO LOOP
13	98+38	99+32	RT	MEXICO RD			4	TRUNCATED DOMES	MEXICO LOOP
13	98+38	98+38	RT	MEXICO RD		179		CONCRETE MEDIAN STRIP	MEXICO LOOP
13	98+40		RT	MEXICO RD			1	PUSH BUTTON POST	MEXICO LOOP
13	98+48		LT	MEXICO RD			1	PUSH BUTTON & PED SIGN	MEXICO LOOP
13	99+79		RT	MEXICO RD			1	YIELD SIGN	MEXICO LOOP
14	103+00	108+50	LT&RT	MEXICO RD	131			SAWCUT	SOUTH WOODLAWN AVE
14	103+00	108+50	LT&RT	MEXICO RD		1097		SIDEWALK	SOUTH WOODLAWN AVE
14	103+00	108+50	LT&RT	MEXICO RD	42			CONCRETE CURB & GUTTER	SOUTH WOODLAWN AVE
14			LT	MEXICO RD	55			CONCRETE CURB	SOUTH WOODLAWN AVE
14	106+08		RT	MEXICO RD			1	SIGNAL BASE & PED HEADS W/ PUSH BUTTONS & PED SIGNS	SOUTH WOODLAWN AVE
14	106+17		LT	MEXICO RD			1	SIGNAL BASE & PED HEADS W/ PUSH BUTTONS & PED SIGNS	SOUTH WOODLAWN AVE
various MEXICO RD					200			CURB AND GUTTER INCLUDING SAWCUTTING	

PAY TOTAL 1 LUMP SUM

MOBILIZATION	1 LUMP SUM
CONTRACTOR FURNISHED SURVEYING AND STAKING	1 LUMP SUM
TEMPORARY SEEDING AND MULCHING	0.4 ACRE
PERMANENT SEEDING/STREAM MIX	0.1 ACRE

1 REVISED

QUANTITY SHEET  
SHEET 1 OF 5

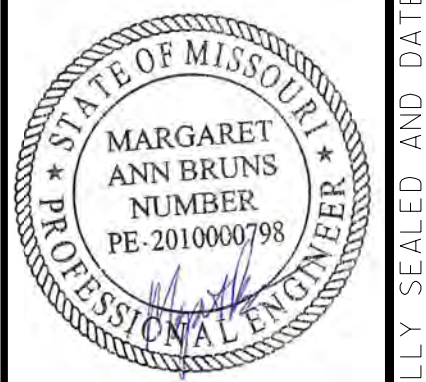

DATE PREPARED  
**2/12/2021**  
SHEET NO.  
**3**  
ROUTE  
**MEXICO ROAD**  
COUNTY  
**ST. CHARLES**  
PROJECT NO.  
**STP-4950(603)**  
CONTRACT ID.

BRIDGE NO.

DATE	DESCRIPTION
6/30/21	Addendum No. 1

Mexico Rd  
City of O'Fallon  
100 North Main Street  
O'Fallon, Missouri 63366

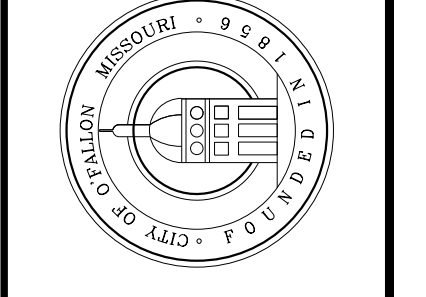

**EFK Moen**  
Civil Engineering Design  
13523 Barrett Parkway Dr Phone 314-394-3100  
Suite 250 St. Louis, MO 63021 Fax 314-394-3199  
Missouri Certificate of Authority: 001578

IF A SEAL IS PRESENT ON THIS SHEET IT HAS BEEN ELECTRONICALLY SEALED AND DATED.

PAVEMENT, COLDMILLING, AND RESURFACING										
SHEET NO	ROADWAY	STA	STA	LOC	AREA	ASPHALTIC CONCRETE MIXTURE	TACK COAT	COLDMILLING BIT PAVEMENT FOR REMOVAL OF SURFACING	REMARKS	
						PG70-22 (SP095CLP)		(3 IN. THICK OR LESS)		
					S.F.	TONS	GAL	S.Y.		
4	MEXICO RD	1+38	9+30	LT&RT	48,199.06	426.87	535.5	5355.5		
5	MEXICO RD	9+30	19+75	LT&RT	63,255.06	560.22	702.8	7028.3		
6	MEXICO RD	19+75	30+30	LT&RT	59,746.04	529.14	663.8	6638.4		
7	MEXICO RD	30+30	40+75	LT&RT	59,309.58	525.27	659.0	6590.0		
8	MEXICO RD	40+75	51+40	LT&RT	59,259.91	524.83	658.4	6584.4		
9	MEXICO RD	51+40	62+00	LT&RT	60,253.40	533.63	669.5	6694.8		
10	MEXICO RD	62+00	71+50	LT&RT	56,754.75	502.65	630.6	6306.1		
11	MEXICO RD	71+50	82+50	LT&RT	66,040.83	584.89	733.8	7337.9		
12	MEXICO RD	82+50	92+50	LT&RT	60,098.11	532.26	667.8	6677.6		
13	MEXICO RD	92+50	103+00	LT&RT	63,501.04	562.40	705.6	7055.7		
14	MEXICO RD	103+00	103+56	LT&RT	3,024.58	26.79	33.6	336.1		
14	MEXICO RD	106+00	108+50	LT&RT	15,797.85	139.91	175.5	1755.3		
15	MEXICO RD	108+50	113+34	LT&RT	33,672.73	298.22	374.1	3741.4		
SUBTOTALS						5,747.08	7210.0	72101.5		
PAY TOTALS						5,747.1	7210	72102		

ENTRANCES										
SHEET NO	ROADWAY	STA	STA	LOC	8-IN CONC. PAVED APPROACH	TYPE 5 AGG. BASE 5-IN THICK	LINEAR GRADING CLASS 2	REMARKS		
					AREA S.F.	S.Y.	S.Y.	STA		
4	MEXICO RD	3+18	5+65	LT	1,743.17	193.69	193.7	0.34		
5	MEXICO RD	9+55	10+42	LT&RT	1,324.95	147.22	147.2	0.48		
6	MEXICO RD	23+63	24+59	LT&RT	350.38	38.93	38.9	0.50		
7	MEXICO RD	31+20	31+79	RT	94.92	10.55	10.6	0.19		
8	MEXICO RD	42+34	43+48	LT&RT	2,781.18	309.02	309.0	0.46		
8	MEXICO RD	50+20	50+90	LT	893.56	99.28	99.3	0.23		
9	MEXICO RD	58+72	59+85	LT&RT	368.06	40.90	40.9	0.42		
10	MEXICO RD	66+83	67+49	LT	105.66	11.74	11.7	0.20		
11	MEXICO RD	73+54	74+55	LT	1,116.94	124.10	124.1	0.17		
11	MEXICO RD	77+58	78+57	RT	1,081.18	120.13	120.1	0.17		
11	MEXICO RD	80+38	81+45	LT&RT	1,414.40	157.16	157.2	0.42		
12	MEXICO RD	89+89	90+99	LT	1,280.45	142.27	142.3	0.20		
13	MEXICO RD	94+82	95+69	RT	142.49	15.83	15.8	0.32		
13	MEXICO RD	98+17	99+56	LT&RT	127.62	14.18	14.2	0.35		
14	MEXICO RD	105+97	106+38	LT	114.02	12.67	12.7	0.39		
SUBTOTALS						1,437.67	1437.7	4.84		
SUBTOTAL FROM ADA						-	64.7	-		
PAY TOTALS						1,437.7	1502.4	4.8		

1 REVISED

UTILITY ATG					
SHEET NO	ROADWAY	STA	LOC	ADJUST TO GRADE MANHOLE	REMARKS
				EA	
4	MEXICO RD	1+97	RT	1	
4	MEXICO RD	8+23	RT	1	
4	MEXICO RD	4+45	RT	1	
SUBTOTALS				3	
PAY TOTALS				3	

CONCRETE CURB						
SHEET NO	ROADWAY	STA	STA	LOC	TYPE B CONC. CURB & GUTTER	REMARKS
					L.F.	
4	MEXICO RD	3+09	5+78	LT	54.0	Ray Dr. & Dorie Dr.
14	MEXICO RD	103+62	103+79	RT	16.7	South side west of Belleau Creek
14	MEXICO RD	106+34	106+60	RT	25.1	South side east of Belleau Creek
VAR.	MEXICO RD	VAR.	VAR.	VAR.	200.0	Locations to be determined by the engineer
SUBTOTALS					295.8	
PAY TOTALS					296	

QUANTITY SHEET  
SHEET 2 OF 5



DATE PREPARED  
6/30/2021  
SHEET NO.  
3  
ROUTE  
MEXICO ROAD  
COUNTY  
ST. CHARLES  
PROJECT NO.  
STP-4950(603)  
CONTRACT ID.

BRIDGE NO.

DATE	DESCRIPTION	ADDENDUM NO.
6/30/21		1

Mexico Rd  
City of O'Fallon  
100 North Main Street  
O'Fallon, Missouri 63366

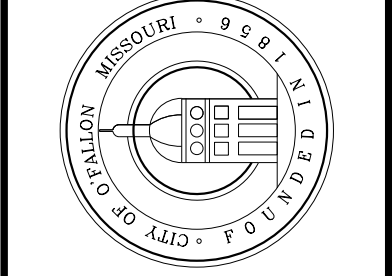

**EFK Moen**  
Civil Engineering Design  
13523 Barrett Parkway Dr  
Suite 250  
St. Louis, MO 63021  
Phone 314-394-3100  
Fax 314-394-3199  
Missouri Certificate of Authority: 001578



1 REVISED

PAVEMENT REPAIR

ROADWAY	LOC	FURNISHING & PLACING CONCRETE MATERIAL FOR FULL DEPTH PAVEMENT REPAIR	SUBGRADE COMPACTION (6-IN DEPTH) PAVEMENT REPAIR	MODIFIED TYPE 5 AGGREGATE FOR BASE (5-IN THICK) PAVEMENT REPAIR	FULL DEPTH PAVEMENT REPAIR SAW CUT	DOWEL BAR FOR FULL DEPTH PAVEMENT REPAIR	TIE BAR FOR FULL DEPTH PAVEMENT REPAIR	REMARKS
		S.Y.	S.Y.	S.Y.	L.F.	EA.	EA.	
MEXICO RD	AS DIRECTED BY ENGINEER	240.0	24	24	1080	600	24	ASSUME 30 - 6' X 12' PAVEMENT REPAIRS
	SUBTOTALS	240.0	24	24	1080	600	24	
	PAY TOTALS	240.0	24	24	1080	600	24	

EROSION CONTROL

EC SHEET NO.	ROADWAY	LOC	STA BEG.	STA END	SILT FENCE	CURB INLET CHECK	ROCK DITCH CHECK	SEDIMENT REMOVAL	TURF TYPE TALL FESCUE SODDING	REMARKS	
					L.F.	EA.	L.F.	C.Y.	S.Y.		
4	MEXICO RD	LT/RT	0+90	4+20	131.0	4		5.3	84.4		
4	MEXICO RD	LT/RT	4+20	5+93	150.5	2		3.5	75.7		
5	MEXICO RD	LT/RT	9+36	11+31	208.1	2		4.1	87.4		
5	MEXICO RD	LT/RT	15+24	19+25		5		5.0			
6	MEXICO RD	LT/RT	23+23	24+77	271.4	4		6.7	116.8		
6	MEXICO RD	LT/RT	25+89	28+03		4		4.0			
7	MEXICO RD	LT/RT	30+96	34+05	113.6	6		7.1	65.5		
8	MEXICO RD	LT/RT	41+73	43+58	255.9	2		4.6	153.4		
8	MEXICO RD	LT/RT	46+44	51+00	94.1	7		7.9	52.8		
9	MEXICO RD	LT/RT	57+99	60+04	237.4	3		5.4	111.4		
9	MEXICO RD	LT/RT	62+45	62+45		2		2.0			
10	MEXICO RD	LT/RT	66+70	71+50	110.3	2		3.1	43.7		
11	MEXICO RD	LT/RT	73+49	75+49	103.3	4		5.0	48.8		
11	MEXICO RD	LT/RT	77+47	81+52	357.1	4		7.6	154.0		
12	MEXICO RD	LT	84+38	84+48		2		2.0			
12	MEXICO RD	LT	89+84	91+02	109.6	2		3.1	66.6		
13	MEXICO RD	LT/RT	93+90	96+50	146.3	3		4.5	57.2		
13	MEXICO RD	LT/RT	97+91	101+86	236.0	5		7.4	102.1		
14	MEXICO RD	LT/RT	103+27	107+72	451.7	4	241	19.5	143.3		
					SUBTOTALS	2976.3	67	241	107.8	1363.1	
					PAY TOTALS	2977	67	241	108	1363	

PAVEMENT EDGE TREATMENT

SHEET NO	ROADWAY	STA	STA	LOC	PAVEMENT EDGE TREATMENT	REMARKS
					L.F.	
4	MEXICO RD	3+18	5+65	LT	155.7	
5	MEXICO RD	9+55	10+42	LT	87.4	
8	MEXICO RD	42+34	43+48	LT&RT	210.5	
8	MEXICO RD	50+20	50+90	LT	70.2	
11	MEXICO RD	73+54	74+55	LT	101.3	
11	MEXICO RD	77+58	78+57	RT	99.9	
11	MEXICO RD	80+38	81+45	LT	105.4	
12	MEXICO RD	89+89	90+99	LT	108.7	
					SUBTOTALS	939.1
					PAY TOTALS	939

EARTHWORK

XS SHEET NO	ROADWAY	LOC.	CLASS A EXCAVATION	FILL	COMPACTING EMBANKMENT	EMBANKMENT IN PLACE	REMARKS
			C.Y.	C.Y.	C.Y.	C.Y.	
1-2PED	BRIDGE APPROACHES		71	65			
			SUBTOTALS	71	65	55	10
			PAY TOTALS	71		55	10

NOTE: ASSUMING 15% SHRINKAGE

QUANTITY SHEET  
SHEET 3 OF 5

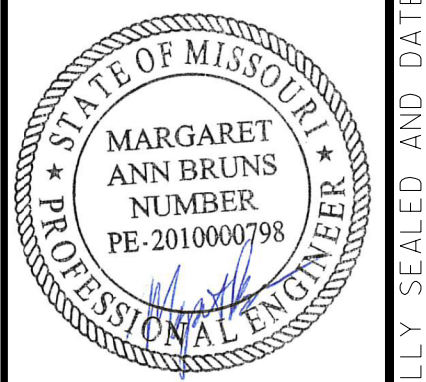

DATE PREPARED  
6/30/2021  
SHEET NO.  
3  
ROUTE  
MEXICO ROAD  
COUNTY  
ST. CHARLES  
PROJECT NO.  
STP-4950(603)  
CONTRACT ID.

BRIDGE NO.

DATE	DESCRIPTION
6/30/21	ADDENDUM NO. 1

Mexico Rd  
City of O'Fallon  
100 North Main Street  
O'Fallon, Missouri 63366

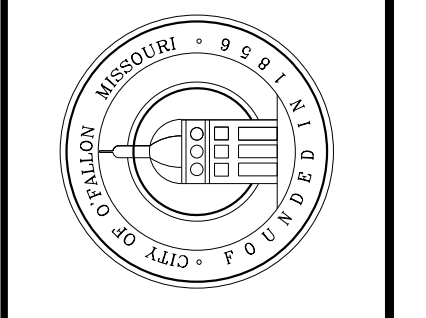

**EFK Moen**  
Civil Engineering Design  
13523 Barrett Parkway Dr  
Suite 250  
St. Louis, MO 63021  
Phone 314-394-3100  
Fax 314-394-3199  
Missouri Certificate of Authority: 001578

ADA FACILITIES

SHEET NO	ROADWAY	STA	STA	LOC	CONCRETE CURB RAMP	4-IN CONCRETE SIDEWALK	6-IN CONC. MEDIAN STRIP	8 IN CONC. PAVEMENT (NON-REINFORCED, 15 FT JOINTS)	MODIFIED TYPE 5 AGG. BASE 4-IN THICK	MODIFIED TYPE 5 AGG. BASE 5-IN THICK	TRUNCATED DOWNS	LINEAR GRADING FOR ADA	REMARKS
					S.Y.	S.Y.	S.Y.	S.Y.	S.Y.	S.Y.	S.F.	LF	
4	MEXICO RD	2+94	5+85	LT	58.84	19.48			78.3		111.3	175.7	
5	MEXICO RD	9+41	10+45	LT&RT	75.94	30.01	3.90		109.9		64.5	156.6	CURB RAMP UNDER MEDIAN STRIP
6	MEXICO RD	23+45	24+67	LT&RT	110.81	33.02	6.77		150.6		101.3	211.0	CURB RAMP UNDER MEDIAN STRIP
7	MEXICO RD	31+02	32+08	RT	48.93	15.96			64.9		39.5	94.1	
8	MEXICO RD	42+24	43+53	LT&RT	92.60	36.84			129.4		70.3	206.1	
8	MEXICO RD	50+15	50+95	LT	20.37	7.45			27.8		20.0	50.2	CURB RAMP UNDER MEDIAN STRIP
9	MEXICO RD	58+57	59+87	LT&RT	110.36	38.36	12.87		161.6		111.4	214.7	
10	MEXICO RD	66+74	67+64	LT	23.29	14.19			37.5		25.2	77.9	
11	MEXICO RD	73+59	74+47	LT	21.63	10.49			32.1		20.0	60.0	
11	MEXICO RD	77+52	78+62	RT	38.51	20.88			59.4		59.6	71.9	
11	MEXICO RD	80+35	81+44	LT&RT	49.27	40.25			89.5		66.2	142.7	
12	MEXICO RD	89+98	90+89	LT	25.18	11.24			36.4		20.0	61.3	
13	MEXICO RD	94+48	95+93	RT	43.26	34.83			78.1		57.4	98.7	
13	MEXICO RD	97+96	99+73	LT&RT	52.48	37.75	21.61	64.72	90.2	64.7	106.4	106.4	
14	MEXICO RD	103+34	107+06	LT&RT	45.37	193.22	9.01		247.6		38.1	258.2	
SUBTOTALS					816.84	543.97	54.16	64.72	1393.3	64.7	911.2	1985.5	
PAY TOTALS					816.8	544.0	54.2	64.7	1393.3	(1)	911	1986	

(1) SEE PAY TOTAL ON ENTRANCE TABLE

PAVEMENT MARKINGS

PVMT MARKING SHEET NO.	ROADWAY	STA	STA	HIGH BUILD WATERBORNE PAVEMENT MARKING PAINT				PERFORMED THERMOPLASTIC PAVEMENT MARKING					REMARKS	
				4-IN YELLOW TYPE L BEADS	6-IN WHITE TYPE L BEADS	6-IN WHITE CROSSWALK	12-IN WHITE YIELD TRIANGLE	24-IN WHITE STOP BAR	30-IN WHITE MIDBLOCK	LEFT/RIGHT ARROW	COMBINATION STR/LT/RT			
				L.F.	L.F.	L.F.	EA.	L.F.	EA.	EA.	EA.			
1	MEXICO RD	1+38	11+00	2197.0	973.2	414.5		63.7				8	1	
1	MEXICO RD	11+00	22+00	2684.3	610.7							9		
2	MEXICO RD	22+00	33+00	2941.2	844.0	88.1		133.3	38			5	1	
2	MEXICO RD	33+00	44+00	3291.6	790.7	225.2		41.2				3		
3	MEXICO RD	44+00	55+00	3030.3	632.9	62.9		12.7				1		
3	MEXICO RD	55+00	66+00	2701.3	879.2			123.8	44			6		
4	MEXICO RD	66+00	77+00	2235.9	826.6	312.5		54.7				10		
4	MEXICO RD	77+00	88+00	2351.2	725.6	319.6		55.3				6		
5	MEXICO RD	88+00	98+00	2050.5	685.9	239.1		42.1				5		
5	MEXICO RD	98+00	107+00	1876.3	1200.8		25	180.5	49			3		
6	MEXICO RD	107+00	113+35	1434.3	890.5							10		
SUBTOTAL				26793.9	9060.1	1661.9	25	707.3	131	66	2			
PAY TOTAL				26794	9060	1662	25	707	131	66	2			

TYPE 2 ROCK BLANKET, 2'-0" THICK

SHEET NO.	ROADWAY	STA	LOC	AREA	FURNISHING TYPE 2 ROCK BLANKET	PLACING TYPE 2 ROCK BLANKET	SUBSURFACE DRAINAGE GEOTEXTILE	REMARKS
				S.F.	C.Y.	C.Y.	S.Y.	
14	PED BRIDGE	11+36	RT	444	32.9	32.9	49.3	WEST ABUTMENT
14	PED BRIDGE	13+20	RT	583	43.2	43.2	64.8	EAST ABUTMENT
SUBTOTAL					76.1	76.1	114.1	
PAY TOTAL					76	76	114	

1 REVISED

1 DELETED

QUANTITY SHEET  
SHEET 4 OF 5



DATE PREPARED  
6/30/2021  
SHEET NO.  
3  
ROUTE  
MEXICO ROAD  
COUNTY  
ST. CHARLES  
PROJECT NO.  
STP-4950(603)  
CONTRACT ID.

BRIDGE NO.

DESCRIPTION	ADDENDUM NO.
	1

Mexico Rd  
City of O'Fallon  
100 North Main Street  
O'Fallon, Missouri 63366

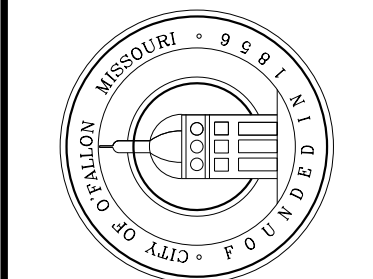

**EFK Moen**  
Civil Engineering Design  
13523 Barrett Parkway Dr  
Suite 250  
St. Louis, MO 63021  
Phone 314-394-3100  
Fax 314-394-3199  
Missouri Certificate of Authority: 001578

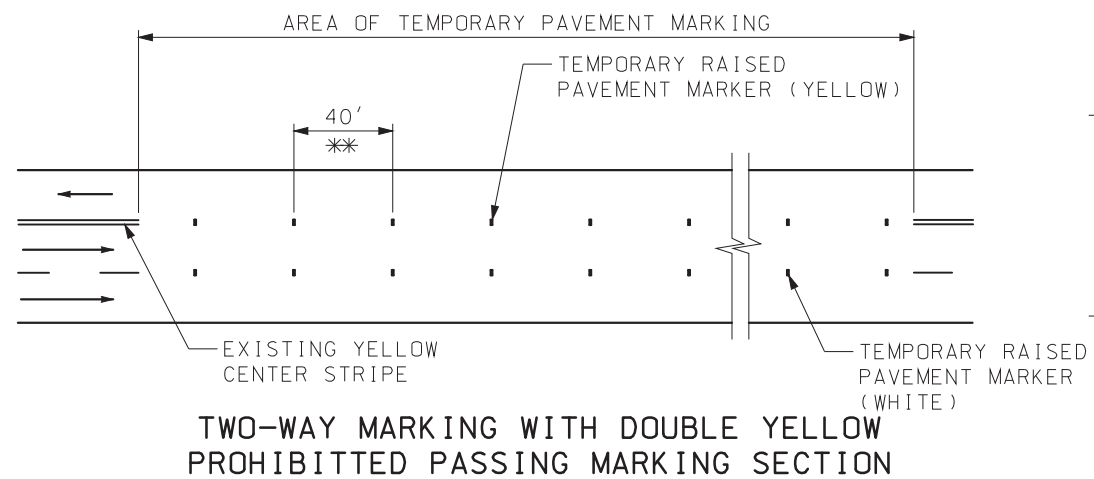

**TWO-WAY MARKING WITH DOUBLE YELLOW PROHIBITED PASSING MARKING SECTION**

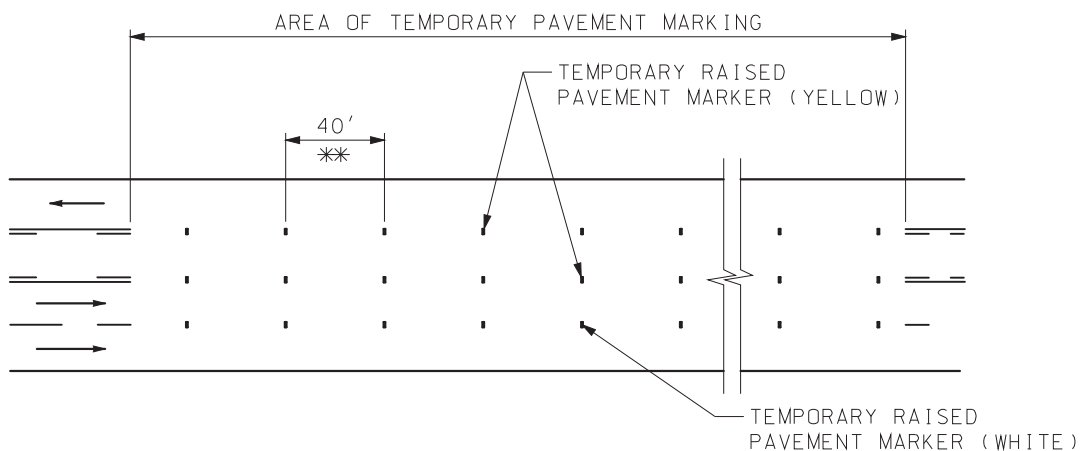

**TWO-WAY WITH LEFT-TURN LANE MARKING SECTION**

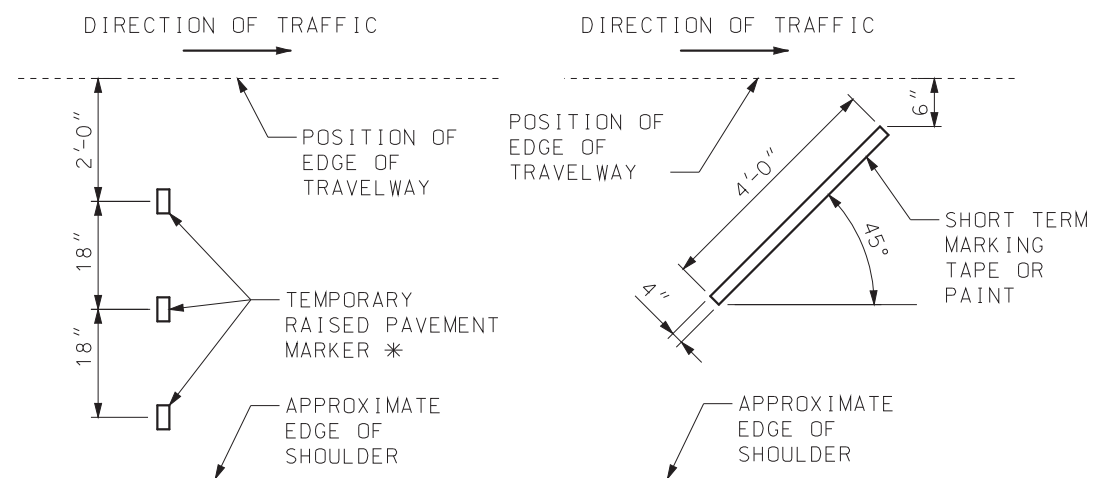

**DETAIL A**

\* THREE TEMPORARY RAISED PAVEMENT MARKERS SHALL BE USED IF SHOULDER IS 6' OR WIDER. OTHERWISE, USE TWO TEMPORARY RAISED PAVEMENT MARKERS.

**OPTIONAL DETAIL A FOR INTERMEDIATE LIFT**

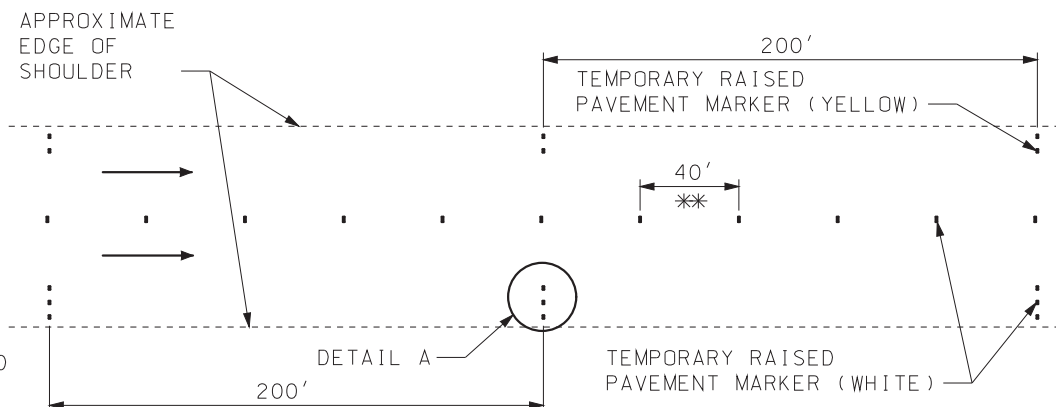

**EDGE LINES AND LANE LINES ON MULTILANE DIVIDED SECTIONS**

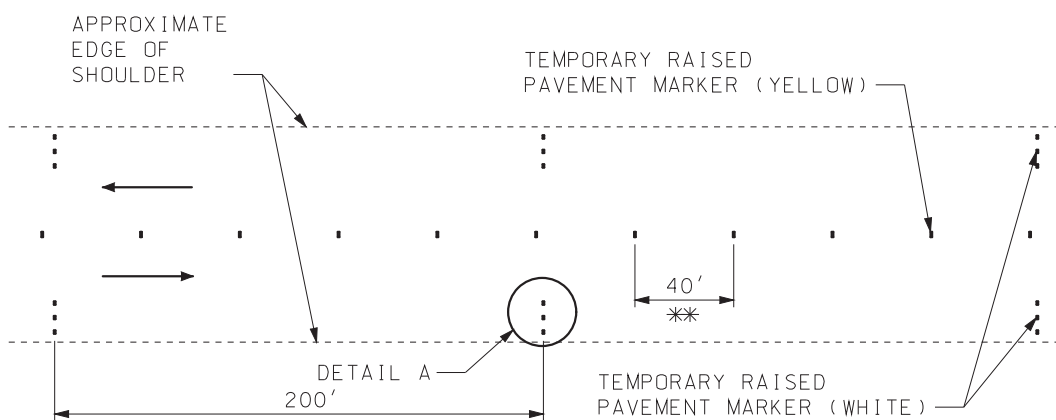

**EDGE LINES AND CENTERLINE ON TWO-WAY SECTIONS WITH PAVED SHOULDERS GREATER THAN 4 FEET WIDE**

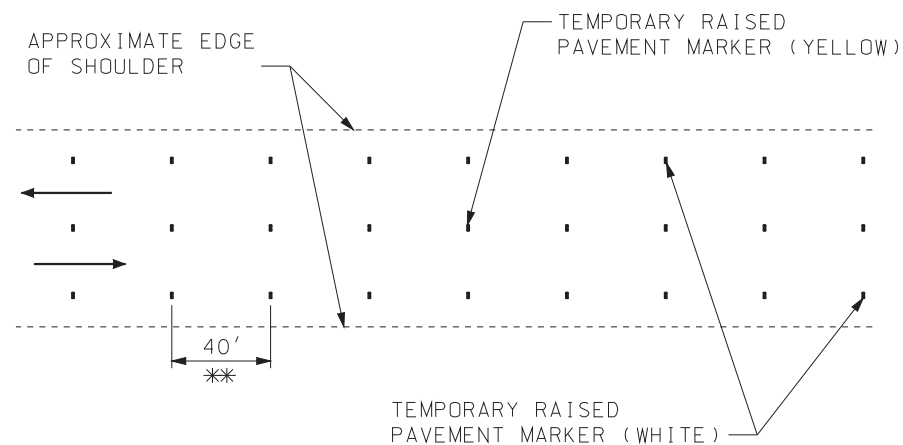

**EDGE LINES AND CENTERLINE ON TWO-WAY SECTIONS WITH PAVED SHOULDERS 4 FEET WIDE OR LESS, AGGREGATE OR EARTH SHOULDERS OR NO SHOULDERS**

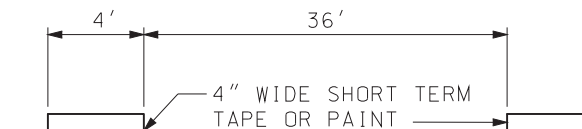

**\*\* OPTIONAL TEMPORARY PAVEMENT MARKING DETAIL FOR INTERMEDIATE LIFTS**

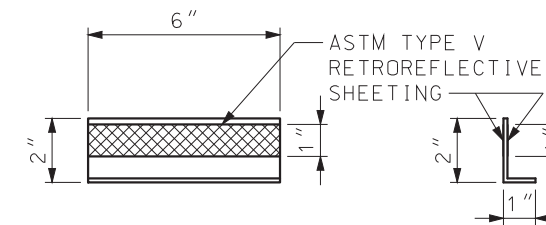

**ELEVATION SIDE TYPICAL TEMPORARY RAISED PAVEMENT MARKER DETAIL**

**GENERAL NOTES:**

TEMPORARY PAVEMENT MARKING IS REQUIRED WHEN 200 CONSECUTIVE LINEAR FEET OR MORE OF PERMANENT PAVEMENT MARKING HAS BEEN OBLITERATED, OR AS DIRECTED BY THE ENGINEER.

TEMPORARY RAISED PAVEMENT MARKERS (TRPMS), OR THE OPTIONAL 4"X 4' SHORT TERM TAPE OR PAINT, WHEN ALLOWED, SHALL BE MAINTAINED IN PLACE AND RETROREFLECTIVE UNTIL THE PERMANENT PAVEMENT MARKINGS ARE INSTALLED. MISSING OR NON-REFLECTIVE MARKINGS SHALL BE REPLACED AT NO ADDITIONAL COST TO THE COMMISSION WHEN 10% OR MORE ARE DEFICIENT WITHIN ONE MILE OR WHEN 4 OR MORE CONSECUTIVE MARKINGS ARE DEFICIENT.

FOR INTERMEDIATE LIFTS, 4"X 4' SHORT TERM TAPE OR TEMPORARY PAINT MAY BE USED IN LIEU OF TRPMS.

TRPMS USED ON INTERMEDIATE LIFTS SHALL BE REMOVED PRIOR TO PLACEMENT OF THE NEXT LIFT.

ALL TEMPORARY MARKINGS SHALL BE REMOVED BY THE CONTRACTOR AFTER INSTALLATION OF PERMANENT MARKINGS, EXCEPT WHEN PERMANENT MARKINGS ARE TO BE INSTALLED BY OTHERS.

TEMPORARY TAPE SHALL NOT BE USED FOR TEMPORARY MARKING ON THE FINAL SURFACE EXCEPT WHEN SPECIFIED IN THE PLANS.

**MoDOT MISSOURI HIGHWAYS AND TRANSPORTATION COMMISSION**  
 105 WEST CAPITOL  
 JEFFERSON CITY, MO 65102  
 1-888-ASK-MODOT (1-888-275-6636)

STATE OF MISSOURI  
 ERIC E. SCHROETER  
 NUMBER PE-28411  
 PROFESSIONAL ENGINEER  
 THIS SHEET HAS BEEN SIGNED SEALED AND DATED ELECTRONICALLY.

**TEMPORARY PAVEMENT MARKING  
 TEMPORARY PAVEMENT MARKING**

DATE EFFECTIVE: 07/01/2017	620.10G	SHEET NO. 1 OF 5
DATE PREPARED: 5/1/2017		

IF A SEAL IS PRESENT ON THIS SHEET IT HAS BEEN ELECTRONICALLY SEALED AND DATED.

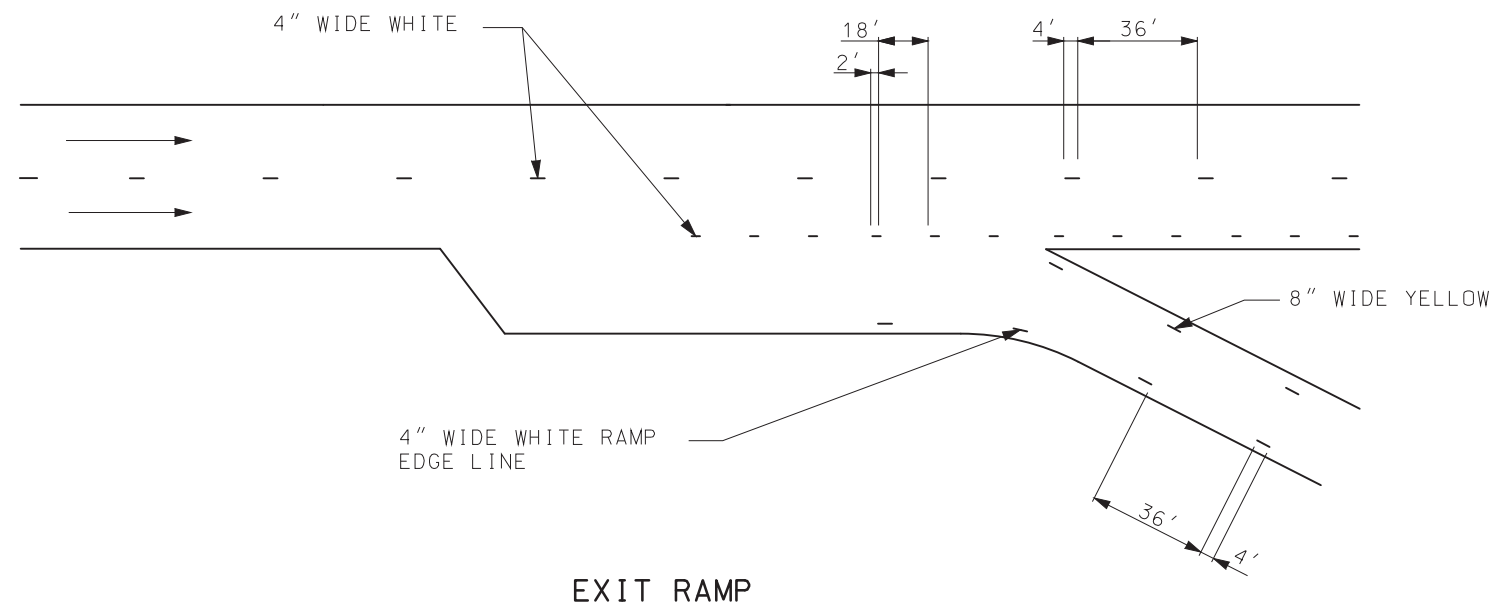
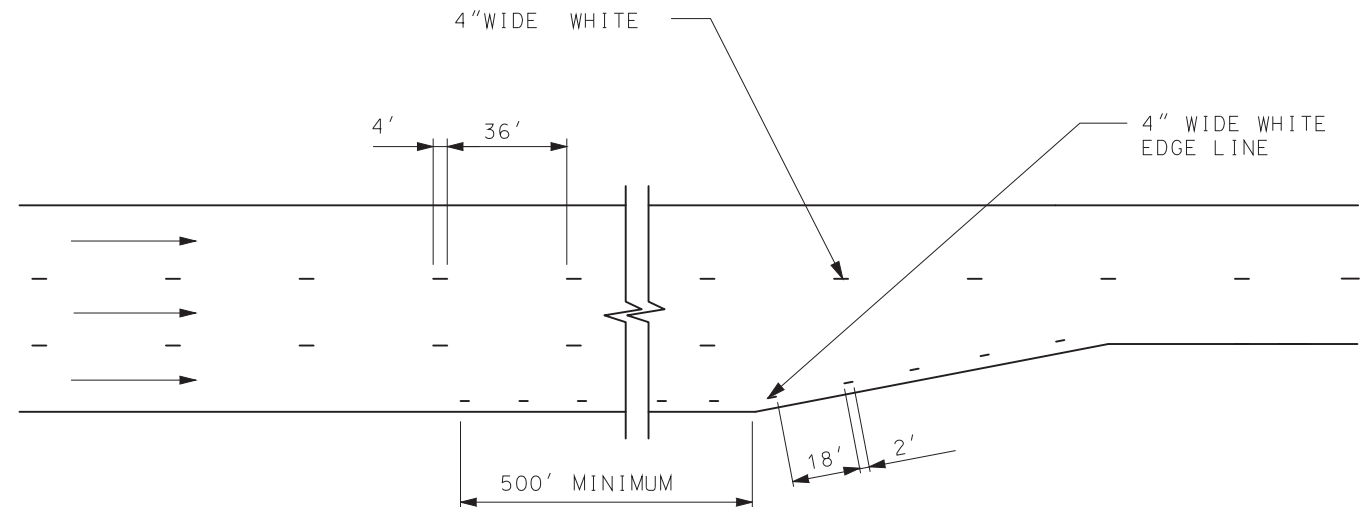
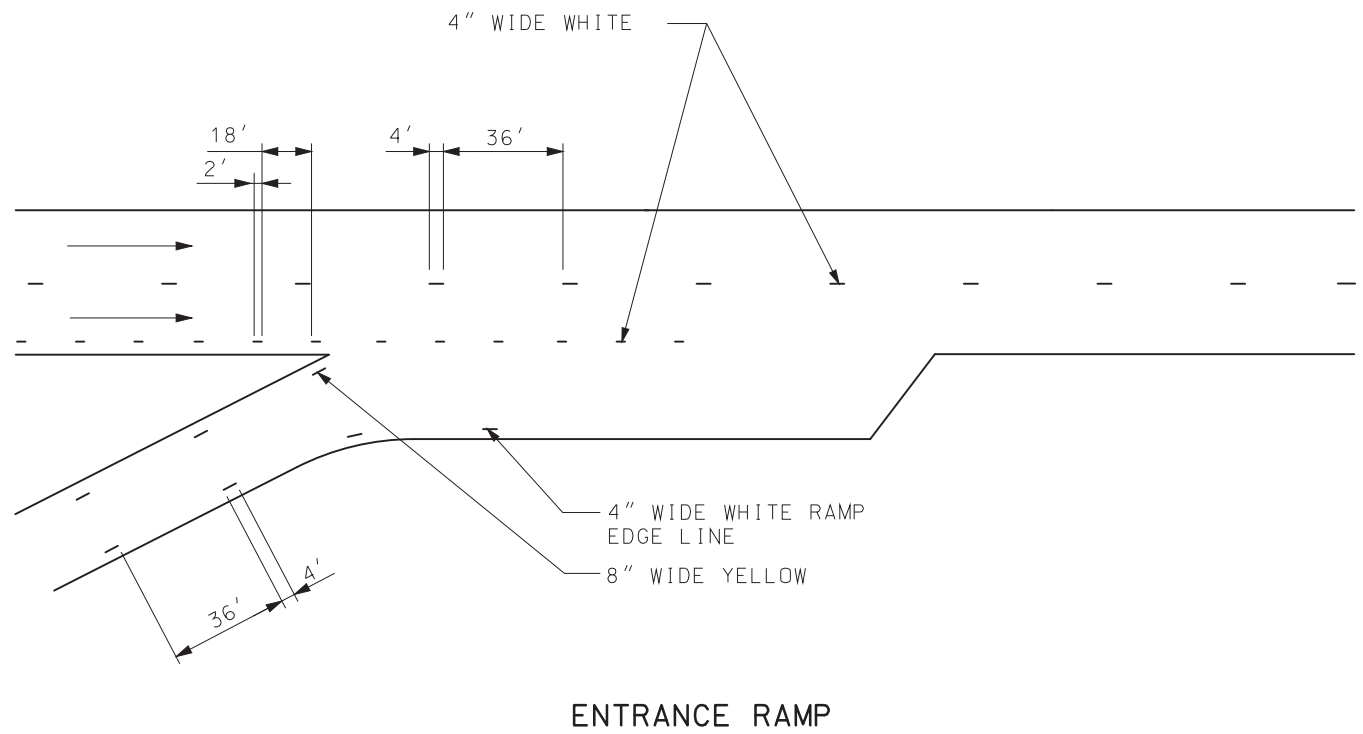

GENERAL NOTES:

TEMPORARY PAVEMENT MARKING IN INTERSECTIONS, RAMPS, GORES AND OTHER TRANSITION AREAS USE AN INTERMITTENT MARKING OF 2 FEET LONG AT A CYCLE OF 20 FEET.

LIMITS OF TEMPORARY GORE MARKING ARE THE SAME AS THE EXISTING GORE LINES.

**MoDOT** MISSOURI HIGHWAYS AND TRANSPORTATION COMMISSION  
 105 WEST CAPITOL  
 JEFFERSON CITY, MO 65102  
 1-888-ASK-MODOT (1-888-275-6636)

STATE OF MISSOURI  
 ERIC E. SCHROETER  
 NUMBER PE-28411  
 PROFESSIONAL ENGINEER  
 THIS SHEET HAS BEEN SIGNED, SEALED AND DATED ELECTRONICALLY.

TEMPORARY PAVEMENT MARKING  
 LANE TRANSITION AND RAMP AREAS

DATE EFFECTIVE: 07/01/2017  
 DATE PREPARED: 5/1/2017

620.10G

SHEET NO.  
 2 OF 5

IF A SEAL IS PRESENT ON THIS SHEET IT HAS BEEN ELECTRONICALLY SEALED AND DATED.



IF A SEAL IS PRESENT ON THIS SHEET IT HAS BEEN ELECTRONICALLY SEALED AND DATED.

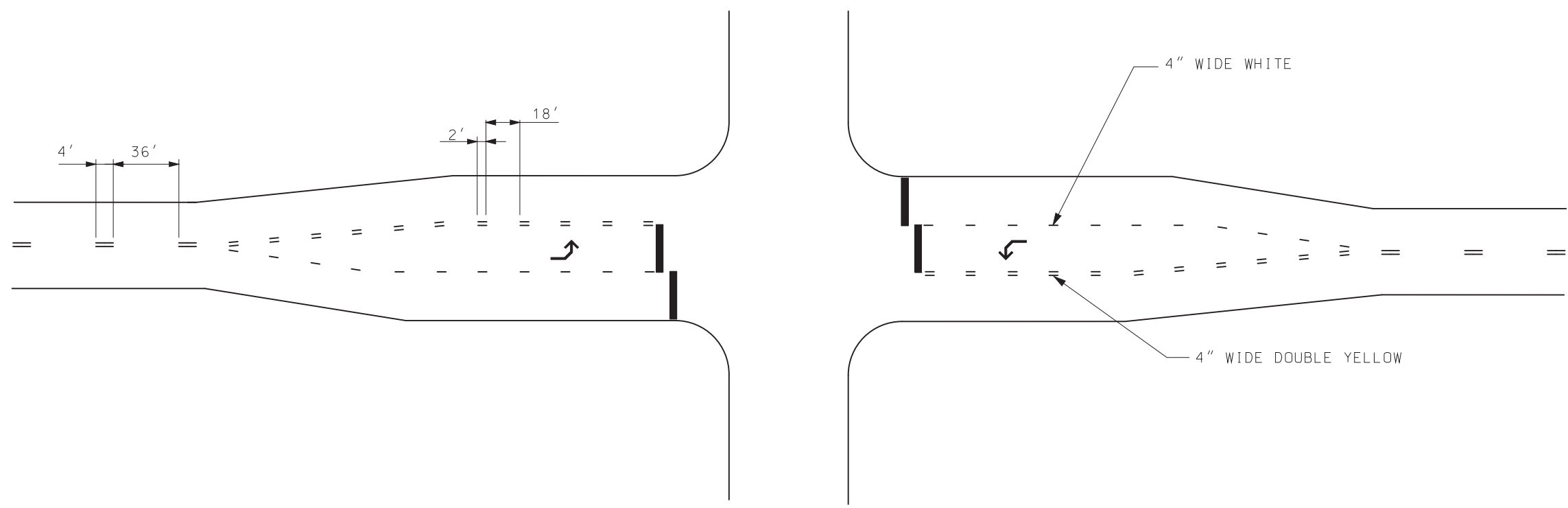

PLAN VIEW



TEMPORARY STOP BAR DETAIL (WHITE)

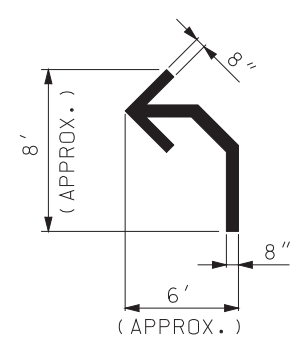

TEMPORARY ARROW DETAIL (WHITE)

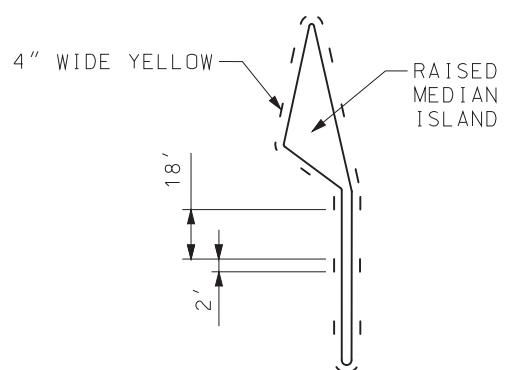

RAISED DIVISIONAL ISLAND

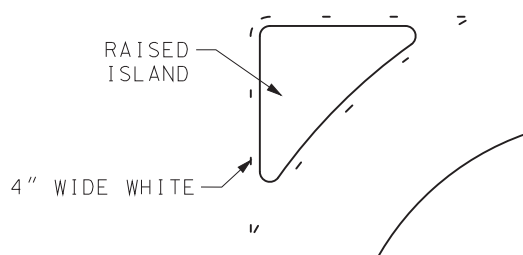

RAISED CHANNELIZING ISLAND

GENERAL NOTES:

TEMPORARY ARROWS AND STOP BARS ARE REQUIRED WHEN GOEMETRIC MODIFICATIONS DURING CONSTRUCTION CREATE LANE CONFIGURATIONS DIFFERENT THAN EXISTING, OR THE EXISTING PAVEMENT MARKING INCLUDES THEM.

YELLOW AND WHITE TEMPORARY MARKING AROUND ISLANDS ONLY REQUIRED WHEN THE ISLAND CURB IS NOT PAINTED.

TEMPORARY PAVEMENT MARKING IN INTERSECTIONS, RAMP GORES AND OTHER TRANSITION AREAS USE AN INTERMITTENT MARKING 2' LONG AT A CYCLE OF 20'.

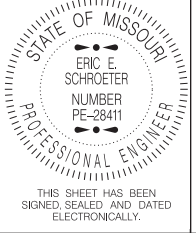
 <b>MISSOURI HIGHWAYS AND TRANSPORTATION COMMISSION</b> 105 WEST CAPITOL JEFFERSON CITY, MO 65102 1-888-ASK-MODOT (1-888-275-6636)	
 <p>STATE OF MISSOURI          ERIC E. SCHROETER          NUMBER PE-28411          PROFESSIONAL ENGINEER</p> <p><small>THIS SHEET HAS BEEN SIGNED, SEALED AND DATED ELECTRONICALLY.</small></p>	<p align="center"><b>TEMPORARY PAVEMENT MARKING INTERSECTIONS</b></p>
DATE EFFECTIVE: 07/01/2017 DATE PREPARED: 5/1/2017	620.10G
SHEET NO. 3 OF 5	



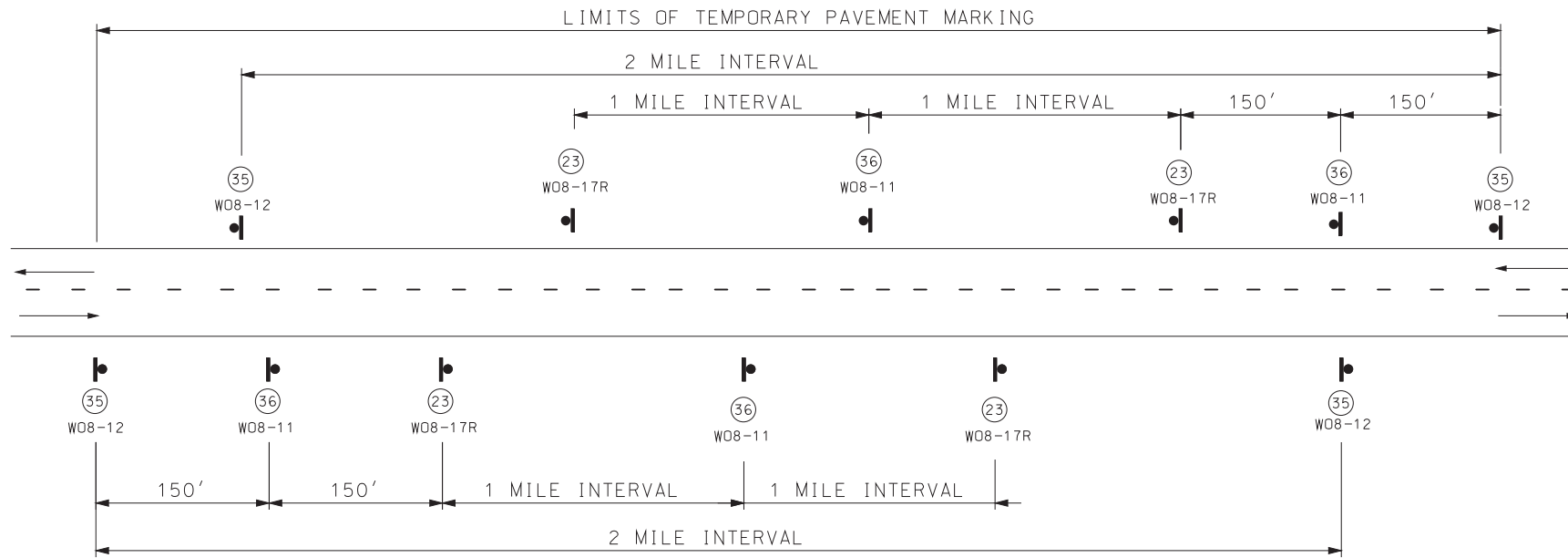

**SIGN SPACING FOR MAINLINE**

(DETAIL SHOWN IS BASED ON A PROJECT MEETING ALL CONDITIONS: NO CENTER STRIPE, UNEVEN LANES, SHOULDER DROP-OFF AND BUMP.)  
 WHEN BOTH UNEVEN LANES AND SHOULDER DROP-OFF SIGNS ARE USED, BOTH SIGNS SHALL STAY IN PLACE UNTIL BOTH CONDITIONS NO LONGER EXIST.  
 IF ONLY ONE CONDITION EXISTS (UNEVEN LANES OR SHOULDER DROP-OFF), THE SIGN SPACING SHALL BE AT 1 MILE INTERVALS.

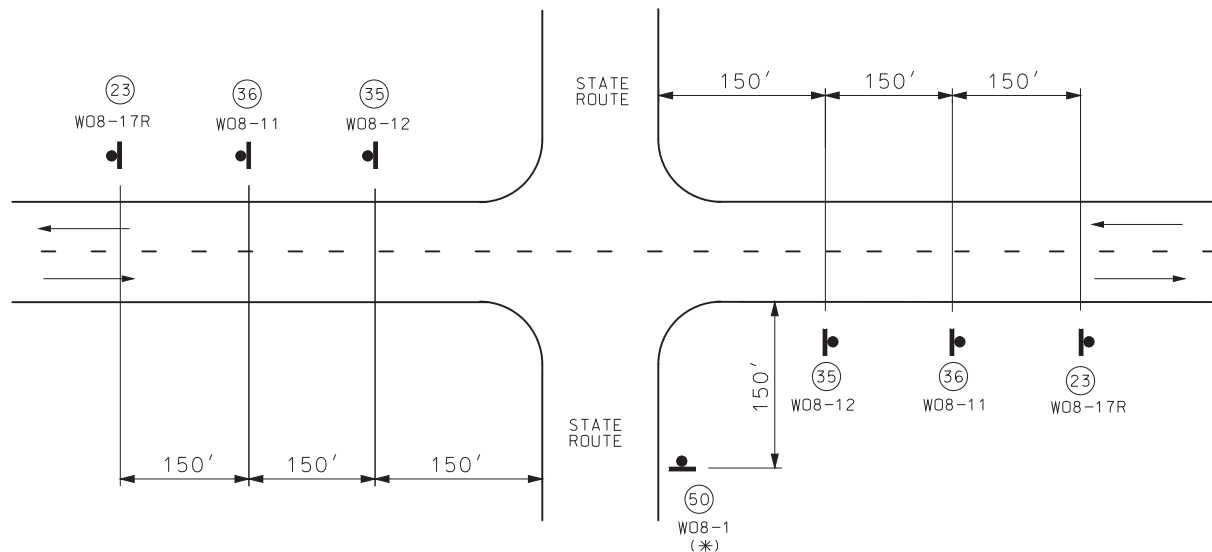

**SIGN SPACING AT STATE ROUTE INTERSECTIONS**

(\*) BUMP SIGN SHOULD BE IN ACCORDANCE WITH STANDARD PLAN 619.10.

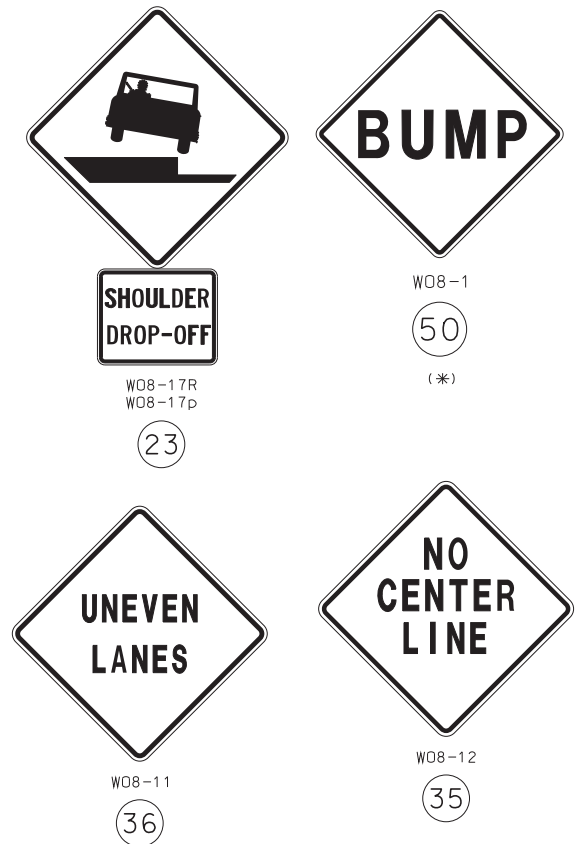

**GENERAL NOTES:**

FOR DETAILS OF TEMPORARY PAVEMENT MARKING, SEE SHEET 1 OF 5.

SIGN (35) AND TEMPORARY PAVEMENT MARKING INSTALLED WHERE CENTERLINE STRIPING HAS BEEN COVERED OR REMOVED. SIGNS ARE TO REMAIN IN PLACE UNTIL THE PERMANENT CENTERLINE PAVEMENT MARKINGS ARE IN PLACE. SIGNS SHALL BE COVERED OR REMOVED WHEN PAVEMENT CENTERLINE MARKING HAS BEEN INSTALLED.

SIGN (35) IS PLACED AT APPROXIMATELY TWO-MILE INTERVALS AND AT STATE ROUTE JUNCTIONS. WHEN THE INSTALLATION AT A JUNCTION IS WITHIN ONE-EIGHTH MILE OF THE NORMAL MAINLINE SIGN (35), THE LATTER MAY BE ELIMINATED.

ALL SIGNS SHALL BE POST MOUNTED AND IN ACCORDANCE WITH STANDARD PLAN 616.10 AND 903.03.

WHEN SHOULDER DROP-OFF SIGNS ARE IN PLACE FOR GREATER THAN THREE DAYS, THE SHOULDER DROP-OFF PLAQUE SHOULD BE USED IN ADDITION WITH THE SHOULDER DROP-OFF SIGN.

<p><b>MISSOURI HIGHWAYS AND TRANSPORTATION COMMISSION</b></p> <p>105 WEST CAPITOL JEFFERSON CITY, MO 65102 1-888-ASK-MODOT (1-888-275-6636)</p>	
<p>STATE OF MISSOURI ERIC E. SCHROETER NUMBER PE-28411 PROFESSIONAL ENGINEER</p> <p>THIS SHEET HAS BEEN SIGNED, SEALED AND DATED ELECTRONICALLY.</p>	<p><b>TEMPORARY PAVEMENT MARKING</b></p> <p><b>TWO-LANE TWO-WAY HIGHWAY</b></p>
<p>DATE EFFECTIVE: 07/01/2017</p> <p>DATE PREPARED: 5/1/2017</p>	<p>620.10G</p> <p>SHEET NO. 4 OF 5</p>

IF A SEAL IS PRESENT ON THIS SHEET IT HAS BEEN ELECTRONICALLY SEALED AND DATED.

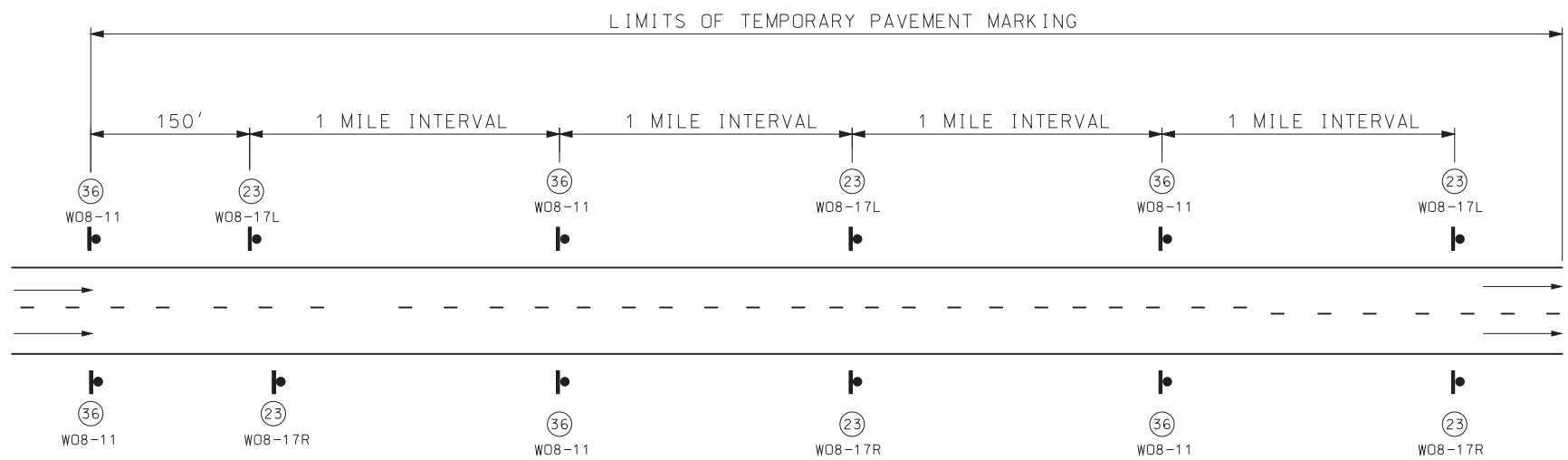

**SIGN SPACING FOR DIVIDED OR MULTI-LANE HIGHWAY**

(DETAIL SHOWN IS BASED ON A PROJECT MEETING CONDITIONS OF UNEVEN LANES AND SHOULDER DROP-OFF.)  
 WHEN BOTH UNEVEN LANES AND SHOULDER DROP-OFF SIGNS ARE USED, BOTH SIGNS SHALL STAY IN PLACE UNTIL BOTH CONDITIONS NO LONGER EXISTS.  
 WHEN ONLY ONE CONDITION EXISTS (UNEVEN LANES OR SHOULDER DROP-OFF), SIGN SPACING SHALL BE AT 1 MILE INTERVALS

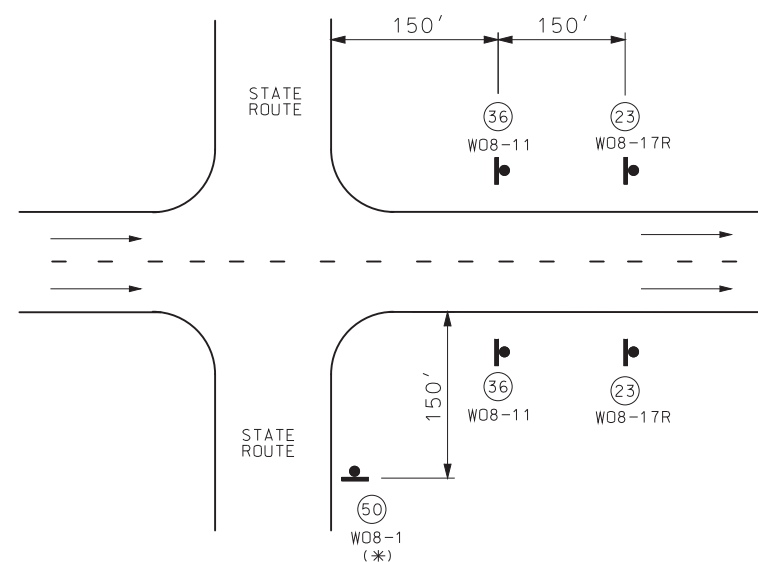
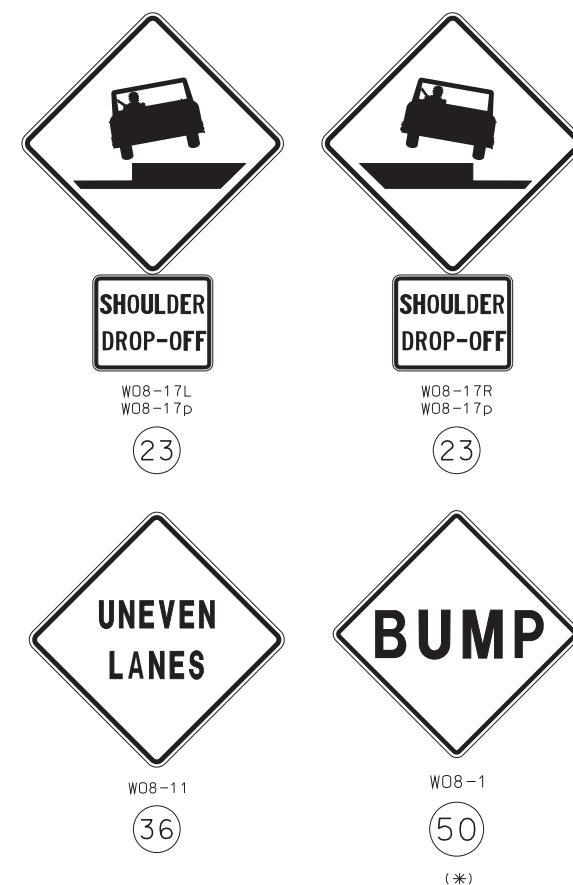

**SIGN SPACING AT STATE ROUTE INTERSECTIONS**

(\*) BUMP SIGN SHOULD BE IN ACCORDANCE WITH STANDARD PLAN 619.10.

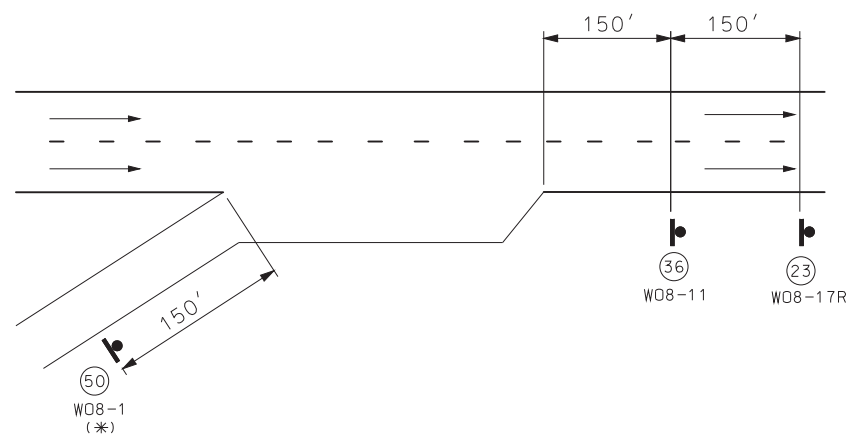

**SIGN SPACING AT RAMPS**

(\*) BUMP SIGN SHOULD BE IN ACCORDANCE WITH STANDARD PLAN 619.10.

**GENERAL NOTES:**

FOR DETAILS OF TEMPORARY PAVEMENT MARKING, SEE SHEET 1 OF 5.

ALL SIGNS SHALL BE POST MOUNTED AND IN ACCORDANCE WITH STANDARD PLANS 616.10 AND 903.03.

WHEN SHOULDER DROP-OFF SIGNS ARE IN PLACE FOR GREATER THAN THREE DAYS, THE SHOULDER DROP-OFF PLAQUE SHOULD BE USED IN ADDITION WITH THE SHOULDER DROP-OFF SIGN.

**MoDOT MISSOURI HIGHWAYS AND TRANSPORTATION COMMISSION**  
 105 WEST CAPITOL  
 JEFFERSON CITY, MO 65102  
 1-888-ASK-MODOT (1-888-275-6636)

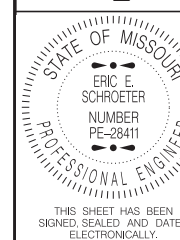

THIS SHEET HAS BEEN SIGNED, SEALED AND DATED ELECTRONICALLY.

**TEMPORARY PAVEMENT MARKING DIVIDED AND MULTI-LANE HIGHWAYS**

DATE EFFECTIVE: 07/01/2017	620.10G	SHEET NO. 5 OF 5
DATE PREPARED: 5/1/2017		

IF A SEAL IS PRESENT ON THIS SHEET IT HAS BEEN ELECTRONICALLY SEALED AND DATED.