Statement of Qualification

On-Call Structural Steel Fabrication Inspection Services

Date
01/08/2021

Project
MacArthur Bridge Broadway Truss

Send Statements of Qualifications to:
Terminal Railroad Association of St. Louis
1201 McKinley Ave.
Venice, IL 62090

Contact:
efields@terminalrailroad.com

RFP SCHEDULE		DATES (CST)
1.	Deadline for submittal of Service Provider requests for clarifications, modifications or questions regarding SOQ	2 PM on 1/22/21
2.	<u>Submittal Deadline for Statement of Qualifications</u>	<u>3 PM on 1/28/21</u>
3.	Service Provider Anticipated Performance Period	8/1/21 – 1/28/22

1.0 INTRODUCTION

TRRA is replacing the MacArthur Bridge Broadway Truss in St. Louis, Missouri with a new steel plate girder superstructure as shown below. USDOT FRA and TRRA is funding the Project.



Figure 1 -- Project Location – St. Louis, MO



Figure 2 -- Replacement of Existing Trusses

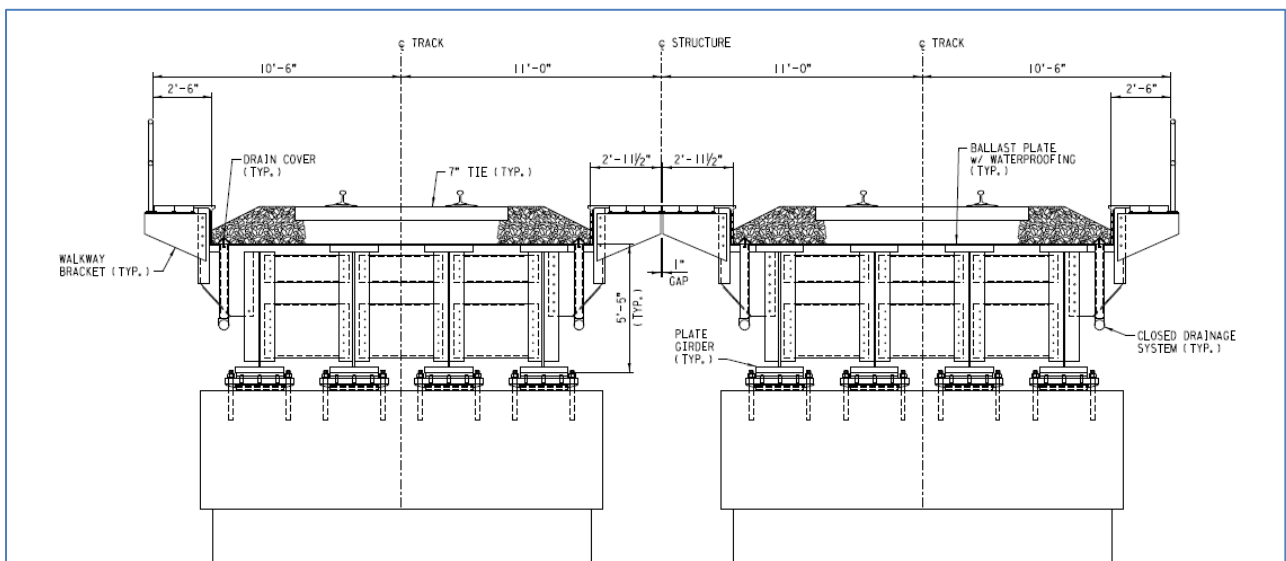

Figure 3 -- New Plate Girders

2.0 PURPOSE OF THIS SOQ

TRRA seeks the services to provide Quality Assurance Steel Fabrication Inspection Services audits of Contractor's Steel Fabricator Quality Control testing and program for the steel fabrication portion of the scope of work. It is anticipated that the selected service provider will review, test, inspect and document steel fabrication materials incorporated into the project in accordance with the plans and technical specifications and perform QA test audits.

3.0 SCOPE OF SERVICES

The specifications generally conform to the requirements of Chapter 15, Steel Structures, of the AREMA Manual for Railway Engineering and the American Welding Society, Bridge Welding

Code AWS D1.5 and the Union Pacific Railroad BNSF Railway Guidelines for Railroad Grade Separation Projects. The Contractor has informed TRRA that Delongs, Inc. of Jefferson City, MO will be performing the steel fabrication <http://delongsinc.com/> .

The service provider shall provide resumes including the names, qualifications, CWI certificates, NDT qualifications and availability of personnel available for this project.

Duties expected of the service provider includes, but are not limited to, the following:

1. Submit a Quality Assurance Audit plan and proposed audit documentation for approval by TRRA.
2. Coordinate and attend the prefabrication meeting.
3. Provide comments on the applicable portions of the Contractor's Quality Control Plan.
4. Perform the applicable portions of the Railroad's Quality Assurance function as it relates to Contractor and Fabricator's conformance with the plans and specifications and the Quality Control Plan.
5. Witness and monitor audit sampling of required Non-Destructive Testing (UT, RT, VT, PT, & MT).
6. Obtain and examine approved shop drawings, approved welding procedures and prefabrication meeting minutes.
7. Review fabricator qualifications to verify conformance with the specifications.
8. Write a daily inspection report to document the activities and findings as witnessed.

4.0 RESPONDING TO THIS SOQ

Email Indicating Interest. Service Providers who intend to respond to this SOQ are requested to notify TRRA by sending an email to efields@terminalrailroad.com with the SOQ name in the subject line. Please include the name, address, telephone, fax number, and e-mail address of the Service Provider and contact person.

Statement of Qualifications. Service Provider's Statement of Qualifications (SOQ) should clearly and accurately demonstrate specialized knowledge and experience required for consideration for the services under consideration. Submit one electronic copy of the SOQ, which consists of a Cover Letter and Standard Form 330, (Parts I and II) to efields@terminalrailroad.com .

In your SOQ please provide:

- 4.1 **Cover letter.** A cover letter, signed by an authorized representative of the

prospective Service Provider, shall include the name, address, telephone, fax number, e-mail address, and federal tax identification number of the proposing Service Provider. (one page maximum)

4.2 **Standard Form 330**, (U.S. General Services Administration): See link below.

4.2.1 Complete Form 330 in full, per specific instructions included therein.

4.2.2 Part 1 (F): Examples of the prospective Service Provider's projects (at least 10 projects). Provide owner's information for each project as a reference contact.

4.2.3 Part 1 (H): The prospective Service Provider shall describe its specific responses to the evaluation criteria, numbered and titled as listed in section 6.0 of this RFP.

For Standard Form 330, please go to: <https://www.gsa.gov/cdnstatic/SF330-16e.pdf?forceDownload=1>

4.3 Responsive SOQs should provide straightforward, concise information that satisfies the requirements specified. Emphasis should be placed on brevity, conformity to instructions, specified requirements of this RFP, and clarity of content.

4.4 USDOT Federal Terms and Conditions (2 CFR 200) will apply, including Debarment and Suspension, and Drug Free Work Place. No separate DBE goal is established for these services due to the projected contract size, but DBE's are encouraged to submit as the Service Provider for the services.

4.5 Service Providers must be able to meet TRRA's insurance requirements which will be provided upon request.

5.0 SELECTION PROCESS

5.1. An evaluation by TRRA will review and score the SOQs, based on the selection criteria, and determine the most qualified firm(s).

5.2. TRRA anticipates entering into a Cost Plus Fixed Fee Contract with the selected services provider.

6.0 EVALUATION OF SOQs

TRRA will evaluate Statements of Qualifications using the following criteria:

Personnel Qualifications (30%)

1. Provide a brief resume for the persons available for performing the inspections at the fabrication shops. Resume should include past and present experience.
2. CWI Certification and Certification Number.

3. NDT knowledge and experience and any certifications.

Staff Experience (30%)

1. Experience performing steel bridge inspections, including fracture critical bridges.
2. Experience working with state DOT agencies and/or Railroads.
3. Experience with AWS D1.5.

Communication (20%)

1. Must be able to maintain required documentation.
2. Work closely with the Railroad Construction Manager.
3. Must be able to describe / communicate and implement / recommend corrective actions for non-compliant fabrication.

Mobility / Availability (20%)

1. The fabrication inspector shall be able to physically perform structural steel inspection at heights within the confines of a steel fabrication facility.
2. Proximity of available personnel to the fabrication inspection facility in Jefferson City, MO and the Project Site in St. Louis, Missouri.