



ADDENDUM NO. 1

Greentrails Drive South Reconstruction 2013-PW-06

Addendum Number 1, attached, is hereby issued. In accordance with section 13 of the Notice to Contractors, addendum acknowledgement is confirmed by including the applicable updated bid documents in the bid submittal and signing and submitting the bid.

March 2016
Department of Public Services
City of Chesterfield, Missouri

ADDENDA AND MODIFICATIONS

CITY OF CHESTERFIELD, MISSOURI

GREENTRAILS DRIVE SOUTH RECONSTRUCTION

MARCH 24, 2016

ADDENDUM NO. 1

This Addendum is hereby made a part of the Contract Documents for the above referenced project. It supplements and modifies the Project Plans and Bidding Documents previously published.

A. CONSTRUCTION PLANS

1. Title sheet revised to update correct pagination (see attached)
2. Page 2 revised to update geotextile quantities (see attached)

B. PROJECT MANUAL:

1. Itemized Bid Form. Updated geotextile quantity. Remove and replace Itemized Bid Form with the attached updated Itemized Bid Form.
2. DBE Submittal Forms. The percent DBE participation was not provided on the forms. This project includes a 15% DBE goals as shown elsewhere in the DBE requirements. Remove and replace DBE Submittal Form page 1 of 3 with the attached DBE Submittal Form page 1.
3. JSP-HH. Section 4.12. Remove and replace with the following:

4.12 All joints shall be placed at right angles to, or radial to, the centerline of the pavement unless directed otherwise. Where both lanes of pavement are to be removed and replaced, a tied keyway shall be provided along the centerline joint per the Construction Details. Dowel bars shall be set in centerline joints in cul-de-sacs and eyebrows, supported to one-half the depth of the pavement.

4. JSP-II. Add the following section.

1.4 Streetlights called out on the plans as TBR&R or TBR&RBO shall be handled in the following manner. The contractor shall contact Ameren prior to

the start of the project and communicate the proposed schedule of work affecting the streetlights. Ameren will be responsible for removing the streetlights in order to avoid impacts to the contractor's progress, and then will reinstall the streetlights upon completion of the contractor's work. The contractor shall communicate with Ameren after the concrete removals have been made, as there is a potential for street lighting cable to be affected by the roadway excavation. This cable relocation will also be the responsibility of Ameren. After Ameren and the contractor complete their work within the roadway limits but before finish grading and sod placement takes place, the contractor shall contact Ameren to schedule installation of the streetlight poles prior to sodding. Any damage to newly-placed sod caused by the contractor failing to contact Ameren will require sod replacement at the sole cost of the contractor. No payment will be made to the contractor for this coordination, nor shall any payments for delays (perceived or actual) be made.

5. JSP-XX. Section 1.0. Add the following permit requirements:

d) St. Louis County Right of Way Permit (detour signage) and Construction Permit (pavement tie-ins)

C. CLARIFICATIONS

1. Pre-Bid Meeting Agenda is attached for reference.
2. Proposed pavement is 7" Portland cement concrete pavement with Type B longitudinal joints as shown on pages 10 and 11 of the construction plans.
3. Grated Trough
 - i. The grates for the proposed grated trough at approximate Sta. 47+75 do not extend across the entire roadway. See detail on Sheet 33 of the construction plans. It is anticipated that there will be 6 grates on each side of the street, 12 grates total for the grated trough.
 - ii. The grated trough bid item includes the required inlet, A2 joints, grates, etc. to make a complete and usable grated trough.
4. Linear Grading Class 1 is typically indicative of minimal cut and fill. This project will generate excess material. See JSP H regarding excess material.
5. There are no pavement lugs included in this project.
6. Trees to be removed (TBR) and trees to use in place (UIP) are shown on the project plans. Some trees between the existing back of curb and sidewalk will remain and are indicated as such on the construction plans.

END OF ADDENDUM NO. 1

FINAL PLANS
GREENTRAILS DRIVE SOUTH RECONSTRUCTION
(WHITE RD. TO LADUE RD.)
FEDERAL PROJECT NO. STP-5410(619)

| GENERAL LEGEND | |
|------------------------------------------------------------------------------------------|------------------|
| DESCRIPTION | SYMBOL |
| RIGHT-OF-WAY NEW | --- |
| RIGHT-OF-WAY EXISTING | --- |
| PROPERTY LINE | --- |
| UNDERGROUND UTILITY (TYPE SPECIFIED) T-TELE/CATV G-GAS W-WATER E-ELECTRIC | --- |
| CONSTRUCTION LIMITS | --- |
| TREE OR SHRUB (DESIGNATE DIA. & TYPE) | --- |
| TREE/VEGETATION LINE | --- |
| FENCE (DESIGNATE TYPE) | --- |
| GUARDRAIL | --- |
| SIGN | --- |
| PERMANENT DRAINAGE EASEMENT | P.D.E. |
| PERMANENT SIDEWALK EASEMENT | P.S.E. |
| PERMANENT SIGHT DISTANCE EASEMENT | P.S.D.E. |
| TEMPORARY SLOPE AND CONSTRUCTION LICENSE | T.S.C.L. |
| PERMANENT TRAFFIC SIGNAL EASEMENT | P.T.S.E. |
| PERMANENT FOOTING EASEMENT | P.F.E. |
| PERMANENT ROADWAY IMPROVEMENT, MAINTENANCE AND UTILITY EASEMENT | P.R.I.M.U.E. |
| PERMANENT ROADWAY IMPROVEMENT, MAINTENANCE AND UTILITY SIDEWALK AND SEWER EASEMENT | P.R.I.M.U.S.S.E. |
| PERMANENT RETAINING WALL EASEMENT | P.R.W.E. |
| TO BE REMOVED | (T.B.R.) |
| TO BE ABANDONED | (T.B.A.) |
| USE IN PLACE | (U.I.P.) |
| TO BE REMOVED AND REPLACED | (T.B.R.&R.) |
| TO BE REMOVED AND REPLACED BY OTHERS | (T.B.R.&R.O.) |
| ADJUST TO GRADE | (A.T.G.) |
| ADJUST TO GRADE BY OTHERS | (A.T.G.O.) |
| TO BE ABANDONED AND FILLED | (T.B.A.&F.) |
| TANGENT TO CURVE | (T.C.) |

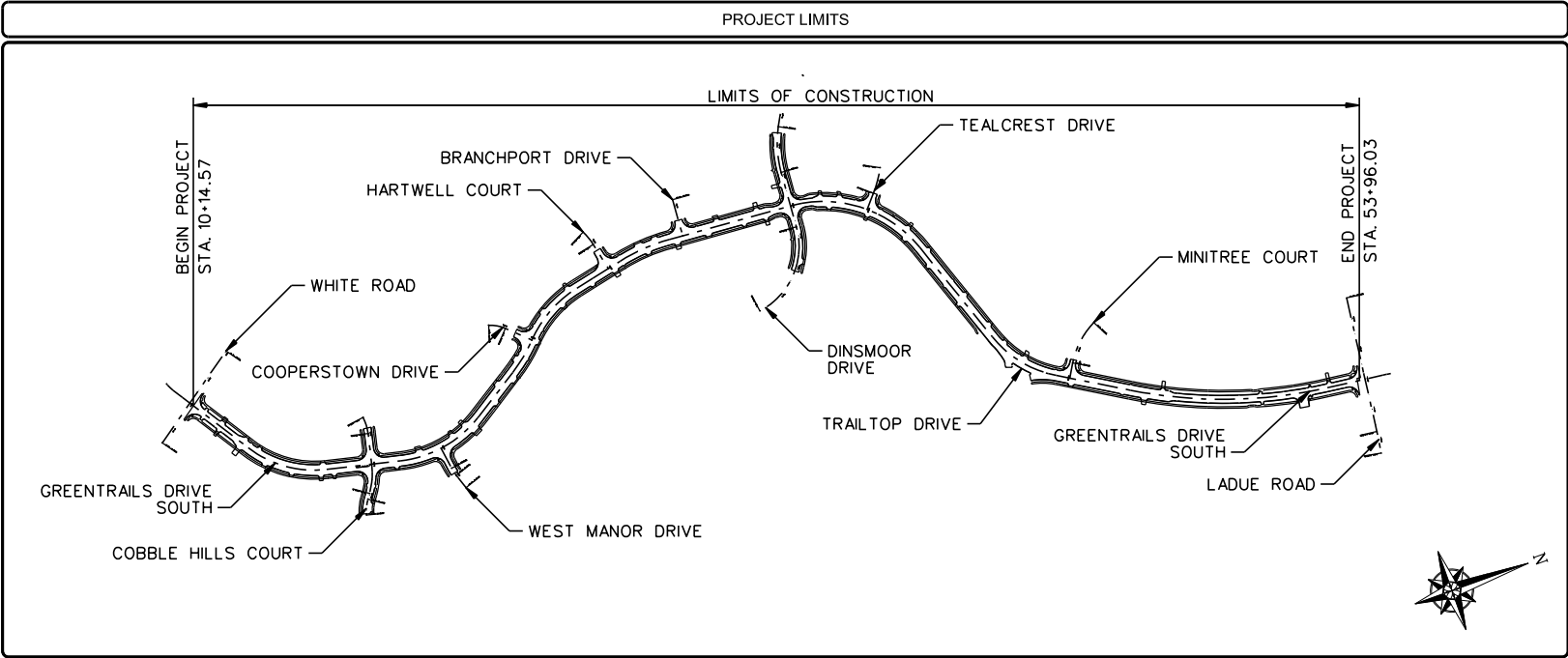



| INDEX OF SHEETS | |
|-----------------|--------------------------------------------|
| SHEET NUMBER | DESCRIPTION |
| 1 | TITLE AND INDEX SHEET |
| 2 - 9 | SUMMARY OF QUANTITIES |
| 10 - 11 | TYPICAL SECTIONS |
| 12 | REFERENCE TIES AND ALIGNMENT INFO |
| 13 - 21 | MAINLINE PLAN AND PROFILE SHEETS |
| 22 - 24 | SIDE ROAD PLAN AND PROFILE SHEETS |
| 25 - 30 | INTERSECTION GEOMETRICS AND WARPING SHEETS |
| 31 | STORM SEWER PROFILES |
| 32 | WATER QUALITY DETAILS |
| 33 | GRATED TROUGH DETAILS |
| 34 - 35 | STRIPING AND SIGNAGE |
| 36 - 41 | EROSION CONTROL |
| 42 - 45 | TRAFFIC CONTROL |
| 46 - 95 | CROSS SECTION SHEETS |

| PROJECT SPECIFIC INFORMATION | |
|---------------------------------------------------------------------------------------------------------------------------------------------------------------------------------------------------------------------------------------------------------------------------------------------------------------------------------------------------------------------------------------------------------------------------------------------------------------------------------------------------------------------------------------------------------------------------------------------------------------------------------------------------------------------------------------------------------------------------------------------------------------------------------------------------------------------------------------------------------------------------------------------------------------------------------------------------------------------------------------------------------------------------------------------------------------------------------------------------------------------------------------------------------------------------------------------------------------------------------------------------------------------------------------------------------------------------------------------------------------------------------------------------------------------------------------------------------------------------------------------------------------------------------------------------------------|--|
| BENCHMARKS USED IN PROJECT "SQUARE" CUT IN THE NORTHEAST CORNER OF THE BASE FOR A SUBDIVISION MONUMENT ("LADUE WOODS"). ELEVATION = 523.35 | |
| PROJECT NOTES 1. THIS PROJECT SHALL BE CONSTRUCTED IN ACCORDANCE WITH THE ST. LOUIS COUNTY TRANSPORTATION DEPARTMENT STANDARD DRAWINGS (LATEST VERSION) AND THE STANDARD SPECIFICATIONS FOR ROAD AND BRIDGE CONSTRUCTION (LATEST EDITION), BOTH AVAILABLE FOR DOWNLOAD OFF THE ST. LOUIS COUNTY WEBSITE, AS WELL AS THE PROJECT'S JOB SPECIAL PROVISIONS INCLUDED IN THE BID PROPOSAL. 2. IT IS THE RESPONSIBILITY OF THE CONTRACTOR TO CONTACT BOTH MISSOURI ONE CALL (DIGRITE) AND EACH INDIVIDUAL UTILITY THAT MAY NOT BE PART OF THE MISSOURI ONE-CALL PROGRAM TO ARRANGE FOR INDIVIDUAL UTILITY LOCATES. 3. PRIOR TO OBTAINING A CONSTRUCTION PERMIT FROM THE METROPOLITAN SEWER DISTRICT, THE CONTRACTOR SHALL BE REQUIRED TO PROVIDE THE DISTRICT WITH A COPY OF AN EXECUTED CERTIFICATE OF INSURANCE INDICATING THAT THE PERMITTEE HAS OBTAINED AND WILL CONTINUE TO CARRY COMMERCIAL GENERAL LIABILITY AND COMPREHENSIVE AUTO LIABILITY INSURANCE. THE REQUIREMENTS AND LIMITS SHALL BE AS STATED IN THE RULES AND REGULATIONS AND ENGINEERING DESIGN REQUIREMENTS FOR SANITARY AND STORMWATER DRAINAGE FACILITIES, FEBRUARY 2006, SECTION 10.090. LAND AREA DISTURBED = 3.70 ACRES ANY FUTURE LAND DISTURBANCE AND/OR INCREASE IN IMPERVIOUS AREA ON THIS SITE MAY REQUIRE ADDITIONAL STORM WATER MANAGEMENT PER MSD REGULATIONS IN PLACE AT THAT TIME (INCLUDING TOTAL LAND DISTURBANCE AND/OR IMPERVIOUSNESS ADDED ON THIS PLAN P-30004-00). DETENTION FOR ANY FUTURE DEVELOPMENT SHALL INCLUDE THESE IMPROVEMENTS AS WELL. | |

| LENGTH OF PROJECT / DESIGN CRITERIA | |
|-------------------------------------|---------------|
| SOUTH GREENTRAILS DRIVE | |
| END OF PROJECT | STA. 10+14.57 |
| BEGINNING OF PROJECT | STA. 53+96.03 |
| APPARENT LENGTH | 4,381.46 FEET |
| EQUATIONS AND EXCEPTIONS | 0.00 FEET |
| TOTAL CORRECTIONS | 0.00 FEET |
| NET LENGTH OF PROJECT | 4,381.46 FEET |
| STATE LENGTH | 0.83 MILES |
| FEDERAL LENGTH | 0.83 MILES |
| DESIGN CRITERIA | |
| FUNCTIONAL CLASSIFICATION: | COLLECTOR |
| DESIGN YEAR: | 2014/2015 |
| CURRENT ADT (YEAR): | 790 (2009) |
| DESIGN ADT (YEAR): | 1,200 (2025) |
| DIRECTIONAL DISTRIBUTION (D) = | N/A |
| TRUCK PERCENTAGE (T) = | 2% |
| DESIGN SPEED (V) = | 30 MPH |
| POSTED SPEED (V) = | 25 MPH |

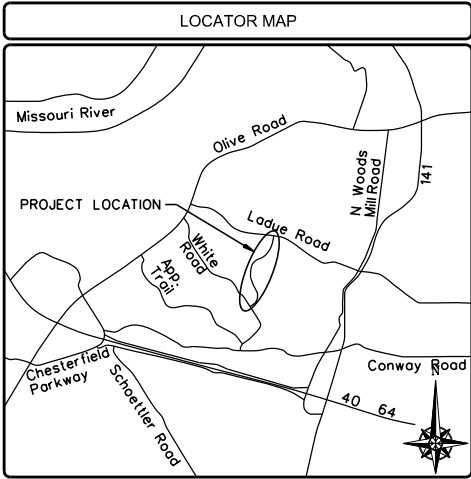
| MSD CERTIFICATION | |
|------------------------------------------------------------------------------------------------------------------------------------------------------------------------------------------------------------------------------------------------------------------------------------------------------------------------------------------------------------------------------------------------------------------------------------------------------------------------------------------------------------------------------------|--|
| THE EXISTING SEWER LENGTHS, SIZES, FLOWLINES, DEPTHS OF STRUCTURES AND SEWERS AND LOCATIONS WITH RESPECT TO EXISTING OR PROPOSED EASEMENTS HAVE BEEN MEASURED. THE RESULTS OF THOSE MEASUREMENTS ARE SHOWN ON THIS SET OF FINAL MEASUREMENT PLANS. SINCE THE WYE LOCATIONS HAVE BEEN PLOTTED FROM INFORMATION PROVIDED BY THE SEWER CONTRACTOR OR OTHER SOURCES, I DISCLAIM ANY RESPONSIBILITY FOR THAT SPECIFIC INFORMATION. ALL PUBLIC SEWERS ARE LOCATED WITHIN DESIGNATED EXISTING OR PROPOSED EASEMENTS EXCEPT AS FOLLOWS: | |
| SIGNED P.E. | |
| DATE | |
| IT SHOULD BE UNDERSTOOD THAT THIS SIGNATURE AND SEAL APPLY ONLY TO THE AFOREMENTIONED FINAL MEASUREMENTS | |



 CITY OF CHESTERFIELD, MISSOURI
DEPARTMENT OF PUBLIC SERVICES
690 CHESTERFIELD PARKWAY WEST
CHESTERFIELD, MISSOURI 63017

| SCALES | |
|------------------|----------------------------------------|
| PLAN: | 1" = 20' |
| PROFILE: | 1" = 20' HORIZ. & 5' VERT. |
| CROSS SECTION: | 1" = 5' HORIZ. & 5' VERT. |
| PIPE PROFILE: | 1" = 20' HORIZ. & 5' VERT. |
| SPECIAL DETAILS: | NOT TO SCALE UNLESS NOTED OTHERWISE |

UTILITY NOTE
UNDERGROUND FACILITIES, STRUCTURES AND UTILITIES HAVE BEEN PLOTTED FROM AVAILABLE SURVEYS AND RECORDS; AND, THEREFORE THEIR LOCATIONS MUST BE CONSIDERED APPROXIMATE ONLY. IT IS POSSIBLE THERE MAY BE OTHERS, THE EXISTENCE OF WHICH IS PRESENTLY NOT KNOWN OR SHOWN. IT IS THE CONTRACTOR'S RESPONSIBILITY TO DETERMINE THEIR EXISTENCE AND EXACT LOCATION AND TO AVOID THERETO.

| | |
|------------------|-------------------|
| M.S.D. P-NUMBER: | P-0030288-00 |
| M.S.D. BASE MAP: | 17R, 18R |
| REVIEW ENGINEER: | EUGENE W. JOHNSON |
| APPROVAL DATE: | N/A |

| | |
|-----------|---------------------------------------------------------------|
| APPROVED: | JAMES ECKRICH, P.E. PUBLIC WORKS DIRECTOR CITY ENGINEER |
| DATE: | |

| | |
|--------------------------------------|-------|
| CITY PROJECT NO. 2013-PW06 | |
| FEDERAL PROJECT NO. STP-5410(619) | |
| E-W GATEWAY TIP NO. 5753-14 | |
| MSD: P-0030288-00 | |
| MSD BASE MAP: 17R, 18R | |
| REV. | DATE |
| 1 | 02/16 |
| HRG | JSD |
| PAGE NUMBERS | |

I hereby certify that the documents intended to be submitted by my seal are accurate and I hereby disclaim any responsibility for all other drawings, specifications, or documents or instruments relating to or intended to be used for any part or for the entire project or survey.



DATE: 3/23/16

PREPARED BY:
 HRGreen
JAMES ECKRICH, P.E.
PUBLIC WORKS DIRECTOR
CITY ENGINEER
LICENSE NO. 200407159

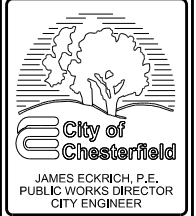

GREENTRAILS DRIVE S.
RECONSTRUCTION
(WHITE RD. TO LADUE RD.)
TITLE AND INDEX SHEET

| | |
|-----------------|-------------|
| DESIGNED: | A. SCHUMANN |
| DRAWN: | A. SCHUMANN |
| CHECKED: | J. DOHRMANN |
| SHEET SEQUENCE: | 1 OF 95 |

3/23/2016 11:51:59 AM
\\hrgwfs004\Data\75130039\CAD\Roadway\Construction_Plans\0039-S-RD-02_Quantity1.dgn

| SUMMARY OF QUANTITIES - STP-5410(619) | | | | |
|------------------------------------------------|----------|--------------------------------------------------------------------------|------|----------|
| ITEM NO. | JSP | DESCRIPTION | UNIT | QUANTITY |
| ROADWAY ITEMS | | | | |
| 201-20.10 | S, T | CLEARING AND GRUBBING | L.S. | 1 |
| 201-20.99 | S | TREE REMOVAL (CONTINGENT) | EACH | 0 |
| 202-20.10 | H, U, CC | REMOVAL OF IMPROVEMENTS | L.S. | 1 |
| 202-20.99 | II | RESTORATION | L.S. | 1 |
| 203-60.10 | DD | UNSUITABLE MATERIAL | C.Y. | 267 |
| 205-00.99 | EE | MODIFIED SUBGRADE - STRUCTURAL GEOGRID | S.Y. | 800 |
| 207-10.00 | GG | LINEAR GRADING, CLASS 1 | STA. | 55.6 |
| 304-05.04 | | TYPE 5 AGGREGATE BASE (4" THICK) | S.Y. | 20,835 |
| 502-11.07 | HH | CONCRETE PAVEMENT (7" NON-REINFORCED) | S.Y. | 19,137.4 |
| 502-90.99 | RR | TYPE A2 JOINT | L.F. | 834 |
| 603-10.99 | JJ | ADJUST SERVICE VALVE TO GRADE | EACH | 30 |
| 604-12.01 | | SINGLE CURB INLET, UNTRAPPED | EACH | 5 |
| 604-20.30 | | ADJUST MANHOLE TO GRADE | EACH | 3 |
| 604-22.32 | SS | GRATED TROUGH (32") | EACH | 1 |
| 604-26.50 | | CONVERT CURB INLET TO AREA INLET AND ADJUST TO GRADE | EACH | 2 |
| 604-90.50 | | REPLACE PRECAST INLET TOP AND ADJUST TO GRADE | EACH | 22 |
| 604-90.52 | | REPLACE INLET SILL | EACH | 22 |
| 605-10.10 | KK | CLASS "A" UNDERDRAIN | L.F. | 261.9 |
| 607-30.20 | AAA | ALUMINUM HANDRAIL | L.F. | 243 |
| 608-50.06 | LL | PAVED APPROACH (6") | S.Y. | 1,293.8 |
| 608-50.99 | MM | DRIVEWAY EXTENSION | S.Y. | 359.3 |
| 609-20.99 | K | INTEGRAL CURB (MOUNTABLE 6" HEIGHT) | L.F. | 8,768 |
| 611-30.99 | L | MSD TYPE 5 ROCK BLANKET | S.Y. | 28.0 |
| 612-10.30 | NN, OO | MOVEABLE BARRICADE (STANDARD) | EACH | 25 |
| 616-10.05 | NN, OO | CONSTRUCTION SIGNS | S.F. | 347 |
| 616-10.25 | NN, OO | CHANNELIZERS | EACH | 228 |
| 616-10.95 | NN, OO | EDGE DROP-OFF TREATMENT | L.F. | 9,148 |
| 617-10.90 | NN, OO | TEMPORARY CONCRETE MEDIAN BARRIER, TYPE A (INCLUDES END SECTIONS) | L.F. | 170 |
| 619-00.00 | | MOBILIZATION | L.S. | 1 |
| 624-10.02 | FF | GEOTEXTILE FABRIC, STABILIZATION AND SEPARATION, CLASS 2 (MEDIUM WEIGHT) | S.Y. | 20,835 |
| 627-40.00 | G | CONTRACTOR FURNISHED SURVEYING AND STAKING | L.S. | 1 |
| 703-90.15 | | MODULAR BLOCK WALL (H<4') | S.F. | 266 |
| 726-13.12 | | 12" CLASS III REINFORCED CONCRETE PIPE CULVERT | L.F. | 488 |
| 731-00.42 | | PRECAST CONCRETE MANHOLE, 42" | EACH | 1 |
| 732-00.12 | | 12" RCP FLARED END SECTION | EACH | 1 |
| 803-10.00 | | SODDING | S.Y. | 8,785 |
| 803-10.99 | ZZ | MAILBOXES | EACH | 34 |
| 804-20.99 | M | AMENDED SOIL | S.Y. | 5,013 |
| 806-16.99 | N | DRY SWALE WITH UNDERDRAIN | L.F. | 816 |
| 806-45.99 | PP | SWPPP DESIGN, INSTALLATION, MAINTENANCE, AND REMOVAL | L.S. | 1 |
| 808-90.99 | R | STREET TREES | EACH | 45 |
| SIGNING, STRIPING, SIGNALS, AND LIGHTING ITEMS | | | | |
| 621-20.17 | P | PERMANENT PAVEMENT MARKINGS, PAINT | S.F. | 157 |
| 621-20.99 | P | PERMANENT PAVEMENT STRIPING, PAINT (4" YELLOW) | L.F. | 8,520 |
| 621-20.99 | P | PERMANENT PAVEMENT STRIPING, PAINT (4" WHITE) | L.F. | 5,190 |
| 621-20.99 | P | PERMANENT PAVEMENT STRIPING, PAINT (6" WHITE) | L.F. | 420 |
| 903-10.99 | O | PERMANENT SIGNING | S.F. | 205 |
| BIKE AND PEDESTRIAN ITEMS | | | | |
| 608-60.04 | J, Q | CONCRETE SIDEWALK | S.Y. | 5,191.0 |
| 608-60.98 | CCC | TRUNCATED DOMES FOR CURB RAMPS (NEW CONSTRUCTION) | S.F. | 360 |

NOTES:

SIL Only = LATEST EDITION OF ST. LOUIS COUNTY STANDARDS FOR HIGHWAY CONSTRUCTION
MoDOT = LATEST EDITION OF MISSOURI STANDARDS FOR HIGHWAY CONSTRUCTION, BY THE MISSOURI DEPT OF TRANSPORTATION
JSP = JOB SPECIAL PROVISIONS, AS ATTACHED IN THE PROJECT MANUAL

CONSTRUCTION SIGNS ARE FOR USE IN TRAFFIC CONTROL AND ARE TEMPORARY. RELOCATION OF THE SIGNS DURING VARIOUS STAGES OF CONSTRUCTION IS CONSIDERED INCIDENTAL TO QUANTITY OF CONSTRUCTION SIGNAGE.

BID FOR PIPE INCLUDES EXCAVATION AND GRANULAR BACKFILL AS REQUIRED IN THE SPECIFICATIONS

| 207-10.00 LINEAR GRADING, CLASS 1 | | | |
|-----------------------------------|-----------|------------|---------------|
| LOCATION | STATION | STATION | LENGTH (STA.) |
| GREENTRAILS | 10+14.57 | 53+96.03 | 43.9 |
| COBBLE HILL | 198+82.23 | 201+62.52 | 2.9 |
| MANOR | 300+00.00 | 300+91.15 | 1.0 |
| COOPERSTOWN | 399+41.35 | 400+00.00 | 0.6 |
| HARTWELL | 499+30.91 | 500+00.00 | 0.7 |
| BRANCHPORT | 599+47.32 | 600+00.00 | 0.6 |
| DINSMOOR | 697+57.82 | 702+15.01 | 4.6 |
| TEALCREST | 799+43.32 | 800+00.00 | 0.6 |
| MINITREE | 999+39.22 | 1000+00.00 | 0.7 |
| TOTAL = | | | 55.6 |

| 205-00.99 MODIFIED SUBGRADE - STRUCTURAL GEOGRID* | | |
|---------------------------------------------------|-------------|-------------|
| LENGTH (FT.) | WIDTH (FT.) | AREA (S.Y.) |
| 200 | 36 | 800 |
| TOTAL = | | 800 |

*ACTUAL QUANTITY IS CONTINGENT UPON MEASURED VALUE IN THE FIELD. SEE JSP.

| EARTHWORK - FOR INFORMATIONAL PURPOSES ONLY | | | |
|---------------------------------------------|--------------------------|------------------------|-----------|
| LOCATION | UNCLASSIFIED EXCAVATION* | COMPACTING EMBANKMENT* | HAUL OFF* |
| | (C.Y.) | (C.Y.) | (C.Y.) |
| GREENTRAILS | 9,133 | 1,242 | 7,691 |
| COBBLE HILL | 218 | 56 | 162 |
| MANOR | 51 | 6 | 45 |
| COOPERSTOWN | 11 | 1 | 10 |
| HARTWELL | 24 | 2 | 22 |
| BRANCHPORT | 4 | 0 | 4 |
| DINSMOOR | 1,001 | 62 | 939 |
| TEALCREST | 8 | 1 | 7 |
| MINITREE | 13 | 3 | 10 |
| EARTHWORK FOR AMENDED SOIL | 5,013 | 0 | 5,013 |
| TOTALS = | | | |
| | 15,476 | 1,373 | 14,103 |

NOTE: NO SHRINKAGE FACTOR APPLIED.

*NO DIRECT PAYMENT FOR THIS BID ITEM WILL BE MADE. TABULATION IS FOR INFORMATIONAL PURPOSES ONLY.

| 203-60.10 UNSUITABLE MATERIAL* | | | |
|--------------------------------|-------------|-------------|---------------|
| LENGTH (FT.) | WIDTH (FT.) | DEPTH (FT.) | VOLUME (C.Y.) |
| 200 | 36 | 1 | 267 |
| TOTAL = | | | 267 |

*ACTUAL QUANTITY IS CONTINGENT UPON MEASURED VALUE IN THE FIELD. SEE JSP.

| 803-10.99 MAILBOXES | |
|---------------------|----------------|
| LOCATION | MAILBOX (EACH) |
| VARIES | 34 |
| TOTAL = | |
| | 34 |

| CONCRETE PAVEMENT | | | | | | | | |
|-------------------|-----------|-----------|-------------|--------|---------|--------------------------------------------------|-----------------------------------------------------------|------------------------------------------------------------------------------------------------|
| SHEET | STATION | STATION | ROUTE | LENGTH | WIDTH | 304-05.04 TYPE 5 AGGREGATE BASE (4" THICK) | 502-11.07 CONCRETE PAVEMENT (7" NON- REINFORCED) | 624-10.02 GEOTEXTILE FABRIC, STABILIZATION AND SEPARATION, CLASS 2 (MEDIUM WEIGHT) |
| | | | | (L.F.) | (FT) | (S.Y.) | (S.Y.) | (S.Y.) |
| 13 | BOP | 14+50.00 | GREENTRAILS | 435 | 26 & 36 | 1699 | 1556.3 | 1699 |
| 14 | 14+50.00 | 19+50.00 | GREENTRAILS | 500 | 36 | 2081 | 1916.9 | 2081 |
| 14 | 199+25.00 | 199+82.75 | COBBLE HILL | 58 | 25.5 | 217 | 205.2 | 217 |
| 14 | 200+17.25 | 200+75.00 | COBBLE HILL | 58 | 25.5 | 223 | 211.4 | 223 |
| 14 | 300+17.25 | 300+91.15 | MANOR | 74 | 26 | 263 | 243.8 | 263 |
| 15 | 19+50.00 | 24+75.00 | GREENTRAILS | 525 | 36 | 2165 | 2010.8 | 2165 |
| 15 | 399+41.35 | 399+82.75 | COOPERSTOWN | 41 | 27 | 179 | 173.7 | 179 |
| 16 | 24+75.00 | 30+00.00 | GREENTRAILS | 525 | 36 | 2170 | 2010.9 | 2170 |
| 16 | 499+30.91 | 499+81.00 | HARTWELL | 50 | 27 | 206 | 196.8 | 206 |
| 16 | 599+47.32 | 599+82.75 | BRANCHPORT | 35 | 26 | 150 | 146.5 | 150 |
| 17 | 30+00.00 | 35+00.00 | GREENTRAILS | 500 | 26 & 36 | 1910 | 1751.4 | 1910 |
| 17 | 699+25.00 | 699+87.10 | DINSMOOR | 62 | 25.5 | 233 | 214.3 | 233 |
| 17 | 700+12.25 | 701+00.00 | DINSMOOR | 88 | 25.5 | 304 | 291.3 | 304 |
| 18 | 35+00.00 | 40+25.00 | GREENTRAILS | 525 | 36 | 2183 | 2012.2 | 2183 |
| 18 | 799+43.32 | 799+82.75 | TEALCREST | 39 | 26 | 156 | 149.9 | 156 |
| 19 | 40+25.00 | 45+75.00 | GREENTRAILS | 550 | VARIES | 2459 | 2263.7 | 2459 |
| 19 | 999+39.22 | 999+81.00 | MINITREE | 42 | 20 | 148 | 140.3 | 148 |
| 20 | 45+75.00 | 51+00.00 | GREENTRAILS | 525 | 26 & 36 | 1854 | 1659.4 | 1854 |
| 21 | 51+00.00 | EOP | GREENTRAILS | 296 | 26 | 977 | 870.7 | 977 |
| 22 | 198+82.23 | 199+25.00 | COBBLE HILL | 43 | 25.5 | 131 | 114.0 | 131 |
| 22 | 200+75.00 | 201+62.52 | COBBLE HILL | 88 | 25.5 | 266 | 239.4 | 266 |
| 23 | 697+57.83 | 699+25.00 | DINSMOOR | 167 | 25.5 | 515 | 452.4 | 515 |
| 23 | 701+00.00 | 702+15.10 | DINSMOOR | 115 | 25.5 | 346 | 306.1 | 346 |
| TOTALS = | | | | | | 20835 | 19137.4 | 20835 |

*CONCRETE PAVEMENT (7" NON-REINFORCED) IS PAID TO THE FLOWLINE OF THE INTEGRAL CURB.

| |
|---------------------------------------------------------|
| REMOVAL OF IMPROVEMENTS = 1 LUMP SUM |
| MOBILIZATION = 1 LUMP SUM |
| CONTRACTOR FURNISHED SURVEYING AND STAKING = 1 LUMP SUM |
| RESTORATION = 1 LUMP SUM |

| 703-90.15 MODULAR BLOCK WALL (H<4') | | | | | |
|-------------------------------------|----------|----------|-------------|------|-------------|
| SHEET | STATION | STATION | ROUTE | SIDE | AREA (S.F.) |
| 17 | 32+75.59 | 32+96.59 | GREENTRAILS | LT | 66 |
| 17 | 32+75.75 | 32+96.75 | GREENTRAILS | RT | 66 |
| 17 | 33+41.76 | 33+60.62 | GREENTRAILS | LT | 62 |
| 17 | 33+47.49 | 33+71.11 | GREENTRAILS | RT | 72 |
| TOTAL = | | | | | 266 |

CITY PROJECT NO.
2013-PW06

FEDERAL PROJECT NO.
STP-5410(619)

E-W GATEWAY TIP NO.
5753-14

MSD:
P-0030288-00

MSD BASE MAP:
17R, 18R

| REV. | DATE | BY | APP. | DESCRIPTION | GEOTEXTILE QTY. EDITS | |
|------|---------|----|------|-------------|-----------------------|-----|
| | | | | | HRG | JSD |
| 1 | 3/23/16 | | | | | |

DISCLAIMER OF LIABILITY
I hereby specify that the documents intended to be authorized by my seal are those of the City of Chesterfield, Missouri, and I hereby disclaim any responsibility for all other drawings, specifications, or documents or instruments relating to or intended to be used for any part or portion of the project or survey.



DATE: 3/23/16

PREPARED BY:

JAS DOHRMANN
PROFESSIONAL ENGINEER
LICENSE NO. 200407159

JAMES ECKRICH, P.E.
PUBLIC WORKS DIRECTOR
CITY ENGINEER

GREENTRAILS DRIVE S.
RECONSTRUCTION
(WHITE RD. TO LADUE RD.)
SUMMARY OF QUANTITIES
(SHEET 1 OF 8)

DESIGNED:
A. SCHUMANN

DRAWN:
A. SCHUMANN

CHECKED:
J. DOHRMANN

SHEET SEQUENCE:
2 OF 95

Greentrails Drive South Reconstruction - Chesterfield, MO

STP-5410(619)

ITEMIZED BID FORM

| ITEM NO. | JSP | DESCRIPTION | UNIT | QUANTITY | BID PRICE | EXTENSION |
|---------------|----------|-------------------------------------------------------------------|------|----------|-----------|-----------|
| ROADWAY ITEMS | | | | | | |
| 201-20.10 | S, T | CLEARING AND GRUBBING | L.S. | 1 | | |
| 201-20.99 | S | TREE REMOVAL (CONTINGENT) | EACH | 0 | | |
| 202-20.10 | H, U, CC | REMOVAL OF IMPROVEMENTS | L.S. | 1 | | |
| 202-20.99 | II | RESTORATION | L.S. | 1 | | |
| 203-60.10 | DD | UNSUITABLE MATERIAL | C.Y. | 267 | | |
| 205-00.99 | EE | MODIFIED SUBGRADE - STRUCTURAL GEOGRID | S.Y. | 800 | | |
| 207-10.00 | GG | LINEAR GRADING, CLASS 1 | STA. | 55.6 | | |
| 304-05.04 | | TYPE 5 AGGREGATE BASE (4" THICK) | S.Y. | 20,835 | | |
| 502-11.07 | HH | CONCRETE PAVEMENT (7" NON-REINFORCED) | S.Y. | 19,137 | | |
| 502-90.99 | RR | TYPE A2 JOINT | L.F. | 834 | | |
| 603-10.99 | JJ | ADJUST SERVICE VALVE TO GRADE | EACH | 30 | | |
| 604-12.01 | | SINGLE CURB INLET, UNTRAPPED | EACH | 5 | | |
| 604-20.30 | | ADJUST MANHOLE TO GRADE | EACH | 3 | | |
| 604-22.32 | SS | GRATED TROUGH (32') | EACH | 1 | | |
| 604-26.50 | | CONVERT CURB INLET TO AREA INLET AND ADJUST TO GRADE | EACH | 2 | | |
| 604-90.50 | | REPLACE PRECAST INLET TOP AND ADJUST TO GRADE | EACH | 22 | | |
| 604-90.52 | | REPLACE INLET SILL | EACH | 22 | | |
| 605-10.10 | KK | CLASS "A" UNDERDRAIN | L.F. | 262 | | |
| 607-30.20 | AAA | ALUMINUM HANDRAIL | L.F. | 243 | | |
| 608-50.06 | LL | PAVED APPROACH (6") | S.Y. | 1,294 | | |
| 608-50.99 | MM | DRIVEWAY EXTENSION | S.Y. | 360 | | |
| 609-20.99 | K | INTEGRAL CURB (MOUNTABLE 6" HEIGHT) | L.F. | 8,768 | | |
| 611-30.99 | L | MSD TYPE 5 ROCK BLANKET | S.Y. | 28 | | |
| 612-10.30 | NN, OO | MOVEABLE BARRICADE (STANDARD) | EACH | 25 | | |
| 616-10.05 | NN, OO | CONSTRUCTION SIGNS | S.F. | 347 | | |
| 616-10.25 | NN, OO | CHANNELIZERS | EACH | 228 | | |
| 616-10.95 | NN, OO | EDGE DROP-OFF TREATMENT | L.F. | 9,148 | | |
| 617-10.90 | NN, OO | TEMPORARY CONCRETE MEDIAN BARRIER, TYPE A (INCLUDES END SECTIONS) | L.F. | 170 | | |
| 619-00.00 | | MOBILIZATION | L.S. | 1 | | |

CONTINUED ON NEXT SHEET

| Greentrails Drive South Reconstruction - Chesterfield, MO STP-5410(619) | | | | | | |
|----------------------------------------------------------------------------|------|--------------------------------------------------------------------------|------|---------|--|--|
| ITEMIZED BID FORM (continued) | | | | | | |
| ROADWAY ITEMS (continued) | | | | | | |
| 624-10.02 | FF | GEOTEXTILE FABRIC, STABILIZATION AND SEPARATION, CLASS 2 (MEDIUM WEIGHT) | S.Y. | 20,835 | | |
| 627-40.00 | G | CONTRACTOR FURNISHED SURVEYING AND STAKING | L.S. | 1 | | |
| 703-90.15 | | MODULAR BLOCK WALL (H<4') | S.F. | 266 | | |
| 726-13.12 | | 12" CLASS III REINFORCED CONCRETE PIPE CULVERT | L.F. | 488 | | |
| 731-00.42 | | PRECAST CONCRETE MANHOLE, 42" | EACH | 1 | | |
| 732-00.12 | | 12" RCP FLARED END SECTION | EACH | 1 | | |
| 803-10.00 | | SODDING | S.Y. | 8,785 | | |
| 803-10.99 | ZZ | MAILBOXES | EACH | 34 | | |
| 804-20.99 | M | AMENDED SOIL | S.Y. | 5,013 | | |
| 806-16.99 | N | DRY SWALE WITH UNDERDRAIN | L.F. | 816 | | |
| 806-45.99 | PP | SWPPP DESIGN, INSTALLATION, MAINTENANCE, AND REMOVAL | L.S. | 1 | | |
| 808-90.99 | R | STREET TREES | EACH | 45 | | |
| Roadway Subtotal: | | | | | | |
| SIGNING, STRIPING, SIGNALS, AND LIGHTING ITEMS | | | | | | |
| 621-20.17 | P | PERMANENT PAVEMENT MARKINGS, PAINT | S.F. | 157 | | |
| 621-20.99 | P | PERMANENT PAVEMENT STRIPING, PAINT (4" YELLOW) | L.F. | 8,520 | | |
| 621-20.99 | P | PERMANENT PAVEMENT STRIPING, PAINT (4" WHITE) | L.F. | 5,190 | | |
| 621-20.99 | P | PERMANENT PAVEMENT STRIPING, PAINT (6" WHITE) | L.F. | 420 | | |
| 903-10.99 | O | PERMANENT SIGNING | S.F. | 205 | | |
| Signing, Striping, Signals, and Lighting Subtotal: | | | | | | |
| BIKE AND PEDESTRIAN ITEMS | | | | | | |
| 608-60.04 | J, Q | CONCRETE SIDEWALK | S.Y. | 5,191.0 | | |
| 608-60.98 | CCC | TRUNCATED DOMES FOR CURB RAMPS (NEW CONSTRUCTION) | S.F. | 360 | | |
| Bike and Pedestrian Subtotal: | | | | | | |
| BID TOTAL: _____ | | | | | | |

DBE Submittal Forms

- (6) **DBE Submittal Forms:** This form must be submitted by 4 p.m. three (3) business days after bid opening.

(A) DBE Contract Goal: By submitting this bid, the bidder certifies that the bidder is familiar with the DBE Program Requirements in this contract. The contract DBE goal for the amount of work to be awarded is 15% of the total federal project price. The bidder shall also complete the DBE Submittal Form in accordance with the program requirements.

(B) DBE Participation: The bidder certifies that it will utilize DBE's as follows:

_____% OF TOTAL FEDERAL CONTRACT

NOTE: Bidder must fill in the above blank. If no percentage is specified, the bidder certifies that it agrees to, and will comply with the contract goal. If a percentage below the contract goal is specified, then the bidder must submit complete documentation of good faith efforts to meet the DBE contract goal, immediately below.

(C) Certification of Good Faith Efforts to Obtain DBE Participation: By submitting its signed bid, the bidder certifies under penalty of perjury and other provisions of law, that the bidder took each of the following steps to try to obtain sufficient DBE participation to achieve the Commission's proposed DBE Contract Goal: (Attach additional sheets if necessary).

This image shows a single sheet of white paper with horizontal ruling lines. The lines are evenly spaced and run across the width of the page. There are no margins, text, or other markings on the paper.



Pre-Bid Meeting Greentrails Drive South Reconstruction 2013-PW-06 STP-5410(619)

**3/23/2016
10:00 AM
Chesterfield City Hall**

GENERAL ITEMS

- Attendance Sheet
- Project Overview
 - Reconstruction of Greentrails Drive South between Ladue Road and White Road.
 - Removal and replacement of approximately 19,130 square yards of pavement, 8,768 lineal feet of curb with 7-inch Portland cement concrete (PCC) pavement with a 6" mountable curb, over 4-inches of Type 5 Aggregate over a geotextile layer on a prepared subgrade.
 - Work will also include removal and replacement of existing 4' wide sidewalk with 5' wide sidewalk, as well as storm sewers, underdrains, expansion joints, striping, restoration, traffic control, paved approaches and driveway extensions, curb ramps, and all other necessary and incidental work to make for a complete and usable roadway.
 - Staged construction will be required to maintain traffic on Greentrails Drive South during the construction of this project. Greentrails Drive will be one-way, south bound, for the project. North bound traffic will be detoured.
- Project Contacts
 - HR Green, Inc.
 - Jason Dohrmann, PE
 - 636-812-4209
 - jdohrmann@hrgreen.com
 - City of Chesterfield
 - Zachary Wolff, PE
 - 636-537-4757
 - zwolff@chesterfield.mo.us

BIDDING AND AWARD

- Schedule
 - Bids Due and Bid Opening: 10:00am April 6th, 2016 Chesterfield City Hall
 - Project will be awarded to the lowest, responsive, and responsible bidder with MoDOT concurrence

- Notice of Award: Tentatively April 21, 2016 (pending City Council schedule)
 - Required submittals - See JSP E, 7.0
- Notice to Proceed: Tentatively May 9th, 2016
- Time of Completion 180 calendar days (November 2016)
- Bid Submittal
 - Federally funded project
 - Prevailing Wage
 - MoDOT's Qualified Contractor List (if not on the list, must submit to MoDOT at least 7 days prior to the bid opening)
 - 10-Hour OSHA
 - DBE: 15% participation goal
 - On the Job Training: 1 slot at 1000 hours
 - Additional OJT information and forms can be found on MoDOT's website, See JSP D.
 - ADA Compliance
 - Buy America
 - See the Bidder's Checklist in the Bid Packet
 - Any addenda will be e-mailed, posted to MoDOT's bidding website and the City's website, you will be asked to confirm receipt of any and all addenda
- Bid Quantities are approximate and are subject to change.

CONSTRUCTION

- Residents:
 - The City, as always, wants to keep the inconveniences and safety hazards to our residents to a minimum. All excavations will need to be barricaded when unattended and storage areas will need to be kept clear. Contractor vehicles are not to be parked in intersections and should not block the path of traffic unless being loaded/unloaded.
 - Keep all trash picked up and don't have after work gatherings in the area.
 - Notification
 - Contractor to provide written notification to residents a minimum of 48 hours in advance of work that will limit access to driveways. (door hanger, letter, etc.)
 - City will place step stakes that can be utilized for construction notices.
 - Door to door notifications are encouraged by field personnel.
 - Minimize construction traffic in the adjacent residential neighborhoods. Utilize Ladue Road and White Road for access to the site.
- Work Areas & Phasing
 - The project is divided into 2 phases. Phases 1 is the west side of Greentrails Drive

and Phase 2 is the east side of Greentrails Dr.

- The contractor must complete all work, including clean-up activities, in each phase before moving to the next phase. It may be possible to get permission to move into the next phase, however, the contractor should not expect this permission.
- Permits – See JSP XX
 - DNR – Land Disturbance
 - MoDOT – Right-of-way
 - MSD – Construction
 - St. Louis County – Right-of-way/construction
- Utilities – See JSP QQ
 - Utility adjustment work is necessary and either has been completed or is in progress. Main utility adjustments at Greentrails Dr./Dinsmoor Intersection
 - Existing facilities (valve box, grade rings, etc.) may need adjusted to grade by the Contractor.
 - Contractor responsible for notifying Missouri One-Call.
- Traffic Control – See JSP OO and plan sheets 42 to 45
 - Awarded Contractor will be required to submit a traffic management plan including phasing, materials, and construction sequence prior to starting work.
 - Temporary Traffic Control is inclusive of any temporary pavement marking to maintain traffic control prior to final pavement striping.
 - Detour route must remain clearly marked throughout construction.
- Payments
 - The City's site inspector, HR Green, is required to make measurements of all work performed. It is highly recommended that the contractor meet with the inspector each day to verify the measured quantities.
 - The Contractor will prepare monthly pay estimates for the City to review/approve.
 - Pay Estimates will need to be submitted on the City's Pay Application form and will need to be accompanied by the following at a minimum:
 - Partial lien waivers
 - Certified payroll
 - OJT Monthly Trainee Report
- Work Hours
 - Work hours are limited to between 7:00 am and 6:00 pm Monday through Friday.
 - Work hours can be extended to 9:00 pm solely for the purpose of making the initial saw cuts for jointing newly placed pavement.
 - Work hour restrictions include equipment startup, deliveries, and loading/unloading equipment.

- Trees
 - Replacement (JSP R): Coordinate with owners to select replacement tree species.
 - In conjunction with the construction notice, City will request residents select replacement tree species and notify the City and/or Contractor.
 - Clearing and Protection (JSP S): Protection of tree to remain is critical.
- Truck Restrictions (JSP VV)
 - All loads are restricted to a maximum gross vehicle weight of 65,000 pounds. Concrete trucks are limited to a maximum load of 8 cubic yards. These restrictions will be enforced.
- Testing and Inspection (See JSP YY)
 - HR Green will provide construction inspection and is responsible for materials testing. There will also be a City inspector assigned to the project.
 - Subgrade must be compacted and observed prior to placement of fabric and base rock. Unsuitable subgrade will be removed and replaced.
 - Base rock must be tested for proper compaction and thickness prior to concrete placement.
 - Concrete cylinders will be made with each pour. At a minimum 2 cylinders will be tested at each of the following times: 3 days, 5 days, and 28 days. Additional cylinders can be prepared at the contractor's request for early strength tests. Pavement may be cored after a phase has been completed to check pavement thickness.
 - A straight edge will be run along the traffic lanes to test smoothness of the pavement. See JSP W.
- Concrete (See JSP HH)
 - Full depth saw cuts are required at the limits of removal.
 - The addition of a finishing aid to the surface of freshly placed concrete will not be permitted. The use of a 10 foot paver's straightedge will be required on all pours. The use of a Fresno paddle is required.
 - 7" PCC pavement (Type B longitudinal joints).
 - Damaged and Defective Pavement (JSP HH, 8.0)
 - Damaged and defective pavement requiring replacement shall be replaced with a high early strength concrete mix.
 - The high early mix has minimum strengths of 2,500 in 24 hours and 3,000 in 48 hours.
 - Replacement slabs not meeting these requirements will be deducted from the pay quantities
- Storm Sewer and Inlets
 - New storm sewer subject to MSD permit and inspection
 - Underdrains are to be installed as shown on the drawings and at locations directed by

- the inspector.
- Rebuilding or replacing inlet sill, top, and/or adjustments to grade, will be determined after excavation of the pavement.
- Grated Trough (JSP SS): Includes all items necessary for Grated Trough (inlet, A2 joints, etc.)
- Backfill (JSP HH, 6.0) and Amended Soils (JSP M)
 - Backfill behind curbs is required before opening the pavement to traffic and excavation of the opposite side of the street. Backfill shall be compacted. Backfill includes filling isolated low spots between the back of curb and sidewalk to promote proper drainage.
 - Amended Soils: 2” thick compost layer tilled in to backfill.
- Dry Swale with Underdrain (JSP N)
 - Includes all elements necessary for construction including excavation, piping, bioretention media, sand, gravel, observation well, and piping.
 - Protect from any runoff and sediment until roadway is complete.
- Driveway Access (JSP AA)
 - Work must progress so that no residential driveway is out of service more than 10 days.
 - Several driveways must remain accessible throughout construction.
 - In the event of rain that would extend a closure beyond 10 days, driveways must be rocked in to allow residents entry to their driveway unless otherwise approved by the resident.
 - Commercial driveways shall remain open unless other arrangements are approved in writing with the property owner.
- Stormwater Pollution Prevention Plan (JSP PP)
 - Contractor is responsible for SWPPP installation, maintenance, and removal.
 - DNR Permit
 - Weekly inspection shall be conducted and reports submitted to the City.
- Sidewalk and Curb Ramps (JSP J)
 - Remove and replace nearly all existing 4’ sidewalk with new 5’ wide sidewalk.
 - Sidewalk and curb ramps must meet ADA requirements.
 - Contractor is responsible for layout and compliance, inspectors will assist.

QUESTIONS