



**ADDENDUM NO. 1**

Issued: May 24, 2016

\_\_\_\_\_  
Name of Bidder

Receipt acknowledged by  
\_\_\_\_\_

To: Holders of Plans, Contract Documents & Specifications for Route 66 Bridge Replacement  
in Jasper County, MO

Planholders:

This Addendum is hereby made a part of the Contract Documents to the same extent as if they were originally included herein. This Addendum shall be inserted in the Contract Documents and shall be executed and submitted with the Bid. This Addendum includes the following:

Contract Documents

1. ITEMIZED BID SCHEDULE, page 8: BIDDERS are instructed to remove page 8 and replace with page 8 (ADDENDUM No. 1) enclosed herewith. Bid Item Number 4R-A Item Code 205-10.10 Modified Subgrade (Geogrid) has been added to include installation and payment for Geogrid as indicated on Drawing Number 6.
2. State Wage Rates-Missouri Department Of Labor Standards – Annual Wage Order No. 23 has been issued since the project was originally advertised. The enclosed State Wage Orders shall now apply to the project and supersede what was included in the original bid documents.

Job Special Provisions (JSP)

1. JSP SECTIONS AD. & AE.: Pages 20 (ADDENDUM No. 1) and 21 (ADDENDUM No. 1) shall be added to include sections “AD. Geotextile Fabric for Use Under Rock Blanket” and “AE. Geogrid for Modified Subgrade.” These paragraphs describe allowable materials, certifications, construction requirements, and measurement and payment of work for these items specified.

Drawings

1. Drawing Number 7: BIDDERS are instructed to remove Drawing Number 7 and replace with Drawing Number 7 (ADDENDUM No. 1) enclosed herewith. The route signs used on the detour shall be the historical route designation signs.

Sincerely,

**ALLGEIER, MARTIN and ASSOCIATES, INC.**



Blake Watson, E.I.  
Project Manager

BW  
Enclosure

**ITEMIZED BID SCHEDULE**

The bidder shall complete the following section in accordance with Sec 102.7. The bidder proposes to furnish all labor, materials, equipment, services, etc. required for the performance and completion of the work, as follows:

<b>Section Title</b>	<b>Line Item</b>	<b>Item Code</b>	<b>Item Description</b>	<b>UofM</b>	<b>Quantity</b>	<b>Unit Price</b>	<b>Extension</b>	
<b><u>ROADWAY ITEMS</u></b>								
	1R	201-99.01	Clearing & Grubbing	LS	1	\$	\$	
	2R	202-20.10	Removal Of Improvements	LS	1	\$	\$	
	3R	203-50.00	Unclassified Excavation	CY	545	\$	\$	
	4R	203-55.00	Embankment In Place	CY	128	\$	\$	
	4R-A	205-10.10	Modified Subgrade (Geogrid)	SY	758	\$	\$	
	5R	207-10.00	Linear Grading Class 1	STA	4.0	\$	\$	
	6R	304-01.63	Type I Aggregate For Base, 6" Thick	SY	831	\$	\$	
	7R	401-99.10	Bituminous Pavement	Tons	252	\$	\$	
	8R	606-23.00A	Transition Section 6.5 Ft. Posts	EA	4	\$	\$	
	9R	606-30.00A	Terminal Section - Guardrail (Turned-Down End)	EA	4	\$	\$	
	10R	607-99.01	Fence Anchor Post	EA	5	\$	\$	
	11R	607-99.03	Permanent Fence (5-Strand Barbed Wire)	LF	200	\$	\$	
	12R	607-99.06	Double Grate and Post Assembly	LS	1	\$	\$	
	13R	611-30.20	Furnish Type 2 Rock Blanket	CY	543	\$	\$	
	14R	611-30.40	Placing Type 2 Rock Blanket	CY	543	\$	\$	
	15R	616-10.05	Construction Signs	SF	265	\$	\$	
	16R	616-10.30	Type III Movable Barricade	EA	6	\$	\$	
	17R	616-10.47	Type III Object Markers	EA	4	\$	\$	
	18R	618-10.00	Mobilization	LS	1	\$	\$	
	19R	620-61.50A	4" White Acrylic Copolymer Fast Dry Pavement Marking Paint	LF	800	\$	\$	
	20R	620-61.51A	4" Yellow Acrylic Copolymer Fast Dry Pavement Marking Paint	LF	400	\$	\$	
	21R	624-01.03A	Permanent Erosion Control Geotextile	SY	948	\$	\$	
	22R	627-40.00	Contractor Furnished Surveying & Staking	LS	1	\$	\$	
	23R	805-99.19	Seeding & Mulching	Acre	0.71	\$	\$	
	24R	808-99.03	Fiber Roll Erosion Control	LF	571	\$	\$	
<b>Total Bid Amount For Roadway Items</b>								<b>\$</b>

# Missouri

## Division of Labor Standards

WAGE AND HOUR SECTION



JEREMIAH W. (JAY) NIXON, Governor

## Annual Wage Order No. 23

Section 049

**JASPER COUNTY**

In accordance with Section 290.262 RSMo 2000, within thirty (30) days after a certified copy of this Annual Wage Order has been filed with the Secretary of State as indicated below, any person who may be affected by this Annual Wage Order may object by filing an objection in triplicate with the Labor and Industrial Relations Commission, P.O. Box 599, Jefferson City, MO 65102-0599. Such objections must set forth in writing the specific grounds of objection. Each objection shall certify that a copy has been furnished to the Division of Labor Standards, P.O. Box 449, Jefferson City, MO 65102-0449 pursuant to 8 CSR 20-5.010(1). A certified copy of the Annual Wage Order has been filed with the Secretary of State of Missouri.

Original Signed by

John E. Lindsey, Director  
Division of Labor Standards

This Is A True And Accurate Copy Which Was Filed With The Secretary of State: **March 10, 2016**

Last Date Objections May Be Filed: **April 11, 2016**

Prepared by Missouri Department of Labor and Industrial Relations

OCCUPATIONAL TITLE	** Date of Increase	*	Basic Hourly Rates	Over-Time Schedule	Holiday Schedule	Total Fringe Benefits
Asbestos Worker (H & F) Insulator			\$25.47	56	28	\$11.25
Boilermaker			\$34.76	57	7	\$28.00
Bricklayer and Stone Mason			\$27.52	24	74	\$15.78
Carpenter			\$22.95	6	63	\$15.10
Cement Mason			\$23.54	64	4	\$10.35
Communication Technician			\$26.46	27	9	\$12.075 + 8%
Electrician (Inside Wireman)			\$26.46	27	9	\$12.075 + 8%
Electrician (Outside-Line Construction)\Lineman			\$41.52	125	65	\$5.00 + 34.5%
Lineman Operator			\$38.37	125	65	\$5.00 + 34.5%
Groundman			\$26.76	125	65	\$5.00 + 34.5%
Elevator Constructor		a	\$43.620	26	54	\$29.956
Glazier			\$23.35	36	52	\$6.21
Ironworker			\$31.25	50	4	\$27.90
Laborer (Building):						
General			\$20.35	29	64	\$11.47
First Semi-Skilled			\$20.35	29	64	\$11.47
Second Semi-Skilled			\$20.35	29	64	\$11.47
Lather			USE CARPENTER RATE			
Linoleum Layer and Cutter			\$24.24	123	78	\$15.10
Marble Mason			\$21.66	124	74	\$12.68
Marble Finisher			\$14.14	124	74	\$9.08
Millwright			\$22.95	6	63	\$15.10
Operating Engineer						
Group I			\$26.00	84	4	\$12.23
Group II			\$24.31	84	4	\$12.23
Group III			\$23.60	84	4	\$12.23
Group III-A			\$24.31	84	4	\$12.23
Group IV						
Group V			\$15.60	84	4	\$12.23
Painter			\$27.71	37	4	\$15.84
Pile Driver			\$22.95	6	63	\$15.10
Pipe Fitter		b	\$28.95	19	1	\$14.67
Plasterer			\$23.53	64	4	\$10.55
Plumber		b	\$28.95	19	1	\$14.67
Roofer \ Waterproofor			\$22.50	10	2	\$10.38
Sheet Metal Worker			\$28.90	4	24	\$13.92
Sprinkler Fitter - Fire Protection			\$32.39	33	19	\$19.05
Terrazzo Worker			\$28.73	124	74	\$14.38
Terrazzo Finisher			\$18.68	124	74	\$14.38
Tile Setter			\$21.66	124	74	\$12.68
Tile Finisher			\$14.14	124	74	\$9.08
Traffic Control Service Driver			\$16.35	48	49	\$2.75
Truck Driver-Teamster						
Group I			\$28.57	31	35	\$12.05
Group II			\$28.73	31	35	\$12.05
Group III			\$28.72	31	35	\$12.05
Group IV			\$21.40	FED		\$6.66

Fringe Benefit Percentage is of the Basic Hourly Rate

\*\*Annual Incremental Increase

OCCUPATIONAL TITLE	** Date of Increase	Basic Hourly Rates	Over-Time Schedule	Holiday Schedule	Total Fringe Benefits

\* Welders receive rate prescribed for the occupational title performing operation to which welding is incidental.

Use Building Construction Rates on Building construction in accordance with the classifications of construction work established in 8 CSR 30-3.040(2).

Use Heavy Construction Rates on Highway and Heavy construction in accordance with the classifications of construction work established in 8 CSR 30-3.040(3).

a - Vacation: Employees over 5 years - 8%; Employees under 5 years - 6%

b - On all work over \$750,000 Total Mech Cost - \$28.95, Fringes - \$14.67

On all work under \$750,000 Total Mech Cost - \$25.98 Fringes - \$14.67

**REPLACEMENT PAGE  
JASPER COUNTY  
BUILDING CONSTRUCTION - OVERTIME SCHEDULE**

**FED:** Minimum requirement per Fair Labor Standards Act means time and one-half (1 ½) shall be paid for all work in excess of forty (40) hours per work week.

**NO. 4:** Means the regular working day shall consist of eight (8) hours labor on the job between six (6) a.m. and six-thirty (6:30) p.m. and the work week shall consist of five (5) consecutive eight (8) hour days beginning on Monday and ending with Friday of each week. All full time or part time labor performed during such hours shall be recognized as regular working hours and paid for at the regular hourly rate. Also, there may be a 40-hour work week which would consist of ten (10) hours each day for Monday, Tuesday, Wednesday, Thursday or Friday. The first two (2) hours performed in excess of an eight (8) hour workday, Monday through Friday, and the first ten (10) hours on Saturday, shall be paid at one and one half (1½) times the regular rate of pay. All work performed on Sundays and Holidays and in excess of ten (10) hours a day on all days shall be paid at two (2) times the regular rate of pay. A make-up day may be scheduled for work missed due to inclement weather. The make-up hours shall be paid at the regular hourly rate of pay.

**NO. 6:** Means eight (8) hours shall constitute a standard work day, and forty (40) hours per week shall constitute a week's work. All time worked outside of the standard work day and on Saturday shall be classified as overtime and paid the rate of time and one-half (1½). All work done on Sunday and recognized holidays must be paid for at the double (2) time rate. The Employer shall have the option of working five (5) eight (8) hour days or four (4) ten (10) hour days to constitute a normal forty (40) hour work week. Work in excess of eight (8) hours per day (when working 5-8's) or ten (10) hours per day (when working 4-10's) or forty (40) hours per week shall be paid at the overtime rate of time and one-half (1½). When the four (4) day ten (10) hour work week is in effect, the standard work week shall consist of forty (40) hours, Monday through Friday, which will consist of any four (4) ten (10) hour days within the five (5) day period. In the event the job is down for any reason beyond the control of the Employer, then Friday and/or Saturday may, at the option of the Employer, be worked as a make-up day, straight time not to exceed ten (10) hours per day or forty (40) hours per week. Starting time will be designated by the Employer. When the five (5) day eight (8) hour work week is in effect, forty (40) hours per week shall constitute a week's work, normal work week being Monday through Friday. In the event the job is down for any reason beyond the control of the Employer, then Saturday may, at the option of the Employer, be worked as a make-up day at straight time not to exceed eight (8) hours per day or forty (40) hours per week. In instances where work days are lost due to circumstances beyond the Contractor's control, make-up days may be used. Scheduling conflicts are not valid reasons. Make-up days are not to be used to make up lost time due to recognized holidays.

**NO. 7:** Means work between the hours of 7:00 a.m. and 6:00 p.m. daily, Monday through Saturday, as assigned by the Employer shall be considered regular hours. Weekend work shall be paid at the rate of one and one-half (1 ½) times the regular rate of pay. Weekend begins 12:01 a.m. Saturday. Overtime is time worked over forty (40) hours per pay period, and shall be paid at the rate of one and one-half (1½) times the regular rate of pay. Sunday and Holidays will be paid at the rate of two (2) times the regular rate of pay.

**NO. 10:** Means the regular working day shall be scheduled to consist of at least eight (8) hours but no more than ten (10) consecutive hours, exclusive of the lunch period, unless otherwise provided. Crews shall be scheduled to commence at any time between the hours of 5:00 a.m. and 10:00 a.m. or earlier if agreed on by the majority of any one crew. Except as specifically provided for Saturdays, Sundays and holidays, all work performed by Employees anywhere in excess of forty (40) hours in one (1) work week, or in excess of ten (10) hours in one work day shall be paid at the rate of one and one-half (1½) times the regular hourly wage scale. Any work performed on a Saturday shall be paid at the rate of one and one-half (1½) times the regular hourly wage scale unless such Saturday work falls under the category of Saturday make Up Day. When this Saturday Make Up Day does occur, the Employee may work on Saturday at straight time; provided, however, if during the period worked by said Employee on Saturday, the Employee's compensable time at the straight time rate exceeds forty (40) hours, all time worked in excess of the forty (40) hours will be paid at the rate of one and one-half (1½) time the regular hourly wage scale. The provision of this Saturday Make Up Day shall not apply to any weeks in which a designated holiday is recognized. Any work performed by Employees anywhere on Sunday or holidays shall be paid at the rate of double (2) time the regular wage scale.

**REPLACEMENT PAGE  
JASPER COUNTY  
BUILDING CONSTRUCTION - OVERTIME SCHEDULE**

**NO. 19:** On single shift operation, eight (8) hours of work, between 8:00 a.m. and 4:30 p.m., shall constitute a day's work. Forty (40) hours of work Monday through Friday shall constitute a workweek. The starting time may be changed to begin between the hours of six (6:00) and ten (10:00) a.m. The first two (2) hours performed in excess of an eight (8) hour workday Monday through Friday, and the first ten (10) hours on Saturday, shall be paid at time and one-half (1.5) the basic straight-time rate. All work performed on Sundays and holidays, and in excess of ten (10) hours a day shall be paid at double (2) the basic straight time rate of pay. When hours worked are outside of established work hours, the pay rate shall be one and one-half (1.5) times the regular rate of pay for the first ten (10) hours, and all hours in excess of ten (10) hours shall be at the double-time rate. Shift work of either one (1) eight hour night shift, or two (2) eight (8) hour night shifts on a job which will continue for at least one (1) week, all employees shall be paid eighteen and one-half percent (18.5%) over the straight-time hourly rate on the night shifts. All hours worked in excess of eight (8) in a shift shall be paid at the applicable overtime rate of pay. The normal workweek may be changed to four (4) ten (10) hour days or four (4) ten (10) hour nights, if on shift work, with the following provisions: Monday through Thursday would be the normal workweek with Friday being used as scheduled workday in case of a day being lost due to weather, all employees working night shift, on a job that will continue at least one (1) week, shall be paid thirty percent (30%) over the regular straight-time hourly rate of pay, and any hours worked before or after established starting and quitting times being paid at double (2) time hourly rates of pay.

**NO. 24:** Means eight (8) hours shall constitute a day's work on all classes of work between the hours of 6:00 a.m. and 5:30 p.m., Monday through Friday. The pay for time worked during these hours shall be at the regular wage rate. The regular workweek shall be Monday through Friday. A workweek of four (4), ten (10) hour days may be established on a per job basis. Saturday may be used for a make-up day, when working 5-8's, Friday when working 4-10's. All time worked before and after the established workday of eight (8) hours, Monday through Friday, and all time worked on Saturday shall be paid for at the rate of time and one-half (1½) except after eight (8) hours worked, then double (2) time will apply. All time worked on Sundays and the recognized holidays shall be paid at the rate of double (2) time.

**NO. 26:** Means that the regular working day shall consist of eight (8) hours worked between 6:00 a.m., and 5:00 p.m., five (5) days per week, Monday to Friday, inclusive. Hours of work at each jobsite shall be those established by the general contractor and worked by the majority of trades. (The above working hours may be changed by mutual agreement). Work performed on Construction Work on Saturdays, Sundays and before and after the regular working day on Monday to Friday, inclusive, shall be classified as overtime, and paid for at double (2) the rate of single time. The employer may establish hours worked on a jobsite for a four (4) ten (10) hour day work week at straight time pay for construction work; the regular working day shall consist of ten (10) hours worked consecutively, between 6:00 a.m. and 6:00 p.m., four (4) days per week, Monday to Thursday, inclusive. Any work performed on Friday, Saturday, Sunday and holidays, and before and after the regular working day on Monday to Thursday where a four (4) ten (10) hour day workweek has been established, will be paid at two times (2) the single time rate of pay. The rate of pay for all work performed on holidays shall be at two times (2) the single time rate of pay.

**NO. 27:** Means eight (8) hours of work between the hours of eight (8:00) a.m. and four-thirty (4:30) p.m. shall constitute a work day. Forty (40) hours within five (5) days - Monday through Friday, inclusive - shall constitute a work week. The regular starting time in the morning may be moved not more than one hour prior to 8:00 a.m.; however, in no case shall more than eight (8) hours be worked per day without the applicable overtime rate being paid. When job conditions dictate and as required by the employer, the employer shall be allowed to establish a four (4) day, ten (10) hour per day work week. This work week is defined as Monday through Thursday, with a Friday make-up day. The normal work day under a ten (10) hour four (4) day work week shall be from 8:00 a.m. to 6:30 p.m., with a one hour starting variance. The make-up day of Friday shall be instituted for specific reasons such as loss of production due to weather and Holidays. All hours worked in excess of ten (10) hours per day or forty (40) hours per week or hours worked outside the normal work week shall be paid at the applicable overtime rate. This language is not intended to change the normal five (5) day, eight (8) hours per day work week. All overtime work after a regular work day, (8) hours, Monday through Friday shall be paid at time and one-half (1½). All hours worked on Saturday shall be paid at time and one-half (1½). All other overtime on Sunday and recognized holidays shall be paid for at double (2) the straight-time rate of pay. Shift work performed between the hours of 4:30 p.m. and 1:00 a.m. (second shift) shall receive eight (8) hours pay at the regular hourly rate of pay plus 17.3% for all hours worked. Shift work performed between the hours of 12:30 a.m. and 9:00 a.m. (third shift) shall receive eight (8) hours pay at the regular hourly rate of pay plus 31.4% for all hours worked. A lunch period of thirty (30) minutes shall be allowed on each shift. All overtime work required after the completion of a regular shift shall be paid at one and one-half (1½) times the shift hourly rate.



**REPLACEMENT PAGE  
JASPER COUNTY  
BUILDING CONSTRUCTION - OVERTIME SCHEDULE**

**NO. 29:** Means eight (8) hours shall constitute a day's work and shall be from 8:00 a.m. to 4:30 p.m., Monday through Friday. Starting time may be advanced or delayed by the employer up to two (2) hours from the regular starting time. Any hours worked in excess of eight (8) hours shall be paid for at one and one-half (1½) times the regular rate of pay. The employer may establish a 4-10's schedule on projects (4 days with 10 hours per day). If using a 4-10's schedule, a Friday make-up day is allowed. If using a 4-10's schedule, any work more than ten (10) hours in a day or forty (40) hours in a work week shall be paid at the time and one-half (1½) rate. Friday make-up days shall not be used to make up for time lost due to recognized holidays. All hours worked between 4:30 p.m. Friday and 4:30 p.m. Saturday shall be paid for at the rate of time and one half. All hours worked from 4:30 p.m. Saturday until 8:00 a.m. Monday and all holidays shall be paid for at double (2) the regular rate of pay. Employees failing to work a regular forty (40) hour week due to inclement weather may work on Saturday at the regular rate of pay.

**NO. 31:** Means a regular work week shall consist of not more than forty (40) hours of work and all work performed over and above ten (10) hours per day and forty (40) hours per week shall be paid at the rate of time and one-half (1½). A workday is to begin between 6:00 a.m. and 9:00 a.m. at the option of the Employer except when inclement weather or other conditions beyond the reasonable control of the Employer, in which event, the starting time may be advanced or delayed. Work performed on recognized holidays or days observed as such, shall receive time and one-half (1½).

**NO. 33:** Means the standard work day and week shall be eight (8) consecutive hours of work between the hours of 6:00 a.m. and 6:00 p.m., excluding the lunch period Monday through Friday, or shall conform to the practice on the job site. Four (4) days at ten (10) hours a day may be worked at straight time, Monday through Friday and need not be consecutive. All overtime, except for Sundays and holidays shall be at the rate of time and one-half (1½). Overtime worked on Sundays and holidays shall be at double (2) time.

**NO. 36:** Means eight (8) hours shall constitute a work day, Monday through Friday between the hours of 6:00 a.m. and 6:00 p.m. Saturday can be used as a makeup day if time is lost due to weather. All hours in excess of the regular forty (40) hour work week or eight (8) hours per day shall be considered overtime and shall be paid for at the rate of one and one-half (1½) times the regular rate. Employees will be paid at the rate of one and one-half (1½) times their regular rate for work performed on Saturdays. Sundays and holidays worked are to be paid at double (2) the regular hourly rate. Four (4) ten-hour days, at the option of the Employer, shall be the standard work week, consisting of a consecutive ten-hour period, Monday through Thursday or Tuesday through Friday, between the hours of 6:00 a.m. and 6:00 p.m. Forty (40) hours per week shall constitute a week's work.

**NO. 37:** The Employer may choose, at his discretion, to work five eight hour days or four ten hour days with a Friday make-up day, Monday through Friday at straight time. Overtime shall be paid after eight (8) hours when working "five eights" and after ten hours when working "four tens". All work performed on Sundays and recognized holidays shall be paid for at the rate of double (2) time. All Saturday work shall be paid for at the rate of time and one-half (1½) the regular wage rate. All night work during the regular work week other than the above-mentioned days shall be paid for at the rate of time and one-half (1½) the regular wage scale until midnight and double (2) time after midnight except make-up time will be allowed under the following condition: In the event of inclement weather on exterior projects which prevents working the full regular eight (8) hour day, forty (40) hour work week schedule, a Saturday make-up day can be granted. Then said work on Saturday shall be paid at the straight time rate of pay up to a maximum total of forty (40) hours per week.

**NO. 48:** Means the regularly scheduled work week shall be five (5) consecutive days, Monday through Friday or Tuesday through Saturday. Eight (8) hours shall constitute a day's work. Starting time shall not be earlier than 7:00 a.m. nor later than 10:00 a.m. Forty (40) hours shall constitute a week's work. Overtime at the rate of time and one-half (1½) will be paid for all work in excess of forty (40) hours in any one work week. On the Monday through Friday schedule, all work performed on Saturday will be time and one-half (1½) unless time has been lost during the week, in which case Saturday will be a make up day to the extent of the lost time. On the Tuesday through Saturday schedule, all work performed on Monday will be time and one-half (1½) unless time has been lost during the week, in which case Monday will be a make-up day to the extent of the lost time. Any work performed on Sunday will be double (2) time. If employees work on any of the recognized holidays, they shall be paid time and one-half (1½) their regular rate of pay for all hours worked.

**REPLACEMENT PAGE  
JASPER COUNTY  
BUILDING CONSTRUCTION - OVERTIME SCHEDULE**

**NO. 50:** Means eight (8) hours constitute a normal day's work Monday through Friday. Any time worked over eight (8) hours will normally be paid at time and one-half (1½) except for exclusions stated in some following additional sentences. The Employer, at his discretion, may start the work day between 6:00 a.m. and 9:00 a.m. Any schedule chosen shall be started at the beginning of the work week (Monday) and used for at least five days. Work may be scheduled on a four (4) days a week (Monday through Thursday) at ten (10) hours a day schedule. If such a schedule is employed, then Friday may be used as a make-up day when time is lost due to inclement weather. Time and one-half (1½) shall be paid for any work in excess of eight (8) hours in any regular work day Monday through Friday unless working 4-10's, then time and one-half (1½) after ten (10) hours. All work performed on Saturday will be time and one-half (1½). Double (2) time shall be paid for all work on Sundays and recognized holidays.

**NO 56:** Means the regular work day shall consist of eight (8) hours between 8:00 a.m. and 4:30 p.m. An optional four day work week may be utilized with the ten (10) hour clause, days Monday through Thursday or Tuesday through Friday. Work hours shall be from 7:00 a.m. to 5:30 p.m. any work performed on Monday or Friday outside the regular scheduled four (4) days shall be at one and one half (1 ½) the regular rate of pay. Work performed outside of the regular work day, and on Saturdays shall be paid at one and one half (1 ½) the regular rate of pay. Sundays and holidays shall be paid at double (2) time the regular rate of pay.

**NO. 57:** Means eight (8) hours per day shall constitute a day's work and forty (40) hours per week, Monday through Friday, shall constitute a week's work. The regular starting time shall be 8:00 a.m. If a second or third shift is used, the regular starting time of the second shift shall be 4:30 p.m. and the regular starting period for the third shift shall be 12:30 a.m. These times may be adjusted by the employer. The day shift shall work a regular eight (8) hours shift as outlined above. Employees working a second shift shall receive an additional \$0.25 above the regular hourly rate and perform seven and one-half (7½) hours work for eight (8) hours pay. Third shift employees shall be paid an additional \$0.50 above the regular hourly rate and work seven (7) hours for eight (8) hours pay. When circumstances warrant, the Employer may change the regular workweek to four (4) ten-hour days at the regular time rate of pay. All time worked before and after the established workday of eight (8) hours, Monday through Friday, and all time worked on Saturday shall be paid at the rate of time and one-half (1½) except in cases where work is part of an employee's regular Friday shift. All time worked on Sunday and recognized holidays shall be paid at the double (2) time rate of pay except in cases where work is part of an employee's previous day's shift. For all overtime hours worked \$26.71 of the fringe benefits portion of the prevailing wage shall be paid at the same overtime rate at which the cash portion of the prevailing wage is to be paid. The remaining \$1.24 of the fringe benefit portion of the prevailing wage may be paid at straight time.

**NO. 64:** Means eight (8) hours shall constitute a day's work beginning at 8:00 a.m. and ending at 4:30 p.m. Forty (40) hours shall constitute a week's work, Sunday through Saturday. In the event time is lost due to weather or conditions beyond the control of the Employer, the Employer may schedule work on Saturday at straight time. All work over eight (8) hours in one day, forty (40) hours in one week, or on Saturday (except as herein provided) shall be classified as overtime and be paid at the rate of time and one-half (1½). All work on Sunday or recognized holidays shall be classified as overtime and be paid at the rate of double (2) time. When the four (4) day ten-hour work week is in effect, the standard work day shall be consecutive ten (10) hour periods. Forty (40) hours per week shall constitute a week's work Sunday through Saturday inclusive. In the event the job is down for reasons beyond the contractors control, then Friday and/or Saturday may, at the option of the Employer be worked as a make-up day, straight time not to exceed ten (10) hours per day or forty (40) hours per week.

**REPLACEMENT PAGE  
JASPER COUNTY  
BUILDING CONSTRUCTION - OVERTIME SCHEDULE**

**NO. 84:** The regular working starting time of 8:00 a.m. (and resulting quitting time of 4:30 p.m.) may be moved forward to 6:00 a.m. or delayed one (1) hour to 9:00 a.m. Except as provided in this Article, eight (8) hours a day shall constitute a standard work day and forty (40) hours per week shall constitute a weeks' work, which shall begin on Sunday and end on Saturday. All time worked outside of the standard work day and on Saturday shall be classified as overtime and paid at the rate of time & one-half (1½) (except as herein provided). All time worked on Sunday and recognized holidays shall be classified as overtime and paid at the rate of double (2) time. The Employer has the option of working either five (5) eight-hour days or four (4) ten-hour days to constitute a normal forty (40) hour work week. When the four (4) ten-hour work week is in effect, the standard work day shall be consecutive ten (10) hour periods, exclusive of the lunch period, beginning at 6:30 a.m. and forty (40) hours per week shall constitute a week's work, Monday through Thursday, inclusive. In the event the job is down for any reason beyond the Employer's control, then Friday and/or Saturday may, at the option of the Employer, be worked as a make-up day, straight time not to exceed ten (10) hours or forty (40) hours per week. When the five (5) eight-hour work week is in effect, forty (40) hours per week shall constitute a week's work, Monday through Friday, inclusive. In the event the job is down for any reason beyond the Employer's control, then Saturday may, at the option of the Employer, be worked as a make-up day, straight time not to exceed eight (8) hours or forty (40) hours per week.

**NO. 123:** Means except as provided, eight (8) hours a day (8:00 A.M. to 4:30 P.M.) shall constitute a standard work day, excluding the 30-minute lunch period, and forty (40) hours per week shall constitute a week's work. All time worked outside of the standard work day and on Saturday shall be classified as overtime and paid the rate of time and one-half (except as herein provided). All time worked on Sunday and herein named holidays shall be classified as overtime and paid at the rate of double time. The Employer has the option of working either five (5) eight-hour days or four (4) ten-hour days to constitute a normal forty (40) hour work week. When the four (4) day ten-hour work week is in effect, the standard work week shall consist of forty (40) hours, Monday through Friday, which will consist of any four (4) consecutive ten (10) hour days within the five day period. In the event the job is down for any reason beyond the control of the Employer, then Friday and/or Saturday may, at the option of the Employer, be worked as a make-up day, straight time not to exceed ten (10) hours or forty (40) hours per week. Starting time will be designated by the Employer. When the five (5) day eight (8) hour work week is in effect forty (40) hours per week will constitute a week's work (normal work week being Monday through Friday). In the event the job is down for any reason beyond the control of the Employer, then Saturday may, at the option of the Employer, be worked as a make-up day; at straight time not to exceed eight (8) hours or forty (40) hours per week.

**NO. 124:** Means eight (8) hours shall constitute a day's work on all classes of work between the hours of 6:00 a.m. and 5:30 p.m., Monday through Friday. The pay for time worked during these hours shall be at the regular wage rate. The regular workweek shall be Monday through Friday. Employment from 4:30 p.m. to 12:00 midnight, Monday through Friday, shall be paid for at one and one-half (1½) times the regular hourly rate. From 12:00 midnight until 8:00 a.m. on any day shall be paid for at twice the regular hourly rate. All time worked on Sundays and the recognized holidays shall be paid at the rate of double (2) time. It is understood that forty (40) hours shall constitute a regular workweek, (5-8's) Sunday Midnight through Friday Midnight, understanding anything over eight (8) hours is one and one-half (1½) times the hourly wage rate.

**NO. 125:** Eight (8) hours of work between the hours of 8:00 a.m. and 4:30 p.m. shall constitute a work day. Forty (40) hours within the five (5) days, Monday through Friday inclusive, shall constitute the work week. Starting time may be adjusted not to exceed two (2) hours. Work performed outside of the aforementioned will be paid at the applicable overtime rate. When starting time has been adjusted, all other provisions concerning the work day shall be adjusted accordingly. The overtime rate of pay shall be one and one-half (1½) times the regular rate of wages, other than on Sundays, holidays and from Midnight until 6:00 a.m., which will be paid at double (2) the straight time rate.

**JASPER COUNTY  
HOLIDAY SCHEDULE – BUILDING CONSTRUCTION**

**NO. 1:** All work done on New Year's Day, Decoration Day, Independence Day, Labor Day, Thanksgiving Day and Christmas Day shall be paid at the rate of double time. When one of the above holidays falls on Sunday, the following Monday shall be observed. When one of the above holidays falls on Saturday the preceding Friday shall be observed.

**NO. 2:** All work performed on New Year's Day, Memorial Day, Fourth of July, Labor Day, Thanksgiving Day, Christmas Day, or the days observed as such, shall be paid at the double time rate of pay.

**NO. 4:** All work done on New Year's Day, Memorial Day, Independence Day, Labor Day, Thanksgiving and Christmas Day shall be paid at the double time rate of pay. If any of the above holidays fall on Sunday, Monday will be observed as the recognized holiday. If any of the above holidays fall on Saturday, Friday will be observed as the recognized holiday and holidays falling on Sunday will be observed on the following Monday.

**NO. 7:** The following days are assigned days and are recognized as holidays: New Year's Day, Memorial Day, Independence Day, Labor Day, Veteran's Day, Thanksgiving Day, and Christmas Day. If a holiday falls on a Sunday, it shall be observed on the following Monday. If a holiday falls on a Saturday, it shall be observed on the preceding Friday. No work shall be performed on Labor Day except in case of jeopardy to work under construction. This is applied to protect Labor Day. When a holiday falls during the normal workweek, Monday through Friday, it shall be counted as eight (8) hours toward the forty (40) hour week. However, no reimbursement for these eight (8) hours is to be paid to the workman unless worked. If workman are required to work the above enumerated holidays or days observed as such, or on Sunday, they shall receive double (2) the regular rate of pay for such work.

**NO. 9:** All work performed on New Year's Day, Memorial Day, Fourth of July, Labor Day, Thanksgiving Day and Christmas Day shall be paid for at the double time rate of pay. Any one of the above listed holidays falling on Sunday shall be observed on the following Monday and paid at the double time rate of pay as all observed holidays, if worked.

**NO. 19:** All work done on New Year's Day, Memorial Day, July 4th, Labor Day, Thanksgiving Day, and Christmas Day shall be paid at the double time rate of pay. The employee may take off Friday following Thanksgiving Day. However, the employee shall notify his or her Foreman, General Foreman or Superintendent on the Wednesday preceding Thanksgiving Day. When one of the above holidays falls on Sunday, the following Monday shall be considered a holiday and all work performed on either day shall be at the double (2) time rate. When one of the holidays falls on Saturday, the preceding Friday shall be considered a holiday and all work performed on either day shall be at the double (2) time rate.

**NO. 14:** The following days are recognized Holidays: Memorial Day, Fourth of July, Thanksgiving Day, Christmas Day, and New Year's Day. No work shall be done on Labor Day. When falling on a Sunday and the following Monday is observed as part of the holiday, then that Monday shall be considered a holiday. Sunday and Holidays will be paid at the rate of two (2) times the regular rate of pay.

**NO. 19:** All work done on New Year's Day, Memorial Day, July 4th, Labor Day, Thanksgiving Day, and Christmas Day shall be paid at the double time rate of pay. The employee may take off Friday following Thanksgiving Day. However, the employee shall notify his or her Foreman, General Foreman or Superintendent on the Wednesday preceding Thanksgiving Day. When one of the above holidays falls on Sunday, the following Monday shall be considered a holiday and all work performed on either day shall be at the double (2) time rate. When one of the holidays falls on Saturday, the preceding Friday shall be considered a holiday and all work performed on either day shall be at the double (2) time rate.

**NO. 24:** All work done on Christmas Day, Thanksgiving Day, New Year's Day, Memorial Day, Independence Day, Labor Day, Veteran's Day, Presidential Election Day or days locally observed as such, and Sunday shall be recognized as holidays and paid at the double time rate of pay.

**NO. 28:** All work done on New Year's Day, Veteran's Day, Memorial Day, Independence Day, Thanksgiving Day and Christmas Day shall be paid at the double time rate of pay. No work shall be performed on Labor Day except when triple (3) time is paid. When a holiday falls on Sunday, the following Monday shall be observed as the holiday.

## **JASPER COUNTY HOLIDAY SCHEDULE – BUILDING CONSTRUCTION**

**NO. 35:** The following days are recognized as holidays: New Year's Day, Memorial Day, Independence Day, Labor Day, Thanksgiving Day and Christmas Day. If a holiday falls on a Sunday, it shall be observed on the following Monday. No work shall be performed on Labor Day except in case of jeopardy to work under construction. This rule is applied to protect Labor Day. When a holiday falls during the normal work week, Monday through Friday, it shall be counted as eight (8) hours toward the forty (40) hour week; however, no reimbursement for this eight (8) hours is to be paid the workman unless worked. An Employer working a four (4) day, ten (10) hour schedule may use Friday as a make-up day when an observed holiday occurs during the work week. Employees have the option to work that make-up day. If workmen are required to work the above enumerated holidays or days observed as such, they shall receive time and one-half (1 ½) the regular rate of pay for such work.

**NO. 49:** The following days shall be observed as legal holidays: New Year's Day, Decoration Day, July 4th, Labor Day, Thanksgiving Day, Christmas Day, Employee's birthday and two (2) personal days. The observance of one (1) of the personal days to be limited to the time between December 1 and March 1 of the following year. If any of these holidays fall on Sunday, the following Monday will be observed as the holiday and if any of these holidays fall on Saturday, the preceding Friday will be observed as the holiday. If employees work on any of these holidays they shall be paid time & one-half (1½) their regular rate of pay for all hours worked.

**NO. 52:** All work performed on Memorial Day, Independence Day, Labor Day, Thanksgiving Day and Christmas Day shall receive the double (2) time rate of pay.

**NO. 54:** All work performed on New Year's Day, Memorial Day, Independence Day, Labor Day, Veteran's Day, Thanksgiving Day, the Friday after Thanksgiving Day, and Christmas Day shall be paid at the double (2) time rate of pay. When a holiday falls on Saturday, it shall be observed on Friday. When a holiday falls on Sunday, it shall be observed on Monday.

**NO. 63:** All work done on New Year's Day, Memorial Day, Fourth of July, Labor Day, Thanksgiving Day and Christmas Day must be paid for at the double (2) time rate. No work shall be done on Labor Day or the Fourth of July except to preserve life or property. When any of the above named holidays fall on Sunday, the following Monday shall be observed as such holiday. If they fall on Saturday, Friday shall be observed as the holiday.

**NO. 64:** All work performed on New Year's Day, Decoration Day (Memorial Day), Independence Day (Fourth of July), Labor Day, Thanksgiving Day and Christmas Day shall be paid for at double (2) the regular rate of pay. When any of the above named holidays shall fall on Sunday, the following Monday shall be observed as such holiday. If any other craft is afforded a provision of observing Friday as the holiday when the holiday falls on Saturday, Laborers shall be granted the same provision. If another craft that Laborers are tending recognize a specific holiday that Laborers do not normally recognize, the Laborers tending that craft shall recognize the same holiday.

**NO. 65:** Work performed on New Year's Day, Memorial Day, Fourth of July, Labor Day, Thanksgiving Day, Christmas Day, or days celebrated as such, shall be paid at the double time rate of pay. If the holiday falls on Saturday, it will be observed on Friday; if the holiday falls on Sunday, it will be observed on Monday, and shall be paid for at double (2) the regular straight time rate of pay.

**NO. 74:** All work performed on New Year's Day, Memorial Day, Fourth of July, Labor Day, Veteran's Day, Thanksgiving Day and Christmas Day, shall be paid at double (2) time of the hourly rate of pay. In the event one of the above holiday's falls on Saturday, the holiday shall be celebrated on Saturday. If the holiday falls on Sunday, the holiday will be celebrated on Monday.

**NO. 78:** The following days shall be recognized as holidays: New Year's Day, Memorial Day, Independence Day, Labor Day, Thanksgiving and Christmas. If any of the above holidays fall on Sunday, Monday will be observed as the legal holiday. If any of the above holidays fall on Saturday, Friday will be observed as the legal holiday. All time worked on Sunday and herein named holidays shall be classified as overtime and paid at the rate of double time.

OCCUPATIONAL TITLE	* Date of Increase	Basic Hourly Rates	Over-Time Schedule	Holiday Schedule	Total Fringe Benefits
Carpenter		\$28.64	23	16	\$15.55
Electrician (Outside-Line Construction\Lineman)		\$41.52	18	24	\$5.00 + 34.5%
Lineman Operator		\$38.37	18	24	\$5.00 + 34.5%
Lineman - Tree Trimmer		\$21.64	31	30	\$5.00 + 27.5%
Groundman		\$26.76	18	24	\$5.00 + 34.5%
Groundman - Tree Trimmer		\$17.50	31	30	\$5.00 + 27.5%
Laborer					
General Laborer		\$23.82	4	18	\$12.31
Skilled Laborer		\$24.37	4	18	\$12.31
Millwright		\$28.64	23	16	\$15.55
Operating Engineer					
Group I		\$30.23	5	15	\$12.84
Group II		\$29.88	5	15	\$12.84
Group III		\$29.68	5	15	\$12.84
Group IV		\$27.63	5	15	\$12.84
Oiler-Driver		\$27.63	5	15	\$12.84
Pile Driver		\$28.64	23	16	\$15.55
Traffic Control Service Driver		\$16.35	29	28	\$2.75
Truck Driver-Teamster					
Group I		\$28.57	12	3	\$12.05
Group II		\$28.73	12	3	\$12.05
Group III		\$28.72	12	3	\$12.05
Group IV		\$28.84	12	3	\$12.05

Use Heavy Construction Rates on Highway and Heavy construction in accordance with the classifications of construction work established in 8 CSR 30-3.040(3).

Use Building Construction Rates on Building construction in accordance with the classifications of construction work established in 8 CSR 30-3.040(2).

If a worker is performing work on a heavy construction project within an occupational title that is not listed on the Heavy Construction Rate Sheet, use the rate for that occupational title as shown on the Building Construction Rate sheet.

**JASPER COUNTY**  
**OVERTIME SCHEDULE - HEAVY CONSTRUCTION**

**FED:** Minimum requirement per Fair Labor Standards Act means time and one-half (1 ½) shall be paid for all work in excess of forty (40) hours per work week.

**NO. 4:** Means a regular work week shall consist of not more than forty (40) hours of work, Monday through Saturday, and all work performed over and above ten (10) hours per day and forty (40) hours per week shall be paid at the rate of time & one-half (1½). Workers shall receive time and one-half (1½) for all work performed on Sundays and holidays. A work day is to begin between 6:00 a.m. and 9:00 a.m. at the option of the Employer except when inclement weather or other conditions beyond the reasonable control of the Employer prevent work, in which event, the starting time may be delayed, but not later than 12:00 noon. When a holiday falls during the normal work week, Monday through Friday, it shall be counted as eight (8) hours toward a forty (40) hour week; however, no reimbursement for this eight (8) hours is to be paid to the worker(s) unless worked.

**NO. 5:** Means a regular work week shall consist of not more than forty (40) hours work, Monday through Saturday, and all work performed over and above ten (10) hours per day and forty (40) hours per week shall be paid at the rate of time & one-half (1½). Workmen shall receive time and one-half (1½) for all work performed on Sundays and recognized holidays or days observed as such. Double (2) time shall be paid for work on Sunday or recognized holidays when and only if any other craft employees of the same employer at work on that same job site are receiving double (2) time pay for that Sunday or holiday. If a job can't work forty (40) hours, Monday through Saturday, because of inclement weather or other conditions beyond the control of the Employer, Friday and Saturday may be worked as make up days at straight time (if working 4-10's). Saturday may be worked as a make up day at straight time (if working 5-8's). Make up days shall not be utilized for days lost to holidays. A work day is to begin between 6:00 a.m. and 9:00 a.m. at the option of the Employer except when inclement weather or other conditions beyond the reasonable control of the Employer, including requirements of the owner, prevent work. In such event the starting time may be delayed but not later than 12:00 noon. Where one of the holidays falls or is observed during the work week, then all work performed over and above thirty-two (32) hours shall be paid at time & one-half (1½).

**NO. 12:** Means a regular work week shall consist of not more than forty (40) hours of work and all work performed over and above ten (10) hours per day and forty (40) hours per week shall be paid at the rate of time & one-half (1½). A workday is to begin between 6:00 a.m. and 9:00 a.m. at the option of the Employer except when inclement weather or other conditions beyond the reasonable control of the Employer, in which event, the starting time may be advanced or delayed. Workers shall receive time and one-half (1½) for all work performed on recognized holidays or days observed as such.

**NO: 18:** Eight (8) hours of work between the hours of 8:00 a.m. and 4:30 p.m. shall constitute a work day. Forty (40) hours within the five (5) days, Monday through Friday inclusive, shall constitute the work week. Starting time may be adjusted not to exceed two (2) hours. Work performed outside of the aforementioned will be paid at the applicable overtime rate. When starting time has been adjusted, all other provisions concerning the work day shall be adjusted accordingly. The overtime rate of pay shall be one and one-half (1½) times the regular rate of wages, other than on Sundays, holidays and from Midnight until 6:00 a.m., which will be paid at double (2) the straight time rate.

**NO. 23:** Means the regular workweek shall start on Monday and end on Friday, except where the Employer elects to work Monday through Thursday, (10) hours per day. All work over ten (10) hours in a day or forty (40) hours in a week shall be at the overtime rate of one and one-half (1½) times the regular hourly rate. The regular workday shall be either eight (8) or ten (10) hours. If a job can't work forty (40) hours Monday through Friday because of inclement weather or other conditions beyond the control of the Employer, Friday or Saturday may be worked as a make-up day at straight time (if working 4-10's). Saturday may be worked as a make-up day at straight time (if working 5-8's). An Employer, who is working a four (4) ten (10) hour day work schedule may use Friday as a make-up day when a workday is lost due to a holiday. A workday is to begin at the option of the Employer but not later than 11:00 a.m. except when inclement weather, requirements of the owner or other conditions beyond the reasonable control of the Employer prevent work. Except as worked as a make-up day, time on Saturday shall be worked at one and one-half (1½) times the regular rate. Work performed on Sunday shall be paid at two (2) times the regular rate. Work performed on recognized holidays or days observed as such, shall also be paid at the double (2) time rate of pay. For all overtime hours worked during the week or on Saturday \$14.55 of the fringe benefits portion of the prevailing wage shall be paid at time and one-half (1½). For all overtime hours worked on Sundays or recognized holidays \$14.55 of the fringe benefits portion of the prevailing wage shall be paid double time. The remaining \$.50 of the fringe benefit portion of the prevailing wage shall be paid at straight time.

**JASPER COUNTY  
OVERTIME SCHEDULE - HEAVY CONSTRUCTION**

**NO. 29:** Means the regularly scheduled work week shall be five (5) consecutive days, Monday through Friday or Tuesday through Saturday. Eight (8) hours shall constitute a day's work. Starting time shall not be earlier than 7:00 a.m. nor later than 10:00 a.m. Forty (40) hours shall constitute a week's work. Overtime at the rate of time and one-half (1½) will be paid for all work in excess of forty (40) hours in any one work week. On the Monday through Friday schedule, all work performed on Saturday will be time and one-half (1½) unless time has been lost during the week, in which case Saturday will be a make up day to the extent of the lost time. On the Tuesday through Saturday schedule, all work performed on Monday will be time and one-half (1½) unless time has been lost during the week, in which case Monday will be a make-up day to the extent of the lost time. Any work performed on Sunday will be double (2) time. If employees work on any of the recognized holidays, they shall be paid time and one-half (1½) their regular rate of pay for all hours worked.

**NO. 31:** Means the overtime rate shall be time and one-half the regular rate for work over forty (40) hours per week. Sundays and Holidays shall be paid at double the straight time rate. All employees performing work on affected properties during or following emergencies shall receive the applicable rate of pay for the first sixteen (16) consecutive hours and all hours worked in excess of sixteen (16) consecutive hours shall be paid at double time until broken by an eight (8) hour rest period. Should an employee be called back to work within two hours of his normal quitting time, the previous hours worked shall count toward the above sixteen (16) hour provision.



**JASPER COUNTY  
HOLIDAY SCHEDULE – HEAVY CONSTRUCTION**

**NO. 3:** The following days are recognized as holidays: New Year's Day, Memorial Day, Independence Day, Labor Day, Thanksgiving Day and Christmas Day. If a holiday falls on a Sunday, it shall be observed on the following Monday. No work shall be performed on Labor Day except in case of jeopardy to work under construction. This rule is applied to protect Labor Day. When a holiday falls during the normal work week, Monday through Friday, it shall be counted as eight (8) hours toward the forty (40) hour week; however, no reimbursement for this eight (8) hours is to be paid to the workmen unless worked. An Employer working a four (4) day, ten (10) hour schedule may use Friday as a make up day when an observed holiday occurs during the work week. Employees have the option to work that make up day. If workmen are required to work the above enumerated holidays, or days observed as such, they shall receive time & one-half (1½) the regular rate of pay for such work.

**NO. 15:** The following days are recognized as holidays: New Year's Day, Memorial Day, July Fourth, Labor Day, Thanksgiving Day and Christmas Day. If a holiday falls on Sunday, it shall be observed on the following Monday. If a holiday falls on Saturday, it shall be observed on the preceding Friday. No work shall be performed on Labor Day except in case of jeopardy to work under construction. This rule is applied to protect Labor Day. If workmen are required to work the above enumerated holidays or days observed as such, they shall receive time and one-half (1½) the regular rate of pay for such work. Where one of the holidays specified falls or is observed during the workweek, then all work performed over and above thirty-two (32) hours in that week shall be paid at the rate of time and one-half (1½). Workmen shall receive time and one-half (1 ½) for all work performed on Sundays. Double (2) time shall be paid for work on Sunday or recognized holidays when and only if any other craft employees of the same employer at work on that same job site are receiving double (2) time for that Sunday or holiday.

**NO. 16:** The following days are recognized as holidays: New Year's Day, Memorial Day, Fourth of July, Labor Day, Thanksgiving Day and Christmas Day. If a holiday falls on Sunday, it shall be observed on the following Monday. If a holiday falls on Saturday, it shall be observed on the preceding Friday. No work shall be performed on Labor Day except in case of jeopardy to work under construction. This rule is applied to protect Labor Day. When a holiday falls during the normal work week, Monday through Friday, it shall be counted as eight (8) hours toward the forty (40) hour week; however, no reimbursement for this eight (8) hours is to be paid to the worker unless worked. If workers are required to work the above recognized holidays or days observed as such, they shall receive double (2) the regular rate of pay for such work.

**NO. 18:** All work performed on New Year's Day, Memorial Day, Independence Day, Labor Day, Thanksgiving Day and Christmas Day shall be paid at the time and one-half (1½) rate of pay. If a holiday falls on Sunday, it shall be observed on the following Monday. If a holiday falls on Saturday, it shall be observed on the preceding Friday. No work shall be performed on Labor Day except in case of jeopardy to work under construction. This rule is applied to protect Labor Day. When a holiday falls during the normal work week, Monday through Friday, it shall be counted as eight (8) hours toward a forty (40) hour week; however no reimbursement for this eight (8) hours is to be paid to the working person(s) unless the holiday is worked.

**NO. 24:** Work performed on New Year's Day, Memorial Day, Fourth of July, Labor Day, Thanksgiving Day, Christmas Day, or days celebrated as such, shall be paid at the double time rate of pay. If the holiday falls on Saturday, it will be observed on Friday; if the holiday falls on Sunday, it will be observed on Monday, and shall be paid for at double (2) the regular straight time rate of pay.

**NO. 28:** The following days shall be observed as legal holidays: New Year's Day, Decoration Day, July 4th, Labor Day, Thanksgiving Day, Christmas Day, Employee's birthday and two (2) personal days. The observance of one (1) of the personal days to be limited to the time between December 1 and March 1 of the following year. If any of these holidays fall on Sunday, the following Monday will be observed as the holiday and if any of these holidays fall on Saturday, the preceding Friday will be observed as the holiday. If employees work on any of these holidays they shall be paid time & one-half (1½) their regular rate of pay for all hours worked.

**NO. 30:** All work performed on New Year's Day, Decoration Day, Fourth of July, Labor Day, Christmas Day, Thanksgiving Day and Day after Thanksgiving or days celebrated for the same.

**JOB SPECIAL PROVISIONS TABLE OF CONTENTS**

(Job Special Provisions shall prevail over General Special Provisions whenever in conflict therewith.)

- A. General
- B. Measurement and Payment
- C. Permits and Restrictions
- D. Work Zone Traffic Management Plan
- E. Linear Grading
- F. Subgrade Compaction
- G. Embankment
- H. Fertilizing Rate
- I. Seeding
- J. Mulching & Mulch Overspray
- K. Fertilizer, Seed and Mulch
- L. Utilities
- M. Inspection and Job Control Tests
- N. Inspections by MoDOT, Federal Agencies and Health Officials
- O. Required Clearances for Borrow Areas
- P. Preservation of Existing Improvements
- Q. Cooperation/Coordination with Property Owners
- R. Fence & Anchor Posts
- S. Payments to Contractor
- T. Construction Staking
- U. Construction Safety Program Notice Requirements
- V. Clearing and Grubbing
- W. Emergency Provisions and Incident Management
- X. Liquidated Damages Specified
- Y. Project Plaque
- Z. Existing Bridge Plaque
- AA. Post Construction R/W and Utility Locate Requirements
- AB. Tree Clearing Restriction
- AC. Additional Insurance Requirements
- AD. Geotextile Fabric for Use Under Rock Blanket
- AE. Geogrid for Modified Subgrade

AD. GEOTEXTILE FABRIC FOR USE UNDER ROCK BLANKET

1.0 Description

This work shall consist of furnishing and placing Geotextile fabrics as specified in the contract or as directed by the Engineer.

2.0 Materials

- 2.1 The minimum permittivity shall be 1.0 sec-1.
- 2.2 The material shall be either AASHTO Class 1 or Class 2.

3.0 Certification and Sampling

The contractor shall furnish a manufacturer's certification, in triplicate, stating that the material supplied conforms to the requirements of these specifications. The certification shall include or have attached, typical results of tests for the specified properties, representative of the materials supplied. The Engineer reserves the right to sample and test any material offered for use. Acceptance will be based on the certification and the results of any tests the Engineer may perform.

4.0 Construction Requirements

4.1 Geotextile fabric shall extend along the slope from the bottom of the trench at the toe of slope to the top of the rock blanket. Areas on which the Geotextile fabric is to be placed shall be reasonably smooth and free from mounds, windrows, and any debris or projections.

4.2 The fabric shall be placed to avoid wrinkles or creases in the material. The fabric shall be left loose to fit the contour of the slope and to be free to move into indentations caused by stone placement without pulling laps apart. Strips of fabric shall be placed horizontally with a minimum 18 inches overlap of material along overlapping edges. Overlaps shall be shingled toward the bottom of the slope. Fabric shall be anchored to the earth foundation by securing pins driven perpendicular to the slope. Pins shall be inserted approximately 4 inches from the edges of the strips and shall be spaced not more than 3 feet apart along all edges. Additional pins may be required away from the edges if very wide strips are used or if winds are very high during installation. Any damage done to the material shall be repaired with an overlay of Geotextile fabric lapped 18 inches beyond the limits of the damaged area and installed in accordance with these specifications. The contractor may be required to demonstrate that the method of placement of rock will prevent damage to the fabric.

5.0 Measurement and Payment

5.1 Measurement of Geotextile fabric has been made to the nearest square yard of surface area to be covered by the completed mat and is stated in the Bid Schedule.

5.2 The accepted quantity of Geotextile fabric will be paid for at the unit price included in the contract. No direct payment will be made for securing pins, washers, or other incidental items.

## AE. GEOGRID FOR MODIFIED SUBGRADE

### 1.0 Description

This work shall consist of furnishing and placing Geogrid for the purpose of subgrade stabilization as specified in the contract or as directed by the Engineer.

### 2.0 Materials

Geogrid shall be an integrally formed Triaxial or Biaxial polypropylene material as manufactured by Tensar International Corporation or by Syntec Corporation.

Currently approved Geogrid materials are as follows:

1. TX 140 Geogrid as manufactured TENSAR,
2. SBX (Type 2) as manufactured by Syntec

### 3.0 Certification and Sampling

The contractor shall furnish a manufacturer's certification, in triplicate, stating that the material supplied conforms to the requirements of these specifications. The certification shall be representative of the materials supplied. The Engineer reserves the right to sample and test any material offered for use. Acceptance will be based on the certification and the results of any tests the Engineer may perform.

### 4.0 Construction Requirements

Geogrid shall be placed over compacted subgrade according to the manufacturers recommendations. Areas on which the Geogrid is to be placed shall be reasonably smooth and free from mounds, windrows, and any projections. Edges of Geogrid shall be overlapped as required by the manufacturer's installation specifications.

### 5.0 Measurement and Payment

5.1 Measurement of Geogrid has been made to the nearest square yard of surface area to be covered and is stated in the Bid Schedule.

5.2 The accepted quantity of Geogrid will be paid for at the unit price included in the contract. No direct payment will be made for overlapping, waste, or other incidental items required for furnishing and installing the Geogrid.

Z:\Jasper County MO\County of Jasper\Transportation\BRO-B049(32), Route 66 Bridge Replacement\Drawings\07 - TRAFFIC CONTROL.dwg, 5/23/2016 2:40:17 PM, bwatson

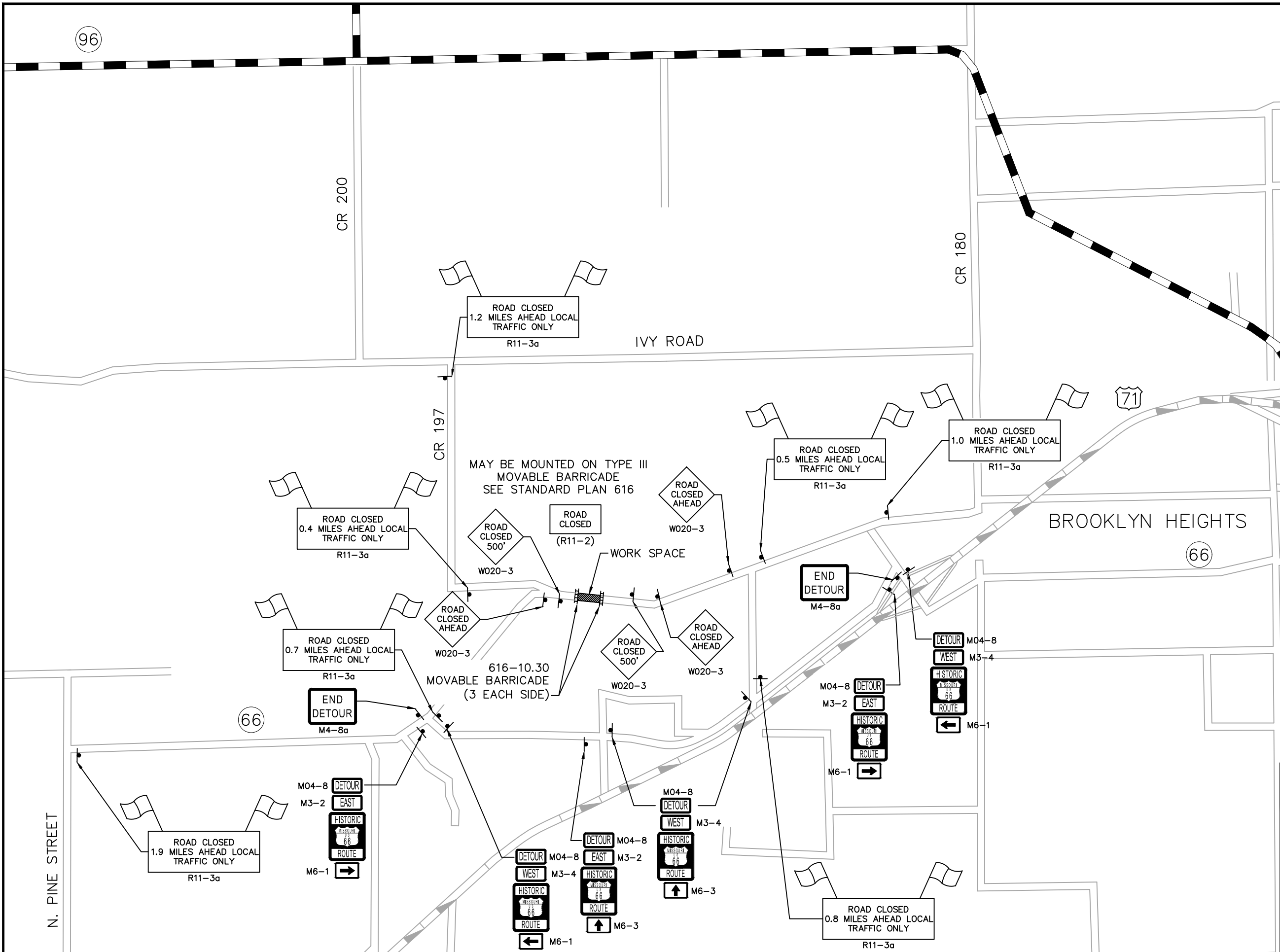

SEE TA-8 IN JOB SPECIAL PROVISIONS

THE "ORIGINAL" OF THIS DOCUMENT, WITH PROFESSIONAL ENGINEER'S SEAL & DATED SIGNATURE, IS ON FILE AT THE OFFICES OF ALLGEIER, MARTIN and ASSOCIATES, INC.  
 CIVIL ENGINEER: MICHAEL ATKINSON  
 LICENSE NO. E-2000149997

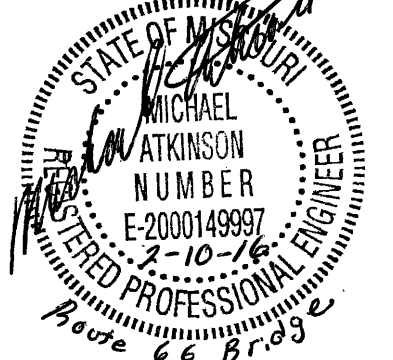

**ALLGEIER, MARTIN and ASSOCIATES, INC.**  
 CONSULTING ENGINEERS and SURVEYORS  
 7231 EAST 24th STREET JOPLIN, MISSOURI 64804 (417) 680 - 7200

THIS DRAWING IS A RECORD OF SERVICE AND IS THE PROPERTY OF ALLGEIER, MARTIN AND ASSOCIATES, INC. THIS DOCUMENT SHALL NOT BE USED ON ANY OTHER PROJECTS WITHOUT THE WRITTEN CONSENT OF ALLGEIER, MARTIN AND ASSOCIATES, INC.  
 CERTIFICATE OF AUTHORITY  
 MISSOURI NO. 000427

DATE	REVISION
4/25	DETOUR ADDITION
5/23	ADDENDUM NO. 1

DWN. BY: AWW  
 CKD. BY: BWW  
 APPD. BY: MRA  
 DATE: FEB, 2016

TRAFFIC CONTROL  
 ROUTE 66 BRIDGE REPLACEMENT BRO-B049(32)  
 JASPER COUNTY, MISSOURI

DWG. NO. **7**