

Addendum No. 1

South Dry Sac Greenway Trail David C Murray Park to Fulbright Landfill Project # TAP 5901 (806)

Issued: March 9, 2017

This addendum shall be considered as part of the bid documents of the above-mentioned project. All items in this addendum should be included in the bids by all bidders. The Contractor shall be responsible for notifying all sub-contractors of this addendum and items affecting them. Receipt of this addendum must be acknowledged on Page 1 of the Form of Proposal.

Changes to the Contract Documents

1. Refer to: **Job Special Provision 02 – Contract Time, Liquidated Damages, Prevailing Wages, Retainage; Section 5.0 Prevailing Wage.** In the last sentence of the first paragraph replace the date (December 18, 2015) for the Federal Davis-Bacon Wages, to **March 3, 2017.** Rates for the Federal Davis-Bacon Wages (General Decision Number: MO170001) can be obtained at <https://www.wdol.gov/wdol/scafiles/davisbacon/MO1.dvb?v=2>. Missouri State Prevailing Wage Order #23 is included in the contract documents.
2. Refer to: **Form of Proposal, Pages 1-6.** Delete this section in its entirety and insert the attached Revised Form of Proposal, Pages 1-6, dated March 9, 2017. The Revised Form of Proposal contains two additional bid items, Additional Subgrade Excavation, and Trench Rock Removal. The Revised Form of Proposal must be submitted with your bid.
3. Refer to: **Division 2 Technical Specifications, Section 05100 – Prefabricated Steel Bridge, 1.02 Scope of Work, D.** The City of Springfield Standard ST-18 referenced in this section has been modified to delete the word “handrail” and replace it with the word “Guardrail”. Refer to the Revised Standard ST-18, dated March 8, 2017, attached to Addendum No. 1, and incorporated into the bid documents.

Changes to the Contract Drawings

4. Refer to: **Plan Sheet 5 – Bridge Plan & Profile, dated 03-16-17.** The Contractor shall be responsible for surveying to establish the layout and elevation of the proposed pedestrian bridge, bridge abutments and wing walls, based on the approved bridge design. The low steel elevation for the bridge has been established at 1095.0 and no part of the bridge structure can be below this elevation. The cross-sectional area beneath the bridge between the bridge abutments can not be less than the cross-sectional area shown on this plan sheet. The control point (CP-125, GR-25A) for establishing the bridge low steel elevation is located approximately 311.8 feet north of the northwest bridge abutment on the Farm Road 141 bridge over the South Dry Sac River, and 33.36 feet west of the centerline of Farm Road 141.

<u>North</u>	<u>East</u>	<u>Elevation</u>
5323329.235'	1400815.101'	1095.09'

End of Addendum No. 1

ADDENDUM No. 1 Dated: March 9, 2017
Springfield-Greene County Park Board
1923 N. Weller Ave.
Springfield, MO 65803

South Dry Sac Greenway Trail
David C. Murray Park to Fulbright Landfill
Project # TAP 5901(806)

REVISED FORM OF PROPOSAL

To: Springfield-Greene County Park Board
1923 N. Weller Ave.
Springfield, MO 65803

From: _____, hereinafter called the "Bidder", having contract examined and being fully informed and familiar with the local conditions and with the contract documents including the drawings, the Notice to Contractor, Instructions to Bidders, the General Conditions and the body of the technical specifications including:

Addenda Number _____ through _____ inclusive

Hereby offer to furnish all labor, supervision, materials, equipment, tools, services and all other items necessary for the performance and the completion of the construction described in the contract documents known as **South Dry Sac Greenway Trail David C. Murray Park to Fulbright Landfill**, in accordance with the PLANS AND SPECIFICATIONS, heretofore filed in the Director of Parks office, at the following prices to be paid in cash, to-wit:

SOUTH DRY SAC GREENWAY TRAIL – TAP 5901(806)

UNIT PRICES					
ITEM NO.	DESCRIPTION	APPROX. NO. UNITS	UNIT TYPE	UNIT PRICE	EXTENDED PRICE
1	Mobilization	1	LS		
2	Engineered, Compacted Fill Material	668	CY		
3	Concrete Trail – 10' width, 4" depth with 4" depth compacted aggregate base, including all grading and backfilling	2509	LF		
4	Corrugated Metal Drain Pipe at Station 22+71.5 -12" diameter with flared end sections	22	LF		
5	Corrugated Metal Drain Pipe at Station 2+80 -18" diameter with flared end sections	56	LF		

Notice of Award, the engineer may annul the Notice of Award and the bid security of that bidder will be forfeited.

Note 2 It is understood by the undersigned that the quantities given in the itemized proposal are not guaranteed and are used solely for the purpose of comparing bids and awarding the contract, and may or may not represent the actual quantities encountered on the job. The gross sum bid shall be based upon the given itemized quantities multiplied by the unit prices shown herein. In the event of a discrepancy between the unit prices and the gross sum bid, the unit prices will prevail. The undersigned agrees that payment will be on the basis of the unit prices shown herein, and shall be made on quantities actually constructed and verified by field measurement.

The undersigned agrees to complete the work specified herein in accordance with the contract unit prices, whether it involves quantities greater or less than those indicated in this Bid Proposal and agrees that the proposed quantities could not in any way be construed to misrepresent earth, rock, or groundwater quantities in the scope of work proposed.

Bidder agrees and understands that by this submission that items required, but not shown on proposal, shall be included in the bid price for other items such as, but not limited to, excavation, ditching, backfilling, or installation of bedding material.

Note 3 The undersigned submits the following itemized proposal and hereby authorizes the Director of Parks to correct any multiplication of "Unit Price" by "Quantity" as shown under "Amount" when copying the itemized proposal sheet(s) into any contract.

Note 4 Bidder agrees that payment will be in cash as follows: On the 22nd day of each month, the Engineer will measure and compute the amount of work performed during the month and the value thereof at the contract unit price. On or about the 20th day of the month following, the Contractor shall be paid an amount equal to the value of the work performed less a retained amount of five (5) percent until construction is complete.

Note 5 The undersigned agrees that if awarded the contract for the work, the contract will be signed and satisfactory bonds filed within ten (10) days after notice of intent to award.

Note 6 It is understood that this bid becomes a part of the specifications upon the signing of the contract and that failing to comply with any part of this bid will be taken as a failure to comply with said specifications and will be just cause for rejection of work.

Note 7 As a condition of submitting this bid and in consideration of the City permitting the bid to be submitted, the bidder hereby agrees that this bid shall be irrevocable for a period of sixty (60) days and that the bid shall not be withdrawn during the sixty (60) day period from the date of the bid opening specified in the bid notice.

Note 8 In submitting this bid, it is understood that the right is reserved by the City of Springfield to reject any and all bids, to waive any irregularities in the bidding, and to increase or decrease the amount of any class or portion of the work.

- Note 9 In submitting this proposal, contractor certifies that no employee, member, or officer of the firm or corporation is a salaried officer or employee of the City of Springfield or any of its boards or agencies, and that no salaried officer or employee of the City has any financial interest, direct or indirect, in this Contract.
- Note 10 The undersigned, as bidder, understands that the bidder awarded the contract will be required to comply, and to cause his subcontractors, if any, to comply with all federal statutes, regulations, and directives against discrimination against any person in connection with the contract, on account of race, color or national origin, and that such discrimination extends to procurement of materials and lease of equipment for use in connection with the contract.
- Note 11 The undersigned, as bidder, declares that the only persons or parties interested in this proposal as principal are those named herein; that this proposal is made without directly or indirectly entered into any agreement, participated in any collusion or otherwise taken any action in restraint of free competitive bidding in connection with such bid of any contract which may result from its acceptance or combination of any kind or character with any other person, firm, association, or corporation, or any member or officer thereof. Bidder further certifies that the person, firm, association, or corporation making said bid is not financially interested in, or financially affiliated with, any other bidder for this Proposal; that he has carefully examined the location of the proposed work, the plans, standard specifications, and special provisions heretofore mentioned, and the form of contract and contract bond; that he proposed and agrees, if this proposal is accepted, to execute the contract and bond and secure execution of the bond by satisfactory surety and to provide all necessary machinery, tools, apparatus, and other means of construction, and will do all the work and furnish all the materials specified in the contract, in the manner and time prescribed and in accordance with the requirements of the engineer as therein set forth, and that he will accept in full payment therefore the amount or amounts certified by the engineer in accordance with the bid, specifications, and contract.
- Note 12 It is understood by the undersigned, that the work to be performed under the provisions of these Contract Documents and the unit and lump sum prices named in this Proposal and the Contract based thereon shall cover the furnishing of all materials (except materials specified to be furnished by the Owner), equipment, supplies and appurtenances, all construction plant, equipment and tools, the performance of all necessary labor, supervision and services and the construction complete as indicated by and detailed on the contract plans and as stipulated in the contract specifications and other contract documents.

The scope of the work to be performed under the various unit and lump sum prices of the contract proposal is in general, defined and described under the respective applicable specification sections. It is the intent of the Proposal Form and the Special Provisions that the total bid as submitted shall cover all work shown by the Contract Drawings and as required by the attached specifications and other Contract Documents. All cost in connection with the work, and payment therefore, shall be included in and based on the unit and lump sum prices named in the Proposal. No item of work that is required by the Contract documents for the proper and successful completion of the contract shall be paid for outside of or in addition to the prices submitted in the Proposal, as all work not specifically set forth in the Proposal as a pay item shall be considered a subsidiary obligation of the

Contractor and all cost in connection therewith shall be included in the unit or lump sum prices named in the Proposal.

NOTE 13 SIGNATURE AND IDENTITY OF BIDDER: The undersigned states that the correct LEGAL NAME and ADDRESS of (1) the individual bidder, (2) each partner or joint venture (whether individuals or corporations, and whether doing business under a fictitious name), or (3) the corporation (with the state in which it is incorporated) are shown below; that (if not signing the intention of binding himself to become the responsible and sole contractor) he is the agent of, and duly authorized in writing to sign for the bidder or bidders; and that he is signing and executing this (as indicated in the proper spaces below) as the proposal of a:

() sole individual () partnership () joint venture

() corporation, incorporated under laws of State of Missouri

Dated _____, 20____

Respectfully submitted,

Doing business under the name of: _____
(If using a fictitious name show
this name above in addition
to legal name.)

(IF AN INDIVIDUAL)

Signature of Bidder _____
Business Address _____

Telephone Number _____

(IF A PARTNERSHIP OR
JOINT VENTURE)

Firm Name _____ (SEAL)

Signed by _____ (SEAL)

Business Address _____

Telephone Number _____

Insert Name and
Address of all
Members of the firm

(IF A CORPORATION)

Corporate Name_____

(CORPORATE SEAL)

Signed by_____ President

Principal Place of Business in Missouri

Telephone Number_____

Insert Names of Officers

Attest:_____

(Secretary)

State of Incorporation_____

NOTE: If the bidder is doing business under a FICTITIOUS NAME, the proposal shall be executed in the legal name of the individual, partners, joint ventures, or corporation, with no legal address shown, and REGISTRATION OF FICTITIOUS NAME filed with the Secretary of State, as required by Sections 417.200 to 417.230 RSMo. If the bidder is a CORPORATION NOT ORGANIZED UNDER THE LAWS OF MISSOURI, it should procure a CERTIFICATE OF AUTHORITY TO DO BUSINESS IN MISSOURI, as required by Section 315.570 and following RSMo. A CERTIFIED COPY of such Registration of Fictitious Name or Certificate of Authority to do Business in Missouri shall be filed with the City of Springfield, Missouri.

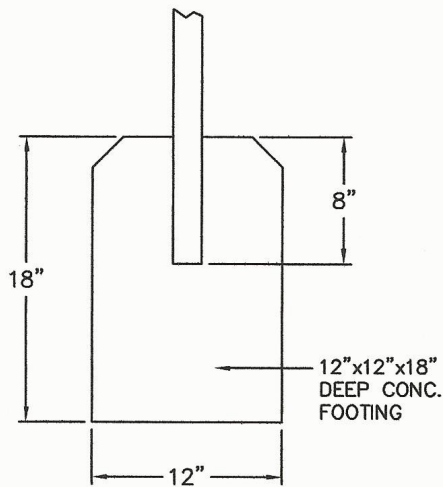
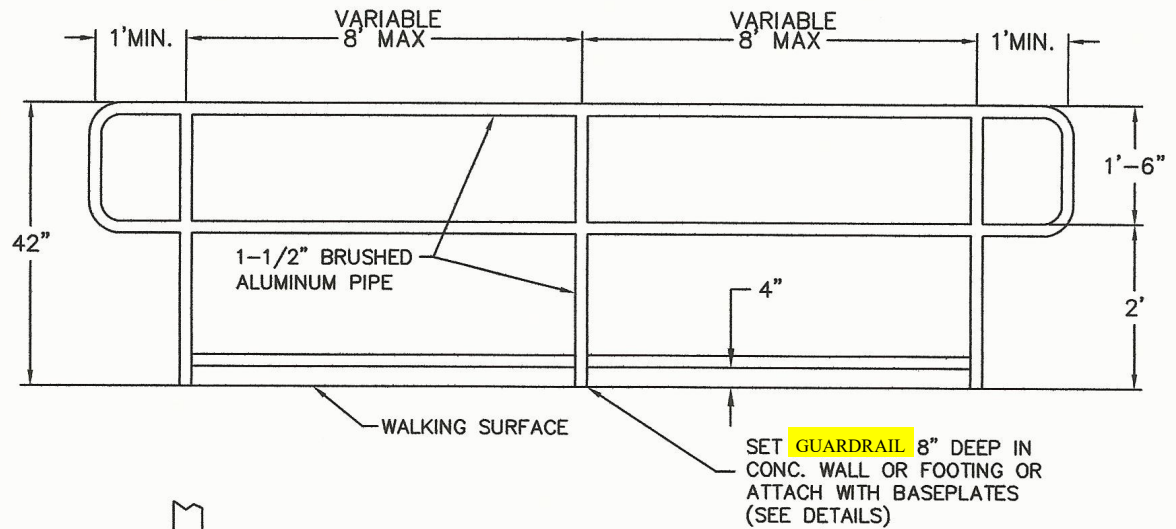

CONC. FOOTING DETAIL

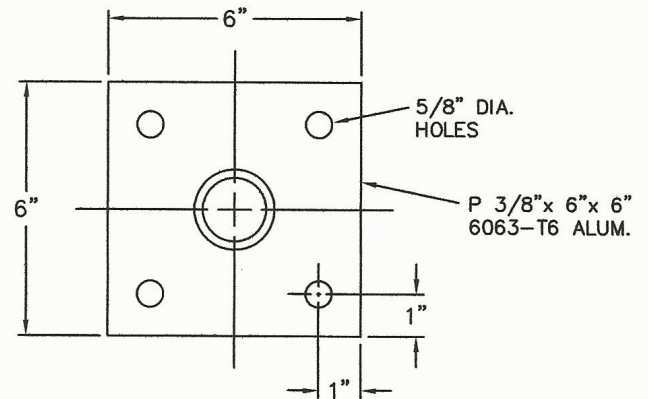

BASEPLATE DETAIL

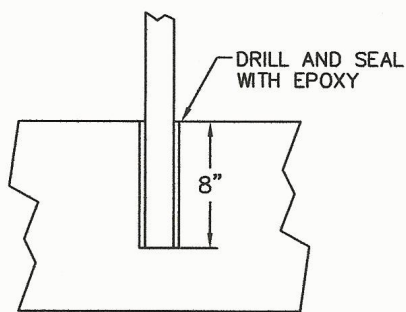

HEADWALL DETAIL

RAILING & POST SPECIFICATIONS		
TYPE	SIZE (DIA.)	WEIGHT (LBS./FT.)
ROUND	1-1/2"	ALUMINUM 0.940

GENERAL NOTES:

RAILINGS, POSTS, AND BASEPLATES SHALL BE ALUMINUM ALLOY 6061-T6 OR 6063-T6.

IF PRE-MANUFACTURED GUARDRAIL COMPONENTS ARE TO BE USED, PRIOR APPROVAL IS REQUIRED.

ALL JOINTS SHALL BE CONTINUOUS WELDED.