



ADDENDUM NUMBER 1

Federal Project Number: TAP 3324 (409) & STP 3400 (435)
City Project Number: 89020265 & 89020226
Project Title: Route 152 Trail Segments 3 & 4

ISSUE DATE: October 3, 2017

Bidders are hereby notified that the Bidding and Contract Documents for the above project, for which Bids are to be received on Tuesday October 10th, 2017, are amended as follows:

Information to Bidders The following is provided to Bidders for information only:

1. Pre-bid meeting Agenda
2. Pre-bid meeting Sign-In sheet

Q1 Tool Joint or Saw joint?

A1 Saw Joint per OSHA Standard # 1926.1153

(https://www.osha.gov/pls/oshaweb/owadisp.show_document?p_table=STANDARDS&p_id=1270)

Q2 Have plans been given to Weatherby Lake?

A2 Yes, they are aware of the project and have been given a set of the plans. Contractor to pay special attention to maintaining or avoiding any existing stormwater BMPs installed by Hunt Midwest or other property owners to reduce stormwater runoff impacts into the Rush Creek watershed.

Q3 Could the entrance to the future Donovan Drive from North Congress be constructed per Option 1 on the (attached) American Public Works Association Table 1 instead of as shown on Plan Sheet 8?

A3 Yes. Contractor can choose to use the concrete pavement option for a commercial collector (7" PCC on 6" untreated compacted aggregate) but there will be no changes to the units or plans and contractor to be paid plan quantity at unit price for item 109, 9" asphalt pavement.

Q4 What radii are required for the metal arch culvert?

A4 Contractor can propose a metal pipe arch with different radii as long as the proposed metal pipe arch has a minimum of 56 square feet of opening for water flow. Below is a chart showing typical metal pipe arch dimensions.

PIPE-ARCH

	Span, Ft.-In.	Rise, Ft.-In.	Area, Ft. ²	R _i , Inches	R _b , Inches	B, Inches ⁽²⁾
↑	6-1	4-7	22	37	77	27
	6-4	4-9	24	38	99	25
	6-9	4-11	26	41	84	29
	7-0	5-1	29	42	105	27
	7-3	5-3	31	44	137	25
R _c Corner Radius = 18"	7-8	5-5	33	47	110	28
	7-11	5-7	36	48	139	27
	8-2	5-9	38	49	183	25
	8-7	5-11	41	52	141	28
	8-10	6-1	43	53	179	26
R _c Corner Radius = 18"	9-4	6-3	46	56	145	30
	9-6	6-5	49	57	178	28
	9-9	6-7	52	58	228	26
	10-3	6-9	55	62	179	29
	10-8	6-11	58	65	153	33
R _c Corner Radius = 18"	10-11	7-1	61	66	181	31
	11-5	7-3	64	70	160	34
	11-7	7-5	68	70	184	32
	11-10	7-7	71	71	217	30
	12-4	7-9	74	75	187	34
↓	12-6	7-11	78	76	218	32
	12-8	8-1	82	77	260	30
	12-10	8-4	85	77	315	28
↑	13-3	9-4	98	80	193	47
	13-6	9-6	102	81	220	45
R _c Corner Radius = 31"	14-0	9-8	106	84	198	48
	14-2	9-10	111	86	224	48
	14-5	10-0	115	87	256	44
	14-11	10-2	120	90	228	48
	15-4	10-4	124	93	209	51
R _c Corner Radius = 31"	15-7	10-6	129	94	232	49
	15-10	10-8	134	95	261	47
	16-3	10-10	138	99	237	51
	16-6	11-0	143	100	264	49
	17-0	11-2	148	103	241	53
R _c Corner Radius = 31"	17-2	11-4	153	104	267	51
	17-5	11-6	158	105	298	49
	17-11	11-8	163	108	271	52
	18-1	11-10	168	109	300	50
	18-7	12-0	174	113	274	54
↓	18-9	12-2	179	114	302	52
	19-3	12-4	185	117	279	55
	19-6	12-6	191	118	305	53
	19-8	12-8	196	119	337	51
	19-11	12-10	202	120	374	49
↓	20-5	13-0	208	123	338	53
	20-7	13-2	214	124	374	51

(1) Dimensions are to inside crests of corrugations and are subject to manufacturing tolerances.

(2) B dimension is measured to top of corner plates.



- Q5 Clarify the tree clearing requirements
- A5 Advance tree clearing has been completed in order to stay within the tree clearing requirements for endangered species habitats and cleared trees have been left on site. All trees and brush cleared or on MoDOT right of way must be mulched or hauled off. For trees not on state right of way, contractor can contact Hunt Midwest or Hawthorn Bank to inquire about leaving on site.
- Q6 Alignment of trail on erosion control sheet does not match plan sheets. Please clarify.
- A6 Sheets 13 and 14 have been revised to show the plan sheet trail layout with no change in quantities.
- Q7 When will NTP be issued?
- A7 Late November or first week in December depending on the time it takes for MoDOT and FHWA to provide concurrence.

Bidding Requirements

1. Delete and replace the following Specification (s):

- A. Delete MoDOT KCMO Federal Project Bid Proposal Boilerplate 112315 (Notice To Contractor)
- B. Add MoDOT KCMO Federal Project Bid Proposal Boilerplate 112315 (Notice To Contractor)

2. Delete and replace the following plan sheet (s):

- A. Delete Sheet 13 (Details)
- B. Add revised Sheet 13 (Revised Details)
- C. Delete Sheet 14 (Erosion Control)
- D. Add revised Sheet 14 (Revised Erosion Control)

NOTE: Bidders must acknowledge receipt of this Addendum by listing the number and date, where provided, on the Bid Form - Document 00410.

Route 152 Trail
Segments 3 and 4
N. Amity to N. Congress to
Tiffany Springs
Federal Projects STP 3400(435) &
TAP 3324 (409)
City Projects 89020265, 89020226
Platte and Clay County

Pre-bid meeting
Tuesday Sept. 26, 2017
10:00 AM

Agenda

Project Overview

- Federal Funds, city funds
- Two city project numbers for accounting purposes
- Review of Section 00210 Notice to Contractors
 1. Discussed Periods of Performances (Milestones)
 2. Discussed Liquidated Damages (\$950 per project per day, \$1900 per day total)
 3. Discussed Prevailing Wage (Federal and State), Annual Wage Order No. 24; Heavy and Highway, the higher of the two must be paid
 4. Prime Contractor Self Perform Requirement is 30%
 5. DBE Requirement is 14%
- Required bid submissions-Section 00210, Paragraph 19
- Federal required forms-Section 00500
- Federal requirements-Section 00700
- DBE of 14%

Planned Addendum

- Pre-bid sign in sheet
- Pre-bid questions and answers

Project Specific Information

- Rush Creek Watershed/Weatherby Lake/Hunt Midwest BMPs
- Staging area (by the outer Road West of Amity)
- Excess excavation placement (Goes to Segment 4 then on Hunt Midwest site, Contact:
- Advance tree clearing completed (Any additional trees removed on MoDOT ROW should be chipped and disposed of on site or removed)
- Traffic control
- Access point: Off Amity, also Segment 4 has easy access points
- MoDOT ROW Markers should be restored (contractor will be responsible to replace them if removed)

General question and answer period

Q: Tool Joint v Saw Joint?

A: Saw Joint per OSHA Standard # 1926.1153

(https://www.osha.gov/pls/oshaweb/owadisp.show_document?p_table=STANDARDS&p_id=1270)

Q: When will NTP be issued?

A: Possibly late November or first week of December

Summary of pre-bid meeting comments and questions:

All questions need to be sent to Masood.Alemifar@kcmo.org, Roberto.Everidge@kcmo.org AND wes.minder@kcmo.org to ensure a response.

Please review paragraph 3 of section 00210. The contract is a calendar date contract with milestone dates. The intent is to ensure proper execution of the contract but provide time to address corrections and issues with the timing of landscaping/seeding installation and acceptance.

Please note paragraph 20 of section 00210 which outlines the required contract submissions:

a) Documents required at the time of Bid:

1. Form 00410-Bid/Form Contract
2. Form 00412-Unit Prices
3. Form 00430 - Bid Bond
4. Anti-Collusion Statement
5. Form 00500.04-Employee Eligibility Verification Affidavit

b) Bidder is required to deliver or fax to the Contract Administrator by 4:00 p.m. within three (3) business days after the bid opening the following documents:

1. DBE Submittal Forms (page 1 of 3; page 2 of 3; and page 3 of 3) (Form 00500.01)
2. Subcontractor Certification Regarding Affirmative Action (Prime Contractor must execute this Certification and obtain an executed Certification from each proposed subcontractor) (Form 00500.02)
3. Certification that Contractor is not Excluded from State or Federal Programs (Prime Contractor must execute this Certification and obtain an executed Certification from each proposed sub-contractor) (Form 00500.03)

DBE goal is 14%. See paragraph 24 of section 00210

Advance tree clearing has been done by City forces. This tree clearing was to knock down trees to ensure that all potential endangered bat habitat trees are removed before the tree clearing restriction. Trees were knocked down and moved to the side to prevent erosion before trail work begins. Due to this advance clearing, there is no JSP restricting clearing on the project for smaller trees and brush. Contractor will be responsible for disposing of the cleared trees.

City wishes to approve the construction contract at the 9/26/17 Council meeting. In order to execute the contract and issue a notice to proceed, contractor will need to have the appropriate bid required and DBE forms submitted in a timely manner. Contractor will also need to submit all subcontractor information to the City so that it can be submitted to MoDOT for approvals. Please review MoDOT EPG section 136.11 at <http://epg.modot.org/index.php?title=136.11> Local Public Agency Construction to see the information contractor needs to provide in order for the City to issue a timely notice to proceed.

STREET CLASSIFICATION	PAVEMENT TYPES	
	OPTION 1	OPTION 2
Major Arterial	9" min. Portland cement concrete pavement 6" min. untreated compacted aggregate 6" min. compacted subgrade 95% of standard max. density	2" Type 5-01 asphaltic concrete surface 10" min. Type 1 asphaltic concrete base course 6" min. untreated compacted aggregate 6" min. compacted subgrade 95% of standard max. density
Industrial Collector and Minor Arterial	8" min. Portland cement concrete pavement 6" min. untreated compacted aggregate 6" min. compacted subgrade 95% of standard max. density	2" Type 5-01 asphaltic concrete surface 9" min. Type 1 asphaltic concrete base course 6" min. untreated compacted aggregate 6" min. compacted subgrade 95% of standard max. density
Commercial Collector	7" min. Portland cement concrete pavement 6" min. untreated compacted aggregate 6" min. compacted subgrade 95% of standard max. density	2" Type 5-01 asphaltic concrete surface 7" min. Type 1 asphaltic concrete base course 6" min. untreated compacted aggregate 6" min. compacted subgrade 95% of standard max. density
Residential Access, Residential Local, and Residential Collector	6" min. Portland cement concrete pavement 6" min. untreated compacted aggregate 6" min. compacted subgrade 95% of standard max. density	2" Type 5-01 or Type 3-01 asphaltic concrete surface 6" min. Type 1 asphaltic concrete base course 6" min. untreated compacted aggregate 6" min. compacted subgrade 95% of standard max. density
General Notes: 1. The pavement thicknesses shown are minimums and the actual pavement design thickness should be determined by an engineering analysis of the traffic and local subgrade conditions. 2. Other pavement type options to be considered shall be submitted to the local government for approval. 3. Concrete pavement joint detail shall be submitted to the local government for approval.		AMERICAN PUBLIC WORKS ASSOCIATION
		KANSAS CITY METROPOLITAN CHAPTER
		STREET PAVEMENT TYPES STANDARD DRAWING NUMBER TABLE 1 ADOPTED June, 2015

NOTICE TO CONTRACTORS

Sealed Bids for **Route 152 Trail Segments 3 and 4, TAP 3324(409), City Project No. 89020265 and STP 3400 (435), City Project No. 89020226** will be received by the General Services Department at City Hall, 414 E 12th Street, First Floor, Room 102W, Kansas City, Missouri, 64106 until **2:00 PM, on Tuesday October 10, 2017** at which time bidding will be closed.

All Bids will be opened and read aloud. The Bid Envelope must contain all required submissions to be included with the Bid. No Bid may be withdrawn for a period of ninety (90) days after the Bid is opened. Bid security shall likewise continue for the same ninety (90) days unless earlier released by the City. The successful Bidder shall comply with all Bidding and contract requirements. Bids, once opened and read, may not be withdrawn without forfeiture of the Bid security.

All Bids shall be addressed to **Manager of Contract Administration, Procurement Services**, shall state on the outside of the sealed Bid envelope "Bid Enclosed", title and Project number, and shall be deposited in the locked Bid box. All Bids must comply with the Bidding Requirements of Kansas City, Missouri (OWNER).

- (1) **PROPOSED WORK:** The proposed work, hereinafter called the work, includes:

Federal Project TAP 3324 (409) Route 152 Trail Segment 3 (City Project 89020265):

Construction of a 10' wide concrete non-motorized transportation facility along Missouri Route 152 between North Amity Road to approximately 1900 feet west of North Congress Avenue. Improvements will include concrete pavement, concrete sidewalk, curb and gutter, drainage flumes, erosion control, retaining walls, metal fencing, wood fencing and gates, storm drainage, grading, rock base, and appurtenances. This is a public improvement project funded in part with Federal funds.

Federal Project STA 3400 (435) Route 152 Trail Segment 4 (City Project 89020226):

Construction of a 10' wide concrete non-motorized transportation facility along Missouri Route 152 between the intersection of Old Tiffany Springs Road and North Avion Avenue to approximately 1900 feet west of North Congress Avenue. Improvements will include concrete pavement, concrete sidewalk, curb and gutter, drainage flumes, erosion control, retaining walls, metal fencing, wood fencing and gates, storm drainage, grading, rock base, and appurtenances. This is a public improvement project funded in part with Federal funds.

Combination bids will be required on the Projects listed above. The bidder will be declared unresponsive if bids are not submitted for all Projects listed above. The combination of the total prices of the bids for all Projects listed above will be used to determine the lowest, responsive, responsible bidder.

- (2) **COMPLIANCE WITH CONTRACT PROVISIONS:** The bidder, having examined and being familiar with the local conditions affecting the work, and with the contract, contract documents, including the requirements of the Kansas City Metropolitan Chapter of the American Public Works Association (APWA), Standard Specifications and Design Criteria apply as amended and supplemented by the Department of Public Works of the City of Kansas City, Missouri (APWA-KCMO), the Missouri Highways and Transportation Commission's "Missouri Standard Specifications for Highway Construction, 2017 Edition" and "Missouri Standard Plans for Highway Construction, 2017 Version", their revisions, and the request for bid, including appendices, the special provisions and plans, hereby proposes to furnish all labor, materials, equipment, services, etc., required for the performance and completion of the work. All references are to the APWA-KCMO Standard Specifications, as revised, unless otherwise noted.

The City's current standards can be found online under the Kansas City Public Works Department website under "Public Works Design & Construction Standards" at: <http://kcmo.gov/publicworks/design-construction-standards/>

The following documents are available on the Missouri Department of Transportation web page at www.modot.mo.gov under "Business with MoDOT" "Standards and Specifications". The effective version shall be determined by the letting date of the project.

General Provisions & Supplemental Specifications
Supplemental Plans to October 2017 Missouri Std. Plans

For Highway Construction

These supplemental bidding documents contain all current revisions to the bound printed versions and have important legal consequences. It shall be conclusively presumed that they are in the bidder's possession, and they have been reviewed and used by the bidder in the preparation of any bid submitted on this project.

Please note that within the above-listed documents, the term "Commission" shall be replaced with the term, City of Kansas City," and the term "Engineer" is a reference to the Engineer of Record from the City of Kansas City.

In the event of conflicts or discrepancies among the specifications, interpretations will be based on the following order: APWA-KCMO, Missouri Standard Specifications for Highway Construction, 2017 edition, and then Missouri Standard Plans for Highway Construction, 2017 edition.

The contracting authority for this contract is the City of Kansas City, Missouri.

- (3) **PERIOD OF PERFORMANCE:** If the bid is accepted, the bidder agrees that work shall be diligently prosecuted at such rate and in such manner as, in the judgment of the engineer, is necessary for the completion of the work within the time specified as follows in accordance with Article 14 of Section 700 ("General Conditions") of this contract: **Calendar Date**
- a) All work for Project STP 3400(435) along Donovan Drive between STA 10+00 to STA 38+35.83 to be completed and ready for semi-final inspection by March 31, 2018.
 - b) All clearing, grading, storm pipes, rock base, and trail pavement for the remainder of Project STP 3400(435) to be completed and ready for semi-final inspection by September 1, 2018.
 - c) All clearing, grading, storm pipes, rock base, trail pavement, and seeding for Project TAP 3422(409) to be completed and ready for semi-final inspection by October 15, 2018
 - d) All tree planting for the remainder of both projects to be completed and ready for semi-final inspection by February 28, 2019
 - e) All remaining work, final corrective measures for both projects for work completed in (a), (b), and (c), and final paperwork to be completed and ready for final inspection and final acceptance by June 1, 2019
- (4) **LIQUIDATED DAMAGES:** The bidder agrees that, should the bidder fail to complete the work or phases of work in the time specified in Section (3) of the Notice to Contractors or such additional time as may be allowed by the engineer under the contract, the amount of liquidated damages to be recovered in accordance with Article 14 of Section 700 ("General Conditions") of this contract:
- A. If the Work is not completed and ready for final payment in accordance with Paragraph 14.07, within the period stated in Paragraph 12.01 B.2, CONTRACTOR shall pay to CITY the amount of Nine Hundred Fifty dollars (\$950.00) per project listed in Section (1) as liquidated damages and not as a penalty for each Calendar Day until the Work is completed and ready for final payment. The maximum liquidated damages for each Calendar Day will be One Thousand, Nine Hundred dollars (\$1,900.00). The amount of liquidated damages shall be deducted from any payments due or to become due CONTRACTOR.
- (5) **BID GUARANTY:** All Bids submitted must be accompanied by a Bid deposit in the amount of five percent (5%) of the base Bid which shall be in the form of a Bid Bond (on the form provided in these Bidding Documents), Cashier's Check, Letter of Credit, Certificate of Deposit or other instrument approved in advance by the City. Prior to submittal of the Bid the City Treasurer must approve both the financial institution and text of a Letter of Credit. A Cashier's Check or a Certificate of Deposit shall be payable to the City Treasurer.
- (6) **CERTIFICATIONS FOR FEDERAL JOBS:** By signing and submitting this bid, the bidder makes the certifications appearing in Sec. 102.18.1 (regarding affirmative action and equal opportunity), Sec. 102.18.2 (regarding disbarment, eligibility, indictments, convictions, or civil judgments), Sec. 102.18.3 (regarding anti-collusion), and Sec. 102.18.4 (regarding lobbying activities). Any necessary documentation is to accompany the bid submission, as required by these sections. As provided in Sec. 108.13, the contracting authority may terminate the contract for acts of misconduct, which includes but is not limited to fraud, dishonesty, and material misrepresentation or omission of fact within the bid submission.
- (7) **ANTIDISCRIMINATION:** The Contracting Authority hereby notifies all bidders that it will affirmatively insure

that in any contract entered into pursuant to this advertisement, businesses owned and controlled by socially and economically disadvantaged individuals will be afforded full opportunity to submit bids in response to this invitation and will not be discriminated against on the grounds of race, color, religion, creed, sex, age, ancestry, or national origin in consideration for an award.

- (8) **FEDERAL AND STATE INSPECTION:** The Federal Government is participating in the cost of construction of this project. All applicable Federal laws, and the regulations made pursuant to such laws, shall be observed by the contractor, and the work will be subject to the inspection of the appropriate State or Federal Agency in the same manner as provided in Sec 105.10 of the Missouri Standard Specifications for Highway Construction with all revisions applicable to this bid and contract.
- (9) **PREVAILING WAGE (FEDERAL AND STATE):** This contract requires payment of the prevailing hourly rate of wages for each craft or type of work required to execute the contract as determined by the Missouri Department of Labor and Industrial Relations, and requires adherence to a schedule of minimum wages as determined by the United States Department of Labor. For work performed anywhere on this project, the contractor and the contractor's subcontractors shall pay the higher of these two applicable wage rates. The applicable state wage rates for this contract are detailed in "Annual Wage Order No. 24", that is attached to this bidding document. The applicable federal wage rates for this contract are the effective Davis-Bacon federal wage rates posted the tenth day before the bid opening date and are attached herein.

These supplemental bidding documents have important legal consequences. It shall be conclusively presumed that they are in the bidder's possession, and they have been reviewed and used by the bidder in the preparation of any bid submitted on this project.

- (10) **WORKER ELIGIBILITY REQUIREMENTS:** Execution of the construction contract for this project is dependent upon the awarded bidder providing an Affidavit of Compliance AND E-Verify Memorandum-of-Understanding (MOU) between the bidder and Department of Homeland Security to the Contracting Authority as required by section 285.530 RSMo. The cover page and signature page of the E-Verify MOU and the Affidavit must be submitted prior to award of this contract.

A sample Affidavit of Compliance can be found at the Missouri Attorney General's website at the following link:
http://ago.mo.gov/forms/Affidavit_of_Compliance.pdf

All bidders must also be enrolled in the E-Verify Program, and include their MOU prior to contract execution. Bidders who are not enrolled will need to go to the following website link and select "Enroll in the Program" to get started. After completing the program, they will receive their E-Verify MOU with Department of Homeland Security. This document will need to be printed out and kept on file so that a copy can be attached to the Affidavit of Compliance.

http://www.dhs.gov/files/programs/gc_1185221678150.shtm

This requirement also applies to subcontractors and contract labor, but this contract only requires submittal of the verification documents for the prime contractor. It is the prime contractor's responsibility to verify the worker eligibility of their subcontractors in order to protect their own company from liability as required by section 285.530 RSMo.

- (11) **OSHA TEN HOUR TRAINING REQUIREMENTS:** Missouri Law, 292.675 RSMO, requires any awarded contractor and its subcontractor(s) to provide a ten-hour Occupational Safety and Health Administration (OSHA) Construction Safety Program (or a similar program approved by the Missouri Department of Labor and Industrial Relations as a qualified substitute) for their on-site employees (laborers, workmen, drivers, equipment operators, and craftsmen) who have not previously completed such a program and are directly engaged in actual construction of the improvement (or working at a nearby or adjacent facility used for construction of the improvement). The awarded contractor and its subcontractor(s) shall require all such employees to complete this ten-hour program, pursuant to 292.675 RSMO, unless they hold documentation on their prior completion of said program. Penalties, for Non-Compliance include contractor forfeiture to the Contracting Authority in the amount of \$2,500, plus \$100 per contractor and subcontractor employee for each calendar day such employee is employed beyond the elapsed time period for required program completion under 292.675 RSMO.

- (12) **BUY AMERICA REQUIREMENTS:** Construction contracts shall assure compliance with Section 165 of the Surface Transportation Assistance Act of 1982, Section 337 of the Surface Transportation and Uniform Relocation Assistance Act of 1987, and 23 CFR 635.410 regarding Buy America provisions on the procurement of foreign products and materials. On all contracts involving Federal-aid, all products of iron, steel, or a coating of steel which are incorporated into the work must have been manufactured in the United States. The Contracting Authority may allow minimal amounts of these materials from foreign sources, provided the cost does not exceed 0.1 percent of the contract sum or \$2,500, whichever is greater. The Contractor certifies that these materials are of domestic origin. Additional information regarding the "Buy America" requirements can be found at: <http://www.fhwa.dot.gov/programadmin/contracts/b-amquck.cfm>
- (13) **ADDENDUM ACKNOWLEDGEMENT:** Bidders must acknowledge that all addenda (if applicable) have been received, acknowledged and incorporated into their bid, prior to submittal. Refer to Bid Form/Contract, form 00410, for Acknowledgement of Addenda.
- (14) **SIGNATURE AND IDENTITY OF BIDDER:** Refer to Bid Form/Contract, form 00410.
- (15) **TRAINEES:** By submitting this bid, the bidder certifies that the bidder is familiar with the Training Provision in the Missouri Highways and Transportation Commission's "General Provisions and Supplement Specifications" which are available on the Missouri Department of Transportation web page at www.modot.mo.gov under "Business with MoDOT" "Standards and Specifications". The number of trainee hours provided under this contract will be **0 slots** at 1000 hours per slot or **0 hours**.
- (16) **SUBCONTRACTOR DISCLOSURE:** Requirements contained within Sec 102.7.12 of the Missouri Standard Specification for Highway Construction shall be waived for this contract.
- (17) **PROJECT AWARD:** This project will be awarded to the lowest, responsive, responsible bidder. The bidder will be declared unresponsive if bids are not submitted for all Projects listed in Section (1). The combination of the total prices of the bids for all Projects listed in Section (1) will be used to determine the lowest, responsive, responsible bidder.
- (18) **PRIME CONTRACTOR REQUIREMENTS:** In accordance with Federal Highway Administration's rule at Title 23 Code of Federal Regulations (CFR) § 635.116(a), the contractor must perform project work with its own organization equal to and not less than 30 percent of the total original contract price. Second-tier subcontracting will not be permitted on this contract. All other provisions in Sec 108.1.1 et seq. of the Missouri Standard Specifications for Highway Construction shall remain in full force and effect, and shall continue to govern the contractor and its subcontractors, in accordance with the provisions of Title 23 CFR § 635.116.
- (19) **SALES AND USE TAX EXEMPTION:** The City of Kansas City, Missouri, a tax exempt entity, will furnish a Missouri Project Exemption Certificate as described in Section 144.062 RSMo to the awarded contractor who in turn may use the certificate to purchase materials for a specific project performed for the tax exempt entity. Only the materials and supplies incorporated or consumed during the construction of the project are exempt. The certificate will be issued to the contractor for a specific project for a defined period of time.
- (20) **REQUIRED CONTRACT SUBMISSIONS:** The following are the documents Contractors will be required to submit in order to enter into a contract with the City:
- a) Documents required at the time of Bid:
 1. Form 00410 – Bid/Form Contract
 2. Form 00412 – Unit Prices
 3. Form 00430 – Bid Bond
 4. Anti-Collusion Statement
 5. Form 00500.04-Employee Eligibility Verification Affidavit
 - b) Bidder is required to deliver or fax to the Contract Administrator **by 4:00 p.m. within three (3) business days after the bid** opening the following documents:

1. DBE Submittal Forms (page 1 of 3; page 2 of 3; and page 3 of 3) (Form 00500.01)
 2. Subcontractor Certification Regarding Affirmative Action (Prime Contractor must execute this Certification and obtain an executed Certification from each proposed subcontractor) (Form 00500.02)
 3. Certification that Contractor is not Excluded from State or Federal Programs (Prime Contractor must execute this Certification and obtain an executed Certification from each proposed sub-contractor) (Form 00500.03)
- (21) **INDEMNIFICATION – CITY OF KANSAS CITY:** The contract documents contain a requirement that Contractor shall indemnify, defend and hold harmless the City and any of its agencies, officials, officers, or employees from and against all claims, damages, liability, losses, costs, and expenses, including reasonable attorneys' fees, arising out of or resulting from any acts or omissions in connection with the contract, caused in whole or in part by Contractor, its employees, agents, or Subcontractors, or caused by others for whom Contractor is liable, including negligent acts or omissions of the City, its agencies, officials, officers, or employees. The contract requires Contractor to obtain specified limits of insurance to insure the indemnity obligation. Contractor has the opportunity to recover the cost of the required insurance in the Contract Price by including the cost of that insurance in the Bid amount.
- (22) **INDEMNIFICATION – STATE OF MISSOURI:** The contract documents contain a requirement that Contractor shall indemnify, defend and hold harmless the Missouri Highways and Transportation Commission (MHTC) and the Missouri Department of Transportation (MoDOT) and their respective employees from and against all claims, damages, liability, losses, costs, and expenses, including reasonable attorneys' fees, arising out of or resulting from any acts or omissions in connection with the contract, caused in whole or in part by Contractor, its employees, agents, or Subcontractors, or caused by others for whom Contractor is liable. The contract requires Contractor to obtain specified limits of insurance to insure the indemnity obligation. Contractor has the opportunity to recover the cost of the required insurance in the Contract Price by including the cost of that insurance in the Bid amount.
- (23) **SIGNATURES:** Each copy of the Bid Form/Contract must be signed and properly dated by the following, as applicable:
- Limited Liability Company:
 - ☐ a member of the limited liability Company authorized to sign on behalf of the company.
 - Partnership:
 - ☐ a partner authorized to sign on behalf of the partnership.
 - Sole Proprietor:
 - ☐ the proprietor.
 - Joint Venture:
 - ☐ the parties to the Joint Venture authorized to sign on behalf of each party to the Joint Venture, or a person authorized by each party to the Joint Venture to sign on behalf of all parties to the Joint Venture.
 - Corporation:
 - ☐ a corporate office authorized to sign on behalf of the corporation. Corporation's seal must be attached to the signature.
- (24) **Disadvantaged Business Enterprises (DBE) Program Requirements:** To be eligible for this Project a Bidder must (1) meet the qualifications of the Missouri Department of Transportation (2) be certified and registered in the current DBE directory of the Missouri Department of Transportation. For this Project the DBE goal is twelve (14%). The DBE Forms and Instructions for Construction Projects are incorporated into these Bidding Documents and the Contract Documents.
- (25) **Schedule of participating DBE's:** By submitting its Bid, Bidder is agreeing that for each DBE, the applicable value and percentage of labor, materials, and services involved in the Work as compared to the entire Contract price contained in this Bid is set forth in the attached schedule of Participating DBE's submitted by Bidder.
- (26) **ADDITIONAL INSURANCE:** In addition to those listed in Section 5.04 of the Contract General Conditions, the following policies of insurance are also required: None
- (27) **PROPERTY INSURANCE:** CONTRACTOR shall not be required to purchase and maintain property insurance on the Work at the Site. Article 5, Paragraph 5.06, Property Insurance, Paragraph A of the Contract General Conditions is deleted.

(28) **SUBCONTRACTORS**: The following Subcontractors, Suppliers or other persons or organizations (including those who are to furnish the principal items of materials or equipment) are to be submitted to CITY for acceptance, on or before the date stated.

(29) **SUBSTITUTES AND "OR-EQUAL" ITEMS**: Article 6, Paragraph 6.06 Substitutes and "Or-Equal" Items, Paragraph A of the Contract General Conditions is amended by adding the following at the end of Paragraph A.1:

Proposed "or-equal" items must be submitted to CITY at least 10 days prior to Bid date at the following address:

Masood Alemifar
City of Kansas City, Mo.
4721 Coal Mine Rd/Manchester Tfwy
Kansas City, MO 64130
masood.alemifar@kcmo.org

Only Bidders may submit proposed "or-equal" items and such items must require no change in related Work. Acceptance by CITY of any proposed "or-equal" items will be made by Addendum only.

Article 6, Paragraph 6.06 Substitutes and "Or-Equal" Items, Paragraph A of the Contract General Conditions is amended by adding the following at the end of Paragraph A.2:

Proposed substitute items must be submitted to CITY's Representative not later than 10 days prior to the time the item is to be incorporated into the Work. Only CONTRACTOR may submit proposed substitute items, and such items must be submitted to CITY's Representative on the standard City form 01630 - Substitution Request. Acceptance by CITY of any proposed substitute item will be made by Change Order.

(30) **PRE-BID CONFERENCE**: The Public Works Department will hold a pre-Bid conference on Tuesday September 26th, 2017 starting at 10:00 A.M. in the Conference Room, located at 4721 Coal Mine Road/Manchester Trafficway, Kansas City, MO 64130. Attendance at the pre-Bid conference is encouraged for all Bidders on this Project.

(31) **END OF NOTICE**

WOOD FENCING
AND GATES

NOT TO SCALE

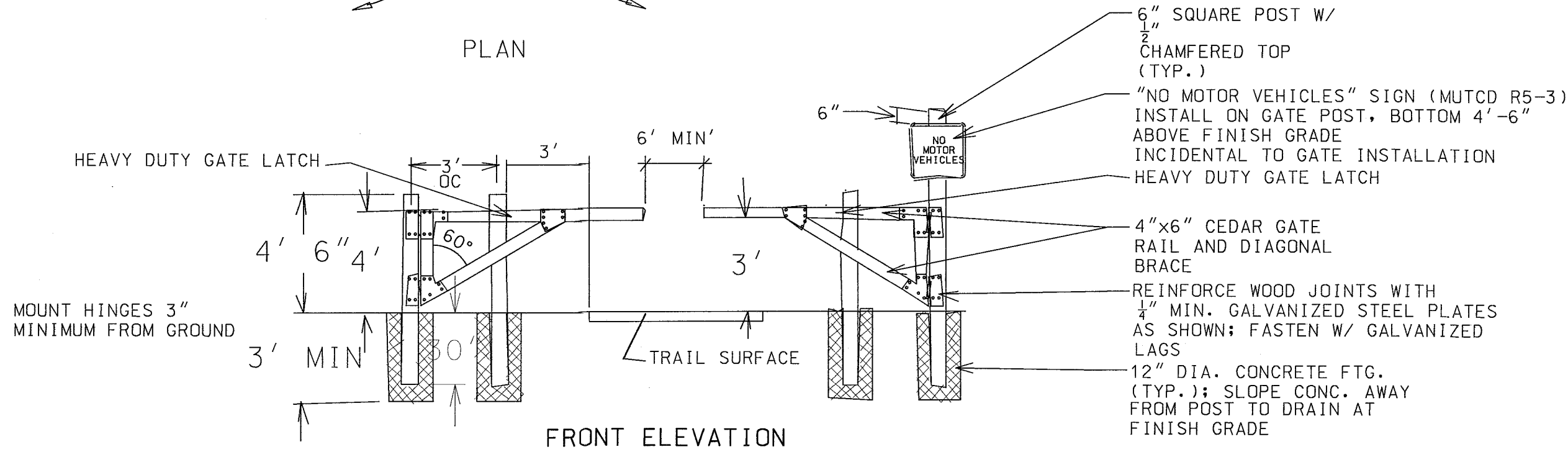
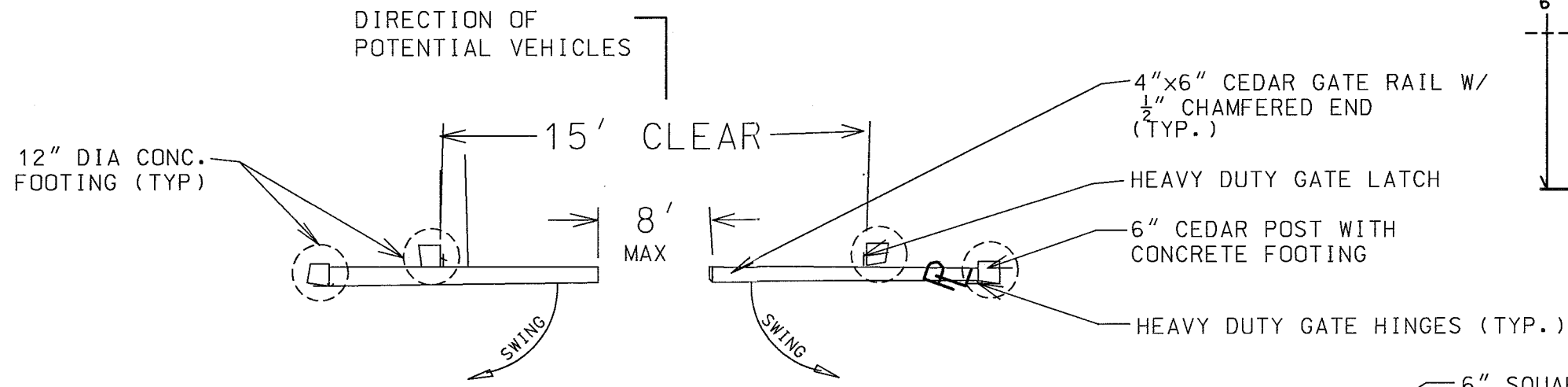
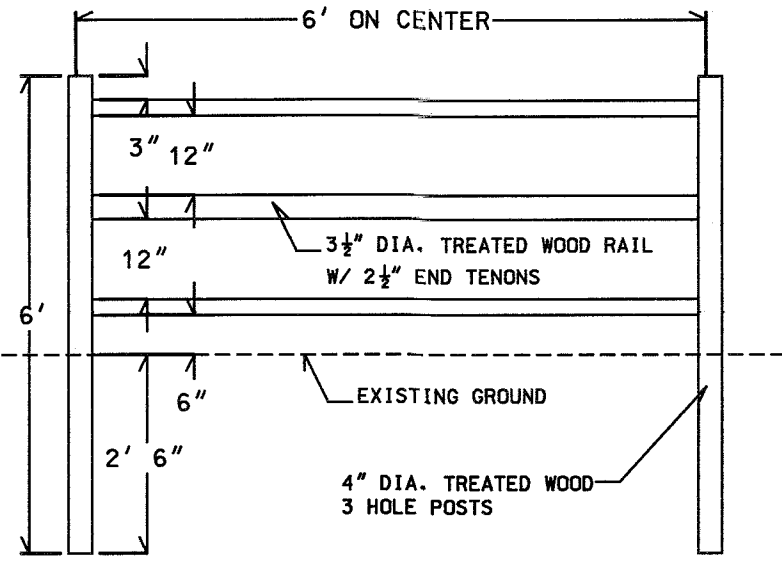

ACCESS CONTROL SWING GATE

NOTE: WOOD FENCES WILL BE PLACED A MINIMUM OF 2' FROM EDGE OF PAVEMENT

IF FENCE IS CLOSER THAN 4' FROM EDGE OF TRAIL OR OVER LARGE CULVERTS, FLARE ENDS OF ALL ROUND RAIL FENCE AT 45 DEGREES AWAY FROM TRAIL EDGE.

- NOTES:
1. ALL MOUNTING HARDWARE SHALL BE HEAVY DUTY GALVANIZED METAL. CONTRACTOR SHALL PROVIDE HEAVY DUTY LOCKS AND KEYS.
 2. WOOD MEMBERS SHALL BE TREATED CEDAR.

MoDOT FENCING

NOT TO SCALE

SEE PROJECT SPECIFICATIONS AND MoDOT STANDARD PLAN 607.20G FOR WOVEN WIRE FENCE DETAILS

NOTES:

ANY EXISTING MoDOT FENCE IMPACTED BY THE PROJECT BUT NOT RELOCATED SHALL BE PRESERVED OR RESTORED IN ITS EXISTING LOCATION. REMOVAL AND RESTORATION SHALL BE INCIDENTAL.

IF SPECIFIED, END POST SYSTEM IS FOR RETROFIT OF EXISTING CHAIN LINK FENCE AND IS TO BE INSTALLED WHERE EXISTING CHAIN LINK FENCE IS TO BE SEVERED FOR TRAIL CROSSING OF STATE RIGHT OF WAY.

ANY NEW FENCE SPECIFIED IN THE PLANS AND REQUIRING END POST SYSTEMS WILL BE PAID FOR UNDER THE BID UNIT PRICE FOR THE NEW FENCE AND NO ADDITIONAL PAYMENT WILL BE PROVIDED FOR END POST SYSTEMS, BRACKETS, MOUNTING HARDWARE, ETC.

CONTRACTOR TO INSTALL NEW END POST SYSTEM AS SHOWN IN THE DETAILS OR PER MANUFACTURER'S RECOMMENDATION.

FENCE AND FENCE MATERIALS SHALL CONFORM TO THE APPLICABLE PARTS OF MoDOT STANDARD SPECIFICATIONS SECTION 607.

IF EXISTING FENCE IS BLACK VINYL COATED, FENCE END POST SYSTEM SHALL BE BLACK VINYL COATED ALSO. IF EXISTING FENCE IS GALVANIZED, FENCE END POST SYSTEM SHALL BE GALVANIZED. CONTRACTOR TO VERIFY EXISTING TYPE OF FENCE PRIOR TO BIDDING.

CONTRACTOR TO REMOVE ANY EXISTING FENCE AND FENCE POST SYSTEMS WHERE IN CONFLICT WITH PROPOSED TRAIL. REMOVAL INCIDENTAL TO CLEARING, GRUBBING AND DEMOLITION.

GENERAL NOTES:

CROSS-WALK PAVEMENT MARKINGS WILL HAVE 10' SPACE BETWEEN INSIDE FRONT EDGE OF PAVEMENT MARKINGS.

SIGN POST MATERIALS, SUPPLIES, AND MOUNTING MATERIALS, FOOTING EXCAVATION, AND BACKFILL MATERIALS ARE INCIDENTAL COSTS TO SIGN UNIT PRICE UNLESS OTHERWISE SPECIFIED IN PROJECT MANUAL.

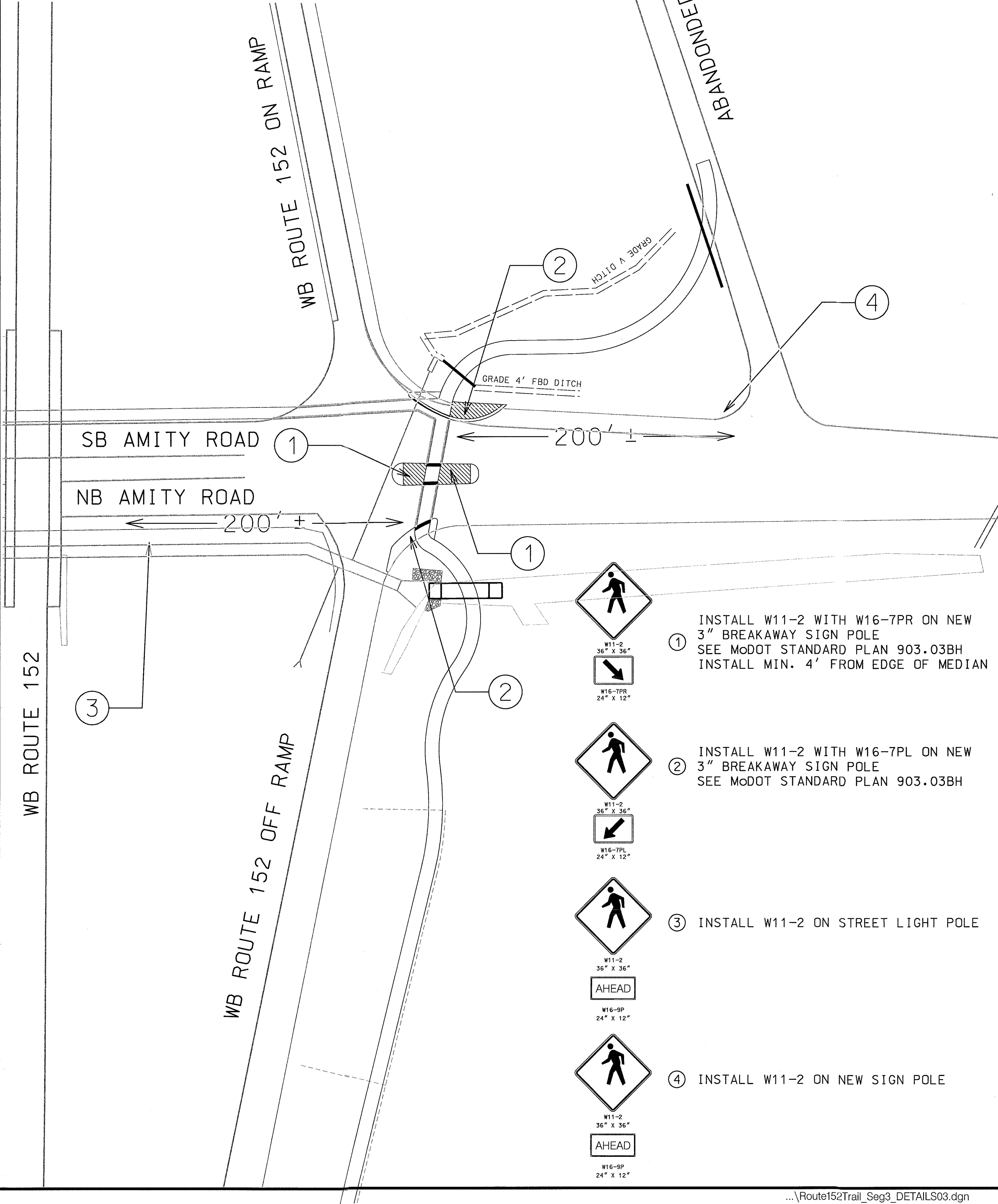

DIRECTION

TAP 3324 (409)

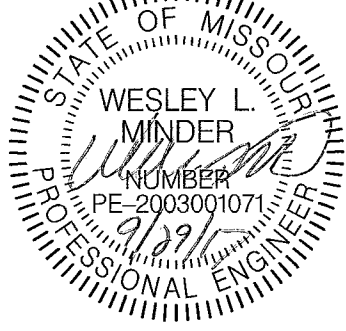

DISCLAIMER
THE PROFESSIONAL WHOSE SIGNATURE AND PERSONAL SEAL APPEAR HEREON ASSUMES RESPONSIBILITY FOR THE DESIGN AND CONSTRUCTION OF THE PROJECT. THE DESIGNER DOES NOT WARRANT, REPRESENT, OR GUARANTEE THE ACCURACY OF THE INFORMATION PROVIDED HEREON. THE DESIGNER'S LIABILITY IS LIMITED TO THE PROJECT TO WHICH THIS PAGE REFERS.



CITY OF KANSAS CITY
PUBLIC WORKS
DEPARTMENT

414 E. 12TH STREET
20TH FLOOR
KANSAS CITY, MO 64151
V: (816) 513-2600
F: (816) 513-6974
www.kcmo.org

DETAILS

ROUTE 152 TRAIL
SEGMENT 3

HOR. SCALE
VERT. SCALE
NTS
SHEET

13

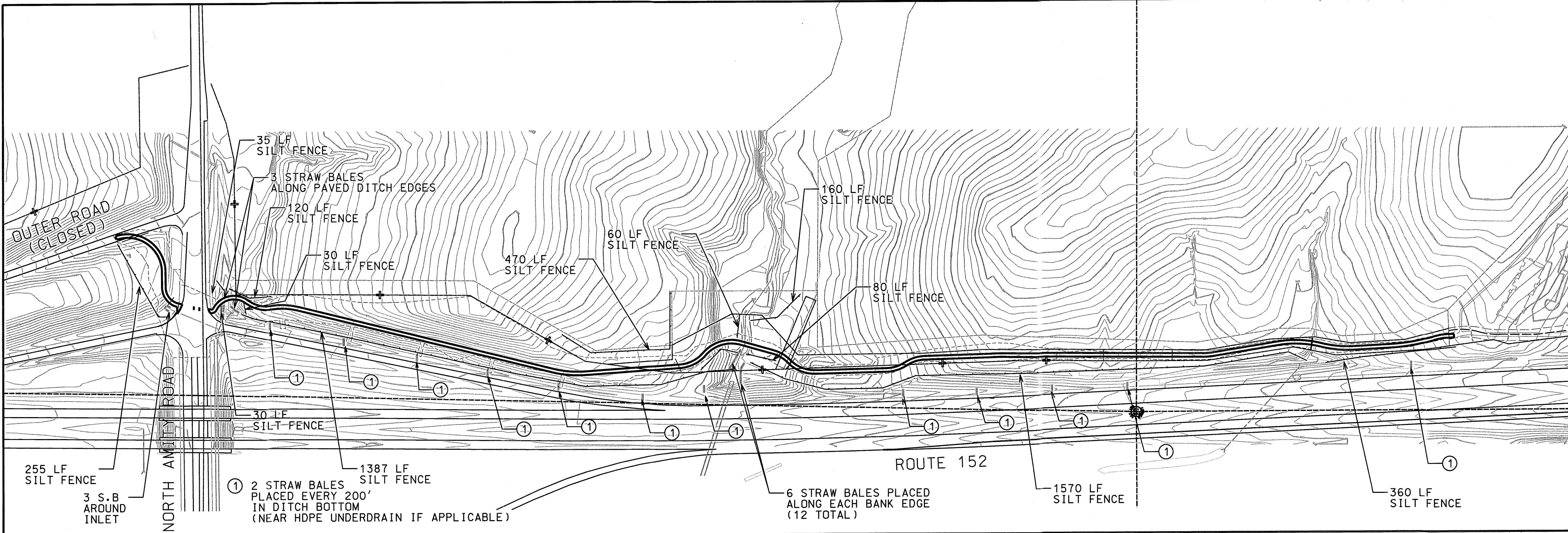

PROJECT IS LOCATED WITHIN THE RUSH CREEK WATERSHED. CONTRACTOR TO REVIEW APWA SECTION 02150 FOR PROPER EROSION CONTROL MEASURES REQUIRED TO COMPLETE THE WORK. ADDITIONAL EROSION CONTROL MEASURES AS OUTLINED IN APWA SECTION 02150 MAY BE REQUIRED DEPENDING ON SITE CONDITIONS AND CONSTRUCTION TIMING. ANY ADDITIONAL EROSION CONTROL MEASURES SHALL BE INCIDENTAL TO OTHER EROSION CONTROL ITEMS.

CONTRACTOR SHALL INSTALL EROSION CONTROL DEVICES PRIOR TO BEGINNING ANY WORK ON THE PROJECT.

VEHICLES OF CONTRACTOR AND ITS EMPLOYEES, LABORERS, AGENTS OR CONTRACTORS SHALL BE PARKED IN AREAS APPROVED BY OWNER BUT IN NO EVENT ON DRIVEWAYS OR OTHER HARD SURFACES ON THE PROPERTY.

NO VEHICLES SHALL BE LEFT ON OR NEAR THE JOB SITE OVERNIGHT WITHOUT THE PRIOR WRITTEN CONSENT OF OWNER AND IF APPROVED, VEHICLES SHALL BE LEFT ONLY ON SURFACES WHICH WILL NOT ALLOW CONTAMINATION OF STORMWATER RUNOFF OR SOIL.

CONTRACTOR SHALL PRESERVE ALL SILT FENCING, HAY BALES AND OTHER EROSION CONTROL DEVICES. INSTALLED AND SHALL, AT ITS EXPENSE, REPAIR AND REPLACE ANY SUCH DEVICES THAT ARE DISTURBED.

CONTRACTOR, AT ITS EXPENSE, SHALL REMOVE ALL MUD THAT ITS VEHICLES PLACE ON THE STREETS.

IF CONTRACTOR OR ITS EMPLOYEES, LABORERS, AGENTS OR CONTRACTORS VIOLATE ANY OF SUCH PROHIBITIONS, CONTRACTOR SHALL BE RESPONSIBLE AND PAY FOR ALL TOWING, CLEAN-UP, REPAIRS, REPLACEMENTS AND FINES.

CONTRACTOR SHALL CAUSE ALL FOOD AND FOOD AND DRINK CONTAINERS FROM ITS PERSONNEL TO BE DISPOSED OF IN TRASH CONTAINERS PROVIDED BY CONTRACTOR.

CONTRACTOR SHALL VERIFY PRIOR TO BIDDING AN STORMWATER EROSION CONTROL MEASURES INSTALLED ON OR ADJACENT TO THE WORK WHICH MAY OR MAY NOT BE IMPACTED BY THE WORK.

CONTRACTOR SHALL NOT DISTURB EROSION CONTROLS INSTALLED BY HUNT MIDWEST ON THE RIVERSTONE SUBDIVISION. SHOULD THE WORK REQUIRE OR CONTRACTOR DAMAGE ANY PREVIOUSLY INSTALLED EROSION CONTROL MEASURES, CONTRACTOR SHALL REPLACE OR REPAIR AS NECESSARY AT NO COST TO HUNT MIDWEST OR THE CITY.

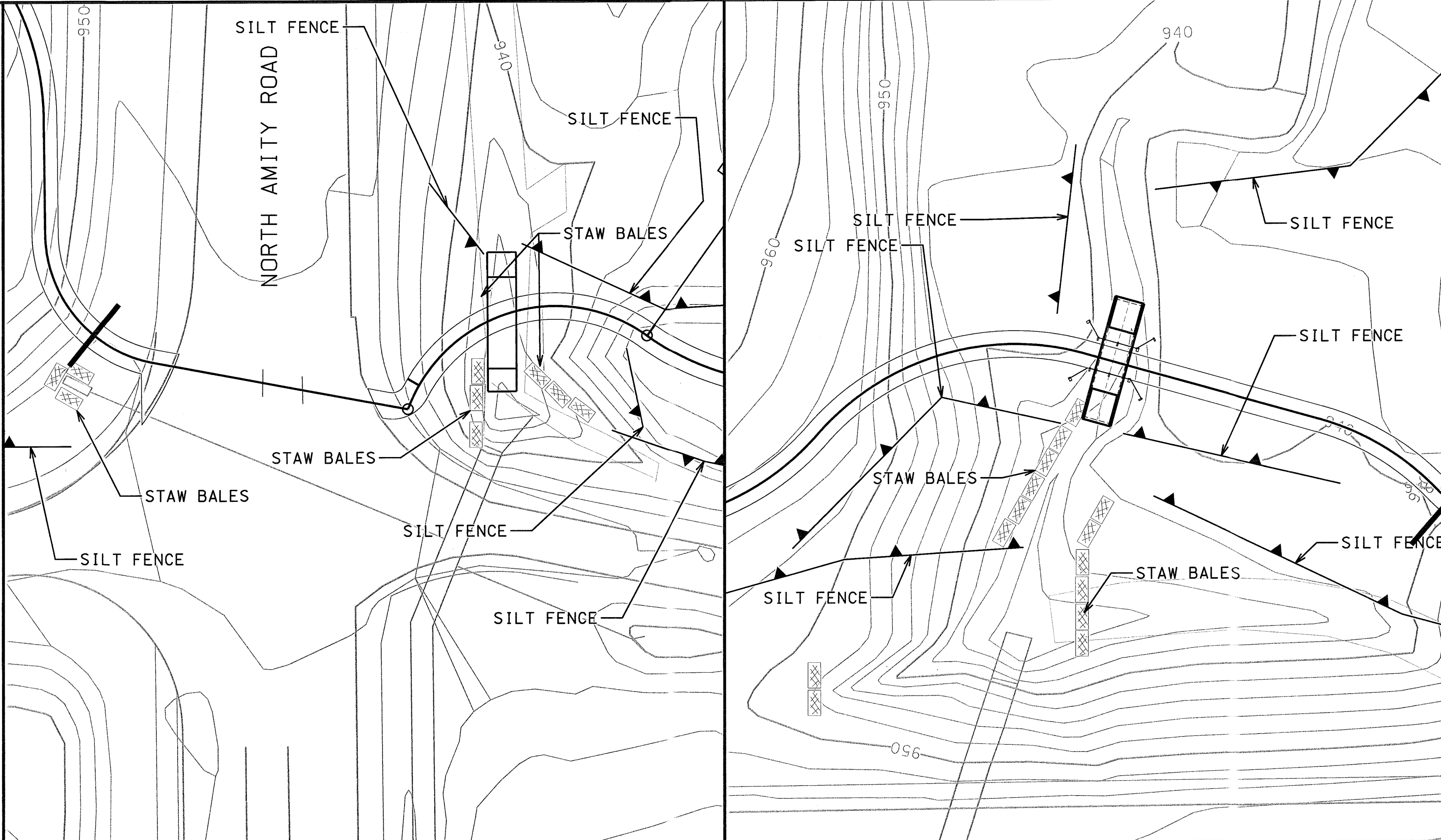

DIRECTION

TAP 3324 (409)

DISCLAIMER
THE PROFESSIONAL ENGINEER'S SIGNATURE AND PERSONAL SEAL APPEAR HEREON ASSUMES RESPONSIBILITY ONLY FOR WHAT APPEARS ON THIS PAGE, AND NOT FOR THE ACCURACY OF THE SURVEYING, SPECIFICATION, ESTIMATES, REPORTS, OR OTHER DOCUMENTS OR INSTRUMENTS NOT SEALED BY THE UNDERSIGNED PROFESSIONAL RELATING TO OR ARISING OUT OF THE PROJECT OR PARTS OF THE PROJECT TO WHICH THIS PAGE REFERS.

CITY OF KANSAS CITY
PUBLIC WORKS
DEPARTMENT

414 E. 12TH STREET
20TH FLOOR
KANSAS CITY, MO 64151
V: (816) 513-2600
F: (816) 513-6974
www.kcmo.org

EROSION CONTROL
ROUTE 152 TRAIL
SEGMENT 3

HOR. SCALE: 1" = 150'
VERT. SCALE: 1" = 150'

9/28/2017

14