

JACKSON COUNTY, MO. PUBLIC WORKS
ENGINEERING DIVISION, 303 W. WALNUT, INDEPENDENCE, MO. 64050

ROCK ISLAND RAIL CORRIDOR SHARED USE PATH-SOUTH SEGMENT
FEDERAL PROJECT NO. STP-345(401)

COUNTY PROJECT #3205
COUNTY BID NO. PW 07-2017

ADDENDUM NO. 1
Dated October 30, 2017

Each bidder shall note these revisions to the Bidding Documents and incorporate these revisions in their bid. Each bidder shall acknowledge receipt of this addendum in the Bid Form of the Bidding Documents.

This addendum consists of this page and the following revisions:

1. RESPONSE TO BIDDERS QUESTIONS

BID OPENING CHANGE, November 9, 2017 at 2:30 p.m.

Phone calls Questions from contractors relating to the Contract:

- 1-1. **Question:** *Since this Addendum is being issued for the project can the contract Bid Opening be changed for additional days?*

Answer: Yes, the Bid Opening for the project, Rock Island Rail Corridor Shared Use Path-South Segment, will change from November 2, 2017 to November 9, 2017 at 2:05 p.m. The location of the Bid Opening is the same as the original contract at the following address:

Jackson County Public Works
303 W. Walnut
Independence, MO. 64050

All the sealed proposal bids must be submitted to the office of the Director of Public Works, Engineering Division, 303 W. Walnut, Independence, Missouri 64050, prior to 2:00 p.m. on November 9, 2017.

- 1-2. **Question:** *Is attending the Pre-Bid Meeting, mandatory?*

Answer: Yes, the Pre-Bid meeting that was held on October 12, 2017 was mandatory. See attached the Pre-Bid Attendance Sheet and the Pre-Bid Presentation.

- 1-3. **Question:** *Who is the contact person for visiting the project site during the bidding process?*

Answer: If contractor(s) want to obtain Bidder's Right of Entry form to enter upon Jackson County, Missouri property on a tract of right of way of the Rock Island Line located at Mile Post 278.5 to 271.9, then please give Eric Johnson, Project Manager, a call at 816-881-4499 to get the form. Please note that the Bidder's

JACKSON COUNTY, MO. PUBLIC WORKS
ENGINEERING DIVISION, 303 W. WALNUT, INDEPENDENCE, MO. 64050

ROCK ISLAND RAIL CORRIDOR SHARED USE PATH-SOUTH SEGMENT
FEDERAL PROJECT NO. STP-345(401)

COUNTY PROJECT #3205
COUNTY BID NO. PW 07-2017

Right of Entry has been extended to November 7, 2017.

- 1-4. **Question:** *At the pre-bid meeting, the % of work to be constructed by the contractor was stated as 40%. What is the correct percentage? The spec book has a different percentage number.*

Answer: The correct percentage is 30%. According to the Special Provision Section SP-18, Assignment and Subletting of Contract (GC-37), states the following on subsection B, "The 40% of the contract work, noted in the General Conditions, shall be reduced to 30%." This means that the Special Provision has modified portions of the General Conditions section 37 to now state the following: Contractor's own forces and equipment shall perform not less than **30 percent** of the contract work.

- 1-5. **Question:** *Can the contractor keep the railroad ties?*

Answer: Yes, the contractor can keep the railroad ties and shall properly dispose them in accordance with Missouri Department of Natural Resources (MDNR) Publication 196 "RAILROAD TIES AND UTILITY POLES", dated October, 2015. See attached documentation.

2. SPECIFICATIONS

- 2-1. Jackson County Public Works (JCPW) has encountered two incorrect and different project numbers, 3204 and 3218 within the specifications and construction plans. **Please note that the correct County Project Number shall be 3205.**
- 2-2. Within the Bid Packet the bidder contractor shall sign the Proposal page P-2 "Addenda Certification" and note they received their ADDENDUM No. 1.

ADDENDUM 1 Prepared by: Chris Jenkins with Jackson County Public Works

END OF ADDENDUM NO. 1

ATTENDANCE SHEET FOR PRE-BID MEETING

October 12, 2017

Rock Island Shared Use Path South Segment STP-3453(401)

Project Number 3204

Bid Number PW 17-2017

NAME	REPRESENTING	TELEPHONE #
Rod Holcomb	Burns & McDonnell	816 349 6693
Barclay Horning	Comanche Const., Inc.	816-830-7509
Clint Hayes	Radmacher Bros.	816-540-3614
Pic Johnson	Jackson County	816-881-4499
Troy Collins Sr	JACKSON County	(816) 804-3922
Shirley Jenkins	Jackson County DW	816-331-4429
Tom Wyrsch	JACKSON County	816-881-3302
Holly Lilling	J.A. Lilling Excavating M/PBE	816-331-2280
GARY SHEYMAKOR	Emery Sapp & Sons	816-221-3500
Mark Holmes	Pyramid Contractors	913-764-6225
Adam Bax	Midwest Heavy Construction	816-623-9680
DUSTIN STULL	J.M. FANEY CONSTRUCTION	816-763-3010
Eva Steinman	MoDOT	816-607-2255
John Wright	Pyramid Excavators	816-765-4464
MATT LAZZLE	Musselman & Han Contractors	816-985-2679

October 12, 2017

Rock Island Shared Use Path South Segment STP-3453(401)

Project Number 3204

Bid Number PW 17-2017

NAME _____

REPRESENTING

TELEPHONE #

Shawn Berkey

Miles Excavating

913-724-1934

KEN ASHMORE

AMINO BROTHERS CO., INC.

913-33A-2330

PAT WEAVER

CLARKSON

(816) 483-8800

TYLER WESSELMAN

MEGA INDUSTRIES

816-472-7222

TREVOR KRATZBERG

LEAVENWORTH EXCAVATING & EQUIPMENT CO.

913-727-1234

GUNTER CONSTRUCTION CO. ↔ TOM GRESKO

913-362-7841

Rock Island Corridor Shared Use Path South Segment

STP-3453(401)

Project # 3205

PW Bid # 17-2017

Pre-Bid Meeting – October 12, 2017

Project Overview

- 6.4 miles
- Brickyard Rd. (Kansas City) to Jefferson Street (Lee's Summit)
- Rail and tie removal and disposal, earthwork, crushed rock, concrete, ADA ramps, pavement striping, signal modification, bridge modification, tunnel repair, tunnel lighting
- Delivery period: 270 calendar days
- Liquidated Damages

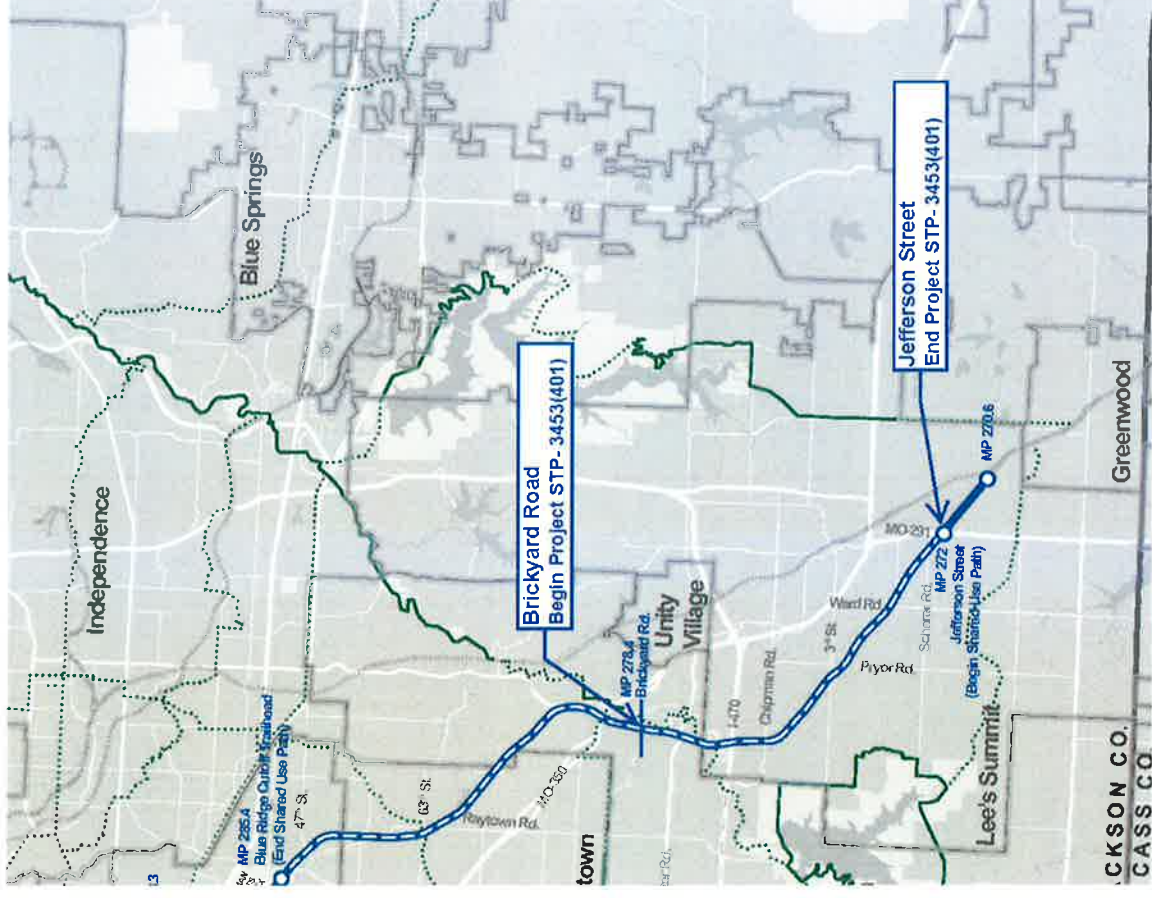

Project Overview

- MoDOT/FHWA oversight & concurrence with award
- 12% DBE goal – must be certified by MRCC by time of bid opening
- Wage rates: State and Federal, whichever is higher
- E-Verify, Buy America, & other Federal requirements apply
- MoDOT pre-approved contractors

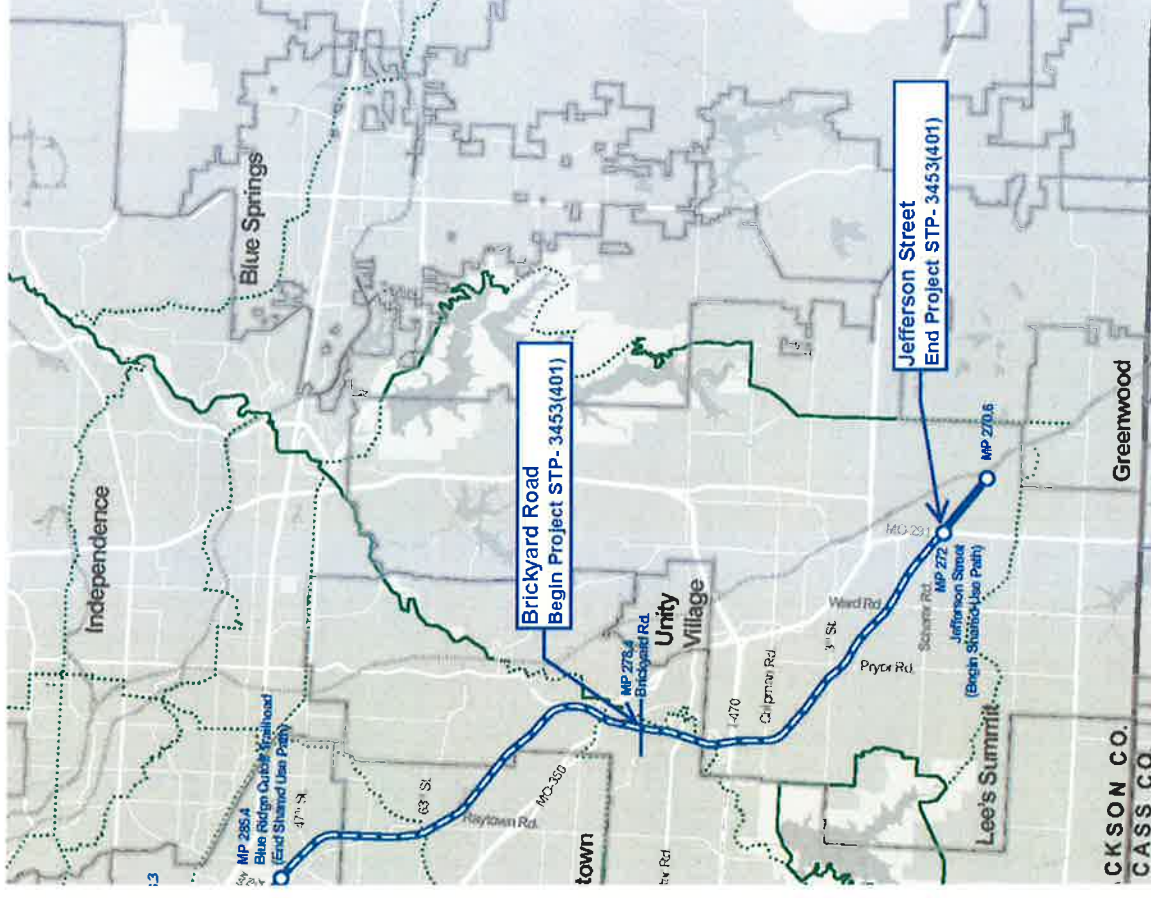

- Last Day for Questions: October 17
- Final Addendum Release: October 20
- Anticipated NTP in mid-December

Job Site Access

- Bidders may enter site for purposes of preparing a bid. Please fill out a Right of Entry agreement and comply with its provisions.
- **ONLY** access is through public ROW







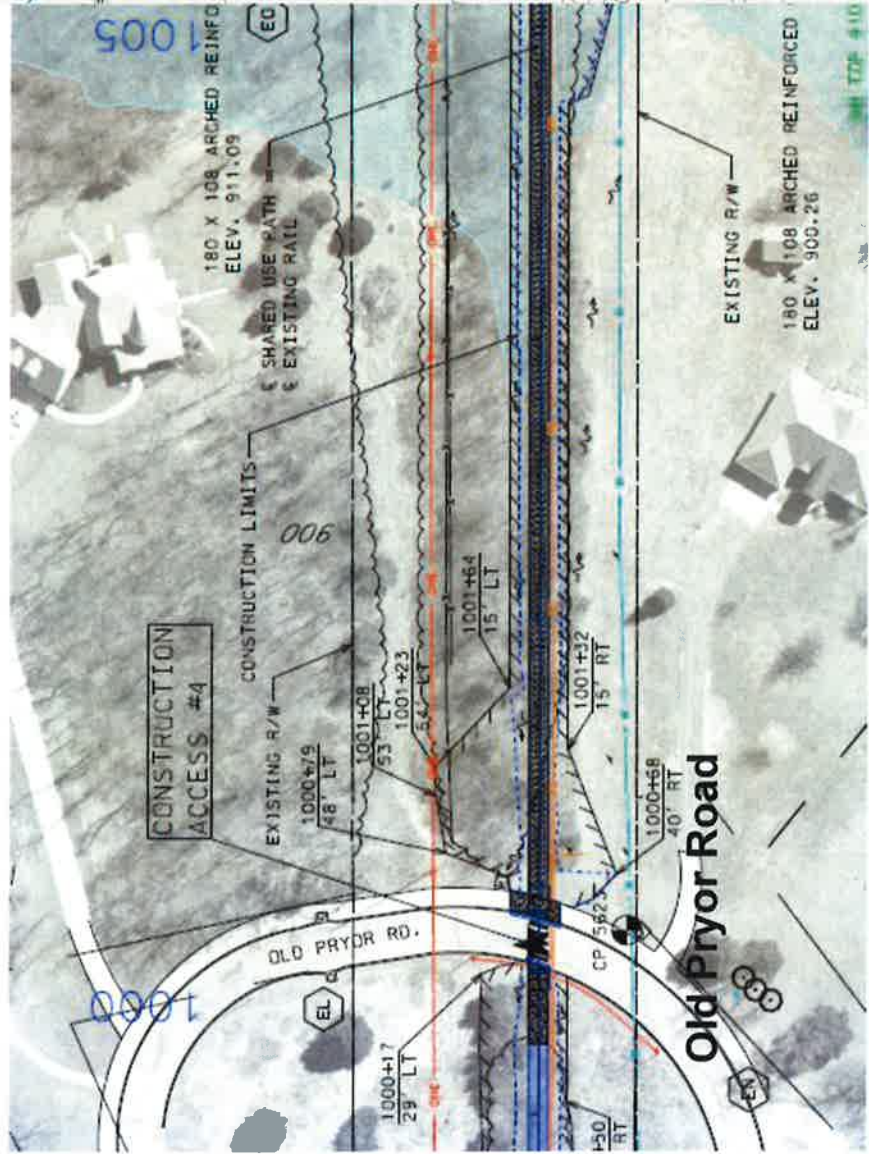

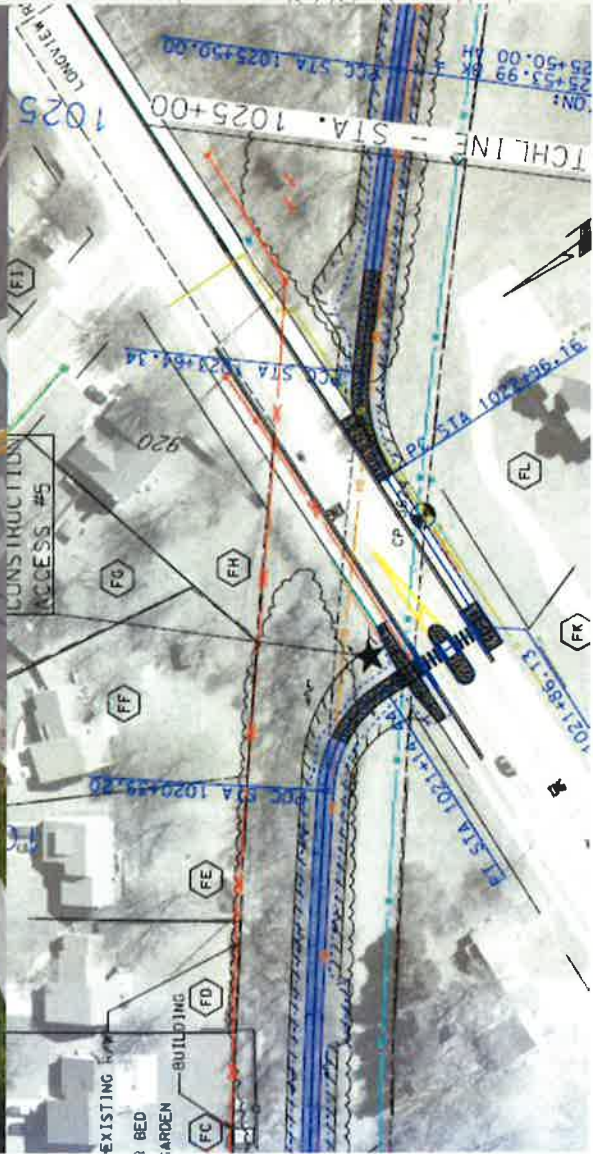
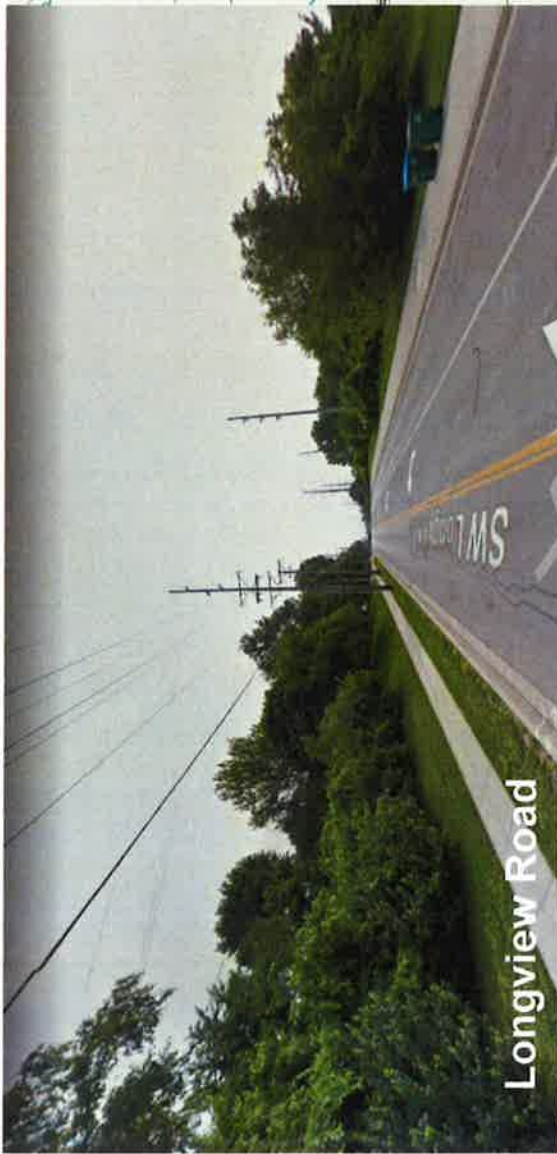

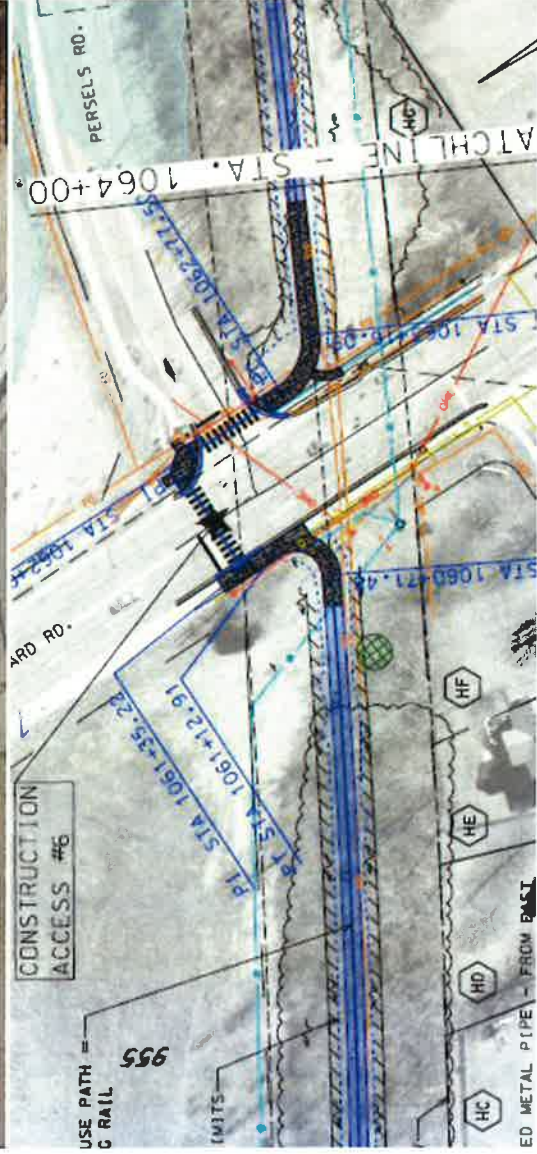

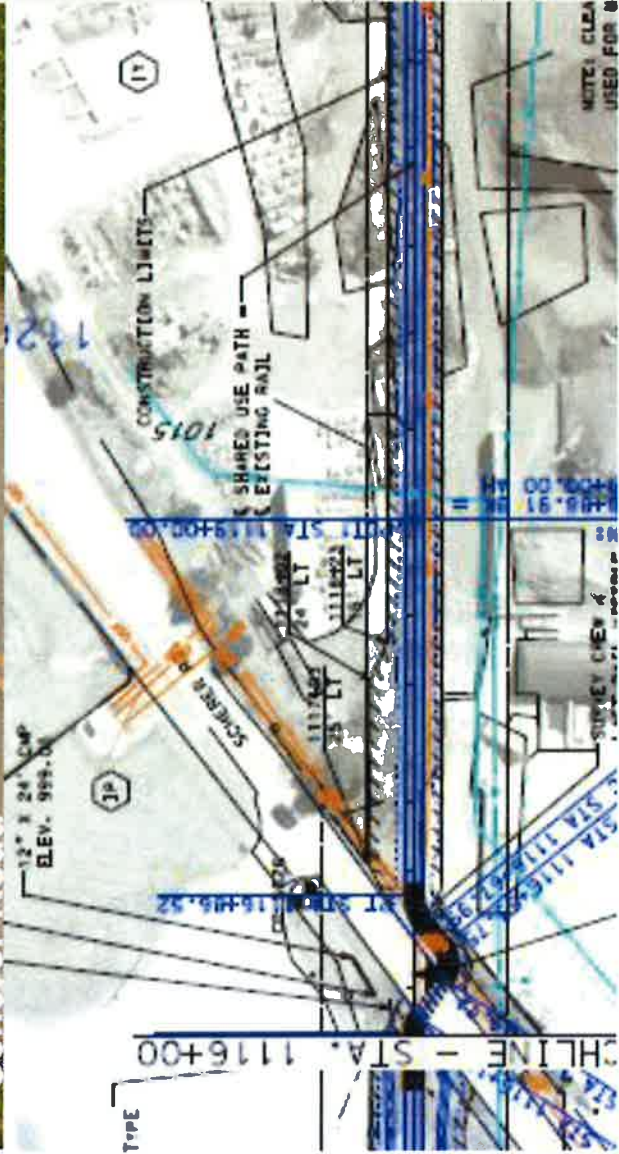
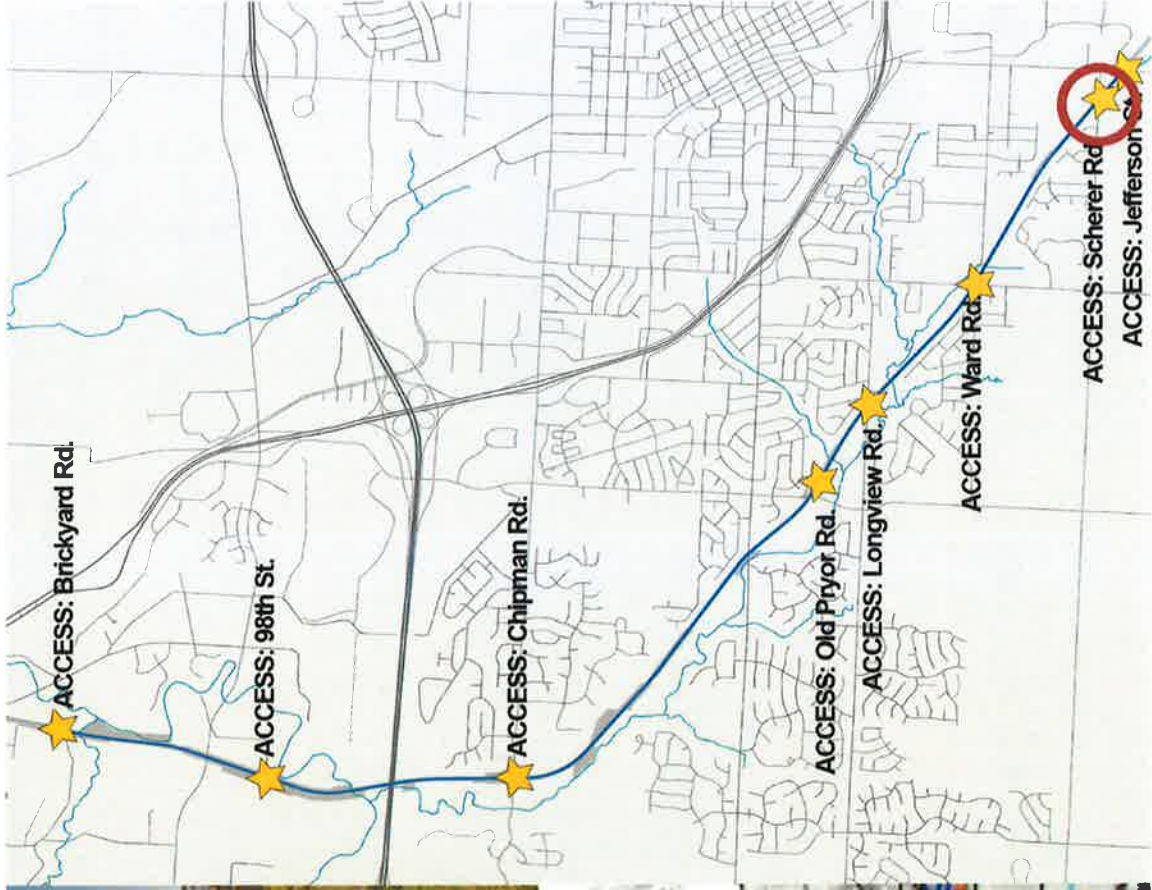

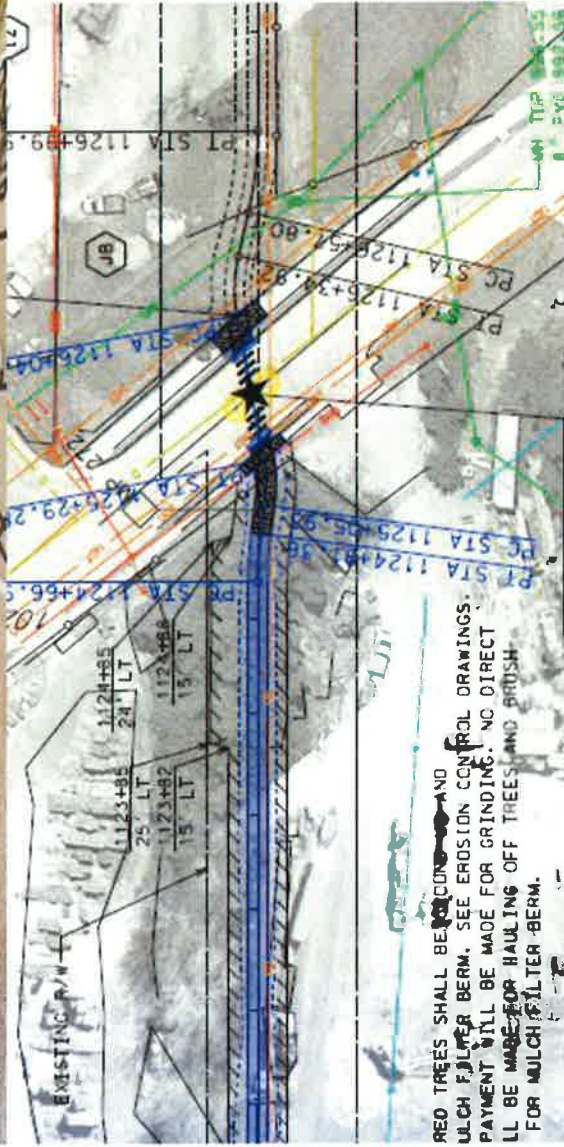

Permit Delay

- Permits are in process and expected to be available by NTP.
- Most of the corridor is unaffected by these permits

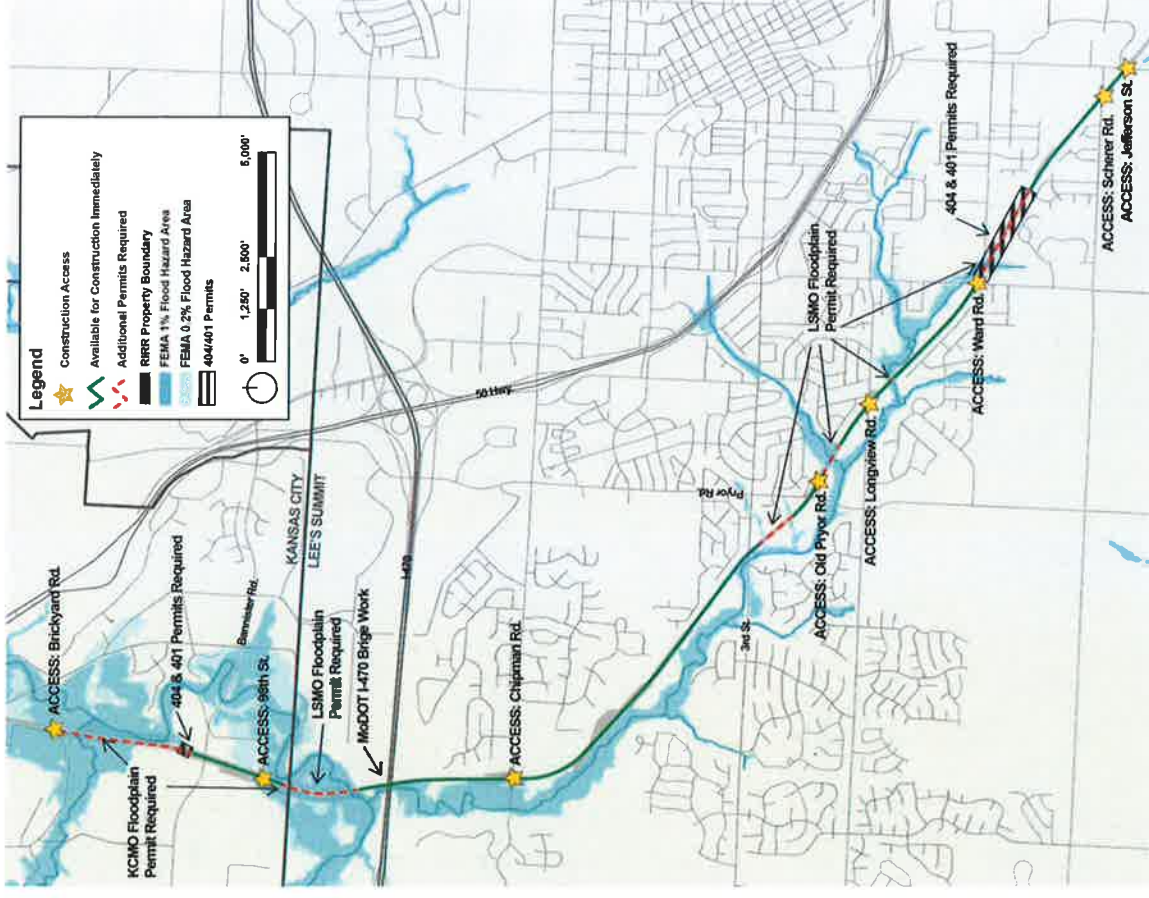

Other project highlights

- **Encroachments:** County is working with encroaching property owners. If you encounter an unexpected encroachment,
- **Erosion control:** should use tree mulch in place of erosion control fence (but supplement with fence if needed)
- **Roll testing required**
- **Traffic control:** coordinate with County and City of Lee's Summit
- **Utilities**
 - **Fiber** (work around & locate at a few culvert)
 - **Water & Sewer** (work around)

Q & A

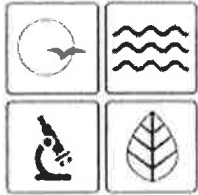

Missouri Department of Natural Resources

RAILROAD TIES AND UTILITY POLES

Solid Waste Management Program fact sheet
Division of Environmental Quality Director: Ed Galbraith

10/2015
PUB196

Introduction

This fact sheet addresses management alternatives for proper handling of waste railroad ties and utility poles. Waste railroad ties and utility poles are considered regulated solid waste under the Missouri Solid Waste Management Law. Three programs of the Missouri Department of Natural Resources (department) administer and enforce requirements that may affect the management of these wastes. They are the Air Pollution Control Program, the Solid Waste Management Program and the Hazardous Waste Program.

Treated wood contains pesticides and substances that are safe when the wood is used as intended, but can cause problems if the wood waste is mishandled. The fresher and more unweathered the wood, the higher the concentration of hazardous chemicals they may contain. Treated wood should not be open-burned or burned in stoves, shredded into mulch, used as fill, or managed in any way that could allow hazardous substances to be released to the environment. Treated wood waste (including sawdust) should be disposed in landfills permitted for sanitary or demolition waste, or only burned in incinerators or energy recovery units that have permits to burn treated wood.

The department encourages using an integrated hierarchy to manage waste, including old railroad ties and utility poles. That hierarchy is:

- Reduce the amount of solid waste created
- Reuse and recycle
- Recover and use energy from solid waste
- Incinerate or dispose of in a permitted solid waste landfill

Reduce

The department encourages railroad ties to be used and maintained within the railroad bed for as long as they can safely support the tracks.

Reuse and Recycle

Railroad ties are commonly reused as landscaping timbers, retaining walls, etc. Waste utility poles are commonly reused for building purposes, etc. If at all possible, waste railroad ties and utility poles should be reused for these kinds of purposes.

Energy Recovery

Railroad ties and utility poles may be used as an alternative fuel in certain high temperature combustion chambers such as cement kilns or power plant boilers. Any operation of this type would need temperatures of sufficient nature for the destruction of certain hazardous compounds. Any fuel usage would have to be permitted by the Air Pollution Control Program.

Incineration

The open burning (including use of an air curtain destructor) of railroad ties and utility poles is prohibited. The rules of the Air Pollution Control Program prohibit the open burning of such trade wastes. Additionally, railroad

ties and utility poles are routinely treated with creosote and pentachlorophenol. Because of the inefficient combustion that occurs during the open burning of these materials, toxic emissions will be produced, possibly causing a threat to human health.

However, the disposal of railroad ties and utility poles in an incinerator permitted by the Air Pollution Control Program may be allowed if the incinerator is specifically permitted for this type of material. An incinerator for burning railroad ties or utility poles will also require a permit from the Solid Waste Management Program to operate a solid waste processing facility.

Landfill Disposal

As a regulated solid waste, railroad ties and utility poles may be disposed of in a permitted sanitary landfill or a permitted demolition landfill. No other land disposal option exists in the Solid Waste Management Law.

For more information on handling of waste railroad ties and utility poles, contact the Solid Waste Management Program at 573-751-5401, the Air Pollution Control Program at 573-751-4817 or the Hazardous Waste Program at 573-751-3176.

Nothing in this document may be used to implement any enforcement action or levy any penalty unless promulgated by rule under chapter 536 or authorized by statute.

For more information

Missouri Department of Natural Resources
Solid Waste Management Program
P.O. Box 176
Jefferson City, MO 65102-0176
800-361-4827 or 573-751-5401
<http://dnr.mo.gov/env/swmp>
