



City of Trenton
Trenton Municipal Utilities
1100 Main St
Trenton MO 64683
660-359-4310 ~ 660-359-2283 ~ Fax: 660-359-2284
www.trentonmo.com

Date: 8/6/2019
To: Potential Bidders
SUBJECT: 17th Street Bridge Replacement over Union Pacific Railroad
Bid Addendum #2
Trenton, MO, Grundy County
Job No. RRP-000S(416)

Bid Addendum #2
Bid Form
&
Q/A regarding Barrier/Moment Slab Construction

The Bid Form is modified as follows;

- Bid Form

Revised the unit of measure to be square yards for item #65, Slab on Concrete Beam.

Replace page 13 of the Project Manual with the attached page.

This was correctly shown on the bridge plans but was mistakenly labelled as lineal feet on the bid form.

Question #1

Would it be allowed to put a construction joint in the barrier and moment slab as shown in the attached to make the moment slab easier to cast in place?

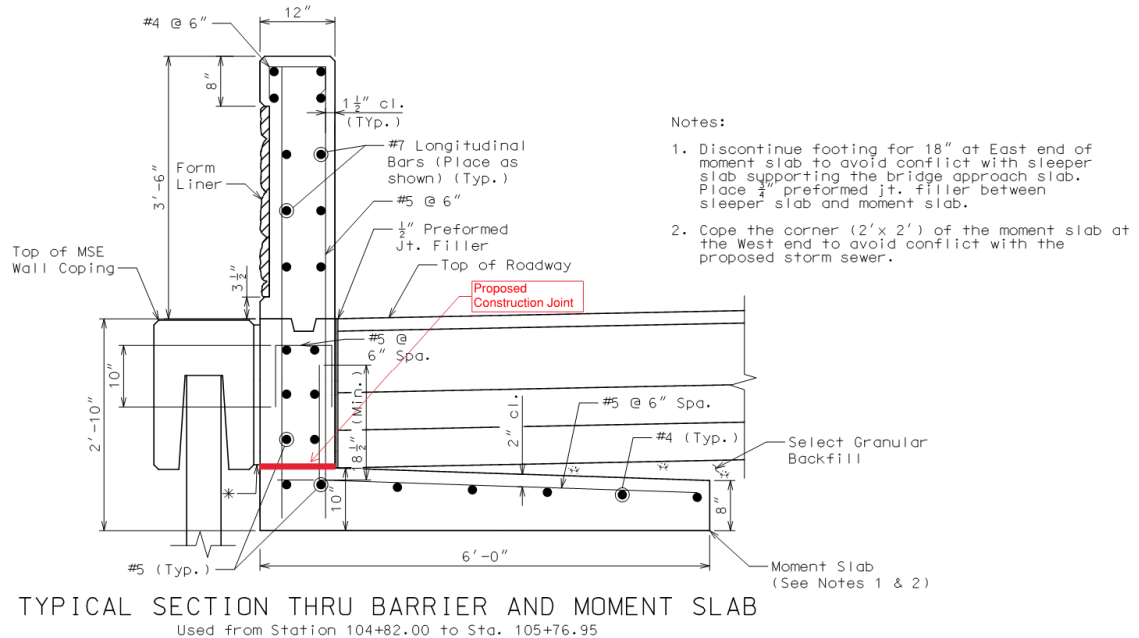

Note: This drawing is not to scale. Follow dimensions.

Sheet No. 34 of 109

Response: Yes. Addition of a construction joint at this location would be an acceptable modification so long as a shear key, similar to the one at the top of the slab, is provided by the Contractor.

This change would not affect measured bid item quantities or payment provisions.

Bidders are instructed to acknowledge receipt of Bid Addendum #2 on the bid form when submitting a bid. Omission of this acknowledgement may disqualify the Bidder's proposal.

Ron Urton
City Administrator & Utilities Director
Trenton, MO

32	Type 3 Erosion Control Blanket	1446	Sq. Yd.		
33	Seeding, Cool Season Mix	2052	Sq. Yd.		
34	Seeding, Fescue Mixture	2052	Sq. Yd.		
35	Construction Signs	685.0	Sq. Ft.		
36	Advanced Warning rail System	4	Each		
37	Channelizer (Trim line)	20	Each		
38	Type III Moveable Barricade with Light	21	Each		
39	Changeable Messign Sign, without communication inter.	2	Each		
40	Temporary Concrete Barrier	4	Each		
41	Remove and Reset Signs	9	Each		
42	Precast concrete drop Inlet, 2X2	13.2	Lin. Ft.		
43	Curved Vane Grate and Frame, 2X2	4	Each		
44	Precast concrete drop Inlet, 4X2	21.75	Lin. Ft.		
45	Curved Vane Grate, 4X2	6	Each		
46	15" Flared End Section	3	Each		
47	15" Class III Reinforced Concrete Pipe	428	Lin. Ft.		
48	Rock Lining	4	Cu. Yd.		
49	48" I.D. Concrete Manhole	1	Each		
50	Manhole Frame and Cover, MODOT Type 1-B	1	Each		
51	Adjust Water Valve	1	Each		
52	Adjust Lamp Hole	1	Each		
53	Class I Excavation	500	Cu. Yd.		
54	Temporary Shoring	1	Lump Sum		
55	Removal of Bridges (23705)	1	Lump Sum		
56	Vertical Drain at End Bent	2	Each		
57	Bridge Approach Slab (Major Road)	173	Sq. Yd.		
58	(78 in.) Pedestrian Fence (Structures)	143	Lin. Ft.		
59	(108 in.) Pedestrian Fence (Structures)	181	Lin. Ft.		
60	Galvanized Cast-in-Place Concrete Piles (16 in.)	3760	Lin. Ft.		
61	Dynamic Pile Testing	4	Each		
62	Class B Concrete (Substructure)	349.2	Cu. Yd.		
63	Safety Barrier Curb	365	Lin. Ft.		
64	Form Liners	91	Sq. Yd.		
65	Slab on Concrete Beam	618	<u>Sq. Yd.</u>		
66	Concrete Curb (Bridge Rail)	181	Lin. Ft.		
67	21 in., Prestressed Concrete Spread Box Beam	557	Lin. Ft.		
68	Reinforcing Steel (Bridges)	31860	Lbs		
69	Conduit System on Structure	1	Lump Sum		
70	Concrete Finish	1	Lump Sum		
71	Laminated Neoprene Bearing Pad (Tapered)	16	Each		
72	Laminated Neoprene Bearing Pad	8	Each		
73	Mechanically Stabilized Earth Wall Systems	1215	Sq. Ft.		
74	Concrete and Masonry Protection System	1	Lump Sum		
75	Sacrificial Graffiti Protection System	1	Lump Sum		
76	Form Liners for MSE Wall Systems	135	Sq. Yd.		
77	Railroad Flagging	100	Days	\$1270.00	\$127,000.00

Addendum #2 - (8/6/2019)