

DETOUR

MO4-8

M1-5

M6-3

50A

DETOUR

MO4-8

M1-5

M5-1R

50B

DETOUR

MO4-8

M1-5

M6-1

50C

DETOUR

MO4-8

M1-5

M5-1L

50D

DETOUR

MO4-8

M1-5

M6-1

50E

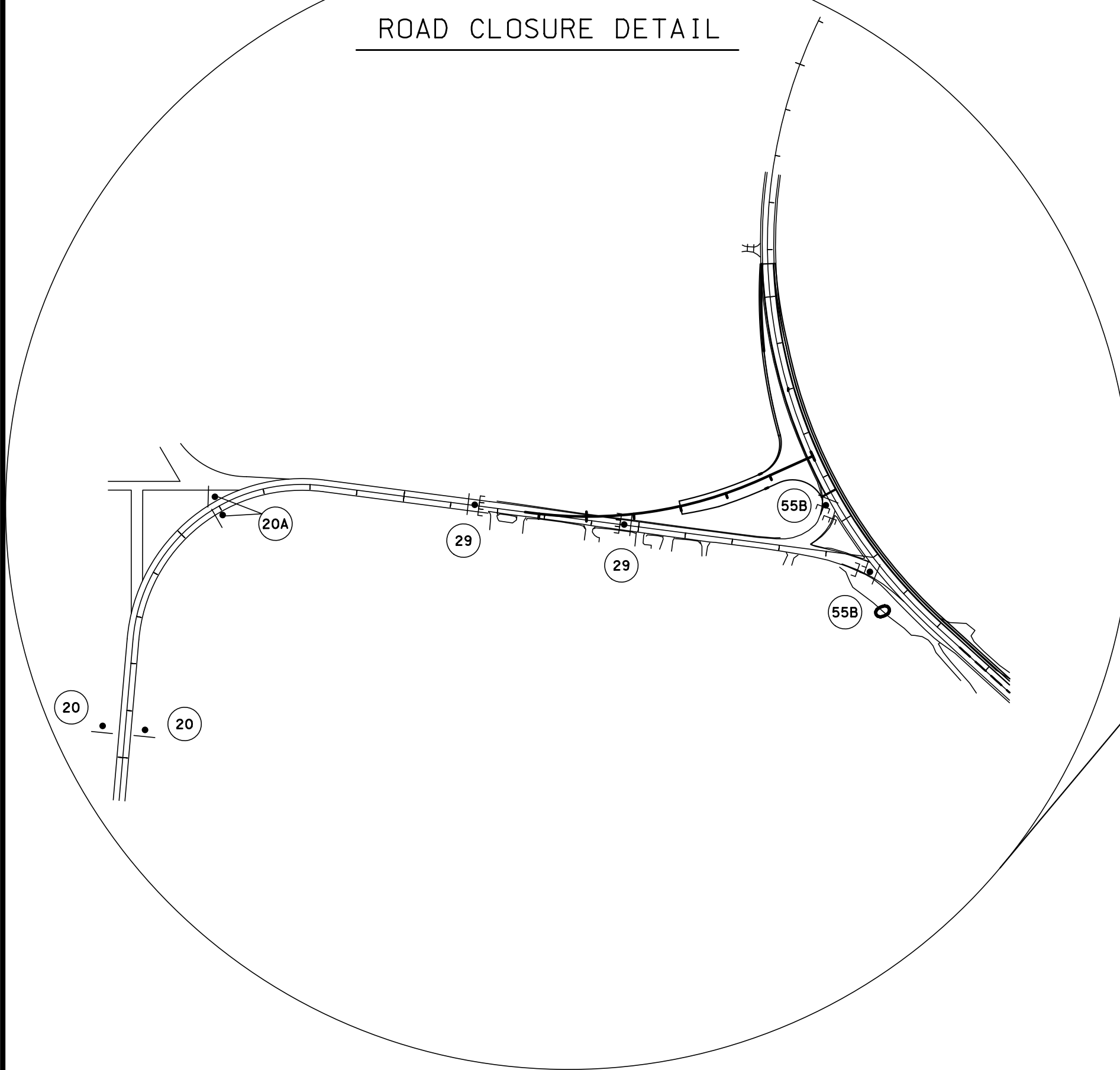

STAGE 3 CONSTRUCTION
ROUTE 133 ROAD CLOSURE

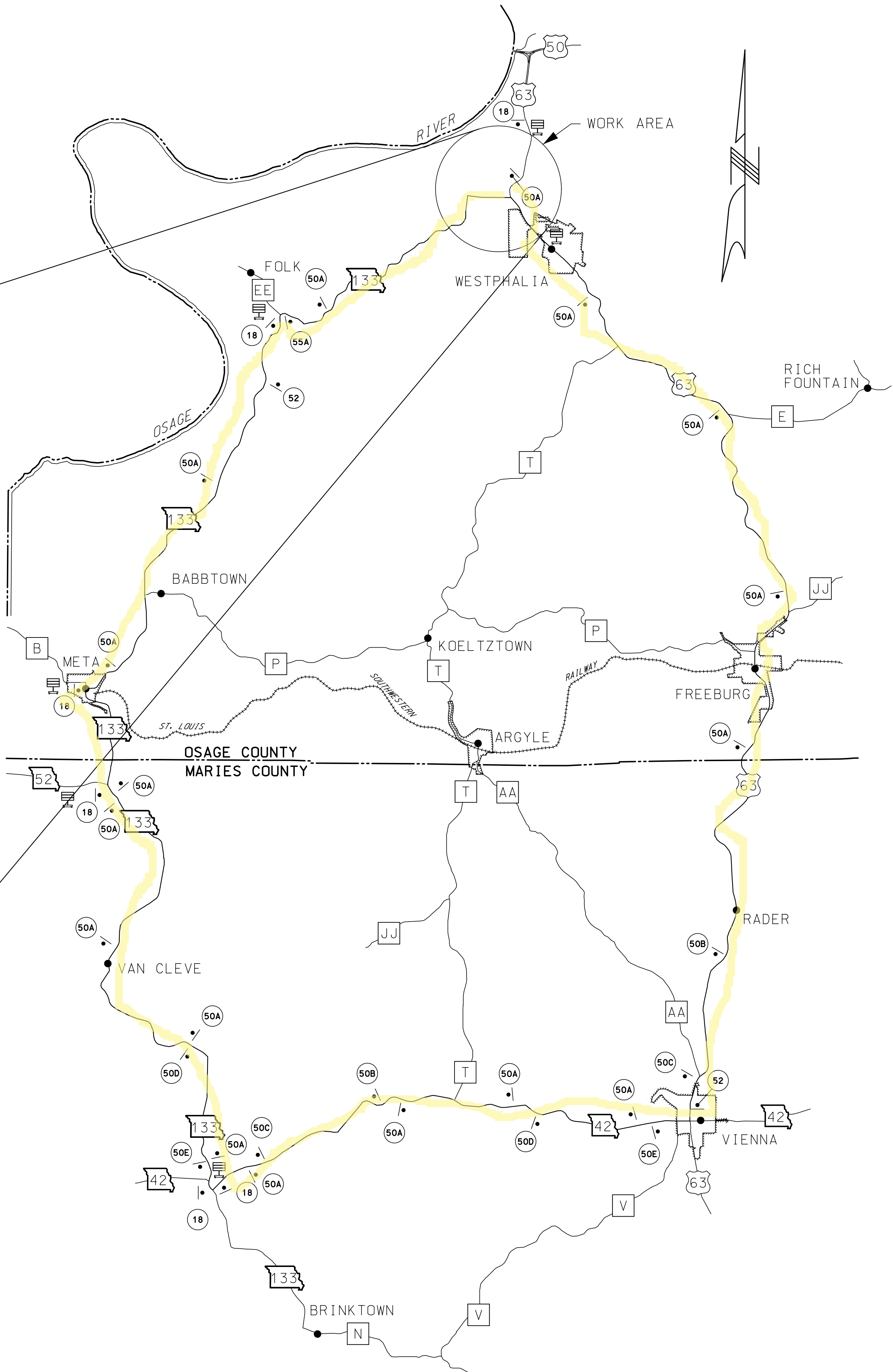

NOT TO SCALE

ROAD
CLOSED
AHEAD

W020-2

18

DETOUR
AHEAD

W020-3

20

ROAD
CLOSED
500 FT

W020-3a

20a

ROAD
CLOSED

R11-2

29

ROAD CLOSED
6 MILES AHEAD
LOCAL TRAFFIC ONLY

R11-3a

55A

ROAD CLOSED
TO
THRU TRAFFIC

R11-4

55B

END
DETOUR

MO4-8a

52

ANY EXISTING SIGN THAT CONFLICTS WITH THE TRAFFIC CONTROL SIGNING SHALL BE COMPLETELY COVERED OR REMOVED AND REPLACED.

PLACEMENT OF TRAFFIC CONTROL SIGNS IS APPROXIMATE AND MAY BE ADJUSTED TO FIT FIELD CONDITIONS AS APPROVED BY THE ENGINEER.

ALL SIGNS SHOWN ON THIS SHEET ARE NON-PORTABLE AND SHALL REMAIN IN PLACE FOR THE DURATION OF THE PROJECT.

TRAFFIC CONTROL LEGEND

SIGN (SINGLE SIDED)

TYPE III
MOVABLE BARRICADE

CHANGEABLE MESSAGE BOARD

TRAFFIC CONTROL

SHEET 4 OF 5

THIS MEDIA SHOULD NOT BE CONSIDERED A CERTIFIED DOCUMENT.

DATE PREPARED
9/5/2018

ROUTE
63/133

STATE
MO

DISTRICT
CD

SHEET NO.
13

COUNTY
OSAGE

JOB NO.
J5P3186

CONTRACT ID.

PROJECT NO.

BRIDGE NO.

DESCRIPTION

DATE

MISSOURI HIGHWAYS AND TRANSPORTATION COMMISSION

105 WEST CAPITAL
JEFFERSON CITY, MO 65102
1-888-ASK-MODOT (1-888-275-6636)

IF A SEAL IS PRESENT ON THIS SHEET IT HAS BEEN ELECTRONICALLY SEALED AND DATED.

REV.