

Addendum 3
Roadway Improvements
W. Karsch Blvd (MO Rte 32) and Walton Rd
W. Karsch Blvd (MO Rte 32) and N. Potosi Street
Farmington, Missouri
Federal Job # STP-2500(007)

Date: May 28, 2019

To: Prospective Bidders

Owner: City of Farmington
Department of Public Works
110 W Columbia, Farmington, MO 63640

Engineer: Brian Courtwright, P.E.
CBB
340 Regency Centre
Collinsville, IL 62234

<p>This Addendum forms a part of the Bidding and Contract Documents and modifies the originals. FAILURE TO ACKNOWLEDGE RECEIPT OF ADDENDUM MAY SUBJECT BIDDER TO DISQUALIFICATION.</p>
--

The purpose of this addendum is to make the following clarifications and revisions to the bid documents. This addendum provides clarifications/revisions to:

- Addition of JSP 27 "SPECIAL GRATE";
- Clarification on Type T Lid;
- Clarification on Type T-1B Frame & Cover;
- Clarification on Sidewalk Handrailing without Balusters.

-
1. Add JSP 27 "SPECIAL GRATE".
 2. Refer to MoDOT Standard Drawing 731.10 for Curb Inlet - Type T.
 3. Refer to MoDOT Standard Drawing 614.30 for Type 1B Frame & Cover.
 4. Refer to MoDOT Standard Drawing 608.40 for Sidewalk Handrailing without Balusters.

ATTACHMENTS

- Revised Sealed JSP Table of Content.
- JSP 27 "SPECIAL GRATE".

**W. Karsch Blvd (MO Rte 32) And Walton Rd
W. Karsch Blvd (MO Rte 32) And N. Potosi Street
Farmington, Missouri**

STP-2500(007)

JOB SPECIAL PROVISIONS – TABLE OF CONTENTS

(Job Special Provisions shall prevail over General Special Provisions whenever in conflict therewith.)

JSP-1*	PROJECT CONTACT FOR CONTRACTOR/BIDDER QUESTIONS	2
JSP-2*	EMERGENCY PROVISIONS AND INCIDENT MANAGEMENT	2
JSP-3*	UTILITIES	3
JSP-4*	ADA COMPLIANCE AND FINAL ACCEPTANCE OF CONSTRUCTED FACILITIES JSP-10-01A	4
JSP-5*	CURB AND GUTTER TYPE B (MODIFIED)	6
JSP-6*	MODIFIED LINEAR GRADING, CLASS 2	6
JSP-7*	SEGMENTAL BLOCK RETAINING WALL	7
JSP-8*	RELOCATE EXISTING SIGN (903-99.04)	7
JSP-9*	12 IN. WHITE ACRYLIC COPOLYMER FAST DRY PAVEMENT MARKING PAINT	7
JSP-10*	LANDSCAPING GRAVEL	8
JSP-11*	PARKING BLOCK	8
JSP-12*	RELOCATED MODOT LIGHT POLE	8
JSP-13*	RELOCATED CITY LIGHT POLE	9
JSP-14*	1' X 1' LIGHTING PULLBOX	9
JSP-15*	VERIFY AND REASSIGN EXISTING LIGHTING CIRCUITS	9
JSP-16*	TRI-PLEX LIGHTING CABLE	10
JSP-17*	62" SIGNAL POST	10
JSP-18*	DRILL OPENING IN EXISTING PULLBOX	10
JSP-19*	ADJUST EXISTING PULLBOX TO GRADE	11
JSP-20*	RELOCATE EXISTING SIGNAL CABINET	11
JSP-21*	MODIFY EXISTING SIGNAL CABINET	11
JSP-22*	COORDINATION WITH MODOT SLITS AND UTILITY LOCATES	12
JSP-23*	PEDESTRIAN SIGNAL HEADS	12
JSP-24*	MODOT ITS EQUIPMENT WITHIN PROJECT LIMITS	14
JSP-25*	WORK ZONE TRAFFIC MANAGEMENT PLAN	14
JSP-26*	TRAFFIC SIGNAL TIMING AND PROGRAMMING	17
JSP-27*	SPECIAL GRATE	18

	MISSOURI HIGHWAYS AND TRANSPORTATION COMMISSION 105 W. CAPITOL AVE. JEFFERSON CITY, MO 65102 Phone 1-888-275-6636
	CONSULTANT NAME <i>CBB Transportation</i> 12400 Olive Boulevard, Suite 430 St. Louis, MO. 63141 Certificate of Authority: Consultant Phone: 314-878-6644
	If a seal is present on this sheet, JSP's have been electronically sealed and dated.
	JOB NUMBER: 002-17 ST. LOUIS, MO DATE PREPARED: 2/22/19 PS&E SUBMITTAL
	ADDENDUM DATE: 5/28/19

Only the items of the Job Special Provisions (Roadway) marked with a * above are authenticated by this seal.

JSP – 27 SPECIAL GRATE

1.0 Description. The Contractor shall provide and install a “special grate” at the proposed ditch flow line as shown in the plans and according to the detail shown below. Alternative style of grates can be provided by the Contractor if first approved by the City.

2.0 Detail.

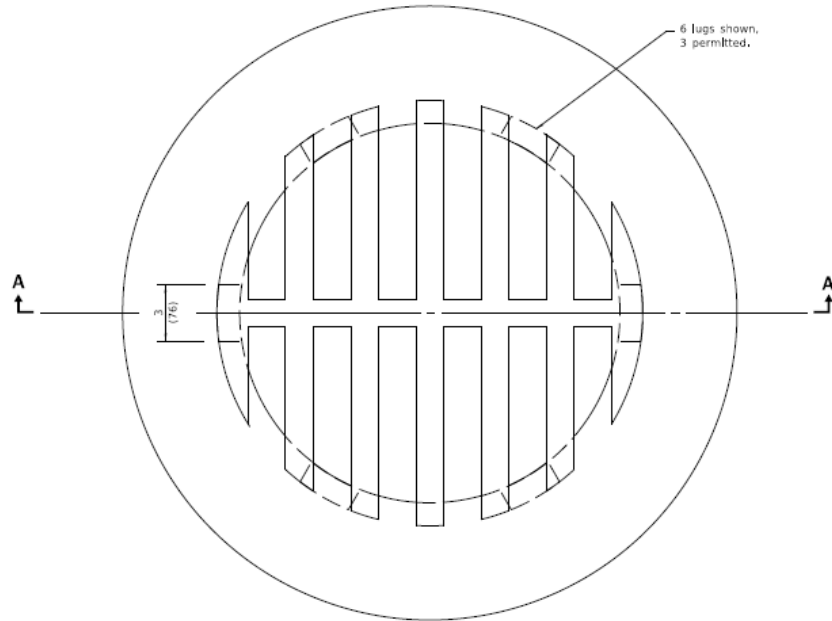

CAST GRATE

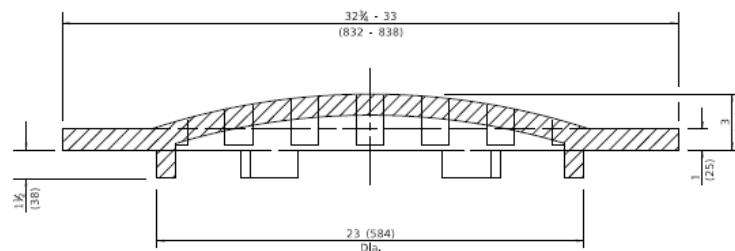

SECTION A-A

3.0 Basis of Payment. All costs associated with compliance with this special provision for all material, equipment, and labor shall be completely covered by the contract unit price for Item Number 614-99.02 “SPECIAL GRATE” per EACH.

END OF JOB SPECIAL PROVISION JSP-27