

A.A.D.T. - 2019= 207
A.A.D.T. - 2039 = 229
D.H.V. = 16.61%
T = 10.73%
V = 55 M.P.H.
D = 48.3% & 51.7%

FUNCTIONAL CLASSIFICATION- MAJOR COLLECTOR

	EXISTING	NEW
BUILDINGS AND STRUCTURES		
GUARD RAIL		
GUARD CABLE		
CONCRETE RIGHT-OF-WAY MARKER		
STEEL RIGHT-OF-WAY MARKER		
LOCATION SURVEY MARKER		
UTILITIES		
FIBER OPTICS	- FO -	- FO -
OVERHEAD CABLE TV	- OTV -	- OTV -
UNDERGROUND CABLE TV	- UTV -	- UTV -
OVERHEAD TELEPHONE	- OT -	- OT -
UNDERGROUND TELEPHONE	- UT -	- UT -
OVERHEAD POWER	- OE -	- OE -
UNDERGROUND POWER	- UE -	- UE -
SANITARY SEWER	- S -	- S -
STORM SEWER	- SS -	- SS -
GAS	- G -	- G -
WATER	- W -	- W -
MANHOLE		
FIRE HYDRANT		
WATER VALVE		
WATER METER		
DROP INLET		
DITCH BLOCK		
GROUND MOUNTED SIGN		
LIGHT POLE		
H-FRAME POWER POLE		
TELEPHONE PEDESTAL		
FENCE		
CHAIN LINK		
WOVEN WIRE		
GATE POST		
BENCHMARK		

NOTE: DASHED OR OPEN SYMBOLS INDICATE EXISTING FEATURES

DESCRIPTION	SHEET NUMBER
TITLE SHEET -----	1
QUANTITIES (QU) (1 SHEET)-----	2
TRAFFIC CONTROL SHEET (TC)-----	3-4

[illegible]

IF A SEAL IS PRESENT ON THIS SHEET IT HAS BEEN ELECTRONICALLY SEALED AND DATED:

WRONG WAY DO NOT ENTER SIGNS									
INTERSECTION ID LOCATION	RAMP DIRECTION	WRONG WAY R5-1A 42"X30" 2.5" PSST POST EACH	DO NOT ENTER R5-1 36"X36" 2.5" PSST POST EACH	TRUCK OR TRAILER MOUNTED ATTENUATOR (TMA) EACH	PARTIAL RAMP CLOSURE LS	SHOULDER WORK AHEAD LS	REMOVAL OF EXISTING SIGN,POST FOOTING EACH	REMOVAL OF EXISTING SIGNS FROM EXIST. POST EACH	REMARKS
35 S	SOUTH	2	2	1	1	1	1	2	USE IN PLACE ONE WAY & STOP SIGNS
35 N	NORTH	2	2	1	1	1	1	2	USE IN PLACE ONE WAY & STOP SIGNS
44 S	SOUTH	2	2	1	1	1	1	1	
44 N	NORTH	2	2	1	1	1	1	1	
47 S	SOUTH	2	2	1	1	1	1	1	USE IN PLACE ONE WAY & STOP SIGNS
47 N	NORTH	2	2	1	1	1	1	2	USE IN PLACE ONE WAY & STOP SIGNS
60 S	SOUTH	2	2	1	1	1	1	2	USE IN PLACE ONE WAY & STOP SIGNS
60 N	NORTH	2	2	1	1	1	1	2	USE IN PLACE ONE WAY & STOP SIGNS
65 S	SOUTH	2	2	1	1	1	1	2	USE IN PLACE ONE WAY & STOP SIGNS
65 N	NORTH	2	2	1	1	1	1	2	USE IN PLACE ONE WAY & STOP SIGNS
67 S	SOUTH	2	2	1	1	1	1	1	USE IN PLACE ONE WAY & STOP SIGNS
67 N	NORTH	2	2	1	1	1	1	2	USE IN PLACE ONE WAY & STOP SIGNS
75 S	SOUTH	2	2	1	1	1	1	2	USE IN PLACE ONE WAY & STOP SIGNS
75 N	NORTH	2	2	1	1	1	1	2	USE IN PLACE ONE WAY & STOP SIGNS
79 S	SOUTH	2	2	1	1	1	1	2	
79 N	NORTH	2	2	1	1	1	1	2	
84 S	SOUTH	2	2	1	1	1	2	2	USE IN PLACE ONE WAY & STOP SIGNS
84 N	NORTH	2	2	1	1	1	2	2	USE IN PLACE ONE WAY & STOP SIGNS
92 S	SOUTH	2	2	1	1	1	1	1	USE IN PLACE ONE WAY & STOP SIGNS
92 N	NORTH	2	2	1	1	1	1	2	USE IN PLACE ONE WAY & STOP SIGNS
99 S	SOUTH	2	2	1	1	1	1	2	USE IN PLACE ONE WAY & STOP SIGNS
99 N	NORTH	2	2	1	1	1	1	2	USE IN PLACE ONE WAY & STOP SIGNS
107 S	SOUTH	2	2	1	1	1	1	2	USE IN PLACE ONE WAY & STOP SIGNS
107 N	NORTH	2	2	1	1	1	1	2	USE IN PLACE ONE WAY & STOP SIGNS
REST AREA	SOUTH	2	2	1	1	1	3		
110 S	SOUTH	2	2	1	1	1	1	2	USE IN PLACE ONE WAY & STOP SIGNS
110 N	NORTH	2	2	1	1	1	1	2	USE IN PLACE ONE WAY & STOP SIGNS
116 S	SOUTH	2	2	1	1	1	2		
116 N	NORTH	2	2	1	1	1	2	1	
WEIGH STATION S	SOUTH	2	2	1	1	1			
WEIGH STATION N	NORTH	2	2	1	1	1			
TOTAL		62.0	62.0	31.0	31.0	31.0	35.0	48.0	
PAY TOTAL		62.0	62.0	31.0	31.0	31.0	35.0	48.0	

"THIS MEDIA SHOULD NOT BE CONSIDERED A CERTIFIED DOCUMENT."

DATE PREPARED
3/6/2019

ROUTE
1-29

STATE
MO

DISTRICT
NW

SHEET NO.
2

COUNTY
AND/BUCH/HOLT/ATCH

JOB NO.
J113238

CONTRACT ID.

PROJECT NO.

BRIDGE NO.

DESCRIPTION									
DATE									

MISSOURI HIGHWAYS AND TRANSPORTATION COMMISSION

MoDOT

105 WEST CAPITOL
JEFFERSON CITY, MO 65102
1-888-ASK-MODOT (1-888-275-6636)

IF A SEAL IS PRESENT ON THIS SHEET IT HAS BEEN ELECTRONICALLY SEALED AND DATED.

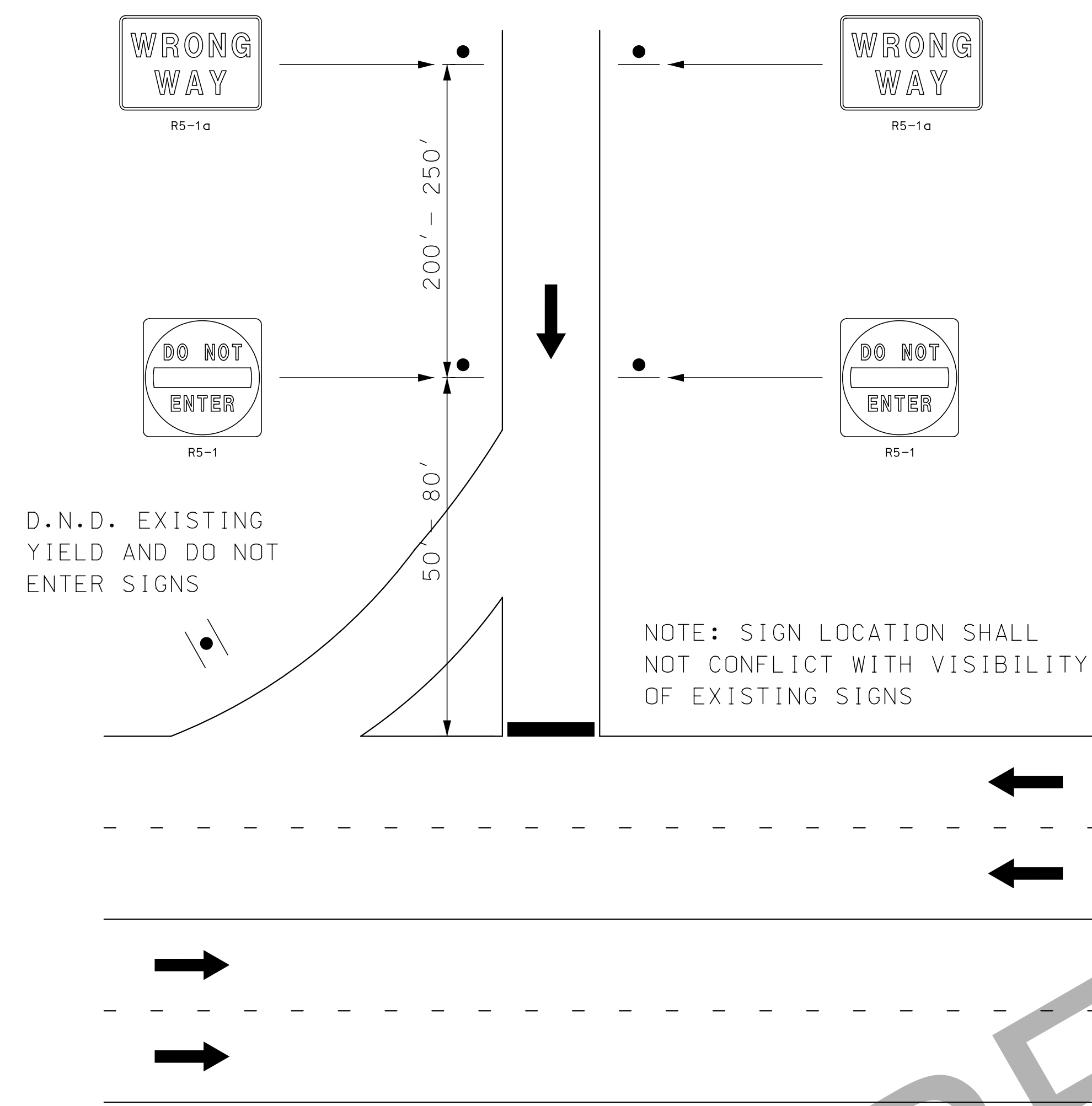

NOTE: SIGN LOCATION SHALL
NOT CONFLICT WITH VISIBILITY
OF EXISTING SIGNS

NOTE: REMOVE EXISTING WRONG WAY AND
DO NOT ENTER SIGNS AS DIRECTED BY THE
ENGINEER. DO NOT REMOVE THE
DO NOT ENTER SIGNS FROM YIELD SIGNS.

SIGNING
DETAIL A

NOT TO SCALE

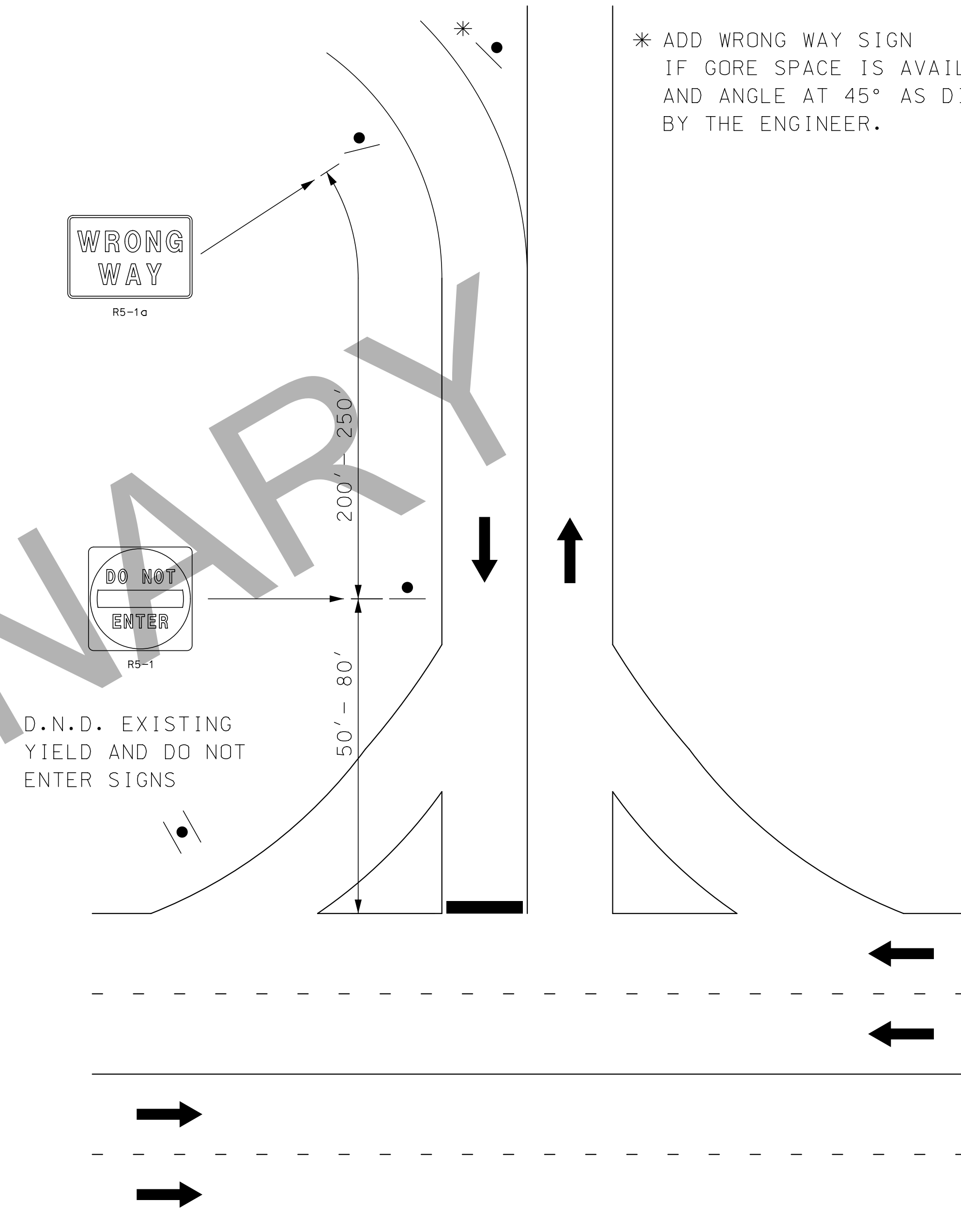

* ADD WRONG WAY SIGN
IF GORE SPACE IS AVAILABLE
AND ANGLE AT 45° AS DIRECTED
BY THE ENGINEER.

NOTE: SIGN LOCATION SHALL
NOT CONFLICT WITH VISIBILITY
OF EXISTING SIGNS

NOTE: REMOVE EXISTING WRONG WAY AND
DO NOT ENTER SIGNS AS DIRECTED BY THE
ENGINEER. DO NOT REMOVE THE
DO NOT ENTER SIGNS FROM YIELD SIGNS.

SIGNING
DETAIL B

NOT TO SCALE

"THIS MEDIA SHOULD
NOT BE CONSIDERED
A CERTIFIED
DOCUMENT."

DATE PREPARED

3/6/2019

ROUTE	STATE
-------	-------

I-29	MO
------	----

DISTRICT	SHEET NO.
----------	-----------

NW	3
----	---

COUNTY

BUCH/AND/HOLT/A

JOB NO.

J1 I3238

CONTRACT ID.

PROJECT NO.

PROJECT NO.

BRIDGE NO.

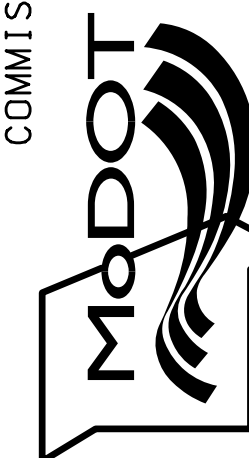
[illegible]MISSOURI HIGHWAYS AND TRANSPORTATION
COMMISSION

105 WEST CAPITOL
JEFFERSON CITY, MO 65102

[illegible]

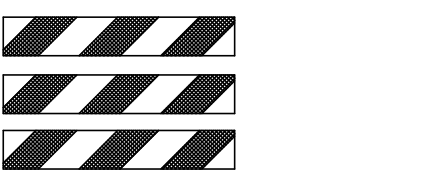
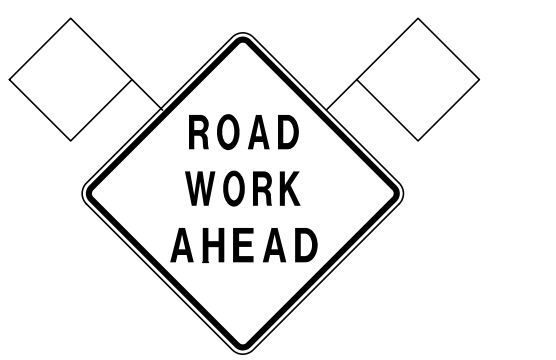

48"x48"



48"x48"

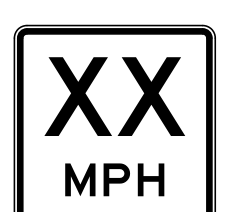

30"x30"

TRAFFIC CONTROL LEGEND

- SIGN (SINGLE SIDED)
- CHANNELIZER (TRIM-LINE)
- WORK AREA

SPEED	SIGN SPACING (ft.)		TAPER LENGTH (ft.)		OPTIONAL	CHANNELIZER SPACING (ft.)	
PERM. POSTED (MPH)	UN-DIVIDED (S)	DIVIDED (S)	SHOULDER (1) (T1)	LANE (2) (T2)	BUFFER LENGTH (ft) (B)	TAPERS	BUFFER/WORK AREAS
0-35	-	200	70	245	280	35	40
40-45	-	500	150	540	400	40	80
50-55	-	1000	185	660	560	50	80
60-70	-	SA-1000 SB-1500 SC-2640	235	840	840	60	120

1. Shoulder taper length based on 10 ft. (standard shoulder width) offset.
2. Lane taper length based on 12 ft. (standard lane width) offset.

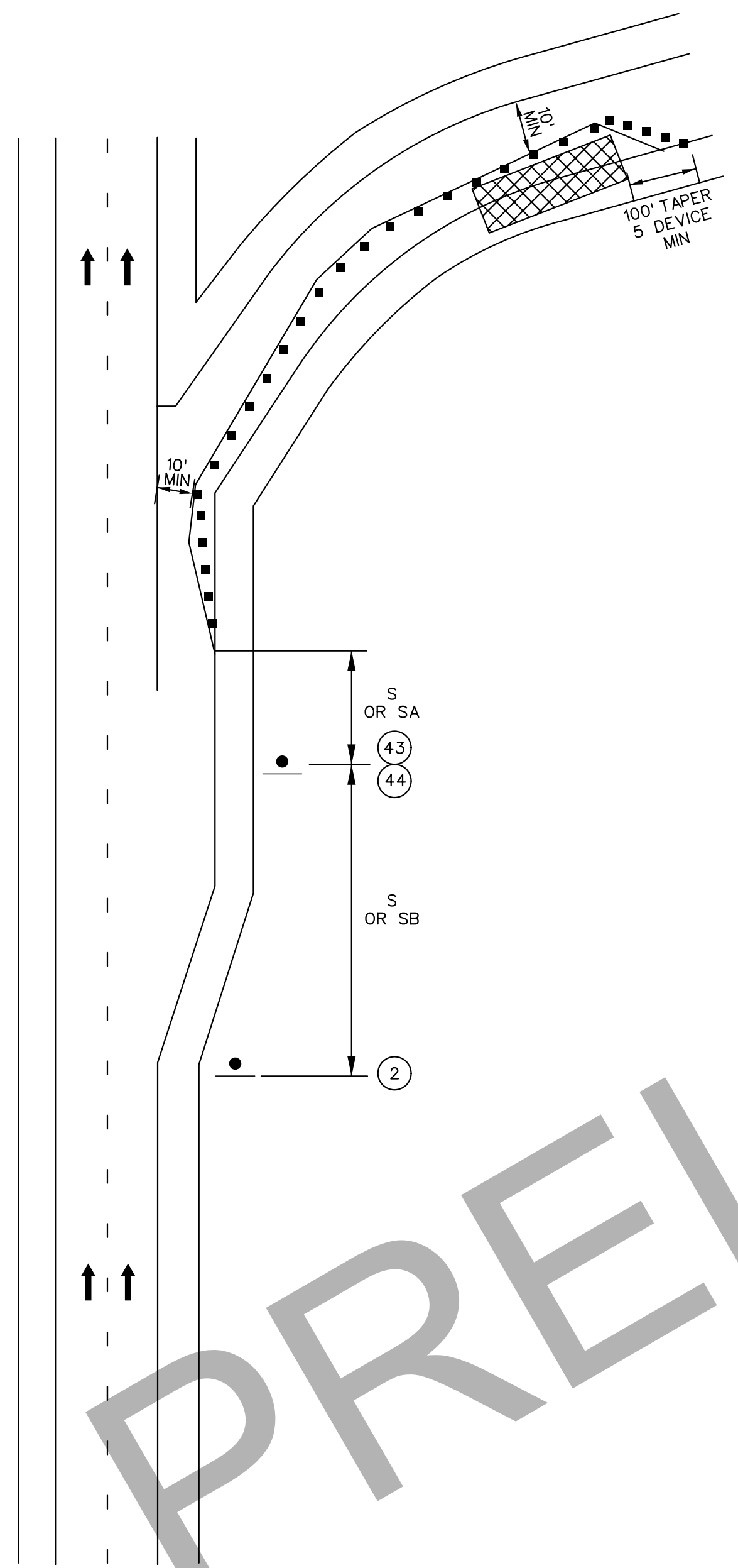

PARTIAL EXIT RAMP CLOSURE

NOT TO SCALE

TRAFFIC CONTROL

SPEED NORMAL POSTED (MPH)	SIGN SPACING (FT.)	
	UNDIVIDED (S)	DIVIDED (S)
0-35	200	200
40-45	350	500
50-55	500	1000
60-70	1000	1000

TYPE OF ROADWAY	SIGN HEIGHT	MAXIMUM WORK ZONE LENGTH (L)
URBAN	1' PORTATBLE 7' POST	1 MILE
RURAL DIVIDED	1' PORTABLE 7' POST	2 MILE
RURAL UNDIVIDED	1' PORTABLE 7' POST	3 MILE

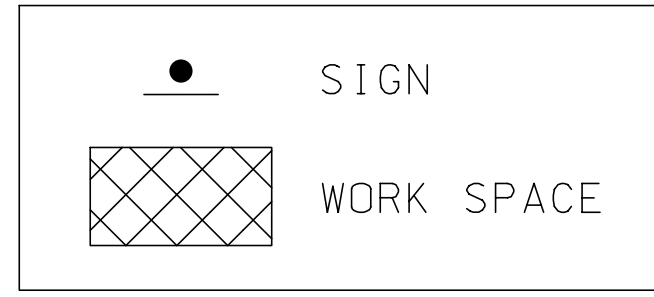

ON MULTI-LANE, DIVIDED HIGHWAYS, SIGNS ADVISING OF SHOULDER WORK OR THE CONDITION OF THE SHOULDER SHOULD BE PLACED ONLY ON THE SIDE OF THE AFFECTED SHOULDER.

THE SHOULDER WORK AHEAD SIGN MAY BE OMITTED WHERE THE WORK SPACE IS 15 FT. OR MORE FROM THE EDGE OF ANY SHOULDER, BEYOND THE DITCH LINE, OR BEHIND THE CURB. SHOULD THE ROADWAY NOT HAVE A SHOULDER, THEN 15 FT. OR MORE FROM THE EDGE OF THE ROADWAY.

FOR SHORT DURATION OR MOBILE OPERATIONS, SIGNS MAY BE REDUCED OR ELIMINATED IF A WORK VEHICLE WITH ACTIVATED ROTATING LIGHTS OR STROBE LIGHTS IS USED.

VEHICLE HAZARD WARNING SIGNALS SHALL NOT BE USED INSTEAD OF THE VEHICLE S ROTATING LIGHTS OR STROBE LIGHTS. OTHER APPROPRIATE SIGNS MAY BE USED IN LIEU OF THE SHOULDER WORK AHEAD SIGN.

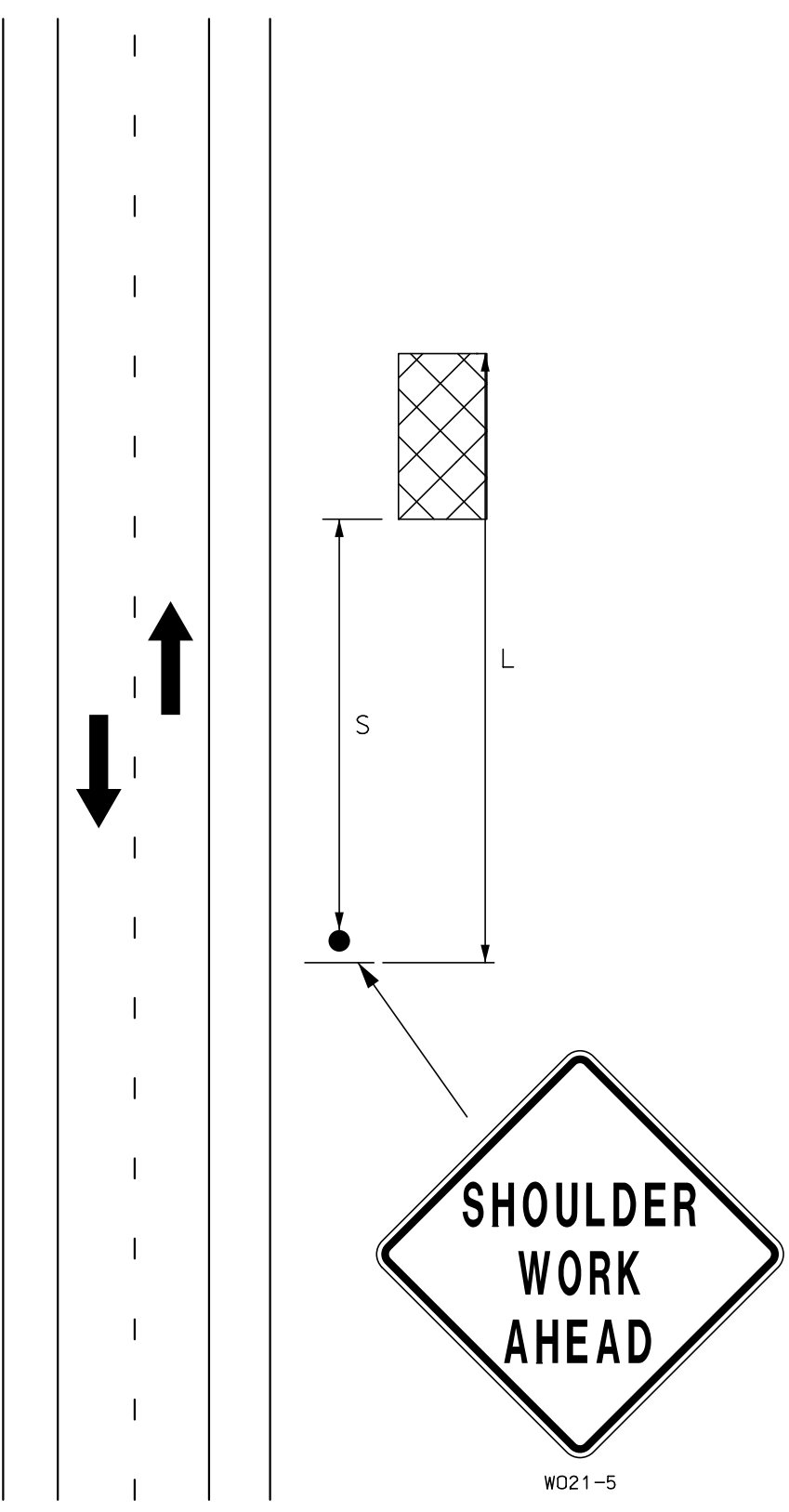

SHOULDER WORK AHEAD

NOT TO SCALE

TRAFFIC CONTROL

"THIS MEDIA SHOULD NOT BE CONSIDERED A CERTIFIED DOCUMENT."

DATE PREPARED
3/6/2019

ROUTE
I-29
STATE
MO
DISTRICT
NW
SHEET NO.
4

COUNTY
BUCH/AND/HOLT/AT

JOB NO.
J113238
CONTRACT ID.

PROJECT NO.

BRIDGE NO.

DESCRIPTION	DATE

MISSOURI HIGHWAYS AND TRANSPORTATION COMMISSION

MoDOT

105 WEST CAPITOL
JEFFERSON CITY, MO 65102
1-888-ASK-MODOT (1-888-275-6636)