

MISSOURI HIGHWAYS AND TRANSPORTATION COMMISSION

PLANS FOR PROPOSED STATE HIGHWAY

INDEX OF SHEETS

DESCRIPTION	SHEET NUMBER
TITLE SHEET -----	1
PLAN SHEETS (PP) -----	2-3
TRAFFIC CONTROL SHEETS (TC)-----	4-5

"THIS MEDIA SHOULD NOT BE CONSIDERED A CERTIFIED DOCUMENT."

DATE PREPARED
2/28/2019

ROUTE	STATE
VAR.	MO
DISTRICT	SHEET NO.
NE/CD	1

COUNTY
VARIOUS

JOB NO.
J213225/J513303

CONTRACT ID.

PROJECT NO.

BRIDGE NO.

DATE	DESCRIPTION

MISSOURI HIGHWAYS AND TRANSPORTATION COMMISSION

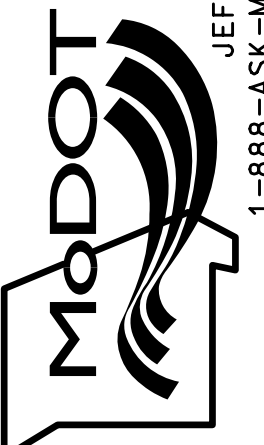

105 WEST CAPITOL
JEFFERSON CITY, MO 65102
1-888-ASK-MODOT (1-888-278-6636)

IF A SEAL IS PRESENT ON THIS SHEET IT HAS BEEN ELECTRONICALLY SEALED AND DATED.

J513303 - WRONG WAY SIGNING AT RAMPS COOPER, BOONE & CALLAWAY COUNTIES

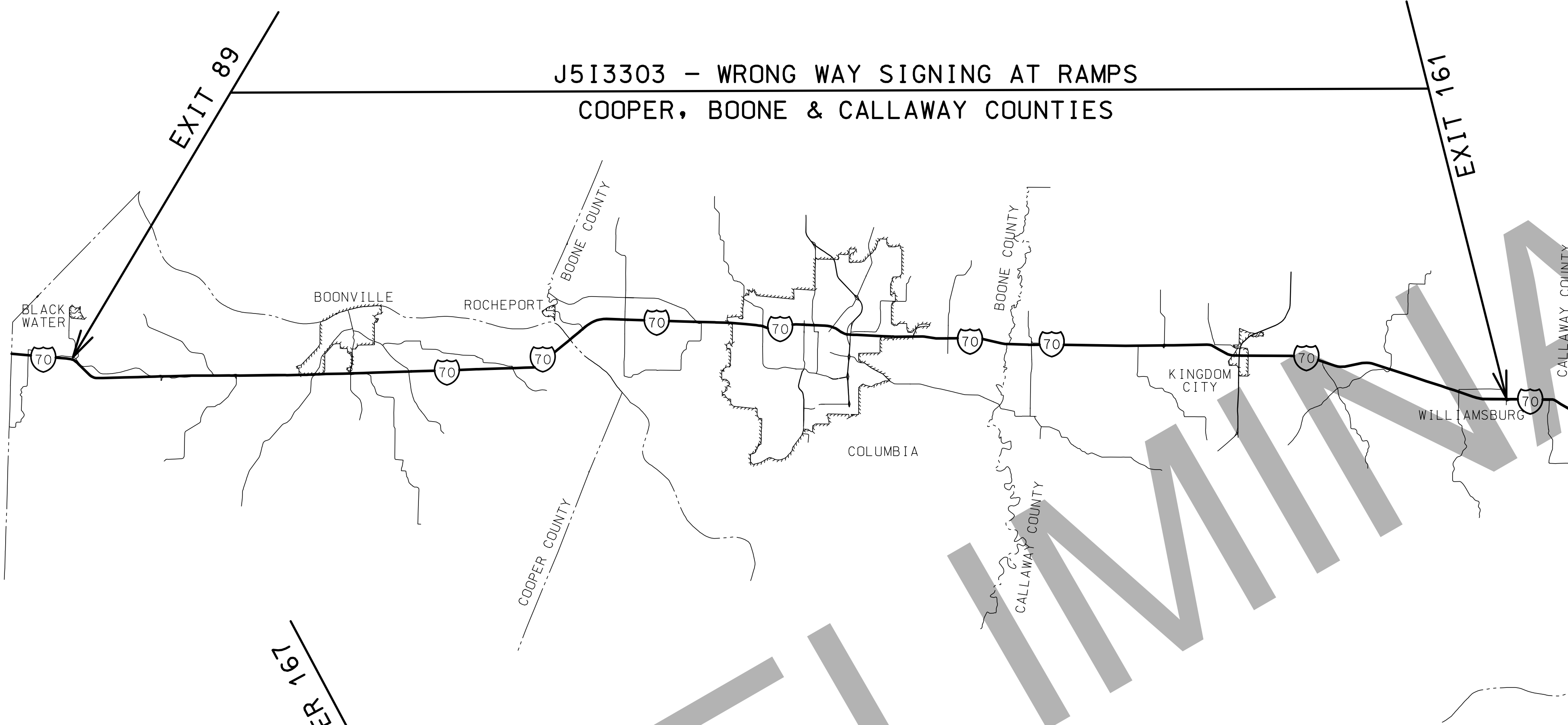

J213225 - WRONG WAY SIGNING AT RAMPS MONTGOMERY & WARREN COUNTIES

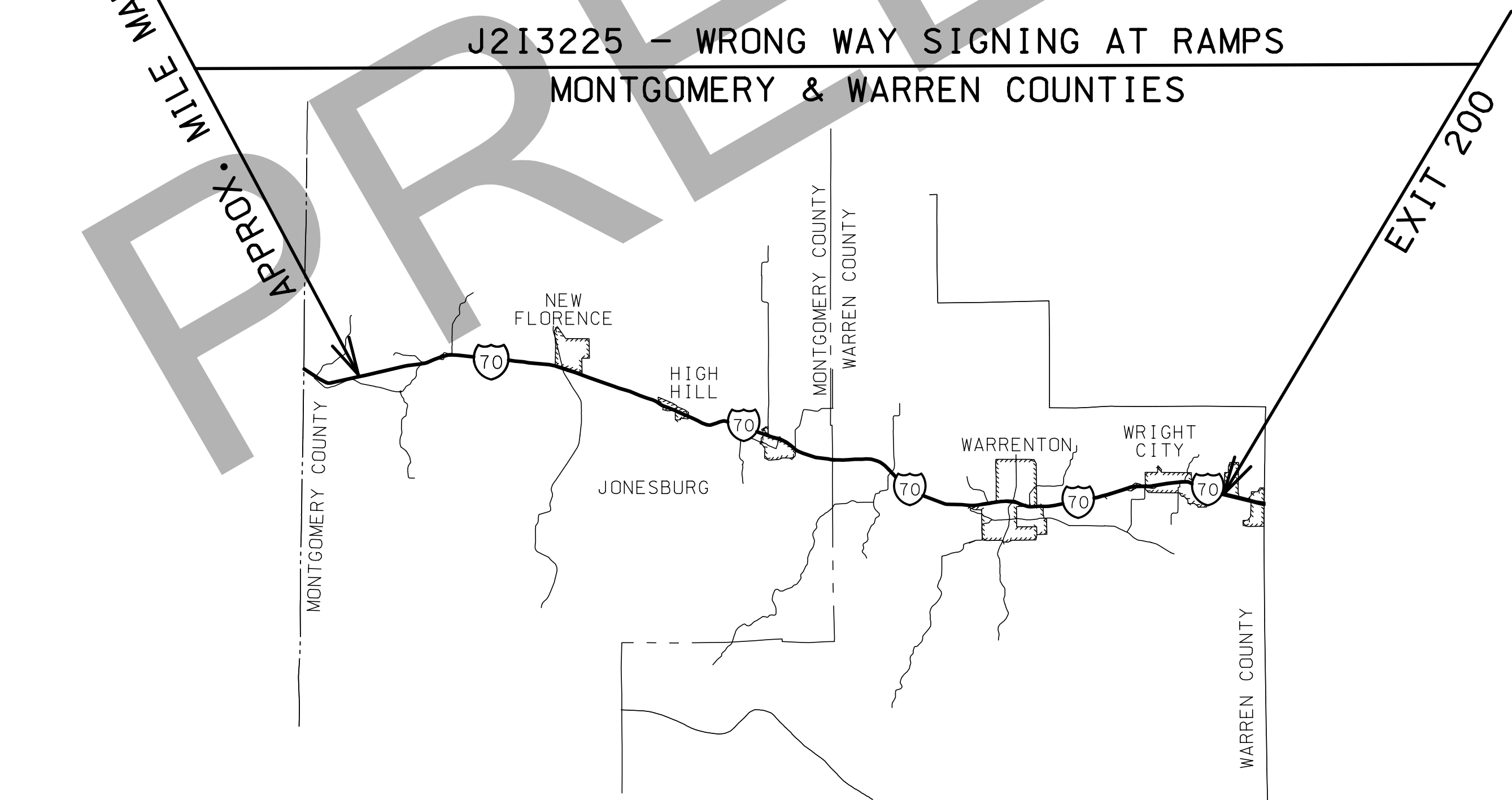

LENGTH OF PROJECT

J513303	
BEGINNING OF PROJECT	EXIT 89
END OF PROJECT	EXIT 161
APPARENT LENGTH	72 MILES
EQUATIONS AND EXCEPTIONS:	NONE
TOTAL CORRECTIONS	NONE
NET LENGTH OF PROJECT	72 MILES
STATE LENGTH	72 MILES
J213225	
BEGINNING OF PROJECT	MM 167
END OF PROJECT	EXIT 200
APPARENT LENGTH	33 MILES
EQUATIONS AND EXCEPTIONS:	NONE
TOTAL CORRECTIONS	NONE
NET LENGTH OF PROJECT	33 MILES
STATE LENGTH	33 MILES

APPROX. MILE MARKER 167

EXIT 200

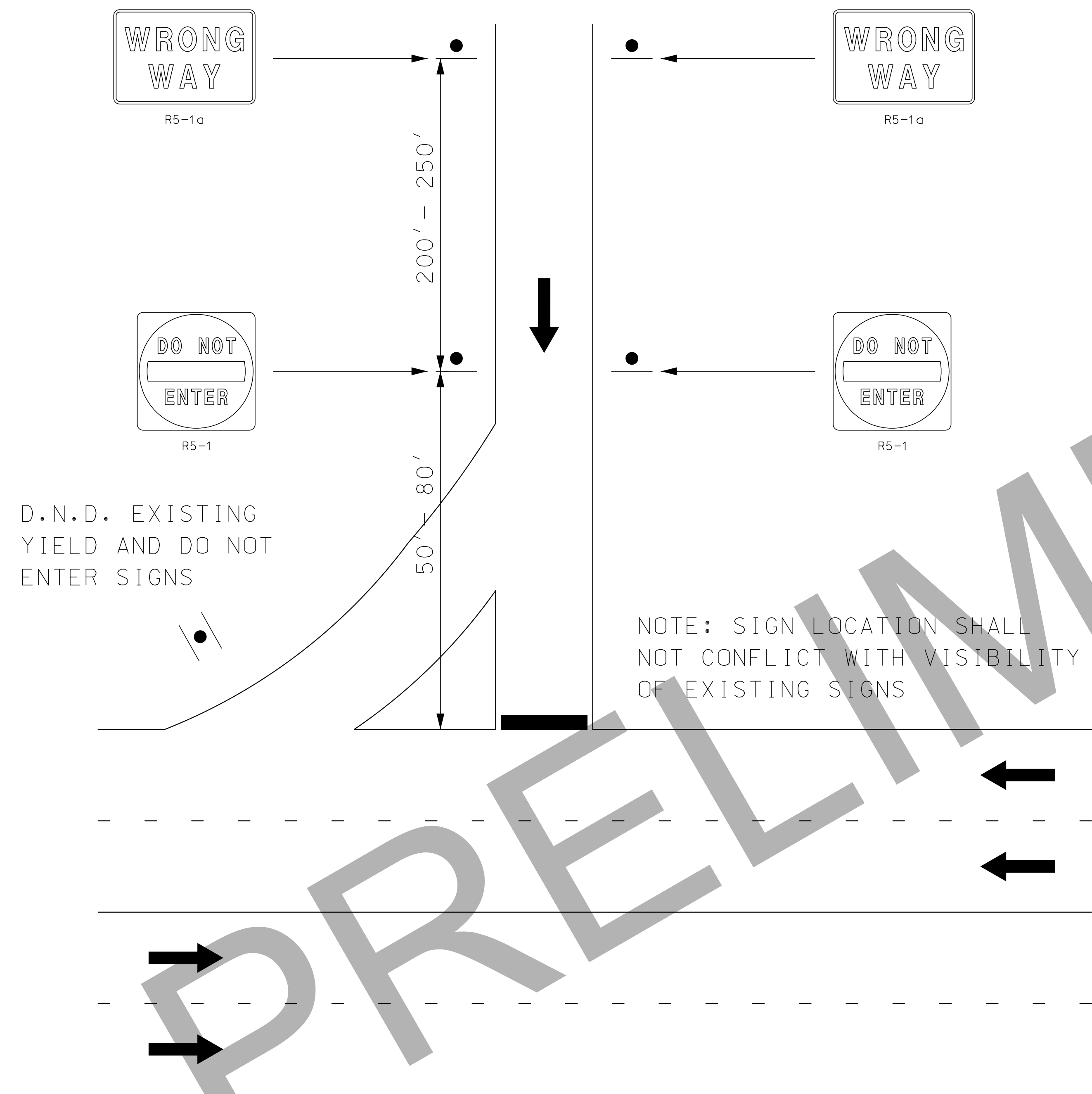

NOTE: REMOVE EXISTING WRONG WAY AND DO NOT ENTER SIGNS AS DIRECTED BY THE ENGINEER. DO NOT REMOVE THE DO NOT ENTER SIGNS FROM YIELD SIGNS.

(1) NOTE: FIELD CONDITIONS AT SOME LOCATIONS MAY VARY FROM WHAT IS SHOWN IN THE TYPICAL SIGNING LAYOUT. AT THESE LOCATIONS, THE CONTRACTOR SHALL WORK WITH THE ENGINEER TO DETERMINE THE SIGN INSTALLATION LOCATIONS.

LOCATIONS THAT VARY FROM THE TYPICAL SIGNING LAYOUT INCLUDE, BUT ARE NOT LIMITED TO DIVERGING DIAMOND INTERCHANGES, ROUNDABOUT RAMP TERMINALS AND REST AREAS/TRUCK PARKING.

TYPICAL SIGNING LAYOUT (1)

NOT TO SCALE

"THIS MEDIA SHOULD NOT BE CONSIDERED A CERTIFIED DOCUMENT."

DATE PREPARED
2/27/2019

ROUTE
VAR. MO
DISTRICT SHEET NO.
NE/CD 2

COUNTY
VARIOUS

JOB NO.
J213225/J513303

CONTRACT ID.

PROJECT NO.

BRIDGE NO.

DATE	DESCRIPTION

MISSOURI HIGHWAYS AND TRANSPORTATION COMMISSION

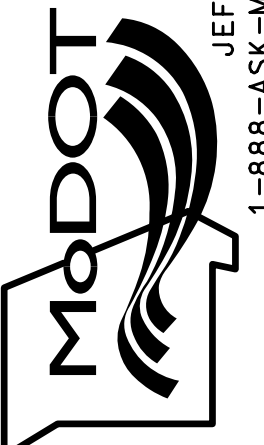

105 WEST CAPITOL
JEFFERSON CITY, MO 65102
1-888-ASK-MODOT (1-888-275-6636)

IF A SEAL IS PRESENT ON THIS SHEET IT HAS BEEN ELECTRONICALLY SEALED AND DATED.

"THIS MEDIA SHOULD NOT BE CONSIDERED A CERTIFIED DOCUMENT."

DATE PREPARED
2/27/2019

ROUTE STATE
VAR. MO

DISTRICT SHEET NO.
NE/CD 3

COUNTY
VARIOUS

JOB NO.
J213225/J513303

CONTRACT ID.

PROJECT NO.

BRIDGE NO.

DATE	DESCRIPTION

MISSOURI HIGHWAYS AND TRANSPORTATION COMMISSION
MoDOT
 105 WEST CAPITOL JEFFERSON CITY, MO 65102
 1-888-ASK-MODOT (1-888-275-6636)

IF A SEAL IS PRESENT ON THIS SHEET IT HAS BEEN ELECTRONICALLY SEALED AND DATED.

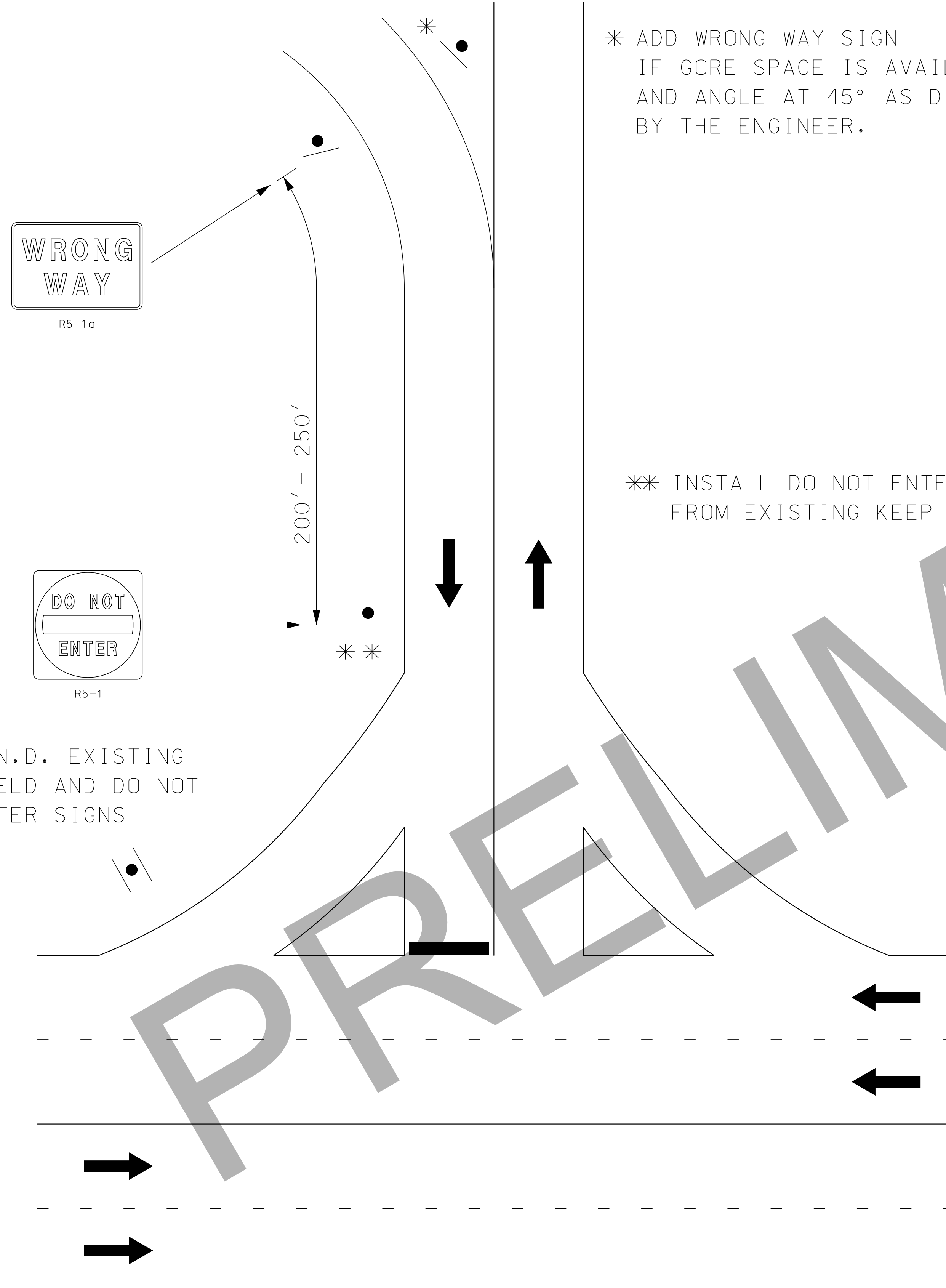

* ADD WRONG WAY SIGN IF GORE SPACE IS AVAILABLE AND ANGLE AT 45° AS DIRECTED BY THE ENGINEER.

** INSTALL DO NOT ENTER ACROSS FROM EXISTING KEEP RIGHT SIGN.

NOTE: SIGN LOCATION SHALL NOT CONFLICT WITH VISIBILITY OF EXISTING SIGNS

NOTE: REMOVE EXISTING WRONG WAY AND DO NOT ENTER SIGNS AS DIRECTED BY THE ENGINEER. DO NOT REMOVE THE DO NOT ENTER SIGNS FROM YIELD SIGNS.

(1) NOTE: FIELD CONDITIONS AT SOME LOCATIONS MAY VARY FROM WHAT IS SHOWN IN THE TYPICAL SIGNING LAYOUT. AT THESE LOCATIONS, THE CONTRACTOR SHALL WORK WITH THE ENGINEER TO DETERMINE THE SIGN INSTALLATION LOCATIONS.

LOCATIONS THAT VARY FROM THE TYPICAL SIGNING LAYOUT INCLUDE, BUT ARE NOT LIMITED TO DIVERGING DIAMOND INTERCHANGES, ROUNDABOUT RAMP TERMINALS AND REST AREAS/TRUCK PARKING.

TYPICAL SIGNING LAYOUT (1)

FOLDED DIAMOND INTERCHANGES

NOT TO SCALE

"THIS MEDIA SHOULD NOT BE CONSIDERED A CERTIFIED DOCUMENT."

DATE PREPARED
2/27/2019

ROUTE
VAR. MO

DISTRICT SHEET NO.
NE/CD 4

COUNTY
VARIOUS

JOB NO.
J213225/J513303

CONTRACT ID.

PROJECT NO.

BRIDGE NO.

DATE	DESCRIPTION

DATE

MISSOURI HIGHWAYS AND TRANSPORTATION COMMISSION
105 WEST CAPITOL JEFFERSON CITY, MO 65102
1-888-ASK-MODOT (1-888-278-6636)

IF A SEAL IS PRESENT ON THIS SHEET IT HAS BEEN ELECTRONICALLY SEALED AND DATED.

ROAD WORK AHEAD
48" x 48"
W020-1

BRIDGE OR RAMP
48" x 48"

②

RAMP NARROWS
48" x 48"
W05-1

④③

XX MPH
30" x 30"
W013-1

④④

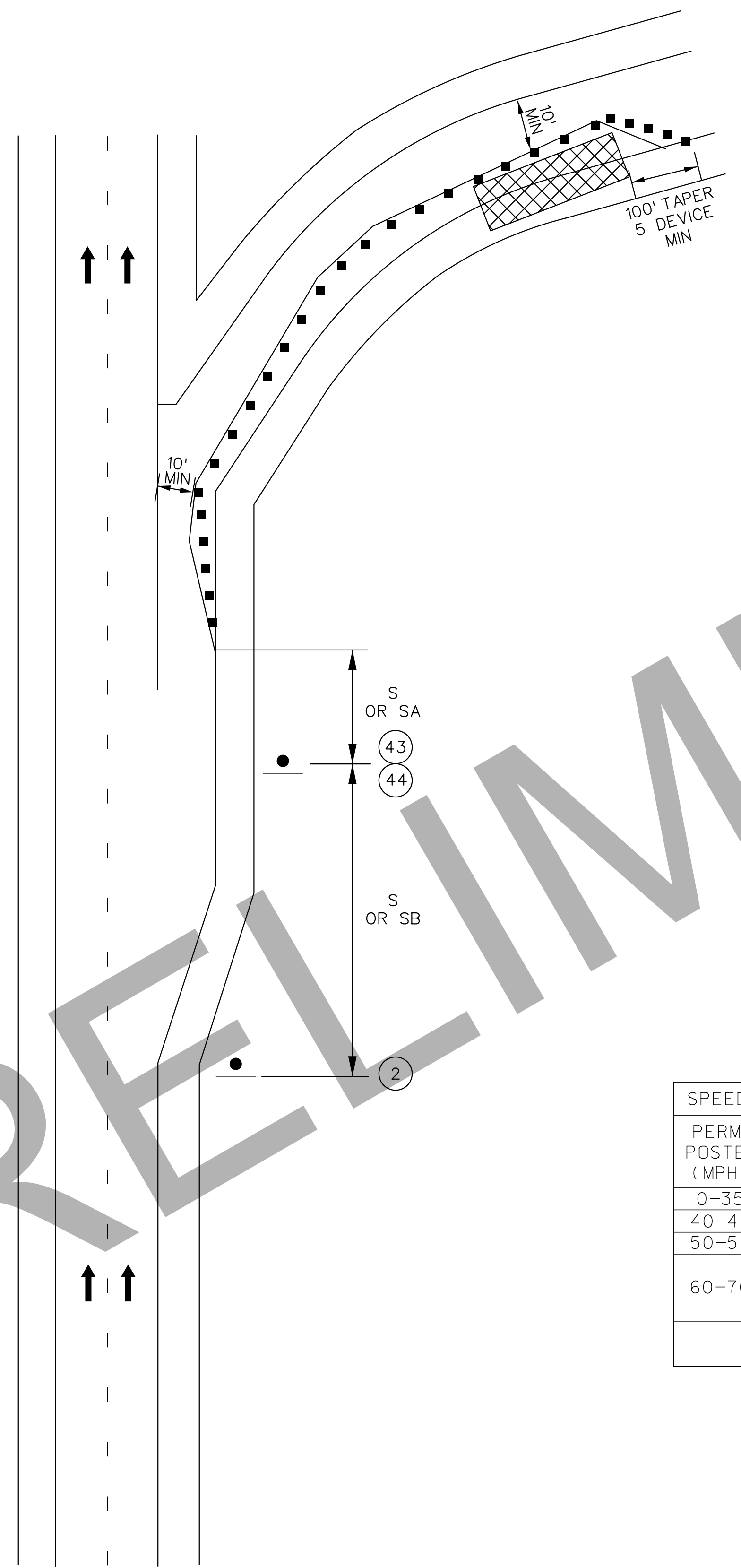

TRAFFIC CONTROL LEGEND

- SIGN (SINGLE SIDED)
- CHANNELIZER (TRIM-LINE)
- WORK AREA

SPEED	SIGN SPACING (ft.)		TAPER LENGTH (ft.)		OPTIONAL BUFFER LENGTH (ft.) (B)	CHANNELIZER SPACING (ft.)	
	UN-DIVIDED (S)	DIVIDED (S)	SHOULDER (1) (T1)	LANE (2) (T2)		TAPERS	BUFFER/WORK AREAS
0-35	-	200	70	245	280	35	40
40-45	-	500	150	540	400	40	80
50-55	-	1000	185	660	560	50	80
60-70	-	SA-1000 SB-1500 SC-2640	235	840	840	60	120

1 Shoulder taper length based on 10 ft. (standard shoulder width) offset.
2. Lane taper length based on 12 ft. (standard lane width) offset.

PARTIAL RAMP CLOSURE

TRAFFIC CONTROL SHEET 1 OF 2

NOT TO SCALE

PRELIMINARY

"THIS MEDIA SHOULD NOT BE CONSIDERED A CERTIFIED DOCUMENT."

DATE PREPARED

2/27/2019

ROUTE STATE

VAR. MO

DISTRICT SHEET NO.

NE/CD 5

COUNTY

VARIOUS

JOB NO.

J213225/J513303

CONTRACT ID.

PROJECT NO.

BRIDGE NO.

DESCRIPTION

ON MULTI-LANE, DIVIDED HIGHWAYS, SIGNS ADVISING OF SHOULDER WORK OR THE CONDITION OF THE SHOULDER SHOULD BE PLACED ONLY ON THE SIDE OF THE AFFECTED SHOULDER.

THE SHOULDER WORK AHEAD SIGN MAY BE OMITTED WHERE THE WORK SPACE IS 15 FT. OR MORE FROM THE EDGE OF ANY SHOULDER, BEYOND THE DITCH LINE, OR BEHIND THE CURB. SHOULD THE ROADWAY NOT HAVE A SHOULDER, THEN 15 FT. OR MORE FROM THE EDGE OF THE ROADWAY.

FOR SHORT DURATION OR MOBILE OPERATIONS, SIGNS MAY BE REDUCED OR ELIMINATED IF A WORK VEHICLE WITH ACTIVATED ROTATING LIGHTS OR STROBE LIGHTS IS USED.

VEHICLE HAZARD WARNING SIGNALS SHALL NOT BE USED INSTEAD OF THE VEHICLE'S ROTATING LIGHTS OR STROBE LIGHTS. OTHER APPROPRIATE SIGNS MAY BE USED IN LIEU OF THE SHOULDER WORK AHEAD SIGN.

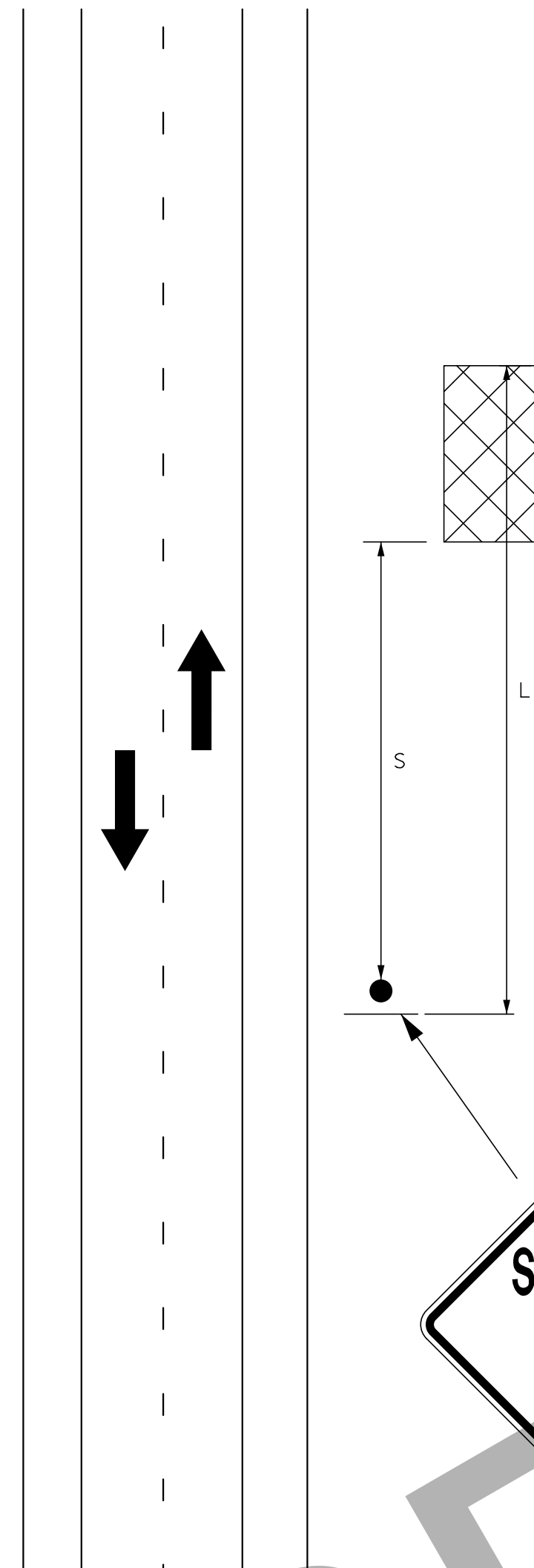

WD21-5

SHOULDER WORK AHEAD

SPEED NORMAL POSTED (MPH)	SIGN SPACING (FT.)		TAPER LENGTH (FT.)		OPTIONAL BUFFER LENGTH (FT.) (B)	CHANNELIZER SPACING (FT.)	
	UNDIVIDED (S)	DIVIDED (S)	SHOULDER1 (T1)	LANE2 (T2)		TAPERS	BUFFER/ WORK AREAS
0-35	200	200	-	-	-	-	-
40-45	350	500	-	-	-	-	-
50-55	500	1000	-	-	-	-	-
60-70	1000	1000	-	-	-	-	-

TYPE OF ROADWAY	SIGN HEIGHT	MAXIMUM WORK ZONE LENGTH (L)
URBAN	1' PORTATBLE 7' POST	1 MILE
RURAL DIVIDED	1' PORTABLE 7' POST	2 MILE
RURAL UNDIVIDED	1' PORTABLE 7' POST	3 MILE

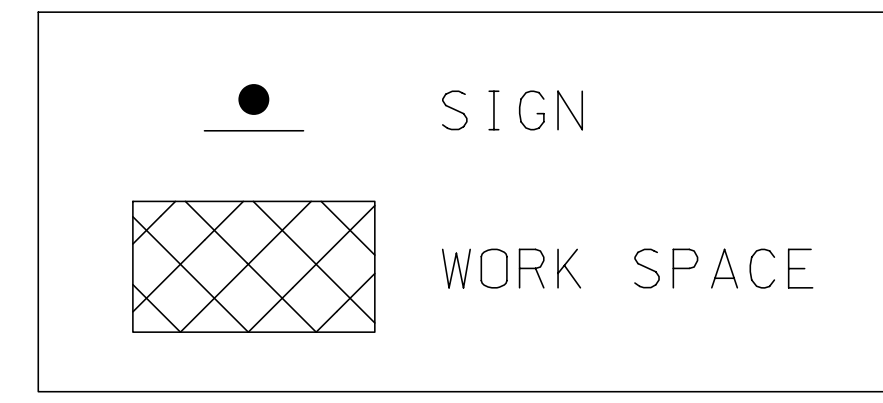

NOT TO SCALE

TRAFFIC CONTROL
SHEET 2 OF 2

IF A SEAL IS PRESENT ON THIS SHEET IT HAS BEEN ELECTRONICALLY SEALED AND DATED.

PRELIMINARY

MISSOURI HIGHWAYS AND TRANSPORTATION
COMMISSION
MoDOT
105 WEST CAPITOL
JEFFERSON CITY, MO 65102
1-888-ASK-MODOT (1-888-275-6636)