

ADDENDUM NO. 3

I. PROJECT INFORMATION

PROJECT: Rock Island Rail Corridor Shared Use Path
OWNER: Jackson County, MO
FEDERAL PROJECT NUMBER: STP-3453(402)
COUNTY PROJECT NUMBER: 3221 – BID NO. 09-2018
DESIGN CONSULTANT: TranSystems
DATE OF ADDENDUM: January 25, 2019

2. NOTICE TO BIDDERS

This Addendum is issued to all registered plan holders pursuant to the Instructions to Bidders and Conditions of the Contract. This Addendum serves to clarify, revise, and supersede information in the Bidding and Contract Documents (Bid Documents), Drawings, and any previously issued Addenda. Portions of the Addendum affecting the Contract Documents will be incorporated into the Contract by enumeration of the Addendum in the Owner/Contractor Agreement.

3. REVISIONS TO BIDDING DOCUMENTS, CONTRACT DOCUMENTS AND SPECIFICATIONS

- A. BID AUTHORIZATION MoDOT authorization for the County to advertise for bids is included in this addendum for reference only.
- B. ACCESS RIGHTS County authorization certifying that all necessary right-of-way, easements, and access rights for that portion of the subject project lying within Jackson County, Missouri is included in this addendum for reference only.
- C. UTILITIES Letter of Certification for utility “status” is included in this addendum for reference only.
- D. ATTENDANCE LIST FOR 2ND PRE-BID MEETING is included in this addendum for reference only.
- E. REVISIONS TO BID FORM
 - I. There have been changes made to the following quantities. Contractor to use the revised Bid Form noted as Addendum No. 3.
 - a. Base Bid Item No. 7 Embankment in Place (Contractor Furnished) quantity changed to 13,510. This change was due to a minor correction in earthwork quantities.
 - b. Base Bid Item No. 11 Lightweight Fill quantity changed to 956. This was due to a quantity take-off error in the plans. Note the design and typical section does not change.
 - c. Base Bid Item No. 41 Rock Blanket (Type I) quantity did not change, but unit was changed to CUYD.
 - d. Base Bid Item No. 43 Mulch Filter Berm quantity changed to 35,018. This change was due to mulch berm lengths not originally quantified on sheet 142 near Sta. 435+00.

Jackson County Missouri - Department of Public Works - Engineering Division
ROCK ISLAND RAIL CORRIDOR SHARED USE PATH
FEDERAL PROJECT NO. STP-3453(402) - COUNTY PROJECT NO. 3221 - BID NO. 09-2018

- e. Base Bid Item No. 48 Sediment Removal quantity changed to 409 to account for rounding.
- f. Base Bid Item No. 49 Erosion Control Blanket quantity changed to 2,591. This change was due to erosion control blanket not originally quantified on sheet 142 near Sta. 432+00.
- g. Base Bid Item No. 66 Structural Steel Pile. The Item description has changed from HPI8x119 to W18x119. This matches the plans with no changes made to the design concept.
- h. Base Bid Item No. 93 24 in. White Preformed Thermoplastic Pavement Marking quantity changed to 490. See REVISIONS TO PLANS item a.
- i. Base Bid Item No. 106 Safety Sign (72") quantity changed to 29. See REVISIONS TO PLANS item c.
- j. Alternate Bid Item No. A6 Embankment in Place (Contractor Furnished) quantity changed to 16,251. This change was due to a minor correction in earthwork quantities.
- k. Alternate Bid Item No. A9 Lightweight Fill quantity changed to 231. This was due to a quantity take-off error in the plans. Note the design and typical section does not change.
- l. Alternate Bid Item No. A23 Rock Blanket (Type I) quantity did not change, but unit was unit changed to CUYD.

F. REVISIONS TO JOB SPECIAL PROVISIONS

- 1. Amend Technical Specification 35, Section A.1, by including LMC Industrial Contractors Inc. (<https://www.lmcic.com/>) as approved equal for pedestrian bridges.
- 2. Amend Technical Specification 39, Section B, to add, "No measurement or payment for Class 3 Excavation."
- 3. Amend the heading of Technical Specification 49 to read "Limestone Slabs."
- 4. Amend Special Provision 39, to add "The County will cut down the identified Bat Trees located within the project area prior to March 31, 2019. The Contractor will need to remove all of the down trees as SUBSIDIARY to unit bid item Clearing and Grubbing."

G. REVISIONS TO FEDERAL WAGE RATES

- 1. Contractor to use revised Federal Wage Rates, publication date January 4, 2019 noted as Addendum No. 3.

H. REVISIONS TO PLANS

- a. Amend plan sheet 91 by removing "w/RRFB" from sign callout at sta. 453+40.00, 50' Left. There will be only 2 sign assemblies with RRFB at this intersection. Also, add 90 LF of 24 in. white preformed thermoplastic pavement marking at the road crossing. For more clarification, following are the locations of RRFBs throughout the project corridor:

Jackson County Missouri - Department of Public Works - Engineering Division
ROCK ISLAND RAIL CORRIDOR SHARED USE PATH
FEDERAL PROJECT NO. STP-3453(402) - COUNTY PROJECT NO. 3221 - BID NO. 09-2018

Base Bid	
Page no.	RRFB
89	1
90	2
91	2
92	2
94	2
Sub-Total	9

Add Alternate A	
page no.	RRFB
89	1
130	4
Sub-Total	5

Total	14
--------------	-----------

- b. Amend plan sheet 94 by adding RRFB to the sign assemblies (W11-15 and W16-7P) at approx. sta. 784+30 and 784+70.
- c. Amend plan sheets 112 through 125 and 128 by omitting all Safety Signs (72") between Sta. 784+65.77 to sta. 1126+04.44.
- d. Amend Plan Sheet 181 by including LMC Industrial Contractors Inc. (<https://www.lmcic.com/>) as approved equal.
- e. See attached sheets 4, 8, 9, 10, 12, 13, 15, 130, 131 and 132.

I. RESPONSES TO SUBMITTED QUESTIONS:

- a. What are the surface requirements for the limestone slabs? *The clarification is found directly in the technical specification for Limestone Slabs, "Material for this item shall be a slab of natural limestone, to the dimensions shown in the plans, and shall be relatively smooth, without sharp edges or any depression over 4" in width that will hold more than 1/4" of standing water after placement."*
- b. What pile size is item 63 (12-inch pile)? *Per bridge sheet 181, the 12-inch pile is an HPI2x53.*
- c. Regarding Bid Items No. 58 and A35 Graffiti Protection: Is this work only on the MSE retaining walls and soldier pile walls? *Graffiti protection is required on all MSE retaining walls. NOTE that the pay quantity is based on retained face; however, the entire exposed face must be protected. See the sample wall quantities as a reference.*
- d. Will the steel piles at the soldier pile walls require field painting? *Yes, the steel piles on the soldier pile walls must be field painted in accordance with the plans and specifications. NO graffiti protection will be placed on the soldier pile walls.*
- e. Regarding TS-30 Concrete Masonry Sealer and Graffiti Protection: Does this technical spec apply to the Bid Items No. 58 and A35? *Yes.*

Jackson County Missouri - Department of Public Works - Engineering Division
ROCK ISLAND RAIL CORRIDOR SHARED USE PATH
FEDERAL PROJECT NO. STP-3453(402) - COUNTY PROJECT NO. 3221 - BID NO. 09-2018

- f. Regarding TS-30 Concrete Masonry Sealer and Graffiti Protection: Is the intent to apply 2 different coatings? *This bid item is for graffiti protection only. It shall consist of a clear coating that can be removed with a hot water wash. The surface preparation and application shall be in accordance with the manufacturer's recommendations.*
- g. Regarding TS-35, Section I: Is the handrail in addition to the metal rub rail shown on the plans? *Handrails are not included on bridges. Rub rail and toe rails to be self weathering steel.*
- h. Should horizontal safety rails be placed on the inside or outside of the truss? *Safety rails may be placed on either side of the truss, provided that all gaps, horizontal and vertical, are a maximum of 4". Toe rails and rub rails must be on the inside of the truss.*
- i. On page I88 of the plans, no camber is shown on the I20' bridge. Is the bridge to be installed with camber? *No camber allowed.*

THE ORIGINAL BID DOCUMENTS, INCLUDING ANY PREVIOUS ADDENDA, REMAIN IN EFFECT EXCEPT AS REVISED BY THE CHANGES NOTED IN THIS ADDENDUM NO. 3.

Jackson County Missouri - Department of Public Works - Engineering Division
ROCK ISLAND RAIL CORRIDOR SHARED USE PATH
FEDERAL PROJECT NO. STP-3453(402) - COUNTY PROJECT NO. 3221 - BID NO. 09-2018

Item No:	DESCRIPTION	Quantity	Unit	Unit Price	Cost
1	MOBILIZATION	1	LS		
2	UTILITY POTHOLES	12	EACH		
3	ORANGE CONSTRUCTION FENCING (48 IN.)	327	LF		
4	CLEARING AND GRUBBING	29	ACRE		
5	UNCLASSIFIED EXCAVATION	11,611	CUYD		
6	ROCK EXCAVATION (CLASS C EXCAVATION)	614	CUYD		
7	EMBANKMENT IN PLACE (CONTRACTOR FURNISHED)	13,510	CUYD		
8	COMPACTING EMBANKMENT	12,169	CUYD		
9	REMOVE AND REPLACE UNSUITABLE MATERIAL	2,686	CUYD		
10	SHOT ROCK	1,620	CUYD		
11	LIGHTWEIGHT FILL	956	CUYD		
12	REMOVAL OF RAIL AND TIES	25,561	LF		
13	REMOVAL OF BRIDGE RAIL AND TIES	370	LF		
14	REMOVAL OF IMPROVEMENTS (NON-RAIL)	1	LS		
15	SCRAP TIRE DISPOSAL OR RECYCLING	80	CUYD		
16	TYPE 5 AGGREGATE FOR BASE (4 IN.) (PUGGED)	20,273	SQYD		
17	ASPHALT BASE (TYPE 1-01) (8 IN.) (64-22)	2,008	SQYD		
18	ASPHALT SURFACE (TYPE 3-01) (2 IN.) (64-22)	2,008	SQYD		
19	CRUSHED ROCK SURFACING (8 IN.)	21,838	SQYD		
20	CONCRETE PAVEMENT (6 IN. WITH FIBERS)	14,425.7	SQYD		
21	CONCRETE PAVEMENT (8 IN. WITH FIBERS)	316.4	SQYD		
22	CONCRETE CURB AND GUTTER (CG-1)	1,847.0	LF		
23	CONCRETE CURB (C-1)	105.0	LF		
24	CONCRETE SIDEWALK, 4 IN.	220.2	SQYD		
25	CONCRETE SIDEWALK, 4 IN. INTEGRAL RED	15.0	SQYD		

Jackson County Missouri - Department of Public Works - Engineering Division
ROCK ISLAND RAIL CORRIDOR SHARED USE PATH
FEDERAL PROJECT NO. STP-3453(402) - COUNTY PROJECT NO. 3221 - BID NO. 09-2018

Item No:	DESCRIPTION	Quantity	Unit	Unit Price	Cost
26	CONCRETE CURB RAMP	248.5	SQYD		
27	TRUNCATED DOMES	343.0	SQFT		
28	LIMESTONE SLAB	72	EACH		
29	AREA INLET (4' X 4')	1	EACH		
30	18 IN. PIPE GROUP C	185	LF		
31	24 IN. PIPE GROUP C	24	LF		
32	30 IN. PIPE GROUP C	140	LF		
33	60 IN. PIPE GROUP C	78	LF		
34	8 IN. FLARED END SECTION GROUP C	1	EACH		
35	18 IN. FLARED END SECTION GROUP C	6	EACH		
36	24 IN. FLARED END SECTION GROUP C	1	EACH		
37	30 IN. FLARED END SECTION GROUP C	1	EACH		
38	60 IN. FLARED END SECTION GROUP C	1	EACH		
39	METAL GRATE(10 FT. X 2.5 FT.)	1	EACH		
40	ROCK LINING	1,364	CUYD		
41	ROCK BLANKET (TYPE I)	223	CUYD		
42	TEMPORARY SEEDING AND MULCHING	28.0	ACRE		
43	MULCH FILTER BERM	35,018	LF		
44	SILT FENCE	4,860	LF		
45	DITCH CHECK	3	EACH		
46	INLET PROTECTION	16	EACH		
47	STABILIZED CONSTRUCTION ENTRANCE	8	EACH		
48	SEDIMENT REMOVAL	409	CUYD		
49	EROSION CONTROL BLANKET	2,591	SQYD		
50	PEDESTRIAN FENCE (STRUCTURES) (48 IN.)	380	LF		
51	PEDESTRIAN FENCE (GROUND MOUNT) (48 IN.)	6,198	LF		
52	CHAIN LINK FENCE (48 IN.)	567	LF		
53	WOVEN WIRE FENCE (48 IN.)	5,328	LF		

Jackson County Missouri - Department of Public Works - Engineering Division
ROCK ISLAND RAIL CORRIDOR SHARED USE PATH
FEDERAL PROJECT NO. STP-3453(402) - COUNTY PROJECT NO. 3221 - BID NO. 09-2018

Item No:	DESCRIPTION	Quantity	Unit	Unit Price	Cost
54	WOODEN SPLIT RAIL FENCE (48 IN.)	547	LF		
55	MSE RETAINING WALL (SMALL BLOCK) (RETAINED FACE)	19,873	SQFT		
56	SOLDIER PILE PRECAST PANELS (8 FT)	7,391	SQFT		
57	SOLDIER PILE PRECAST PANELS (16 FT)	466	SQFT		
58	GRAFFITI PROTECTION	19,873	SQFT		
59	PRECAST DECK PANEL (BLUE PARKWAY / 350 HWY)	77	SQYD		
60	CLASS B-I CONCRETE (SUBSTRUCTURE)	48	CUYD		
61	CLASS B-I CONCRETE (SUPERSTRUCTURE)	9	CUYD		
62	CLASS B CONCRETE (RETAINING WALLS)	74	CUYD		
63	STRUCTURAL STEEL PILE (12 IN.)	168	LF		
64	STRUCTURAL STEEL PILE (HPI2X63)	1,240	LF		
65	STRUCTURAL STEEL PILE (HPI4X102)	1,693	LF		
66	STRUCTURAL STEEL PILE (W18X119)	61	LF		
67	PRE-BORE FOR PILING	100	LF		
68	DRILLED SHAFTS (4 FT. 0 IN. DIA.)	33	LF		
69	ROCK SOCKETS (1 FT. 6 IN. DIA.)	387	LF		
70	ROCK SOCKETS (2 FT. 6 IN. DIA.)	224	LF		
71	ROCK SOCKETS (3 FT. 6 IN. DIA.)	10	LF		
72	CONCRETE PILE (24 IN)	516	LF		
73	CONCRETE PILE (36 IN)	781	LF		
74	FOUNDATION INSPECTION HOLES	30	LF		
75	VIDEO CAMERA INSPECTION HOLES	2	LF		
76	SONIC LOGGING TESTING	6	EACH		
77	SLAB ON STEEL TRUSS	400	SQYD		
78	VERTICAL DRAIN AT END BENT	2	EACH		
79	WATERPROOFING MEMBRANE	435	SQYD		

Jackson County Missouri - Department of Public Works - Engineering Division
ROCK ISLAND RAIL CORRIDOR SHARED USE PATH
FEDERAL PROJECT NO. STP-3453(402) - COUNTY PROJECT NO. 3221 - BID NO. 09-2018

Item No:	DESCRIPTION	Quantity	Unit	Unit Price	Cost
80	PREFABRICATED BRIDGE (WILDWOOD - SPAN 1)	1	EACH		
81	PREFABRICATED BRIDGE (WILDWOOD - SPAN 2)	1	EACH		
82	CROSSFRAME TIMBER MEMBERS (RAYTOWN ROAD)	9	EACH		
83	FLAGGERS	8	EACH		
84	CHANNELIZER (TRIM LINE)	400	EACH		
85	TEMPORARY CONCRETE SAFETY BARRIER	200	LF		
86	TEMPORARY SIGN ASSEMBLY	70	EACH		
87	CHANGEABLE MESSAGE SIGN	2	EACH		
88	FLASHING ARROW PANEL	2	EACH		
89	EXIST. PAVEMENT MARKINGS REMOVAL	400	LF		
90	4 IN. WHITE PREFORMED THERMOPLASTIC PAVEMENT MARKING	800	LF		
91	4 IN. YELLOW PREFORMED THERMOPLASTIC PAVEMENT MARKING	440	LF		
92	12 IN. WHITE PREFORMED THERMOPLASTIC PAVEMENT MARKING	500	LF		
93	24 IN. WHITE PREFORMED THERMOPLASTIC PAVEMENT MARKING	490	LF		
94	GREEN BIKE LANE PAVEMENT MARKING PAINT	510	SQFT		
95	LEFT TURN ARROW	1	EACH		
96	"SHARROW" PAVEMENT MARKING	2	EACH		
97	PAVEMENT MARKING SYMBOL, TYPE 2 TAPE (ADA)	4	EACH		
98	CONDUIT, 2 IN, IN TRENCH	85	LF		
99	BASE, CONCRETE	3	CUYD		
100	POST, SIGNAL 8 FT	6	EACH		
101	DETECTOR, ACCESSIBLE PUSH BUTTON	8	EACH		
102	CABLE, 16 AWG 2 CONDUCTOR	400	LF		

Jackson County Missouri - Department of Public Works - Engineering Division
ROCK ISLAND RAIL CORRIDOR SHARED USE PATH
FEDERAL PROJECT NO. STP-3453(402) - COUNTY PROJECT NO. 3221 - BID NO. 09-2018

Item No:	DESCRIPTION	Quantity	Unit	Unit Price	Cost
103	PULL BOX, PREFORMED, CLASS I	1	EACH		
104	VIDEO DETECTION SYSTEM ADJUSTMENT	1	EACH		
105	PERMANENT SIGN ASSEMBLIES	62	EACH		
106	SAFETY SIGN (72")	29	EACH		
107	INTERPRETIVE SIGN ASSEMBLY	9	EACH		
108	RECTANGULAR RAPID FLASHING BEACON ASSEMBLY	9	EACH		
109	COLLAPSIBLE BOLLARD	15	EACH		
110	TRASH RECEPTACLE	2	EACH		
111	BENCH	4	EACH		
112	BIKE RACK	0	EACH	N/A	N/A
113	PICNIC TABLE	0	EACH	N/A	N/A
114	BUMPING POST RELOCATION	1	EACH		
115	SWAMP WHITE OAK/QUERCUS BICOLOR (2.5" CALIPER)	10	EACH		
116	PERMANENT SEEDING AND MULCHING (HYDROSEEDING)	28.0	ACRE		
				Base Bid Total	

Jackson County Missouri - Department of Public Works - Engineering Division
ROCK ISLAND RAIL CORRIDOR SHARED USE PATH
FEDERAL PROJECT NO. STP-3453(402) - COUNTY PROJECT NO. 3221 - BID NO. 09-2018

Page Intentionally Left Blank

Jackson County Missouri - Department of Public Works - Engineering Division
ROCK ISLAND RAIL CORRIDOR SHARED USE PATH
FEDERAL PROJECT NO. STP-3453(402) - COUNTY PROJECT NO. 3221 - BID NO. 09-2018

Item No:	DESCRIPTION	Quantity	Unit	Unit Price	Cost
A1	UTILITY POTHOLES	8	EACH		
A2	ORANGE CONSTRUCTION FENCING (48 IN.)	135	LF		
A3	CLEARING AND GRUBBING	15	ACRE		
A4	UNCLASSIFIED EXCAVATION	15,108	CUYD		
A5	ROCK EXCAVATION (CLASS C EXCAVATION)	796	CUYD		
A6	EMBANKMENT IN PLACE (CONTRACTOR FURNISHED)	16,251	CUYD		
A7	COMPACTING EMBANKMENT	9,938	CUYD		
A8	REMOVE AND REPLACE UNSUITABLE MATERIAL	663	CUYD		
A9	LIGHTWEIGHT FILL	231	CUYD		
A10	REMOVAL OF RAIL AND TIES	8,601	LF		
A11	REMOVAL OF BRIDGE RAIL AND TIES	146	LF		
A12	REMOVAL OF IMPROVEMENTS (NON-RAIL)	1	LS		
A13	SCRAP TIRE DISPOSAL OR RECYCLING	20	CUYD		
A14	TYPE 5 AGGREGATE FOR BASE (4 IN.) (PUGGED)	9,492	SQYD		
A15	CONCRETE PAVEMENT (6 IN. WITH FIBERS)	7,944.5	SQYD		
A16	CONCRETE SIDEWALK, 4 IN.	4.0	SQYD		
A17	CONCRETE CURB RAMP	44.4	SQYD		
A18	TRUNCATED DOMES	88	SQFT		
A19	LIMESTONE SLAB	12	EACH		
A20	18 IN. PIPE GROUP C	44	LF		
A21	18 IN. FLARED END SECTION GROUP C	2	EACH		
A22	ROCK LINING	2	CUYD		
A23	ROCK BLANKET (TYPE I)	273	CUYD		
A24	TEMPORARY SEEDING AND MULCHING	7.0	ACRE		
A25	MULCH FILTER BERM	2,350	LF		
A26	SILT FENCE	375	LF		
A27	DITCH CHECK	9	EACH		

Jackson County Missouri - Department of Public Works - Engineering Division
ROCK ISLAND RAIL CORRIDOR SHARED USE PATH
FEDERAL PROJECT NO. STP-3453(402) - COUNTY PROJECT NO. 3221 - BID NO. 09-2018

Item No:	DESCRIPTION	Quantity	Unit	Unit Price	Cost
A28	STABILIZED CONSTRUCTION ENTRANCE	3	EACH		
A29	SEDIMENT REMOVAL	38	CUYD		
A30	EROSION CONTROL BLANKET	10,714	SQYD		
A31	PEDESTRIAN FENCE (GROUND MOUNT) (48 IN.)	917	LF		
A32	2- RAIL WHITE VINYL FENCE (48 IN.)	60	LF		
A33	MSE RETAINING WALL (SMALL BLOCK) (RETAINED FACE)	4,693	SQFT		
A34	SOLDIER PILE PRECAST PANELS (8 FT)	1,249	SQFT		
A35	GRAFFITI PROTECTION	4,693	SQFT		
A36	CLASS B-I CONCRETE (SUBSTRUCTURE)	156	CUYD		
A37	CLASS B CONCRETE (RETAINING WALLS)	10	CUYD		
A38	STRUCTURAL STEEL PILE (12 IN.)	340	LF		
A39	STRUCTURAL STEEL PILE (HPI 4X102)	499	LF		
A40	PRE-BORE FOR PILING	186	LF		
A41	PIPE PILE SPACER	8	EACH		
A42	CONCRETE PILE (36 IN)	320	LF		
A43	SLAB ON STEEL TRUSS	578	SQYD		
A44	VERTICAL DRAIN AT END BENT	8	EACH		
A45	PREFABRICATED BRIDGE (STADIUM TRAILHEAD)	1	EACH		
A46	PREFABRICATED BRIDGE (BLUE RIDGE CUTOFF)	1	EACH		
A47	PREFABRICATED BRIDGE (ROUND GROVE CREEK - TRIB. #1)	1	EACH		
A48	PREFABRICATED BRIDGE (47TH STREET)	1	EACH		
A49	TYPE III MOVABLE BARRICADE W/ FLASHERS	10	EACH		
A50	FLAGGERS	2	EACH		
A51	CHANNELIZER (TRIM LINE)	100	EACH		
A52	TEMPORARY CONCRETE SAFETY BARRIER	40	LF		
A53	TEMPORARY SIGN ASSEMBLY	90	EACH		

Jackson County Missouri - Department of Public Works - Engineering Division
ROCK ISLAND RAIL CORRIDOR SHARED USE PATH
FEDERAL PROJECT NO. STP-3453(402) - COUNTY PROJECT NO. 3221 - BID NO. 09-2018

Item No:	DESCRIPTION	Quantity	Unit	Unit Price	Cost
A54	CHANGEABLE MESSAGE SIGN	2	EACH		
A55	FLASHING ARROW PANEL	2	EACH		
A56	4 IN. YELLOW PREFORMED THERMOPLASTIC PAVEMENT MARKING	120	LF		
A57	24 IN. WHITE PREFORMED THERMOPLASTIC PAVEMENT MARKING	140	LF		
A58	PERMANENT SIGN ASSEMBLIES	22	EACH		
A59	SAFETY SIGN (72")	6	EACH		
A60	INTERPRETIVE SIGN ASSEMBLY	1	EACH		
A61	RECTANGULAR RAPID FLASHING BEACON ASSEMBLY	5	EACH		
A62	COLLAPSIBLE BOLLARD	3	EACH		
A63	TRASH RECEPTACLE	1	EACH		
A64	BENCH	2	EACH		
A65	BIKE RACK	0	EACH	N/A	N/A
A66	PERMANENT SEEDING AND MULCHING (HYDROSEEDING)	7.0	ACRE		
				Alternate A Total	

Jackson County Missouri - Department of Public Works - Engineering Division
ROCK ISLAND RAIL CORRIDOR SHARED USE PATH
FEDERAL PROJECT NO. STP-3453(402) - COUNTY PROJECT NO. 3221 - BID NO. 09-2018

Page Intentionally Left Blank

Jackson County Missouri - Department of Public Works - Engineering Division
ROCK ISLAND RAIL CORRIDOR SHARED USE PATH
FEDERAL PROJECT NO. STP-3453(402) - COUNTY PROJECT NO. 3221 - BID NO. 09-2018

Unit Price	Cost
BASE BID TOTAL	
ALTERNATE A BID TOTAL	
BASE BID + ALTERNATE A BID TOTAL	

Jackson County Missouri - Department of Public Works - Engineering Division
ROCK ISLAND RAIL CORRIDOR SHARED USE PATH
FEDERAL PROJECT NO. STP-3453(402) - COUNTY PROJECT NO. 3221 - BID NO. 09-2018

Page Intentionally Left Blank

Jackson County Missouri - Department of Public Works - Engineering Division
ROCK ISLAND RAIL CORRIDOR SHARED USE PATH
FEDERAL PROJECT NO. STP-3453(402) - COUNTY PROJECT NO. 3221 - BID NO. 09-2018

FEDERAL WAGE RATES

General Decision Number: MO190001 01/04/2019 MO1

Superseded General Decision Number: MO20180001

State: Missouri

Construction Types: Heavy and Highway

Counties: Missouri Statewide.

HEAVY AND HIGHWAY CONSTRUCTION PROJECTS

Note: Under Executive Order (EO) 13658, an hourly minimum wage of \$10.60 for calendar year 2019 applies to all contracts subject to the Davis-Bacon Act for which the contract is awarded (and any solicitation was issued) on or after January 1, 2015. If this contract is covered by the EO, the contractor must pay all workers in any classification listed on this wage determination at least \$10.60 per hour (or the applicable wage rate listed on this wage determination, if it is higher) for all hours spent performing on the contract in calendar year 2019. If this contract is covered by the EO and a classification considered necessary for performance of work on the contract does not appear on this wage determination, the contractor must pay workers in that classification at least the wage rate determined through the conformance process set forth in 29 CFR 5.5(a)(1)(ii) (or the EO minimum wage rate, if it is higher than the conformed wage rate). The EO minimum wage rate will be adjusted annually. Please note that this EO applies to the above-mentioned types of contracts entered into by the federal government that are subject to the Davis-Bacon Act itself, but it does not apply to contracts subject only to the Davis-Bacon Related Acts, including those set forth at 29 CFR 5.1(a)(2)-(60). Additional information on contractor requirements and worker protections under the EO is available at www.dol.gov/whd/govcontracts.

Modification Number	Publication Date
0	01/04/2019

CARP0002-002 05/01/2018

ST. LOUIS COUNTY AND CITY

	Rates	Fringes
Carpenters.....	\$ 37.33	17.10

CARP0005-006 05/03/2015		

Jackson County Missouri - Department of Public Works - Engineering Division
ROCK ISLAND RAIL CORRIDOR SHARED USE PATH
FEDERAL PROJECT NO. STP-3453(402) - COUNTY PROJECT NO. 3221 - BID NO. 09-2018

CASS (Richards-Gebauer AFB ONLY), CLAY, JACKSON, PLATTE AND RAY
COUNTIES

	Rates	Fringes
Carpenters:		
CARPENTERS & LATHERS.....	\$ 36.34	15.55
MILLWRIGHTS & PILEDRIVERS...	\$ 36.34	15.55

CARP0011-001 05/01/2018

	Rates	Fringes
Carpenter and Piledriver		
ADAIR, AUDRAIN (West of Hwy 19), BOONE, CALLAWAY, CHARITON, COLE, COOPER, HOWARD, KNOX, LINN, MACON, MILLER, MONITEAU, MONROE, OSAGE, PUTNAM, RANDOLPH, SCHUYLER, SHELBY AND SULLIVAN COUNTIES.....	\$ 31.73	17.10
ATCHISON, ANDREW, BATES, CALDWELL, CARROLL, DAVIESS, DEKALB, GENTRY, GRUNDY, HARRISON, HENRY, HOLT, LIVINGSTON, MERCER, NODAWAY, ST. CLAIR, SALINE AND WORTH COUNTIES.....	\$ 30.24	17.10
AUDRAIN (East of Hwy.19), RALLS, MARION, LEWIS, CLARK AND SCOTLAND COUNTIES.	\$ 31.74	17.10
BARRY, BARTON, CAMDEN, CEDAR, CHRISTIAN, DADE, DALLAS, DOUGLAS, GREENE, HICKORY, JASPER, LACLEDE, LAWRENCE, MCDONALD, NEWTON, OZARK, POLK, STONE, TANEY, VERNON, WEBSTER AND WRIGHT COUNTIES.	\$ 29.85	17.10
BENTON, MORGAN AND PETTIS...	\$ 30.29	17.10
BOLLINGER, BUTLER, CAPE GIRARDEAU, DUNKLIN, MISSISSIPPI, NEW MADRID, PEMISCOT, PERRY, STE. GENEVIEVE, SCOTT, STODDARD AND WAYNE COUNTIES.....	\$ 31.59	17.10
BUCHANAN, CLINTON, JOHNSON AND LAFAYETTE COUNTIES.....	\$ 30.96	17.10
CARTER, HOWELL, OREGON AND RIPLEY COUNTIES.....	\$ 30.57	17.10
CRAWFORD, DENT, GASCONADE,		

Jackson County Missouri - Department of Public Works - Engineering Division
ROCK ISLAND RAIL CORRIDOR SHARED USE PATH
FEDERAL PROJECT NO. STP-3453(402) - COUNTY PROJECT NO. 3221 - BID NO. 09-2018

IRON, MADISON, MARIES, MONTGOMERY, PHELPS, PULASKI, REYNOLDS, SHANNON AND TEXAS COUNTIES.....\$	31.58	17.10
FRANKLIN COUNTY.....\$	34.93	17.10
JEFFERSON AND ST. CHARLES COUNTIES.....\$	37.33	17.10
LINCOLN COUNTY.....\$	33.40	17.10
PIKE, ST. FRANCOIS AND WASHINGTON COUNTIES.....\$	32.35	17.10
WARREN COUNTY.....\$	33.83	17.10

ELEC0001-002 06/03/2018

BOLLINGER, BUTLER, CAPE GIRARDEAU, CARTER, DUNKLIN, FRANKLIN,
IRON, JEFFERSON, LINCOLN, MADISON, MISSISSIPPI, NEW MADRID,
PEMISCOT, PERRY, REYNOLDS, RIPLEY, ST. CHARLES, ST. FRANCOIS,
ST. LOUIS (City and County), STE. GENEVIEVE, SCOTT, STODDARD,
WARREN, WASHINGTON AND WAYNE COUNTIES

	Rates	Fringes
Electricians.....\$	38.12	15.60

ELEC0002-001 09/01/2018

ADAIR, AUDRAIN, BOONE, CALLAWAY, CAMDEN, CARTER, CHARITON,
CLARK, COLE, COOPER, CRAWFORD, DENT, FRANKLIN, GASCONADE,
HOWARD, HOWELL, IRON, JEFFERSON, KNOX, LEWIS, LINCON, LINN,
MACON, MARIES, MARION, MILLER, MONITEAU, MONROE, MONTGOMERY,
MORGAN, OREGON, OSAGE, PERRY, PHELPS, PIKE, PULASKI, PUTNAM,
RALLS, RANDOLPH, REYNOLDS, RIPLEY, ST. CHARLES, ST. FRANCOIS,
ST. LOUIS (City and County), STE. GENEVIEVE, SCHUYLER,
SCOTLAND, SHANNON, SHELBY, SULLIVAN, TEXAS, WARREN AND
WASHINGTON COUNTIES

	Rates	Fringes
Line Construction:		
Equipment Operator.....\$	39.50	19.96
Groundman & Truck Driver....\$	30.36	16.67
Lineman & Cable Splicer.....\$	45.90	22.27

ELEC0053-004 09/02/2018

	Rates	Fringes
Line Construction: (ANDREW, ATCHINSON, BARRY, BARTON, BUCHANAN, CALDWELL, CEDAR, CHRISTIAN, CLINTON, DADE, DALLAS, DAVIES,, DEKALB,		

Jackson County Missouri - Department of Public Works - Engineering Division
ROCK ISLAND RAIL CORRIDOR SHARED USE PATH
FEDERAL PROJECT NO. STP-3453(402) - COUNTY PROJECT NO. 3221 - BID NO. 09-2018

DOUGLAS, GENTRY, GREENE,
GRUNDY, HARRISON, HICKORY,
HOLT, JASPER, LACLEDE,
LAWRENCE, LIVINGSTON,
MCDONALD, MERCER, NEWTON,
NODAWAY, OZARK, POLK, ST.
CLAIR, STONE, TANEY, VERNON,
WEBSTER, WORTH AND WRIGHT
COUNTIES)

Groundman Powderman.....	\$ 31.56	14.90
Groundman.....	\$ 29.46	14.29
Lineman Operator.....	\$ 42.24	18.00
Lineman.....	\$ 45.70	19.00

Line Construction; (BATES,
BENTON, CARROLL, CASS, CLAY,
HENRY, JACKSON, JOHNSON,
LAFAYETTE, PETTIS, PLATTE,
RAY AND SALINE COUNTIES)

Groundman Powderman.....	\$ 31.56	14.90
Groundman.....	\$ 29.46	14.29
Lineman Operator.....	\$ 42.24	18.00
Lineman.....	\$ 45.70	19.00

ELEC0095-001 06/01/2017

BARRY, BARTON, CEDAR, DADE, JASPER, LAWRENCE, MCDONALD, NEWTON,
ST CLAIR, AND VERNON COUNTIES

	Rates	Fringes
--	-------	---------

Electricians:

Cable Splicers.....	\$ 25.40	12.19
Electricians.....	\$ 26.79	13.86

* ELEC0124-007 08/27/2018

BATES, BENTON, CARROLL, CASS, CLAY, COOPER, HENRY, JACKSON,
JOHNSON, LAFAYETTE, MORGAN, PETTIS, PLATTE, RAY AND SALINE
COUNTIES:

	Rates	Fringes
--	-------	---------

Electricians.....	\$ 39.45	22.51
-------------------	----------	-------

ELEC0257-003 03/01/2018

AUDRAIN (Except Cuivre Township), BOONE, CALLAWAY, CAMDEN,
CHARITON, COLE, CRAWFORD, DENT, GASCONADE, HOWARD, MARIES,
MILLER, MONITEAU, OSAGE, PHELPS AND RANDOLPH COUNTIES

	Rates	Fringes
--	-------	---------

Jackson County Missouri - Department of Public Works - Engineering Division
ROCK ISLAND RAIL CORRIDOR SHARED USE PATH
FEDERAL PROJECT NO. STP-3453(402) - COUNTY PROJECT NO. 3221 - BID NO. 09-2018

Electricians:

Cable Splicers.....	\$ 30.42	16.085
Electricians.....	\$ 32.50	17.53

ELEC0350-002 12/01/2016

ADAIR, AUDRAIN (East of Highway 19), CLARK, KNOX, LEWIS, LINN,
MACON, MARION, MONROE, MONTGOMERY, PIKE, PUTNAM, RALLS,
SCHUYLER, SCOTLAND, SHELBY AND SULLIVAN COUNTIES

	Rates	Fringes
Electricians.....	\$ 30.57	5.93+35%

ELEC0453-001 09/01/2017

	Rates	Fringes
Electricians:		
CHRISITAN, DALLAS,		
DOUGLAS, GREENE, HICKORY,		
HOWELL, LACLEDE, OREGON,		
OZARK, POLK, SHANNON,		
WEBSTER and WRIGHT COUNTIES..	\$ 26.15	14.56
PULASKI and TEXAS COUNTIES..	\$ 30.80	15.03
STONE and TANEY COUNTIES....	\$ 21.94	13.75

ELEC0545-003 06/01/2017

ANDREW, BUCHANAN, CLINTON, DEKALB, ATCHISON, HOLT, MERCER,
GENTRY, HARRISON, DAVIESS, GRUNDY, WORTH, LIVINGSTON, NODAWAY,
AND CALDWELL COUNTIES

	Rates	Fringes
Electricians:.....	\$ 31.00	15.60

ELEC0702-004 07/02/2018

BOLLINGER, BUTLER, CAPE GIRARDEAU, DUNKLIN, MADISON,
MISSISSIPPI, NEW MADRID, PEMISCOT, SCOTT, STODDARD AND WAYNE
COUNTIES

	Rates	Fringes
Line Construction:		
Groundman - Class A.....	\$ 28.97	14.15
Groundman-Equipment		
Operator Class II (all		
other equipment).....	\$ 36.71	16.39

Jackson County Missouri - Department of Public Works - Engineering Division
ROCK ISLAND RAIL CORRIDOR SHARED USE PATH
FEDERAL PROJECT NO. STP-3453(402) - COUNTY PROJECT NO. 3221 - BID NO. 09-2018

Heavy-Equipment Operator		
Class I (all crawler type		
equipment D-4 and larger)...	\$ 41.86	17.88
Lineman.....	\$ 50.99	20.535

 ENGI0101-001 05/01/2016

ANDREW, ATCHISON, BATES, BENTON, BUCHANAN, CALDWELL, CARROLL,
 CHARITON, CLINTON, COOPER, DAVIESS, DEKALB, GENTRY, GRUNDY,
 HARRISON, HENRY, HOLT, HOWARD, JOHNSON, LAFAYETTE, LINN,
 LIVINGSTON, MERCER, NODAWAY, PETTIS, SALINE, SULLIVAN AND WORTH
 COUNTIES

	Rates	Fringes
Power equipment operators:		
GROUP 1.....	\$ 33.38	15.92
GROUP 2.....	\$ 32.98	15.92
GROUP 3.....	\$ 30.98	15.92

POWER EQUIPMENT OPERATORS CLASSIFICATIONS

GROUP 1: Asphalt roller operator, finish; asphalt paver and spreader; asphalt plant operator; auto grader or trimmer or sub-grader; backhoe; blade operator (all types); boilers - 2; booster pump on dredge; bulldozer operator; boring machine (truck or crane mounted); clamshell operator; concrete mixer paver; concrete plant operator; concrete pump operator; crane operator; derrick or derrick trucks; ditching machine; dragline operator; dredge engineman; dredge operator; drill cat with compressor mounted (self-contained) or similar type self-propelled rotary drill (not air tract); drilling or boring machine (rotary-self-propelled); finishing machine operator; greaser; high loader-fork lift-skid loader (all types); hoisting engineer (2 active drums); locomotive operator (standard guage); mechanics and welders (field and plants); mucking machine operator; pile drive operator; pitman crane or boom truck (all types); push cat; quad track; scraper operators (all types); shovel operator; sideboom cats; side discharge spreader; skimmer scoop operators; slip form paver operator (CMI, Rex, Gomeco or equal); la tourneau rooter (all tiller types); tow boat operator; truck crane; wood and log chippers (all types).

GROUP 2: A-frame truck operator; articulated dump truck; back filler operator; boilers (1); chip spreader; churn drill operator; compressor; concrete mixer operator, skip loader; concrete saws (self-propelled); conveyor operator; crusher operator; distributor operator; elevating grader operator; farm tractor (all attachments); fireman rig; float operator; form grade operator; hoisting engine (one drum); maintenance operator; multiple compactor; pavement

Jackson County Missouri - Department of Public Works - Engineering Division
ROCK ISLAND RAIL CORRIDOR SHARED USE PATH
FEDERAL PROJECT NO. STP-3453(402) - COUNTY PROJECT NO. 3221 - BID NO. 09-2018

breaker, self-propelled hydra-hammer (or similar type);
paymill operator; power shield; pumps; roller operator
(with or without blades); screening and washing plant;
self-propelled street broom or sweeper; siphons and jets;
straw blower; stump cutting machine; siphons and jets; tank
car heater operator (combination boiler and booster);
welding machine; vibrating machine operator (not hand
held); welding machine.

GROUP 3: (a) Oiler;
 (b) Oiler driver
 (c) Mechanic.

HOURLY PREMIUMS:

THE FOLLOWING CLASSIFICATIONS SHALL RECEIVE (\$.25) ABOVE
GROUP 1 RATE: Dragline operator - 3 yds. & over; shovel
3 yds. & over; clamshell 3 yds. & over; Crane, rigs or
piledrivers, 100' of boom or over (incl. jib.), hoist -
each additional active drum over 2 drums

THE FOLLOWING CLASSIFICATIONS SHALL RECEIVE (\$.50) ABOVE
GROUP 1 RATE: Tandem scoop operator; crane, rigs or
piledrivers 150' to 200' of boom (incl. jib.)

THE FOLLOWING CLASSIFICATIONS SHALL RECEIVE (\$.75) ABOVE
GROUP 1 RATE: Crane rigs, or piledrivers 200 ft. of boom
or over (including jib.)

ENGI0101-005 04/01/2018

CASS, CLAY, JACKSON, PLATTE AND RAY COUNTIES

	Rates	Fringes
Power equipment operators:		
GROUP 1.....	\$ 36.22	17.99
GROUP 2.....	\$ 35.18	17.99
GROUP 3.....	\$ 30.71	17.99
GROUP 4.....	\$ 34.06	17.99

POWER EQUIPMENT OPERATORS CLASSIFICATIONS

GROUP 1: Asphalt roller operator, finish; asphalt paver and
spreader; asphalt plant operator; auto grader or trimmer or
sub-grader; backhoe; blade operator (all types); boilers-2;
booster pump on dredge; boring machine (truck or crane
mounted); bulldozer operator; clamshell operator; concrete
cleaning decontamination machine operator; concrete mixer
paver; concrete plant operator; concrete pump operator;
crane operator; derrick or derrick trucks; ditching
machine; dragline operator; dredge engineman; dredge
operator; drillcat with compressor mounted (self-contained)
or similar type self propelled rotary drill (not air

Jackson County Missouri - Department of Public Works - Engineering Division
ROCK ISLAND RAIL CORRIDOR SHARED USE PATH
FEDERAL PROJECT NO. STP-3453(402) - COUNTY PROJECT NO. 3221 - BID NO. 09-2018

tract); drilling or boring machine (rotary - self-propelled); finishing machine operator; greaser; heavy equipment robotics operator/mechanic; horizontal directional drill operator; horizontal directional drill locator; loader-forklift - skid loader (all types); hoisting engineer (2 active drums); locomotive operator (standard guage); master environmental maintenance mechanic; mechanics and welders (field and plants); mucking machine operator; piledrive operator; pitman crane or boom truck (all types); push cat; quad-track; scraper operators (all types); shovel operator; side discharge spreader; sideboom cats; skimmer scoop operator; slip-form paver (CMI, REX, Gomaco or equal); la tourneau rooter (all tiller types); tow boat operator; truck crane; ultra high perssure waterjet cutting tool system operator/mechanic; vacuum blasting machine operator/mechanic; wood and log chippers (all types)

GROUP 2: "A" Frame truck operator; back filler operator; boilers (1); chip spreader; churn drill operator; concrete mixer operator, skip loader; concrete saws (self-propelled); conveyor operator; crusher operator; distributor operator; elevating grader operator; farm tractor (all attachments); fireman rig; float operator; form grader operator; hoisting engine (1 drum); maintenance operator; multiple compactor; pavement breaker, self-propelled hydra- hammer (or similar type); power shield; paymill operator; pumps; siphons and jets; stump cutting machine; tank car heater operator (combination boiler and booster); compressor; roller operator (with or without blades); screening and washing plant; self-propelled street broom or sweeper; straw blower; tank car heater operator (combination boiler and booster); vibrating machine operator (not hand held)

GROUP 3: Oilers

GROUP 4: Oiler Driver (All Types)

FOOTNOTE:

HOURLY PREMIUMS FOLLOWING CLASSIFICATIONS SHALL RECEIVE (\$1.00) ABOVE GROUP 1 RATE:

Clamshells - 3 yd. capacity or over; Cranes or rigs, 80 ft. of boom or over (including jib); Draglines, 3 yd. capacity or over;

Piledrivers 80 ft. of boom or over (including jib);

Shovels & backhoes, 3 yd. capacity or over.

ENGI0101-022 05/01/2016

BARRY, BARTON, CAMDEN, CEDAR, CHRISTIAN, DADE, DALLAS, DOUGLAS, GREENE, HICKORY, JASPER, LACLEDE, LAWRENCE, MCDONALD, NEWTON, OZARK, POLK, ST. CLAIR, STONE, TANEY, VERNON, WEBSTER AND

Jackson County Missouri - Department of Public Works - Engineering Division
ROCK ISLAND RAIL CORRIDOR SHARED USE PATH
FEDERAL PROJECT NO. STP-3453(402) - COUNTY PROJECT NO. 3221 - BID NO. 09-2018

WRIGHT COUNTIES and CITY OF SPRINGFIELD

	Rates	Fringes
Power equipment operators:		
GROUP 1.....	\$ 30.82	13.30
GROUP 2.....	\$ 29.88	13.30
GROUP 3.....	\$ 30.27	13.30
GROUP 4.....	\$ 28.22	13.30

POWER EQUIPMENT OPERATORS CLASSIFICATIONS

GROUP 1: Asphalt finishing machine & trench widening spreader; asphalt plant console operator; autograder; automatic slipform paver; backhoe; blade operator - all types; boat operator - tow; boilers-2; central mix concrete plant operator; clamshell operator; concrete mixer paver; crane operator; derrick or derrick trucks; ditching machine; dozer operator; dragline operator; dredge booster pump; dredge engineman; dredge operator; drill cat with compressor mounted on cat; drilling or boring machine rotary self-propelled; highloader; hoisting engine - 2 active drums; launch hammer wheel; locomotive operator; - standard guage; mechanic and welders; mucking machine; off-road trucks; piledriver operator; pitman crane operator; push cat operator; quad trac; scoop operator - all types; shovel operator; sideboom cats; skimmer scoop operators; trenching machine operator; truck crane.

GROUP 2: A-frame; asphalt hot-mix silo; asphalt plant fireman (drum or boiler); asphalt plant man; asphalt plant man; asphalt plant mixer operator; asphalt roller operator; backfiller operator; barber-greene loader; boat operator (bridges and dams); chip spreader; concrete mixer operator - skip loader; concrete plant operator; concrete pump operator; crusher operator; dredge oiler; elevating grader operator; fork lift; greaser-fleet; hoisting engine - 1; locomotive operator - narrow gauge; multiple compactor; pavement breaker; powerbroom - self-propelled; power shield; rooter; side discharge concrete spreader; slip form finishing machine; stumpcutter machine; throttle man; tractor operator (over 50 h.p.); winch truck.

GROUP 3: Boilers - 1; chip spreader (front man); churn drill operator; clef plane operator; concrete saw operator (self-propelled); curb finishing machine; distributor operator; finishing machine operator; flex plane operator; float operator; form grader operator; pugmill operator; roller operator, other than high type asphalt; screening & washing plant operator; siphons & jets; sub-grading machine operator; spreader box operator, self-propelled (not asphalt); tank car heater operator (combination boiler & booster); tractor operator (50 h.p. or less); Ulmac, Ulric

Jackson County Missouri - Department of Public Works - Engineering Division
ROCK ISLAND RAIL CORRIDOR SHARED USE PATH
FEDERAL PROJECT NO. STP-3453(402) - COUNTY PROJECT NO. 3221 - BID NO. 09-2018

or similar spreader; vibrating machine operator, not hand;

GROUP 4: Grade checker; Oiler; Oiler-Driver

HOURLY PREMIUMS:

The following classifications shall receive \$.25 above GROUP 1 rate:

Clamshells - 3 yds. or over; Cranes - Rigs or Piledrivers, 100 ft. of boom or over (including jib);
Draglines - 3 yds. or over; Hoists - each additional active drum over 2 drums; Shovels - 3 yds. or over;

The following classifications shall receive \$.50 above GROUP 1 rate:

Tandem scoop operator; Cranes - Rigs or Piledrivers, 150 ft. to 200 ft. of boom (including jib); Tandem scoop.

The following classifications shall receive \$.75 above GROUP 1 rate:

Cranes - Rigs or Piledrivers, 200 ft. of boom or over (including jib.).

ENGI0513-004 05/01/2018

FRANKLIN, JEFFERSON, LINCOLN, ST CHARLES, AND WARREN COUNTIES

	Rates	Fringes
Power equipment operators:		
GROUP 1.....	\$ 32.96	27.24
GROUP 2.....	\$ 32.96	27.24
GROUP 3.....	\$ 31.66	27.24
GROUP 4.....	\$ 31.21	27.24

POWER EQUIPMENT OPERATORS CLASSIFICATIONS

GROUP 1: Backhoe, Cable; Backhoe, Hydraulic (2 cu yds bucket and under regardless of attachment, one oiler for 2 or 3, two oilers for 4 through 6); Backhoe, Hydraulic over 2 cu yds; Cableway; Crane, Crawler or Truck; Crane, Hydraulic - Truck or Cruiser mounted, 16 tons and over; Crane, Locomotive; crane with boom including jib over 100 ft from pin to pin; Crane using rock socket tool; Derrick, Steam; Derrick Car and Derrick Boat; Dragline, 7 cu yds and over; Dredge; Gradall, Crawler or tire mounted; Locomotive, Gas, Steam & other powers; Pile Driver, Land or Floating; Scoop, Skimmer; Shovel, Power (Electric, Gas, Steam or other powers); Shovel, Power (7 cu yds and over); Switch Boat; Whirley; Air Tugger with air compressor; Anchor Placing Barge; Asphalt Spreader; Athey Force Feeder Loader, self-propelled; Backfilling Machine; Boat Operator - Push Boat or Tow Boat (job site); Boiler, High Pressure Breaking

Jackson County Missouri - Department of Public Works - Engineering Division
ROCK ISLAND RAIL CORRIDOR SHARED USE PATH
FEDERAL PROJECT NO. STP-3453(402) - COUNTY PROJECT NO. 3221 - BID NO. 09-2018

in Period; Boom Truck, Placing or Erecting; Boring Machine, Footing Foundation; Bullfloat; Cherry Picker; Combination Concrete Hoist and Mixer (such as Mixermobile); Compressor, Two 125 CFM and under; Compressor, Two through Four over 125 CFM; Compressor when operator runs throttle; Concrete Breaker (Truck or Tractor mounted); Concrete Pump (such as Pumpcrete machine); Concrete Saw (self-propelled); Concrete Spreader; Conveyor, Large (not selfpropelled) hoisting or moving brick and concrete into, or into and on floor level, one or both; Crane, Climbing (such as Linden); Crane, Hydraulic - Rough Terrain, self-propelled; Crane, Hydraulic - Truck or Cruiser mounted - under 16 tons; Drilling machine - Self-powered, used for earth or rock drilling or boring (wagon drills and any hand drills obtaining power from other sources including concrete breakers, jackhammers and Barco equipment no engineer required); Elevating Grader; Engine Man, Dredge; Excavator or Powerbelt Machine; Finishing Machine, self-propelled oscillating screed; Forklift; Generators, Two through Six 30 KW or over; Grader, Road with power blade; Greaser; Highlift; Hoist, Concrete and Brick (Brick cages or concrete skips operating or on tower, Towermobile, or similar equipment); Hoist, Three or more drums in use; Hoist, Stack; Hydro-Hammer; Lad-A-Vator, hoisting brick or concrete; Loading Machine such as Barber-Greene; Mechanic on job site

GROUP 2: Air Tugger with plant air; Boiler (for power or heating shell of building or temporary enclosures in connection with construction work); Boiler, Temporary; Compressor, One over 125 CFM; Compressor, truck mounted; Conveyor, Large (not self-propelled); Conveyor, Large (not self-propelled) moving brick and concrete (distributing) on floor level; Curb Finishing Machine; Ditch Paving Machine; Elevator (outside); Endless Chain Hoist; Fireman (as required); Form Grader; Hoist, One Drum regardless of size (except brick or concrete); Lad-A-Vator, other hoisting; Manlift; Mixer, Asphalt, over 8 cu ft capacity; Mixer, one bag capacity or less; Mixer, without side loader, two bag capacity or more; Mixer, with side loader, regardless of size, not Paver; Mud Jack (where mud jack is used in conjunction with an air compressor, operator shall be paid \$.55 per hour in addition to his basic hourly rate for covering both operations); Pug Mill operator; Pump, Sump - self powered, automatic controlled over 2"; Scissor Lift (used for hoisting); Skid Steer Loader; Sweeper, Street; Tractor, small wheel type 50 HP and under with grader blade and similar equipment; Welding Machine, One over 400 amp; Winch, operating from truck

GROUP 3: Boat operator - outboard motor, job site; Conveyors (such as Con-Vay-It) regardless of how used; Elevator (inside); Heater operator, 2 through 6; Sweeper, Floor

GROUP 4: Crane type

Jackson County Missouri - Department of Public Works - Engineering Division
ROCK ISLAND RAIL CORRIDOR SHARED USE PATH
FEDERAL PROJECT NO. STP-3453(402) - COUNTY PROJECT NO. 3221 - BID NO. 09-2018

HOURLY PREMIUMS:

Backhoe, Hydraulic 2 cu yds or less without oiler - \$2.00;
 Crane, climbing (such as Linden) - \$.50;
 Crane, Pile Driving and Extracting - \$.50
 Crane with boom (including job) over
 100 ft from pin to pin - add \$.01 per foot
 to maximum of \$4.00);
 Crane, using rock socket tool - \$.50;
 Derrick, diesel, gas or electric hoisting material
 and erecting steel (150 ft or more above ground) - \$.50;
 Dragline, 7 cu yds and over - \$.50;
 Hoist, Three or more drums in use - \$.50;
 Scoop, Tandem - \$.50;
 Shovel, Power - 7 cu yds and over - \$.50;
 Tractor, Tandem Crawler - \$.50;
 Tunnel, man assigned to work in tunnel or
 tunnel shaft - \$.50;
 Wrecking, when machines are working on
 second floor or higher - \$.50

 ENGI0513-006 05/01/2018

ADAIR, AUDRAIN, BOLLINGER, BOONE, BUTLER, CALLAWAY, CAPE
 GIRARDEAU, CARTER, CLARK, COLE, CRAWFORD, DENT, DUNKLIN,
 GASCONADE, HOWELL, IRON, KNOX, LEWIS, MACON, MADISON, MARIES,
 MARION, MILLER, MISSISSIPPI, MONITEAU, MONROE, MONTGOMERY,
 MORGAN, NEW MADRID, OREGON, OSAGE, PEMISCOT, PERRY, PHELPS,
 PIKE, PULASKI, PUTNAM, RALLS, RANDOLPH, REYNOLDS, RIPLEY, ST.
 FRANCOIS, STE. GENEVIEVE, SCHUYLER, SCOTLAND, SCOTT, SHANNON,
 SHELBY, STODDARD, TEXAS, WASHINGTON, AND WAYNE COUNTIES

	Rates	Fringes
Power equipment operators:		
GROUP 1.....	\$ 28.34	27.06
GROUP 2.....	\$ 27.99	27.06
GROUP 3.....	\$ 27.79	27.06
GROUP 4.....	\$ 24.14	27.06

POWER EQUIPMENT OPERATORS CLASSIFICATIONS

GROUP 1: Asphalt finishing machine & trench widening
 spreader, asphalt plant console operator; autograder;
 automatic slipform paver; back hoe; blade operator - all
 types; boat operator tow; boiler two; central mix concrete
 plant operator; clam shell operator; concrete mixer paver;
 crane operator; derrick or derrick trucks; ditching
 machine; dozer operator; dragline operator; dredge booster
 pump; dredge engineman; dredge operator; drill cat with
 compressor mounted on cat; drilling or boring machine

Jackson County Missouri - Department of Public Works - Engineering Division
ROCK ISLAND RAIL CORRIDOR SHARED USE PATH
FEDERAL PROJECT NO. STP-3453(402) - COUNTY PROJECT NO. 3221 - BID NO. 09-2018

rotary self-propelled; highloader; hoisting engine 2 active drums; launchhammer wheel; locomotive operator standrad guage; mechanics and welders; mucking machine; piledriver operator; pitman crane operator; push cat operator; quad-trac; scoop operator; sideboom cats; skimmer scoop operator; trenching machine operator; truck crane, shovel operator.

GROUP 2: A-Frame; asphalt hot-mix silo; asphalt roller operator asphalt plant fireman (drum or boiler); asphalt plant man; asphalt plant mixer operator; backfiller operator; barber-greene loader; boat operator (bridge & dams); chip spreader; concrete mixer operator skip loader; concrete plant operator; concrete pump operator; dredge oiler; elevating graded operator; fork lift; grease fleet; hoisting engine one; locomotive operator narrow guage; multiple compactor; pavement breaker; powerbroom self-propelled; power shield; rooter; slip-form finishing machine; stumpcutter machine; side discharge concrete spreader; throttleman; tractor operator (over 50 hp); winch truck; asphalt roller operator; crusher operator.

GROUP 3: Spreader box operator, self-propelled not asphalt; tractor operator (50 h.p. or less); boilers one; chip spreader (front man); churn drill operator; compressor over 105 CFM 2-3 pumps 4" & over; 2-3 light plant 7.5 KWA or any combination thereof; clef plane operator; compressor maintenance operator 2 or 3; concrete saw operator (self-propelled); curb finishing mancine; distributor operator; finishing machine operator; flex plane operator; float operator; form grader operator; pugmill operator; riller operator other than high type asphalt; screening & washing plant operator; siphons & jets; subgrading machine operator; tank car heater (combination boiler & booster); ulmac, ulric or similar spreader; vibrating machine operator; hydrobroom.

GROUP 4: Oiler; grout machine; oiler driver; compressor over 105 CFM one; conveyor operator one; maintenance operator; pump 4" & over one.

FOOTNOTE: HOURLY PREMIUMS

Backhoe hydraulic, 2 cu. yds. or under Without oiler - \$2.00
Certified Crane Operator - \$1.50;
Certified Hazardous Material Operator \$1.50;
Crane, climbing (such as Linden) - \$0.50;
Crane, pile driving and extracting - \$0.50;
 Crane, with boom (including jib) over 100' from pin to pin
 add \$0.01 per foot to maximum of \$4.00;
Crane, using rock socket tool - \$0.50;
 Derrick, diesel, gas or electric, hoisting material and
 erecting steel (150' or more above the ground) - \$0.50;
Dragline, 7 cu. yds, and over - \$0.50;

Jackson County Missouri - Department of Public Works - Engineering Division
ROCK ISLAND RAIL CORRIDOR SHARED USE PATH
FEDERAL PROJECT NO. STP-3453(402) - COUNTY PROJECT NO. 3221 - BID NO. 09-2018

Hoist, three or more drums in use - \$0.50; Scoop, Tandem - \$0.50;
Shovel, power - 7 cu. yds. or more - \$0.50;
Tractor, tandem crawler - \$0.50;
Tunnel, man assigned to work in tunnel or tunnel shaft - \$0.50;
Wrecking, when machine is working on second floor or higher - \$0.50;

ENGI0513-007 05/02/2018

ST. LOUIS CITY AND COUNTY

	Rates	Fringes
Power equipment operators:		
GROUP 1.....	\$ 32.96	27.24
GROUP 2.....	\$ 32.96	27.24
GROUP 3.....	\$ 31.66	27.24
GROUP 4.....	\$ 31.21	27.24

POWER EQUIPMENT OPERATORS CLASSIFICATIONS

GROUP 1: Backhoe, cable or hydraulic; cableway; crane crawler or truck; crane, hydraulic-truck or cruiser mounted 16 tons & over; crane locomotive; derrick, steam; derrick car & derrick boat; dragline; dredge; gradall, crawler or tire mounted; locomotive, gas, steam & other powers; pile driver, land or floating; scoop, skimmer; shovel, power (steam, gas, electric or other powers); switch boat; whirley.

GROUP 2: Air tugger w/air compressor; anchor-placing barge; asphalt spreader; atthey force feeder loader (self-propelled); backfilling machine; backhoe-loader; boat operator-push boat or tow boat (job site); boiler, high pressure breaking in period; boom truck, placing or erecting; boring machine, footing foundation; bull- float; cherry picker; combination concrete hoist & mixer (such as mixer mobile); compressor (when operator runs throttle); concrete breaker (truck or tractor mounted); concrete pump, such as pump-crete machine; concrete saw (self-propelled), concrete spreader; conveyor, large (not self-propelled), hoisting or moving brick and concrete into, or into and on floor level, one or both; crane, hydraulic-rough terrain, self-propelled; crane hydraulic-truck or cruiser mounted-under 16 tons; drilling machines, self-powered use for earth or rock drilling or boring (wagon drills nd any hand drills obtaining power from other sources including concrete breakers, jackhammers and barco equipment-no engineer required); elevating grader; engineman, dredge; excavator or powerbelt machine; finishing machine, self-propelled oscillating screed; forklift; grader, road

Jackson County Missouri - Department of Public Works - Engineering Division
ROCK ISLAND RAIL CORRIDOR SHARED USE PATH
FEDERAL PROJECT NO. STP-3453(402) - COUNTY PROJECT NO. 3221 - BID NO. 09-2018

with power blade; highlift. greaser; hoist, stack, hydro-hammer; loading machine (such as barber-green); machanic, on job site; mixer, pipe wrapping machines; plant asphalt; plant, concrete producing or ready-mix job site; plant heating-job site; plant mixing-job site; plant power, generating-job site; pumps, two through six self-powered over 2"; pumps, electric submersible, two through six, over 4"; quad-track; roller, asphalt, top or sub-grade; scoop, tractor drawn; spreader box; sub-grader; tie tamper; tractor-crawler, or wheel type with or without power unit, power take-offs and attachments regardless of size; trenching machine; tunnel boring machine; vibrating machine automatic, automatic propelled; welding machines (gasoline or diesel) two through six; well drilling machine

GROUP 3: Conveyor, large (not self-propelled); conveyor, large (not self-propelled) moving brick and concrete distributing) on floor level; mixer two or more mixers of one bag capacity or less; air tugger w/plant air; boiler, for power or heating on construction projects; boiler, temporary; compressor (mounted on truck; curb finishing machine; ditch paving machine; elevator; endless chain hoist; form grader; hoist, one drum regardless of size; lad-a-vator; manlift; mixer, asphalt, over 8 cu. ft. capacity, without side loader, 2 bag capacity or more; mixer, with side loader, regardless of size; pug mill operator; pump, sump-self-powered, automatic controlled over 2" during use in connection with construction work; sweeper, street; welding machine, one over 400 amp.; winch operating from truck; scissor lift (used for hoisting); tractor, small wheel type 50 h.p. & under with grader blade & similar equipment; Oiler on dredge and on truck crane.

GROUP 4: Boat operator-outboard motor (job site); conveyor (such as con-vay-it) regardless of how used; sweeper, floor

HOURLY PREMIUMS:

Backhoe, hydraulic	
2 cu. yds. or under without oiler	\$2.00
Certified Crane Operator	1.50
Certified Hazardous Material Operator	1.50
Crane, climbing (such as Linden)	.50
Crane, pile driving and extracting	.50
Crane, with boom (including jib) over 100' (from pin to pin) add \$.01 per foot to maximum of	4.00
Crane, using rock socket tool	.50
Derrick, diesel, gas or electric, hoisting material and erecting steel (150' or more above ground)	.50
Dragline, 7 cu. yds. and over	.50
Hoist, three (3) or more drums in use	.50
Scoop, Tandem	.50
Shovel, power - 7 cu. yds. or more	.50

Jackson County Missouri - Department of Public Works - Engineering Division
ROCK ISLAND RAIL CORRIDOR SHARED USE PATH
FEDERAL PROJECT NO. STP-3453(402) - COUNTY PROJECT NO. 3221 - BID NO. 09-2018

Tractor, tandem crawler	.50
Tunnel, man assigned to work in tunnel or tunnel shaft	.50
Wrecking, when machine is working on second floor or higher	.50

IRON0010-012 04/01/2018

	Rates	Fringes
Ironworkers:		
ANDREW, BARTON, BENTON, CAMDEN, CEDAR, CHARITON, CHRISTIAN, COOPER, DADE, DALLAS, DAVIESS, DE KALB, GENTRY, GREENE, GRUNDY, HARRISON, HICKORY, HOLT, HOWARD, LACLEDE, LINN, LIVINGSTON, MERCER, MONITEAU, MORGAN, NODAWAY, PETTIS, POLK, PUTNAM, RANDLOPH, ST. CLAIR, SULLIVAN, TANEY, VERNON, WEBSTER, WRIGHT and WORTH Counties and portions of ADAIR, BOONE, MACON, MILLER and RANDOLPH Counties.....	\$ 30.30	29.44
ATCHISON, BATES, BUCHANAN, CALDWELL, CARROLL, CASS, CLAY, CLINTON, HENRY, JACKSON, JOHNSON, LAFAYETTE, PETTIS, PLATTE, SALINE, AND RAY COUNTIES....	\$ 33.30	29.44

IRON0321-002 09/01/2018

DOUGLAS, HOWELL and OZARK COUNTIES

	Rates	Fringes
Ironworker.....	\$ 19.95	18.36

IRON0396-004 08/02/2017

ST. LOUIS (City and County), ST. CHARLES, JEFFERSON, IRON,
FRANKLIN, LINCOLN, WARREN, WASHINGTON, ST. FRANCOIS, STE.
GENEVIEVE, and REYNOLDS Counties; and portions of MADISON,
PERRY, BOLLINGER, WAYNE, and CARTER Counties

	Rates	Fringes
--	-------	---------

Jackson County Missouri - Department of Public Works - Engineering Division
ROCK ISLAND RAIL CORRIDOR SHARED USE PATH
FEDERAL PROJECT NO. STP-3453(402) - COUNTY PROJECT NO. 3221 - BID NO. 09-2018

Ironworker.....	\$ 33.96	25.11
-----------------	----------	-------

IRON0396-009 08/02/2017

AUDRAIN, CALLAWAY, COLE, CRAWFORD, DENT, GASCONADE, MARIES,
MONTGOMERY, OSAGE, PHELPS, PIKE, PULASKI, TEXAS and WRIGHT
Counties; and portions of BOONE, CAMDEN, DOUGLAS, HOWELL,
LACLEDE, MILLER, MONROE, OREGON, SHANNON and RALLS Counties

	Rates	Fringes
Ironworker.....	\$ 29.49	25.11

IRON0577-005 08/01/2018

ADAIR, CLARK, KNOX, LEWIS, MACON, MARION, MONROE, RALLS,
SCHUYLER, SCOTLAND, AND SHELBY COUNTIES

	Rates	Fringes
Ironworker.....	\$ 26.25	23.10

IRON0584-004 06/01/2017

BARRY, JASPER, LAWRENCE, MCDONALD, NEWTON AND STONE Counties

	Rates	Fringes
Ironworkers:.....	\$ 24.00	14.81

IRON0782-003 05/01/2016

CAPE GIRARDEAU, MISSISSIPPI, NEW MADRID, SCOTT, & STODDARD
Counties; and portions of BOLLINGER, BUTLER, CARTER, DUNKLIN,
MADISON, PEMISCOT, PERRY, RIPLEY, and WAYNE Counties

	Rates	Fringes
Ironworkers:		
Locks, Dams, Bridges and other major work on the Mississippi and Ohio River only.....	\$ 31.63	24.27
All Other Work.....	\$ 25.12	19.90

LABO0042-003 03/07/2018

ST. LOUIS (City and County)

	Rates	Fringes
--	-------	---------

Jackson County Missouri - Department of Public Works - Engineering Division
ROCK ISLAND RAIL CORRIDOR SHARED USE PATH
FEDERAL PROJECT NO. STP-3453(402) - COUNTY PROJECT NO. 3221 - BID NO. 09-2018

LABORER

Plumber Laborer.....	\$ 32.32	15.50
----------------------	----------	-------

LABO0042-005 03/07/2018

ST. LOUIS (City and County)

	Rates	Fringes
--	-------	---------

LABORER

Dynamiter, Powderman.....	\$ 32.32	15.32
Laborers, Flaggers.....	\$ 32.32	15.32
Wrecking.....	\$ 32.32	15.32

LABO0424-002 05/01/2016

	Rates	Fringes
--	-------	---------

LABORER

ADAIR, AUDRAIN, BOONE,
CALLAWAY, CHARITON, CLARK,
COLE, COOPER, HOWARD,
IRON, KNOX, LEWIS, LINN,
MACON, MADISON, MARION,
MILLER, MONITEAU, MONROE,
PERRY, PIKE, PUTNAM,
RALLS, RANDOLPH, REYNOLDS,
ST. FRANCOIS, STE.
GENEVIEVE, SCHUYLER,
SCOTLAND, SHELBY AND
SULLIVAN COUNTIES

GROUP 1.....	\$ 27.96	13.17
GROUP 2.....	\$ 27.96	13.17

BOLLINGER, BUTLER, CAPE
GIRARDEAU, CARTER,
CRAWFORD, DENT, DUNKLIN,
GASCONADE, HOWELL, MARIES,
MISSISSIPPI, NEW MADRID,
OREGON, OSAGE, PEMISCOT,
PHELPS, PULASKI, RIPLEY,
SCOTT, SHANNON, STODDARD,
TEXAS, WASHINGTON AND
WAYNE COUNTIES

GROUP 1.....	\$ 27.96	13.17
GROUP 2.....	\$ 27.96	13.17

FRANKLIN COUNTY

GROUP 1.....	\$ 29.71	13.17
GROUP 2.....	\$ 30.31	13.17

JEFFERSON COUNTY

GROUP 1.....	\$ 29.76	13.17
GROUP 2.....	\$ 30.36	13.17

LINCOLN, MONTGOMERY AND

WARREN COUNTIES

GROUP 1.....	\$ 31.18	13.32
--------------	----------	-------

Jackson County Missouri - Department of Public Works - Engineering Division
ROCK ISLAND RAIL CORRIDOR SHARED USE PATH
FEDERAL PROJECT NO. STP-3453(402) - COUNTY PROJECT NO. 3221 - BID NO. 09-2018

GROUP 2.....	\$ 31.18	13.32
ST.CHARLES COUNTY		
GROUP 1.....	\$ 3.18	13.32
GROUP 2.....	\$ 31.18	13.32

LABORERS CLASSIFICATIONS

GROUP 1 - General laborer-flagman, carpenter tenders; salamander Tenders; Dump Man; Ticket Takers; loading trucks under bins, hoppers, and conveyors; track man; cement handler; dump man on earth fill; georgie buggy man; material batch hopper man; spreader on asphalt machine; material mixer man (except on manholes); coffer dams; riprap pavers rock, block or brick; scaffolds over ten feet not self-supported from ground up; skip man on concrete paving; wire mesh setters on concrete paving; all work in connection with sewer, water, gas, gasoling, oil, drainage pipe, conduit pipe, tile and duct lines and all other pipe lines; power tool operator; all work in connection with hydraulic or general dredging operations; form setters, puddlers (paving only); straw blower nozzle man; asphalt plant platform man; chuck tender; crusher feeder; men handling creosote ties or creosote materials; men working with and handling epoxy material; toppler of standing trees; feeder man on wood pulverizers, board and willow mat weavers and cable ties on river work; deck hands; pile dike and revetment work; all laborers working on underground tunnels less than 25 ft. where compressed air is not used; abutment and pier hole men working six (6) ft. or more below ground; men working in coffer dams for bridge piers and footing in the river; barco tamper; jackson or any other similar tamp; cutting torch man; liners, curb, gutters, ditch lines; hot mastic kettlemen; hot tar applicator; hand blade operator; mortar men or brick or block manholes; rubbing concrete, air tool operator under 65 lbs.; caulker and lead man; chain or concrete saw under 15 h.p.; signal Gan; Guard rail and sign erectors.

GROUP 2 - Skilled laborers - Vibrator man; asphalt raker; head pipe layer on sewer work; batterboard man on pipe and ditch work; cliff scalers working from bosun's chairs; scaffolds or platforms on dams or power plants over 10 ft. high; air tool operator over 65 lbs.; stringline man on concrete paving; sandblast man; laser beam man; wagon drill; churn drill; air track drill and all other similar type drills, gunite nozzle man; pressure grout man; screed man on asphalt; concrete saw 15 h.p. and over; grade checker; strigline man on electronic grade control; manhole builder; dynamite man; powder man; welder; tunnel man; waterblaster - 1000 psi or over; asbestos and/or hazardous waste removal and/or disposal

Jackson County Missouri - Department of Public Works - Engineering Division
ROCK ISLAND RAIL CORRIDOR SHARED USE PATH
FEDERAL PROJECT NO. STP-3453(402) - COUNTY PROJECT NO. 3221 - BID NO. 09-2018

LABO0579-005 05/01/2018

	Rates	Fringes
LABORER (ANDREW, ATCHISON, BUCHANAN, CALDWELL, CLINTON, DAVISS, DEKALB, GENTRY, GRUNDY, HARRISON, HOLT, LIVINGSTON, MERCER, NODAWAY and WORTH COUNTIES.)		
GROUP 1.....	\$ 26.16	14.47
GROUP 2.....	\$ 26.51	14.47
LABORER (BARRY, BARTON, BATES, BENTON, CAMDEN, CARROLL, CEDAR, CHRISTIAN, DADE, DALLAS, DOUGLAS, GREENE, HENRY. HICKORY, JASPER, JOHNSON, LACLEDE, LAWRENCE, MCDONALD, MORGAN, NEWTON, OZARK, PETTIS, POLK, ST.CLAIR, SALINE, STONE, TANEY, VERNON, WEBSTER and WRIGHT COUNTIES)		
GROUP 1.....	\$ 25.16	13.67
GROUP 2.....	\$ 25.71	13.67
LABORER (LAFAYETTE COUNTY)		
GROUP 1.....	\$ 26.71	13.92
GROUP 2.....	\$ 27.06	13.92

LABORERS CLASSIFICATIONS

GROUP 1: General Laborers - Carpenter tenders; salamander tenders; loading trucks under bins; hoppers & conveyors; track men & all other general laborers; air tool operator; cement handler-bulk or sack; dump man on earth fill; georgie buggy man; material batch hopper man; material mixer man (except on manholes); coffer dams; riprap pavers - rock, block or brick; signal man; scaffolds over ten feet not self-supported from ground up; skipman on concrete paving; wire mesh setters on concrete paving; all work in connection with sewer, water, gas, gasoline, oil drainage pipe, conduit pipe, tile and duct lines and all other pipe lines; power tool operator, all work in connection with hydraulic or general dredging operations; puddlers (paving only); straw blower nozzle man; asphalt plant platform man; chuck tender; crusher feeder; men handling creosote ties or creosote materials; men working with and handling epoxy material or materials (where special protection is required); rubbing concrete; topper of standing trees; batter board man on pipe and ditch work; feeder man on wood pulverizers; board and willow mat weavers and cable tiers on river work; deck hands; pile dike and revetment work; all laborers working on underground tunnels less than 25 feet where compressed air is not used; abutment and pier

Jackson County Missouri - Department of Public Works - Engineering Division
ROCK ISLAND RAIL CORRIDOR SHARED USE PATH
FEDERAL PROJECT NO. STP-3453(402) - COUNTY PROJECT NO. 3221 - BID NO. 09-2018

hole men working six (6) feet or more below ground; men working in coffer dams for bridge piers and footings in the river; ditchliners; pressure groutmen; caulker; chain or concrete saw; cliffscalers working from scaffolds, bosuns' chairs or platforms on dams or power plants over (10) feet above ground; mortarmen on brick or block manholes; toxic and hazardous waste work.

GROUP 2: Skilled Laborers - Head pipe layer on sewer work; laser beam man; Jackson or any other similar tamp; cutting torch man; form setters; liners and stringline men on concrete paving, curb, gutters; hot mastic kettleman; hot tar applicator; sandblasting and gunite nozzlemen; air tool operator in tunnels; screed man on asphalt machine; asphalt raker; barco tamper; churn drills; air track drills and all similar drills; vibrator man; stringline man for electronic grade control; manhole builders-brick or block; dynamite and powder men; grade checker.

LABO0663-002 04/01/2018

CASS, CLAY, JACKSON, PLATTE AND RAY COUNTIES

	Rates	Fringes
LABORER		
GROUP 1.....	\$ 30.18	15.63
GROUP 2.....	\$ 31.39	15.63

LABORERS CLASSIFICATIONS

GROUP 1: General laborers, Carpenter tenders, salamander tenders, loading trucks under bins, hoppers and conveyors, track men and all other general laborers, air tool operator, cement handler (bulk or sack), chain or concrete saw, deck hands, dump man on earth fill, Georgie Buggies man, material batch hopper man, scale man, material mixer man (except on manholes), coffer dams, abutments and pier hole men working below ground, riprap pavers rock, black or brick, signal man, scaffolds over ten feet not self-supported from ground up, skipman on concrete paving, wire mesh setters on concrete paving, all work in connection with sewer, water, gas, gasoling, oil, drainage pipe, conduit pipe, tile and duct lines and all other pipelines, power tool operator, all work in connection with hydraulic or general dredging operations, straw blower nozzleman, asphalt plant platform man, chuck tender, crusher feeder, men handling creosote ties on creosote materials, men working with and handling epoxy material or materials (where special protection is required), topper of standing trees, batter board man on pipe and ditch work, feeder man on wood pulverizers, board and willow mat weavers and cable tiers on river work, deck hands, pile dike and revetment

Jackson County Missouri - Department of Public Works - Engineering Division
ROCK ISLAND RAIL CORRIDOR SHARED USE PATH
FEDERAL PROJECT NO. STP-3453(402) - COUNTY PROJECT NO. 3221 - BID NO. 09-2018

work, all laborers working on underground tunnels less than 25 feet where compressed air is not used, abutment and pier hole men working six (6) feet or more below ground, men working in coffer dams for bridge piers and footings in the river, ditchliners, pressure groutmen, caulker and chain or concrete saw, cliffscalers working from scaffolds, bosuns' chairs or platforms on dams or power plants over (10) feet above ground, mortarmen on brick or block manholes, signal man.

GROUP 2: Skilled Laborer - spreader or screed man on asphalt machine, asphalt raker, grade checker, vibrator man, concrete saw over 5 hp., laser beam man, barco tamper, jackson or any other similar tamp, wagon driller, churn drills, air track drills and other similar drills, cutting torch man, form setters, liners and stringline men on concrete paving, curb, gutters and etc., hot mastic kettleman, hot tar applicator, hand blade operators, mortar men on brick or block manholes, sand blasting and gunnite nozzle men, rubbing concrete, air tool operator in tunnels, head pipe layer on sewer work, manhole builder (brick or block), dynamite and powder men.

PAIN0002-002 09/01/2007

CLARK, FRANKLIN, JEFFERSON, LEWIS, LINCOLN, MARION, PIKE, RALLS, ST. CHARLES, ST. LOUIS (CITY & COUNTY), AND WARREN COUNTIES

	Rates	Fringes
Painters:		
Brush and Roller; Taper.....	\$ 28.61	10.24
High work over 60 feet.....	\$ 29.11	10.24
Lead Abatement.....	\$ 29.36	10.24
Pressure Roller; High work under 60 ft.....	\$ 28.86	10.24
Spray & Abrasive Blasting; Water Blasting (Over 5000 PSI).....	\$ 30.61	10.24
Taper (Ames Tools & Bazooka).....	\$ 30.21	10.24

PAIN0002-006 04/01/2018

ADAIR, AUDRAIN, BOONE, CALLAWAY, CHARITON, COLE, GASCONADE, HOWARD, KNOX, LINN, MACON, MONROE, MONTGOMERY, OSAGE, PUTNAM, RANDOLPH, SCHUYLER, SCOTLAND, SHELBY AND SULLIVAN COUNTIES and the City of Booneville.

	Rates	Fringes
--	-------	---------

Jackson County Missouri - Department of Public Works - Engineering Division
ROCK ISLAND RAIL CORRIDOR SHARED USE PATH
FEDERAL PROJECT NO. STP-3453(402) - COUNTY PROJECT NO. 3221 - BID NO. 09-2018

Painters:

Bridges, Dams, Locks or Powerhouses.....	\$ 25.93	12.79
Brush and Roll; Taping, Paperhanging.....	\$ 23.93	12.79
Epoxy or Any Two Part Coating; Sandblasting; Stage or other Aerial Work - Platforms over 50 feet high; Lead Abatement.....	\$ 24.93	12.79
Spray; Structural Steel (over 50 feet).....	\$ 24.93	12.79
Tapers using Ames or Comparable Tools.....	\$ 24.68	12.79

PAIN0003-004 04/01/2017

CASS, CLAY, CLINTON, JACKSON, JOHNSON, LAFAYETTE, PLATTE & RAY COUNTIES

Rates	Fringes
-------	---------

Painters:

Bridgeman; Lead Abatement; Sandblast; Storage Bin & Tanks.....	\$ 31.96	16.96
Brush & Roller.....	\$ 29.34	16.96
Drywall.....	\$ 30.34	16.96
Paper Hanger.....	\$ 29.84	16.96
Stageman; Beltman; Steelman; Elevator Shaft; Bazooka, Boxes and Power Sander; Sprayman; Dipping...	\$ 30.96	16.96
Steeplejack.....	\$ 35.53	16.96

PAIN0003-011 04/01/2011

BATES, BENTON, CALDWELL, CARROLL, COOPER, DAVIESS, GRUNDY, HARRISON, HENRY, LIVINGSTON, MERCER, MONITEAU, MORGAN, PETTIS & SALINE COUNTIES

Rates	Fringes
-------	---------

Painters:

Bridgeman; Lead Abatement; Sandblast; Storage Bin & Tanks.....	\$ 24.06	14.04
Brush & Roller.....	\$ 22.67	14.04
Drywall.....	\$ 22.84	14.04
Paper Hanger.....	\$ 23.07	14.04
Stageman; Beltman;		

Jackson County Missouri - Department of Public Works - Engineering Division
ROCK ISLAND RAIL CORRIDOR SHARED USE PATH
FEDERAL PROJECT NO. STP-3453(402) - COUNTY PROJECT NO. 3221 - BID NO. 09-2018

Steelman; Elevator Shaft;		
Bazooka, Boxes and Power		
Sander; Sprayman; Dipping...	\$ 23.56	14.04
Steeplejack.....	\$ 26.82	14.04

PAIN0203-001 04/01/2012

BARRY, BARTON, CEDAR, CHRISTIAN, DADE, DALLAS, DOUGLAS, GREENE,
HICKORY, HOWELL, JASPER, LAWRENCE, MCDONALD, NEWTON, OZARK,
POLK, ST. CLAIR, STONE, TANEY, VERNON, WEBSTER, and WRIGHT
COUNTIES

	Rates	Fringes
Painters:		
Finisher.....	\$ 20.18	11.33
Painter.....	\$ 19.75	11.76
Sandblaster, High Man, Spray Man, Vinyl Hanger, Tool Operator.....	\$ 21.18	11.33

PAIN1265-003 07/01/2013

CAMDEN, CRAWFORD, DENT, LACLEDE, MARIES, MILLER, PHELPS,
PULASKI AND TEXAS COUNTIES

	Rates	Fringes
Painters:		
Brush and Roller.....	\$ 25.64	13.27
Floor Work.....	\$ 26.14	13.27
Lead Abatement.....	\$ 27.89	13.27
Spray.....	\$ 27.14	13.27
Structural Steel, Sandblasting and All Tank Work.....	\$ 26.89	13.27
Taping, Paperhanging.....	\$ 26.64	13.27

PAIN1292-002 09/01/2016

BOLLINGER, BUTLER, CAPE GIRARDEAU, CARTER, DUNKLIN,
MISSISSIPPI, NEW MADRID, OREGON, PEMISCOT, PERRY, REYNOLDS,
RIPLEY, SCOTT, SHANNON, STODDARD and WAYNE COUNTIES

	Rates	Fringes
Painters:		
Bridges, Stacks & Tanks.....	\$ 30.85	11.64
Brush & Roller.....	\$ 25.35	11.64
Spray & Abrasive Blasting; Waterblasting (over 5000		

Jackson County Missouri - Department of Public Works - Engineering Division
ROCK ISLAND RAIL CORRIDOR SHARED USE PATH
FEDERAL PROJECT NO. STP-3453(402) - COUNTY PROJECT NO. 3221 - BID NO. 09-2018

PSI).....\$ 28.95 11.64

Height Rates (All Areas):
Over 60 ft. \$0.50 per hour.
Under 60 ft. \$0.25 per hour.

PAIN1292-003 09/01/2017

IRON, MADISON, ST. FRANCOIS, STE. GENEVIEVE and WASHINGTON
COUNTIES

	Rates	Fringes
Painters:		
Bridges, Stacks & Tanks.....	\$ 31.05	12.74
Brush & Roller.....	\$ 25.70	12.74
Spray & Abrasive Blasting; Waterblasting (Over 5000 PSI).....	\$ 28.70	12.74

Height Rates (All Areas):
Over 60 ft. \$0.50 per hour
Under 60 ft. \$0.25 per hour.

PAIN2012-001 04/01/2017

ANDREW, ATCHISON, BUCHANAN, DE KALB, GENTRY, HOLT, NODAWAY &
WORTH COUNTIES

	Rates	Fringes
Painters:		
Brush & Roller.....	\$ 30.46	16.96
Sandblaster.....	\$ 31.96	16.96
Steeplejack.....	\$ 35.53	16.96

PLAS0518-006 03/01/2018

BARRY, BARTON, CEDAR, CHRISTIAN, DADE, DALLAS, DOUGLAS, GREENE,
HICKORY, JASPER, LACLEDE, LAWRENCE, MCDONALD, NEWTON, OZARK,
POLK, ST. CLAIR, STONE, TANEY, VERNON, WEBSTER, AND WRIGHT
COUNTIES

	Rates	Fringes
CEMENT MASON/CONCRETE FINISHER...	\$ 24.24	11.05

PLAS0518-007 04/01/2018

Jackson County Missouri - Department of Public Works - Engineering Division
ROCK ISLAND RAIL CORRIDOR SHARED USE PATH
FEDERAL PROJECT NO. STP-3453(402) - COUNTY PROJECT NO. 3221 - BID NO. 09-2018

CASS (Richards-Gebaur AFB only), CLAY, JACKSON, PLATTE AND RAY
COUNTIES

	Rates	Fringes
Cement Masons:.....	\$ 31.83	17.39

PLAS0518-011 04/01/2018

ANDREW, ATCHISON, BATES, BUCHANNAN, CLINTON, DEKALB, GENTRY,
HENRY, HOLT, JOHNSON, LAFAYETTE, NODAWAY & WORTH COUNTIES

	Rates	Fringes
CEMENT MASON/CONCRETE FINISHER...	\$ 31.71	19.62

PLAS0527-001 04/01/2018

	Rates	Fringes
CEMENT MASON FRANKLIN, LINCOLN AND WARREN COUNTIES.....	\$ 30.74	18.07
JEFFERSON, ST. CHARLES COUNTIES AND ST. LOUIS (City and County).....	\$ 32.66	18.62

PLAS0527-004 06/01/2017

CRAWFORD, DENT, IRON, MADISON, MARION, PHELPS, PIKE, PULASKI,
RALLS, REYNOLDS, ST. FRANCOIS, STE. GENEVIEVE, SHANNON, TEXAS,
WASHINGTON COUNTIES

	Rates	Fringes
CEMENT MASON.....	\$ 28.10	18.07

PLAS0908-001 05/01/2017

BOLLINGER, BUTLER, CAPE GIRARDEAU, CARTER, DUNKLIN, HOWELL,
MISSISSIPPI, NEW MADRID, OREGON, PEMISCOT, PERRY, RIPLEY,
SCOTT, STODDARD, AND WAYNE COUNTIES

	Rates	Fringes
CEMENT MASON.....	\$ 27.60	15.73

PLAS0908-005 05/01/2017

BENTON, CALDWELL, CALLAWAY, CAMDEN, CARROLL, COLE, DAVIESS,

Jackson County Missouri - Department of Public Works - Engineering Division
ROCK ISLAND RAIL CORRIDOR SHARED USE PATH
FEDERAL PROJECT NO. STP-3453(402) - COUNTY PROJECT NO. 3221 - BID NO. 09-2018

GASCONADE, GRUNDY, HARRISON, LIVINGSTON, MACON, MARIES, MERCER,
MILLER, MONTGOMERY, MORGAN, OSAGE, PETTIS & SALINE COUNTIES

	Rates	Fringes
CEMENT MASON.....	\$ 27.60	15.73

PLUM0008-003 06/01/2018

CASS, CLAY, JACKSON, JOHNSON, AND PLATTE COUNTIES

	Rates	Fringes
Plumbers.....	\$ 45.34	21.39

PLUM0008-017 06/01/2018

BATES, BENTON, CARROLL, HENRY, LAFAYETTE, MORGAN, PETTIS, RAY,
ST. CLAIR, SALINE AND VERNON COUNTIES

	Rates	Fringes
Plumbers.....	\$ 45.34	21.39

PLUM0045-003 09/01/2018

ANDREW, ATCHISON, BUCHANAN, CALDWELL, CLINTON, DAVIESS, DEKALB,
GENTRY, HARRISON, HOLT, NODAWAY AND WORTH COUNTIES

	Rates	Fringes
Plumbers and Pipefitters.....	\$ 36.40	23.00

PLUM0178-003 11/01/2018

BARRY, CEDAR, CHRISTIAN, DADE, DALLAS, DOUGLAS, GREENE,
HICKORY, LACLEDE, LAWRENCE, POLK, STONE, TANEY, WEBSTER AND
WRIGHT COUNTIES

	Rates	Fringes
Plumbers and Pipefitters.....	\$ 30.90	15.35

PLUM0178-006 11/01/2018

BARTON, JASPER, MCDONALD AND NEWTON COUNTIES

	Rates	Fringes
Plumbers and Pipefitters		

Jackson County Missouri - Department of Public Works - Engineering Division
ROCK ISLAND RAIL CORRIDOR SHARED USE PATH
FEDERAL PROJECT NO. STP-3453(402) - COUNTY PROJECT NO. 3221 - BID NO. 09-2018

Projects \$750,000 & under...\$ 27.93	15.35
Projects over \$750,000.....\$ 30.90	15.35

 PLUM0533-004 06/01/2018

BATES, BENTON, CARROLL, CASS, CLAY, HENRY, HICKORY, JACKSON,
 JOHNSON, LAFAYETTE, MORGAN, PETTIS, PLATTE, RAY, SALINE, ST.
 CLAIR AND VERNON COUNTIES

	Rates	Fringes
Pipefitters.....\$ 46.28		21.15

 PLUM0562-004 07/01/2018

ADAIR, AUDRAIN, BOLLINGER, BOONE, BUTLER, CALLAWAY, CAMDEN, CAPE
 GIRARDEAU, CARTER, CHARITON, CLARK, COLE, COOPER, CRAWFORD,
 DENT, DUNKLIN, FRANKLIN, GASCONADE, GRUNDY, HOWARD, HOWELL,
 IRON, JEFFERSON, KNOX, LEWIS, LINCOLN, LINN, LIVINGSTON, MACON,
 MADISON, MARIES, MARION, MERCER, MILLER, MISSISSIPPI, MONITEAU,
 MONROE, MONTGOMERY, NEW MADRID, OREGON, OSAGE, PEMISCOTT,
 PERRY, PHELPS, PIKE, PULASKI, PUTNAM, RALLS, RANDOLPH,
 REYNOLDS, RIPLEY, ST. CHARLES, ST. FRANCOIS, STE. GENEVIEVE, ST.
 LOUIS, SCHUYLER, SCOTLAND, SCOTT, SHANNON, SHELBY, STODDARD,
 SULLIVAN, TEXAS, WARREN, WASHINGTON, AND WAYNE COUNTIES.

	Rates	Fringes
Plumbers and Pipefitters		
Mechanical Contracts		
including all piping and		
temperature control work		
\$7.0 million & under.....\$ 38.91		22.09
Mechanical Contracts		
including all piping and		
temperature control work		
over \$7.0 million.....\$ 40.25		27.68

 PLUM0562-016 07/01/2018

CAMDEN, COLE, CRAWFORD, FRANKLIN, JEFFERSON, MARIES, MILLER,
 MONITEAU, OSAGE, PHELPS, PULASKI, ST. CHARLES, ST. LOUIS (City
 and County), WARREN and WASHINGTON COUNTIES

	Rates	Fringes
Plumbers		
Mechanical Contracts		
including all piping and		
temperature control work		
\$7.0 million & under.....\$ 38.91		22.09

Jackson County Missouri - Department of Public Works - Engineering Division
ROCK ISLAND RAIL CORRIDOR SHARED USE PATH
FEDERAL PROJECT NO. STP-3453(402) - COUNTY PROJECT NO. 3221 - BID NO. 09-2018

Mechanical Contracts
including all piping and
temperature control work
over \$7.0 million.....\$ 40.25 27.68

TEAM0013-001 05/01/2017

	Rates	Fringes
Truck drivers (ADAIR, BUTLER, CLARK, DUNKIN, HOWELL, KNOX, LEWIS, OREGON, PUTNAM, RIPLEY, SCHUYLER AND SCOTLAND COUNTIES)		
GROUP 1.....	\$ 28.54	12.00
GROUP 2.....	\$ 28.44	12.00
GROUP 3.....	\$ 28.69	12.00
GROUP 4.....	\$ 28.81	12.00
Truck drivers (AUDRAIN, BOLLINGER, BOONE, CALLAWAY, CAPE GIRARDEAU, CARTER, COLE, CRAWFORD, DENT, GASCONADE, IRON, MACON, MADISON, MARIES, MARION, MILLER, MISSISSIPPI, MONROE, MONTGOMERY, NEW MADRID, OSAGE, PEMISCOT, PERRY, PHELPS, PIKE, PULASKI, RALLS, REYNOLDS, ST. FRANCOIS, STE. GENEVIEVE, SCOTT, SHANNON, SHELBY, STODDARD, TEXAS, WASHINGTON AND WAYNE COUNTIES)		
GROUP 1.....	\$ 29.14	12.85
GROUP 2.....	\$ 29.04	12.85
GROUP 3.....	\$ 29.29	12.85
GROUP 4.....	\$ 29.41	12.85
Truck drivers (FRANKLIN, JEFFERSON and ST. CHARLES COUNTIES)		
GROUP 1.....	\$ 31.63	12.00
GROUP 2.....	\$ 31.74	12.00
GROUP 3.....	\$ 31.74	12.00
GROUP 4.....	\$ 31.85	12.00
Truck drivers (LINCOLN and WARREN COUNTIES)		
GROUP 1.....	\$ 30.28	12.00
GROUP 2.....	\$ 30.39	12.00
GROUP 3.....	\$ 31.43	12.00
GROUP 4.....	\$ 30.50	12.00

TRUCK DRIVERS CLASSIFICATIONS:

GROUP 1: Flat Bed Trucks, Single Axle; Station Wagons;
Pickup Trucks; Material Trucks, Single Axle; Tank Wagon,

Jackson County Missouri - Department of Public Works - Engineering Division
ROCK ISLAND RAIL CORRIDOR SHARED USE PATH
FEDERAL PROJECT NO. STP-3453(402) - COUNTY PROJECT NO. 3221 - BID NO. 09-2018

Single Axle

GROUP 2: Agitator and Transit Mix Trucks

GROUP 3: Flat Bed Trucks, Tandem Axle; Articulated Dump Trucks; Material Trucks, Tandem Axle; Tank Wagon, Tandem Axle

GROUP 4: Semi and/or Pole Trailers; Winch, Fork & Steel Trucks; Distributor Drivers and Operators; Tank Wagon, Semi-Trailer; Insley Wagons, Dumpsters, Half-Tracks, Speedace, Euclids and other similar equipment; A-Frame and Derrick Trucks; Float or Low Boy

TEAM0056-001 05/01/2017

	Rates	Fringes
Truck drivers (ANDREW, BARTON, BATES, BENTON, CALDWELL, CAMDEN, CARROLL, CEDAR, CHARITON, CHRISTIAN, CLINTON, COOPER, DADE, DALLAS, DAVIESS, DEKALB, DOUGLAS, GREENE, HENRY, HICKORY, HOWARD, JASPER, LACLEDE, LAWRENCE, LINN, LIVINGSTON, MONITEAU, MORGAN, NEWTON, PETTIS, POLK, RANDOLPH, ST. CLAIR, SALINE, VERNON, WEBSTER AND WRIGHT COUNTIES)		
GROUP 1.....	\$ 29.57	12.85
GROUP 2.....	\$ 29.73	12.85
GROUP 3.....	\$ 29.72	12.85
GROUP 4.....	\$ 29.84	12.85
Truck drivers: (ATCHISON, BARRY, GENTRY, GRUNDY, HARRISON, HOLT, MCDONALD, MERCER, NODAWAY, OZARK, STONE, SULLIVAN, TANEY AND WORTH COUNTIES)		
GROUP 1.....	\$ 28.84	12.85
GROUP 2.....	\$ 29.00	12.85
GROUP 3.....	\$ 28.99	12.85
GROUP 4.....	\$ 29.11	12.85
Truck drivers; (BUCHANAN, JOHNSON AND LAFAYETTE COUNTIES)		
GROUP 1.....	\$ 30.78	12.85
GROUP 2.....	\$ 30.89	12.85
GROUP 3.....	\$ 30.93	12.85
GROUP 4.....	\$ 31.00	12.85

Jackson County Missouri - Department of Public Works - Engineering Division
ROCK ISLAND RAIL CORRIDOR SHARED USE PATH
FEDERAL PROJECT NO. STP-3453(402) - COUNTY PROJECT NO. 3221 - BID NO. 09-2018

TRUCK DRIVER CLASSIFICATIONS

GROUP 1: Flat bed trucks single axle; station wagons; pickup trucks; material trucks single axle; tank wagons single axle.

GROUP 2: Agitator and transit mix-trucks.

GROUP 3: Flat bed trucks tandem axle; articulated dump trucks; material trucks tandem axle; tank wagons tandem axle.

GROUP 4: Semi and/or pole trailers; winch, fork & steel trucks; distributor drivers & operators; tank wagons semi-trailer; insley wagons, dumpsters, half-tracks, speedace, euclids & other similar equipment; A-frames and derrick trucks; float or low boy.

TEAM0245-001 03/26/2012

BARRY, BARTON, CAMDEN, CEDAR, CHRISTIAN, DALLAS, DENT, DOUGLAS, GREENE, HICKORY, HOWELL, JASPER, LACLEDE, LAWRENCE, MCDONALD, MILLER, NEWTON, OZARK, PHELPS, POLK, PULASKI, SHANNON, STONE, TANEY, TEXAS, VERNON, WEBSTER AND WRIGHT COUNTIES

	Rates	Fringes
--	-------	---------

Truck drivers:

Traffic Control Service		
Driver.....	\$ 20.45	0.00

PAID HOLIDAYS: New Year's Day, Decoration Day, July 4th, Labor Day, Thanksgiving Day, Christmas Day, employee's birthday and 2 personal days.

TEAM0541-001 04/01/2018

CASS, CLAY, JACKSON, PLATTE AND RAY COUNTIES

	Rates	Fringes
--	-------	---------

Truck drivers:

GROUP 1.....	\$ 32.66	15.25
GROUP 2.....	\$ 32.09	15.25
GROUP 3.....	\$ 31.57	15.25

TRUCK DRIVERS CLASSIFICATIONS

GROUP 1: Mechanics and Welders, Field; A-Frame Low Boy-Boomer Driver.

Jackson County Missouri - Department of Public Works - Engineering Division
ROCK ISLAND RAIL CORRIDOR SHARED USE PATH
FEDERAL PROJECT NO. STP-3453(402) - COUNTY PROJECT NO. 3221 - BID NO. 09-2018

GROUP 2: Articulated Dump Truck; Insley Wagons; Dump Trucks, Excavating, 5 cu yds and over; Dumpsters; Half-Tracks: Speedace; Euclids & similar excavating equipment Material trucks, Tandem Two teams; Semi-Trailers; Winch trucks-Fork trucks; Distributor Drivers and Operators; Agitator and Transit Mix; Tank Wagon Drivers, Tandem or Semi; One Team; Station Wagons; Pickup Trucks; Material Trucks, Single Axle; Tank Wagon Drivers, Single Axle

GROUP 3: Oilers and Greasers - Field

TEAM0682-002 05/01/2017

ST LOUIS CITY AND COUNTY

	Rates	Fringes
Truck drivers:		
GROUP 1.....	\$ 33.30	13.79+a+b+c+d
GROUP 2.....	\$ 33.50	13.79+a+b+c+d
GROUP 3.....	\$ 33.60	13.79+a+b+c+d

a. PENSION: 5/1/2012 - \$182.20 per week.

b. HAZMAT PREMIUM: If Hazmat certification on a job site is required by a state or federal agency or requested by project owner or by the employer, employees on that job site shall receive \$1.50 premium pay.

TRUCK DRIVERS CLASSIFICATIONS

GROUP 1 - Pick-up trucks; forklift, single axle; flatbed trucks; job site ambulance, and trucks or trailers of a water level capacity of 11.99 cu. yds. or less

GROUP 2 - Trucks or trailers of a water level capacity of 12.0 cu yds. up to 22.0 cu yds. including euclids, speedace and similar equipment of same capacity and compressors

GROUP 3 - Trucks or trailers of a water level capacity of 22.0 cu. yds & over including euclids, speedace & all floats, flatbed trailers, boom trucks, winch trucks, including small trailers, farm wagons tilt-top trailers, field offices, tool trailers, concrete pumps, concrete conveyors & gasoline tank trailers and truck mounted mobile concrete mixers

FOOTNOTE FOR TRUCK DRIVERS:

c. PAID HOLIDAYS: Christmas Day, Independence Day, Labor Day, Memorial Day, Veterans Day, New Years Day, Thanksgiving Day

Jackson County Missouri - Department of Public Works - Engineering Division
ROCK ISLAND RAIL CORRIDOR SHARED USE PATH
FEDERAL PROJECT NO. STP-3453(402) - COUNTY PROJECT NO. 3221 - BID NO. 09-2018

d. PAID VACATION: 3 days paid vacation for 600 hours of service in any one contract year; 4 days paid vacation for 800 hours of service in any one contract year; 5 days paid vacation for 1,000 hours of service in any one contract year. When such an employee has completed 3 years of continuous employment with the same employer and then works the above required number of hours, he shall receive double the number of days of vacation specified above. When such an employee has completed 10 years of continuous employment with the same employer and then works the above required number of hours, he shall receive triple the number of days of vacation specified above. When such an employee has completed 15 years of continuous employment with the same employer and then works the above required number of hours, he shall receive 4 times the number of days of vacation specified above.

WELDERS - Receive rate prescribed for craft performing operation to which welding is incidental.

=====

Note: Executive Order (EO) 13706, Establishing Paid Sick Leave for Federal Contractors applies to all contracts subject to the Davis-Bacon Act for which the contract is awarded (and any solicitation was issued) on or after January 1, 2017. If this contract is covered by the EO, the contractor must provide employees with 1 hour of paid sick leave for every 30 hours they work, up to 56 hours of paid sick leave each year. Employees must be permitted to use paid sick leave for their own illness, injury or other health-related needs, including preventive care; to assist a family member (or person who is like family to the employee) who is ill, injured, or has other health-related needs, including preventive care; or for reasons resulting from, or to assist a family member (or person who is like family to the employee) who is a victim of, domestic violence, sexual assault, or stalking. Additional information on contractor requirements and worker protections under the EO is available at www.dol.gov/whd/govcontracts.

Unlisted classifications needed for work not included within the scope of the classifications listed may be added after award only as provided in the labor standards contract clauses (29CFR 5.5 (a) (1) (ii)).

The body of each wage determination lists the classification and wage rates that have been found to be prevailing for the

Jackson County Missouri - Department of Public Works - Engineering Division
ROCK ISLAND RAIL CORRIDOR SHARED USE PATH
FEDERAL PROJECT NO. STP-3453(402) - COUNTY PROJECT NO. 3221 - BID NO. 09-2018

cited type(s) of construction in the area covered by the wage determination. The classifications are listed in alphabetical order of "identifiers" that indicate whether the particular rate is a union rate (current union negotiated rate for local), a survey rate (weighted average rate) or a union average rate (weighted union average rate).

Union Rate Identifiers

A four letter classification abbreviation identifier enclosed in dotted lines beginning with characters other than "SU" or "UAVG" denotes that the union classification and rate were prevailing for that classification in the survey. Example: PLUM0198-005 07/01/2014. PLUM is an abbreviation identifier of the union which prevailed in the survey for this classification, which in this example would be Plumbers. 0198 indicates the local union number or district council number where applicable, i.e., Plumbers Local 0198. The next number, 005 in the example, is an internal number used in processing the wage determination. 07/01/2014 is the effective date of the most current negotiated rate, which in this example is July 1, 2014.

Union prevailing wage rates are updated to reflect all rate changes in the collective bargaining agreement (CBA) governing this classification and rate.

Survey Rate Identifiers

Classifications listed under the "SU" identifier indicate that no one rate prevailed for this classification in the survey and the published rate is derived by computing a weighted average rate based on all the rates reported in the survey for that classification. As this weighted average rate includes all rates reported in the survey, it may include both union and non-union rates. Example: SULA2012-007 5/13/2014. SU indicates the rates are survey rates based on a weighted average calculation of rates and are not majority rates. LA indicates the State of Louisiana. 2012 is the year of survey on which these classifications and rates are based. The next number, 007 in the example, is an internal number used in producing the wage determination. 5/13/2014 indicates the survey completion date for the classifications and rates under that identifier.

Survey wage rates are not updated and remain in effect until a new survey is conducted.

Union Average Rate Identifiers

Classification(s) listed under the UAVG identifier indicate that no single majority rate prevailed for those classifications; however, 100% of the data reported for the classifications was union data. EXAMPLE: UAVG-OH-0010 08/29/2014. UAVG indicates that the rate is a weighted union

Jackson County Missouri - Department of Public Works - Engineering Division
ROCK ISLAND RAIL CORRIDOR SHARED USE PATH
FEDERAL PROJECT NO. STP-3453(402) - COUNTY PROJECT NO. 3221 - BID NO. 09-2018

average rate. OH indicates the state. The next number, 0010 in the example, is an internal number used in producing the wage determination. 08/29/2014 indicates the survey completion date for the classifications and rates under that identifier.

A UAVG rate will be updated once a year, usually in January of each year, to reflect a weighted average of the current negotiated/CBA rate of the union locals from which the rate is based.

WAGE DETERMINATION APPEALS PROCESS

1.) Has there been an initial decision in the matter? This can be:

- * an existing published wage determination
- * a survey underlying a wage determination
- * a Wage and Hour Division letter setting forth a position on a wage determination matter
- * a conformance (additional classification and rate) ruling

On survey related matters, initial contact, including requests for summaries of surveys, should be with the Wage and Hour Regional Office for the area in which the survey was conducted because those Regional Offices have responsibility for the Davis-Bacon survey program. If the response from this initial contact is not satisfactory, then the process described in 2.) and 3.) should be followed.

With regard to any other matter not yet ripe for the formal process described here, initial contact should be with the Branch of Construction Wage Determinations. Write to:

Branch of Construction Wage Determinations
Wage and Hour Division
U.S. Department of Labor
200 Constitution Avenue, N.W.
Washington, DC 20210

2.) If the answer to the question in 1.) is yes, then an interested party (those affected by the action) can request review and reconsideration from the Wage and Hour Administrator (See 29 CFR Part 1.8 and 29 CFR Part 7). Write to:

Wage and Hour Administrator
U.S. Department of Labor
200 Constitution Avenue, N.W.
Washington, DC 20210

The request should be accompanied by a full statement of the

Jackson County Missouri - Department of Public Works - Engineering Division
ROCK ISLAND RAIL CORRIDOR SHARED USE PATH
FEDERAL PROJECT NO. STP-3453(402) - COUNTY PROJECT NO. 3221 - BID NO. 09-2018

interested party's position and by any information (wage payment data, project description, area practice material, etc.) that the requestor considers relevant to the issue.

3.) If the decision of the Administrator is not favorable, an interested party may appeal directly to the Administrative Review Board (formerly the Wage Appeals Board). Write to:

Administrative Review Board
U.S. Department of Labor
200 Constitution Avenue, N.W.
Washington, DC 20210

4.) All decisions by the Administrative Review Board are final.

=====

END OF GENERAL DECISION

END OF ADDENDUM

Missouri Department of Transportation

600 Northeast Colbern Rd.
Lee's Summit, Missouri 64086
816.622.6500
Fax: 816.622.6550
1.888.ASK MODOT (275.6636)

12/3/2018

Mr. Matt Davis
Project Coordinator
Jackson County
415 E 12th Street
Kansas City, MO 64106

Re: STP-3454 (402) Rock Island Shared Use Path Phase 2

Dear Mr. Davis:

We have completed our review of the P.S. & E. Plans and Documents previously submitted for this project.

The P. S. & E. submittal is now approved and the County is authorized to advertise for bids.

The Missouri Department of Transportation (MoDOT) does not accept responsibility for any Design errors or omissions by the LPA or Engineer of Record in the review of these plans. MoDOT will not participate in any costs associated with Design errors or omissions made by the LPA or Engineer of Record. It is the responsibility of the LPA or the Engineer of Record to correct, at their own cost, any errors or omissions determined at any time following this plan review process.

The Disadvantaged Business Enterprise (DBE) goal has been established at **12%** (twelve percent). All DBE's to be used on this project must be certified and contained in the MRCC DBE Directory at time of bid opening.

After bids are received, the "DBE Submittal Forms", must be included in the contract proposal, completed by the contractor and submitted with the city's bid tab submittal. Each line item, percentage and dollar amount must be shown for each DBE sub-contractor. **Without the DBE form completely filled-out and returned, MoDOT will not grant concurrence and the bidder will be considered non-responsive.**

Please remember all contractors must be on MoDOT's approved contractor listing unless otherwise stipulated in the contract. If the city elects to stipulate otherwise, the following sentence must be inserted into the contract proposal:

"Section 102.2 of the Missouri Standards Specifications for Highway
Construction will be waived for this project."

This statement should only be used on proposed improvements which do not contain roadway or bridge construction (ie, landscaping, sidewalks, bicycle paths, etc.), and should be placed in the advertisement.



*Our mission is to provide a world-class transportation experience that
delights our customers and promotes a prosperous Missouri.*

www.modot.org

The latest Federal Wage Rates will only be required for projects that are located on roadways functionally classified as major collectors or above. If the project is on a local road or a rural minor collector, the Federal Wage Rates will not be required.

If a contract calls for "Embankment in Place" using contractor furnished borrow, the borrow acquisition requires full environmental clearance before excavation can begin. Refer to Section 136.6, "Environmental and Cultural Requirements" of the MoDOT engineering policy guide.

All necessary utility adjustments will need to be addressed, underway, and/or completed prior to construction.

Any addendums added to the proposals after P.S. & E. approval must be submitted to MoDOT for our review and/or approval.

Please note that this project must be advertised on the MoDOT website for 21 days. Please send us a copy of the advertisement once prepared and we will coordinate the advertisement on the MoDOT website with your own advertisement.

Once the bids have been received you will be working directly with MoDOT Central Office personnel to receive concurrence in award. **Your formal request for concurrence in award must be submitted electronically by email to LPASubmit@modot.mo.gov.** Please be sure to copy me on all correspondence with Central Office. My address is: Eva.Steinman@modot.mo.gov

To summarize what data must be submitted to MoDOT Central Office before concurrence can be given. Once the city receives the bids and the low bid contractor is selected, please submit one copy of the following documents:

1. Cover letter including the low bid contractor recommended and the amount of the low bid.
2. A spreadsheet listing each bid item, unit costs and item totals for each contractor's bid and the engineer's estimate.
3. The low and 2nd low bidders' Bid Form/Contract signed with visible seal.
4. The low and 2nd low bidders' bid sheets, to include each item, item cost, and totals.
5. The low and 2nd low bidders' Bid Bond. Bid Bonds must include Power of Attorney.
6. The low and 2nd low bidders' fully executed DBE submittal forms. Must be received by LPA within three (3) business days of bid opening if not included within original packet.
7. The low and 2nd low bidders' fully executed Anti-Collusion Statement.
8. The low and 2nd low bidders' Sub Contractor Certification regarding Affirmative Action

9. E-Verify Affidavit of Compliance with Attached Memorandum of Understanding.
10. Affidavit of publication verifying the 21 day advertisement.
11. Verification of receipt of addendums from all bidders.

If you have any questions, please contact me at (816) 607-2255.

Sincerely,

A handwritten signature in purple ink, reading "Eva Steinman". The signature is fluid and cursive, with the first name "Eva" and last name "Steinman" clearly distinguishable.

Eva Steinman
Senior Transportation Planner

Enclosure



Matt Davis
Program Coordinator

(816) 503-4849
dmdavis@jacksongov.org

ROCK ISLAND RAIL CORRIDOR AUTHORITY
415 E 12TH STREET
KANSAS CITY, MISSOURI 64106
WWW.JACKSONGOV.ORG

Gregory S. Wood
Approved 11/19/2018

DATE: November 15, 2018
TO: District Right of Way Manager
FROM: Matt Davis, Project Coordinator
SUBJECT: Right of Way Clearance Certification

Date and Type Environmental Clearance:	<u>August 28, 2018 (CE2)</u>
Entire Project or Partial Clearance:	<u>Entire Project</u>
Name of City / County / Sponsor:	<u>Jackson County</u>
Road or Project Name:	<u>Rock Island Shared Use Path Phase 2</u>
Federal Project Number:	<u>STP-3453(402)</u>
Termini of the Entire Right of Way Project:	<u>265+74.48 to 604+30.30</u>
Termini of the Portion Being Cleared:	<u>265+74.48 to 604+30.30</u>
Termini of the Construction Project:	<u>249+50.00 to 784+65.77</u>

The above referenced city/county certifies the following (all acquisitions):

We certify that all necessary right of way, easements and access rights for that portion of the subject project lying within Jackson County, Missouri, have been acquired in accordance with Titles 49 and 23 C.F.R. Legal and physical possession of **Parcel 1 (Langerock), Parcel 3 (Raytown Road Properties LLC), Parcel 4 (Cirese Real Estate Holdings), Parcel 5 (Professional Office Buildings), Parcel 6 (Raytown Chamber), Parcel 7 (Land Trust), Parcel 8 (Chaudhuri), Parcel 10 (Starforth), and Parcel 11 (Lakewood Estates HOA)** have been obtained. We request right of way clearance certification for a planned **December 15, 2018** advertisement.

Parcels 1, 3, 4, 5, 6, 7, 8, 10, and 11 have been acquired for this project. Parcels 2, 9, 12, 13, and 14 have been eliminated through re-design efforts. Tract 7 was conveyed to Jackson County, Missouri by the Jackson County Land Trust as a donation.

This project will extend the Rock Island Shared Use Path through additional trail facilities planned from Brickyard Road to the Truman Sports Complex. In the north phase of the project, Jackson County is avoiding constructing the shared use path on top of the existing rail bed; therefore, additional easements are required to build embankments, retaining walls, and pedestrian bridges necessary to achieve a minimum 25' offset from the existing rail centerline.

As mentioned above, we currently have legal and physical possession of nine (9) parcels as delineated on the approved right-of-way plans for this project. A table reflecting the type of acquisition is presented below. Steps relative to relocation advisory assistance and payments as required by 49 CFR, Part 24 were not required.

Parcel	Owner	Land	Perm. Esmt	Temp. Esmt	Relocation
1	Langerock	0 ft ²	0 ft ²	38,402 ft ²	No
3	Raytown Road	0 ft ²	4177 ft ²	1957 ft ²	No
4	Cirese Real Estate	0 ft ²		2600 ft ²	No
5	Professional Office Buildings	0 ft ²	4,177 ft ²	4,113 ft ²	No
6	Raytown Chamber	0 ft ²	1,017 ft ²	15,956 ft ²	No
7	Land Trust	4056ft ²			No
8	Chaudhuri	0 ft ²	0 ft ²	3,707 ft ²	No
10	Starforth	0 ft ²	910 ft ²	13,232 ft ²	No
11	Lakewood Estates HOA	0 ft ²	5,715 ft ²	12,227 ft ²	No

There were 9 parcels on this project that required the acquisition of right of way, easements and/or access rights.

01- LANGEROCK

~~02- ROMEO~~

03- RAYTOWN RD. PROPERTIES

04- CIRESE

05- PROFESSIONAL OFFICE BUILDINGS

06- RAYTOWN CHAMBER OF COMMERCE

07- LAND TRUST OF JACKSON COUNTY, MO

08- CHAUDHURI

~~09- D'ENTREMONT~~

10- STARFORTH

11- LAKEWOOD ESTATES HOA

~~12- MCMURRAY~~

~~13- BEAN~~

~~14- WOOD~~

(Bold: Acquired; Strikethrough: Eliminated through design process)

- There was 1 parcel acquired by free deed.
(07-LAND TRUST OF JACKSON COUNTY)
- There were 5 parcels that were appraised and subsequently voided and not acquired.
(ROMEO, D'ENTREMONT, MCMURRAY, BEAN, WOOD)
- There were 5 parcels that were deleted from the project.
(ROMEO, D'ENTREMONT, MCMURRAY, BEAN, WOOD)
- There were 0 parcels that were acquired by condemnation.
- There were 0 parcels that were acquired by MoDOT personnel.
- There were 0 parcels that were acquired by Local Public Agency personnel.
- There were 8 parcels that were acquired by Acquisition Agent(s) on the MoDOT Roster.
(LANGEROCK, RAYTOWN RD PROPERTIES, CIRESEE, PROFESSIONAL OFFICE BUILDINGS, RAYTOWN CHAMBER, CHAUDHURI, STARFORTH, LAKEWOOD HOA)
- There was \$56,200 spent in Right of Way Acquisition.

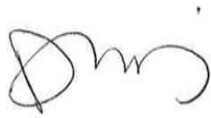

Signature of LPA

November 15, 2018

Date

D. Matt Davis



Matt Davis
Program Coordinator

(816) 503-4849
dmdavis@jacksongov.org

ROCK ISLAND RAIL CORRIDOR AUTHORITY
415 E 12TH STREET
KANSAS CITY, MISSOURI 64106
WWW.JACKSONGOV.ORG
WWW.ROCKISLANDCORRIDOR.ORG

Date: November 15, 2018

To: Ms. Eva Steinman
Transportation Planner
Missouri Department of Transportation
600 NE Colbern Road
Lee's Summit, MO 64086

SUBJECT: Federal Aid Project STP-3453 (402)
Rock Island Railroad Corridor Shared Use Path – North Segment
Jackson County, Missouri
Utility/Railroad - Letter of Certification

LETTER OF CERTIFICATION
UTILITIES "STATUS"

This project is scheduled to be let in December of 2018. The scope of work includes constructing a shared use path for cyclists and pedestrians within the Rock Island Rail Corridor right of way. The primary tasks will include clearing and grading the location of the path, constructing retaining wall, and the installation of path surface including both aggregate and concrete surfaces. Additional construction tasks include the construction of five new bridges and the rehabilitation and modification of existing bridges and drainage structures.

The utility status is as follows:

No utility relocations are anticipated prior to the construction of this project. Various utilities do exist throughout the project corridor, however; impacts to those utilities that would require relocation are not anticipated. The following activities by the **Contractor** will be completed as a part of the construction project:

- **Contractor** will complete pot-holing of existing utilities in a variety of locations to confirm no conflict will occur resulting from the construction of the project. Should pot-holing reveal a potential conflict, the Engineer shall be notified and adjustments to the design will be reviewed.
- It is anticipated that the **Contractor** will be required to work adjacent to CenturyLink / Verizon fiber optic lines. Prior to construction, the **Contractor** will pot-hole and expose the existing lines as indicated in the plans and/or directed by the **Engineer** before adjacent construction begins. The **Contractor** shall deploy protective devices approved by the **Engineer** to prevent damage to the exposed fiber optic lines. Coordination with the County, CenturyLink / Verizon, and the Engineer will be completed prior to exposing fiber optic line and prior to completing work directly adjacent to fiber optic lines.

Harry S. Truman, Presiding Judge, 1927-1934

- Existing traffic signal equipment at the intersection of 59th and Raytown Trafficway will be modified as a part of the construction of this project. The existing equipment is owned and operated by the City of Raytown, MO. The City has reviewed the project plans and concurs with the proposed modifications.

Based on the above information, utility work will not impact the shared-use path contractor's progress for this project. We recommend approval of the PS&E on this project.

**LETTER OF CERTIFICATION
RAILROAD "STATUS"**

This project will not impact any active railroad corridor. The project is located along and within the existing Rock Island Railroad Corridor previously acquired from Union Pacific Railroad by Jackson County, Missouri and the Kansas City Area Transit Authority (KCATA). Acquisition of the corridor by the County included all land and railroad rights. The County and the KCATA concur with the proposed improvements and recommend approval of the PS&E on this project.

Bid Number PW 09-2018

M:\PROJECTS\ROCK ISLAND RAILROAD (3204)_Rock Island South Segment-STP-3454(401)-3204\Bidding Process 3204\I-Pre Bid
InfoM:\SDSKPROJ\PROJECTS\ROCK ISLAND RAILROAD (3205 South & 3221 North)_Rock Island North Segment-STP-3453(402)-3221_Pre-Bid Meeting
3221\2nd Pre-Bid Bidder Attendance Sheet 3221.doc

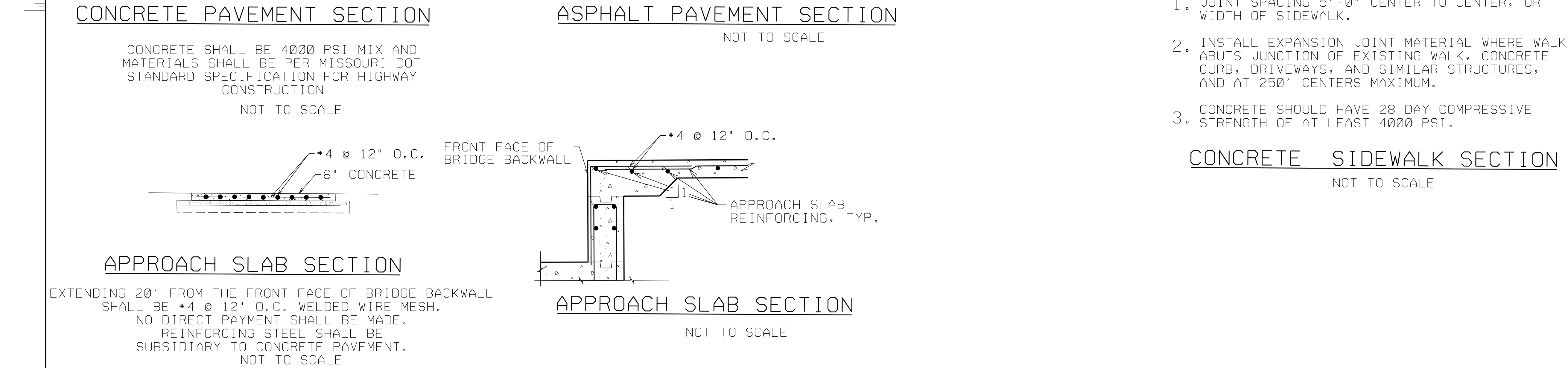
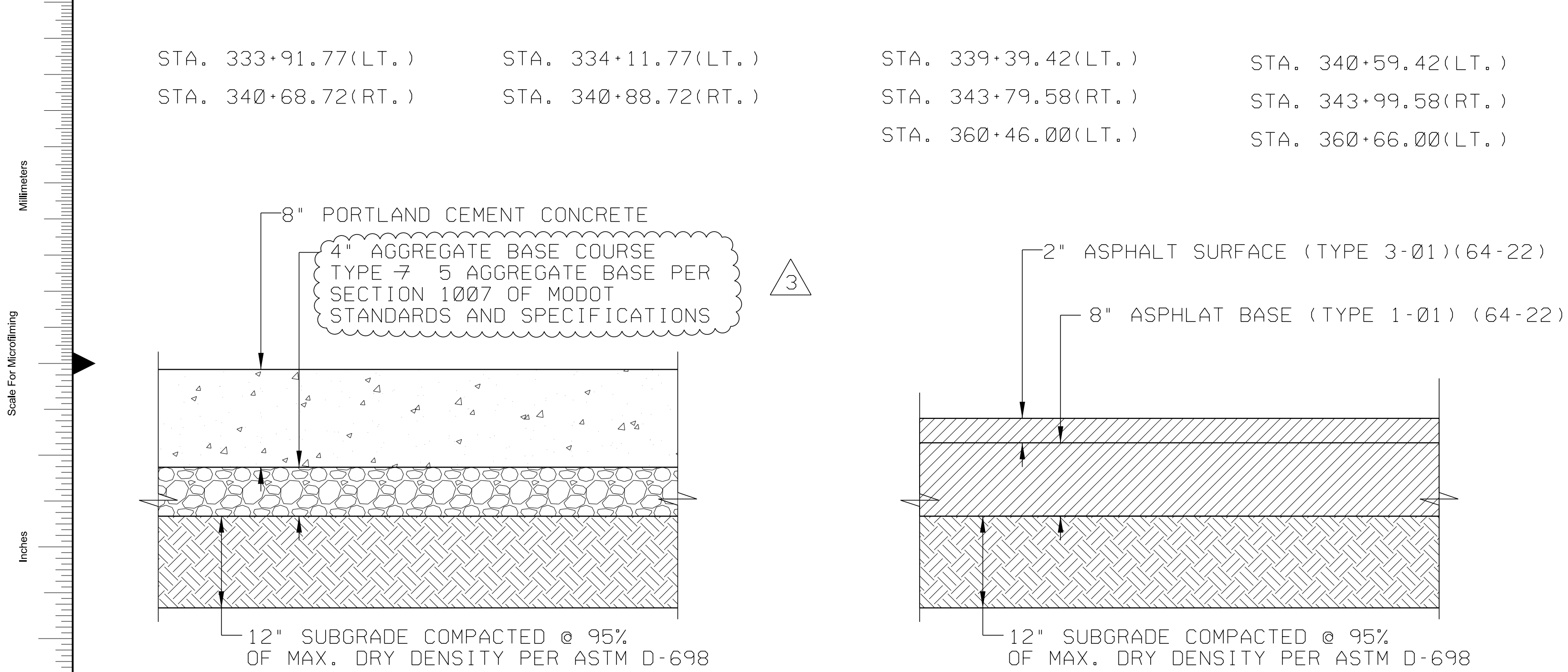
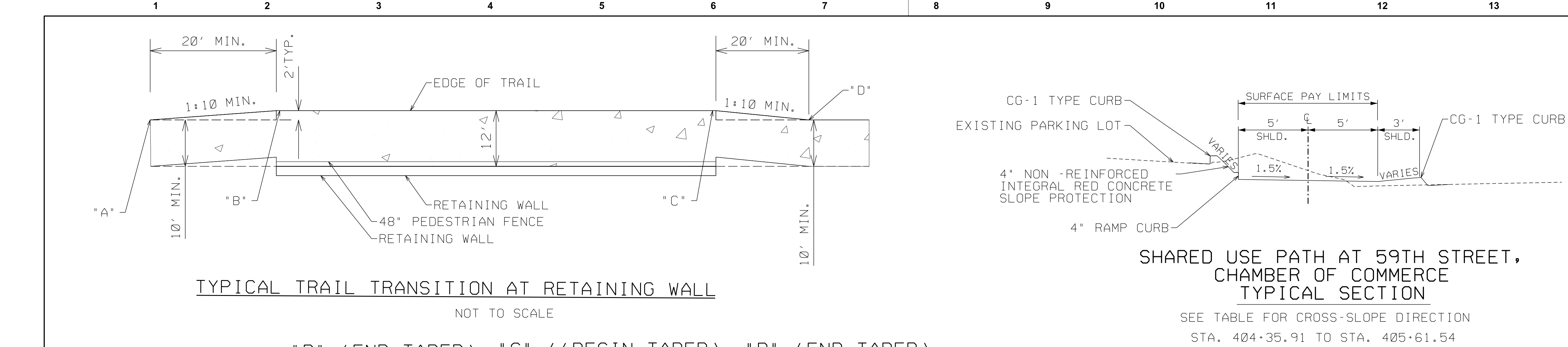

no.	date	by	ckd	description
-----	------	----	-----	-------------

date	designed	detailed	checked
1/25/2019	RS	AAM	JWZ

JACKSON COUNTY, MISSOURI
ROCK ISLAND RAIL CORRIDOR SHARED USE PATH PROJECT
TYPICAL SECTIONS

project	contract
STP 3453(402)	

drawing	rev.
	3 01/25/19

sheet	of	sheets
4	367	

file 95731-TYP20-005.dgn

Millimeters
Scale For Microfitting
Inches

DRAINAGE															
PLAN SHEET	SECTION SHEET	STA.	LOCATION	DOUBLE GRATE AREA INLET (4'X4') (EACH)	18 IN. PIPE GROUP C (L.F.)	24 IN. PIPE GROUP C (L.F.)	30 IN. PIPE GROUP C (L.F.)	60 IN. PIPE GROUP C (L.F.)	8" FLARED END SECTION GROUP C (EACH)	18" FLARED END SECTION GROUP C (EACH)	24" FLARED END SECTION GROUP C (EACH)	30" FLARED END SECTION GROUP C (EACH)	60" FLARED END SECTION GROUP C (EACH)	METAL GRATE (10 FT. x 2.5 FT.) (EACH)	ROCK LINING (CUYD)
30	-	352+51.00	RT												7.00
31	179	369+50.31	CL		27.00					2.00					2.00
32	179	405+33.80	CL	1.00	134.00										
32	179	405+81.44	CL					78.00					1.00		
32	179	411+85.33	CL			24.00					1.00				1,327.00
33	-	425+61.60	LT												7.00
34	-	431+66.57	LT												7.00
35	180	444+68.46	CL				140.00					1.00			4.00
131	-	448+50.00	LT											1.00	
35	180	451+11.99	CL		13.00					2.00					2.00
37	-	501+00.00	RT						1.00						
39	-	531+57.80	RT												6.00
42	179	565+05.00	CL		11.00					2.00					2.00
			TOTALS	1	185	24	140	78	1	6	1	1	1	1	1,364

PAVEMENT MARKING									
SHEET	EXIST. PAVEMENT MARKINGS REMOVAL (L.F.)	4 IN. WHITE PREFORMED THERMOPLASTIC PAVEMENT MARKING (L.F.)	4 IN. YELLOW PREFORMED THERMOPLASTIC PAVEMENT MARKING (L.F.)	12 IN. WHITE PREFORMED THERMOPLASTIC PAVEMENT MARKING (L.F.)	24 IN. WHITE PREFORMED THERMOPLASTIC PAVEMENT MARKING (L.F.)	GREEN BIKE LANE PAVEMENT MARKING PAINT (S.F.)	LEFT TURN ARROW (EACH)	"SHARROW" PAVEMENT MARKING (EACH)	PAVEMENT MARKING SYMBOL, TYPE 2 TAPE (ADA) (EACH)
29				40.00		60.00			
30				80.00		70.00			
32				80.00	500.00	160.00	510.00	1.00	2.00
36				80.00		50.00			
41				80.00		60.00			
53				40.00		50.00			
131			380.00						2.00
132			420.00	40.00					2.00
161	400.00								
TOTALS:	400		800		440	490 400	510	1	4

SOLDIER PILE WALL														
SHEET	STA.	TO	STA.	WALL #	CLASS B CONCRETE (RETAINING WALLS) (CUFT)	SOLDIER PILE PRECAST PANELS (8FT) (SQFT)	SOLDIER PILE PRECAST PANELS (16FT) (SQFT)	STRUCTURAL STEEL PILES (HP12X63) (LF)	STRUCTURAL STEEL PILES (HP14X102) (LF)	STRUCTURAL STEEL PILES (W18X119) (LF)	CONCRETE PILES (24 IN) (LF)	CONCRETE PILES (36 IN) (LF)	ROCK SOCKET (1FT. 6IN. DIA.) (LF)	ROCK SOCKET (2FT. 6IN. DIA.) (LF)
213-214	10+00.00		15+27.64	283-4	45.00	5,168.00	466.00	-	1,693.00	61.00	-	781.00	-	224.00
220	15+07.00		18+43.00	282-3	28.50	2,223.00	-	1,240.00	-	-	516.00	-	387.00	-
TOTALS:					74	7,391	466	1,240	1,693	61	516	781	387	224

LANDCOVER MANAGEMENT													
SHEET	STA.	TO	STA.	ROCK BLANKET (TYPE 1) (CUYD)	TEMPORARY SEEDING & MULCHING (ACRE)	EROSION CONTROL BLANKET (SQYD)	MULCH FILTER BERM (LF)	SILT FENCE (LF)	DITCH CHECK (EACH)	INLET PROTECTION (EACH)	STABILIZED CONSTRUCTIO N ENTRANCE (EACH)	SEDIMENT REMOVAL (CUYD)	PERMANENT SEEDING & MULCHING (HYDROSEEDING) (ACRE)
140	332+28.66		345+00.00				1,700				1	17	
140	345+00.00		358+00.00				1,745					18	
141	358+00.00		371+00.00			456	570	240		1		9	
141	371+00.00		415+00.00			1,015	150			4		2	
142	415+00.00		428+00.00				580			4		6	
142	428+00.00		441+00.00			3	970	925 860	3			10 9	3
143	441+00.00		454+00.00				1,070				1	11	
143	454+00.00		500+00.00				1,045	325		1	1	14	
144	500+00.00		506+00.00				565					6	
144	506+00.00		519+00.00									-	
145	519+00.00		532+00.00				3,035					31	
145	532+00.00		545+00.00			150	755					8	
196	531+85.31			110								-	
196	534+89.28			113								-	
146	545+00.00		558+00.00				2,260	630		2	1	29	
146	558+00.00		602+00.00				965	475		2	1	15	
147	602+00.00		615+00.00				430	1,260	3		1	20	
147	615+00.00		628+00.00				2,815					29	
148	628+00.00		641+00.00				1,270	230				15	
148	641+00.00		700+00.00				670					7	
149	700+00.00		713+00.00				2,400	200				26	
149	713+00.00		726+00.00				2,600					26	
150	726+00.00		739+00.00				1,900	200				21	
150	739+00.00		752+00.00				1,200	1,100			1	23	
151	752+00.00		765+00.00				2,400	200				26	
151	765+00.00		778+00.00				2,600					26	
152	778+00.00		784+42.00				1,368			2	1	14	
TOTALS				223	28.0	2,591 1,621	35018 34953	4,860	3	16	8	409 408	28.0

SIGNAL							
SHEET	CONDUIT, 2 IN. IN TRENCH (L.F.)	BASE, CONCRETE (CUYD)	POST, SIGNAL 8 FT (EACH)	DETECTOR, ACCESSIBLE PUSH BUTTON (EACH)	CABLE, 16 AWG 2 CONDUCTOR (L.F.)	PULL BOX, PREFORMED, CLASS 1 (EACH)	VIDEO DETECTION SYSTEM ADJUSTMENT (EACH)
128	85.00	3.00	6.00	8.00	400.00	1.00	1.00
TOTALS:	85	3	6	8	400	1	1

TEMPORARY TRAFFIC CONTROL DEVICES						
LOCATION	FLAGGERS (EACH)	CHANNELIZER (TRIM LINE) (EACH)	TEMPORARY CONCRETE SAFETY BARRIER (L.F.)	TEMPORARY SIGN ASSEMBLY (EACH)	CHANGEABLE MESSAGE SIGN (EACH)	FLASHING ARROW PANEL (EACH)
VARIOUS	8.00	400.00	200	70.00	2.00	2.00
TOTALS:	8	400	200	70	2	2

no.	date	by	ckd	description
-----	------	----	-----	-------------

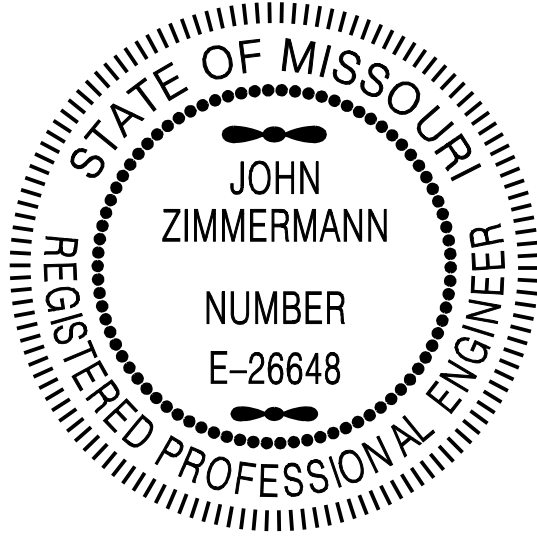

2400 PERSHING ROAD SUITE 400
KANSAS CITY, MISSOURI 64108
816-329-8600
MO STATE CERTIFICATE OF AUTHORITY
#273 ENGINEERING



9400 WARD PARKWAY
KANSAS CITY, MISSOURI 64114
816-333-9400
MO STATE CERTIFICATE OF AUTHORITY
000165 ENGINEERING

date	1/22/2019	detailed	AAM
designed	JWZ	checked	JWZ



JACKSON COUNTY, MISSOURI

ROCK ISLAND RAIL CORRIDOR
SHARED USE PATH PROJECT
SUMMARY OF QUANTITIES

project	STP 3453(402)	contract	
drawing		rev.	01/22/19
sheet	8	of	367 sheets
file	95731-QTY20-004.dgn		

Millimeters

Inches

Scale For Microfining

SHARED USE PATH SURFACING																
SHEET	STA.	TO	STA.	TOP WIDTH (FT.)	TYPE 5 AGGREGATE FOR BASE (4 IN.) (PUGGED) (SQYD)	ASPHALT BASE (TYPE 1- 01) (8 IN.) (64-22) (SQYD)	ASPHALT SURFACE (TYPE 3-01) (2 IN.) (64- 22) (SQYD)	CRUSHED ROCK SURFACING (8 IN.) (SQYD)	CONCRETE PAVEMENT (6 IN. WITH FIBERS) (SQYD)	CONCRETE PAVEMENT (8 IN. WITH FIBERS) (SQYD)	CONCRETE CURB AND GUTTER (CG-1) (L.F.)	CONCRETE CURB (C-1) (L.F.)	CONCRETE SIDEWALK, 4 IN. (SQYD)	CONCRETE SIDEWALK, 4 IN. INTEGRAL RED (SQYD)	CONCRETE CURB RAMP (SQYD)	TRUNCATED DOMES (SQFT)
29	332+28.66		345+00.00	VARIES	1,878.92				1,595.30		105.00		1.33		22.22	44.00
30	345+00.00		358+00.00	VARIES	1,888.83				1,607.84				1.33		22.22	44.00
31	358+00.00		371+00.00	VARIES	1,781.81				1,491.54				1.33			
32	371+00.00		415+00.00	VARIES	1,743.49	282.70	282.70		1,265.63	268.37	920.00		83.52	15.00	140.45	135.00
33	415+00.00		428+00.00	VARIES	1,851.43				1,562.54							
34	428+00.00		441+00.00	12.000	2,051.48				1,762.59				30.56			
35	441+00.00		454+00.00	VARIES	1,975.84				1,687.30		720.00		76.00			
36	454+00.00		500+00.00	VARIES	3,146.65			1,143.02	153.54		60.00		10.11		22.22	44.00
37	500+00.00		506+00.00	10.000				733.33								
38	506+00.00		519+00.00	10.000				1,588.89								
39	519+00.00		532+00.00	VARIES	1,128.05			644.91	959.73				1.33			
40	532+00.00		545+00.00	VARIES	502.44			801.91	422.92				2.67			
41	545+00.00		558+00.00	10.000	104.90			1,461.78	87.40				2.67		22.22	44.00
42	558+00.00		602+00.00	VARIES	203.56			1,236.92	169.52				4.00			
43	602+00.00		615+00.00	VARIES	165.92			1,424.06	138.26							
44	615+00.00		625+00.00	10.000				1,222.22								
45	625+00.00		641+00.00	10.000				1,955.56					2.67			
46	641+00.00		700+00.00	10.000				788.64					2.67			
47	700+00.00		713+00.00	VARIES	815.70			850.68	683.30							
48	713+00.00		726+00.00	10.000	173.33			1,430.00	144.44							
49	726+00.00		739+00.00	10.000				1,588.97								
50	739+00.00		752+00.00	VARIES	608.96			1,176.97	512.44							
51	752+00.00		765+00.00	10.000				1,467.07								
52	765+00.00		778+00.00	10.000				1,588.89								
53	778+00.00		784+65.77	10.000	54.52			734.56	45.41						11.11	22.00
131	448+41.93		450+47.14		86.00	483.00	483.00		63.00			105.00			8.00	10.00
132	543+51.56		546+47.26		111.00	1,242.00	1,242.00		73.00	48.00	42.00					
TOTALS:					20,273	2,008	2,008	21,838	14,425.7	316.4	1,847.0	105.0	220.2	15.0	248.5	343.0

EARTHWORK										
SEGMENT	STA.	TO	STA.	UNCLASSIFIED EXCAVATION (CUYD)	ROCK EXCAVATION (CLASS C EXCAVATION) (CUYD)	EMBANKMENT IN PLACE (CONTRACTOR FURNISHED) (CUYD)	COMPACTING EMBANKMENT (CUYD)	REMOVE AND REPLACE UNSUITABLE MATERIAL (CUYD)	SHOT ROCK (CUYD)	LIGHTWEIGHT FILL (CUYD)
2	332+28.66		371+60.94	1,702.00	90.00	1792.18 2239.40	1,791.00	349.54		955.82 508.60
3	403+54.59		466+26.11	3,774.00	199.00	2,790.36	3,972.09	557.47	1,620.00	
4	500+00.00		567+96.79	3,182.00	168.00	6,904.00	3,349.00	604.16		
5	600+00.00		647+45.25	858.00	46.00	-	852.00	421.80		
6	700+00.00		784+65.77	2,095.00	111.00	2,023.00	2,205.00	752.51		
TOTALS:				11,611	614	13510 13957	12,169	2,686	1,620	956 509

MISCELLANEOUS										
LOCATION	MOBILIZATION (LS)	UTILITY POTHOLES (EACH)	LIMESTONE SLAB (EACH)	TRASH RECEPTACLES (EACH)	BENCH (EACH)	BIKE RACK (EACH)	PICNIC TABLE (EACH)	BUMPING POST RELOCATION (EACH)	SWAMP WHITE OAK/QUERCUS BICOLOR (2.5" CALIPER) (EACH)	
VARIOUS	1.00	12.00	<div>6.00 2.00</div>							
29			<div>12.00 4.00</div>							
30			<div>12.00 0.00</div>							
32			<div>12.00 0.00</div>							
36			<div>12.00 0.00</div>							
39									10.00	
41			<div>12.00 4.00</div>							
42			<div>12.00 4.00</div>							
53			<div>6.00 4.00</div>							
131				1.00	<div>2.00 1.00</div>	<div>0.00 3.00</div>	<div>0.00 1.00</div>	1.00		
132				1.00	<div>2.00 1.00</div>	<div>0.00 3.00</div>	<div>0.00 1.00</div>			
TOTALS:	1	12	<div>72 18</div>	2	<div>4 2</div>	<div>0 6</div>	<div>0 1</div>	1	10	

REMOVALS AND CLEARING (RAIL)							
SHEET	STA.	TO	STA.	CLEARING AND GRUBBING (ACRE)	REMOVAL OF RAIL AND TIES (LF)	REMOVAL OF BRIDGE RAIL AND TIES (LF)	SCRAP TIRE DISPOSAL OR RECYCLING (CUYD)
166	332+04.93		358+00.00	3.28	2,574.00	26.00	
167	358+00.00		415+00.00	2.83	1,306.00	13.00	
168	415+00.00		441+00.00	1.60			
169	441+00.00		500+00.00	2.56	1,967.11	117.00	
170	500+00.00		519+00.00	2.44	1,900.00		
171	519+00.00		545+00.00	4.32	2,461.00	139.00	
172	545+00.00		602+00.00	2.23	2,470.79		
173	602+00.00		628+00.00	2.29	2,580.00	20.00	
174	628+00.00		700+00.00	1.32	1,945.25		
175	700+00.00		726+00.00	1.93	2,600.00		
176	726+00.00		752+00.00	1.94	2,600.00		
177	752+00.00		778+00.00	1.72	2,545.00	55.00	
178	778+00.00		784+65.77	0.72	612.00		
VARIOUS							80.00
TOTALS:				29	25,561	370	80

REMOVALS AND CLEARING (NON-RAIL)				
SHEET	STA.	TO	STA.	DESCRIPTION
161	371+00.00		404+00.00	REMOVE 475 SQYD OF ASPHALT PAVEMENT
161	371+00.00		404+00.00	REMOVE 932 LF OF CURB AND GUTTER
161	371+00.00		404+00.00	REMOVE 219 SQYD OF SIDEWALK
161	371+00.00		404+00.00	REMOVE 13 SQYD CONCRETE ISLAND
161	371+00.00		404+00.00	REMOVE FLOOD LIGHT
161	371+00.00		404+00.00	REMOVE MONUMENT SIGN
161	371+00.00		404+00.00	REMOVE STORM PIPE
161	371+00.00		404+00.00	RELOCATE WATER VALVE & TRAFFIC BOX
161	371+00.00		404+00.00	ADJUST WATER VALVE
162	404+00.00		407+00.00	REMOVE LIGHT POLE
162	404+00.00		407+00.00	REMOVE 64 SQYD CONCRETE DRIVEWAY
162	404+00.00		407+00.00	REMOVE 122 SQYD ASPHALT
162	404+00.00		407+00.00	REMOVE CONCRETE HEADWALL
162	404+00.00		407+00.00	REMOVE 62 LF 60" RCP PIPE
162	404+00.00		407+00.00	REMOVE 267 LF OF CURB AND GUTTER
162	404+00.00		407+00.00	REMOVE 63 SQYD CONCRETE SIDEWALK
162	404+00.00		407+00.00	REMOVE 6 SQYD ASPHALT
162	404+00.00		407+00.00	REMOVE 171 SQYD CONCRETE PARKING LOT
162	404+00.00		407+00.00	RELOCATE 2 LIGHT POLES
166	332+39.00			REMOVE 8'X30' ASPHALT SHOULDER
166	332+39.00			RELOCATE MAILBOX
166	348+95.00			REMOVE 2 SIGNS
167	358+44.00	358+84.00		28 SQYD DEBRIS ZONE B REMOVALS
169	441+00.00	443+23.00		REMOVE 5'X224' CONCRETE SIDEWALK
169	453+00.00	454+00.00		REMOVE CONCRETE FLUME
169	454+00.00			REMOVE AND REPLACE 68 LF CURB AND GUTTER
169	454+00.00			REMOVE 10 LF SIDEWALK
170	506+07.00	507+07.00		REMOVE 63 SQYD GARDEN
172	546+43.00			REMOVE TRESSPASSING SIGN
172	564+20.00	565+22.00		113 SQYD DEBRIS ZONE D REMOVALS
173	609+82.00			REMOVE 15 SQYD CONCRETE PAD
173	616+00.00	619+00.00		514 SQYD DEBRIS ZONE E REMOVALS
174	645+52.00			REMOVE 85 LF 8" PVC PIPE
TOTALS: LUMP SUM				

no.	date	by	ckd	description
-----	------	----	-----	-------------

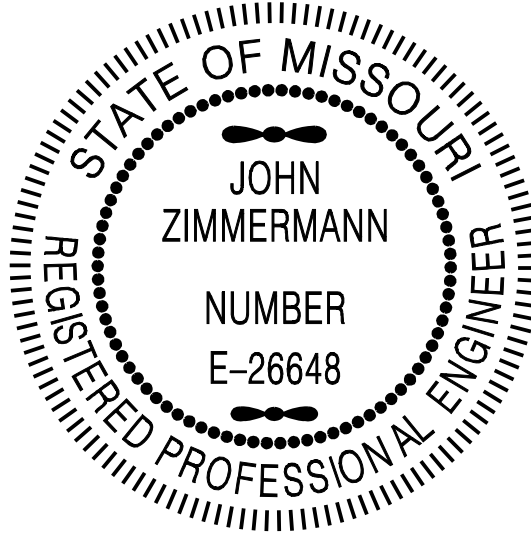

2400 PERSHING ROAD SUITE 400
KANSAS CITY, MISSOURI 64108
816-329-8600
MO STATE CERTIFICATE OF AUTHORITY
#273 ENGINEERING



9400 WARD PARKWAY
KANSAS CITY, MISSOURI 64114
816-333-9400
MO STATE CERTIFICATE OF AUTHORITY
000165 ENGINEERING

date	1/22/2019	detailed	AAM
designed	JWZ	checked	JWZ



JACKSON COUNTY, MISSOURI

ROCK ISLAND RAIL CORRIDOR
SHARED USE PATH PROJECT
SUMMARY OF QUANTITIES

project	STP 3453(402)	contract	
drawing		rev.	01/22/19
sheet	9	of	367
file	95731-QTY20-005.dgn	sheets	

Millimeters

Scale For Microfining

Inches

SUMMARY OF QUANTITIES				
Item No.	Specifications	Description	Quantity	Unit
1	TS-13-01	MOBILIZATION	1	LS
2	TS-12-01	UTILITY POTHOLES	12	EACH
3	TS-02-01	ORANGE CONSTRUCTION FENCING (48 IN.)	327	LF
4	TS-15-01	CLEARING AND GRUBBING	29	ACRE
5	TS-17-01	UNCLASSIFIED EXCAVATION	11,611	CUYD
6	TS-17-02	ROCK EXCAVATION (CLASS C EXCAVATION)	614	CUYD
7	TS-17-03	EMBANKMENT IN PLACE (CONTRACTOR FURNISHED)	13510 13957	CUYD
8	TS-17-04	COMPACTING EMBANKMENT	12,169	CUYD
9	TS-17-05	REMOVE AND REPLACE UNSUITABLE MATERIAL	2,686	CUYD
10	TS-17-06	SHOT ROCK	1,620	CUYD
11	TS-17-07	LIGHTWEIGHT FILL	956 509	CUYD
12	TS-15-02	REMOVAL OF RAIL AND TIES	25,561	LF
13	TS-15-03	REMOVAL OF BRIDGE RAIL AND TIES	370	LF
14	TS-15-04	REMOVAL OF IMPROVEMENTS (NON-RAIL)	1	LS
15	TS-15-05	SCRAP TIRE DISPOSAL OR RECYCLING	80	CUYD
16	TS-20-01	TYPE 5 AGGREGATE FOR BASE (4 IN.) (PUGGED)	20,273	SQYD
17	TS-47-01	ASPHALT BASE (TYPE 1-01) (8 IN.) (64-22)	2,008	SQYD
18	TS-48-01	ASPHALT SURFACE (TYPE 3-01) (2 IN.) (64-22)	2,008	SQYD
19	TS-21-01	CRUSHED ROCK SURFACING (8 IN.)	21,838	SQYD
20	TS-22-01	CONCRETE PAVEMENT (6 IN. WITH FIBERS)	14,425.7	SQYD
21	TS-22-02	CONCRETE PAVEMENT (8 IN. WITH FIBERS)	316.4	SQYD
22	TS-23-01	CONCRETE CURB AND GUTTER (CG-1)	1,847.0	LF
23	TS-23-02	CONCRETE CURB (C-1)	105.0	LF
24	TS-23-03	CONCRETE SIDEWALK, 4 IN.	220.2	SQYD
25	TS-23-04	CONCRETE SIDEWALK, 4 IN. INTEGRAL RED	15.0	SQYD
26	TS-23-05	CONCRETE CURB RAMP	248.5	SQYD
27	TS-23-06	TRUNCATED DOMES	343.0	SQFT
28	TS-49-01	LIMESTONE SLAB	72 38	EACH
29	TS-29-01	AREA INLET (4' X 4')	1	EACH
30	TS-29-02	18 IN. PIPE GROUP C	185	LF
31	TS-29-03	24 IN. PIPE GROUP C	24	LF
32	TS-29-04	30 IN. PIPE GROUP C	140	LF
33	TS-29-05	60 IN. PIPE GROUP C	78	LF
34	TS-29-06	8 IN. FLARED END SECTION GROUP C	1	EACH
35	TS-29-07	18 IN. FLARED END SECTION GROUP C	6	EACH
36	TS-29-08	24 IN. FLARED END SECTION GROUP C	1	EACH
37	TS-29-09	30 IN. FLARED END SECTION GROUP C	1	EACH
38	TS-29-10	60 IN. FLARED END SECTION GROUP C	1	EACH
39	TS-29-11	METAL GRATE(10 FT. X 2.5 FT.)	1	EACH
40	TS-29-12	ROCK LINING	1,364	CUYD
41	TS-29-13	ROCK BLANKET (TYPE 1)	223	CUYD ACRE
42	TS-18-01	TEMPORARY SEEDING AND MULCHING	28.0	ACRE
43	TS-18-02	MULCH FILTER BERM	35,018 34,953	LF
44	TS-18-03	SILT FENCE	4,860	LF
45	TS-18-04	DITCH CHECK	3	EACH
46	TS-18-05	INLET PROTECTION	16	EACH
47	TS-18-06	STABILIZED CONSTRUCTION ENTRANCE	8	EACH
48	TS-18-07	SEDIMENT REMOVAL	409 408	CUYD
49	TS-18-08	EROSION CONTROL BLANKET	2,591 1,621	SQYD
50	TS-26-01	PEDESTRIAN FENCE (STRUCTURES) (48 IN.)	380	LF
51	TS-26-02	PEDESTRIAN FENCE (GROUND MOUNT) (48 IN.)	6,198	LF
52	TS-26-03	CHAIN LINK FENCE (48 IN.)	567	LF
53	TS-26-04	WOVEN WIRE FENCE (48 IN.)	5,328	LF
54	TS-26-05	WOODEN SPLIT RAIL FENCE (48 IN.)	547	LF
55	TS-40-02	MSE RETAINING WALL (SMALL BLOCK) (RETAINED FACE)	19,873	SQFT
56	TS-52-01	SOLDIER PILE PRECAST PANELS (8 FT)	7,391	SQFT
57	TS-52-02	SOLDIER PILE PRECAST PANELS (16 FT)	466	SQFT
58	TS-30-01	GRAFFITI PROTECTION	19,873	SQFT
59	TS-36-01	PRECAST DECK PANEL (BLUE PARKWAY / 350 HWY)	77	SQYD
60	TS-36-02	CLASS B-1 CONCRETE (SUBSTRUCTURE)	48	CUYD
61	TS-36-03	CLASS B-1 CONCRETE (SUPERSTRUCTURE)	9	CUYD
62	TS-36-04	CLASS B CONCRETE (RETAINING WALLS)	74	CUYD
63	TS-38-01	STRUCTURAL STEEL PILE (12 IN.)	168	LF
64	TS-38-02	STRUCTURAL STEEL PILE (HP12X63)	1,240	LF
65	TS-38-03	STRUCTURAL STEEL PILE (HP14X102)	1,693	LF
66	TS-38-04	STRUCTURAL STEEL PILE (HP18X119) (W18X119)	61	LF
67	TS-38-05	PRE-BORE FOR PILING	100	LF
68	TS-37-01	DRILLED SHAFTS (4 FT. 0 IN. DIA.)	33	LF
69	TS-37-02	ROCK SOCKETS (1 FT. 6 IN. DIA.)	387	LF

3

3

1

3

3

3

3

SUMMARY OF QUANTITIES				
Item No.	Specifications	Description	Quantity	Unit
71	TS-37-04	ROCK SOCKETS (3 FT. 6 IN. DIA.)	10	LF
72	TS-37-05	CONCRETE PILE (24 IN)	516	LF
73	TS-37-06	CONCRETE PILE (36 IN)	781	LF
74	TS-37-07	FOUNDATION INSPECTION HOLES	30	LF
75	TS-37-08	VIDEO CAMERA INSPECTION HOLES	2	LF
76	TS-37-09	SONIC LOGGING TESTING	6	EACH
77	TS-36-04	SLAB ON STEEL TRUSS	400	SQYD
78	TS-36-05	VERTICAL DRAIN AT END BENT	2	EACH
79	TS-41-01	WATERPROOFING MEMBRANE	435	SQYD
80	TS-35-05	PREFABRICATED BRIDGE (WILDWOOD - SPAN 1)	1	EACH
81	TS-35-06	PREFABRICATED BRIDGE (WILDWOOD - SPAN 2)	1	EACH
82	TS-32-01	CROSSFRAME TIMBER MEMBERS (RAYTOWN ROAD)	9	EACH
83	TS-02-03	FLAGGERS	8	EACH
84	TS-02-04	CHANNELIZER (TRIM LINE)	400	EACH
85	TS-02-05	TEMPORARY CONCRETE SAFETY BARRIER	200	LF
86	TS-02-06	TEMPORARY SIGN ASSEMBLY	70	EACH
87	TS-02-07	CHANGEABLE MESSAGE SIGN	2	EACH
88	TS-02-08	FLASHING ARROW PANEL	2	EACH
89	TS-25-01	EXIST. PAVEMENT MARKINGS REMOVAL	400	LF
90	TS-25-02	4 IN. WHITE PREFORMED THERMOPLASTIC PAVEMENT MARKING	800	LF
91	TS-25-03	4 IN. YELLOW PREFORMED THERMOPLASTIC PAVEMENT MARKING	440	LF
92	TS-25-04	12 IN. WHITE PREFORMED THERMOPLASTIC PAVEMENT MARKING	500	LF
93	TS-25-05	24 IN. WHITE PREFORMED THERMOPLASTIC PAVEMENT MARKING	490 490	LF
94	TS-25-06	GREEN BIKE LANE PAVEMENT MARKING PAINT	510	SQFT
95	TS-25-07	LEFT TURN ARROW	1	EACH
96	TS-25-08	"SHARROW" PAVEMENT MARKING	2	EACH
97	TS-25-09	PAVEMENT MARKING SYMBOL, TYPE 2 TAPE (ADA)	4	EACH
98	TS-02-09	CONDUIT, 2 IN, IN TRENCH	85	LF
99	TS-02-10	BASE, CONCRETE	3	CUYD
100	TS-02-11	POST, SIGNAL 8 FT	6	EACH
101	TS-02-12	DETECTOR, ACCESSIBLE PUSH BUTTON	8	EACH
102	TS-02-13	CABLE, 16 AWG 2 CONDUCTOR	400	LF
103	TS-02-14	PULL BOX, PREFORMED, CLASS 1	1	EACH
104	TS-02-15	VIDEO DETECTION SYSTEM ADJUSTMENT	1	EACH
105	TS-27-01	PERMANENT SIGN ASSEMBLIES	62	EACH
106	TS-27-02	SAFETY SIGN (72")	29 62	EACH
107	TS-27-03	INTERPRETIVE SIGN ASSEMBLY	9	EACH
108	TS-27-04	RECTANGULAR RAPID FLASHING BEACON ASSEMBLY	9	EACH
109	TS-33-01	COLLAPSIBLE BOLLARD	15 11	EACH
110	TS-42-01	TRASH RECEPTACLE	2	EACH
111	TS-43-01	BENCH	4 2	EACH
112	TS-44-01	BIKE RACK	0 6	EACH
113	TS-46-01	PICNIC TABLE	0 1	EACH
114	TS-45-01	BUMPING POST RELOCATION	1	EACH
115	TS-53-01	SWAMP WHITE OAK/QUERCUS BICOLOR (2.5" CALIPER)	10	EACH
116	TS-09-01	PERMANENT SEEDING AND MULCHING (HYDROSEEDING)	28.0	ACRE

3

3

1

1

no. | date | by | ckd | description

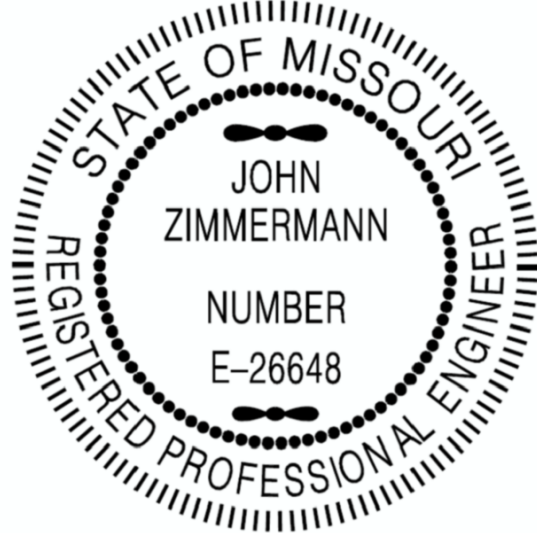

2400 PERSHING ROAD SUITE 400
KANSAS CITY, MISSOURI 64108
816-329-8600
MO STATE CERTIFICATE OF AUTHORITY
#273 ENGINEERING



9400 WARD PARKWAY
KANSAS CITY, MISSOURI 64114
816-333-9400
MO STATE CERTIFICATE OF AUTHORITY
000165 ENGINEERING

date	1/25/2019	detailed	AAM
designed	JWZ	checked	JWZ



JACKSON COUNTY, MISSOURI

ROCK ISLAND RAIL CORRIDOR
SHARED USE PATH PROJECT
SUMMARY OF QUANTITIES

project	STP 3453(402)	contract	
drawing	3	rev.	01/22/19
sheet	12	of	367 sheets
file	95731-QTY20-008.dgn		

Millimeters

Scale For Microfilming

Inches

EVERYTHING ON THIS SHEET IS ADD ALTERNATE A

PAVEMENT MARKING		
SHEET	4 IN. YELLOW PREFORMED THERMOPLASTIC PAVEMENT MARKING (L.F.)	24 IN. WHITE PREFORMED THERMOPLASTIC PAVEMENT MARKING (L.F.)
29	40.00	
130	80.00	140.00
TOTALS:	120	140

DRAINAGE						
PLAN SHEET	SECTION SHEET	STA.	LOCATION	18 IN. PIPE GROUP C (L.F.)	18" FLARED END SECTION GROUP C (EACH)	ROCK LINING (CUYD)
28	179	321+66.20	CL	44.00	2.00	2.00
TOTALS				44	2	2

TEMPORARY TRAFFIC CONTROL DEVICES							
LOCATION	TYPE III MOVABLE BARRICADE W/ FLASHERS (EACH)	FLAGGERS (EACH)	CHANNELIZER (TRIM LINE) (EACH)	TEMPORARY CONCRETE SAFETY BARRIER (L.F.)	TEMPORARY SIGN ASSEMBLY (EACH)	CHANGEABLE MESSAGE SIGN (EACH)	FLASHING ARROW PANEL (EACH)
VARIOUS	10.00	2.00	100.00	40.00	90.00 70.00	2.00	2.00
TOTALS:	10	2	100	40	90 70	2	2

LANDCOVER MANAGEMENT												
SHEET	STA.	TO	STA.	ROCK BLANKET (TYPE 1) (CUYD)	TEMPORARY SEEDING & MULCHING (ACRE)	EROSION CONTROL BLANKET (SQYD)	MULCH FILTER BERM (LF)	SILT FENCE (LF)	DITCH CHECK (EACH)	STABILIZED CONSTRUCTION ENTRANCE (EACH)	SEDIMENT REMOVAL (CUYD)	PERMANENT SEEDING & MULCHING (HYDROSEEDING) (ACRE)
137	246+00.00		253+00.00				480			1	5	
182	247+78.00			58							-	
182	249+00.00			14							-	
137	253+00.00		266+00.00			5,505		75		1	1	
185	258+56.76			23							-	
185	259+95.09			8							-	
138	266+00.00		279+00.00			568	585				6	
138	279+00.00		306+00.00			1,202	920	225	2	1	14	
188	279+82.59			19							-	
188	280+74.84			21							-	
139	306+00.00		319+00.00			3,439					-	
190	316+26.78			62							-	
190	317+47.12			68							-	
139	319+00.00		332+04.93				365	75	7		12	
TOTALS				273	7.0	10,714	2,350	375	9	3	38	7.0

SHARED USE PATH SURFACING									
SHEET	STA.	TO	STA.	TOP WIDTH (FT.)	TYPE 5 AGGREGATE FOR BASE (4 IN.) (PUGGED) (SQYD)	CONCRETE PAVEMENT (6 IN. WITH FIBERS) (SQYD)	CONCRETE SIDEWALK, 4 IN. (SQYD)	CONCRETE CURB RAMP (SQYD)	TRUNCATED DOMES (SQFT)
23	247+01.03		253+00.00		678.29	565.24			
24	253+00.00		266+00.00	VARIES	1,636.73	1,378.58	1.33		
25	266+00.00		279+00.00	VARIES	1,838.58	1,549.70	1.33		
26	279+00.00		306+00.00	10.000	1,520.37	1,266.97			
27	306+00.00		319+00.00	10.000	1,570.22	1,308.52	1.33		
28	319+00.00		332+04.93	10.000	1,733.33	1,444.44			
130	242+82.75		247+01.03	10.000	514.00	431.00		44.44	88.00
TOTALS:					9,492	7,944.5	4.0	44.4	88.0

EARTHWORK							
SEGMENT	STA.	TO	STA.	UNCLASSIFIED EXCAVATION (CUYD)	ROCK EXCAVATION (CLASS C EXCAVATION) (CUYD)	EMBANKMENT IN PLACE (CONTRACTOR FURNISHED) (CUYD)	COMPACTING EMBANKMENT (CUYD)
1	242+82.75		285+32.52	2,181.00	115.00	16250.44 16353.20	2,295.00
2	300+00.00		332+04.93	12,927.00	681.00	-	7,643.00
TOTALS:				15,108	796	16251 16354	9,938

MISCELLANEOUS					
LOCATION	UTILITY POTHOLES (EACH)	LIMESTONE SLAB (EACH)	TRASH RECEPTACLES (EACH)	BENCH (EACH)	BIKE RACK (EACH)
VARIOUS	8.00				
29		6.00 2.00			
130		6.00 0.00	1.00	2.00 1.00	0.00 5.00
TOTALS:	8	12 2	1	2 1	0 5

no. | date | by | ckd | description

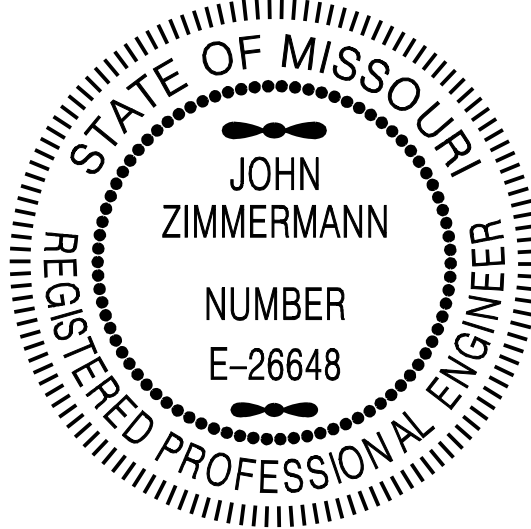

2400 PERSHING ROAD SUITE 400
KANSAS CITY, MISSOURI 64108
816-329-8600
MO STATE CERTIFICATE OF AUTHORITY
#273 ENGINEERING



9400 WARD PARKWAY
KANSAS CITY, MISSOURI 64114
816-333-9400
MO STATE CERTIFICATE OF AUTHORITY
000165 ENGINEERING

date	1/22/2019	detailed	AAM
designed	JWZ	checked	JWZ



JACKSON COUNTY, MISSOURI

ROCK ISLAND RAIL CORRIDOR
SHARED USE PATH PROJECT
SUMMARY OF QUANTITIES

project	STP 3453(402)	contract	
drawing	3	rev.	01/22/19
sheet	13	of	367 sheets
file	95731-QTY20-001.dgn		

EVERYTHING ON THIS SHEET IS ADD ALTERNATE A

SUMMARY OF QUANTITIES				
Item No.	Specifications	Description	Quantity	Unit
A1	TS-12-01	UTILITY POTHOLE	8	EACH
A2	TS-02-01	ORANGE CONSTRUCTION FENCING (48 IN.)	135	LF
A3	TS-15-01	CLEARING AND GRUBBING	15	ACRE
A4	TS-17-01	UNCLASSIFIED EXCAVATION	15,108	CUYD
A5	TS-17-02	ROCK EXCAVATION (CLASS C EXCAVATION)	796	CUYD
A6	TS-17-03	EMBANKMENT IN PLACE (CONTRACTOR FURNISHED)	16251 16354	CUYD
A7	TS-17-04	COMPACTING EMBANKMENT	9,938	CUYD
A8	TS-17-05	REMOVE AND REPLACE UNSUITABLE MATERIAL	663	CUYD
A9	TS-17-07	LIGHTWEIGHT FILL	231 129	CUYD
A10	TS-15-02	REMOVAL OF RAIL AND TIES	8,601	LF
A11	TS-15-03	REMOVAL OF BRIDGE RAIL AND TIES	146	LF
A12	TS-15-04	REMOVAL OF IMPROVEMENTS (NON-RAIL)	1	LS
A13	TS-15-05	SCRAP TIRE DISPOSAL OR RECYCLING	20	CUYD
A14	TS-20-01	TYPE 5 AGGREGATE FOR BASE (4 IN.) (PUGGED)	9,492	SQYD
A15	TS-22-01	CONCRETE PAVEMENT (6 IN. WITH FIBERS)	7,944.5	SQYD
A16	TS-23-03	CONCRETE SIDEWALK, 4 IN.	4.0	SQYD
A17	TS-23-05	CONCRETE CURB RAMP	44.4	SQYD
A18	TS-23-06	TRUNCATED DOMES	88.0	SQFT
A19	TS-49-01	LIMESTONE SLAB	12 3	EACH
A20	TS-29-02	18 IN. PIPE GROUP C	44	LF
A21	TS-29-07	18 IN. FLARED END SECTION GROUP C	2	EACH
A22	TS-29-12	ROCK LINING	2	CUYD
A23	TS-29-13	ROCK BLANKET (TYPE 1)	273	CUYD ACRE
A24	TS-18-01	TEMPORARY SEEDING AND MULCHING	7.0	ACRE
A25	TS-18-02	MULCH FILTER BERM	2,350	LF
A26	TS-18-03	SILT FENCE	375	LF
A27	TS-18-04	DITCH CHECK	9	EACH
A28	TS-18-06	STABILIZED CONSTRUCTION ENTRANCE	3	EACH
A29	TS-18-07	SEDIMENT REMOVAL	38	CUYD
A30	TS-18-08	EROSION CONTROL BLANKET	10,714	SQYD
A31	TS-26-02	PEDESTRIAN FENCE (GROUND MOUNT) (48 IN.)	917	LF
A32	TS-26-06	2- RAIL WHITE VINYL FENCE (48 IN.)	60	LF
A33	TS-40-02	MSE RETAINING WALL (SMALL BLOCK) (RETAINED FACE)	4,693	SQFT
A34	TS-52-01	SOLDIER PILE PRECAST PANELS (8 FT)	1,249	SQFT
A35	TS-30-01	GRAFFITI PROTECTION	4,693	SQFT
A36	TS-36-02	CLASS B-1 CONCRETE (SUBSTRUCTURE)	156	CUYD
A37	TS-36-04	CLASS B CONCRETE (RETAINING WALLS)	10	CUYD
A38	TS-38-01	STRUCTURAL STEEL PILE (12 IN.)	340	LF
A39	TS-38-03	STRUCTURAL STEEL PILE (HP14X102)	499 417	LF
A40	TS-38-05	PRE-BORE FOR PILING	186	LF
A41	TS-38-06	PIPE PILE SPACER	8	EACH
A42	TS-37-06	CONCRETE PILE (36 IN)	320	LF
A43	TS-36-04	SLAB ON STEEL TRUSS	578	SQYD
A44	TS-36-05	VERTICAL DRAIN AT END BENT	8	EACH
A45	TS-35-01	PREFABRICATED BRIDGE (STADIUM TRAILHEAD)	1	EACH
A46	TS-35-02	PREFABRICATED BRIDGE (BLUE RIDGE CUTOFF)	1	EACH
A47	TS-35-03	PREFABRICATED BRIDGE (ROUND GROVE CREEK - TRIB. #1)	1	EACH
A48	TS-35-04	PREFABRICATED BRIDGE (47TH STREET)	1	EACH
A49	TS-02-02	TYPE III MOVABLE BARRICADE W/ FLASHERS	10	EACH
A50	TS-02-03	FLAGGERS	2	EACH
A51	TS-02-04	CHANNELIZER (TRIM LINE)	100	EACH
A52	TS-02-05	TEMPORARY CONCRETE SAFETY BARRIER	40	LF
A53	TS-02-06	TEMPORARY SIGN ASSEMBLY	90 70	EACH
A54	TS-02-07	CHANGEABLE MESSAGE SIGN	2	EACH
A55	TS-02-08	FLASHING ARROW PANEL	2	EACH
A56	TS-25-03	4 IN. YELLOW PREFORMED THERMOPLASTIC PAVEMENT MARKING	120	LF
A57	TS-25-05	24 IN. WHITE PREFORMED THERMOPLASTIC PAVEMENT MARKING	140	LF
A58	TS-27-01	PERMANENT SIGN ASSEMBLIES	22	EACH
A59	TS-27-02	SAFETY SIGN (72")	6	EACH
A60	TS-27-03	INTERPRETIVE SIGN ASSEMBLY	1	EACH
A61	TS-27-04	RECTANGULAR RAPID FLASHING BEACON ASSEMBLY	5	EACH
A62	TS-33-01	COLLAPSIBLE BOLLARD	3	EACH
A63	TS-42-01	TRASH RECEPTACLE	1	EACH
A64	TS-43-01	BENCH	2 1	EACH
A65	TS-44-01	BIKE RACK	0 5	EACH
A66	TS-09-01	PERMANENT SEEDING AND MULCHING (HYDROSEEDING)	7.0	ACRE

3

3

1

3

1

1

1

no. | date | by | ckd | description

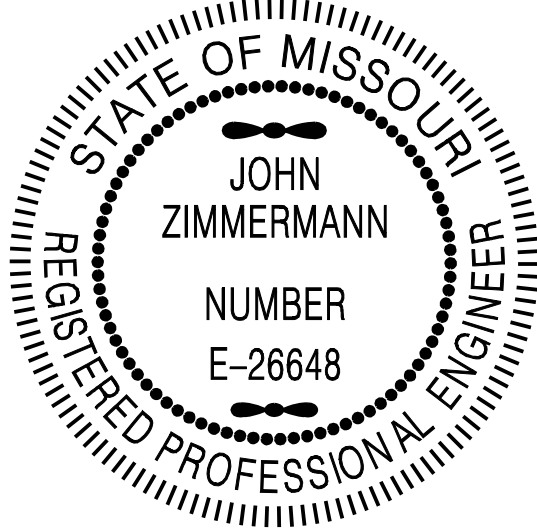

2400 PERSHING ROAD SUITE 400
KANSAS CITY, MISSOURI 64108
816-329-8600
MO STATE CERTIFICATE OF AUTHORITY
#273 ENGINEERING



9400 WARD PARKWAY
KANSAS CITY, MISSOURI 64114
816-333-9400
MO STATE CERTIFICATE OF AUTHORITY
000165 ENGINEERING

date	1/22/2019	detailed	AAM
designed	JWZ	checked	JWZ



JACKSON COUNTY, MISSOURI

ROCK ISLAND RAIL CORRIDOR
SHARED USE PATH PROJECT
SUMMARY OF QUANTITIES

project	STP 3453(402)	contract	
drawing	3	rev.	01/22/19
sheet	15	of	367 sheets
file	95731-QTY20-003.dgn		

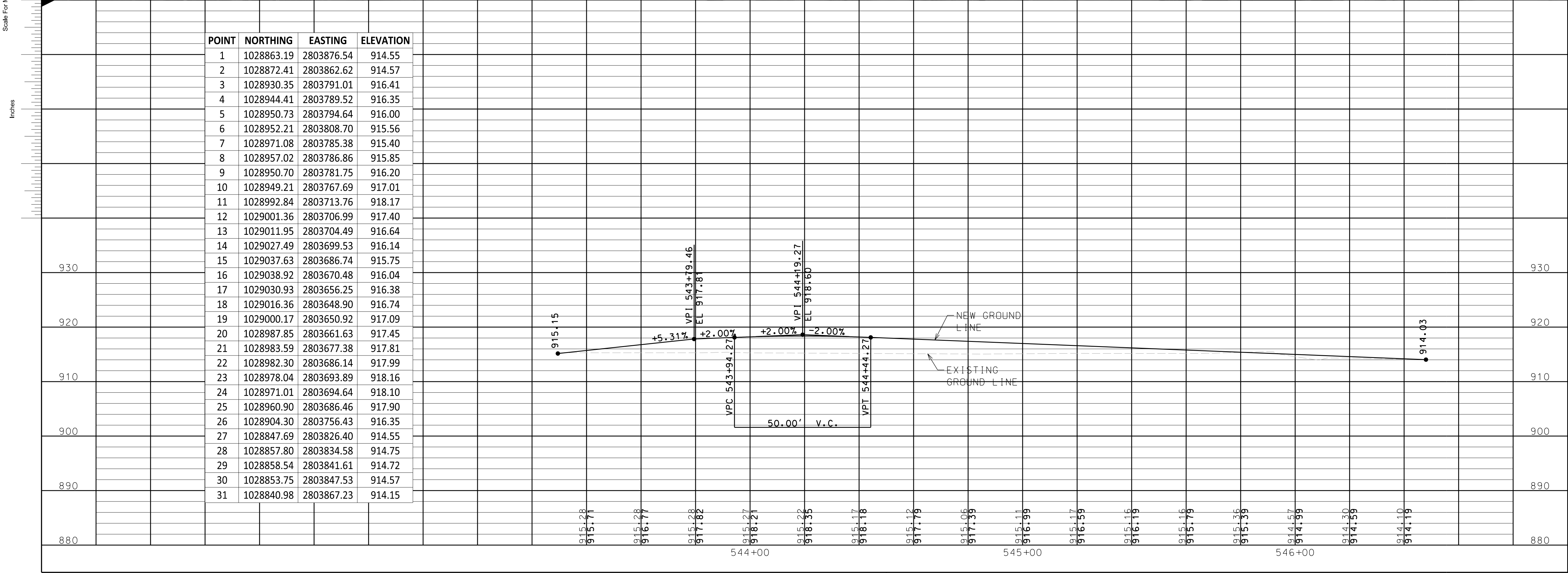
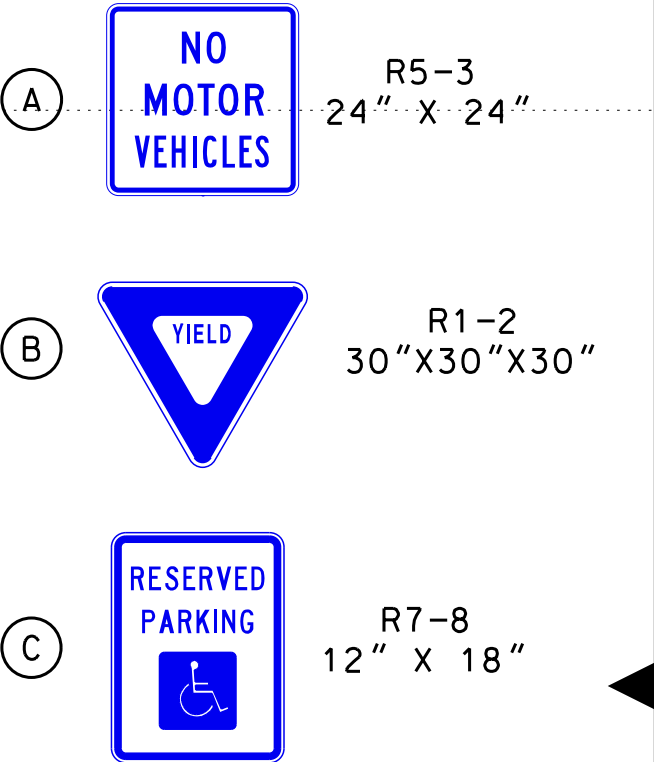
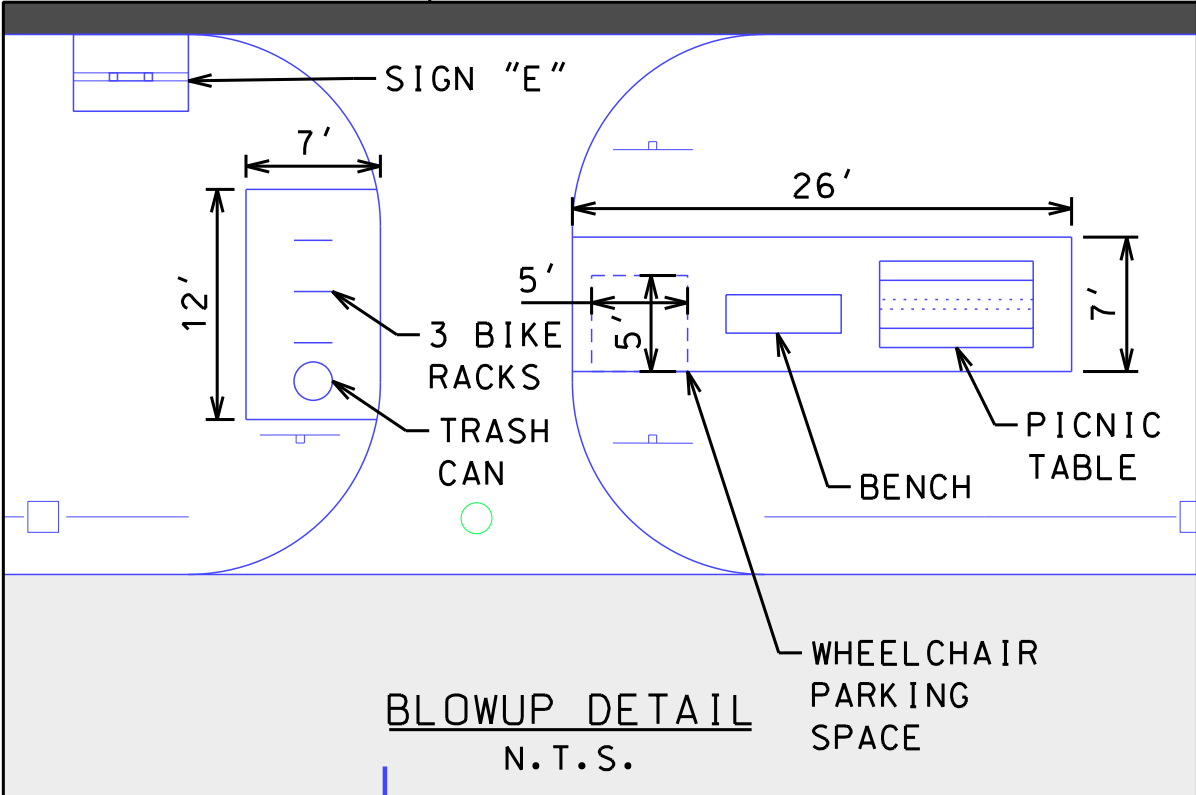
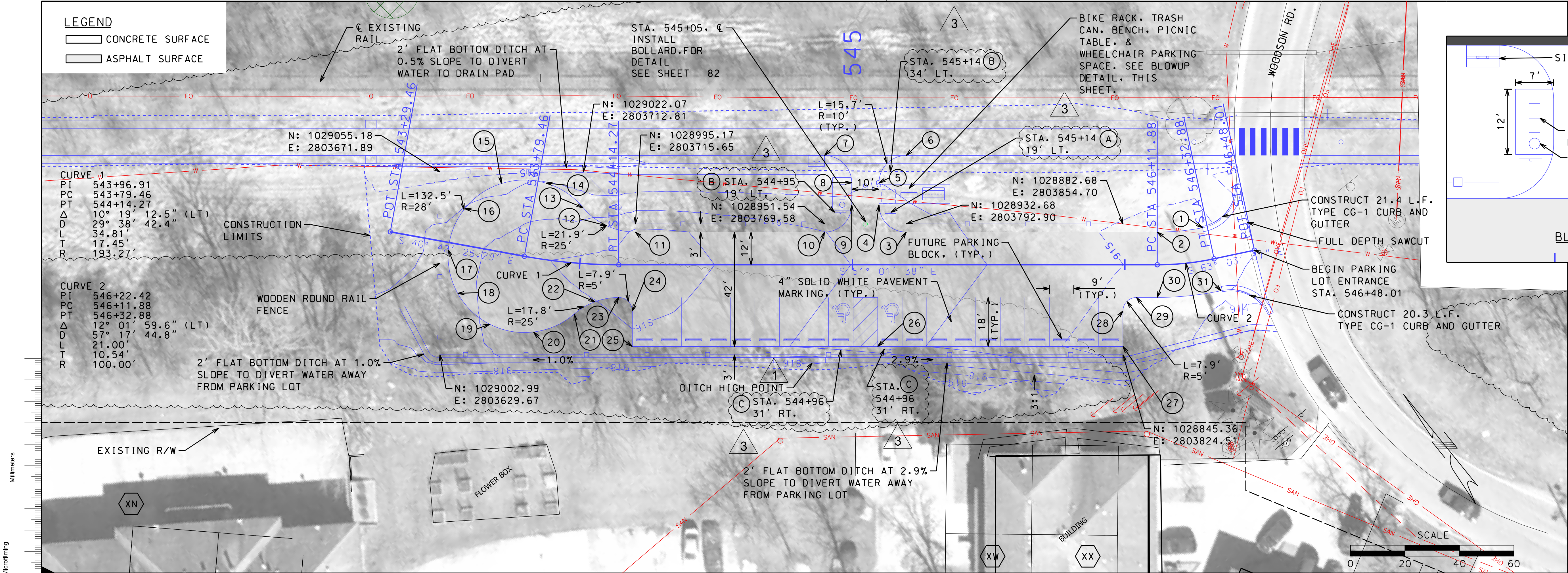

Hg Consult Inc.
10512 N. EUCLID AVE.
KANSAS CITY, MISSOURI 64155
(816) 256-5153
MO STATE CERTIFICATE OF AUTHORITY
2010005873 ENGINEERING

BURNS
McDONNELL
9400 WARD PARKWAY
KANSAS CITY, MISSOURI 64114
816-333-9400
MO STATE CERTIFICATE OF AUTHORITY
000165 ENGINEERING

date	1/22/2019	detailed	RAM
designed	RAM	checked	EJH

JACKSON COUNTY, MISSOURI

ROCK ISLAND RAIL CORRIDOR
SHARED USE PATH PROJECT

WOODSON ROAD TRAIL HEAD

project	STP 3453(402)	contract	
drawing		rev.	3 01/22/19
sheet	132	of	367
file	95731-PP30-004.dgn	sheets	