

Contract Addendum



Addendum No.: 2

Issue Date of Addendum: Friday, January 18, 2019

Issued by: Kevin Ostermiller (kostermiller@twm-inc.com)

Contract Name: WILDWOOD - Manchester Road Streetscape Phase 3
TWM Project No.: 140229

To: ALL BIDDERS AND HOLDERS OF CONTRACT DOCUMENTS

This Addendum comprises part of the Contract Documents and modifies the original Contract Plans and Specifications for the subject Contract. Bidders are advised to acknowledge receipt of this Addendum in the space provided in the Bid Form Document.

FAILURE TO MAKE THIS ACKNOWLEDGEMENT MAY SUBJECT BIDDER TO DISQUALIFICATION.

Thouvenot, Wade & Moerchen, Inc.

OFFICE OF ORIGINATION

- Corporate Office**
4940 Old Collinsville Road
Swansea, Illinois 62226
Tel. No. 618.624.4488
Fax No. 618.624.6688
- Waterloo Regional Office**
113 South Main Street
Waterloo, Illinois 62298
Tel. No. 618.939.5050
Fax No. 618.939.3938
- Edwardsville Regional Office**
600 Country Club View, Suite 1
Edwardsville, Illinois 62025
Tel. No. 618.656.4040
Fax No. 618.656.4343
- St. Louis Regional Office**
720 Olive Street, Suite 200A
St. Louis, Missouri 63101
Tel. No. 314.241.6300
Fax No. 314.241.2391
- St. Charles Satellite Office**
400 North 5th Street, Suite 101
St. Charles, Missouri 63301
Tel. No. 636.724.8300
Fax No. 636.724.8304

Addendum Information/Clarifications/Instructions for Bidders

1. Revised - Pay Item "MISC., SIGN ON PRIVATE PROPERTY" Removed. See Quantity (QU) Sheet 1 of 18 and. See Revised Bid Sheets.
2. Revised - Sheet name changed to "SS" and Sheet number changed to "3 of 3". See Special Plan Sheet 60 (SS 3 of 3).

ITEMIZED BID FORM
STP-5536(610) MANCHESTER ROAD STREETScape PHASE 3

City of Wildwood, Missouri

REVISÉ

| ITEM # | ITEM DESCRIPTION | UNIT | UNIT COST | QUANTITY | TOTAL |
|----------------------------------|--|------|-----------|----------|-------|
| ROADWAY ITEMS | | | | | |
| 202-20.10 | REMOVAL OF IMPROVEMENTS | LS | | 1 | |
| 203-10.00 | CLASS A EXCAVATION | CY | | 4970 | |
| 203-60.00 | COMPACTING EMBANKMENT | CY | | 4255 | |
| 203-70.75 | COMPACTING IN CUT | STA | | 27.7 | |
| 206-30.00 | CLASS 3 EXCAVATION | CY | | 1410 | |
| 207-10.00 | LINEAR GRADING, CLASS 1 | STA | | 11.8 | |
| 304-01.83 | TYPE 1 AGGREGATE FOR BASE (8 IN. THICK) | SY | | 1916 | |
| 304-05.04 | TYPE 5 AGGREGATE FOR BASE (4 IN. THICK) | SY | | 3429 | |
| 310-10.02 | GRAVEL (A) | TONS | | 25 | |
| 401-01.07 | 7 INCHES, BITUMINOUS PAVEMENT | SY | | 1255.4 | |
| 401-12.09 | BITUMINOUS PAVEMENT MIXTURE PG64-22 (BP-1) | TONS | | 311.0 | |
| 401-30.00 | BITUMINOUS PAVEMENT MIXTURE PG64-22 (BASE) | TONS | | 575.0 | |
| 403-01.09 | ASPHALTIC CONCRETE MIXTURE PG70-22 (SP125CLP) | TONS | | 1396.4 | |
| 407-99.12 | MISC., POLYMER MODIFIED EMULSION MEMBRANE | GAL | | 1872 | |
| 502-40.08 | CONCRETE BASE (8 IN. NON-REINFORCED) | SY | | 1328.7 | |
| 502-99.05 | MISC., PERVIOUS CONCRETE PAVEMENT, 8 IN. THICK | SY | | 1681.0 | |
| 608-50.07 | PAVED APPROACH, 7 IN. | SY | | 1593.8 | |
| 609-10.10 | CONCRETE CURB (6 IN. HEIGHT AND UNDER) TYPE S | LF | | 3520 | |
| 609-20.12 | INTEGRAL CURB (6 IN. HEIGHT AND UNDER) TYPE B | LF | | 3023 | |
| 616-99.01 | MISC., TEMPORARY TRAFFIC CONTROL | LS | | 1 | |
| 616-10.98 | CHANGEABLE MESSAGE SIGN, WITHOUT COMM. INTERFACE, CONTRACTOR FURN./RET. | EA | | 2 | |
| 618-10.00 | MOBILIZATION | LS | | 1 | |
| 619-10.00 | PAVEMENT EDGE TREATMENT | LF | | 5546 | |
| 622-10.01 | COLDMILLING BITUMINOUS PAVEMENT FOR REMOVAL OF SURFACING (3 IN. THICK OR LESS) | SY | | 9911 | |
| 627-40.00 | CONTRACTOR FURNISHED SURVEYING AND STAKING | LS | | 1 | |
| 720-99.03 | SMALL-BLOCK RETAINING WALL | SF | | 25 | |
| 803-30.00 | K-31 TALL FESCUE SODDING | SY | | 3943 | |
| 804-10.00 | TOPSOIL | CY | | 1120 | |
| 806-10.05 | ROCK DITCH CHECK | LF | | 174 | |
| 806-10.07A | CURB INLET CHECK | EA | | 23 | |
| 806-10.16 | SEDIMENT REMOVAL | CY | | 64 | |
| 806-10.19 | SILT FENCE | LF | | 3456 | |
| ROADWAY ITEMS SUB-TOTAL = | | | | | |

ITEMIZED BID FORM
STP-5536(610) MANCHESTER ROAD STREETScape PHASE 3

City of Wildwood, Missouri



REVISED

| ITEM # | ITEM DESCRIPTION | UNIT | UNIT COST | QUANTITY | TOTAL |
|-------------------------------|---|------|-----------|----------|-------|
| DRAINAGE/UTILITY ITEMS | | | | | |
| 206-99.07 | MISC., SELECT GRANULAR BACKFILL FOR DRAINAGE SYSTEMS | CY | | 1082 | |
| 304-99.10 | MISC., 2 IN. CLEAN CRUSHED STONE (OPEN GRADED) | TON | | 4092 | |
| 604-99.02 | WATER (ADJUSTING WATER VALVE) | EA | | 7 | |
| 604-99.02 | SEWER (ADJUSTING CLEAN OUT) | EA | | 1 | |
| 604-99.02 | GAS (ADJUSTING GAS VALVE) | EA | | 2 | |
| 604-20.10 | ADJUSTING MANHOLE | EA | | 10 | |
| 604-40.11 | PIPE COLLAR, TYPE A | EA | | 1 | |
| 604-99.01 | MISC., GRATED TRENCH DRAIN WITH PAN | LS | | 1 | |
| 604-99.02 | MISC., OBSERVATION WELLS | EA | | 46 | |
| 604-99.05 | MISC., MSD TYPE 4 FILTER FABRIC | SY | | 8470 | |
| 605-99.03 | MISC., UNDERDRAIN 6 IN. PERFORATED RIGID SCHEDULE 40 | LF | | 8047 | |
| 609-70.00 | ROCK LINING | CY | | 21 | |
| 726-99.02 | MISC., 12 IN. CLASS III PRECAST CONCRETE FLARED END SECTION | EA | | 1 | |
| 726-99.02 | MISC., 18 IN. CLASS III PRECAST CONCRETE FLARED END SECTION | EA | | 1 | |
| 726-99.03 | MISC., 12 IN. CLASS III REINFORCED CONCRETE PIPE CULVERT | LF | | 1717 | |
| 726-99.03 | MISC., 15 IN. CLASS III REINFORCED CONCRETE PIPE CULVERT | LF | | 363 | |
| 726-99.03 | MISC., 18 IN. CLASS III REINFORCED CONCRETE PIPE CULVERT | LF | | 742 | |
| 730-99.03 | MISC., 12 IN. PVC PIPE | LF | | 36 | |
| 731-99.02 | MISC., PRECAST GRATE INLET - 42 IN. | EA | | 1 | |
| 731-99.02 | MISC., PRECAST CURB INLET - 42 IN. | EA | | 9 | |
| 731-99.02 | MISC., PRECAST AREA INLET - 42 IN. | EA | | 13 | |
| 731-99.02 | MISC., PRECAST CONCRETE MANHOLE - 42 IN. | EA | | 5 | |
| 731-99.02 | MISC., PRECAST CONCRETE MANHOLE - 48 IN. | EA | | 9 | |
| 731-99.02 | MISC., PRECAST CONCRETE MANHOLE - 60 IN. | EA | | 1 | |
| 731-99.02 | MISC., HYDRO - DYNAMIC SEPARATOR, 4 FT. DIAMETER | EA | | 2 | |
| | | | | | |
| | DRAINAGE ITEMS SUB-TOTAL = | | | | |

ITEMIZED BID FORM
STP-5536(610) MANCHESTER ROAD STREETScape PHASE 3
 City of Wildwood, Missouri



REVISED

| ITEM # | ITEM DESCRIPTION | UNIT | UNIT COST | QUANTITY | TOTAL |
|--|---|------|-----------|----------|-------|
| SIGNING/STRIPING/LIGHTING ITEMS | | | | | |
| 604-99.01 | MISC., AMEREN AND SPECTRUM UNDERGROUND CONDUIT SYSTEM | LS | | 1 | |
| 616-99.01 | MISC., ACCESSIBLE SIGNAGE | LS | | 1 | |
| 620-00.09 | PREFORMED THERMOPLASTIC PAVEMENT MARKING, 6 IN. WHITE | LF | | 345 | |
| 620-00.15 | PREFORMED THERMOPLASTIC PAVEMENT MARKING, 24 IN. WHITE | LF | | 452 | |
| 620-00.18 | PREFORMED THERMOPLASTIC PAVEMENT MARKING, 24 IN. YELLOW | LF | | 117 | |
| 620-60.00C | 4 IN. WHITE STANDARD WATERBORNE PAVEMENT MARKING PAINT, TYPE P BEADS | LF | | 9008 | |
| 620-60.01C | 4 IN. YELLOW STANDARD WATERBORNE PAVEMENT MARKING PAINT, TYPE P BEADS | LF | | 5698 | |
| 620-99.02 | PREFORMED THERMOPLASTIC PAVEMENT MARKING, BIKE SYMBOL AND ARROW (WHITE) | EA | | 22 | |
| 620-99.02 | PREFORMED THERMOPLASTIC PAVEMENT MARKING, ACCESSIBLE PARKING SYMBOL (WHITE) | EA | | 3 | |
| 620-99.02 | PREFORMED THERMOPLASTIC PAVEMENT MARKING, BIKE SHARED LANE MARKING (WHITE) | EA | | 4 | |
| 901-99.02 | MISC., DECORATIVE STREET LIGHT | EA | | 34 | |
| 903-99.02 | MISC., DECORATIVE STREET POST, TYPE 1 | EA | | 6 | |
| 903-99.02 | MISC., DECORATIVE STREET POST, TYPE 2 | EA | | 22 | |
| | | | | | |
| | SIGNING/STRIPING/LIGHTING ITEMS SUB-TOTAL = | | | | |

ITEMIZED BID FORM
STP-5536(610) MANCHESTER ROAD STREETScape PHASE 3
 City of Wildwood, Missouri

REVISED

| ITEM # | ITEM DESCRIPTION | UNIT | UNIT COST | QUANTITY | TOTAL |
|--|---|------|-----------|----------|-------|
| BICYCLE/PEDESTRIAN FACILITIES/LANDSCAPING ITEMS | | | | | |
| 608-10.10 | CONCRETE CURB RAMP | SY | | 12 | |
| 608-10.12 | TRUNCATED DOMES | SF | | 470 | |
| 608-60.04 | CONCRETE SIDEWALK, 4 IN. | SY | | 113 | |
| 608-99.01 | MISC., CONCRETE STAIRS AND HANDRAILS | LS | | 1 | |
| 608-99.02 | MISC., BIKE RACK | EA | | 2 | |
| 608-99.02 | MISC., PLANTER | EA | | 5 | |
| 608-99.05 | MISC., PERVIOUS CONCRETE SIDEWALK, 4 IN. THICK | SY | | 4406 | |
| 608-99.05 | MISC., PERVIOUS COLORED CONCRETE SIDEWALK, 4 IN. | SY | | 548 | |
| 608-99.05 | MISC., CROSSWALK STAMPED CONCRETE | SY | | 153 | |
| 803-99.05A | MISC., SODDING | SY | | 1935 | |
| 804-99.07A | MISC., PLANT SOIL MIX | CY | | 330 | |
| 805-99.19 | MISC., SEEDING | ACRE | | 0.3 | |
| 808-05.20 | MISC., GROW-LOW SUMAC | EA | | 248 | |
| 808-99.02 | MISC., BUTTERFLY WEED | EA | | 132 | |
| 808-99.02 | MISC., ELIJAH BLUE FESCUE | EA | | 768 | |
| 808-99.02 | MISC., MAIDEN GRASS | EA | | 49 | |
| 808-99.02 | MISC., BLACK-EYED SUSAN | EA | | 150 | |
| 808-99.02 | MISC., COMPACT ANDORRA JUNIPER | EA | | 344 | |
| 808-99.02 | MISC., PYRAMIDAL HORNBEAM | EA | | 60 | |
| 808-99.02 | MISC., GREEN VASE ZELKOVA | EA | | 30 | |
| | | | | | |
| | BICYCLE/PEDESTRIAN FACILITIES/ LANDSCAPING ITEMS SUB-TOTAL = | | | | |
| | CONSTRUCTION TOTAL = | | | | |

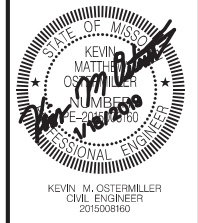

DATE PREPARED
11/2018

ROUTE STATE
MO

DISTRICT SHEET NO.
3B

COUNTY
ST. LOUIS

JOB NO.
STP-5536(610)

PROJECT NAME
MANCHESTER

SHEET NAME
QU

SHEET
1 OF 18

DISCLAIMER:
THE PROFESSIONAL WHOSE SIGNATURE AND PERSONAL SEAL APPEAR HEREIN ASSUMES RESPONSIBILITY ONLY FOR WHAT APPEARS ON THIS PAGE AND DISCLAIMS (PURSUANT TO SECTION 327.141 RSMO) SPECIFICATION, ESTIMATES, REPORTS OR OTHER DOCUMENTS OR INSTRUMENTS NOT SEALED BY THE UNDERSIGNED PROFESSIONAL RELYING TO OR INTENDED TO BE USED FOR ANY PART OR PARTS OF THE PROJECT TO WHICH THIS PAGE REFERS.

| DATE | DESCRIPTION |
|---------|------------------|
| 1/14/19 | REMARKS |
| 1/18/19 | PAY ITEM REMOVED |

CITY OF WILDWOOD
PUBLIC WORKS DEPARTMENT
16860 MAIN STREET
WILDWOOD, MO 63040
636.458.0440

ST. LOUIS OFFICE
720 OLIVE STREET, SUITE 200A
ST. LOUIS, MISSOURI 63101
TEL (636) 241-6300
FAX (636) 241-2391
stlouis@twm-inc.com

PROFESSIONAL REGISTRATIONS LICENSE NO.
MISSOURI PROFESSIONAL ENGR. CORP. NO. 000328
MISSOURI LAND SURVEYING CORP. NO. 000346



REMOVAL OF IMPROVEMENTS = 1 LUMP SUM

CONTRACTOR FURNISHED SURVEYING AND STAKING = 1 LUMP SUM

MOBILIZATION = 1 LUMP SUM

TEMPORARY TRAFFIC CONTROL = 1 LUMP SUM

GRATED TRENCH DRAIN WITH PAN = 1 LUMP SUM

ACCESSIBLE SIGNAGE = 1 LUMP SUM

CONCRETE STAIRS AND HANDRAIL = 1 LUMP SUM

AMEREN AND SPECTRUM UNDERGROUND CONDUIT SYSTEM = 1 LUMP SUM

UTILITY ADJUSTMENTS

| SHEET | STATION | OFFSET | ROUTE | ADJUSTING WATER VALVE (EACH) | ADJUSTING CLEAN OUT (EACH) | ADJUSTING GAS VALVE (EACH) | ADJUSTING MANHOLE (EACH) | REMARKS |
|-----------------|------------|--------|-------|------------------------------|----------------------------|----------------------------|--------------------------|----------------------|
| MANCHESTER ROAD | | | | | | | | |
| PN-1 | 101+54.18 | 29.04 | MAN | 1 | | | | |
| PN-1 | 101+61.44 | -33.94 | MAN | 1 | | | | |
| PN-2 | 105+20.10 | 15.74 | MAN | 1 | | | | |
| PN-2 | 107+16.21 | -32.15 | MAN | 1 | | | | |
| PN-2 | 108+56.02 | 32.52 | MAN | 1 | | | | |
| PN-2 | 108+56.55 | 21.59 | MAN | 1 | | | | |
| PN-4 | 1116+74.09 | 19.32 | MAN | 1 | | | | |
| PN-1 | 101+58.30 | -32.50 | MAN | | 1 | | | |
| PN-2 | 104+66.88 | -20.25 | MAN | | | 1 | | |
| PN-5 | 121+21.05 | -20.62 | MAN | | | 1 | | |
| PN-1 | 102+18.51 | 30.08 | MAN | | | | 1 | |
| PN-1 | 102+40.18 | -20.69 | MAN | | | | 1 | LOCKING LID REQUIRED |
| PN-1 | 103+81.19 | -21.25 | MAN | | | | 1 | |
| PN-2 | 104+20.47 | -21.21 | MAN | | | | 1 | LOCKING LID REQUIRED |
| PN-2 | 104+45.90 | -21.40 | MAN | | | | 1 | LOCKING LID REQUIRED |
| PN-2 | 106+08.70 | -22.52 | MAN | | | | 1 | LOCKING LID REQUIRED |
| PN-2 | 106+89.83 | -23.84 | MAN | | | | 1 | LOCKING LID REQUIRED |
| PN-2 | 107+45.91 | -21.57 | MAN | | | | 1 | |
| PN-2 | 108+88.17 | 40.91 | MAN | | | | 1 | |
| PN-3 | 110+16.82 | 61.66 | MAN | | | | 1 | |
| TOTAL | | | | 7 | 1 | 2 | 10 | |

1

LOCKING LID REQUIRED

LOCKING LID REQUIRED

LOCKING LID REQUIRED

LOCKING LID REQUIRED

2

PAVEMENT ITEMS

| SHEET | STATION | STATION | ROUTE | LOCATION | 4 IN. TYPE 5 AGGREGATE (SY) | ASPHALTIC CONCRETE MIXTURE PG70-22 (SP125CLP) (TONS) | BITUMINOUS PAVEMENT MIXTURE PG64-22 (BASE) (TONS) | POLYMER MODIFIED EMULSION MEMBRANE (GAL) | COLDMILL BITUMINOUS PAV'T (3" OR LESS) (SY) | PAV'T EDGE TREATMENT (LF) | CONCRETE BASE 8 IN. NON-REINFORCED (SY) | REMARKS |
|-----------------|-----------|-----------|---------|----------|-----------------------------|--|---|--|---|---------------------------|---|---------|
| MANCHESTER ROAD | | | | | | | | | | | | |
| PN-1 | 100+00.00 | 104+00.00 | MAN | LT/RT | 795.0 | 191.2 | 61.80 | 255.2 | 1669.4 | 800.0 | | |
| PN-2 | 104+00.00 | 109+00.00 | MAN | LT/RT | 551.9 | 231.3 | | 308.7 | 1773.3 | 1000.0 | | |
| PN-3 | 109+00.00 | 114+00.00 | MAN | LT/RT | 577.6 | 233.7 | | 311.9 | 1884.9 | 1000.0 | | |
| PN-4 | 114+00.00 | 119+00.00 | MAN | LT/RT | 366.3 | 231.2 | | 308.5 | 1789.4 | 1000.0 | | |
| PN-5 | 119+00.00 | 124+00.00 | MAN | LT/RT | 575.3 | 228.2 | | 304.4 | 1734.0 | 1000.0 | | |
| PN-6 | 124+00.00 | 127+73.23 | MAN | LT/RT | 562.4 | 154.2 | | 205.9 | 1059.7 | 746.5 | | |
| PN-1 | 15+19.00 | 18+17.50 | WOODS | LT/RT | | 70.7 | 287.00 | 99.0 | | | | |
| PN-2 | 25+19.00 | 26+09.50 | CLAY | LT/RT | | 16.6 | 68.00 | 23.3 | | | | |
| PN-3 | 35+19.00 | 36+05.00 | GROVER | LT/RT | | 29.4 | 118.70 | 41.2 | | | | |
| PN-5 | 44+56.00 | 44+81.00 | CORSAIR | LT/RT | | 9.8 | 39.50 | 13.7 | | | | |
| PN-1 | 100+00.00 | 104+00.00 | MAN | RT | | | | | | | 32.9 | |
| PN-2 | 104+00.00 | 105+19.75 | MAN | RT | | | | | | | 116.3 | |
| PN-2 | 105+36.89 | 107+17.72 | MAN | RT | | | | | | | 163.3 | |
| PN-3 | 112+04.54 | 114+00.00 | MAN | RT | | | | | | | 140.7 | |
| PN-4 | 114+00.00 | 119+00.00 | MAN | RT | | | | | | | 263.3 | |
| PN-4 | 114+47.19 | 114+72.99 | MAN | LT | | | | | | | 0.4 | |
| PN-4 | 116+38.08 | 116+74.14 | MAN | LT | | | | | | | 0.4 | |
| PN-4 | 118+03.70 | 119+00.00 | MAN | LT | | | | | | | 3.1 | |
| PN-5 | 119+00.00 | 119+55.66 | MAN | LT | | | | | | | 1.1 | |
| PN-5 | 119+00.00 | 119+12.89 | MAN | RT | | | | | | | 0.1 | |
| PN-5 | 119+75.02 | 120+40.47 | MAN | RT | | | | | | | 2.1 | |
| PN-5 | 120+40.47 | 124+00.00 | MAN | RT | | | | | | | 193.3 | |
| PN-5 | 121+24.48 | 121+91.47 | MAN | LT | | | | | | | 6.8 | |
| PN-5 | 121+91.47 | 124+00.00 | MAN | LT | | | | | | | 92.1 | |
| PN-6 | 124+00.00 | 127+73.27 | MAN | LT | | | | | | | 197.3 | |
| PN-6 | 124+00.00 | 127+26.41 | MAN | RT | | | | | | | 107.1 | |
| PN-6 | 127+32.37 | 127+72.83 | MAN | RT | | | | | | | 8.4 | |
| TOTAL | | | | | 3429 | 1396.4 | 575.0 | 1872 | 9911 | 5546 | 1328.7 | |

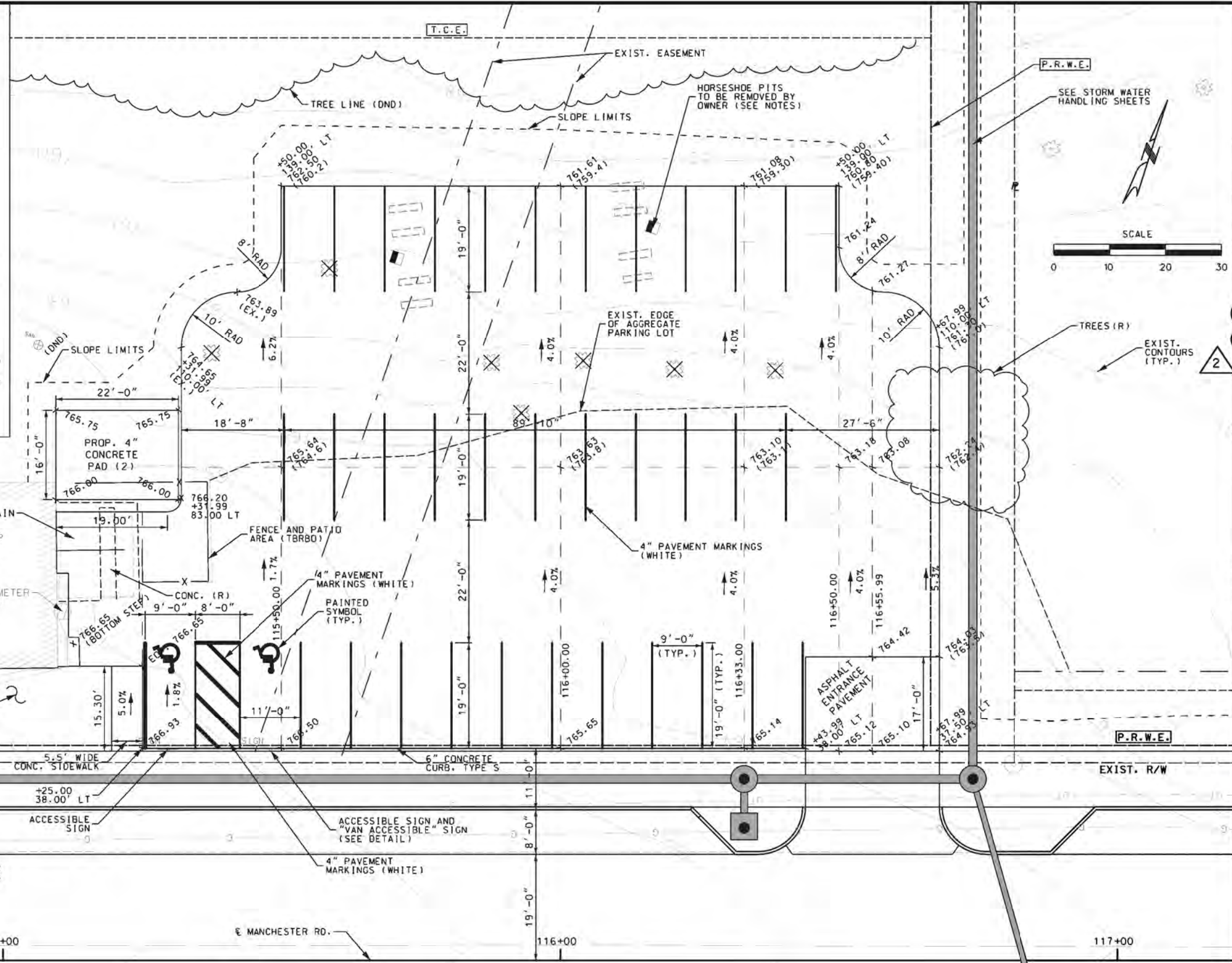
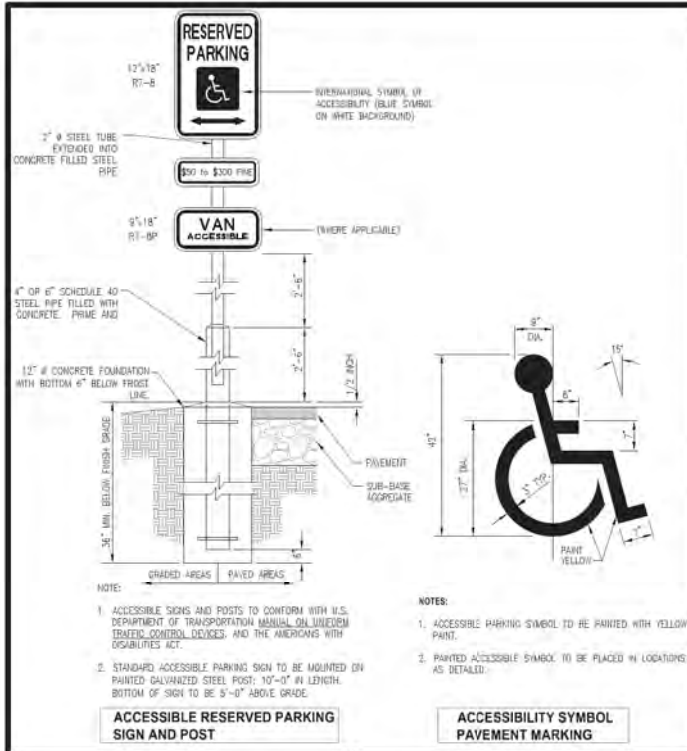

STATE OF MISSOURI
KEVIN M. OSTERMILLER
CIVIL ENGINEER
2006000103

DATE PREPARED: 11/2018

ROUTE: MO
STATE: MO
DISTRICT: SHEET NO. 60
COUNTY: ST. LOUIS
JOB NO.: STP-5536(610)
PROJECT NAME: MANCHESTER
SHEET NAME: SS
SHEET: 3 OF 3

SCALE: 0 10 20 30

SEE STORM WATER HANDLING SHEETS

TREES (R)
EXIST. CONTOURS (TYP.)

1/18/19

DESCRIPTION: SHEET NAME AND # S

DATE: 1/18/19

CITY OF WILDMOOD
PUBLIC WORKS DEPARTMENT
TABBES MAIN STREET
WILDMOOD, MO 65440
636.438.0440

ST. LOUIS OFFICE
720 OLIVE STREET, SUITE 200A
ST. LOUIS, MISSOURI 63101
TEL (636) 241-6300
FAX (636) 241-2391
stlouis@twm-inc.com

PROFESSIONAL REGISTRATIONS LICENSE NO.
MISSOURI PROFESSIONAL CORP. CORP. NO. 002578
MISSOURI LAND SURVEYING CORP. NO. 00046

TWM
THOUVENOT,
WADE &
MOERCHEN, INC.
ENGINEERS & SURVEYORS • PLANNERS

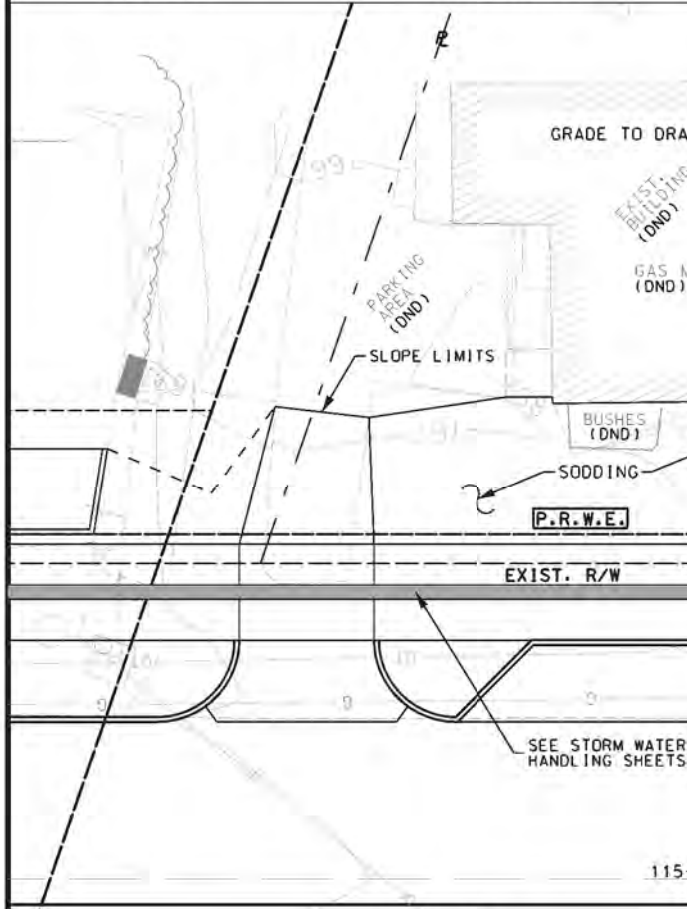

GENERAL NOTES:

- SEE CROSS SECTIONS FOR ADDITIONAL INFORMATION.
- CONCRETE PAD TO BE PAID FOR AS CONCRETE SIDEWALK, 4 INCH.
- CONTRACTOR SHALL REMOVE ANY EXISTING CONCRETE, AGGREGATE AND OTHER MATERIALS IN ORDER TO CONSTRUCT PARKING LOT.
- THE CROSS SLOPE OF THE ACCESSIBLE PARKING STALL AND ACCESS AISLE SHALL NOT EXCEED 2.00% IN ANY DIRECTION
- TREE REMOVAL SHALL BE INCLUDED WITH COST OF REMOVAL OF IMPROVEMENTS.
- IF THE OWNER ELECTS NOT TO REMOVE HORSESHOE PIT, THE CONTRACTOR SHALL REMOVE SAID HORSESHOE PITS AND APPURTENANCES. COST INCLUDED IN COST OF PROJECT.
- ACCESSIBLE SIGNAGE SHALL BE PAID FOR AT THE CONTRACT UNIT PRICE FOR 906-99.01 MISC. SIGN (LUMP SUM) AND SHALL INCLUDE ALL NECESSARY EQUIPMENT, MATERIALS, AND LABOR NECESSARY FOR COMPLIANCE WITH THE CONSTRUCTION AND INSTALLATION OF THE ACCESSIBLE SIGNS SHOWN HEREON. NO DIRECT PAYMENT WILL BE MADE FOR ANY INCIDENTAL ITEMS.

LEGEND
X = TREE (R)
(762.42) = EXIST. GRADE

PAVEMENT DETAIL
3" BITUMINOUS PAVEMENT MIXTURE PG 64-22 (BP-1)
8" TYPE 1 AGGREGATE BASE
PREPARED SUBGRADE

1/18/19

DESCRIPTION: SHEET NAME AND # S

DATE: 1/18/19

CITY OF WILDMOOD
PUBLIC WORKS DEPARTMENT
TABBES MAIN STREET
WILDMOOD, MO 65440
636.438.0440

ST. LOUIS OFFICE
720 OLIVE STREET, SUITE 200A
ST. LOUIS, MISSOURI 63101
TEL (636) 241-6300
FAX (636) 241-2391
stlouis@twm-inc.com

PROFESSIONAL REGISTRATIONS LICENSE NO.
MISSOURI PROFESSIONAL CORP. CORP. NO. 002578
MISSOURI LAND SURVEYING CORP. NO. 00046

TWM
THOUVENOT,
WADE &
MOERCHEN, INC.
ENGINEERS & SURVEYORS • PLANNERS