

Steven V. Stenger
County Executive

Saint Louis
COUNTY
TRANSPORTATION
PUBLIC WORKS

Daniel W. Dreisewerd, P.E., PTOE
Acting Director

Stephanie Leon Streeter, P.E.
Deputy Director

September 26, 2018

ADDENDUM NO. 1

Notice to All Persons and Firms Proposing
to Submit a Bid or Furnish Materials for
2018 ITS Program-Interconnect Camera and Beacon
St. Louis County Project No. AR-1689
Federal Project No. CMAQ-5537(622)

The construction contract for this project has been revised as follows:

No. 1

Revised Bid Sheets in Contract and Specification Book. Bid Sheet pages 183 through 185 of 194 replaced with 183a through 185a of 194, specific changes as follows:

- A.) Bid Item 904-43.88 "Controller, Fully Actuated, (8 Phase Timer, in Aluminum Cabinet Approx. 55"H x 44"W x 26"D, Wired for 8 Phase Operation) w/Internal Fiber Optic Modem and Termination Housing TS2, Type 2, w/Battery Backup" quantity updated from 7 to 6.
- B.) Bid Item 904-43.87 "Controller, Fully Actuated, (8 Phase Timer, in Aluminum Cabinet Approx. 67"H x 44"W x 26"D, Wired for 8 Phase Operation) w/Internal Fiber Optic Modem and Termination Housing TS2, Type 2, w/Battery Backup" bid item added – quantity 1.

No. 2

Revised plan sheet No. 3 of 20 for Bid Item No. 904-43.88 from 7 to 6; **Added** Bid Item No. 904-43.87– quantity 1.

No. 3

Modified notes on Plan Sheet No. 4 of 20.

REVISED ITEMIZED BID SHEET NOS. 183a THROUGH 185a OF 194 ARE ATTACHED AND REFLECT THE CHANGES NOTED IN ITEM NO. 2 ABOVE. FAILURE TO SUBSTITUTE THE ITEMIZED BID SHEETS MAY RESULT IN REJECTION OF THE BID.

ATTENTION BIDDERS: THE ADDENDUM ACKNOWLEDGEMENT IN THE BID DOCUMENTS MUST BE COMPLETED AND SUBMITTED WITH ALL BID PROPOSALS.



Joseph W. Kulesa, P.E.
Division Manager, Design

JWK/JLM/jlh

Attachments: Revised Itemized Bid Sheets and Revised Plan Sheets 3 and 4 of 20

ITEMIZED BID BID OPTION 1 OF 1

PAGE 1 OF 3

FEDERAL PROJECT NO. CMAQ-5537(622)

COUNTY PROJECT NO. AR-1689

ITEM NO.	ITEM DESCRIPTION	UNIT	QUANTITY	UNIT PRICE	AMOUNT
ROADWAY ITEMS					
107-02.00	Railroad Permits, Agreements, and Licenses	EACH	1		
612-30.10	Standard Traffic Control Devices	L.S.	1		
619-00.00	Mobilization	L.S.	1		
806-00.00	Erosion Control Measures (Sites less than 1 acre)	L.S.	1		
806-45.00	Inlet Protection	L.S.	1		
SUBTOTAL - ROADWAY ITEMS					

COUNTY TRAFFIC SIGNAL ITEMS					
904-43.87	Controller, Fully Actuated, (8 Phase Timer, in Aluminum Cabinet Approx. 67"H x 44"W x 26"D, Wired for 8 Phase Operation) w/Internal Fiber Optic Modem and Termination Housing TS2, Type 2, w/Battery Backup	EACH	1		
904-43.88	Controller, Fully Actuated, (8 Phase Timer, in Aluminum Cabinet Approx. 55"H x 44"W x 26"D, Wired for 8 Phase Operation) w/Internal Fiber Optic Modem and Termination Housing, TS2, Type 2, w/Battery Backup	EACH	6		

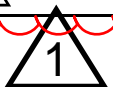

ADDENDUM 1

ITEMIZED BID BID OPTION 1 OF 1

PAGE 2 OF 3

FEDERAL PROJECT NO. CMAQ-5537(622)

COUNTY PROJECT NO. AR-1689

ITEM NO.	ITEM DESCRIPTION	UNIT	QUANTITY	UNIT PRICE	AMOUNT
COUNTY TRAFFIC SIGNAL ITEMS					
904-49.35	Detector, Vehicle Induction Loop, Card Rack Mtg., 2 Channel, w/Delay and Extension Timing and Relay Outputs	EACH	21		
904-49.51	Pan Tilt Zoom (PTZ) Internet Protocol Video Surveillance Camera System (Camera w/Bracket, Managed Ethernet Switch, and Misc. Cables)	EACH	35		
904-49.52	Software License, PTZ Camera	EACH	35		
904-52.00	Conduit, 2"	L.F.	2755		
904-74.99	Conduit Repair (locate broken conduit, excavate, remove existing cable, repair/replace conduit, reinstall cable, backfill and restore) (Does not include sidewalk or pavement removal and replacement)	EACH	1		
904-85.36	Cable, Communication, Fiber Optic, 36 Fibers (30 Single-Mode and 6 Multi-Mode)	L.F.	6700		
904-85.81	Cable, Communication, Power, PTZ Camera, #24 Gauge, 4 Pair (Shielded)	L.F.	5920		
904-89.17	Preformed Pull Box (17"W x 30"L x 26"min.H), Reinforced Polymer Concrete	EACH	6		
904-90.17	Preformed Pull Box (17"W x 30"L x 26"min.H), Reinforced Polymer Concrete w/1' Concrete Apron	EACH	1		



ADDENDUM 1

ITEMIZED BID BID OPTION 1 OF 1

PAGE 3 OF 3

FEDERAL PROJECT NO. CMAQ-5537(622)

COUNTY PROJECT NO. AR-1689

ITEM NO.	ITEM DESCRIPTION	UNIT	QUANTITY	UNIT PRICE	AMOUNT
COUNTY TRAFFIC SIGNAL ITEMS					
904-95.10	Opening Drilled in Existing Concrete Pull Box	EACH	4		
904-95.30	Removal of Preformed Pull Box	EACH	1		
904-97.33	Removal of Existing Controller Cabinet	EACH	7		
906-92.00	School Zone Beacon Wireless Communication Equipment (Installed by Others)	EACH	19		
SUBTOTAL - COUNTY TRAFFIC SIGNAL ITEMS					

PEDESTRIAN AND BICYCLE ITEMS					
608-60.94	Remove and Replace Concrete Sidewalk (4" Thick)	S.Y.	33.6		
SUBTOTAL - PEDESTRIAN AND BICYCLE ITEMS					

PROJECT TOTAL - BID OPTION 1 OF 1					
--	--	--	--	--	--



ADDENDUM 1

THE CENTERLINES DEPICTED HEREON ARE NOT TIED TO ANY KNOWN OR ESTABLISHED SURVEY CONTROL POINTS AND WILL NOT BE ABLE TO BE PHYSICALLY ESTABLISHED ON THE GROUND. THEY ARE SHOWN FOR GENERAL REFERENCE ONLY AND SHOULD NOT BE USED FOR CONSTRUCTION PURPOSES.

THIS DRAWING IS NOT BASED ON THE RESULTS OF A TOPOGRAPHIC SURVEY. THE ACTUAL CONDITIONS AND RELATIVE LOCATIONS OF EXISTING IMPROVEMENTS AT THIS LOCATION MAY VARY FROM THOSE SHOWN.

THIS DRAWING IS NOT TO SCALE. DO NOT SCALE THIS DRAWING FOR DETERMINING DIMENSIONS OR QUANTITIES. REFER TO TABLES AND SCHEDULES HEREON.

GEOGRAPHIC INFORMATION SYSTEM (GIS) PARCEL LINES SHOWN ON THESE PLANS ARE BASED UPON THE PARCEL MAPPING LAYER OF THE ENTERPRISE GIS AS MAINTAINED BY THE ST. LOUIS COUNTY GIS SERVICE CENTER, AND HAVE NOT BEEN VERIFIED BY ACTUAL GROUND SURVEYS. THE QUALITY AND ACCURACY OF THE GIS DATA IS UNKNOWN, AND MAY NOT ACCURATELY REFLECT THE TRUE LOCATION OR EXTENT OF PROPERTY RIGHTS. PARCEL LINES ARE FOR THE SOLE PURPOSE OF GENERAL ILLUSTRATION. THESE PLANS SHALL NOT BE UTILIZED AS THE BASIS FOR DETERMINING TITLE INTEREST TO REAL ESTATE. IT SHALL BE THE RESPONSIBILITY OF ANY INTERESTED PARTIES TO DETERMINE WHETHER A MORE RELIABLE SOURCE OF PARCEL DATA IS REQUIRED.

THE PROFESSIONAL ENGINEER WHOSE SEAL AND SIGNATURE APPEARS ON THIS PLAN HEREBY DISCLAIMS ANY RESPONSIBILITY OF THE LINES SHOWN HEREON LABELED AS "GIS PARCEL LINE".

THE UNDERLYING ORTHOPHOTOGRAPH IS FROM A SET OF AERIAL IMAGES TAKEN BY SURDEX CORPORATION DURING 2016.

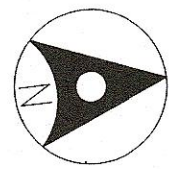

N.T.S.

COUNTY PROJECT NO.		AR-1689
FEDERAL PROJECT NO.		
E-W GATEWAY TIP NO.		
MSD:		
MSD BASE MAP:		
REV	DATE	DESCRIPTION
		ADDENDUM 1
1	10/2/2018	

DISCLAIMER OF RESPONSIBILITY
I, the undersigned, hereby certify that the design and construction of the project shown on this sheet, and I hereby disclaim any responsibility for the design, construction, or performance of the project shown on this sheet, and I hereby disclaim any responsibility for the design, construction, or performance of the project shown on this sheet, and I hereby disclaim any responsibility for the design, construction, or performance of the project shown on this sheet.

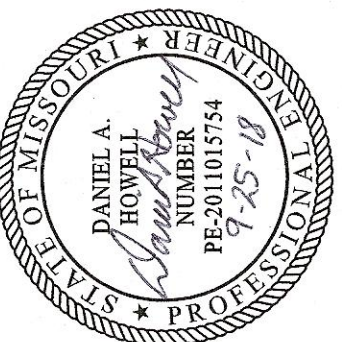

DATE: 9-25-18

DESIGNED BY:
DESIGN DIVISION
1060 N. LINDBERGH BLVD.
ST. LOUIS, MISSOURI 63132
(314) 615-8843
DANIEL A. HOWELL
PROFESSIONAL ENGINEER
LICENSE NO. 2011015754

Saint Louis
COUNTY
TRANSPORTATION
PUBLIC WORKS
Daniel W. Dreiswerdt, P.E., PTOE
Acting Director

2018 ITS Program-
Interconnect, Camera,
and Beacon Improvements
INTERCONNECT SHEET

DESIGNED: J.L.MILLER

DRAWN: J.L.MILLER

CHECKED: C.B.DENBOW

SHEET SEQUENCE:
4 OF 20

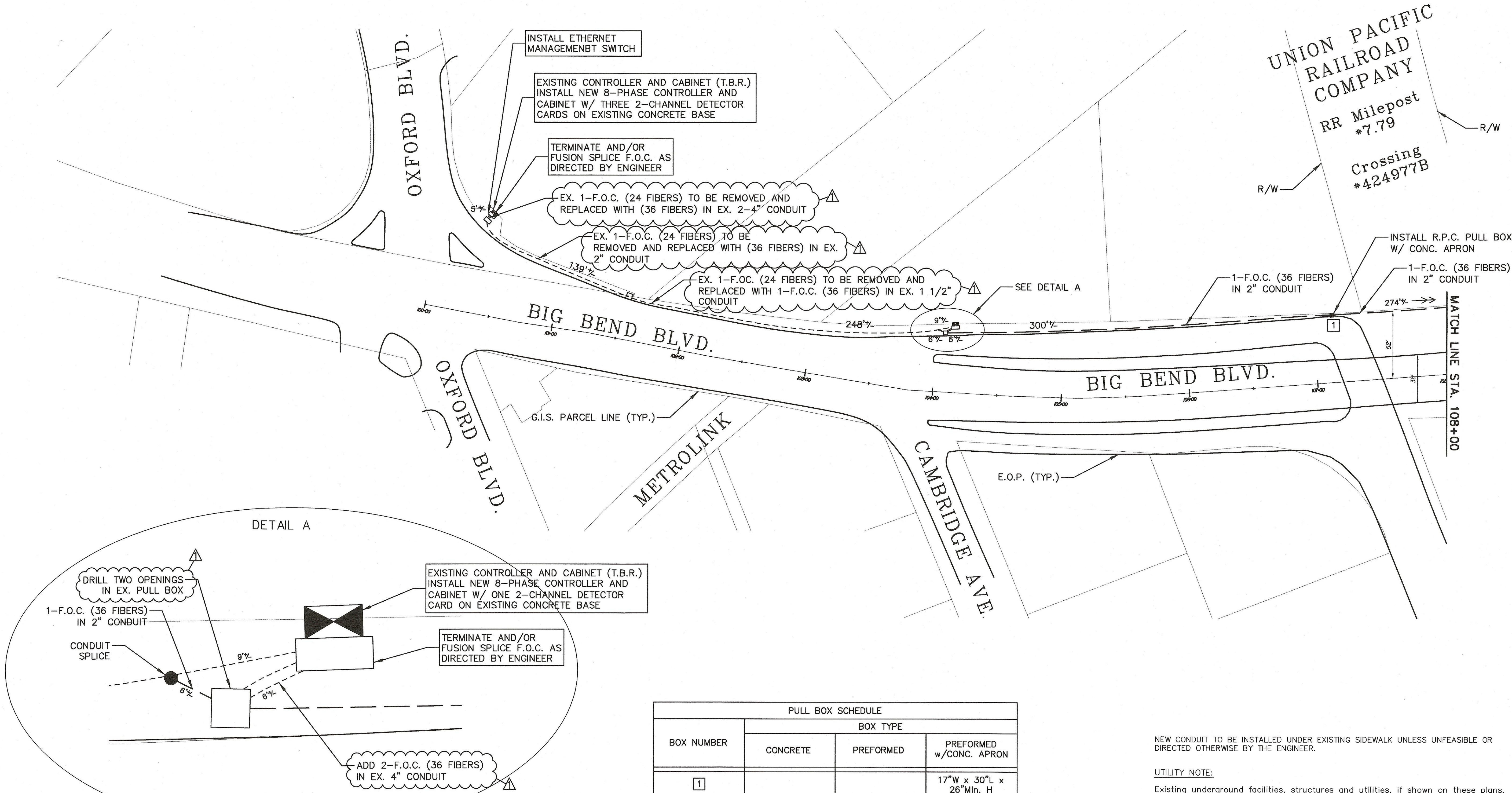

BOX NUMBER	PULL BOX SCHEDULE		
	BOX TYPE		
	CONCRETE	PREFORMED	PREFORMED w/CONC. APRON
1			17"W x 30"L x 26"Min. H

NEW CONDUIT TO BE INSTALLED UNDER EXISTING SIDEWALK UNLESS UNFEASIBLE OR DIRECTED OTHERWISE BY THE ENGINEER.

UTILITY NOTE:

Existing underground facilities, structures and utilities, if shown on these plans, shall be considered approximate only. Verification of the locations of all existing facilities, structures and utilities either shown or not shown on these plans, shall be the responsibility of the Contractor, and shall be verified prior to any grading, excavation or construction of improvements.