

DESIGN DESIGNATION

A.D.T. - 2009 = 33.300
 A.D.T. - 2029 = 45.025
 D.H.V. = 10%
 T = 38%
 V = 70 M.P.H.

FUNCTIONAL CLASSIFICATION - INTERSTATE

FULLY CONTROLLED ACCESS HIGHWAY

THIS SHALL BE A FULLY CONTROLLED ACCESS HIGHWAY BETWEEN STA. 744+72.35 AND STA. 783+39.37. NO ABUTTING OWNER SHALL HAVE THE RIGHT OF DIRECT ACCESS TO SAID HIGHWAY OR ITS RIGHT-OF-WAY EXCEPT THAT ACCESS WILL BE PERMITTED TO ANY ADJACENT OUTER ROADWAY OR SERVICE ROAD TO WHICH ACCESS IS NOT SPECIFICALLY PROHIBITED BY THE SPECIAL SYMBOL DENOTING "NO RIGHT OF ACCESS" AS SHOWN ON THE PLANS. NO ACCESS WILL BE PERMITTED FROM OUTER ROADWAYS AND SERVICE ROADS TO THROUGHWAYS EXCEPT ALONG ROUTES CONSTRUCTED FOR THAT PURPOSE. OUTER ROADWAYS AND SERVICE ROADS, AS THE CASE MAY BE, ARE SO DESIGNATED ON THE PLANS.

- BEGINNING AND ENDING OF CONTROLLED ACCESS
- +—+— CONTROLLED ACCESS
- ||—||— NO RIGHT OF ACCESS OR CROSSING OF LINES BEARING THIS SYMBOL WILL BE PERMITTED UNDER ANY CIRCUMSTANCES.
- ||—||— TEMPORARY ACCESS THROUGH FUTURE NO RIGHT OF ACCESS

**CONVENTIONAL SYMBOLS
(USED IN PLANS)**

- | | | |
|------------------------------|----------|----------------|
| | EXISTING | NEW |
| BUILDINGS AND STRUCTURES | | |
| GUARD RAIL (GR) | | |
| CONCRETE RIGHT-OF-WAY MARKER | | |
| STEEL RIGHT-OF-WAY MARKER | | |
| LOCATION SURVEY MARKER | | |
| UTILITIES | | |
| FIBER OPTICS | | |
| OVERHEAD TELEPHONE | | |
| UNDERGROUND TELEPHONE | | |
| OVERHEAD POWER | | |
| UNDERGROUND POWER | | |
| GAS | | |
| WATER | | |
| MANHOLE | | |
| FIRE HYDRANT | | |
| WATER VALVE | | |
| WATER METER | | |
| DROP INLET | | |
| DITCH BLOCK | | |
| GROUND MOUNTED SIGN | | |
| LIGHT POLE | | |
| H-FRAME POWER POLE | | |
| TELEPHONE PEDESTAL | | |
| FENCE | | |
| CHAIN LINK | | |
| WOVEN WIRE | | |
| GATE POST | | |
| BENCHMARK | | |
| UIP | | USE IN PLACE |
| (R) | | REMOVE |
| DND | | DO NOT DISTURB |
- NOTE: DASHED OR OPEN SYMBOLS INDICATE EXISTING FEATURES

MISSOURI HIGHWAYS AND TRANSPORTATION COMMISSION

PLANS FOR PROPOSED STATE HIGHWAY FEDERAL AID PROJECT LAWRENCE COUNTY

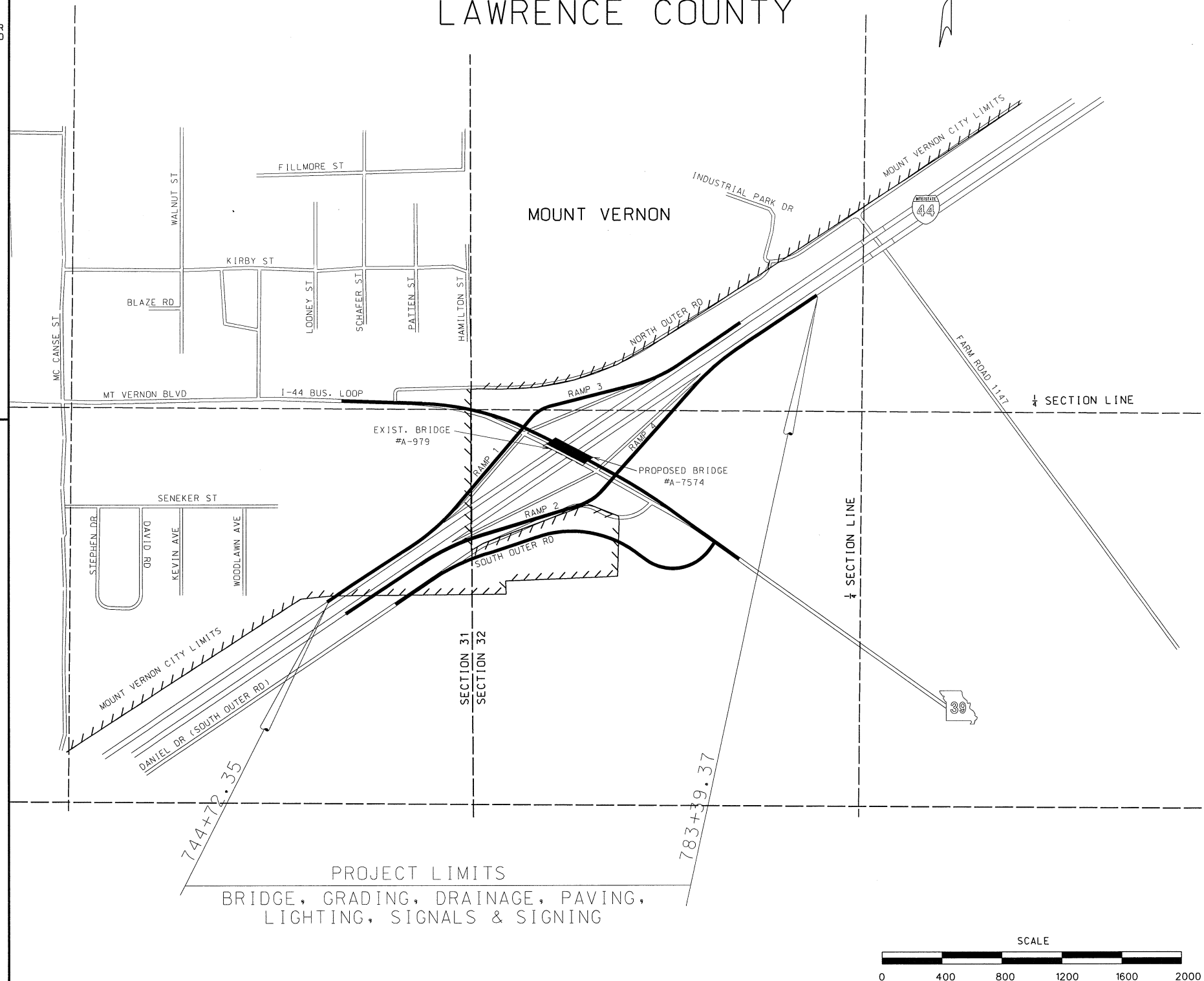

ROUTE 44	STATE MO	DISTRICT 7	SHEET NO. 1
JOB NO. J710599			
CONTRACT ID.			
PROJECT NO.			
COUNTY LAWRENCE			

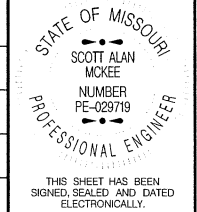

INDEX OF SHEETS

DESCRIPTION	SHEET NUMBER
TITLE SHEET -----	1
TYPICAL SECTIONS (TS) (10 SHEETS)---	2
QUANTITIES (QU) (13 SHEETS)-----	3
PLAN-PROFILE (PP)-----	4-24
REFERENCE POINTS (RP)-----	25
COORDINATE POINTS (CP)-----	26
SPECIAL SHEETS (SS)-----	27-28
TRAFFIC CONTROL SHEETS (TC)-----	29-37C
EROSION CONTROL SHEETS (EC)-----	38-39
LIGHTING (LT)-----	40-42
SIGNALS (SG)-----	43-58
SIGNING (SN)-----	59-85
PAVEMENT MARKING (PM)-----	86-90
CULVERT SECTIONS (CS)-----	91-94
MSE WALL (MSE)	
D7-0002-----	95-96
BRIDGE DRAWINGS (B)	
A7574-----	1-50
CROSS SECTIONS (XS)-----	1-115

LENGTH OF PROJECT

BEGINNING OF PROJECT	STA. 744+72.35
END OF PROJECT	STA. 783+39.37
APPARENT LENGTH	3867.02 FEET
EQUATIONS AND EXCEPTIONS	NONE
TOTAL CORRECTIONS	0.00 FEET
NET LENGTH OF PROJECT	3867.02 FEET
STATE LENGTH	0.732 MILES

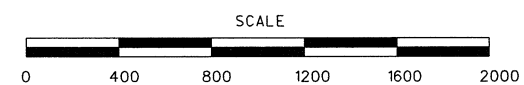

IF A SEAL IS PRESENT ON THIS SHEET IT HAS BEEN ELECTRONICALLY SEALED AND DATED. Contract I.D. 080919-701