

ROUTE	STATE	DISTRICT	SHEET NO.	"THIS MEDIA SHOULD NOT BE CONSIDERED A CERTIFIED DOCUMENT." DATE _____
	MO	BR		
JOB NO.				
CONTRACT ID.				
PROJECT NO.				
COUNTY				

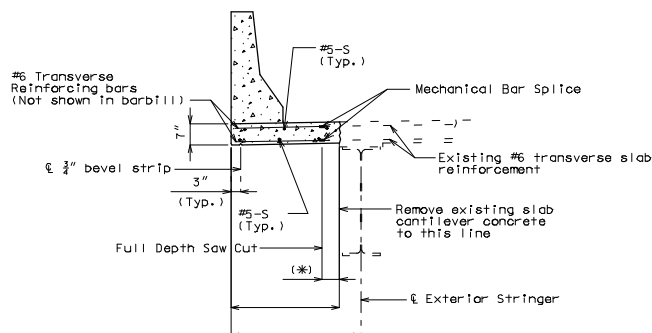

TYPICAL PART SECTION FOR OPTIONAL SLAB CANTILEVER REPLACEMENT

OPTIONAL SLAB CANTILEVER REPLACEMENT

The box shown below indicating whether or not the optional slab cantilever replacement method was used should be checked by MODOT Construction personnel:

Optional replacement method WAS used.
 Optional replacement method WAS NOT used.

NOTE :

(*) Min. distance required for mechanical bar splice. All existing transverse slab reinforcement in this area shall be cleanly stripped.

With the optional slab cantilever replacement, the contractor shall use a mechanical bar splice for the existing exposed transverse slab reinforcement. The length of the new #6 reinforcing bars used with the mechanical bar splice shall be determined by the contractor based on the style of mechanical bar splice used and other considerations. Mechanical bars splices shall be in accordance with Sec 706 except that there will be no separate pay item for mechanical bar splices. The mechanical bar splices and accompanying new #6 reinforcing bars will be considered completely covered by contract unit price for other items included in the contract.

For spacing longitudinal reinforcing steel, see Sheet No. . . .

For details of Safety Barrier Curb, see Sheet Nos. . . .

DETAILS OF OPTIONAL SLAB CANTILEVER REPLACEMENT

Detailed
Checked

Note: This drawing is not to scale. Follow dimensions.

Sheet No. of

WID6

IF A SEAL IS PRESENT ON THIS SHEET IT HAS BEEN ELECTRONICALLY SEALED AND DATED.