

ROUTE	STATE	DISTRICT	SHEET NO.	*THIS MEDIA SHOULD NOT BE CONSIDERED A CERTIFIED DOCUMENT.* DATE
	MO			
JOB NO.				
CONTRACT ID.				
PROJECT NO.				
COUNTY				

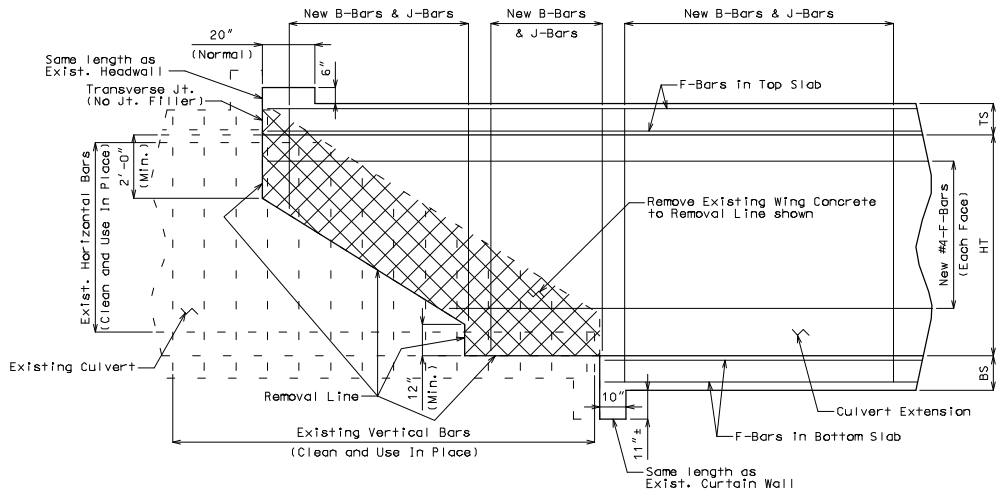

**ELEVATION OF EXTERIOR WING SHOWING OPTIONAL CONCRETE REMOVAL**  
(Interior Wings similar)

Note: A-Bars, D-Bars, H-Bars & R-Bars not shown for clarity.

Note: For details of Transverse Joint, see Missouri Standard Plans.

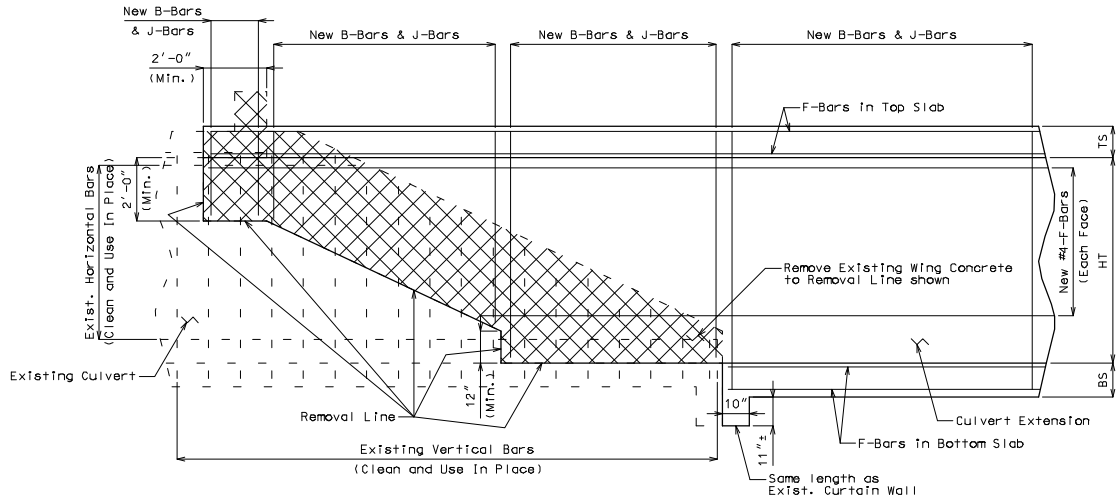

**ELEVATION OF EXTERIOR WING SHOWING OPTIONAL CONCRETE REMOVAL**  
(Interior Wings similar)

Note: A-Bars & H-Bars not shown for clarity.

Note: When the headwall is removed, the top slab A-bars and F-bars shall lap the existing bars a minimum of 2'-0".

Note to Detailer:

Check wall thickness to see if existing and new matches. If different, see SPM.

SPM to have design checked before using details.

SPM could use wing beam design to possibly eliminate all removals.

Detailed Checked

Note: This drawing is not to scale. Follow dimensions.

Sheet No. of

BOX 16

IF A SEAL IS PRESENT ON THIS SHEET IT HAS BEEN ELECTRONICALLY SEALED AND DATED.